

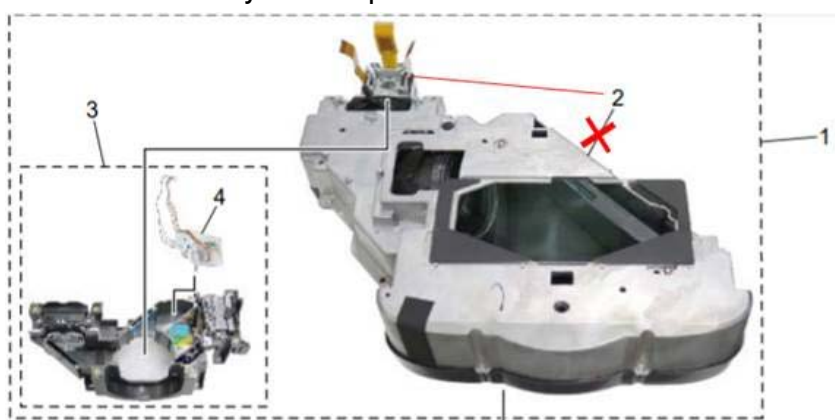



Model: Praesepe-PJ1		Date: 13-Feb-19	No.: RY0CC001
Subject: Parts Catalog correction - the PN of prism unit		Prepared by: T. Sakakibara	
From: CS Business Center, Digital Business Group			
Classification:	<input type="checkbox"/> Troubleshooting <input type="checkbox"/> Mechanical <input type="checkbox"/> Paper path <input type="checkbox"/> Product Safety	<input type="checkbox"/> Part information <input type="checkbox"/> Electrical <input type="checkbox"/> Transmit/receive <input type="checkbox"/> Other (Firmware)	<input type="checkbox"/> Action required <input checked="" type="checkbox"/> Service manual revision <input type="checkbox"/> Retrofit information <input checked="" type="checkbox"/> Tier 2

Page 6 Index No.2:

Index No.2 is only for the prism unit.

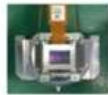

1	Y0C83001	EFN:250002700:OPTICAL_ENGIN (RICOH PJ XC4660, LX3800UST, LX3806UST)		The entire Optical engine
1	Y0CC3000	EFN:250002600:OPTICAL_ENGIN (RICOH PJ WXC4660, LW3800UST)		
1	Y0CD3004	EFN:250002500:OPTICAL_ENGIN (RICOH PJ WUC4650, LU3800UST)		
2	Y0C83500	EFN:230007200:OPTICAL_ENGIN (RICOH PJ XC4660, LX3800UST, LX3806UST)		The prism unit, a part of optical engine
2	Y0CC3500	EFN:230007100:OPTICAL_ENGIN (RICOH PJ WXC4660, LW3800UST)		
2	Y0CD3500	EFN:230007000:OPTICAL_ENGIN (RICOH PJ WUC4650, LU3800UST)		
3	Y0C83550	EFN:250005300:ILLUMINATION_ (RICOH PJ XC4660, LX3800UST, LX3806UST)		The frame and the shutter
3	Y0CC3550	EFN:250005400:ILLUMINATION_ (RICOH PJ WXC4660, WUC4650, LW3800UST, LU3800UST)		
4	Y0C83560	EFN:230008700:SHUTTER		

Only the shutter