

Read This First

Safety Information

1

Information for This Machine

2



Read this manual carefully before you use this machine and keep it handy for future reference. For safe and correct use, be sure to read the Safety Information in this manual before using the machine.

TABLE OF CONTENTS

How to Read This Manual.....	2
Introduction.....	2
Disclaimer.....	2
Notes.....	2

1. Safety Information

Safety During Operation.....	3
Safety Precautions to Be Followed.....	4
Environments Where the Machine Can Be Used.....	4
Handling Power Cords and Power Cord Plugs.....	5
Handling the Main Machine.....	7
Handling the Machine's Interior.....	8
Installing and Fixing the Projector a Wall or Ceiling.....	9
About the Batteries.....	10
About the Lamp.....	10
Handling a Wireless LAN.....	11
Moving.....	12
Safety Labels of This Machine.....	13
Positions of WARNING and CAUTION Labels.....	13
Power Switch Symbols.....	15

2. Information for This Machine

Laws and Regulations.....	17
Notes to USA Users of FCC Requirements.....	17
Notes to Canadian Users of IC Rules.....	19
Notes on lamp(s) inside this machine.....	21
Notes to users in the state of California.....	21
Notes to Canadian Users of ICES -003 Conformance.....	21

How to Read This Manual

Introduction

This manual contains detailed instructions and notes on the operation and use of this machine. For your safety and benefit, read this manual carefully before using the machine. Keep this manual in a handy place for quick reference.

Disclaimer

In no event will the company be liable for direct, indirect, special, incidental, or consequential damages as a result of handling or operating the machine.

Notes

Contents of this manual are subject to change without prior notice.

Some illustrations in this manual might be slightly different from the machine.

The manufacturer shall not be responsible for any damage or expense that might result from the use of parts other than genuine parts from the manufacturer with your office products.

1. Safety Information

This chapter describes safety information for this machine.

Safety During Operation

In this manual, the following important symbols are used:

WARNING

Indicates a potentially hazardous situation which, if instructions are not followed, could result in death or serious injury.

CAUTION

Indicates a potentially hazardous situation which, if instructions are not followed, may result in minor or moderate injury or damage to property.

Safety Precautions to Be Followed

This section explains safety precautions that should always be followed when using this machine.

Environments Where the Machine Can Be Used

This section explains safety precautions about environments where the machine can be used.

WARNING

- Do not place vases, plant pots, cups, toiletries, medicines, small metal objects, or containers holding water or any other liquids, on or close to this machine. Fire or electric shock could result from spillage or if such objects or substances fall inside this machine.
- Keep the machine and attachments out of the reach of children. If the machine is near children, it may cause injury.

CAUTION

- Keep the machine away from humidity and dust. Otherwise a fire or an electric shock might occur.
- Do not place any objects on the machine. Doing so may cause the machine to topple over, possibly resulting in injury.
- Do not place the machine on an unstable or tilted surface. If it topples over, an injury might occur.
- Do not place the machine or use it in an environment where it might get wet such as from snow, rain, or being near water. Doing so could result in fire or electric shock.
- Do not put your face or hand near the exhaust vents. Doing so could result in burns or an accident due to hot air coming from the exhaust vents.
- Do not use the machine on soft material such as paper or cloth that might get sucked into the intake vents. Doing so may cause heat buildup inside the machine, resulting in malfunction, burns, or fire.
- Do not place the machine in a location where air flow is poor. Doing so may cause fire due to internal components becoming overheated.

⚠ CAUTION

- Do not place or store the machine in a location where direct sunlight or heat generation might occur. The heat may deform or wear out the exterior parts or negatively affect internal parts. Doing so could result in fire.
- Do not place low heat resistant material near the exhaust vents. Hot air may come from the exhaust vents, resulting in damage to the machine or an accident.
- Do not obstruct the machine's vents. Doing so risks fire caused by overheated internal components.

1

Handling Power Cords and Power Cord Plugs

This section explains safety precautions about handling power cords and power cord plugs.

⚠ WARNING

- Do not use any power sources other than those that match the specifications shown in this manual. Doing so could result in fire or electric shock.
- Do not damage, break, or modify the power cord. Also, do not place heavy objects on the power cord, or pull the cord or bend it severely. Doing so could result in fire or electric shock.
- Touching the prongs of the power cable's plug with anything metallic constitutes a fire and electric shock hazard.
- The supplied power cord is for use with this machine only. Do not use it with other appliances. Doing so could result in fire or electric shock.
- It is dangerous to handle the power cord plug with wet hands. Doing so could result in electric shock.
- Be sure to disconnect the plug from the wall outlet at least once a year and check for the following:
 - There are burn marks on the plug.
 - The prongs on the plug are deformed.
- If any of the above conditions exist, do not use the plug and consult your dealer or service representative. Use of the plug could result in fire or electric shock.

WARNING

- Be sure to disconnect the power cord from the wall outlet at least once a year and check for the following:
 - The power cord's inner wires are exposed, broken, etc.
 - The power cord's coating has a crack or dent.
 - When bending the power cord, the power turns off and on.
 - Part of the power cord becomes hot.
 - The power cord is damaged.
- If any of the above conditions exist, do not use the power cord and consult your dealer or service representative. Use of the power cord could result in fire or electric shock.

- Do not use the connection cable if it is deformed, cracked, or damaged. Doing so could result in fire or electric shock. If the connection cable is deformed, cracked, or damaged, contact your service representative to request a replacement cable.

- When using an extension cord or power strip, only connect equipment whose total power consumption is within the power rating for the extension cord or power strip. If the power rating is exceeded, it may cause heat buildup and result in fire.

CAUTION

- Push the power plug all the way into the power outlet. Do not use a power outlet with a loose connection. Doing so may result in heat buildup. Plug the power cord in the correct direction into the base. If they are not plugged in correctly, it could result in smoke, fire, or electric shock.

- If this machine is not going to be used for several days or longer at a time, disconnect its power cord from the wall outlet.

- When disconnecting the power cord from the wall outlet, always pull the plug, not the cord. Pulling the cord can damage the power cord. Use of damaged power cords could result in fire or electric shock.

- Be sure to disconnect the plug from the wall outlet and clean the prongs and the area around the prongs at least once a year. Allowing dust to build up on the plug constitutes a fire hazard.

- When performing maintenance on the machine, always disconnect the power cord from the wall outlet.

- Do not place the power cord and connection cable in a way that might cause someone to trip and fall. The machine might fall over and cause an injury.

- Power Source

220–240 V, 1.7A or more, 50/60Hz

120 V, 3.7A or more, 60Hz

Please be sure to connect the power cord to a power source as above.

1

Handling the Main Machine

This section explains safety precautions about handling the main machine.

WARNING

- If the machine emits smoke or odours, or if it behaves unusually, you must turn off its power immediately. After turning off the power, be sure to disconnect the power cord plug from the wall outlet. Then contact your service representative and report the problem. Do not use the machine. Doing so could result in fire or electric shock.
- If metal objects, or water or other fluids fall inside this machine, you must turn off its power immediately. After turning off the power, be sure to disconnect the power cord plug from the wall outlet. Then contact your service representative and report the problem. Do not use the machine. Doing so could result in fire or electric shock.
- Do not touch this machine if a lightning strike occurs in the immediate vicinity. Doing so could result in electric shock.
- The following explains the warning messages on the plastic bag used in this product's packaging.
 - Keep the polythene materials (bags, etc.) supplied with this machine away from babies and small children at all times. Suffocation can result if polythene materials are brought into contact with the mouth or nose.
- If the machine topples, or if a cover or other part gets broken, you must turn off its power immediately. After turning off the power, be sure to disconnect the power cord plug from the wall outlet. Then contact your service representative and report the problem. Do not use the machine. Doing so could result in fire or electric shock.

CAUTION

- The machine may be very hot after it is turned off, especially the vents and the lower part of the unit where the lamp is located. Avoid touching these areas. Doing so may result in burns.
- Do not place the machine on other equipment or vice versa. Doing so may cause heat buildup inside the machine or cause the other equipment to malfunction.

⚠ CAUTION

- Do not increase the volume unless you are listening while increasing the volume. Also, lower the volume before turning off the power, because a loud sound may be emitted when the power is turned on and cause hearing damage.
- Do not tilt the machine horizontally more than ± 20 degrees. Doing so may cause the entrance of foreign objects in the housing of the machine which could result in fire or electric shock.

The projector can be installed at any vertical angle. However, the projector cannot be tilted to the left or right. Do not use the projector horizontally inclined (± 20 degrees or greater).

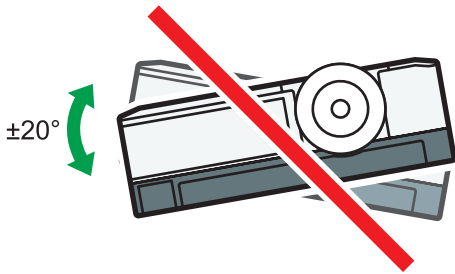

DHY039

Handling the Machine's Interior

This section explains safety precautions about handling the machine's interior.

⚠ WARNING

- Do not remove any covers or screws that are not mentioned in this manual. There are high voltage components inside the machine that may cause electric shock. Contact your service representative if any of the machine's internal components require maintenance, adjustment, or repair.
- Do not disassemble or modify the machine. Doing so may cause injury or malfunction.

⚠ CAUTION

- If the machine's interior is not cleaned regularly, dust will accumulate. Fire and breakdown can result from heavy accumulation of dust inside this machine. Contact your sales or service representative for details about and charges for cleaning the machine's interior.

Installing and Fixing the Projector a Wall or Ceiling

⚠ WARNING

- For safe operation, follow the warnings below when installing and fixing the projector a wall or ceiling.
 - Do not attempt to clean or replace parts for a machine. Doing so may cause it to fall down, resulting in an injury.
 - Do not open the lamp cover of a machine. Doing so may cause the lamp cover to fall down. If the lamp is broken, pieces of glass may fall and cause an injury.
 - Contact your sales or service representative to clean or replace parts for a machine.
- If a machine is installed and fixed on a wall or ceiling incorrectly, it may fall down and cause an injury. Contact your sales or service representative to install and fix a machine on a wall or ceiling.

For users

- Do not install the projector by yourself. Contact your sales or service representative to install the projector to a wall or ceiling. When installing the projector lens-up, be sure to secure the projector to the wall or ceiling using brackets.

For sales or service representatives

- Use brackets that are strong enough to support the projector. The projector weighs about 3.1 kg (6.9 lb.).
- The projector must be installed in a location that is sturdy enough to support the full weight of the projector and brackets.
- Use only the screws (three M4×16 screws) provided with the projector to attach the brackets to the projector.
- Use all three of the projector's screw holes to attach the brackets. The locations of the screw holes are shown in the illustration below. Make sure that the screws are tightened firmly.

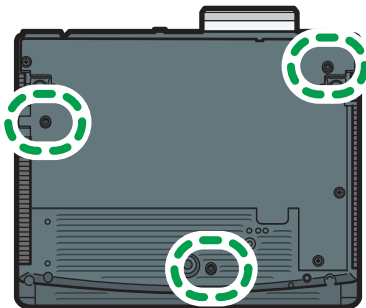

DHY001

About the Batteries

Explains things that you should follow in regard to the batteries.

WARNING

- For safe operation, follow the warnings below regarding the batteries. If you use the batteries incorrectly, it may result in fire or injury due to batteries leaking or exploding.
 - Do not use batteries other than the ones specified.
 - Do not mix and use batteries that are different types or that are new and old.
 - Correctly insert batteries according to the polarity (+/-).
 - Do not charge non-rechargeable batteries.
 - Do not heat or throw the batteries into fire or water.
 - Do not connect the positive and negative terminals on a battery with a wire.
 - Remove the batteries that are past their suggested use period or that are depleted.
 - Remove the batteries when they will not be used for extended periods.
 - Keep the batteries out of the reach of children. Children may swallow or choke on the batteries. If this happens, contact a doctor immediately.

What to do if a battery has leaked

- If leakage from a battery adheres to your skin, rinse it with water immediately, and then contact a doctor.
- Wipe off the leakage with tissue paper while being careful not to touch it.
- Soak the tissue paper that you used in water, and then throw it away as burnable trash.

About the Lamp

Explains things that you should follow in regard to the lamp.

WARNING

- Do not look into the lens or vent when the machine is on. The bright light may damage your eyes. Be especially careful in an environment with children.
- Before replacing the lamp, turn off the power and wait at least one hour to allow the machine to cool completely. If it is not completely cool, you may burn or injure yourself due to the inside of the machine and lamp unit being hot. If you replace the lamp without unplugging the power cord from the power outlet, electric shock or explosion may occur.
- Be careful when handling the used lamp so that it does not break. If it breaks, it may cause injury.

CAUTION

- The machine's light uses a mercury vapor lamp that becomes high pressure when it is turned on. The lamp has the following characteristics, so be sure to handle it with care after understanding the contents. If the lamp explodes and you are either injured from broken pieces of glass, think you have gotten glass particles or mercury vapour in your eyes, or have inhaled glass particles or mercury vapour, contact a doctor immediately.
 - Deterioration or shock can cause the lamp's life span to end or the lamp to explode. If the lamp explodes, it may make a big noise.
 - The time that it takes for the lamp to reach its life span or explode depends on each individual lamp and its operating conditions. It is possible that it might explode the first time it is used.
 - If you use the lamp past its replacement period, the possibility of explosion increases.
 - If the lamp explodes, broken glass pieces may be scattered around the inside of the machine and ejected from the vent or other opening.
 - If the lamp explodes, a very small amount of mercury vapor in the lamp tube and broken glass pieces may be ejected from the vents or other opening.
- Do not block the projection light when it is on. If you do so, the part that is blocking the projection light may get quite hot and deform, deteriorate or cause a burn or fire. The reflected light may make the lens hot and cause a machine failure. To temporarily suspend projection, select the AV mute function. To suspend longer, turn off the machine.
- Be sure to always use a dedicated replacement lamp that is new when replacing the lamp. If you use a lamp that is not dedicated, it may result in an explosion and injury.

What to do if a lamp has exploded

- If the lamp explodes, remove the power cord from the projector, leave the room while making sure it is thoroughly ventilated.
- If the lamp explodes and you think that you have gotten glass particles or mercury vapor in your eyes or have inhaled either, contact a doctor immediately.
- Clean up the area around the projector completely while being careful not to get injured from any broken glass pieces.
- Throw away any food that was near the projector.
- Ask your service representative to replace the lamp and inspect the projector.

Handling a Wireless LAN

This section explains safety precautions about handling a wireless LAN for users of RICOH PJ X3351N/WX3351N/WX4241N.

WARNING

- Before using a wireless LAN, make sure there is nobody with a pacemaker nearby. This machine may cause pacemakers to malfunction due to electromagnetic interference.
- Before using a wireless LAN, make sure there is no medical equipment nearby. This machine may cause medical equipment to malfunction due to electromagnetic interference.
- Before using a wireless LAN, make sure there are no limitations or restrictions in the place you will be using it. There may be restricted use in places such as medical facilities due to electromagnetic interference.
- Do not use a wireless LAN if there is electromagnetic interference from other equipment. Doing so may cause an accident due to the other equipment malfunctioning from the electromagnetic interference.

Moving

This section explains safety precautions about moving the machine.

CAUTION

- Unplug the power cord from the wall outlet before you move the machine. While moving the machine, take care that the power cord is not damaged under the machine. Failing to take these precautions could result in fire or electric shock.

Safety Labels of This Machine

Positions of WARNING and CAUTION Labels

This machine has labels for ⚠WARNING and ⚠CAUTION at the positions shown below. For safety, please follow the instructions and handle the machine as indicated.

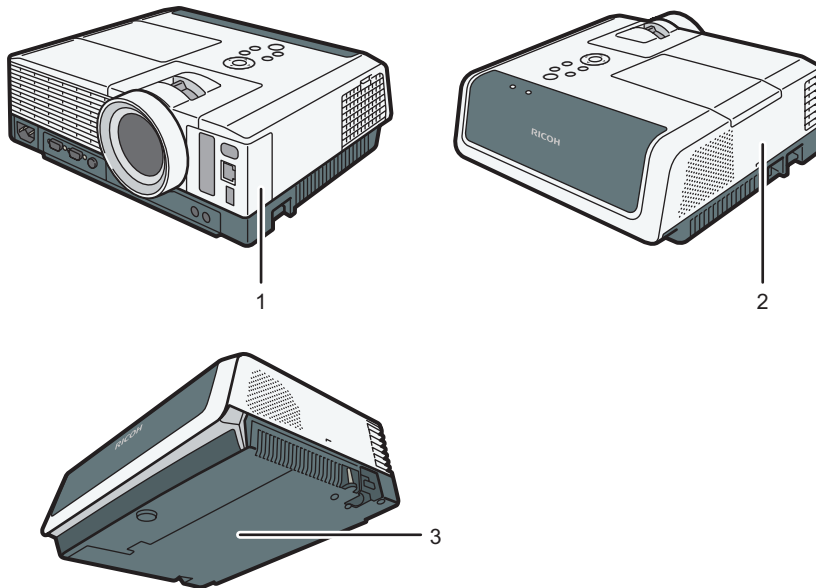

DHY002

1

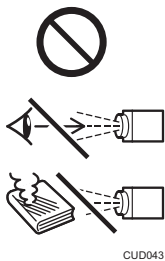

CUD043

Do not look into the lens when the product is on. The bright light may damage your eyes.

Do not place anything in front of the lens. The object may become very hot and cause a fire or burn. To blank the image temporarily, turn on the mute function.

2

⚠ CAUTION ATTENTION PRECAUCIÓN CUIDADO

- To replace the lamp, first unplug the power cord then wait for more than 1 hour. The lamp might be broken. Be careful of pieces of broken glass.
- Pour rempl. lampe, débrancher cordon d'alimentation, puis attendre + d'1 h. Lampe peut-être cassée. Attent° aux morceaux de verre brisé.
- Para cambiar la lámpara, desenchufe el cable y espere más de 1 hora. La lámpara puede romperse. Cuidado con los cristales rotos.
- P/ subst. a lâmpada, desligue o cabo de alimentação e aguarde + de 1 hora. A lâmpada pode estar partida. Tome cuidado com vidros partidos.



CUD080

To replace the lamp, first unplug the power cord then wait for more than 1 hour. The lamp might be broken. Be careful of pieces of broken glass.

3

⚠ ⚡ WARNING VORSICHT AVERTISSEMENT AVVERTIMENTO ADVERTENCIA AVISO 警告

- Do not remove any screws except the lamp cover screws.
- Entfernen Sie keine Schrauben außer den Schrauben der Lampenabdeckung.
- Ne retirer aucune vis à l'exception des vis du cache de la lampe.
- Non rimuovere viti eccetto quelle sul coperchio lampada.
- No retire ningún tornillo excepto los tornillos de la cubierta de la lámpara.
- Não remova quaisquer parafusos, excepto os parafusos da tampa da lâmpada.
- ランプカバー以外のネジを取り外さないでください。

>ABS<

DHY038

Do not remove any screws except the lamp cover screws. Doing so could result in fire or electric shock.

Inner lamp cover

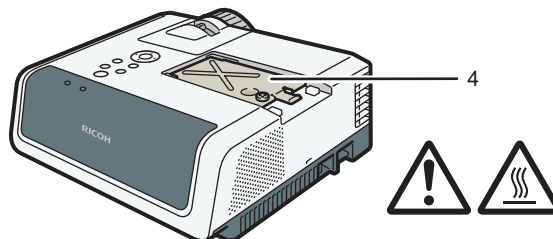

DHY003

4

High temperature parts. Wait a while to allow the inner lamp cover to cool down before replacing the lamp.

Lamp unit

1

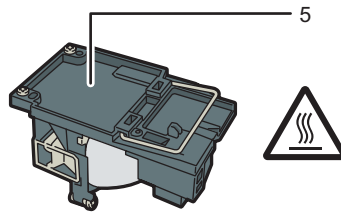

DHY004

5

Do not touch the parts a label indicates. The lamp unit could be very hot.

Power Switch Symbols

The meanings of the symbols for the switches on this machine are as follows:

-  : STANDBY

2. Information for This Machine

This chapter describes laws and regulations related to this machine.

Laws and Regulations

2

Notes to USA Users of FCC Requirements

For users of RICOH PJ X4241N

Declaration of Conformity

This device complies with Part 15 of the FCC Rules.

Operation is subject to the following two conditions:

- (1) This device may not cause harmful interference, and
- (2) this device must accept any interference received, including interference that may cause undesired operation.

Responsible party: Ricoh Americas Corporation

Address: 5 Dedrick Place, West Caldwell, NJ 07006

Telephone number: 973-882-2000

Product Name: Data Projector

Model Number:

- RICOH PJ X4241N

For users of RICOH PJ X3351N/WX3351N/WX4241N

Declaration of Conformity

This device complies with Part 15 of the FCC Rules.

Operation is subject to the following two conditions:

- (1) This device may not cause harmful interference, and
- (2) this device must accept any interference received, including interference that may cause undesired operation.

Responsible party: Ricoh Americas Corporation

Address: 5 Dedrick Place, West Caldwell, NJ 07006

Telephone number: 973-882-2000

Product Name: Data Projector

Model Number:

- RICOH PJ X3351N
- RICOH PJ WX3351N
- RICOH PJ WX4241N

WLAN Module Name: LBWB1ZZWU6

Note:

This equipment has been tested and found to comply with the limits for a Class B digital device, pursuant to Part 15 of the FCC Rules. These limits are designed to provide reasonable protection against harmful interference in a residential installation. This equipment generates, uses and can radiate radio frequency energy and, if not installed and used in accordance with the instructions, may cause harmful interference to radio communications. However, there is no guarantee that interference will not occur in a particular installation. If this equipment does cause harmful interference to radio or television reception, which can be determined by turning the equipment off and on, the user is encouraged to try to correct the interference by one or more of the following measures:

- Reorient or relocate the receiving antenna.
- Increase the separation between the equipment and receiver.
- Connect the equipment into an outlet on a circuit different from that to which the receiver is connected.
- Consult the dealer or an experienced radio /TV technician for help.

Note to users:

This equipment may only be operated indoors. Operation outdoors is in violation of 47 U.S.C. 301 and could subject the operator to serious legal penalties.

Caution:

Changes or modifications not expressly approved by the party responsible for compliance could void the user's authority to operate the equipment.

This equipment complies with FCC radiation exposure limits set forth for an uncontrolled environment and meets the FCC radio frequency (RF) Exposure Guidelines. This equipment has very low levels of RF energy that it deemed to comply without maximum permissive exposure evaluation (MPE). But it is desirable that it should be installed and operated keeping the radiator at least 20cm or more away from person's body (excluding extremities: hands, wrists, feet and ankles).

5.15-5.35GHz band is restricted to indoor operations only.

Compliance with FCC requirement 15.407(c) Data transmission is always initiated by software, which is the passed down through the MAC, through the digital and analog baseband, and finally to the RF chip. Several special packets are initiated by the MAC. These are the only ways the digital baseband portion will turn on the RF transmitter, which it then turns off at the end of the packet. Therefore, the transmitter will be on only while one of the aforementioned packets is being transmitted. In other words, this device

automatically discontinue transmission in case of either absence of information to transmit or operational failure.

Frequency Tolerance: ± 200 ppm

This transmitter must not be co-located or operated in conjunction with any other antenna or transmitter.

This device must not be co-located or operated in conjunction with any other antenna or transmitter except for Wireless LAN module LBWB1ZZWU6 (FCC ID: BBP-WLALT01) which performed co-location testing.

Notes to Canadian Users of IC Rules

Notes to users in Canada

This device complies with Industry Canada licence-exempt RSS standard(s).

Operation is subject to the following two conditions:

- (1) this device may not cause interference, and
- (2) this device must accept any interference, including interference that may cause undesired operation of the device.

Product Name: Data Projector

Model Number:

- RICOH PJ X3351N
- RICOH PJ WX3351N
- RICOH PJ WX4241N

WLAN Module Name: LBWB1ZZWU6

Remarques à l'attention des utilisateurs canadiens

Le présent appareil est conforme aux CNR d'Industrie Canada applicables aux appareils radio exempts de licence.

L'exploitation est autorisée aux deux conditions suivantes :

- (1) l'appareil ne doit pas produire de brouillage, et
- (2) l'utilisateur de l'appareil doit accepter tout brouillage radioélectrique subi, même si le brouillage est susceptible d'en compromettre le fonctionnement.

Nom de produit : Projecteur de données

Numéro de modèle :

- RICOH PJ X3351N
- RICOH PJ WX3351N
- RICOH PJ WX4241N

Nom de module WLAN : LBWB1ZZWU6

This equipment complies with IC radiation exposure limits set forth for an uncontrolled environment and meets RSS-102 of the IC radio frequency (RF) Exposure rules. This equipment has very low levels of RF energy that it is deemed to comply without maximum permissive exposure evaluation (MPE). But it is desirable that it should be installed and operated keeping the radiator at least 20cm or more away from person's body (excluding extremities: hands, wrists, feet and ankles).

Cet équipement est conforme aux limites d'exposition aux rayonnements énoncées pour un environnement non contrôlé et respecte les règles d'exposition aux fréquences radioélectriques (RF) CNR-102 de l'IC. Cet équipement émet une énergie RF très faible qui est considérée conforme sans évaluation de l'exposition maximale autorisée. Cependant, cet équipement doit être installé et utilisé en gardant une distance de 20 cm ou plus entre le dispositif rayonnant et le corps (à l'exception des extrémités : mains, poignets, pieds et chevilles).

5.15-5.35GHz band is restricted to indoor operations only.

La bande 5.15-5.35 GHz est restreinte à une utilisation à l'intérieur.

Under Industry Canada regulations, this radio transmitter may only operate using an antenna of a type and maximum (or lesser) gain approved for the transmitter by Industry Canada. To reduce potential radio interference to other users, the antenna type and its gain should be so chosen that the equivalent isotropically radiated power (e.i.r.p.) is not more than that necessary for successful communication.

Conformément à la réglementation d'Industrie Canada, le présent émetteur radio peut fonctionner avec une antenne d'un type et d'un gain maximal (ou inférieur) approuvé pour l'émetteur par Industrie Canada. Dans le but de réduire les risques de brouillage radioélectrique à l'intention des autres utilisateurs, il faut choisir le type d'antenne et son gain de sorte que la puissance isotrope rayonnée équivalente (p.i.r.e.) ne dépasse pas l'intensité nécessaire à l'établissement d'une communication satisfaisante.

This radio transmitter (identify the device by certification number, or model number if Category II) has been approved by Industry Canada to operate with the antenna types listed below with the maximum permissible gain and required antenna impedance for each antenna type indicated. Antenna types not included in this list, having a gain greater than the maximum gain indicated for that type, are strictly prohibited for use with this device.

Original application

Antenna type: Chip dielectric antenna

Gain: 2.4GHz: -0.5 dBi, W52/53: -0.3dBi, W56: -1.2dBi, W58: -1.7dBi

Class II Permissive Change

Antenna type: Printed PCB Antenna

Gain: 2.4GHz: -1.1 dBi, W52/53: 2.3dBi, W56: 4.5dBi, W58: 2.7dBi

Le présent émetteur radio (identifier le dispositif par son numéro de certification ou son numéro de modèle s'il fait partie du matériel de catégorie I) a été approuvé par Industrie Canada pour fonctionner avec les types d'antenne énumérés ci-dessous et ayant un gain admissible maximal et l'impédance requise pour chaque type d'antenne. Les types d'antenne non inclus dans cette liste, ou dont le gain est supérieur au gain maximal indiqué, sont strictement interdits pour l'exploitation de l'émetteur.

Original application

Antenna type: Chip dielectric antenna

Gain: 2.4GHz: -0.5dBi, W52/53: -0.3dBi, W56: -1.2dBi, W58: -1.7dBi

Class II Permissive Change

Antenna type: Printed PCB Antenna

Gain: 2.4GHz: -1.1 dBi, W52/53: 2.3dBi, W56: 4.5dBi, W58: 2.7dBi

High-power radars are allocated as primary users (i.e. priority users) of the bands 5250-5350 MHz and 5650-5850 MHz and that these radars could cause interference and/or damage to LE-LAN devices.

Les utilisateurs devraient aussi être avisés que les radars de haute puissance sont désignés comme utilisateurs principaux (ils ont la priorité) pour les bandes 5250-5350 MHz et 5650-5850 MHz, et que ces radars peuvent provoquer du brouillage et/ou des dommages aux dispositifs LAN-EL.

Notes on lamp(s) inside this machine

LAMP(S) INSIDE THIS PRODUCT CONTAIN MERCURY AND MUST BE RECYCLED OR DISPOSED OF ACCORDING TO LOCAL, STATE OR FEDERAL LAWS.

Notes to users in the state of California

Perchlorate Material - special handling may apply. See: www.dtsc.ca.gov/hazardouswaste/perchlorate

Notes to Canadian Users of ICES -003 Conformance

CAN ICES-3(B)/NMB-3(B)

MEMO

MEMO

MEMO

