

Notes for Users

The following section explains how to clean the air filter on the side of the projector, and the bottom air intake.

The air filter prevents dust and dirt from entering the interior of the projector. If you will use the projector in a dusty location, install the air filter.

If the message "Check the air filter for dirt." is displayed, check the air filter for dirt or dust, and use the following procedure to clean off any dirt or dust.

★ Important

- The temperature error (the "Temp" indicator flashing in red or the power indicator flashing rapidly in blue) may occur if the air filter and the bottom air intake vent get clogged and the interior of the projector overheats due to inadequate circulation of air. Clean the air filter and the bottom air intake vent also when "Temperature Error" is displayed.
- If an air filter is damaged, replace it with a new one. Using a damaged air filter may cause the projector to stop operating or malfunction. For details, contact your sales representative or service representative.

Cleaning the Air Filter

1. Disconnect the power plug.
2. While pressing the lever on the right side of the air filter, pull the filter open.
3. Remove the air filter.
4. Use a vacuum cleaner to clean any dirt or dust from the filter.

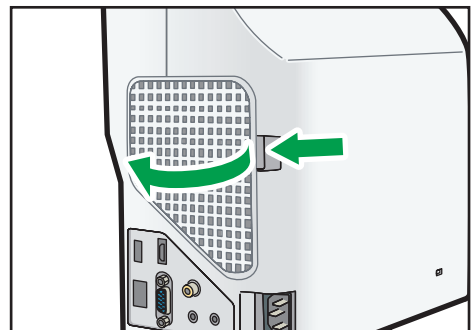

5. Install the air filter in the projector.

Insert the left side of the air filter in first, and then press the lever while pushing in the right side of the filter.

Make sure that the air filter is installed correctly. Otherwise, dirt and dust may enter the projector through any gaps and cause it to stop or malfunction.

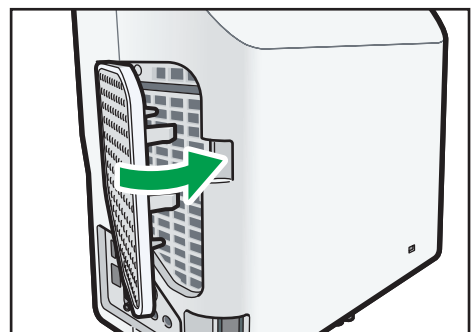

Cleaning the Bottom Air Intake Vent

1. Place the projector on a stable and level surface with the bottom surface clearly visible.
2. Gently slide and pull out the bottom air intake vent cover to remove it, and then use a vacuum cleaner to clean any dirt or dust from the intake vent.

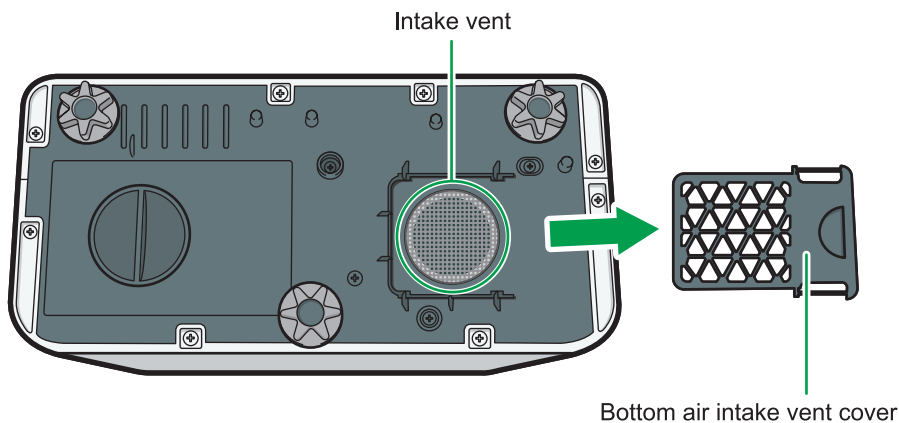

DHY852

3. Install the bottom air intake vent cover by sliding it gently back into place.

Check that the bottom air intake vent cover is correctly installed.

Note

- The message is displayed for approximately 30 seconds every 500 hours after the projector is first turned on. The display closes when operation starts.
- Depending on the environment in which the projector is located, the filter may get clogged earlier than expected. When any dust or dirt has visibly collected on the air filter, clean it regardless of whether the warning message is displayed or not. A buildup of dust on the air filter may cause poor ventilation, causing the interior of the projector overheat and operations to stop or malfunction.
- If vacuuming the air filter does not remove the dust and dirt, wash it with water. After washing the air filter with water, make sure to dry it completely before reinstalling it back in the projector.