

SUBJECT: Paper jams caused when one-way clutch slips

DATE: Mar. 30 '91

PAGE: 1 of 1

PREPARED BY: S.Asai
CHECKED BY:

FROM: Copier Technical Support Section

CLASSIFICATION:

☐ Action Required

☒ Troubleshooting

☐ Retrofit Information

☐ Revision of service manual

☐ Information only

☐ Other

MODEL:

SS 810/830

Ges 5110

[Phenomenon]:

The one-way clutches inside the paper feed and second feed roller gears have worn the roller shafts smooth. The clutch slips and paper jams or is not fed. This tends to occur during high speed printing and is more likely to occur on machines that exceed the recommended monthly copy volume. When the feed mechanism is manually operated to check the paper feed, paper feeds correctly.

[Countermeasure]:

1. Remove the paper feed roller gear [A] and the second feed roller gear [B].
2. With fine sandpaper, lightly sand the roller shaft surface at the point where it comes into contact with the one-way clutch. This increases the coefficient of friction.
3. If paper jams continue to occur, replace the one-way clutch.
4. If paper jams continue to occur, replace the roller shaft together with the one-way clutch.

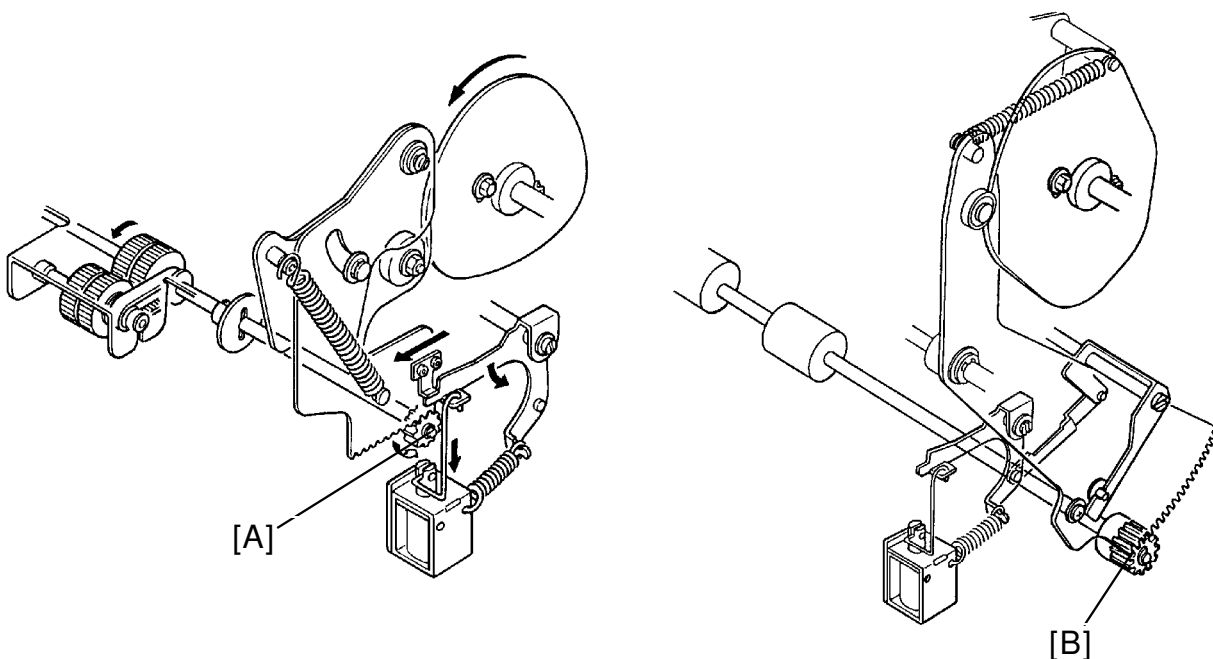

SUBJECT: Paper jams caused when one-way clutch slips

DATE: Mar. 30 '91

PAGE: 1 of 1

PREPARED BY: S.Asai
CHECKED BY:

FROM: Copier Technical Support Section

CLASSIFICATION:

☐ Action Required

☒ Troubleshooting

☐ Retrofit Information

☐ Revision of service manual

☐ Information only

☐ Other

MODEL:

Ges CD510R

Rex 1040

[Phenomenon]:

The one-way clutches inside the paper feed and second feed roller gears have worn the roller shafts smooth. The clutch slips and paper jams or is not fed. This tends to occur during high speed printing and is more likely to occur on machines that exceed the recommended monthly copy volume. When the feed mechanism is manually operated to check the paper feed, paper feeds correctly.

[Countermeasure]:

1. Remove the paper feed roller gear [A] and the second feed roller gear [B].
2. With fine sandpaper, lightly sand the roller shaft surface at the point where it comes into contact with the one-way clutch. This increases the coefficient of friction.
3. If paper jams continue to occur, replace the one-way clutch.
4. If paper jams continue to occur, replace the roller shaft together with the one-way clutch.

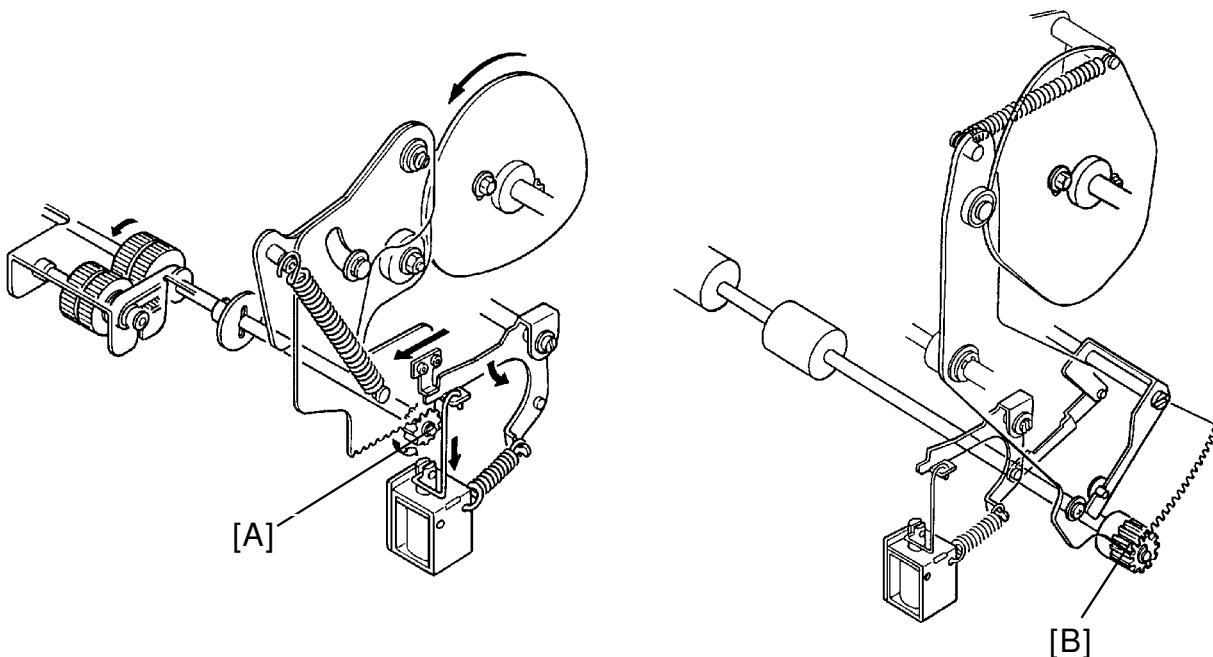

SUBJECT: Priport Ink Lot Number

DATE: Aug. 15, '92
PAGE: 1 of 2

PREPARED BY: J. Mochizuki
CHECKED BY:

FROM: Copier Technical Support Section

CLASSIFICATION:

- ☐ Action Required
- ☐ Troubleshooting
- ☐ Retrofit Information

- ☐ Revision of service manual
- ☒ Information only
- ☐ Other

MODEL:

SS810/830
Ges 5110/5305
Rex 1230
NSA CP305

To clarify the ink production dating, the method of lot numbering has been changed as follows:

Old method

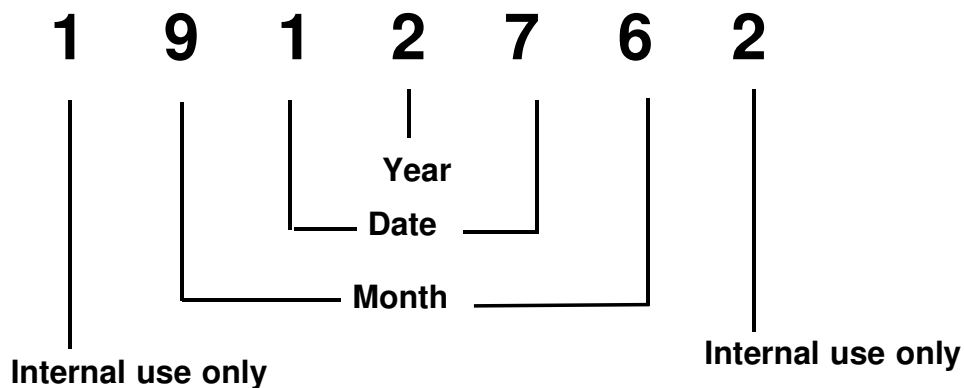

New method

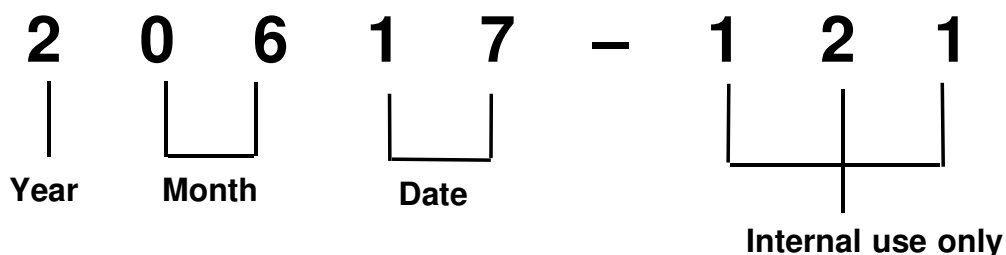

The above lot number means that the ink is produced on **June 17, '92**

SUBJECT: Priport Ink Lot Number

DATE: Aug. 15, '92

PAGE: 2 of 2

The table below shows the new lot numbering start date.

Type of ink	New lot numbering start date
Black 800cc	July 13, '92
Black 500cc	July 13, '92
Color Red 500cc	July 13, '92
Color Blue 500cc	July 16, '92
Color Green 500cc	July 14, '92
Color Brown 500cc	July 16, '92