

<b>Model:</b> PRIPORT RUBY		<b>Date:</b> 12-Oct-04	<b>No:</b> M-C232-002
<b>Modified Article:</b> Paper Guide		<b>Prepared by:</b>	
<b>From:</b> Priport Service Planning Section		A. Yoshida	
<b>Classification:</b> <input type="checkbox"/> Parts catalog correction <input type="checkbox"/> Vendor change <input type="checkbox"/> To meet standards <input type="checkbox"/> To facilitate assembly <input checked="" type="checkbox"/> To improve reliability         (      ) <input type="checkbox"/> Part standardization <input type="checkbox"/> Other (      )			
<b>Model Name:</b> Ricoh JP5800			

The following applies to the optional JS40-Sorter.

Old #	New #	Description	Qty	Int	Page	Index
-	C5922370	Front Guide Assembly	1	X/O as a set	21	*24
-	C5922371	Rear Guide Assembly	1		21	*25
-	04514006B	Tapping Screw – 4x6	2		21	101
-	C5922374	Guide	2	-	21	*26

\*: New index

**NOTE:** The #C5922374 guide is part of the front guide assembly and rear guide assembly.

**Change:** Added front guide assembly [A], rear guide assembly.

**Reason:** To ensure that curled paper is fed smoothly in the relay transport area [B] and horizontal transport area [C].

**Important:** When images with many solid image areas are printed out often, light scratches can appear on the copy. For these customers, attach a piece of double-sided tape [D] to the guide assembly, and then attach the guide assembly to the upper stay [E].

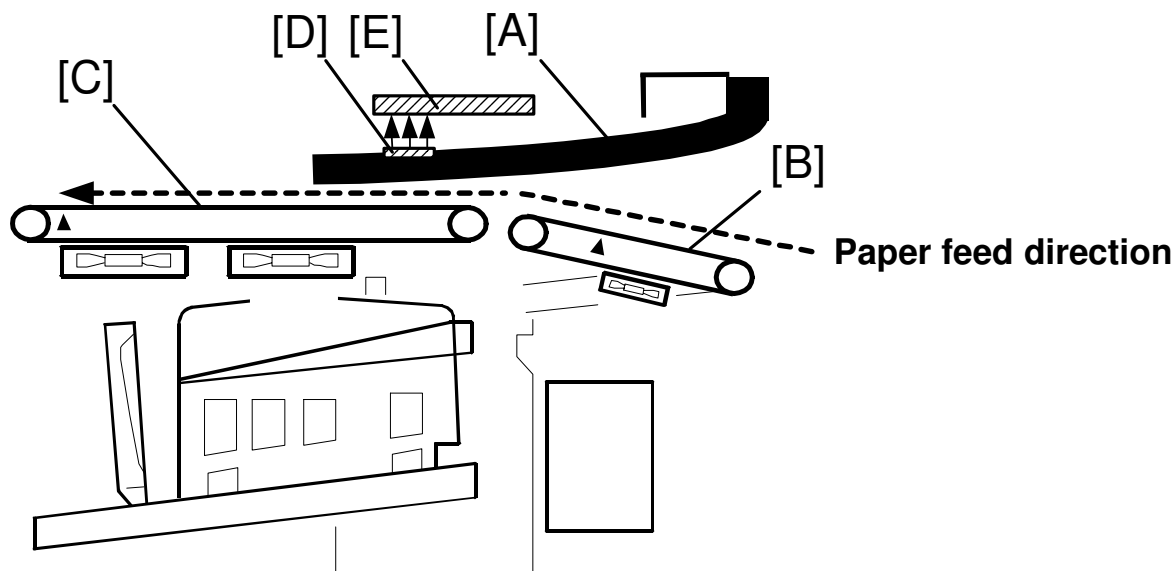

**Model:** PRIPORT RUBY

**Date:** 12-Oct-04

**No:** M-C232-012

Revised Illustration:

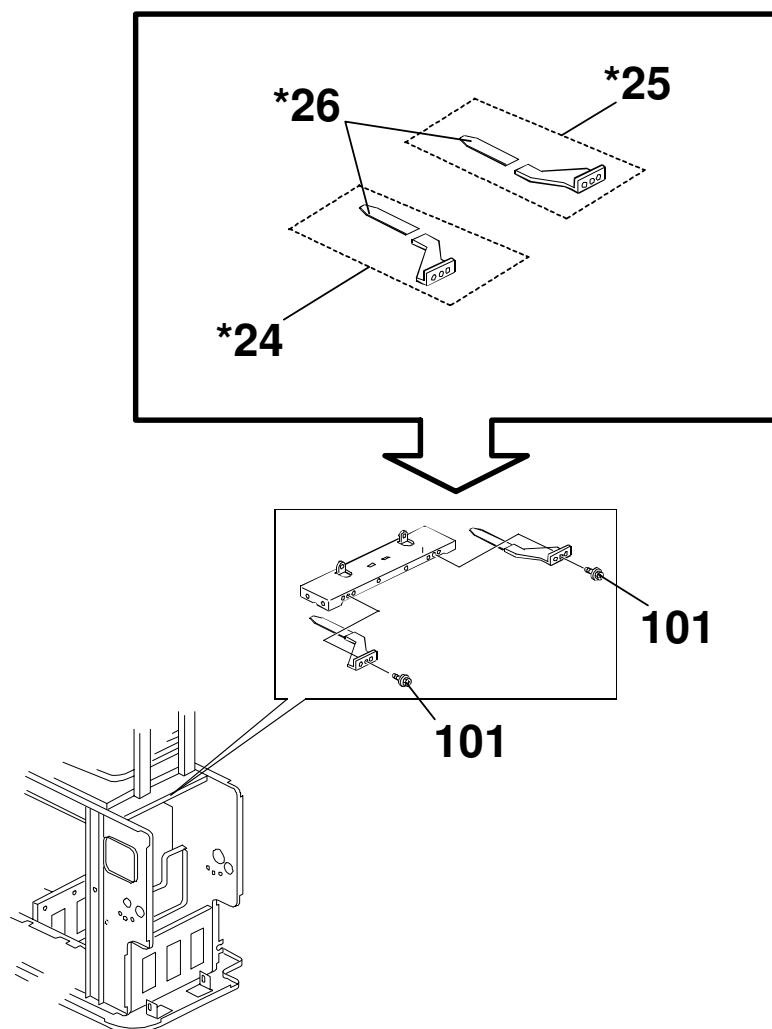

## CUT IN SERIAL NUMBERS

Model Name	V/Hz	Destination	Code	Serial Number
JS40-Sorter	230/50	Europe	C592-53	C3881080001

<b>Model:</b> PRIPORT RUBY		<b>Date:</b> 3-Dec-04	<b>No:</b> M-C232-003
<b>Modified Article:</b> Belt drive motor		<b>Prepared by:</b>	
<b>From:</b> Priport Service Planning Section		M. Kanomata	
<b>Classification:</b>	<input type="checkbox"/> Parts catalog correction <input type="checkbox"/> Vendor change <input type="checkbox"/> To meet standards <input type="checkbox"/> To facilitate assembly <input checked="" type="checkbox"/> To improve reliability    (    ) <input type="checkbox"/> Part standardization <input type="checkbox"/> Other (    )		
<b>Model Name:</b>			
Ricoh JP5600			

This MB applies to the optional **JS40-Sorter**.

Old #	New #	Description	Qty	Int	Page	Index
C5925868	C5925869	BELT DRIVE MOTOR	1	X/O	7	21

**Change:** The internal connection of the harness and motor was changed.

**Reason:** To ensure that the harness stays connected to the motor. This will ensure that a jam at the relay transport unit does not occur.

## Illustrations:

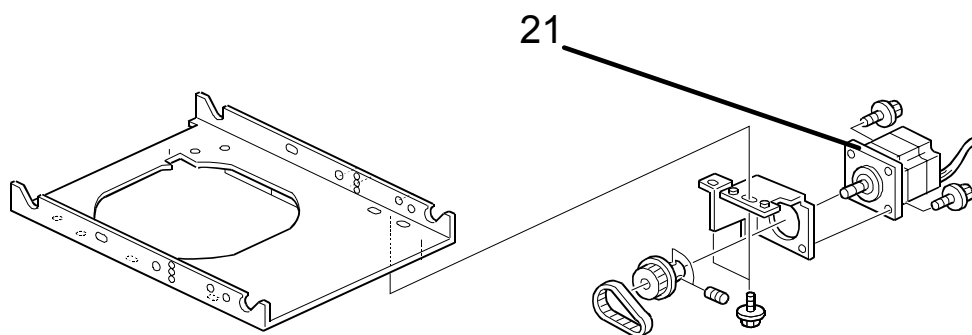

**[A]:** Internal connection point of the harness.

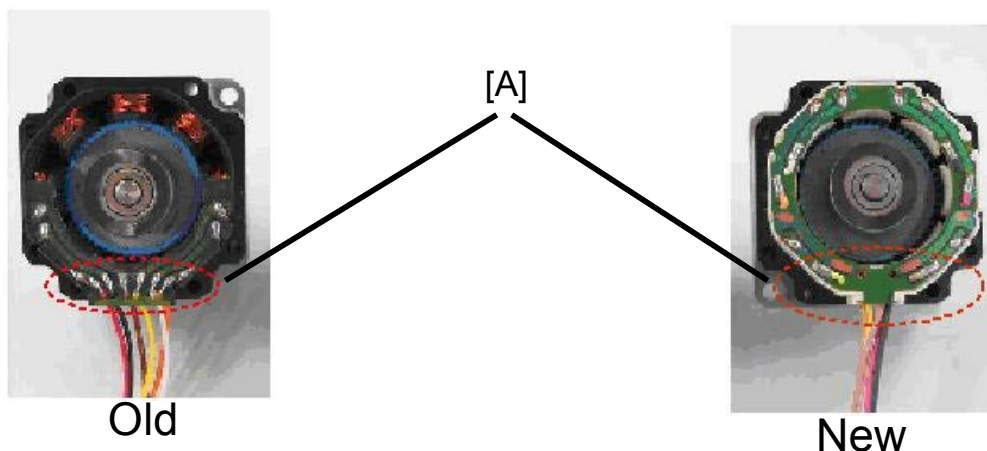

**Model:** PRIPORT RUBY**Date:** 3-Dec-04**No:** M-C232-**003****CUT IN SERIAL NUMBERS**

Model Name	V/Hz	Destination	Code	Serial Number
JS-40 Sorter	230/50	Europe	C592-53	C3384090001