

Model	Priport Interface kit	Code	Model Name	Serial Number
Modified Article		C544 - 00	Interface Unit -10 Type 1	
Reason for Modification	Spare Parts List for the Computer Interface Kit	C544 - 01	Interface Unit -10 Type 2	

Add the following parts list to the Priport parts catalogs. Note that there are two types for the kit: one is Interface Unit - 10



e 2 (C544-01) for the N810 only, and the other is Type 1 (C544-00) for the other Priport models.

1. INTERFACE UNIT - 10 TYPE 1

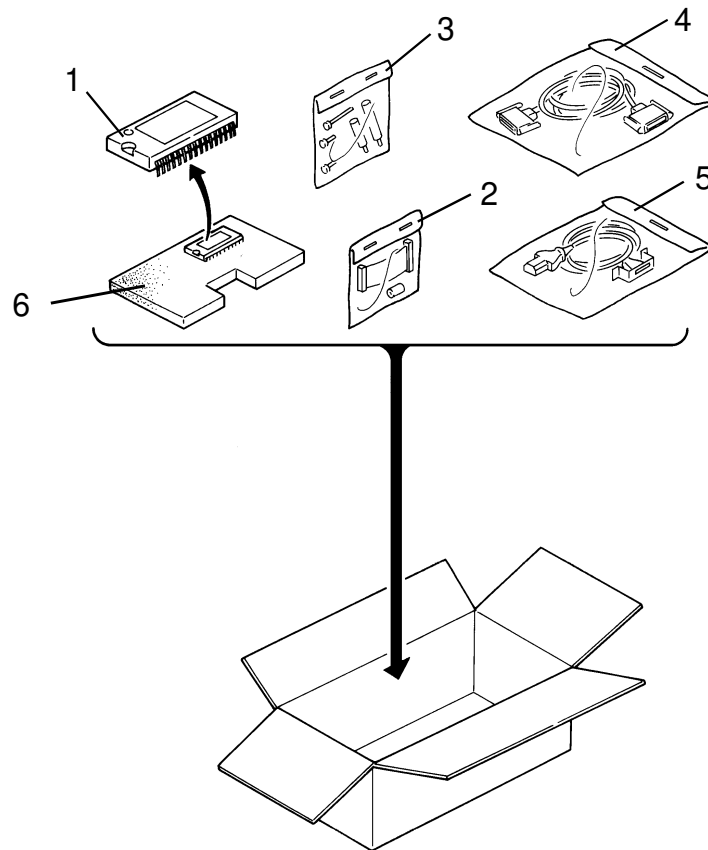

INDEX	PART NO	DESCRIPTION
1	C544 1005	IC - Interface - AM27C512 - 150DC
2	--	Accessories for NA2
3	--	Accessories for N865
4	C544 1510	Controller Cable
5	C544 1500	Interface Cable - Type 1
6	C544 1100	Interface Board

1. 1 Accessories for N865

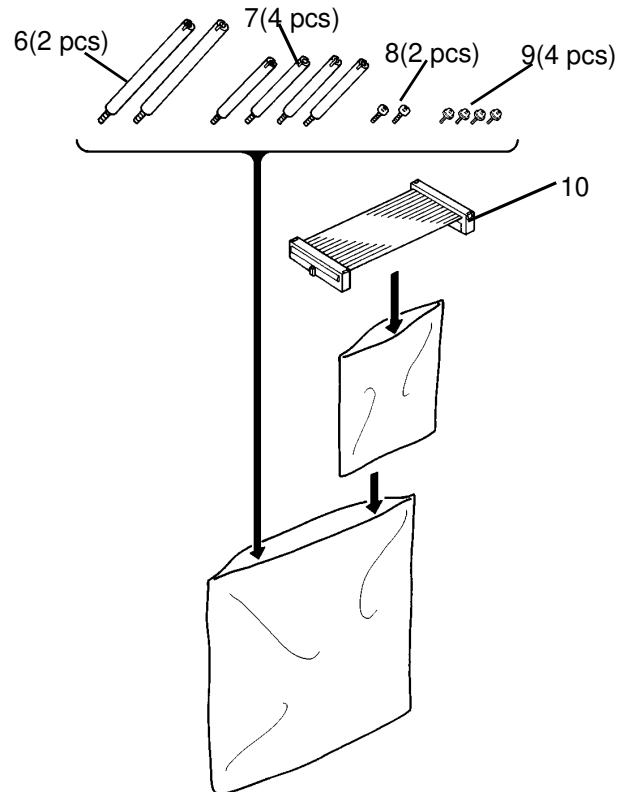

Accessories for N865

INDEX	PART NO	DESCRIPTION
6	R326 5302	Interface Board Stud
7	C200 2596	Main Board Stud - Long
8	0314 0080Z	Philips Screw - M4 x 8
9	0951 3006Z	Philips Screw with Flat Washer - M3 x 6
	C544 1601	Flat Cable - N865

1. 2 Accessories for NA2

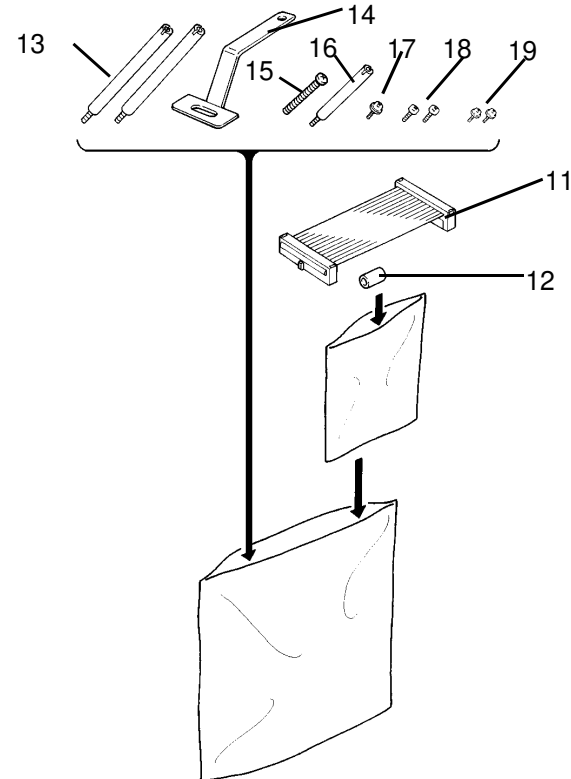

Accessories for NA2

INDEX	PART NO	DESCRIPTION
11	C544 1602	Flat Cable - NA2
12	C203 2031	Main Board Spacer
13	C531 5300	Stud - Bracket - Interface
14	C531 5310	Interface Board Bracket
15	0951 3025Z	Philips Screw with Flat Washer - M3 x 25
16	C209 8500	Stud - Main Board
17	0951 4006Z	Philips Screw with Flat Washer - M4 x 6
18	0314 0080Z	Philips Screw - M4 x 8
19	0951 3006Z	Philips Screw With Flat Washer - M3 x 6



2. INTERFACE UNIT - 10 TYPE 2

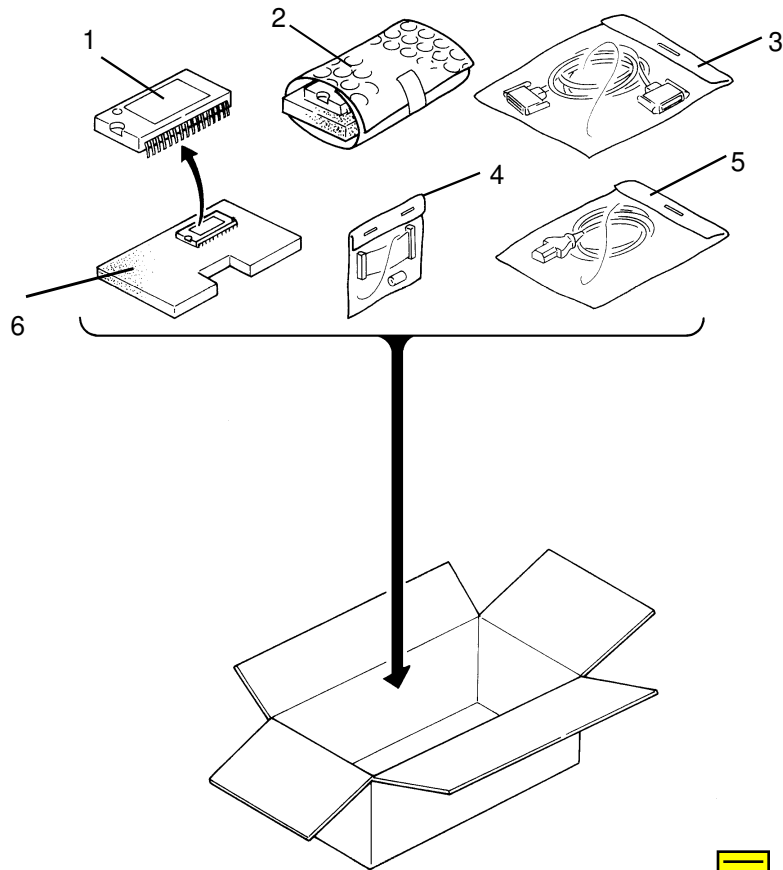

PART NO	INDEX	DESCRIPTION
1	C544 1005	IC - Interface - AM27C512 - 150DC
2	C544 1301	IC - Main - M27C 512-12F1
3	C544 1510	Controller Cable
4	--	Accessories for N810
5	C544 1501	Interface Cable - Type 2
6	C544 1100	Interface Board

2. 1 Accessories for N810

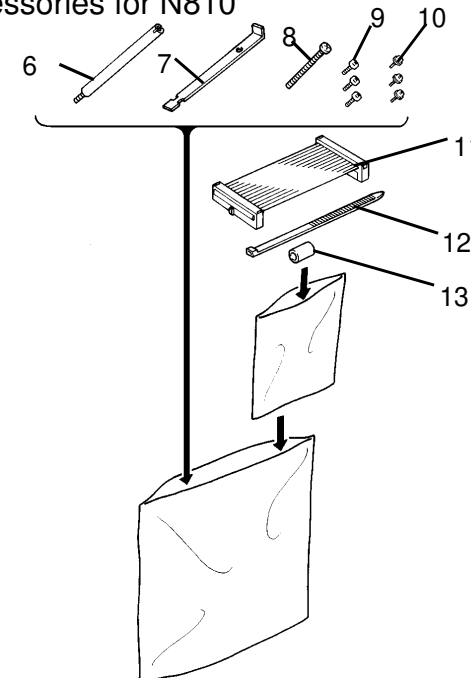

Accessories for N810

PART NO	INDEX	DESCRIPTION
6	C544 2110	PCB Stud
7	C544 2112	Harness Support Bracket
8	0313 0350B	Philips Pan Head Screw - M3 x 35
9	0960 3008W	Philips Flange Screw - M3 x 8
10	0960 4008W	Philips Flange Screw - M4 x 8
11	C544 1600	Flat Cable - N810
12	1105 0042	Wire Band

S. Hamano, Assistant General Manager
Technical Support Department

Model	Priport Interface Kit	Code	Model Name	Serial Number
Modified Article	Sleeve Core and Insulating Sheet	C544-00	Interface Unit - 10 Type 1	
Reason for Modification	Due to missing information from the parts list on MB No.1	C544-01	Interface Unit - 10 Type 2	

The following two parts were missing from the parts list in MB No. 1:

P/N	Description	Q'ty Used	Index	Location in MB No. 1
C5442105	Insulating Sheet - 145 x 200 (Plastic Sheet)	1	* 11	Page 3 of 4, Accessories for N865
16070576	Sleeve Core - SFC-8 (Ferrite Core)	1	* 7	Page 2 of 4, INTERFACE UNIT - 10 TYPE 1
		1	* 7	Page 4 of 4, INTERFACE UNIT - 10 TYPE 2

* New Index

Note:

1. The plastic sheet is used only for the N865/860 (Ricoh VT2105/VT2005, Gestetner 5325/5323, RexRotary 1250/1245, Nashuatec CP325/CP323, A.B. Dick 6520) and the other older models. It is to be installed under the interface board according to the installation procedure (booklet) packed with the kit. This is an EMI (ElectroMagnetic field Interference) standard requirement.
2. The ferrite core is to be fitted on the cable between the Priport and controller (C5441510). Fit the ferrite core on the Priport end of the cable (approximately less than 20 mm from the end).

S. Hamano, Assistant General Manager
Technical Support Department

Model	Priport Interface Kit	Code	Model Name	Serial Number
Modified Article	Flat Cable for NA3 / NB2	C544-00	Interface Unit - 10 Type 1	4060001
Reason for Modification	To enable installation of the kit in the NA3 / NB2 models (For Type 1 only)	C544-01	Interface Unit - 10 Type 2	

To enable installation of the kit in the NA3 / NB2 models (Ricoh VT3600 / VT2600 / VT 2630, Gestetner 5380 / 5360, RexRotary 1285 / 1270, Nashuatec CP380 / CP360, A. B. Dick 6770), the following part has been added to the Interface Unit 10 Type 1 (C544-00):

Part Number	Description	Q'ty	Index No.	Location in MB No. 1
C5441600	Flat Cable - N810	1	* 20	Page 3 of 4, Accessories for NA2

NOTE:

1. This flat cable is commonly used for the N810 (Ricoh VT1730, Gestetner 5303, RexRotary 1220, Nashuatec CP303, A. B. Dick 6120), and is also packed in the Interface Unit 10 Type 2 (C544-01).
2. For installation in the NA3 / NB2 models, use the accessories for the NA2 (Ricoh VT3500, Gestetner 5375, RexRotary 1280, Nashuatec CP375, A. B. Dick 6720) except for the flat cable.

DETAILS OF MODIFICATION

3. Note that the dip switch setting of the interface board (DPS101) is different between the NA3 and NB2. (The NA3's setting is the same as that of the NA2.)

	DPS101 - 1	-2	-3	-4
NA3 (Ricoh VT3600, Gestetner 5380, RexRotary 1285, nashuatec CP380, A. B. Dick 6770)	ON	ON	ON	OFF
NB2 (Ricoh VT2600 / VT2630, Gestetner 5360, RexRotary 1270, nashuatec CP360)	OFF	ON	ON	OFF

The installation procedure (booklet) packed in the kit has been updated at the same time, and this information (also how to install the kit in the NA3 / NB2 models) has been added.

S. Hamano, Assistant General Manager
Technical Support Department

Model	Priport Interface Kit	Code	Model Name	Serial Number
Modified Article	ROM for N810 Main Board	C544-00	Interface Unit - 10 Type 1	
Reason for Modification	To make the installation of the Interface Unit 10 Type 2 easier (For Type 2 only)	C544-01	Interface Unit - 10 Type 2	4080001

To enable the installation of the Interface Unit 10 Type 2 (C544-01) in the N810 (Ricoh VT1730, Gestetner 5303, RexRotary 1220, Nashuatec CP303, and A. B. Dick 6120) without replacing the ROM on the N810's main board, the ROM has been changed from C2178005 to C2178015. When you install the Interface Unit 10 Type 2 in the N810 which has the new ROM, you do not have to replace the ROM on the N810's main board with the ROM packed in the Interface Unit 10 Type 2. (For the cut-in serial number, refer to N810 MB-022.)

Also for the Interface Unit Type 2, the ROM has been changed due to part standardization as follows:

Old P/N	New P/N	Description	Index No.	Location in MB No. 1
C5441301	C2178015	IC - Main - M27C512-12F1	2	Page 4 of 4, INTERFACE UNIT - 10 TYPE 2

This ROM is used only when the kit is installed in an N810 which has the old type ROM.

S. Hamano, Assistant General Manager
Technical Support Department

Model	Priport Interface Kit	Code	Model Name	Serial Number
Modified Article		C544 - 00	Interface Unit - 10 Type 1	5070001
Reason for Modification	Spare Parts List for the New Computer Interface Kit (To unify Type 1 and Type 2)			

To allow the Interface Unit - 10 Type 1 (C544-00) to cover all the Priport models, some parts have been changed as described on page 7 and thereafter. As a result, Type 2 (C544-01) has been discontinued and the new Type 1 will be used also for the N810.

The new Type 1 kit includes 4 sets of the accessories (each of them is packed in a small plastic bag) and the sets are named "for PART 1A", "for PART 1B", "for PART 1C", or "for PART 1D". Each set corresponds to the appropriate Priport models as follows:

Name of the set	Applicable Priport Models (Code Name)	Note
for PART 1A	N810, N810-II	This set was in the Type 2 kit. The ROM for the main body's main board has been removed and some parts have been newly added. See page 5 for details.
for PART 1B	NA33, NA3, NA2, NB2	
for PART 1C	N850, N865, and the other older Priport models	
for PART 1D	RN925	This set has been newly added. See page 6.

- NOTE: - A decal that indicates the name of the set is attached on each plastic bag for identification.
- For the model names for each code name, refer to the following " Model Name and Code Name Cross Reference Table" (see page 3).
 - The installation procedure (booklet) packed in the kit has been updated at the same time.
 - The sets for PART 1A, for PART 1B, and for PART 1C include a flat cable, which connects the interface board to the main body's main board. Note that those flat cables are used for different Priport models in some cases. Each flat cable corresponds as follows:

Part Number	Location	Applicable Priport Models (Code Name)
C5441600	PART 1A	N810, N810-II, N850, RN925, NB2, NA3, NA33
C5441602	PART 1B	NA2
C5441601	PART 1C	N865 and the other older Priport models

Model Name and Code Name Cross Reference Table

Code Name	Code #	Model Name
N810	C217	Ricoh VT1730, NRG 5303 / 1220 / CP303, AB DICK 6120
N810 - II	C225	Ricoh VT1800, NRG 5304 / 1222 / CP304, AB DICK 6130
N865	C216	Ricoh VT2105, NRG 5325 / 1250 / CP325, AB DICK 6520
N850	C224	Ricoh VT2200, NRG 5327 / 1252 / CP327, AB DICK 6530
RN925	C222	Ricoh VT2400, NRG 5340 / 1255 / CP340, AB DICK 6550
NB2	C219	Ricoh VT2600 / VT2630, NRG 5360 / 1270 / CP360
NA2	C210	Ricoh VT3500, NRG 5375 / 1280 / CP375, AB DICK 6720
NA3	C218	Ricoh VT3600, NRG 5380 / 1285 / CP380, AB DICK 6770
NA33	C223	Ricoh VT3800, NRG 5385 / 1290 / CP385, AB DICK 6790

PART LIST for NEW INTERFACE UNIT - 10 TYPE 1

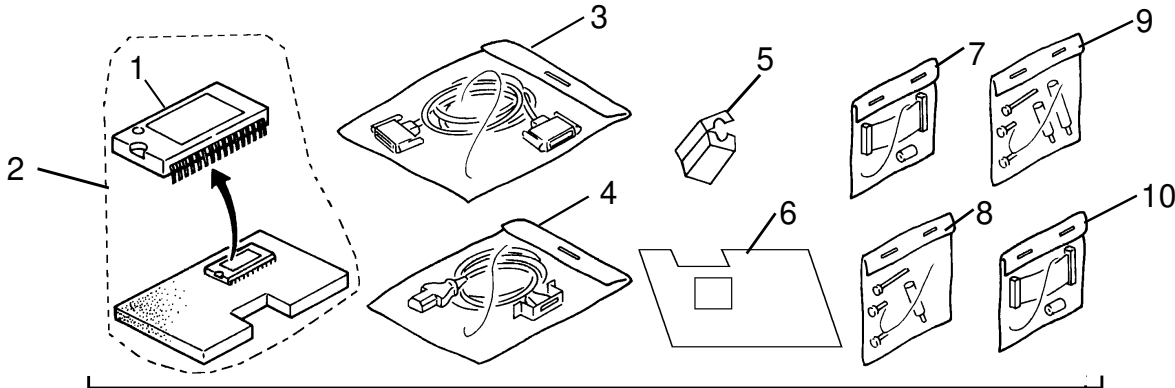

INDEX	PART NO	DESCRIPTION
1	C544 1015	IC - Interface - AM27C512 - 150DC
2	C544 1010	Interface Board
3	C544 1510	Controller Cable
4	C544 1520	Interface Cable - Interface Board
5	1607 0576	Sleeve Core - SFC-8
6	C544 2105	Insulating Sheet - 145 x 200
7	--	Accessories for PART 1A
8	--	Accessories for PART 1D
9	--	Accessories for PART 1C
10	--	Accessories for PART 1B

1. Accessories for PART 1A

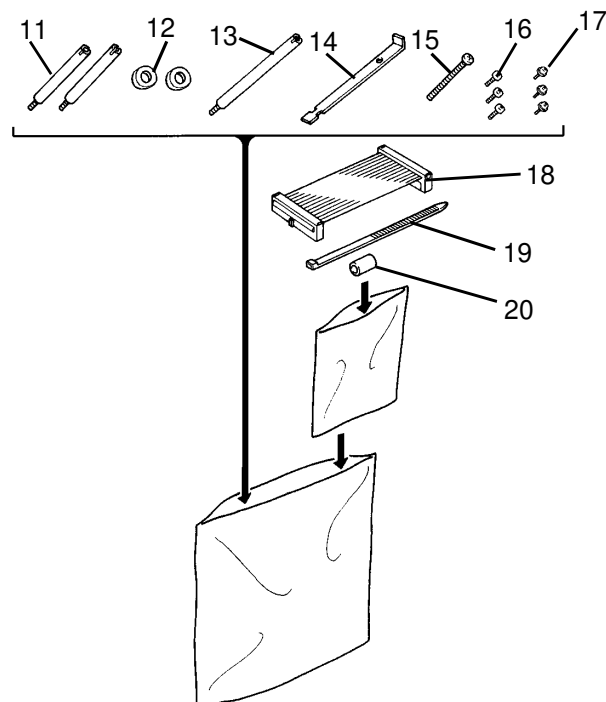

Accessories for PART 1A

PART NO	INDEX	DESCRIPTION
11	C544 2116	Stud - 50 mm
12	0807 3083	Spacer - 10 mm
13	C544 2110	PCB Stud - 64 mm
14	C544 2112	Harness Support Bracket
15	0313 0350B	Philips Pan Head Screw - M3 x 35
16	0960 3008W	Philips Flange Screw - M3 x 8
17	0960 4008W	Philips Flange Screw - M4 x 8
18	C544 1600	Flat Cable - N810 / NA33 / NA3 / NB2 / RN925 / N850
19	1105 0042	Wire Band
20	C544 2111	PCB Collar

2. Accessories for PART 1B

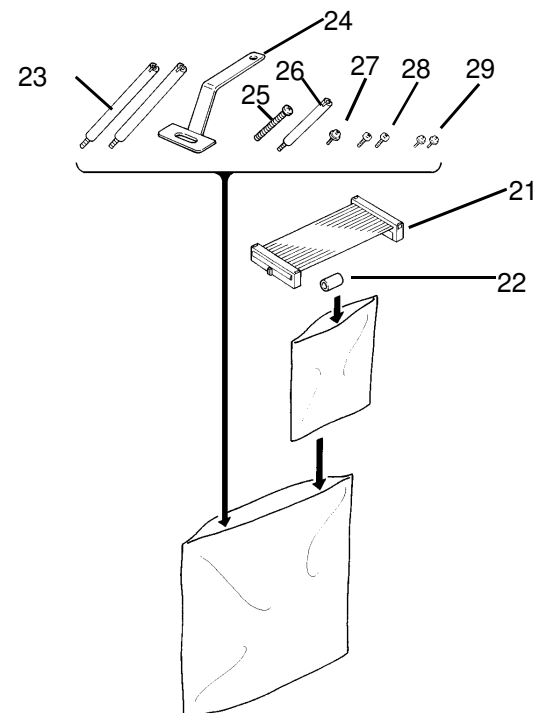

Accessories for PART 1B

INDEX	PART NO	DESCRIPTION
21	C544 1602	Flat Cable - NA2
22	C203 2031	Main Board Spacer
23	C531 5300	Stud - Bracket - Interface
24	C531 5310	Interface Board Bracket
25	0951 3025Z	Philips Screw with Flat Washer - M3 x 25
26	C209 8500	Stud - Main Board
27	0951 4006Z	Philips Screw with Flat Washer - M4 x 6
28	0314 0080Z	Philips Screw - M4 x 8
29	0951 3006Z	Philips Screw With Flat Washer - M3 x 6

3. Accessories for PART 1C

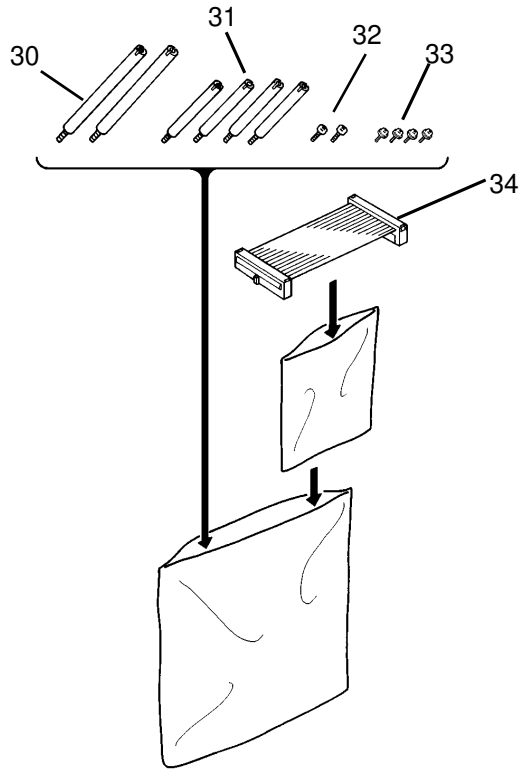

Accessories for PART 1C

INDEX	PART NO	DESCRIPTION
30	R326 5302	Interface Board Stud
31	C200 2596	Main Board Stud - Long
32	0314 0080Z	Philips Screw - M4 x 8
33	0951 3006Z	Philips Screw with Flat Washer - M3 x 6
34	C544 1601	Flat Cable - N865

4. Accessories for PART 1D

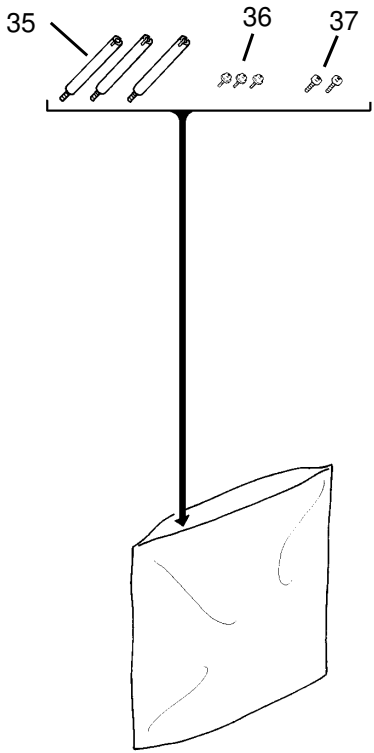

Accessories for PART 1D

INDEX	PART NO	DESCRIPTION
35	C544 2120	Stud - 35 mm
36	0951 3006Z	Philips Screw With Flat Washer - M3 x 6
37	0314 0080Z	Philips Screw - M4 x 8
-	C544 2330	Set For PART 1D (See page 8)

The following shows details of the modifications applied for the new kit:

1. A new decal that indicates the names of the sets for PART 1A, for PART 1B, for PART 1C, and PART 1D is attached on each plastic bag for identification.
2. To enable the installation of the kit for the N810 and N810-II, some parts have been added as "for PART 1A" (see page 5), which were used in the "Type 2" kit. Also, to use the same cable (going to the rear of the machine from the interface board) as that used for the other models, some new parts have been added as shown below. The old cable (P/N - C5441501) is no longer needed. (The old cable can still be used for the N810 and N810-II without these new parts. However, the cable, P/N - C5441500, which is the old type for the other models, cannot be used for the N810 and N810-II even with these new parts. This is because the bracket of the new cable (P/N - C5441520) has a new configuration.)

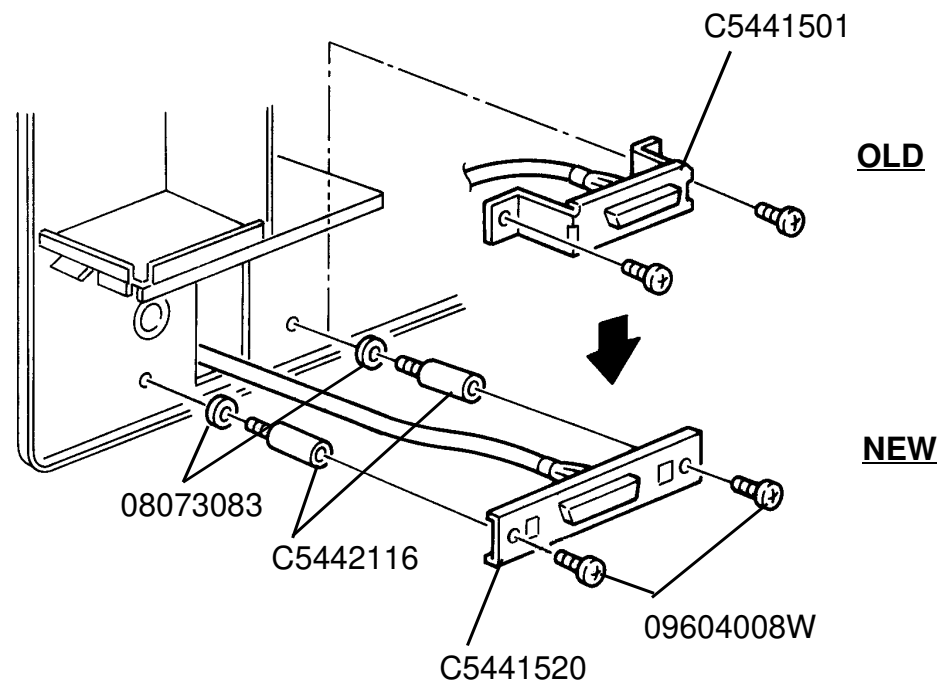

3. To enable the installation of the kit for the RN925, some new parts have been added as "for PART 1D" (see page 6). Also, the cable going to the rear of the machine from the interface board has been lengthened by 100 mm (P/N - C5441500 has been changed to P/N - C5441520) since the old cable was too short for the RN925. (See page 4. The new cable is used for all models.) The new ROM is also required (see the next page).

NOTE:1. If you use the old interface unit - 10 Type 1 for the RN925, you need the following parts:

- 1) All parts for PART 1D (see page 6). You can order these parts as a set with P/N - C5442330 (Set For PART 1D).
 - 2) The new cable (P/N - C5441520).
 - 3) The new ROM on the interface board (P/N - C5441015).
2. If you use the old interface unit - 10 Type 1 for the N850, you need the new ROM (P/N - C5441015) only.
3. If you use the old interface unit - 10 Type 2 for the N810-II, you need the new ROM (P/N - C5441015) only.
4. For the other older models, the old Type 1 can be used (the Type 2 for the N810).

4. Due to the following reasons, the ROM on the interface board has been changed from P/N - C5441005 to P/N - C5441015. At the same time, the part number of the interface board has also been changed from C5441100 to C5441010 for identification purposes.

- (1) The new ROM enables operating the latest Priport models (NA33, RN925, N850, and N810-II) with the controller. The following are the features unique to these Priport models:

- Auto On-line -

When data is sent from the controller, the Priport enters the On-line mode automatically.

- Auto Off-line -

When the Priport stops while operating in the On-line mode due to the end of a job, running out of paper, or a paper or master jam, etc., the On-line mode is automatically canceled.

- (2) The number of prints can be set from the computer. (This is possible only with the Priport N810, N810-II, N850, NB2, RN925, NA3, NA33, and other future models.) Also, if the Priport has a paper size detection system, the size of the paper set in the Priport is compared with the paper size selected on the computer when the data is sent from the computer. If they are different, the controller resets the print number to 2 (as a print number of 1 cannot be used in this case) in order to minimize unusable printouts. (This is possible only with the Priport NB2, RN925, NA3, NA33, and other future models that can detect the paper size.)

- NOTE:
1. These functions can be used since version 2.02 of the old interface board ROM (P/N - C5441005). However, only the new ROM (P/N - C5441015) can be used for the Priport NA33, RN925, N850, and N810-II.
 2. The controller that supports these functions must be used.
(The cut-in serial numbers are : 51504090001 for the NRG version and C32394090001 for Ricoh's.)
 3. For the N810, the ROM on the main board (P/N - C2178015) must be changed to the new version (P/N - C2178016).
 4. To enable these functions, all dip switches on the interface board (DPS101 - 1, -2, -3, and -4) must be set to OFF.

M. Iwasa, Manager
Technical Support Department