

# Replacing the Paper Feed Roller and the Separation Pressure Pad

If paper misfeeds or double-feeds are occurring frequently, first try cleaning the paper feed roller, and then check that you are using the correct feed roller pressure and separation pressure (refer to *Operating Instructions*).

When the problem persists even after you have done the above, replace the paper feed roller and the separation pressure pad. As a rule, the paper feed roller needs to be replaced after approximately 600,000 prints and the separation pressure pad after 300,000 prints.

**1** Detach the paper feed tray.

**2** Move the separation pressure lever to Position 1.

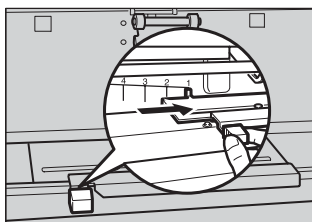

ZJSH500E

**3** Remove the snap ring at the end of the paper feed roller shaft.

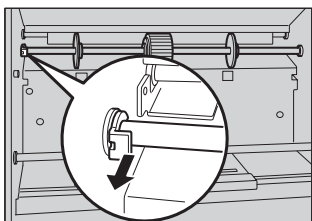

ZJSH490E

- 4** Slide the shaft slightly to the left and lift it out from its right end.

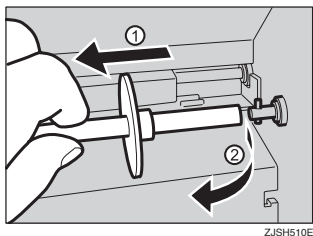

**Note**

- If you are replacing only the separation pressure pad, proceed to Step 9.

- 5** Take the side roller off the shaft. Remove the snap ring on the paper feed roller.

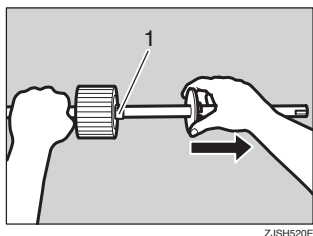

1. Snap ring

- 6** Take the paper feed roller off the shaft.

- 7** Slide a new paper feed roller back onto the shaft.

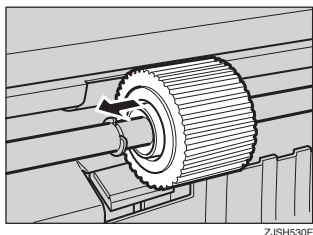

**Note**

- Make sure that the protruding side of the roller core touches the band at the center of the shaft.

**8** Attach the snap ring onto the paper feed roller. Slide the side roller back onto the shaft.

**9** To replace the separation pressure pad, first move the separation pressure lever to Position 2.

The separation pressure pad protrudes slightly.

**10** Lift out the used separation pressure pad. Insert a new pad in its place.

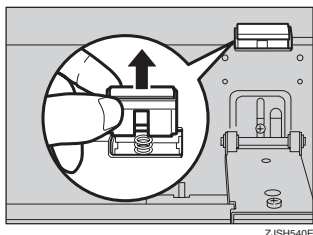

**Note**

□ To determine whether you have set the new pad correctly, press it down and then release it. The pad should spring back smoothly.

**11** Return the separation pressure lever to Position 1.

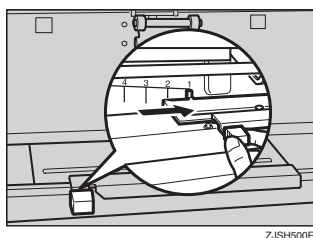

**12** To attach the paper feed roller shaft to the machine, insert it from its left end.

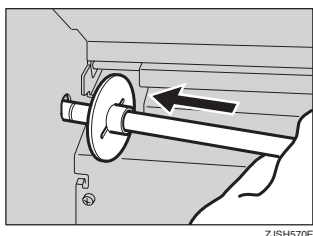

- 13** Slide in the other end of the shaft.

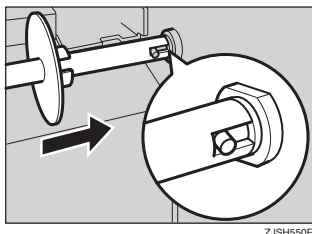

**Note**

- Check that the pin in the shaft stem fits completely into the slit in the right end of the shaft.

- 14** Attach the snap ring onto the end of the roller shaft.

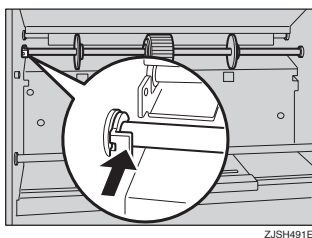

- 15** Move the separation pressure lever back to Position 3 (the position for Standard paper).

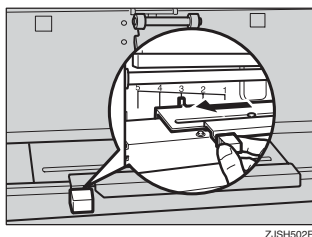

- 16** Return both side rollers to their original positions.

