

Model: PRIPORT RUBY		Date: 10-May-04	No: M-C232-001
Modified Article: Parts catalog correction for Drum Drive Shaft		Prepared by:	
From: Priport Service Planning Section		K. Yamamoto	
Classification: <input checked="" type="checkbox"/> Parts catalog correction <input type="checkbox"/> Vendor change <input type="checkbox"/> To meet standards <input type="checkbox"/> To facilitate assembly <input type="checkbox"/> To improve reliability () <input type="checkbox"/> Part standardization <input type="checkbox"/> Other ()			
Model Name: Ricoh JP5800			

The shape of drum drive shaft [A] and timing pulley – drum drive [B] were changed to prevent wear to the drum drive shaft.

Old part number	New part number	Description	Q'ty	Int	Page	Index
C2291090	C2331090	Drum Drive Shaft	1	X/O as a set	23	12
C2291092	C2331092	Timing Pulley - Drum Drive	1		25	12

Note: Replace the Drum Drive Shaft and the Timing Pulley together as a set.

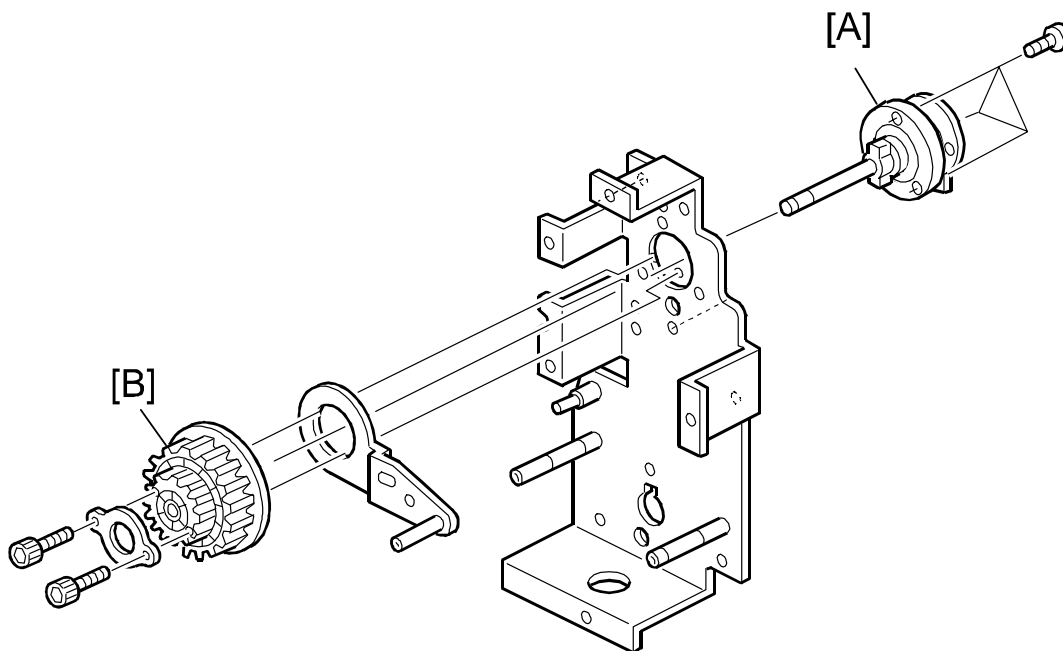

Model: PRIPORT RUBY**Date:** 10-May-04**No:** M-C232-001**CUT IN SERIAL NUMBERS**

Model Name	V/Hz	Destination	Code	Serial Number
Ricoh JP5800	230/50	Europe, etc.	C232-27	C3711100001~

Model: PRIPORT RUBY		Date: 12-Oct-04	No: M-C232-002
Modified Article: Paper Guide		Prepared by:	
From: Priport Service Planning Section		A. Yoshida	
Classification: <input type="checkbox"/> Parts catalog correction <input type="checkbox"/> Vendor change <input type="checkbox"/> To meet standards <input type="checkbox"/> To facilitate assembly <input checked="" type="checkbox"/> To improve reliability () <input type="checkbox"/> Part standardization <input type="checkbox"/> Other ()			
Model Name: Ricoh JP5800			

The following applies to the optional JS40-Sorter.

Old #	New #	Description	Qty	Int	Page	Index
-	C5922370	Front Guide Assembly	1	X/O as a set	21	*24
-	C5922371	Rear Guide Assembly	1		21	*25
-	04514006B	Tapping Screw – 4x6	2		21	101
-	C5922374	Guide	2	-	21	*26

*: New index

NOTE: The #C5922374 guide is part of the front guide assembly and rear guide assembly.

Change: Added front guide assembly [A], rear guide assembly.

Reason: To ensure that curled paper is fed smoothly in the relay transport area [B] and horizontal transport area [C].

Important: When images with many solid image areas are printed out often, light scratches can appear on the copy. For these customers, attach a piece of double-sided tape [D] to the guide assembly, and then attach the guide assembly to the upper stay [E].

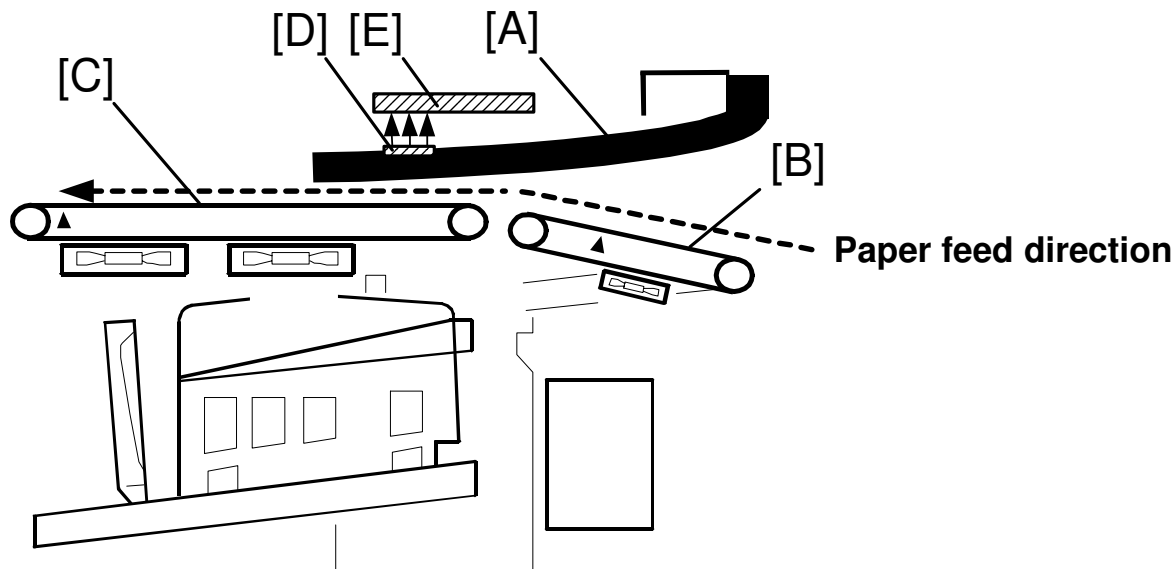

Model: PRIPORT RUBY

Date: 12-Oct-04

No: M-C232-012

Revised Illustration:

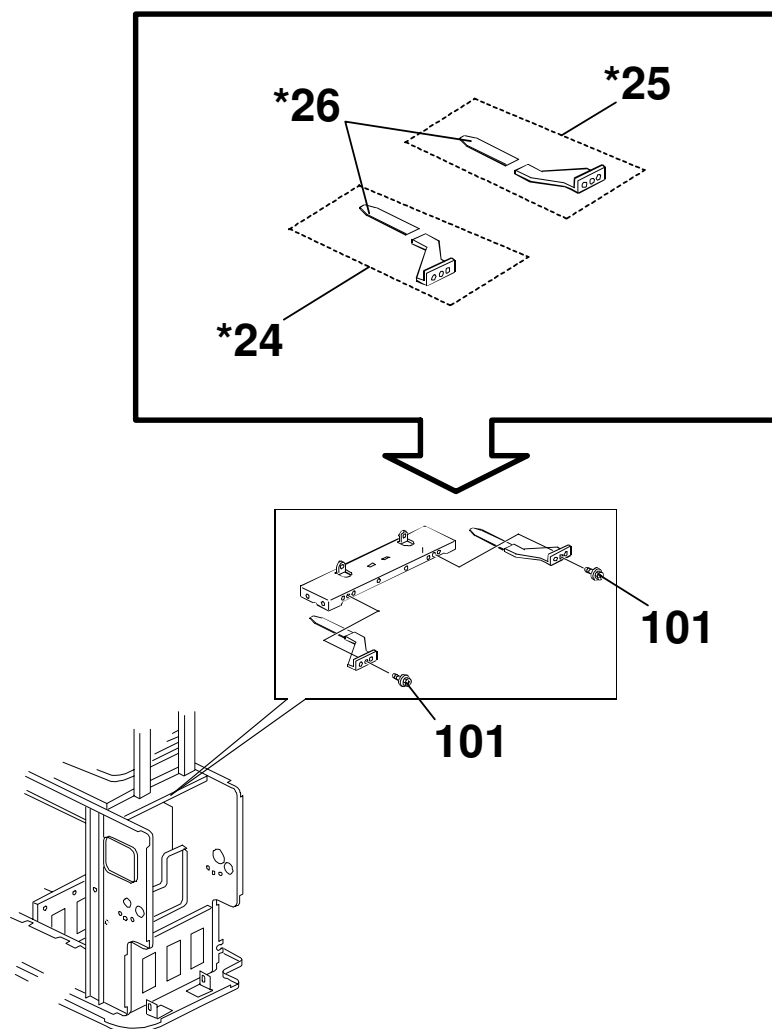

CUT IN SERIAL NUMBERS

Model Name	V/Hz	Destination	Code	Serial Number
JS40-Sorter	230/50	Europe	C592-53	C3881080001

Model: PRIPORT RUBY		Date: 3-Dec-04	No: M-C232-003
Modified Article: Belt drive motor		Prepared by:	
From: Priport Service Planning Section		M. Kanomata	
Classification:	<input type="checkbox"/> Parts catalog correction <input type="checkbox"/> Vendor change <input type="checkbox"/> To meet standards <input type="checkbox"/> To facilitate assembly <input checked="" type="checkbox"/> To improve reliability () <input type="checkbox"/> Part standardization <input type="checkbox"/> Other ()		
Model Name:			
Ricoh JP5600			

This MB applies to the optional **JS40-Sorter**.

Old #	New #	Description	Qty	Int	Page	Index
C5925868	C5925869	BELT DRIVE MOTOR	1	X/O	7	21

Change: The internal connection of the harness and motor was changed.

Reason: To ensure that the harness stays connected to the motor. This will ensure that a jam at the relay transport unit does not occur.

Illustrations:

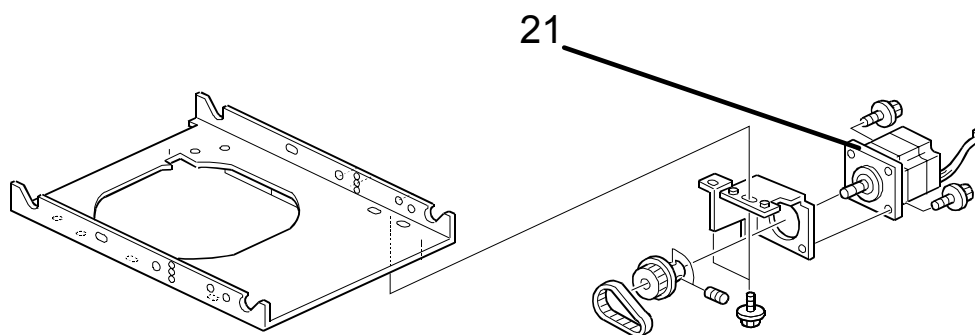

[A]: Internal connection point of the harness.

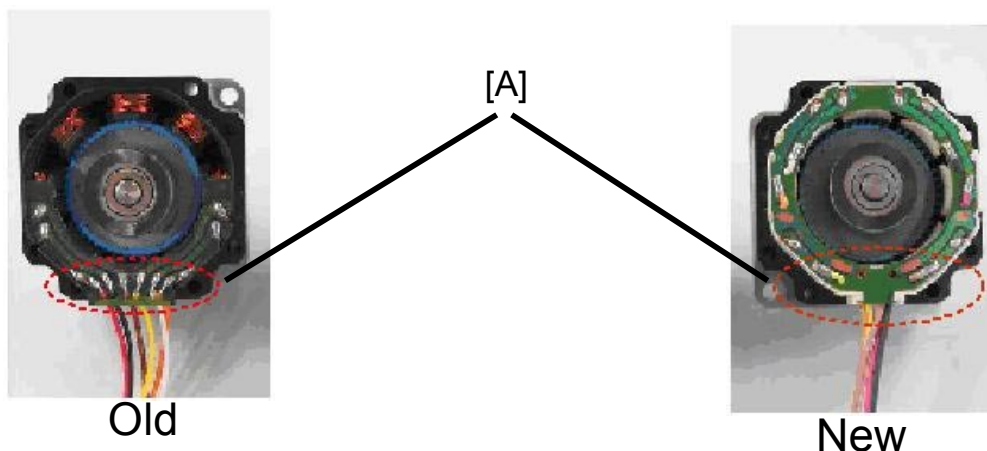

Model: PRIPORT RUBY**Date:** 3-Dec-04**No:** M-C232-**003****CUT IN SERIAL NUMBERS**

Model Name	V/Hz	Destination	Code	Serial Number
JS-40 Sorter	230/50	Europe	C592-53	C3384090001

Model: PRIPORT RUBY		Date: 24-Jan-05	No: M-C232-004
Modified Article: Modified to environmentally-friendly material		Prepared by:	
From: Priport Service Planning Section		K. Yamamoto	
Classification: <input type="checkbox"/> Parts catalog correction <input type="checkbox"/> Vendor change <input type="checkbox"/> To meet standards <input type="checkbox"/> To facilitate assembly <input type="checkbox"/> To improve reliability () <input type="checkbox"/> Part standardization <input checked="" type="checkbox"/> Other ()			
Model Name:			
Ricoh JP5800			

Change: The materials of these parts were changed to more environmentally-friendly materials.

Reason: As part of Ricoh's ongoing application of in-house environmental management standards.

Ruby

Old Part Number	New Part Number	Description	Q'ty	Int	Page	Index
C2292850	C2442850	Paper Feed Stay	1	O/O	33	22
C2295732	C2445734	Feed Pressure Motor Bracket	1	O/O	33	14
C2292893	C2442893	Right Pressure Arm	1	O/O	37	12
C2292894	C2442894	Left Pressure Arm	1	O/O	37	10
C2292898	C2442898	Pressure Release Lock Arm - Right	1	O/O	37	13
C2292899	C2442899	Pressure Release Lock Arm - Left	1	O/O	37	9
C2292900	C2442900	Pressure Release Shaft	1	O/O	37	11
C2295730	C2445730	Paper Table Motor Bracket	1	O/O	31	30
C2292751	C2442751	Right Side Plate	1	O/O	31	10
C2292755	C2442755	Lift Up Rack - Paper Table	1	O/O	31	1
C2292754	C2442754	Left Side Plate	1	O/O	31	6
56073927	C2442799	Stepped Screw - M3x8	2	O/O	31	17
C2322767	C2362767	Paper Tray Unit	1	O/O	29	26
C2322779	C2582779	Sheet Harness Clamp	1	O/O	29	29
C2322773	C2362773	Paper Tray	1	O/O	29	14
C2292955	C2442955	Ground Plate	1	O/O	29	15
C2322774	C2362774	Paper Tray Cover	1	O/O	29	3
C2322775	C2362775	Paper Tray - Sub	1	O/O	29	12
C2322861	C2452861	Pulley Cover	1	O/O	27	24