

Reissued: 31-Aug-11

Model: PRIPORT HP4-R2.5	Date: 13-Jan-09	No.: RC272001g
-------------------------	-----------------	----------------

RTB Reissue

The items in bold italics have been corrected.

Subject: Firmware Release History – HP4-R2.5		Prepared by: H. Matsui	
From: 1st Overseas Tech Support Sec., 1st PQM Dept.			
Classification:	<input type="checkbox"/> Troubleshooting <input type="checkbox"/> Mechanical <input type="checkbox"/> Paper path <input type="checkbox"/> Product Safety	<input type="checkbox"/> Part information <input type="checkbox"/> Electrical <input type="checkbox"/> Transmit/receive <input checked="" type="checkbox"/> Other ()	<input type="checkbox"/> Action required <input type="checkbox"/> Service manual revision <input type="checkbox"/> Retrofit information <input type="checkbox"/> Tier 2

The RTB has been issued to announce the firmware release information for the **HP4-R2.5**.

FIRMWARE MODIFICATION HISTORY
For NA, ASI, CHN (A3)

C2725135	File Name	Version	C.SUM	Production	Availability of RFU
<i>J</i>	<i>C2725135J.bin</i>	<i>1.14</i>	<i>CBFD</i>	<i>September 2011 production</i>	<i>Not available</i>
H	C2725135H.bin	1.13	E9E2	April 2011 production	Not available
G	C2725135G.bin	1.11	D3E2	January 2010 production	Not available
F	C2725135F.bin	1.10	5AFA	January 2010 production	Not available
E	C2725135E.bin	1.09	8836	June 2009 production	Not available
D	C2725135D.bin	1.06	32DD	March 2009 production	Not available
C	C2725135C.bin	1.05	5126	February 2009 production	Not available
B	C2725135B.bin	1.03	97CC	1st Mass production	Not available

Reissued: 31-Aug-11

Model: PRIPORT HP4-R2.5	Date: 13-Jan-09	No.: RC272001g
-------------------------	-----------------	----------------

For EU (A3)

C2725136	File Name	Version	C.SUM	Production	Availability of RFU
J	<i>C2725136J.bin</i>	<i>1.14</i>	<i>A830</i>	<i>September 2011 production</i>	<i>Not available</i>
H	C2725136H.bin	1.13	1949	April 2011 production	Not available
G	C2725136G.bin	1.11	A78A	January 2010 production	Not available
F	C2725136F.bin	1.10	F0AC	January 2010 production	Not available
E	C2725136E.bin	1.09	6E53	June 2009 production	Not available
D	C2725136D.bin	1.06	E463	March 2009 production	Not available
C	C2725136C.bin	1.05	840C	February 2009 production	Not available
B	C2725136B.bin	1.03	EAFD	1st Mass production	Not available

For EXP (B4)

C2735135	File Name	Version	C.SUM	Production	Availability of RFU
E	<i>C2735135E.bin</i>	<i>1.14</i>	<i>839A</i>	<i>September 2011 production</i>	<i>Not available</i>
D	C2735135D.bin	1.13	119F	April 2011 production	Not available
C	C2735135C.bin	1.11	40EE	January 2010 production	Not available
B	C2735135B.bin	1.10	B048	January 2010 production	Not available
A	C2735135A.bin	1.09	26AE	June 2009 production	Not available
-	C2735135.bin	1.06	C284	1st Mass production	Not available

Note: The firmware is different depends on the destinations.

Note: Definition of Availability of RFU

“Available”: The firmware can be updated via RFU or SD card.

“Not available”: The firmware can only be updated via SD card.

Reissued: 31-Aug-11

Model: PRIPORT HP4-R2.5	Date: 13-Jan-09	No.: RC272001g
-------------------------	-----------------	----------------

For NA, ASI, CHN (A3)

Symptom Corrected / Changes	Suffix
Symptom corrected: Wording error in Chinese language error message. Other changes: A Retry feature was added for SC (E-43/printing pressure error).	J
Minor bug correction.	H
Symptom corrected: The printed image is shifted due to the skewing of the master during the master wrapping process.	G
Other changes: (Minor change applied to facilitate production line inspections).	F
Other changes: Image positioning accuracy was improved.	E
Other changes: 1. Firmware modified to support the China model. 2. New SP modes were added: SP2-115 (Reg Improvement for 1st Prt) Note: Sets the amount of time that the drum is idled before the machine begins a print job (longer idling brings the drum closer to actual print speed, which improves registration). If this setting is changed from default, the 1st Print time will change. SP2-120 Master Compression Time - A3 SP2-121 Master Compression Time - B4 SP2-122 Master Compression Time - A4 Note: Sets the amount of time for master compression. If the time is reduced, the number of masters that can be stored in the master storage box at one time is also reduced.	D
Symptom corrected: The machine does not enter Energy Saver mode when there is no paper loaded on the feed table and turn on the main SW..	C
1st Mass production	B

For EU (A3)

Symptom Corrected / Changes	Suffix
Symptom corrected: Wording error in Chinese language error message. Other changes: A Retry feature was added for SC (E-43/printing pressure error).	J
Minor bug correction.	H

Reissued: 31-Aug-11

Model: PRIPORT HP4-R2.5	Date: 13-Jan-09	No.: RC272001g
Symptom Corrected / Changes		Suffix
Symptom corrected: The printed image is shifted due to the skewing of the master during the master wrapping process.		G
Other changes: (Minor change applied to facilitate production line inspections).		F
Other changes: Image positioning accuracy was improved.		E
Other changes: 1. Firmware modified to support the China model. 2. New SP modes were added: SP2-115 (Reg Improvement for 1st Prt) Note: Sets the amount of time that the drum is idled before the machine begins a print job (longer idling brings the drum closer to actual print speed, which improves registration). If this setting is changed from default, the 1st Print time will change. SP2-120 Master Compression Time - A3 SP2-121 Master Compression Time - B4 SP2-122 Master Compression Time - A4 Note: Sets the amount of time for master compression. If the time is reduced, the number of masters that can be stored in the master storage box at one time is also reduced.		D
Symptom corrected: Machines with the FV-Lt controller installed do not enter Energy Saver mode if there is no paper loaded on the feed table when the main switch is turned on.		C
1st Mass production		B

For EXP (B4)

OF 2017 (2017)

Symptom Corrected / Changes	Suffix
Symptom corrected: <i>Wording error in Chinese language error message.</i>	<i>E</i>
Other changes: <i>A Retry feature was added for SC (E-43/printing pressure error).</i>	
Minor bug correction.	D
Symptom corrected: The printed image is shifted due to the skewing of the master during the master wrapping process.	C
Other changes: (Minor change applied to facilitate production line inspections).	B
Other changes: Image positioning accuracy was improved.	A
1st Mass production	-

Model: PRIPORT HQPG4-R2.5		Date: 12-Feb-09	No.: RC272002
Subject: Energy Saver Mode		Prepared by: K. Yamamoto	
From: 2nd Tech Support Sec. Service Support Dept.			
Classification:	<input checked="" type="checkbox"/> Troubleshooting	<input type="checkbox"/> Part information	<input type="checkbox"/> Action required
	<input type="checkbox"/> Mechanical	<input type="checkbox"/> Electrical	<input type="checkbox"/> Service manual revision
	<input type="checkbox"/> Paper path	<input type="checkbox"/> Transmit/receive	<input type="checkbox"/> Retrofit information
	<input type="checkbox"/> Product Safety	<input type="checkbox"/> Other ()	<input type="checkbox"/> Tier 2

Upgrade the firmware at machine installation

SYMPTOM

Machines with the FV-Lt controller installed might not enter Energy Saver mode if there is no paper loaded on the feed table when the main switch is turned on.

Note: You can clear the symptom by printing out from the controller, accessing User Tools and loading paper on the paper feed table.

CAUSE

The warm-up cycles of the machine and controller are not perfectly synchronized. When the machine finishes warming up first, the machine cannot recognize the controller correctly (as the controller is still warming up). As a result, the machine cannot start the Energy Saver Timer.

SOLUTION

The firmware (C2725136) was modified so that the machine recognizes the controller.

In the Field:

On machines that were produced before the serial numbers listed below and that have the FV-Lt controller installed, upgrade the firmware at machine installation to **Ver1.05** (C2725136C) **or newer**.

Cut in Serial Numbers:

Model Name	Destination	Code	Serial Number
Standard SD435	USA, Canada	C272-11	N7290200001~
Ricoh/Gestetner DX4545	Asia, etc	C272-35	N7090200001~
Ricoh DX4545CP, Gestetner CP6453P	China	C272-50	Beginning of mass production~
Ricoh DX4545, Gestetner CP6250, Savin 3275DNP, Lanier LDD345	USA, Canada	C272-52	N7190300001~
Ricoh/NRG DX4545	USA, Canada	C272-53	N6990200001~
Ricoh DX4544C Gestetner CP6452C	China	C272-95	Beginning of mass production~

Model: P HP4-R2.5		Date: 19-Aug-09	No.: RC272003
Subject: Parts Information		Prepared by: M. Kumagai	
From: 2nd Tech Support Sec. Service Support Dept.			
Classification:	<input type="checkbox"/> Troubleshooting <input checked="" type="checkbox"/> Part information <input type="checkbox"/> Action required <input type="checkbox"/> Mechanical <input type="checkbox"/> Electrical <input type="checkbox"/> Service manual revision <input type="checkbox"/> Paper path <input type="checkbox"/> Transmit/receive <input type="checkbox"/> Retrofit information <input type="checkbox"/> Product Safety <input type="checkbox"/> Other () <input type="checkbox"/> Tier 2		

Change / Reason: The following parts used on each size drum were changed for improved reliability of adhesion.

For A3 drum

Old part number	New part number	Description	Q'ty	Int	Page	Index	Note
C2492581	C2722581	DRAM METAL SCREEN:DRUM:A3:ASS'Y	1	X/O	37	20	
C2492584	C2722584	SEAL:INK:DRAM METAL SCREEN:A3:FRONT REAR	1	X/O	37	31	
C2492585	C2722585	SEAL:INK:DRAM METAL SCREEN:A3:INNER REAR	1	X/O	37	30	
C2492586	C2722586	SEAL:INK:DRAM METAL SCREEN:A3	1	X/O	37	21	

For B4 drum

Old part number	New part number	Description	Q'ty	Int	Page	Index	Note
C2502581	C2732581	DRAM METAL SCREEN:DRUM:B4:ASS'Y	1	X/O	37	20	
C2492584	C2722584	SEAL:INK:DRAM METAL SCREEN:A3:FRONT REAR	1	X/O	37	31	
C2492585	C2722585	SEAL:INK:DRAM METAL SCREEN:A3:INNER REAR	1	X/O	37	30	
C2502586	C2732586	SEAL:INK:DRAM METAL SCREEN:B4	1	X/O	37	21	

For A4 drum

Old part number	New part number	Description	Q'ty	Int	Page	Index	Note
C6202581	C6202583	DRAM METAL SCREEN:DRUM:A4:ASS'Y	1	X/O	37	20	
C2492584	C2722584	SEAL:INK:DRAM METAL SCREEN:A3:FRONT REAR	1	X/O	37	31	
C2492585	C2722585	SEAL:INK:DRAM METAL SCREEN:A3:INNER REAR	1	X/O	37	30	
C6202586	C6202588	SEAL:INK:DRAM METAL SCREEN:A4:BOTH ENDS	2	X/O	37	32	

Model: PRIPORT HQPG4-R2.5		Date: 09-Oct-09	No.: RC272004
Subject: Noise from the master making unit		Prepared by: K. Yamamoto	
From: 2nd Tech Support Sec. Service Support Dept.			
Classification:	<input checked="" type="checkbox"/> Troubleshooting	<input checked="" type="checkbox"/> Part information	<input type="checkbox"/> Action required
	<input type="checkbox"/> Mechanical	<input type="checkbox"/> Electrical	<input type="checkbox"/> Service manual revision
	<input type="checkbox"/> Paper path	<input type="checkbox"/> Transmit/receive	<input type="checkbox"/> Retrofit information
	<input type="checkbox"/> Product Safety	<input type="checkbox"/> Other ()	<input type="checkbox"/> Tier 2

SYMPTOM

A noise can be heard from the master making unit during the master making process.

Note: This does not affect machine operation or performance in any way.

CAUSE

Sometimes, the master vibrates as suction is holding it against the duct of the master making unit.

SOLUTION

A cushion was added to the duct, which reduces the sound.

Old part number	New part number	Description	Q'ty	Int	Page	Index	Note
-	C2722248	Cushion: Duct: Scraper	1	-	29*	43*	

* New index

Note: This cushion was added to service part P/N C2642188 (index #38), as shown in the illustration below.

Model: PRIPORT HQPG4-R2.5

Date: 09-Oct-09

No.: RC272004

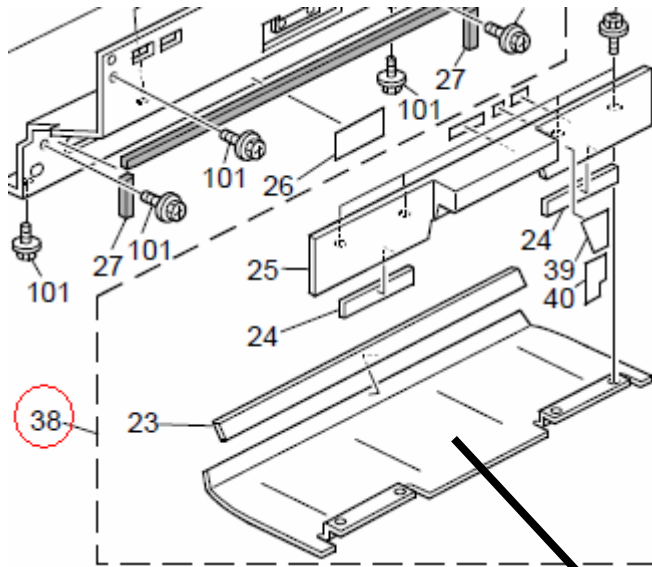

Model: P HP4-R2.5		Date: 25-Nov-09	No.: RC272005
Subject: Parts Information for B4 model		Prepared by: K. Yamamoto	
From: 1st Overseas Tech Support Sec., 1st PQM Dept.			
Classification:	<input type="checkbox"/> Troubleshooting <input type="checkbox"/> Mechanical <input type="checkbox"/> Paper path <input type="checkbox"/> Product Safety	<input checked="" type="checkbox"/> Part information <input type="checkbox"/> Electrical <input type="checkbox"/> Transmit/receive <input type="checkbox"/> Other ()	<input type="checkbox"/> Action required <input type="checkbox"/> Service manual revision <input type="checkbox"/> Retrofit information <input type="checkbox"/> Tier 2

This RTB lists the parts unique to the B4 model (C273)

1. Exterior

Sec	Page	Index	Parts No.	Description	Q'ty	Note
1	8	6	C2731362	SHEET:EMBLEM:GES:CP6402C	1	
1	8	6	C2731361	SHEET:EMBLEM:RIC:DX4446C	1	

9. Plotter unit 1

Sec	Page	Index	Parts No.	Description	Q'ty	Note
9	25	21	C2682290	ROLLER:REAR:TENSION:B4	1	
9	25	22	C2682104	PLATEN:B4	1	
9	25	35	C2472221	FRONT FLANGE HOLDER-B4:G	1	
9	25	37	C2472211	REAR FLANGE HOLDER - B4	1	

10. Plotter unit 2

Sec	Page	Index	Parts No.	Description	Q'ty	Note
10	27	17	C2502076	BRAKE ROLLER	1	
10	27	19	C2502065	BRAKE ROLLER SPRING	1	
10	27	40	C2502277	SENSOR BRACKET - B4	1	

12. Press Roller Section

Sec	Page	Index	Parts No.	Description	Q'ty	Note
12	31	14	C2683050	PRESSURE ROLLER:B4:ASS'Y	1	

Model: P HP4-R2.5

Date: 25-Nov-09

No.: RC272005

13. Drum Unit 1

Sec	Page	Index	Parts No.	Description	Q'ty	Note
13	33	33	C2502538	CONNECTOR BRACKET - B4	1	

14. Drum Unit 1

Sec	Page	Index	Parts No.	Description	Q'ty	Note
14	35	1	C2732381	SCREEN:B4:ADHESION	1	
14	35	4	C2472389	SCREEN HOLDER 2	1	
14	35	6	C2472388	SCREEN HOLDER 1	1	

15. Drum Unit 1

Sec	Page	Index	Parts No.	Description	Q'ty	Note
15	37	1	C2502307	CLAMP:B4:ASS'Y	1	
15	37	8	C2472360	FRONT DRUM FLANGE - B4	1	
15	37	10	C2472362	REAR DRUM FLANGE - B4	1	
15	37	20	C2732581	DRAM METAL SCREEN: DRUM:B4: ASS'Y	1	
15	37	21	C2732586	SEAL:INK:DRAM METAL SCREEN: B4	1	
15	37	25	C2502675	FRONT SHEET	1	
15	37	26	C2502676	REAR SHEET	1	
15	37	32*	C2472367	REAR DRUM SPACER - B4	1	

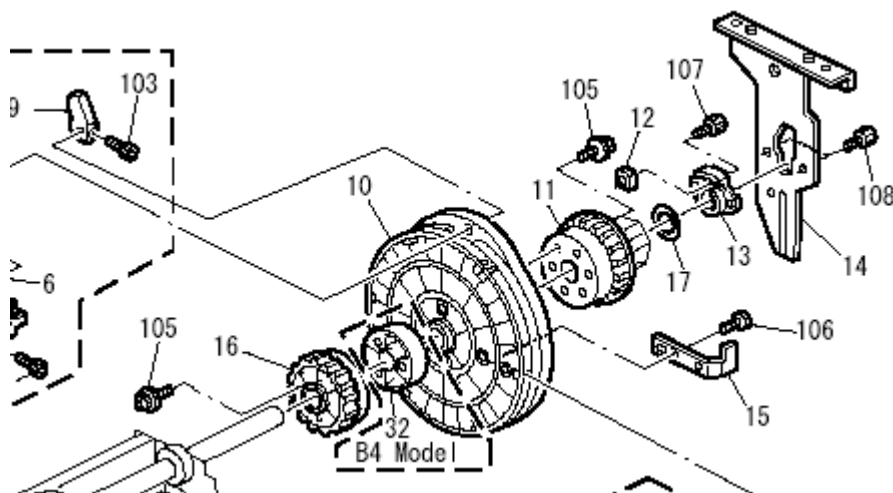

Model: P HP4-R2.5

Date: 25-Nov-09

No.: RC272005

16. Drum Unit 1

Sec	Page	Index	Parts No.	Description	Q'ty	Note
16	39	*	C2682325	ROLLER:INK:B4:ASS'Y	1	
16	39	1	C2292535	INK DISTRIBUTOR	1	
16	39	8	C2682475	DRUM SHAFT:B4:ASS'Y	1	
16	39	9	C2502472	INK SENSOR - B4	1	
16	39	10	C2472470	INK SENSOR BRACKET - B4	1	
16	39	11	C2682463	STAY:MAIN:DRUM:B4	1	
16	39	12	C2472450	INK ROLLER - B4	1	
16	39	13	C2472454	DOCTOR ROLLER - B4	1	
16	39	14	C2682465	STAY:AUXILIARY:DRUM:B4	1	
16	39	39	C2682334	OIL SUPPLY ROLLER: INK: B4: ASS'Y	1	
16	39	40	C2502558	BLADE BRACKET - B4	1	
16	39	49	C2682681	SHAFT:ARM:MOVE:OIL SUPPLY ROLLER:B4	1	
16	39	58*	C2472398	FRONT DRUM SPACER - B4	1	

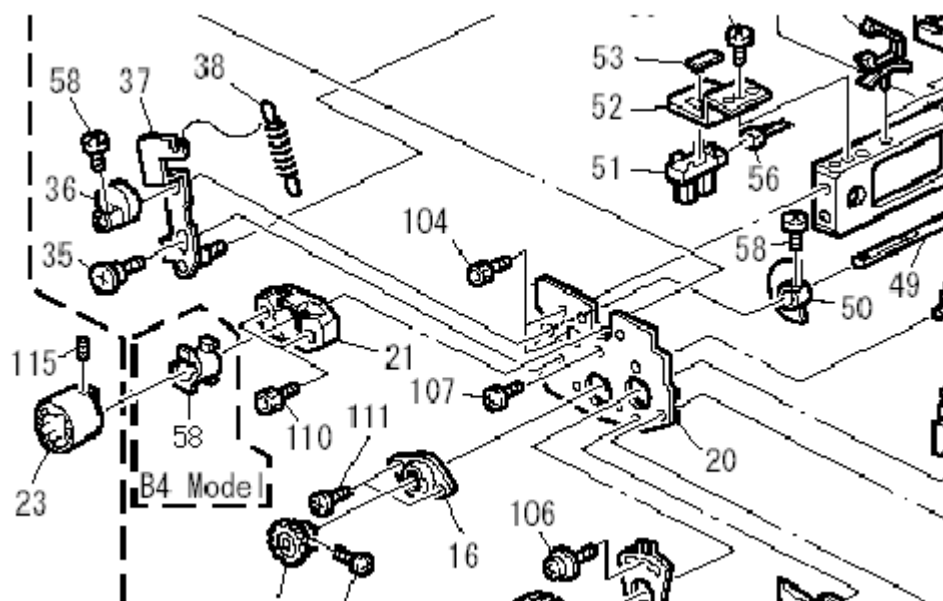

21. Master Eject Unit 1

Sec	Page	Index	Parts No.	Description	Q'ty	Note
21	49	*	C2683403	MASTER EJECTION UNIT:B4:ASS'Y	1	

Model: P HP4-R2.5

Date: 25-Nov-09

No.: RC272005

22. Master Eject Unit 2

Sec	Page	Index	Parts No.	Description	Q'ty	Note
22	51	*	C2683403	MASTER EJECTION UNIT:B4:ASS'Y	1	
22	51	4	C2503462	MASTER EJECT STAY	1	
22	51	19	C2733447	ROLLER:UPPER:MASTER EJECTION UNIT:B4:ASS'Y	1	
22	51	20	C2683466	LOWER EJECT ROLLER - B4	1	
22	51	24	C2493524	SMALL CLAW	1	
22	51	25	C2493523	LARGE CLAW	1	

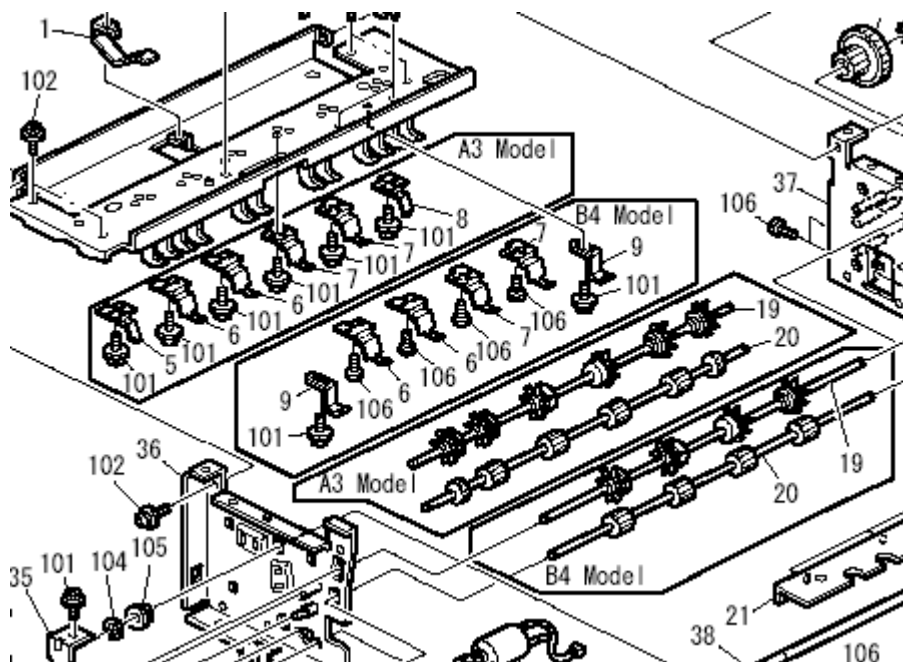

25. Electrical Section 1

Sec	Page	Index	Parts No.	Description	Q'ty	Note
25	57	1	C2735122	PCB:MPU:EXP:B4:ASS'Y	1	
25	57	13	C2735141	CARD:EXP:B4	1	

26. Electrical Section 2

Sec	Page	Index	Parts No.	Description	Q'ty	Note
26	59	10	C2502611	CONNECTOR BRACKET - B4	1	

Model: P HP4-R2.5		Date: 02-Jun-10	No.: RC272006
Subject: Parts information		Prepared by: M. Kumagai	
From: 1st Overseas Tech Support Sec., 1st PQM Dept.			
Classification:	<input type="checkbox"/> Troubleshooting <input type="checkbox"/> Mechanical <input type="checkbox"/> Paper path <input type="checkbox"/> Product Safety	<input checked="" type="checkbox"/> Part information <input type="checkbox"/> Electrical <input type="checkbox"/> Transmit/receive <input type="checkbox"/> Other ()	<input type="checkbox"/> Action required <input type="checkbox"/> Service manual revision <input type="checkbox"/> Retrofit information <input type="checkbox"/> Tier 2

Change: Anti-vibration weights were added to the brake shoe.

Reason: To prevent a squeaking sound from being generated in the plotter unit.

See “Important notes regarding attachment” on the next page

New part number	Description	Q'ty	Int	Page	Index	Note
C2722230	PLATE:BRACKET SHOE:PLOTTER:ASS'Y	0-2	X/O	29	43*	

*New Index

11.Plotter Unit 3 (C272/C273)

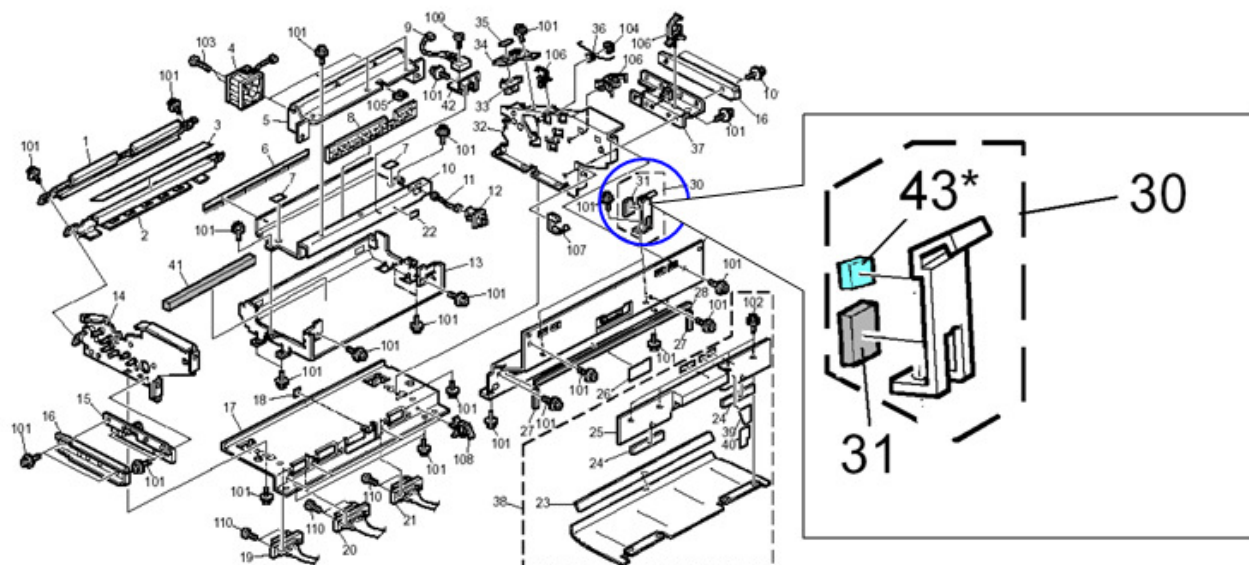

Model: P HP4-R2.5

Date: 02-Jun-10

No.: RC272006

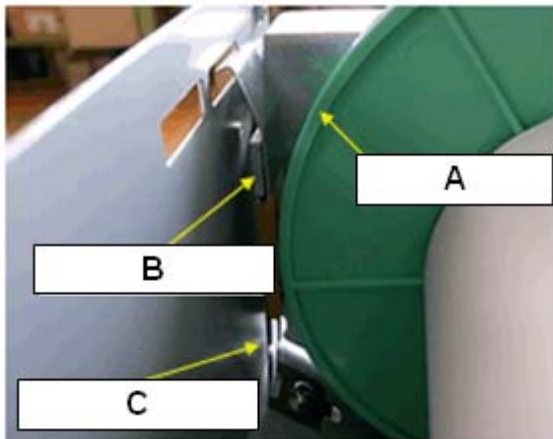
**A:** Master flange**B:** Anti-vibration weight (**C2722230 / Index 43**)**C:** Brake shoe

Important notes regarding attachment

- Before you attach B to C, remove the grease on the surface of C.
- Attach B to C with the following clearances:
 - Lengthwise: 0–1.5mm of the bend in C
 - Side to side: Line up the side edges of both B and C

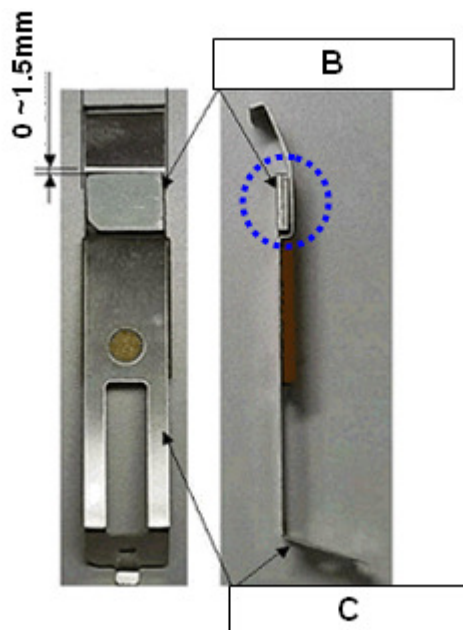

Model: P HP4-R2.5		Date: 24-Aug-10	No.: RC272007
Subject: Discharge brush at cutter unit		Prepared by: K. Yamamoto	
From: 1st Overseas Tech Support Sec., 1st PQM Dept.			
Classification:	<input type="checkbox"/> Troubleshooting <input type="checkbox"/> Mechanical <input type="checkbox"/> Paper path <input type="checkbox"/> Product Safety	<input checked="" type="checkbox"/> Part information <input type="checkbox"/> Electrical <input type="checkbox"/> Transmit/receive <input type="checkbox"/> Other ()	<input type="checkbox"/> Action required <input type="checkbox"/> Service manual revision <input type="checkbox"/> Retrofit information <input type="checkbox"/> Tier 2

Old part number	New part number	Description	Q'ty	Int	Page	Index
C2722070	C2722071	CUTTER UNIT:ASS'Y	1	X/0	25	42
C2492219	C2722219	BLADE:CUTTER UNIT	4	X/0 as	25	43
-	C2722220	DISCHARGE BRUSH:CUTTER UNIT:PLOTTER	4	a set	25	53*

*New Index

Change: An anti-static brush was added.

Reason: To improve master feeding performance.

Important:

1. Remove the Mylar before you attach the new brush.
2. Clean the cutter unit before attaching the new Mylar and brush.
3. Attach the brush first, and then the Mylar.

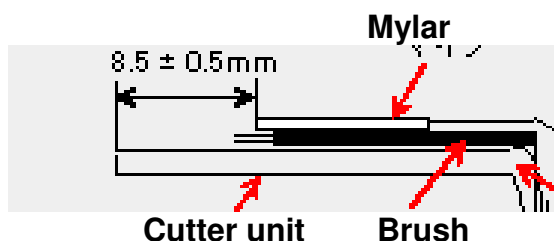

Model: P HP4-R2.5		Date: 20-Oct-10	No.: RC272008
Subject: PSU new safety standard		Prepared by: K. Yamamoto	
From: 1st Overseas Tech Support Sec., 1st PQM Dept.			
Classification:	<input type="checkbox"/> Troubleshooting <input checked="" type="checkbox"/> Part information <input type="checkbox"/> Action required <input type="checkbox"/> Mechanical <input type="checkbox"/> Electrical <input type="checkbox"/> Service manual revision <input type="checkbox"/> Paper path <input type="checkbox"/> Transmit/receive <input type="checkbox"/> Retrofit information <input type="checkbox"/> Product Safety <input type="checkbox"/> Other () <input type="checkbox"/> Tier 2		

Old part number	New part number	Description	Q'ty	Int	Page	Index
C2645310	C2725310	DC POWER SUPPLY:MAIN: 220-240V:ASS'Y	1	X/O as a set	57	12
11070392	11071295	FUSE:GLASS CARTRIDGE: FSL 250V 6.3A(EM)	4		57	108
11071067	11071295	FUSE:GLASS CARTRIDGE: FSL 250V 6.3A(EM)	1		57	109

Note: C2725310 is included in the new fuse (11071295).

Change: The material of the PCU was changed.

Reason: To comply with new product safety standards in the EU market.

Model: P HP4-R2.5		Date: 30-Jun-11	No.: RC272009
Subject: MPU board damage		Prepared by: K. Yamamoto	
From: 1st Overseas Tech Support Sec., 1st PQM Dept.			
Classification:	<input checked="" type="checkbox"/> Troubleshooting <input type="checkbox"/> Mechanical <input type="checkbox"/> Paper path <input type="checkbox"/> Product Safety	<input checked="" type="checkbox"/> Part information <input type="checkbox"/> Electrical <input type="checkbox"/> Transmit/receive <input type="checkbox"/> Other ()	<input type="checkbox"/> Action required <input type="checkbox"/> Service manual revision <input type="checkbox"/> Retrofit information <input checked="" type="checkbox"/> Tier 2

Symptom

- E-43 occurs while the machine is initializing after the main power is turned on.
- Registration jams or paper feed jams occur frequently.
- The operation panel does not respond when the main switch is turned on.

Cause

Damaged MPU board

SOLUTION

Replace the MPU board.

Note:

- The following table shows the latest versions of the board, which have improved durability.
- The P/N for the B4 machine was missing from the Parts Catalog.

A3 machine

Old part number	New part number	Description	Q'ty	Int	Page	Index
C2725134	C2725180	PCB:MPU:EXP:ASS'Y	1	X/O	57	1
C2725121	C2725183	PCB:MPU:EU:ASS'Y	1	X/O	57	1

B4 machine

Old part number	New part number	Description	Q'ty	Int	Page	Index
-	C2735180	PCB:MPU:EXP:B4:ASS'Y	1	X/O	57	1

Model: P HP4-R2.5	Date: 11-Jan-12	No.: RC272010
-------------------	-----------------	---------------

Subject: Air pump hose		Prepared by: K. Yamamoto	
From: 1st Tech Service Sect., MFP/P Tech Service Dept.			
Classification:	<input type="checkbox"/> Troubleshooting <input type="checkbox"/> Mechanical <input type="checkbox"/> Paper path <input type="checkbox"/> Other ()	<input checked="" type="checkbox"/> Part information <input type="checkbox"/> Electrical <input type="checkbox"/> Transmit/receive	<input type="checkbox"/> Action required <input type="checkbox"/> Service manual revision <input type="checkbox"/> Retrofit information

HP4-R2

Old part number	New part number	Description	Q'ty	Int	Page	Index
C2494364	C2693135	SPRING:HOSE:PUMP:EXIT	1	X/O as a set	51	27
C2094711	C2442530	HOSE BAND	2		51	8
C2444369	C2724369	HOSE: PUMP: EXIT:	1		51	9

HP4-R2.5

Old part number	New part number	Description	Q'ty	Int	Page	Index
C2494364	C2693135	SPRING:HOSE:PUMP:EXIT	1	X/O as a set	53	27
C2094711	C2442530	HOSE BAND	2		53	8
C2444369	C2724369	HOSE: PUMP: EXIT:	1		53	9

Change: The shape of the hose was changed.

Reason: Vendor change

Model: P HP4-R2.5	Date: 26-Sep-12	No.: RC272011
-------------------	-----------------	---------------

Subject: Paper feed table		Prepared by: K. Yamamoto	
From: 1st Tech Service Sect., MFP/P Tech Service Dept.			
Classification:	<input type="checkbox"/> Troubleshooting <input type="checkbox"/> Mechanical <input type="checkbox"/> Paper path <input type="checkbox"/> Other ()	<input checked="" type="checkbox"/> Part information <input type="checkbox"/> Electrical <input type="checkbox"/> Transmit/receive	<input type="checkbox"/> Action required <input type="checkbox"/> Service manual revision <input type="checkbox"/> Retrofit information

HP4-R2

Old part number	New part number	Description	Q'ty	Int	Page	Index
C2382955	C2792955	BASE:PAPER FEED TRAY	1	X/O	19	37
C2382960	C2722965	ARM:FRONT:PAPER FEED TRAY	1	X/O as a set	19	36
C2382961	C2722966	ARM:REAR:PAPER FEED TRAY: PEEN	1		19	35

HP4-R2.5

Old part number	New part number	Description	Q'ty	Int	Page	Index
C2382955	C2792955	BASE:PAPER FEED TRAY	1	X/O	19	37
C2722960	C2722965	ARM:FRONT:PAPER FEED TRAY	1	X/O as a set	19	36
C2722961	C2722966	ARM:REAR:PAPER FEED TRAY: PEEN	1		19	35

Change: The shapes of the brackets were changed.

Reason: Parts standardization with the PD-D1.