

Model: P TT3		Date: 2-Jun-09	No.: RC274001
Subject: Parts catalog correction		Prepared by: M. Kumagai	
From: 2nd Tech Support Sec. Service Support Dept.			
Classification:	<input type="checkbox"/> Troubleshooting <input type="checkbox"/> Mechanical <input type="checkbox"/> Paper path <input type="checkbox"/> Product Safety	<input checked="" type="checkbox"/> Part information <input type="checkbox"/> Electrical <input type="checkbox"/> Transmit/receive <input checked="" type="checkbox"/> Other (     )	<input type="checkbox"/> Action required <input type="checkbox"/> Service manual revision <input type="checkbox"/> Retrofit information <input type="checkbox"/> Tier 2

**Change:** The following parts were deleted.

**Reason:** Parts catalog correction

Old part number	New part number	Description	Q'ty	Int	Page	Index	Note
14076556	-	CMOS LOGIC:SN74ACT244PW	1		45	124	
14076910	-	MOTOR CONTROL IC:TA84007PQ	1		45	130	
14082625	-	IC:R3112Q461A-FA	1		45	135	
14082631	-	SERIES REGULATOR:TA7818SB	1		45	136	
14082708	-	SERIES REGULATOR:TA7805SB	1		45	137	
16018728	-	RESISTOR:200K OHM:+-10%:0.5W	1		45	143	
16018729	-	RESISTOR:20K OHM:+-10%:0.5W	1		45	144	
16531071	-	RESISTOR:1.07K OHM:+-1%:1/8W:2125	1		45	177	
16531401	-	RESISTOR:1.4K OHM:+-1%:1/8W:2125	1		45	178	

Model: P TT3		Date: 19-Aug-09	No.: RC274002
Subject: Color Drum Type 20		Prepared by: M.Kumagai	
From: 2nd Tech Support Sec. Service Support Dept.			
Classification:	<input type="checkbox"/> Troubleshooting <input type="checkbox"/> Mechanical <input type="checkbox"/> Paper path <input type="checkbox"/> Product Safety	<input checked="" type="checkbox"/> Part information <input type="checkbox"/> Electrical <input type="checkbox"/> Transmit/receive <input type="checkbox"/> Other (     )	<input type="checkbox"/> Action required <input type="checkbox"/> Service manual revision <input type="checkbox"/> Retrofit information <input type="checkbox"/> Tier 2

## Parts Change

- **Main change:** The Ink pump unit was changed to the same Thorochoid unit used on the PT series and TT3.  
**Reason:** To facilitate servicing in the field.

3.Color Drum 3 (C647/C648)

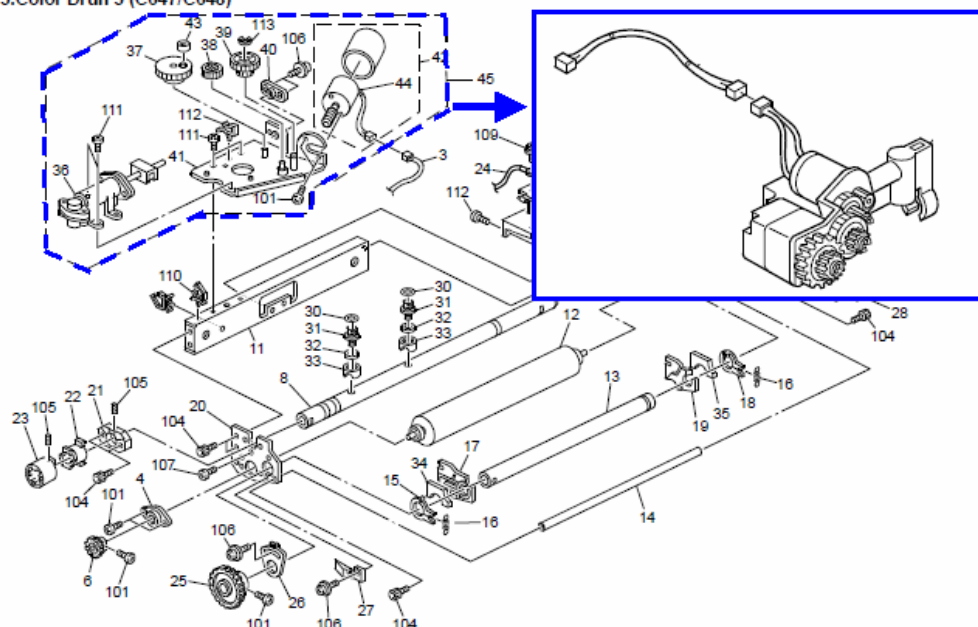

- **In accordance with this change:**
  - Some service parts changes were made (**see the PT or TT3 parts catalog**).
  - The format of the serial number for the drum was changed (**see the table below**) so that it is easy to distinguish between the drums with the old/new pump units.

Item	Model Name	Product Code	Old S/N format	New S/N format	Note
LG Color Drum	Color Drum Type 20 (LG)	C647-59	N01YMM70001	<b>N96YMM70001</b>	
B4 Color Drum	Color Drum Type 20 (B4)	C648-59	N02YMM70001	<b>N97YMM70001</b>	
A4 Color Drum	Color Drum Type 20 (A4)	C643-59	N11YMM70001	<b>N95YMM70001</b>	Only for Platinum

**Reissued:14-Jun-10**

Model: TT3	Date: 21-Apr-10	No.: RC274004a
------------	-----------------	----------------

**RTB Reissue**

The items in ***bold italics*** were corrected or added.

Subject: Parts information		Prepared by: M. Kumagai	
From: 1st Overseas Tech Support Sec., 1st PQM Dept.			
Classification:	<input type="checkbox"/> Troubleshooting <input type="checkbox"/> Mechanical <input type="checkbox"/> Paper path <input type="checkbox"/> Product Safety	<input checked="" type="checkbox"/> Part information <input type="checkbox"/> Electrical <input type="checkbox"/> Transmit/receive <input type="checkbox"/> Other (     )	<input type="checkbox"/> Action required <input type="checkbox"/> Service manual revision <input type="checkbox"/> Retrofit information <input type="checkbox"/> Tier 2

Old part number	New part number	Description	Q'ty	Int	Page	Index	Note
C2745100	C2745103	PCB:MPU:ASS'Y	1	O/O	37	4	
C2745105	C2745115	EPROM:PRINTED CIRCUIT BOARD:MPU	1	O/O	37	5	

**Change:** The MPU board for the **TT3 (Eco model)** was changed to the one shown below.

**Reason:** Parts standardization.

**Note:** The new board has an additional connector [A] and dip switch block [B], but these are not used when this board is installed on TT3 machines produced before this change was applied.

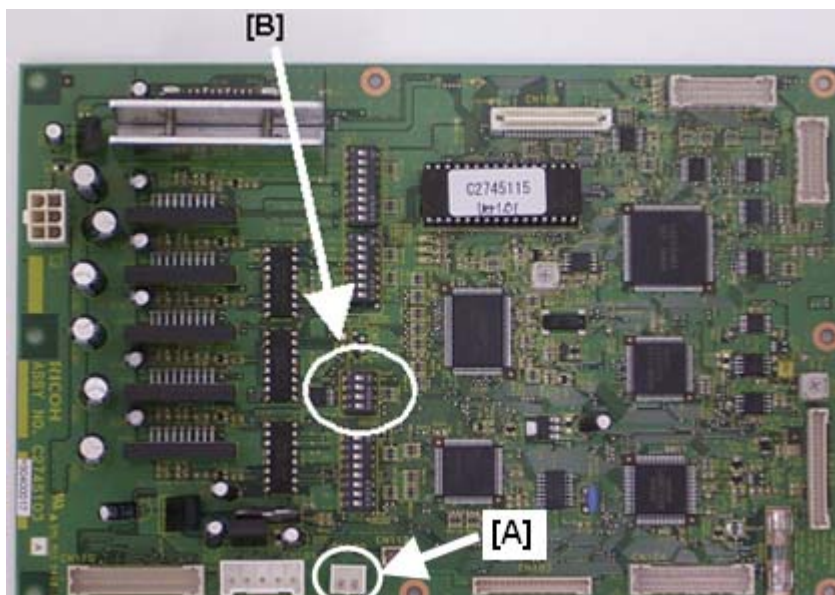

**Reissued:06-Sept-10**

Model: TT3	Date: 22-Dec-09	No.: RC274003b
------------	-----------------	----------------

**RTB Reissue**

The items in ***bold italics*** were corrected or added.

Subject: Additional new model for TT3		Prepared by: M. Kumagai	
From: 1st Overseas Tech Support Sec., 1st PQM Dept.			
Classification:	<input type="checkbox"/> Troubleshooting <input type="checkbox"/> Mechanical <input type="checkbox"/> Paper path <input type="checkbox"/> Product Safety	<input checked="" type="checkbox"/> Part information <input type="checkbox"/> Electrical <input type="checkbox"/> Transmit/receive <input type="checkbox"/> Other (     )	<input type="checkbox"/> Action required <input checked="" type="checkbox"/> Service manual revision <input type="checkbox"/> Retrofit information <input checked="" type="checkbox"/> Tier 2

**This RTB contains the Service Manual and Parts Catalog information unique to the new model TT3 (C274-70, 71, 72, 95, 96, 97)**

**Note:** As of September 2010, the Product Code and Serial Number type will change as follows for the existing model (C274-92, 94, 93, 77). The Product Names have not been changed.

Area	Name	Product Code	Serial #	Note
LA	Ricoh Priort DX 2330	C274-92	N91YMM70001	Size: LG
	<del>Gestetner CopyPrinter DX 2330</del> Lanier LDD745	<b>C274-95</b>	<b>D21YMM70001</b>	
Eupope	Ricoh Priort DX 2330	C274-94	N89YMM70001	Size: LG
	Nashuatec CopyPrinter DX 2330 Rex Rotary CopyPrinter DX 2330 Gestetner CopyPrinter DX 2330	<b>C274-97</b>	<b>D21YMM70001</b>	
Europe	Ricoh Priort DX 2430	C274-93	N90YMM70001	Size: B4
	NRG CopyPrinter DX 2430 Rex Rotary CopyPrinter DX 2430 Gestetner CopyPrinter DX 2430	<b>C274-96</b>	<b>D21YMM70001</b>	
LA Asia Korea	Ricoh Priort DX 2430	C274-77	N92YMM70001	Size: B4
	Gestetner CopyPrinter DX 2430	<b>C274-72</b>	<b>D21YMM70001</b>	

Reissued:06-Sept-10

Model: TT3	Date: 22-Dec-09	No.: RC274003b
------------	-----------------	----------------

## Service manual changes

---

### Overall information

#### Essential differences from the predecessor model (TT3) service manual

**NOTE:** If there are no changes, we simply marked “None” in the corresponding remarks column.

#### Main Chapters

Section	Item	Remarks
1	Product Information	Guidance for Those Who are Familiar with Predecessor Product was added.
2	Installation	None
3	Preventive Maintenance	None
4	Replacement and Adjustment	Cover and board was changed
5	System Maintenance Reference	None
6	Troubleshooting	None

#### Appendices

Section	Item	Remarks
1	Appendix: Specifications	Auto shut-off was added
2	Appendix: Maintenance Table	None
3	Appendix: Service Call Condition	New SC was added
4	Appendix: Electrical Component Defects	New DIP switch for MPU was added
5	Appendix: SP Mode Tables	New SP was added

**Reissued:06-Sept-10**

Model: TT3	Date: 22-Dec-09	No.: RC274003b
------------	-----------------	----------------

## Main Chapters

### 1. Product Information

#### Guidance for Those Who are Familiar with Predecessor Product

##### Different Points from Predecessor Products

Item	Predecessor Model	New Model
Auto shut-off mechanism	No	Yes
Auto shut-off timing	No	C274-70, 71: 5 minutes  C274-72, 95, 96, 97: 15 minutes
Main switch location	On the PSU board	Separate

**Note:** Auto shut-off timing is controlled by a DIP switch on the MPU board.

Refer to the replacement and adjustment section for details of the auto shut-off setting.

### 4. Replacement and Adjustment

#### Covers and Board

##### MPU

##### Changes:

1. One connector (circled in the diagram below) was added.
2. DIP SW 104 for auto shut-off setting was added.

Reissued:06-Sept-10

Model: TT3

Date: 22-Dec-09

No.: RC274003b

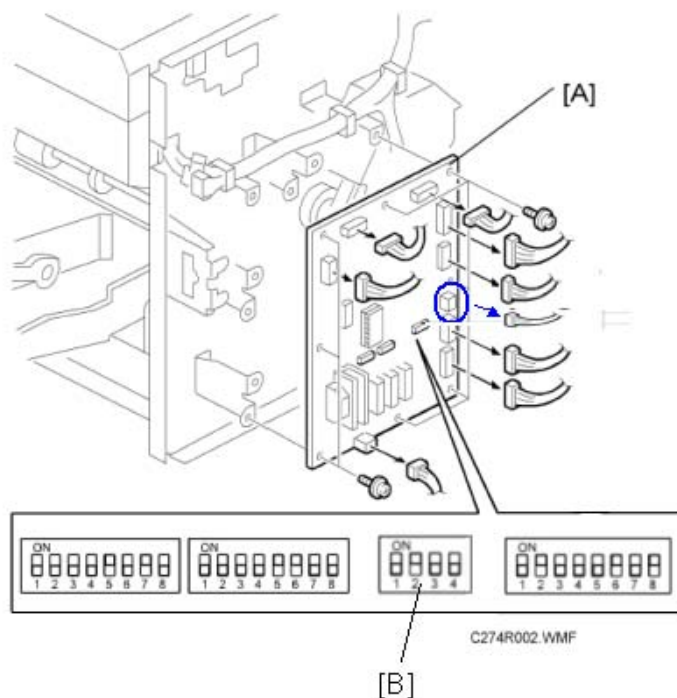

[A] MPU (Screw x 8, Connector x 9)

**Important:** The default auto shut-off setting of a brand new MPU board is OFF.

So when you replace the MPU board, you must set **DIP SW 104** to the same setting as the MPU board that you removed.

If the customer wishes to change the auto shut-off timing, change the DIP SW setting (refer to the following chart).

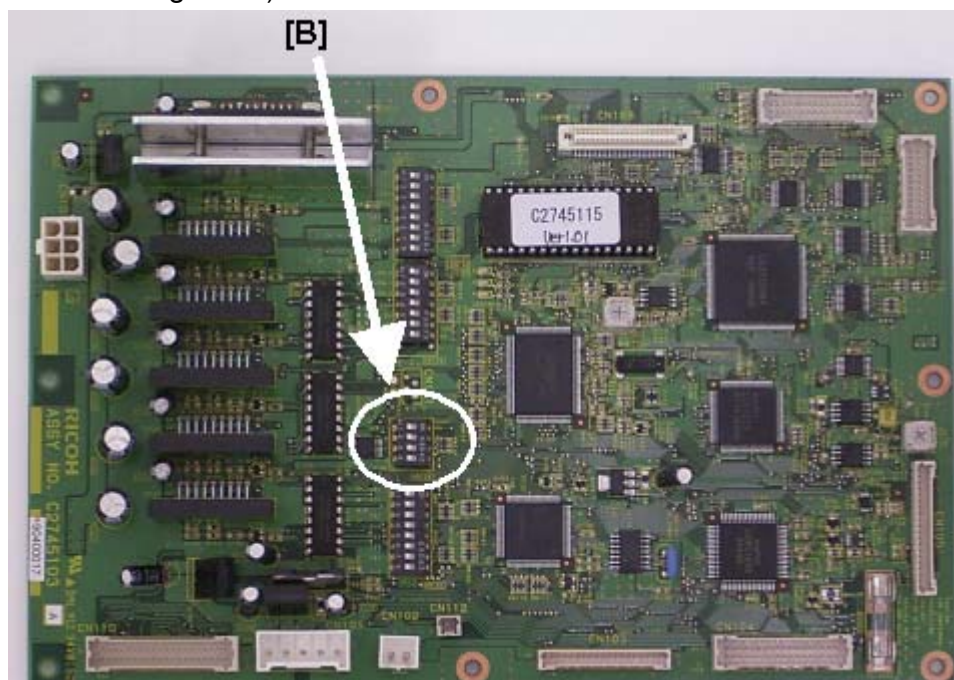



**Reissued:06-Sept-10**

Model: TT3

Date: 22-Dec-09

No.: RC274003b

[B]: DIP SW 104

**DIP SW 104 setting and auto shut-off timing**

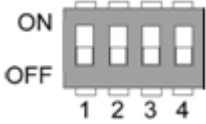
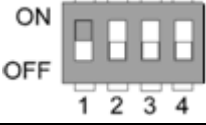
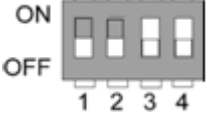
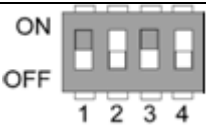
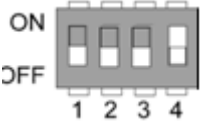
Auto shut-off timing	DIP SW 104 setting
OFF	
3 minutes	
5 minutes	
15 minutes	
30 minutes	

**Default settings**

C274-70 / C274-71: 5 minutes

C274-72 / C274-95 / C274-96 / C274-97: 15 minutes



**Reissued:06-Sept-10**

Model: TT3

Date: 22-Dec-09

No.: RC274003b

## PSU

**Changed:** One connector was added (circled in blue in the diagram).

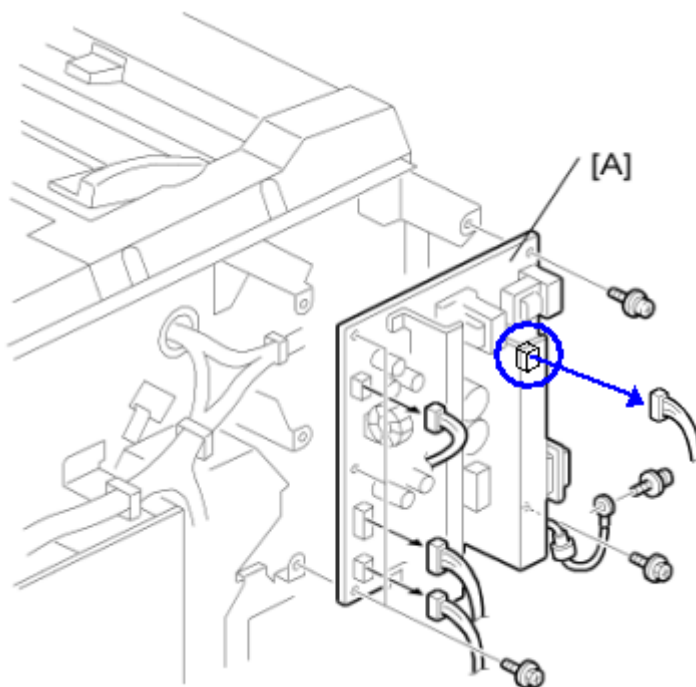

[A] PSU (Screw x 6, Connector x 4)

## Appendices

### 1. Specifications

#### Main Frame

Auto shut-off timing	Default : 5 minutes (C274-70 / C274-71) 15 minutes (C274-72 / C274-95 / C274-96 / C274-97)  Setting change: OFF / 3 minutes / 5 minutes / 15 minutes / 30 minutes
----------------------	--

**Reissued:06-Sept-10**

Model: TT3	Date: 22-Dec-09	No.: RC274003b
------------	-----------------	----------------

### 3. Service Call Condition

#### SC Tables

No.	Symptom	Possible cause
E-61	<u>Auto shut-off solenoid error</u> Main switch does not turn off within 6.0 seconds after the auto shut-off solenoid signal turned ON.	Auto shut-off solenoid Auto shut-off solenoid connector PCB

### 4. Electrical Component Defects

#### DIP Switches

##### MPU

DIPSW No.	Bit No.	Name	Settings
104	1 to 4	Auto shut-off timing setting	(Refer to Replacement and Adjustment – Cover and board– MPU)

### 5. SP Mode Tables

#### SP Tables

##### Input Mode

No.	Name	Note
1-95	DIPSW 104	Display the auto shut-off timing on the LCD (minutes)

##### Output Mode

No.	Name	Function
2-16	Auto shut-off solenoid	

**Reissued:06-Sept-10**

Model: TT3	Date: 22-Dec-09	No.: RC274003b
------------	-----------------	----------------

## Parts catalog changes

### 1. Exterior

Sec	Page	Index	Parts No.	Description	Q'ty
	7	11	C2741306	COVER:REAR	1
	7	21	C2741345	SHEET:EMBLEM:RIC:CHN	1
	7	21	<b>C2741355</b>	SHEET:EMBLEM:GES:CHN	1
	7	21	C2741342	SHEET:EMBLEM:RIC:LA	1

### 16. Electrical and Drive Section

Sec	Page	Index	Parts No.	Description	Q'ty
	37	4	C2745103	PCB:MPU:ASS'Y	1
	37	5	C2745115	EPROM:PRINTED CIRCUIT BOARD:MPU	1
	37	34*	A2505725	ROCKER SWITCH	1
	37	35*	C2745613	BRACKET:MAIN SWITCH	1
	37	36*	11050487	HARNESS CLAMP	1
	37	37*	C2745202	HARNESS:MAIN SWITCH:ASS'Y	1
	37	38*	C2745201	HARNESS:MOTOR:ASS'Y	1
	37	7	C2745320	DC POWER SUPPLY:MAIN:200V:ASS'Y ( <b>C274-70</b> , 71, 72, 96, 97 )	1
	37	7	C2745300	DC POWER SUPPLY:MAIN:ASS'Y ( <b>C274-95</b> )	1

\* New Index

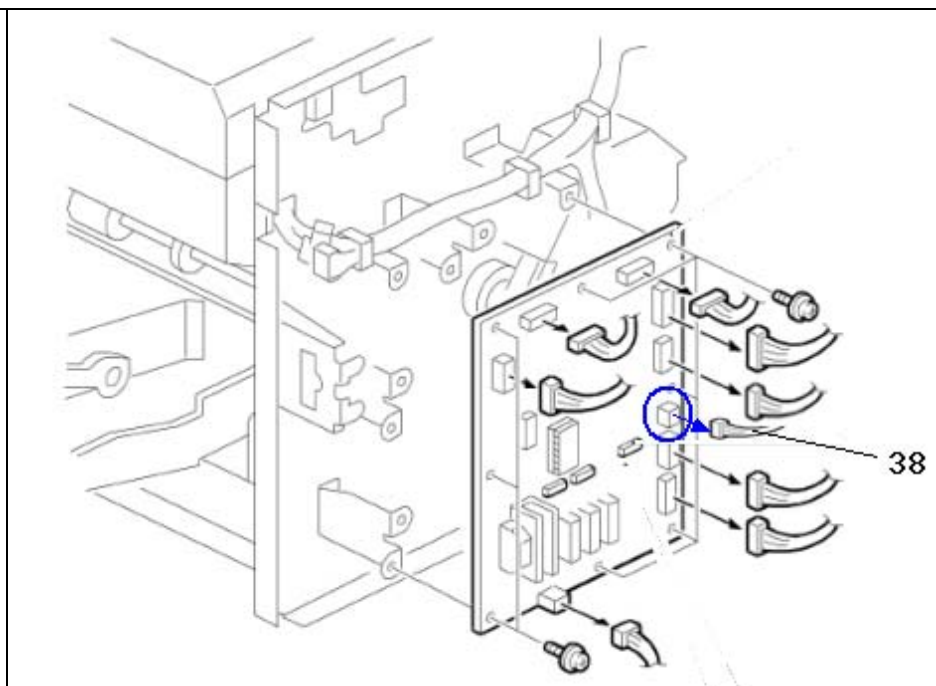
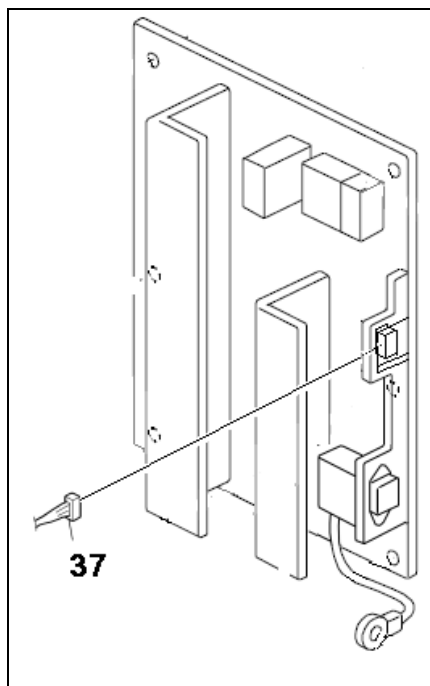
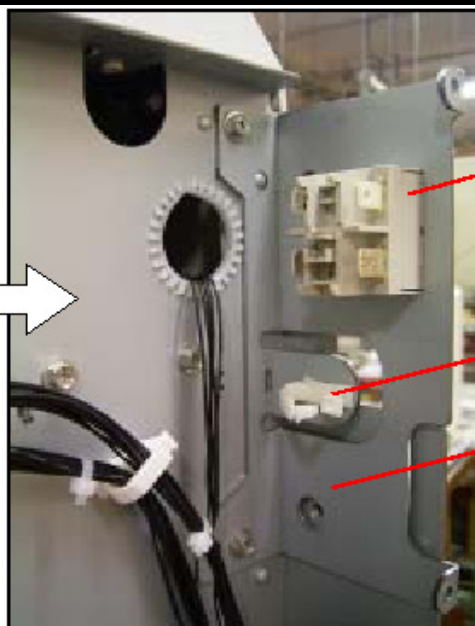
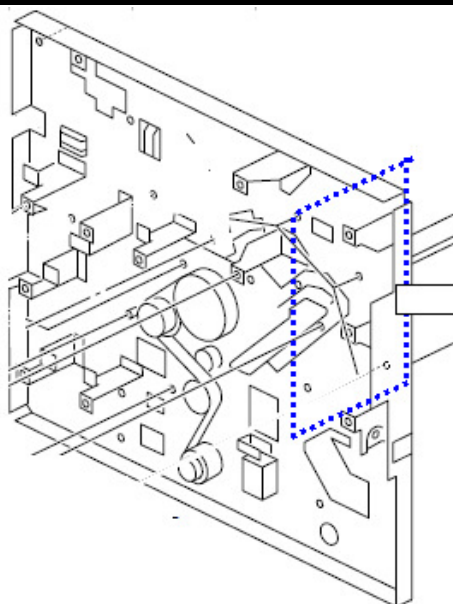
**Reissued:06-Sept-10**
**Model: TT3**
**Date: 22-Dec-09**
**No.: RC274003b**

## 20. Decals And Documents

Sec	Page	Index	Parts No.	Description	Q'ty
	37	7	C2741345	SHEET:EMBLEM:RIC:CHN	1
	37	7	C2741355	SHEET:EMBLEM:GES:CHN	1
	37	7	C2741342	SHEET:EMBLEM:RIC:LA	1

**Reissued: 22-Oct-13**

Model: TITANIUM III	Date: 20-Feb-09	No.: RC252007b
---------------------	-----------------	----------------

**RTB Reissue**

The items in bold italics have been changed.

Subject: Firmware Release Note: main		Prepared by: K. Yamamoto	
From: 2nd Tech Service Sect., MFP/Printer Tech Service Dept.			
Classification:	<input type="checkbox"/> Troubleshooting	<input type="checkbox"/> Part information	<input type="checkbox"/> Action required
	<input type="checkbox"/> Mechanical	<input type="checkbox"/> Electrical	<input type="checkbox"/> Service manual revision
	<input type="checkbox"/> Paper path	<input type="checkbox"/> Transmit/receive	<input type="checkbox"/> Retrofit information
	<input type="checkbox"/> Product Safety	<input checked="" type="checkbox"/> Other (     )	<input checked="" type="checkbox"/> Tier 2

This is to inform you of the firmware history for the Titanium3.

Version	Program No.	Effective Date	Availability of RFU
<b>1.66</b>	<b>C2745126A</b>	<b>November 2013 production</b>	<b>Not available</b>
1.02	C2745116A	November 2009 production	Not available
1.01	C2745106	1st Mass production	Not available

**Note: Definition of Availability of RFU via @Remote**

**“Available”:** The firmware can be updated via RFU or SD card.

**“Not available”:** The firmware can only be updated via SD card.

Version	Modified Points or Symptom Corrected
<b>1.66</b>	<b><i>Other changes:</i></b> <b><i>Supports firmware update via SD card when the C2745120 PCB is installed.</i></b> <b><i>Note: The C2745120 PCB must be installed for this feature to work.</i></b>
1.02	Other change: Supports the China Eco models (C274-70/C274-71) from this version.
1.01	1st Mass production

Model: TT3	Date: 12-Feb-14	No.: RC274005
------------	-----------------	---------------

Subject: New MPU board		Prepared by: K. Yamamoto	
From: 1st Overseas Tech Support Sec., 1st PQM Dept.			
Classification:	<input type="checkbox"/> Troubleshooting	<input checked="" type="checkbox"/> Part information	<input type="checkbox"/> Action required
	<input type="checkbox"/> Mechanical	<input type="checkbox"/> Electrical	<input type="checkbox"/> Service manual revision
	<input type="checkbox"/> Paper path	<input type="checkbox"/> Transmit/receive	<input type="checkbox"/> Retrofit information
	<input type="checkbox"/> Product Safety	<input type="checkbox"/> Other (      )	<input type="checkbox"/> Tier 2

Old part number	New part number	Description	Q'ty	Int	Page	Index	Note
C2745103	C2745123	PCB:MPU:ASS'Y	1	X/X	37	4	

**Change:** The MPU board now includes the functions of the Interface board for the VC-20.

**Note:**

- Because of this, the I/F board is not needed when the VC-20 is installed.
- The new Interface Kit for the VC-20 contains the harness only (it previously contained the harness + interface board).

**Reason:** To improve serviceability

**See ATTACHMENT PROCEDURE below.**

Model: TT3

Date: 12-Feb-14

No.: RC274005

**ATTACHMENT PROCEDURE (VC-20)**

1. Remove the rear cover.

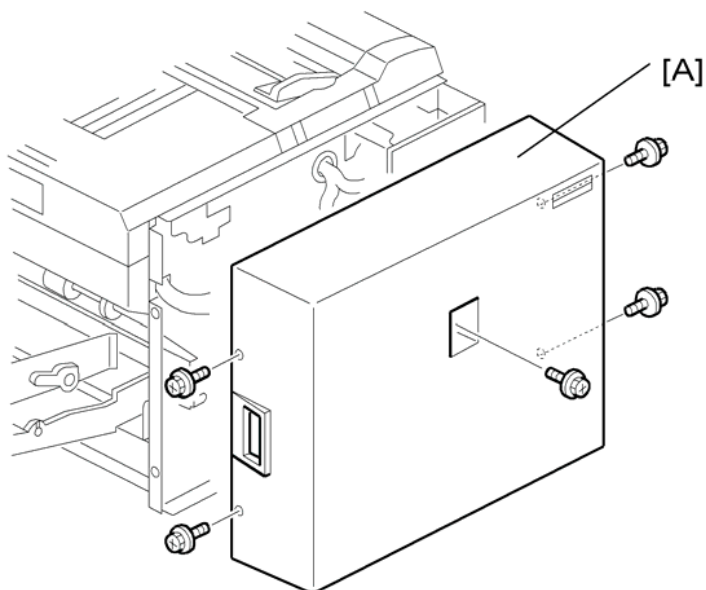

C274R920.WMF

2. Attach the controller to the side of the machine (see diagram below).
3. Connect the VC-20 and MPU board (CN108).

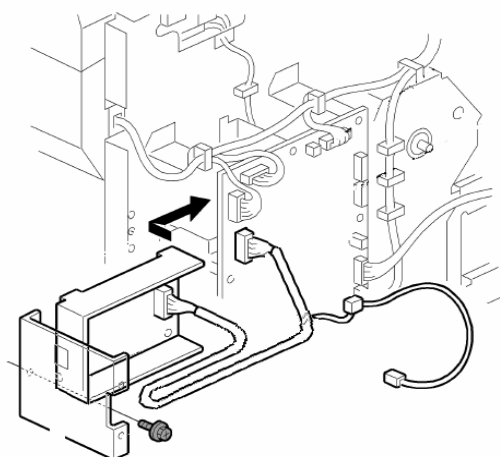



Model: TT3

Date: 12-Feb-14

No.: RC274005

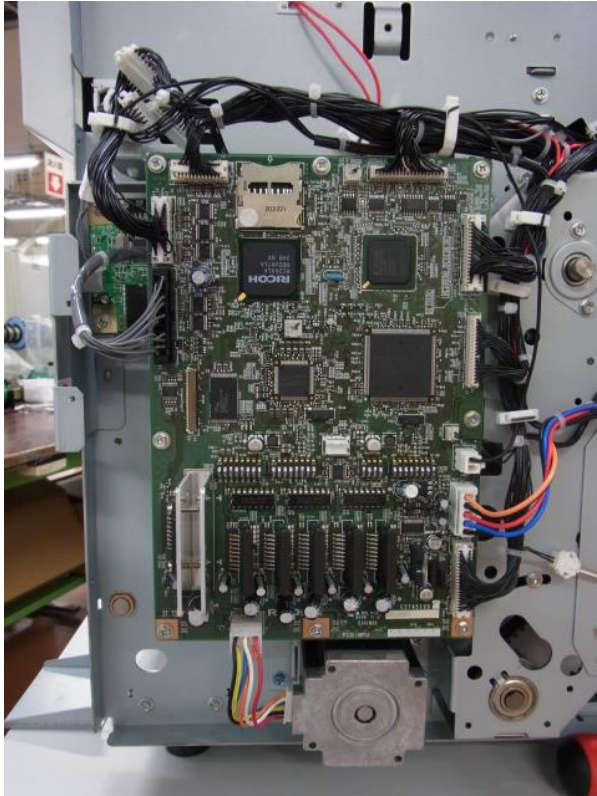
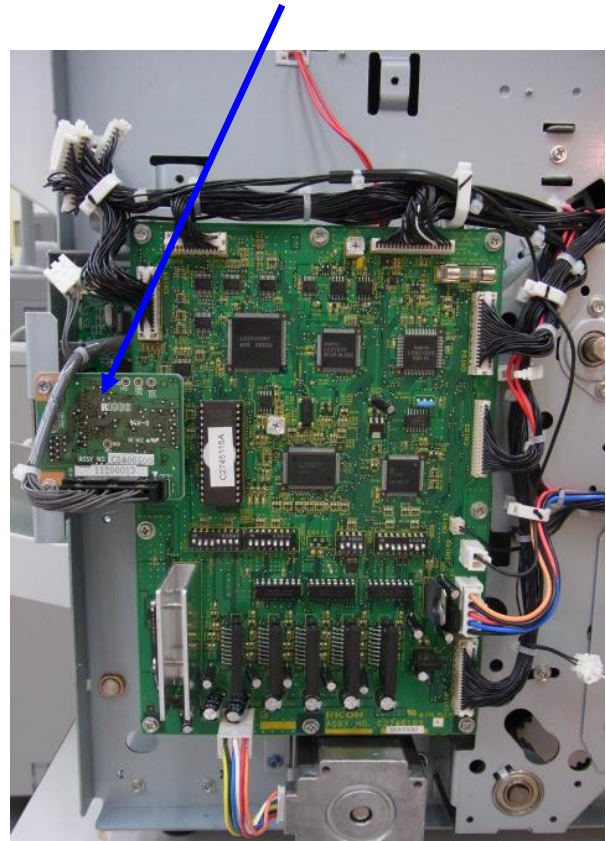
**NEW MPU board (no interface board)****Old MPU board (with interface board)**

Model: TT3		Date: 22-Mar-17	No.: RC274006
Subject: Addition of the new CHN only model TT3		Prepared by: A. Ishida	
From: 1st Tech Service Sect., MFP/P Tech Service Dept.			
Classification:	<input type="checkbox"/> Troubleshooting <input type="checkbox"/> Mechanical <input type="checkbox"/> Paper path <input type="checkbox"/> Product Safety	<input type="checkbox"/> Part information <input type="checkbox"/> Electrical <input type="checkbox"/> Transmit/receive <input type="checkbox"/> Other (     )	<input type="checkbox"/> Action required <input checked="" type="checkbox"/> Service manual revision <input type="checkbox"/> Retrofit information <input checked="" type="checkbox"/> Tier 2

**This bulletin announces the information unique to the new China only model: TT3 (C274-21, -61).**

Model name: DD 2433 c / CP 6203 c

### Changes

- EDP code
- Model name
- Operation panel color (See below.)
- There are no improvements made to the specifications.

The panel color is black.

