

Model: TT3		Date: 22-Dec-09	No.: RC274003
Subject: Additional new model for TT3		Prepared by: M. Kumagai	
From: 1st Overseas Tech Support Sec., 1st PQM Dept.			
Classification:	<input type="checkbox"/> Troubleshooting <input type="checkbox"/> Mechanical <input type="checkbox"/> Paper path <input type="checkbox"/> Product Safety	<input checked="" type="checkbox"/> Part information <input type="checkbox"/> Electrical <input type="checkbox"/> Transmit/receive <input type="checkbox"/> Other (     )	<input type="checkbox"/> Action required <input checked="" type="checkbox"/> Service manual revision <input type="checkbox"/> Retrofit information <input checked="" type="checkbox"/> Tier 2

This RTB contains the service manual and parts catalog information unique to the new model TT3 (C274-70, 71)

## Service manual changes

### Overall information

#### Essential differences from the predecessor model (TT3) service manual

**NOTE:** If there are no changes, we simply marked "None" in the corresponding remarks column.

#### Main Chapters

Section	Item	Remarks
1	Product Information	Guidance for Those Who are Familiar with Predecessor Product was added.
2	Installation	None
3	Preventive Maintenance	None
4	Replacement and Adjustment	Cover and board was changed
5	System Maintenance Reference	None
6	Troubleshooting	None

#### Appendices

Section	Item	Remarks
1	Appendix: Specifications	Auto shut-off was added
2	Appendix: Maintenance Table	None
3	Appendix: Service Call Condition	New SC was added
4	Appendix: Electrical Component Defects	New DIP switch for MPU was added
5	Appendix: SP Mode Tables	New SP was added

Model: TT3	Date: 22-Dec-09	No.: RC274003
------------	-----------------	---------------

## Main Chapters

### 1. Product Information

#### Guidance for Those Who are Familiar with Predecessor Product

##### Different Points from Predecessor Products

Item	Predecessor Model	New Model
Auto shut-off mechanism	No	Yes
Auto shut-off timing	No	5 minutes
Main switch location	On the PSU board	Separate

**Note:** Auto shut-off timing is controlled by a DIP switch on the MPU board.

Refer to the replacement and adjustment section for details of the auto shut-off setting.

### 4. Replacement and Adjustment

#### Covers and Board

##### MPU

##### Changes:

1. One connector (circled in the diagram below) was added.
2. DIP SW 104 for auto shut-off setting was added.

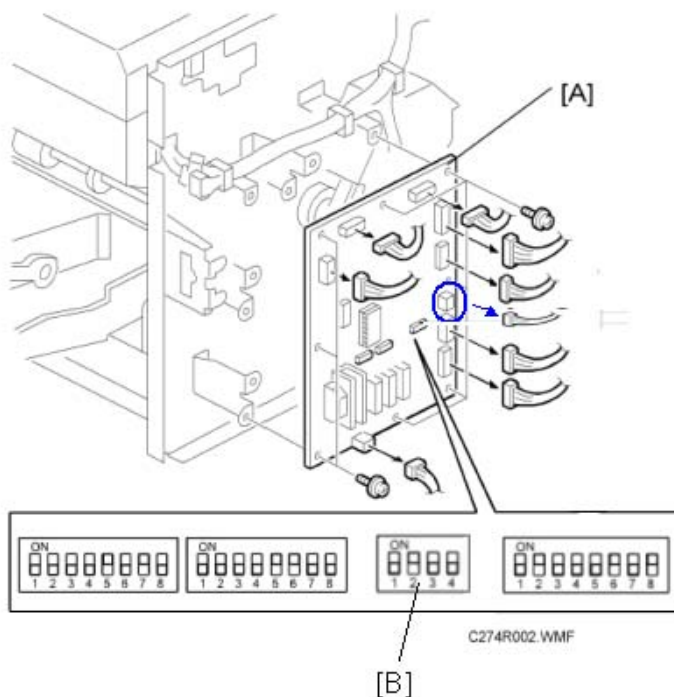

[A] MPU (Screw x 8, Connector x 9)

Model: TT3

Date: 22-Dec-09

No.: RC274003

**Important:** The default auto shut-off setting of a brand new MPU board is OFF.

So when you replace the MPU board, you must set **DIP SW 104** to the same setting as the MPU board that you removed.

If the customer wishes to change the auto shut-off timing, change the DIP SW setting (refer to the following chart).

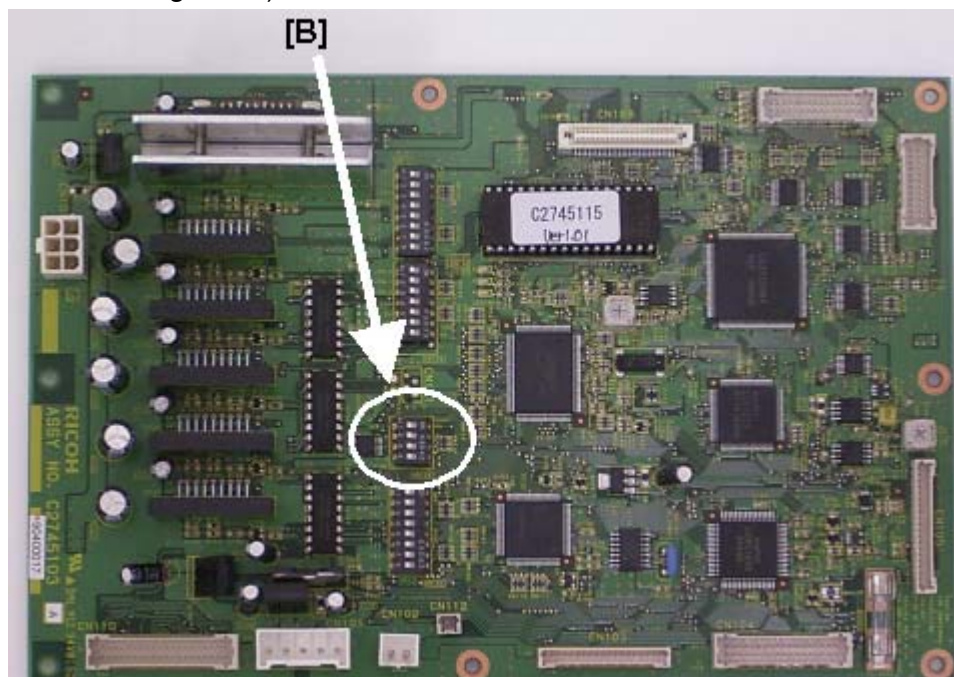

[B]: DIP SW 104

## DIP SW 104 setting and auto shut-off timing

Auto shut-off timing	DIP SW 104 setting
OFF	<div> <div>ON</div> <div>OFF</div> <div>1</div> <div>2</div> <div>3</div> <div>4</div> </div>
3 minutes	<div> <div>ON</div> <div>OFF</div> <div>1</div> <div>2</div> <div>3</div> <div>4</div> </div>
5 minutes	<div> <div>ON</div> <div>OFF</div> <div>1</div> <div>2</div> <div>3</div> <div>4</div> </div>
15 minutes	<div> <div>ON</div> <div>OFF</div> <div>1</div> <div>2</div> <div>3</div> <div>4</div> </div>

Model: TT3	Date: 22-Dec-09	No.: RC274003
------------	-----------------	---------------

Auto shut-off timing	DIP SW 104 setting
30 minutes	

## Default settings

C274-70 / C274-71: 5 minutes

---

**PSU**

---

**Changed:** One connector was added (circled in blue in the diagram).

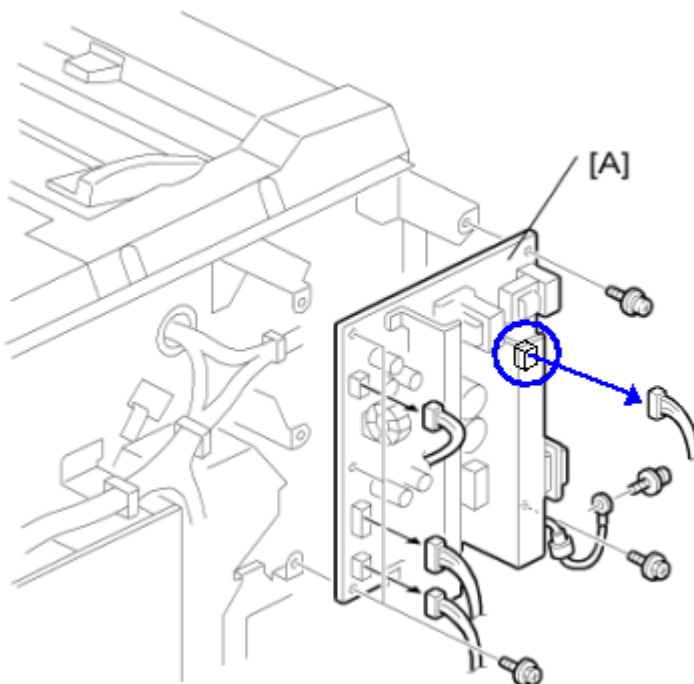

[A] PSU (Screw x 6, Connector x 4)

---

**Appendices**
**1. Specifications**

---

**Main Frame**

---

Auto shut-off timing	Default : 5 minutes (C274-70 / C274-71)  Setting change: OFF / 3 minutes / 5 minutes / 15 minutes / 30 minutes
----------------------	---

Model: TT3

Date: 22-Dec-09

No.: RC274003

### 3. Service Call Condition

#### SC Tables

No.	Symptom	Possible cause
E-61	<u>Auto shut-off solenoid error</u> Main switch does not turn off within 6.0 seconds after the auto shut-off solenoid signal turned ON.	Auto shut-off solenoid Auto shut-off solenoid connector PCB

### 4. Electrical Component Defects

#### DIP Switches

##### MPU

DIPSW No.	Bit No.	Name	Settings
104	1 to 4	Auto shut-off timing setting	(Refer to Replacement and Adjustment – Cover and board– MPU)

### 5. SP Mode Tables

#### SP Tables

##### Input Mode

No.	Name	Note
1-95	DIPSW 104	Display the auto shut-off timing on the LCD (minutes)

##### Output Mode

No.	Name	Function
2-16	Auto shut-off solenoid	

Model: TT3

Date: 22-Dec-09

No.: RC274003

## Parts catalog changes

### 1. Exterior

Sec	Page	Index	Parts No.	Description	Q'ty
	7	11	C2741306	COVER:REAR	1
	7	21	C2741345	SHEET:EMBLEM:RIC:CHN	1
	7	21	C2751355	SHEET:EMBLEM:GES:CHN	1

### 16. Electrical and Drive Section

Sec	Page	Index	Parts No.	Description	Q'ty
	37	4	C2745103	PCB:MPU:ASS'Y	1
	37	5	C2745115	EPROM:PRINTED CIRCUIT BOARD:MPU	1
	37	34*	A2505725	ROCKER SWITCH	1
	37	35*	C2745613	BRACKET:MAIN SWITCH	1
	37	36*	11050487	HARNESS CLAMP	1
	37	37*	C2745202	HARNESS:MAIN SWITCH:ASS'Y	1
	37	38*	C2745201	HARNESS:MOTOR:ASS'Y	1

\* New Index

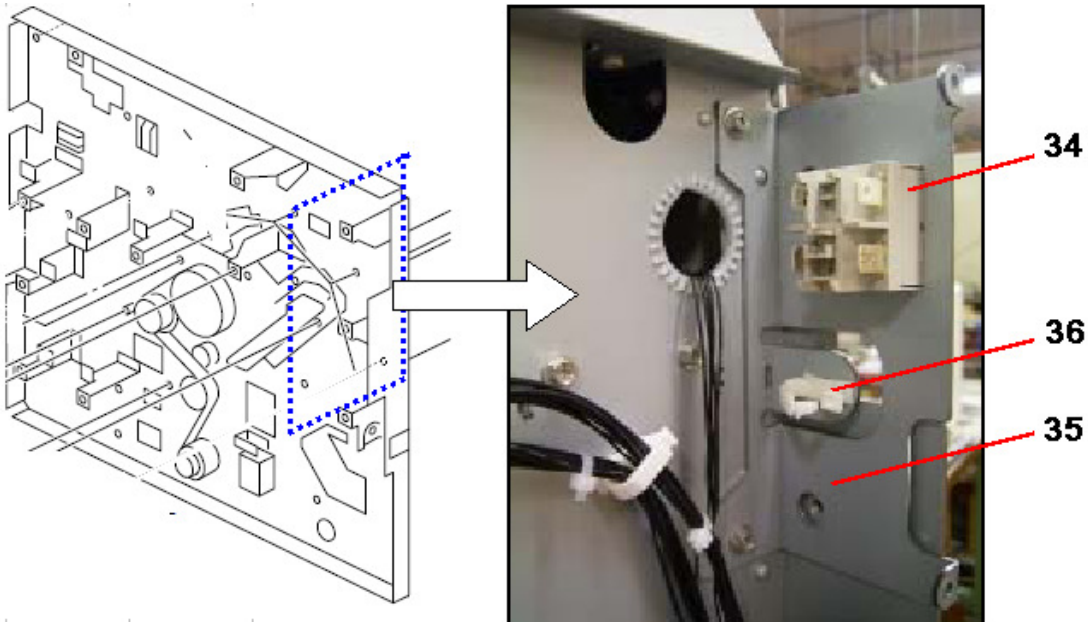

Model: TT3

Date: 22-Dec-09

No.: RC274003

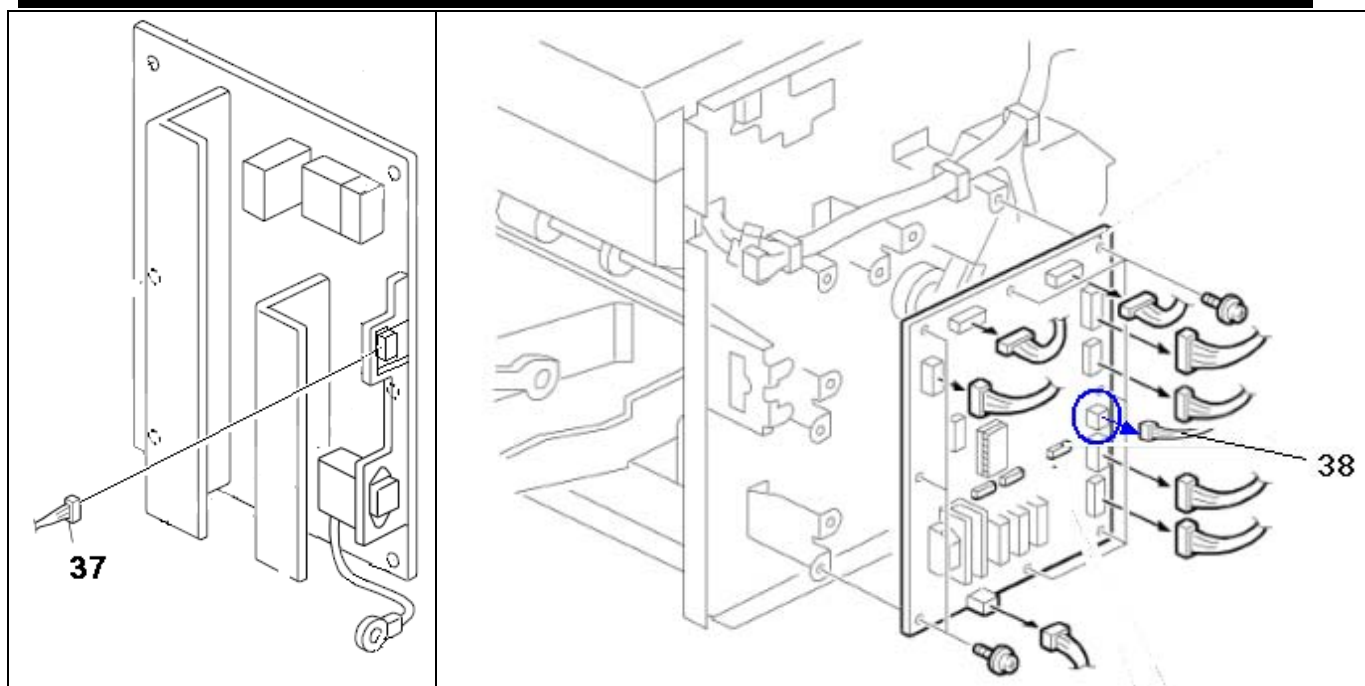

## 20. Decals And Documents

Sec	Page	Index	Parts No.	Description	Q'ty
	37	7	C2741345	SHEET:EMBLEM:RIC:CHN	1
	37	7	C2741355	SHEET:EMBLEM:GES:CHN	1