

Reissued:25-Jun-13

Model: EM-D2	Date: 07-May-13	No.: RC280002a
--------------	-----------------	----------------

RTB Reissue

The items in ***bold italics*** have been corrected.

Subject: Firmware Release Note: ECU		Prepared by: K. Yamamoto	
From: 2nd Tech Service Sect., MFP/Printer Tech Service Dept.			
Classification:	<input type="checkbox"/> Troubleshooting	<input type="checkbox"/> Part information	<input type="checkbox"/> Action required
	<input type="checkbox"/> Mechanical	<input type="checkbox"/> Electrical	<input type="checkbox"/> Service manual revision
	<input type="checkbox"/> Paper path	<input type="checkbox"/> Transmit/receive	<input type="checkbox"/> Retrofit information
	<input type="checkbox"/> Product Safety	<input checked="" type="checkbox"/> Other (Firmware)	<input checked="" type="checkbox"/> Tier 2

This RTB has been issued to announce the firmware release information for the **ECU**.

Version	Program No.	Effective Date	Availability of RFU
1.04	C2805116B	June 2013 production	Not available
1.03	C2805116A	1st Mass production	Not available

Note: Definition of Availability of RFU via @Remote

“Available” The firmware can be updated via RFU or SD card.

“Not available”: The firmware can only be updated via SD card.

Version	Modified Points or Symptom Corrected																																																
1.04	<p><i>Other changes:</i></p> <p><i>The following SP modes were added.</i></p> <p><i>SP6-96-1: Displays the detection results of original length sensors 1 and 2.</i> <i>SP6-96-2~10: Displays the detection results of the width sensors.</i> <i>SP6-96-11: Adjusts the timing for turning the lamp ON when detecting the size of the original</i></p> <table><tr><th>SP6-96</th><th>Name</th><th>Default</th><th>Range</th></tr><tr><td>1</td><td>APS Operation Check</td><td>-</td><td>ON/OFF</td></tr><tr><td>2</td><td>Scan Size Detect Value (S1 R)</td><td>0</td><td>0~255 (digit)</td></tr><tr><td>3</td><td>Scan Size Detect Value (S1 G)</td><td>0</td><td>0~255 (digit)</td></tr><tr><td>4</td><td>Scan Size Detect Value (S1 B)</td><td>0</td><td>0~255 (digit)</td></tr><tr><td>5</td><td>Scan Size Detect Value (S2 R)</td><td>0</td><td>0~255 (digit)</td></tr><tr><td>6</td><td>Scan Size Detect Value (S2 G)</td><td>0</td><td>0~255 (digit)</td></tr><tr><td>7</td><td>Scan Size Detect Value (S2 B)</td><td>0</td><td>0~255 (digit)</td></tr><tr><td>8</td><td>Scan Size Detect Value (S3 R)</td><td>0</td><td>0~255 (digit)</td></tr><tr><td>9</td><td>Scan Size Detect Value (S3 G)</td><td>0</td><td>0~255 (digit)</td></tr><tr><td>10</td><td>Scan Size Detect Value (S3 B)</td><td>0</td><td>0~255 (digit)</td></tr><tr><td>11</td><td>Lamp ON:Delay Time</td><td>40</td><td>0~200 (msec)</td></tr></table>	SP6-96	Name	Default	Range	1	APS Operation Check	-	ON/OFF	2	Scan Size Detect Value (S1 R)	0	0~255 (digit)	3	Scan Size Detect Value (S1 G)	0	0~255 (digit)	4	Scan Size Detect Value (S1 B)	0	0~255 (digit)	5	Scan Size Detect Value (S2 R)	0	0~255 (digit)	6	Scan Size Detect Value (S2 G)	0	0~255 (digit)	7	Scan Size Detect Value (S2 B)	0	0~255 (digit)	8	Scan Size Detect Value (S3 R)	0	0~255 (digit)	9	Scan Size Detect Value (S3 G)	0	0~255 (digit)	10	Scan Size Detect Value (S3 B)	0	0~255 (digit)	11	Lamp ON:Delay Time	40	0~200 (msec)
SP6-96	Name	Default	Range																																														
1	APS Operation Check	-	ON/OFF																																														
2	Scan Size Detect Value (S1 R)	0	0~255 (digit)																																														
3	Scan Size Detect Value (S1 G)	0	0~255 (digit)																																														
4	Scan Size Detect Value (S1 B)	0	0~255 (digit)																																														
5	Scan Size Detect Value (S2 R)	0	0~255 (digit)																																														
6	Scan Size Detect Value (S2 G)	0	0~255 (digit)																																														
7	Scan Size Detect Value (S2 B)	0	0~255 (digit)																																														
8	Scan Size Detect Value (S3 R)	0	0~255 (digit)																																														
9	Scan Size Detect Value (S3 G)	0	0~255 (digit)																																														
10	Scan Size Detect Value (S3 B)	0	0~255 (digit)																																														
11	Lamp ON:Delay Time	40	0~200 (msec)																																														
1.03	1st Mass production																																																

Model: EM-D2	Date: 07-May-13	No.: RC280003
---------------------	-----------------	---------------

Subject: Firmware Release Note: LCDC		Prepared by: K. Yamamoto	
From: 2nd Tech Service Sect., MFP/Printer Tech Service Dept.			
Classification:	<input type="checkbox"/> Troubleshooting	<input type="checkbox"/> Part information	<input type="checkbox"/> Action required
	<input type="checkbox"/> Mechanical	<input type="checkbox"/> Electrical	<input type="checkbox"/> Service manual revision
	<input type="checkbox"/> Paper path	<input type="checkbox"/> Transmit/receive	<input type="checkbox"/> Retrofit information
	<input type="checkbox"/> Product Safety	<input checked="" type="checkbox"/> Other (Firmware)	<input checked="" type="checkbox"/> Tier 2

This RTB has been issued to announce the firmware release information for the **LCDC**.

Version	Program No.	Effective Date	Availability of RFU
1.00	USA C2805165 EUR C2805167	1st Mass production	Not available

Note: Definition of Availability of RFU via @Remote

“Available” The firmware can be updated via RFU or SD card.

“Not available”: The firmware can only be updated via SD card.

Version	Modified Points or Symptom Corrected
1.00	1st Mass production

Model: EM-D2	Date: 07-May-13	No.: RC280004
---------------------	-----------------	---------------

Subject: Firmware Release Note: LCDC(for language set)		Prepared by: K. Yamamoto	
From: 2nd Tech Service Sect., MFP/Printer Tech Service Dept.			
Classification:	<input type="checkbox"/> Troubleshooting	<input type="checkbox"/> Part information	<input type="checkbox"/> Action required
	<input type="checkbox"/> Mechanical	<input type="checkbox"/> Electrical	<input type="checkbox"/> Service manual revision
	<input type="checkbox"/> Paper path	<input type="checkbox"/> Transmit/receive	<input type="checkbox"/> Retrofit information
	<input type="checkbox"/> Product Safety	<input checked="" type="checkbox"/> Other (Firmware)	<input checked="" type="checkbox"/> Tier 2

This RTB has been issued to announce the firmware release information for the **LCDC(for language set)**.

Version	Program No.	Effective Date	Availability of RFU
1.00	C2805400	1st Mass production	Not available

Note: Definition of Availability of RFU via @Remote

“Available” The firmware can be updated via RFU or SD card.

“Not available”: The firmware can only be updated via SD card.

Version	Modified Points or Symptom Corrected
1.00	1st Mass production

Model: P EM-D2		Date: 9-Mar-15	No.: RC280005
Subject: Parts information(ADF GRIP)		Prepared by: A.Ishida	
From: 2nd Tech Service Sect., MFP/P Tech Service Dept.			
Classification:	<input type="checkbox"/> Troubleshooting <input type="checkbox"/> Mechanical <input type="checkbox"/> Paper path <input type="checkbox"/> Product Safety	<input checked="" type="checkbox"/> Part information <input type="checkbox"/> Electrical <input type="checkbox"/> Transmit/receive <input type="checkbox"/> Other ()	<input type="checkbox"/> Action required <input type="checkbox"/> Service manual revision <input type="checkbox"/> Retrofit information <input type="checkbox"/> Tier 2

Change: The following assembly was added.

Reason: To increase the adhesive strength between the handgrip and DF base.

Note: The handgrip can be damaged when the DF is opened/closed repeatedly.

Model	Old part number	New part number	Description	Q'ty	Int	Page	Index	Note
LHOTSE-D	-	D5781991	GRIP:PROTECT:ASS'Y	0-1	-	3	27	

Important: Attach the grip to the base using double-sided tape.

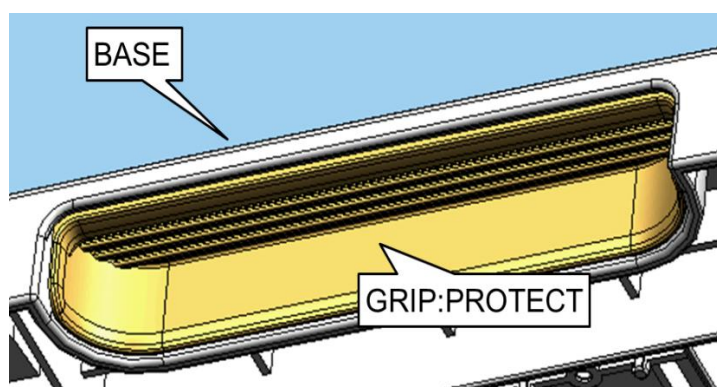
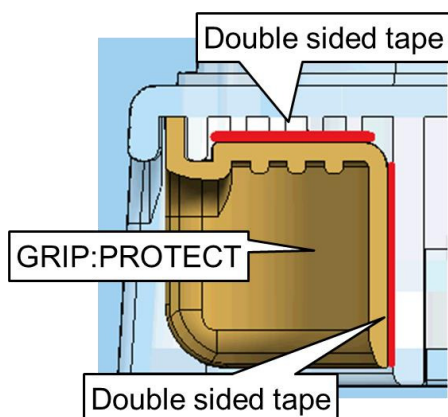

Model: EM-D2		Date: 7-Dec-17	No.: RC280006	
Subject: Parts Catlog Correction: Paper Delivery Table			Prepared by: K. Moriizumi	
From: 1st Tech Service Sect., MFP/P Tech Service Dept.				
Classification:	<input type="checkbox"/> Troubleshooting	<input checked="" type="checkbox"/> Part information	<input type="checkbox"/> Action required	
	<input type="checkbox"/> Mechanical	<input type="checkbox"/> Electrical	<input type="checkbox"/> Service manual revision	
	<input type="checkbox"/> Paper path	<input type="checkbox"/> Transmit/receive	<input type="checkbox"/> Retrofit information	
	<input type="checkbox"/> Product Safety	<input type="checkbox"/> Other ()	<input type="checkbox"/> Tier 2	<input type="checkbox"/> Tier 0.5

Old part number	New part number	Description	Q'ty	Int	Page	Index
	C2804201	PAPER EXIT SUB-UNIT:PLATE:EXP:ASS'Y	1	-	81	36

Change/Reason:

Parts Catalog correction.

40. Paper Delivery Table

