

Quick Installation Guide



1 Where to Put the Printer

The printer's location should be carefully chosen because environmental conditions greatly affect its performance.

⚠ Warning

- The supplied power cord is for use with this equipment only. Do not use with other appliances. Doing so may result in fire, electric shock, or injury.
- Connect the machine to the power source specified in "Safety Information" and do not use any other power sources. Connect the power cord directly to a wall outlet and do not use an extension cord. Power sources not specified in "Safety Information" and extension cords are electric shock or fire hazards.
- Power cords that are damaged, broken, modified, trapped under heavy objects, pulled hard, or bent severely are electric shock and fire hazards.

⚠ Caution

- Make sure the room where you are using the machine is well ventilated and spacious. Good ventilation is especially important when the machine is used heavily.
- Place the machine on a strong and level surface. Otherwise, it might fall and injure someone.
- Keep the machine in an area that is within optimum environmental conditions.
Operating the machine in an environment that is outside the recommended ranges of humidity and temperature can cause an electrical fire hazard. Keep the area around the socket free of dust. Accumulated dust can become an electrical fire hazard.
- It is dangerous to handle the plug with wet hands. Doing this may result in receiving an electric shock.

★ Important

Do not use the printer in the following environments:

- Areas exposed to direct sunlight or strong light
- Dusty areas
- Areas with corrosive gases
- Areas that are excessively cold, hot, or humid
- Locations near air conditioners or humidifiers
- Locations near other electronic equipment
- Locations subject to frequent strong vibration

❖ Space Required for Installation

Leave enough space around the printer to operate it freely. The recommended minimum space is as follows:

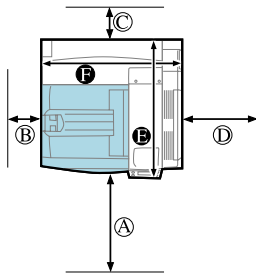

- Ⓐ: 75.0 cm (29.6 inches) or more
- Ⓑ: 10.0 cm (4.0 inches) or more
- Ⓒ: 10.0 cm (4.0 inches) or more
- Ⓓ: 55.0 cm (21.7 inches) or more
- Ⓔ: 67.0 cm (26.4 inches) or more
- Ⓕ: 67.0 cm (26.4 inches) or more

Read this manual carefully before you use the product and keep it handy for future reference. For safe and correct use, please be sure to read "Safety Information" before using the machine.

❖ Optimum Environmental Conditions

Permissible and recommended temperature and humidity ranges are as follows:

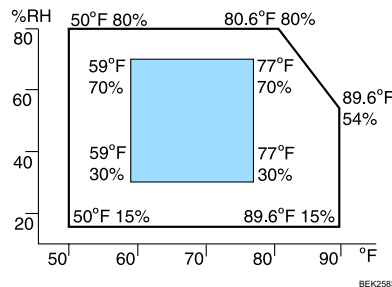
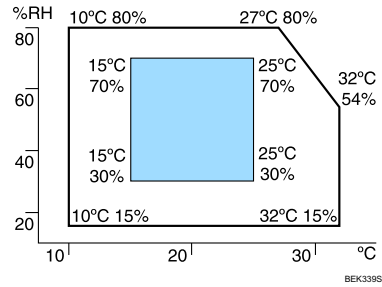

- White area: Permissible Range
- Gray area: Recommended Range

⬇ Note

- The machine must be level within 5 mm, 0.2" from both front to rear and left to right.
- To avoid possible build-up of ozone, locate this machine in a large well ventilated room that has an air turnover of more than 30 m³/hr/person.
- When you use this machine for a long time in a confined space without good ventilation, you may detect a smell. To keep the workplace comfortable, we recommend that you keep it well ventilated.

❖ Power Source

Connect the power cord to a power source of the following specification:

- 220 - 240 V, 50/60 Hz, 7 A or more

2 Checking the Included Items

Verify the items that come with the printer. Make sure that you find all the items listed below.

Note that some of the items are in tray 1. Pull out tray 1, and remove the red tag on the tray. Take out the items inside tray 1.

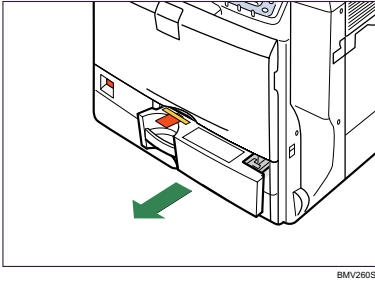

❖ Manuals and CD-ROMs

- ☒ Quick Installation Guide (This manual)
- ☐ CD-ROM "Printer Drivers and Utilities"
- ☐ Safety Information
- ☐ CD-ROM "Manuals"
- ☐ CD-ROM "Document Management Utility"
- ☐ Ferrite Core

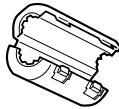

- ☐ Power cord
- ☐ Toner: Black (K), Magenta (M), Cyan (C), Yellow (Y)

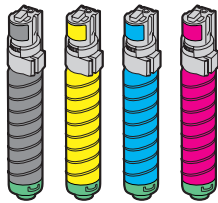

- ☐ Colour Calibration Sample Sheet

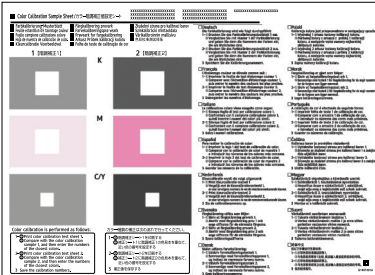

- ☐ Additional Documentation
- ☐ Paper Feed Unit Labels

⬇ Note

- This package does not include an interface cable. Purchase one as necessary to connect to the printer.

3 Unpacking

To protect it from shock and vibration during transit, this printer comes packaged in cushioning foam and secured with tape. Remove these protective materials after bringing the machine to where it will be installed.

⚠ Caution

- When moving the machine, hold the handles at both sides, and then lift the printer slowly. Lifting it carelessly or dropping it may cause an injury.
- Place no objects on the front or inner cover.

1 Pull out the handle from the right side of the printer.

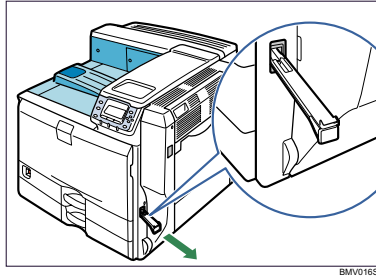

2 Lift the printer with four people by using the handles on both sides of the printer.

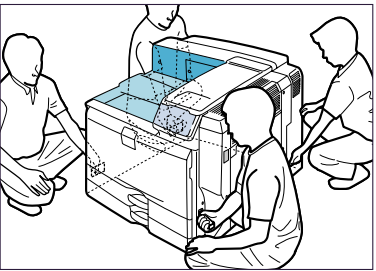

- Leave the tape in place while moving the printer.
- Lower the printer slowly and carefully to prevent trapping your hands.

3 Return the handle you pulled out from the printer to its original position.

4 Remove the tape indicated by the arrow. Do not remove the four strips of tape attached to the front cover.

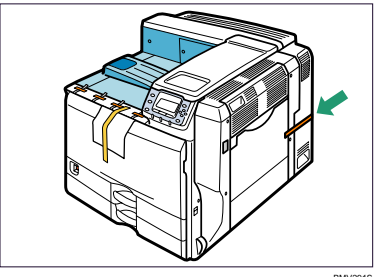

5 Push up the lever on the right side, and open the printer's right cover carefully.

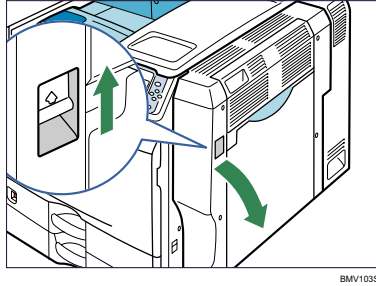

6 Close the right cover firmly until it clicks.

7 Holding the left and right side grips, carefully open the front cover.

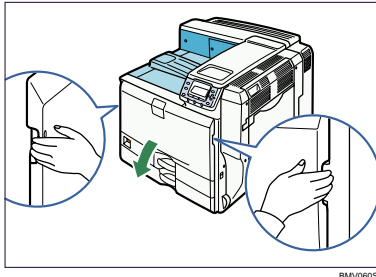

8 Turn the two green levers counterclockwise.

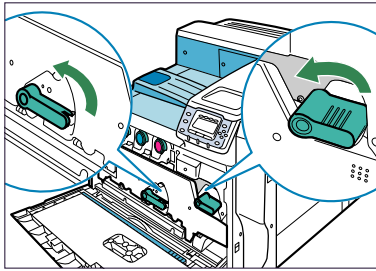

9 Pulling the handle, slowly open the inner cover.

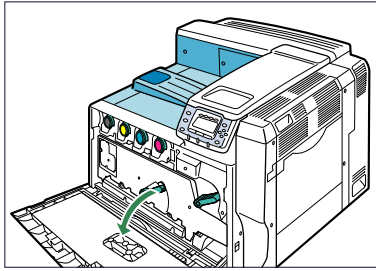

10 Remove the orange tapes from the printer.

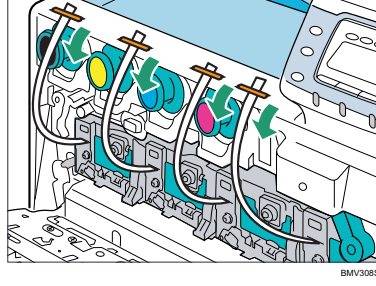

11 Pull out the tapes horizontally. Be sure to pull out all four strips of tape.

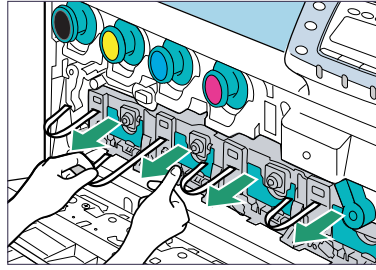

★ Important

- To avoid malfunctions, be sure to remove all four strips of tape from the photo conductor unit.
- Removed tape is dirty. Be careful not to let it touch your hands or clothes.

12 Pressing both sides, firmly close the inner cover.

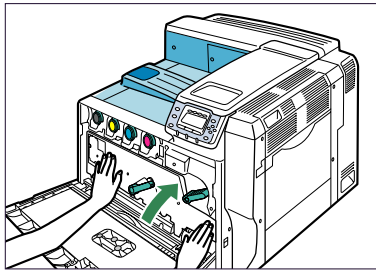

13 Turn the two green levers clockwise to lock the cover.

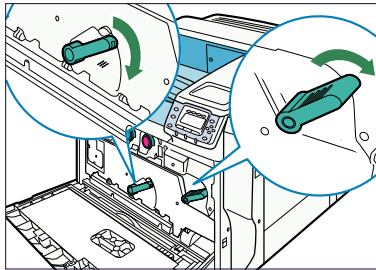

4 Installing the Toner

- Warning**
- Do not incinerate used toner or toner container. Toner dust might ignite when exposed to an open flame.
 - Dispose of used toner containers in accordance with local regulations.
 - Do not store toner, used toner, or toner containers in a place with an open flame. The toner might ignite and cause burns or a fire.

- Caution**
- Keep toner (used or unused) and the toner container out of reach of children.
 - If toner or used toner is inhaled, gargle with plenty of water and move into a fresh air environment. Consult a doctor if necessary.
 - Avoid getting toner on your clothes or skin when removing a paper jam or replacing toner. If your skin comes into contact with toner, wash the affected area thoroughly with soap and water.
 - If toner or used toner gets into your eyes, flush immediately with large amounts of water. Consult a doctor if necessary.
 - If toner or used toner is swallowed, dilute by drinking a large amount of water. Consult a doctor if necessary.
 - If toner gets on your clothing, wash with cold water. Hot water will set the toner into the fabric and may make removing the stain impossible.

- Important**
- When you first use this printer, use the toner packaged with the printer.

- Note**
- The number of pages that can be printed using the toner supplied with this printer is approximately 10,000 pages for black and 8,000 pages for cyan, magenta and yellow. (A4/Letter 5% test chart; 3 pages/job; Cyan, Magenta and Yellow: colour printing only.)
 - The actual number of printable pages varies depending on the image volume and density, number of pages to be printed at a time, paper type and paper size used, contents of print images, and environmental conditions such as temperature and humidity.
 - Two types of replacement toner are available to print a different volume of pages: 20,000 pages (black) and 15,000 pages (colour).
 - Toner is a consumable and is not covered by warranty. However, if there is a problem, contact the store where it was purchased.

1 Take the toner containers out of the box.

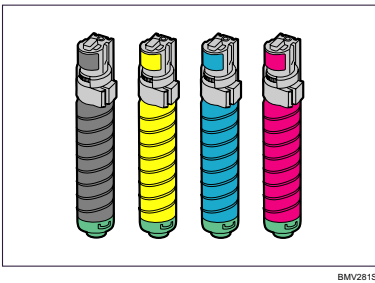

2 Shake the toner up and down five or six times.

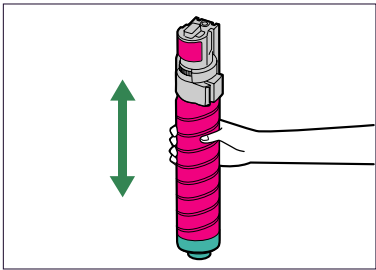

Even distribution of toner within the cartridge improves print quality.

3 With the label facing up, fully insert the magenta toner into place, keeping the container horizontal.

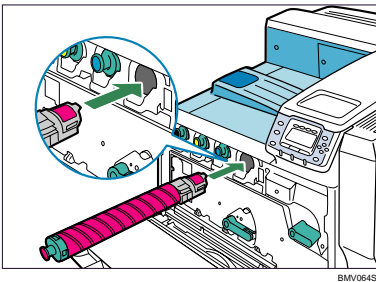

4 Use the same procedure to insert the remaining toner. From the right: magenta (M), cyan (C), yellow (Y) and black (K).

5 Close the front cover.

5 Loading Paper

- Caution**
- Do not pull out the paper tray forcefully. If you do, the tray might fall and cause an injury.

- Important**
- To avoid paper jams, make sure paper is not stacked higher than the upper limit mark inside the paper tray. Paper misfeeds might occur.
 - Do not mix different types of paper in the same paper tray.

1 Carefully pull out tray 1 until it stops.

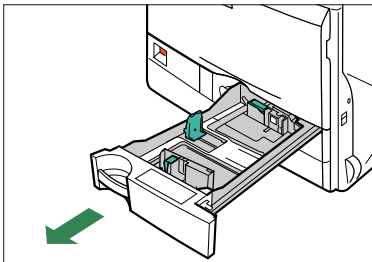

When printing using the bypass tray, do not pull out the paper tray.

2 Take the included items out of the tray.

3 Pinch the green clip on the end guide (1), and adjust it to A4 size (2).

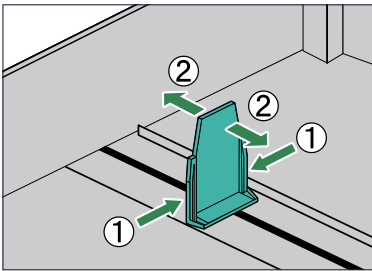

Confirm that there are no gaps between the paper and paper guides. If there are gaps, adjust the guides.

4 Align and load paper in the tray with the print side up.

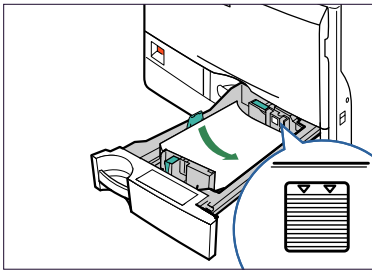

5 Push tray 1 carefully into the printer until it stops. If you push the tray forcefully, the paper guides might move.

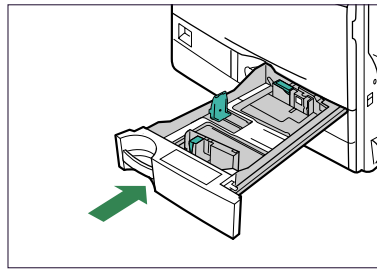

- Reference**
- For details about types of paper supported by this printer, see "Loading Paper", *Hardware Guide* (8).

6 Slide out the Paper-full detector. The printer automatically stops ejecting paper when the Paper-full detector detects that the standard output tray has become full.

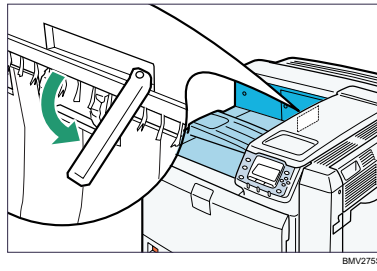

6 Turning the Power On

- Warning**
- It is dangerous to handle the plug with wet hands. Doing this may result in receiving an electric shock.

1 Make sure the power switch is set to "Off".

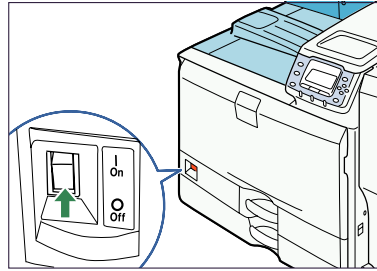

2 Plug the power cord into the rear of the printer.

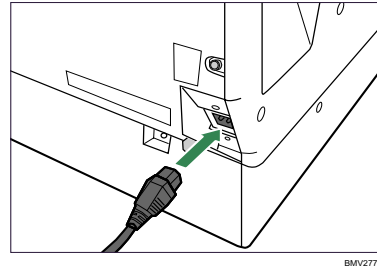

- Important**
- Make sure the power cord is plugged securely into the wall outlet.
 - Turn the power switch off when plugging and unplugging the power plug.

3 Turn the power switch on.

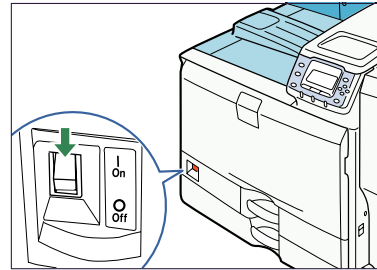

The power indicator on the control panel lights up.

- Note**
- Wait until "Ready" appears on the display panel.
 - The machine may make a noise while initializing. This noise does not indicate a malfunction.

- Important**
- Do not turn off the power switch until initializing is complete. Doing so results in malfunctions.

7 Selecting the Display Language

Displays are shown in the selected language. The language is set to English by default.

1 Press the [Menu] key.

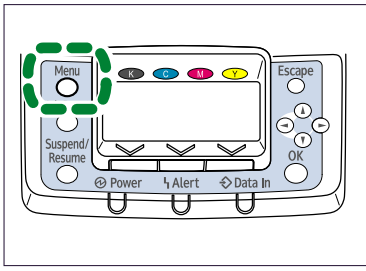

2 Press the [▼] or [▲] key to select [Language], and then press the [OK] key.

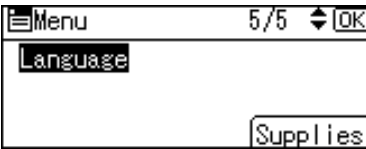

3 Press the [▼] or [▲] key to select the preferred language, and then press the [OK] key.

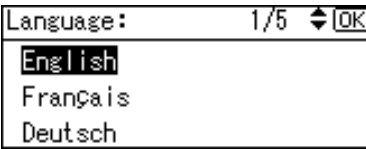

4 Press the [Menu] key to return to the initial screen.



8 Test Printing

Print a test print in order to verify that the printer is working normally. Test printing checks printer performance only; it does not test the connection to the computer.

1 Press the **[Menu]** key.

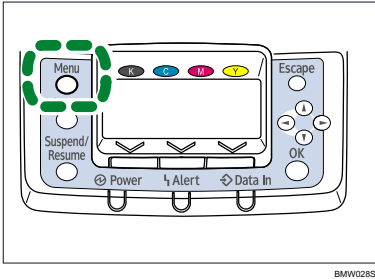

BMV0285

2 Press the **[▼]** or **[▲]** key to select **[List/Test Print]**, and then press the **[OK]** key.

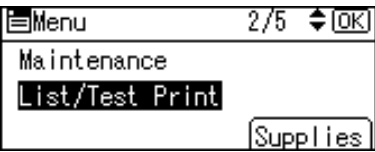

3 Press the **[▼]** or **[▲]** key to select **[Config. Page]**, and then press the **[OK]** key.

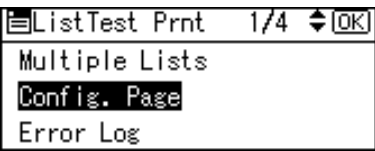

The configuration page will be printed. If printing is not normal, check if an error message appears on the display. If there is an error message, see "Troubleshooting", *Hardware Guide* (8).

4 Press the **[Menu]** key to return to the initial screen.

9 Network Connection

Prepare a hub and other network devices, and connect the Ethernet cable to the printer. Connect 10BASE-T or 100BASE-TX cable to the printer's Ethernet port.

Caution

- Properly shielded and grounded cables and connectors must be used for connections to a host computer (and/or peripheral) in order to meet emission limits.

Important

- The Ethernet cable must be an Unshielded Twisted Pair cable (UTP) or Shielded Twisted Pair cable (STP), and Category type 5 or more.
- An Ethernet cable is not supplied with this printer. Select your cable according to the network environment.

1 Attach the ferrite core supplied with this printer at the printer end of the Ethernet cable about 5 cm (2.5 inches) (1) from the connector, making a loop as shown.

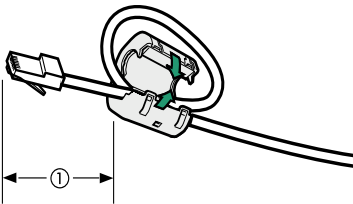

BBM0115

2 Connect the Ethernet cable to the Ethernet port that is located on the left side of the printer.

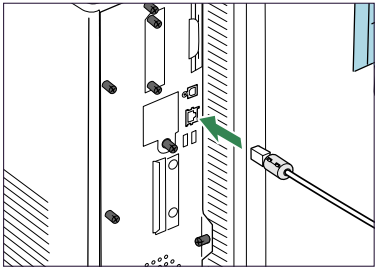

BMV1825

3 Connect the other end of the cable to the network, for example using a hub.

Reference

- For details about network environment settings, see *Software Guide* (8).

Reading the LED Lamps

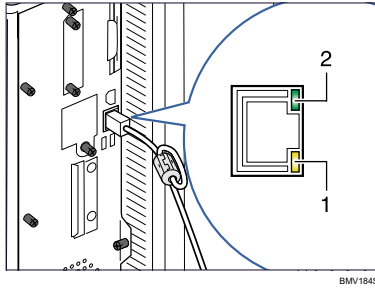

BMV1845

- Yellow: turns on when 100BASE-TX is in use. It turns off when 10BASE-T is in use.
- Green: turns on when the printer is properly connected to the network.

10 USB Connection

Caution

- Properly shielded and grounded cables and connectors must be used for connections to a host computer (and/or peripheral) in order to meet emission limits.

Important

- A USB cable is not supplied with this printer. Select your cable according to the computer.
- USB connection is possible under Windows 2000/XP/Vista, Windows Server 2003/2003 R2/2008, Mac OS 9, and Mac OS 10.3.3 or later.
- USB connection with Mac OS is only possible via the printer's USB port.

1 Connect the square-shaped connector of the USB cable to USB port B on the left side of the printer.

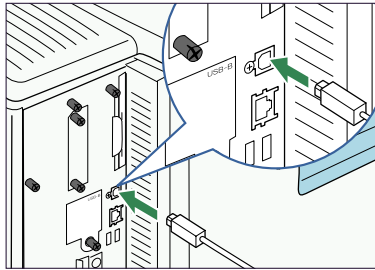

BMV1865

2 Connect the opposite end's flat connector to the desired device such as your computer's USB interface, or a USB hub.

11 Ethernet Configuration

Configure the following network settings according to the network environment using the control panel.

Caution

- Properly shielded and grounded cables and connectors must be used for connections to a host computer (and/or peripheral) in order to meet emission limits.

Important

- After configuring the network setting, configure the security settings.
- We recommend that you first make the following setting.
 - Installing the server certificate
 - Enabling SSL
 - Changing the administrator's user name and password using Web Image Monitor. For details, see "Setting Up the Machine", *Security Guide* (8).
- The following table shows the control panel settings and their default values. These items appear in the [Host Interface] menu.

Setting Name	Default
Machine IPv4 Address	
DHCP	On
IPv4 Address	11.22.33.44
Subnet Mask	0.0.0.0
Gateway Address	0.0.0.0
IPv6 Stateless Setting	
Stateless set	Active
IPsec	Inactive
Effective Protocol	
IPv4	Active
IPv6	Inactive
SMB	Active
AppleTalk	Inactive
Ethernet Speed	Auto Select
IEEE802.1X Auth.(Ethernet)	Inactive
Restr.IEEE802.1X Auth.Def.	-
LAN Type	Ethernet

Note

- If DHCP is in use on your network, the IP address, subnet mask, and gateway address are all set automatically.
- If the printer is already placed on a TCP/IP-capable environment, you can also use SmartDeviceMonitor for Admin or a Web browser to configure IP address-related settings.

❖ Receiving an IP Address Automatically (DHCP)

Important

- When [DHCP] is selected, you cannot configure settings for the following items:
 - IP Address
 - Subnet Mask
 - Gateway Address
- Consult your network administrator for information about configuring network settings.

1 Press the **[Menu]** key.

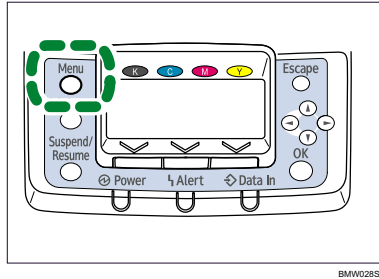

BMV0285

2 Press the **[▼]** or **[▲]** key to select **[Host Interface]**, and then press the **[OK]** key.

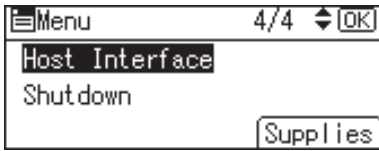

3 Press the **[▼]** or **[▲]** key to select **[Network]**, and then press the **[OK]** key.

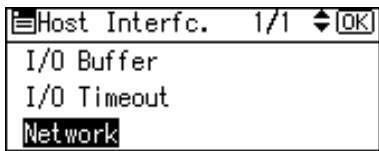

4 Press the **[▼]** or **[▲]** key to select **[Machine IPv4 Address]**, and then press the **[OK]** key.

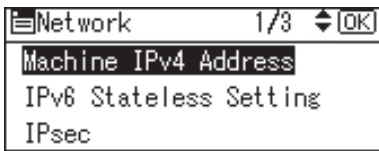

5 Press the **[▼]** or **[▲]** key to select **[Auto-Obtain (DHCP)]**, and then press the **[OK]** key.

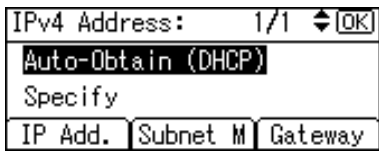

The printer will automatically receive an IP address. To check the detected addresses, press the following:

- [IP Add.] : IP address
- [Subnet M] : Subnet mask
- [Gateway] : Gateway address

6 Press the **[Menu]** key to return to the initial screen.

7 Print a configuration page to confirm the settings.

Reference

- For details about printing the configuration page, see "Test Printing".

❖ Specifying an IP Address (No DHCP)

1 Press the **[Menu]** key.

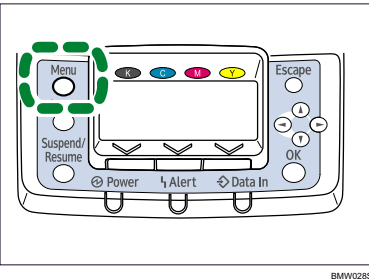

BMV0285

2 Press the **[▼]** or **[▲]** key to select **[Host Interface]**, and then press the **[OK]** key.

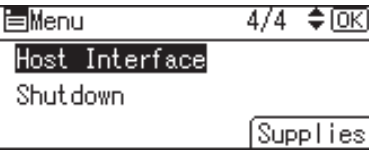

3 Press the **[▼]** or **[▲]** key to select **[Network]**, and then press the **[OK]** key.

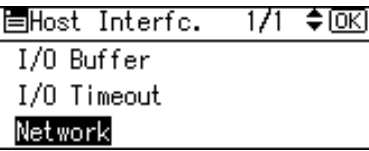

4 Press the **[▼]** or **[▲]** key to select **[Effective Protocol]**, and then press the **[OK]** key.

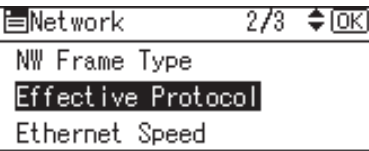

5 Press the **[▼]** or **[▲]** key to select the appropriate network protocol, and then press the **[OK]** key.

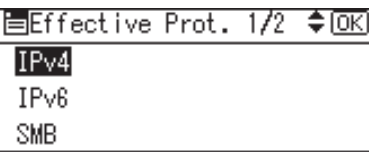

6 Press the [▼] or [▲] key to select [Active] or [Inactive], and then press the [OK] key.

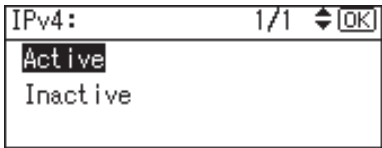

Set other protocols you need to set in the same way.

- Select [Inactive] for unused protocols.
- Enable IPv4 to use the pure IPv4 environment of NetWare 5/5.1, NetWare 6/6.5.

7 Press the [Escape] key until the screen returns to the [Network] menu.

8 If your network uses IPv4, assign the IPv4 address to the printer. Press the [▼] or [▲] key to select [Machine IPv4 Address], and then press the [OK] key.

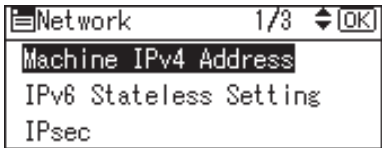

To get the IP address for the printer, contact your network administrator.

9 To specify the IPv4 Address, press [IP Add].

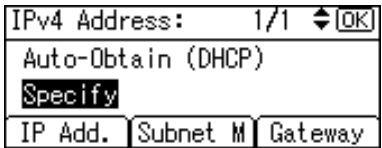

If you use IPv4, also assign the subnet mask and gateway address. To assign these, press [Subnet M] or [Gateway].

10 Press the [▼] or [▲] to enter the address, and then press the [OK] key.

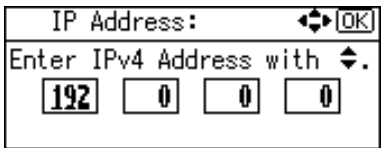

Press the [▼] or [▲] key to enter the left-most entry field of the address. After entering the left field, press the [OK] key, and then you can enter the next field. After completing all fields, press the [OK] key. Use the same method to assign the subnet mask and gateway address.

- Change the IP address from “11.22.33.44” to an IP address supported by your network.

11 Press the [▼] or [▲] key to select [Specify], and then press the [OK] key.

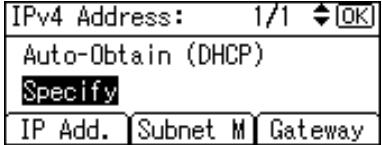

★ Important

- If you do not select [Specify] in this step, the address you set will not be saved.

12 Press the [Menu] key to return to the initial screen.

13 Print a configuration page to confirm the settings.

📖 Reference

- For details about printing the configuration page, see “Test Printing”.

12 Installing The Printer Driver

You can install the printer drivers and software easily from the CD-ROM labeled “Printer Drivers and Utilities”.

Click [Quick Install] in the window of the CD-ROM to install PCL and RPCS printer drivers. To install the PostScript 3 printer driver, click the [PostScript 3 Printer Driver] button. For more information about the PostScript 3 printer driver, see *Software Guide* (📖) on the CD-ROM labeled “Manuals”.

When the TCP/IP protocol is used, SmartDevice Monitor for Client will be installed as well.

When using the TCP/IP protocol, confirm the following:

- ☐ The printer is connected to the network with Category 5 interface cable.
- ☐ The TCP/IP protocol is enabled.
- ☐ The IP address is set for the printer and the computer.

★ Important

- To install printer drivers under Windows 2000/XP Professional/Vista or Windows Server 2003/2003 R2/2008, you must have an account that has the Manage Printers permission. Log on as an administrator.
- For details about installing the printer drivers, see “Preparing for Printing”, *Software Guide* (📖).
- When using this printer under parallel connection, only the printer drivers are installed and not SmartDeviceMonitor for Client.
- Quick Install is not available when using this printer under USB connection. If you connect the printer using USB, see *Software Guide* (📖).

1 Quit all applications currently running.

2 Insert the CD-ROM into the CD-ROM drive.
The installer starts.
Auto Run may not work under certain operating system settings. In this case, launch “Setup.exe” in the CD-ROM root directory.

3 Select an interface language, and then click [OK].

The default interface language is English.

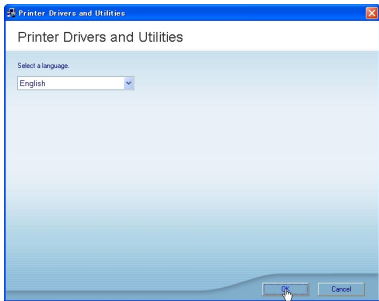

4 Click [Quick Install].
The software license agreement appears in the [License Agreement] dialog box.

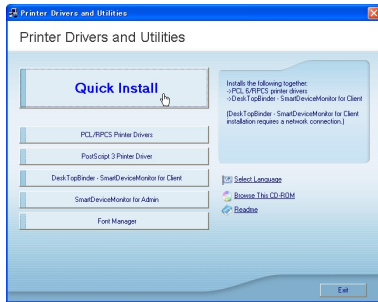

This is an example when English is selected in step 3.

5 After reading through all of the contents, click [I accept the agreement] to agree with the License Agreement, and then click [Next >].

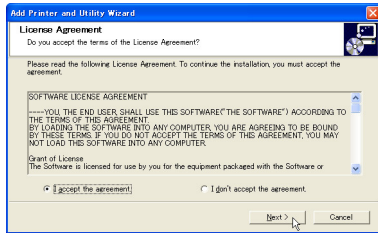

6 Select the printer model you want to install in the “Select Printer” dialog box.

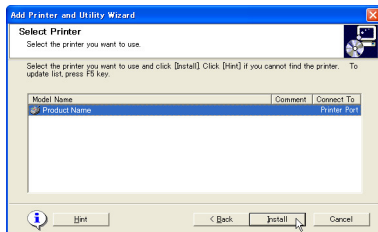

📌 Note

- For a network connection via TCP/IP, select the printer whose IP address is displayed in [Connect to]. In this case, SmartDeviceMonitor for Client will also be installed.
- For parallel connection, select the printer whose printer port is displayed in [Connect to].

7 Click [Install].
The following display appears while installing the printer driver.

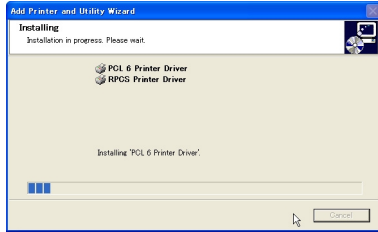

8 Click [Finish].
A message about restarting the computer may appear. Restart the computer to complete installation.



9 Click [Exit] in the first dialog box of the installer, and then take out the CD-ROM.

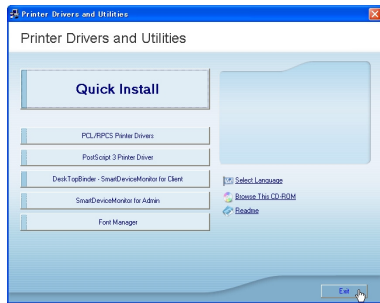

📌 Note

- To stop installation of the selected software, click [Cancel] before installation is complete.

📖 Reference

- Quick Install is not available for parallel connection unless bidirectional communication between the printer and computer is enabled. For details about bidirectional communication between the printer and computer, see “Printing with Parallel Connection”, *Software Guide* (📖).