

Model: Model SY-P1	Date: 07-Jan-08	No.: RG186001a
--------------------	-----------------	----------------

Subject: Firmware Release Note: Engine Firmware (Package)		Prepared by: Yuji Mimura	
From: 1st Tech. Support Sec. Service Support Dept.			
Classification:	<input type="checkbox"/> Troubleshooting <input type="checkbox"/> Mechanical <input type="checkbox"/> Paper path <input checked="" type="checkbox"/> Other ()	<input type="checkbox"/> Part information <input type="checkbox"/> Electrical <input type="checkbox"/> Transmit/receive	<input type="checkbox"/> Action required <input type="checkbox"/> Service manual revision <input type="checkbox"/> Retrofit information

This RTB has been issued to announce the firmware release information for the Engine Firmware (Package)

Version	Program No.	Effective Date
1.50.00.77	G1868630A	July 2007 production
1.50.00.72	G1888630A	1st Mass production.

Version	Modified Points or Symptom Corrected
1.50.00.77	1. Modified a fuser reference temperature in Ready mode for Blue Angel. 2. Output format of fonts does not align with table in form printing. (GFPR#RA07040001) 3. Abnormal printing of ruled lines in form printing. (GFPR#RA7060001)
1.50.00.72	1st Mass production.

Reissued: 21-Jan-09

Model: Model SY-P1	Date: 07-Jan-08	No.: RG186001c
--------------------	-----------------	----------------

RTB Reissue

The items in bold italics have been corrected.

Subject: Firmware Release Note: Engine Firmware (Package)		Prepared by: K. Hamada	
From: 2nd Tech. Support Sec. Service Support Dept.			
Classification:	<input type="checkbox"/> Troubleshooting <input type="checkbox"/> Mechanical <input type="checkbox"/> Paper path <input type="checkbox"/> Product Safety	<input type="checkbox"/> Part information <input type="checkbox"/> Electrical <input type="checkbox"/> Transmit/receive <input checked="" type="checkbox"/> Other ()	<input type="checkbox"/> Action required <input type="checkbox"/> Service manual revision <input type="checkbox"/> Retrofit information <input checked="" type="checkbox"/> Tier 2

This RTB has been issued to announce the firmware release information for the Engine Firmware (Package)

Version	Program No.	Effective Date
1.50.00.99	G1868630C	August 2008 production
1.50.00.92	G1868630B	January 2008 production
1.50.00.77	G1868630A	July 2007 production
1.50.00.72	G1888630A	1st Mass production.

Version	Modified Points or Symptom Corrected
1.50.00.99	Symptom corrected: 1. The status of the operation returns to "Ready" but this is not reflected in SDM for Admin's Device properties 2. Fixed the paper source problem that occurs if the option tray initialization is delayed. 3. Fixed the red question mark display in Power Save mode 4. Fixed a problem in which the Default Type of PS driver and default Type of PCL driver work differently. 5. Delay to inform the status of the option tray.
1.50.00.92	Minor bug correction.
1.50.00.77	1. Modified a fuser reference temperature in Ready mode for Blue Angel. 2. Output format of fonts does not align with table in form printing. (GFPR#RA07040001) 3. Abnormal printing of ruled lines in form printing. (GFPR#RA7060001)
1.50.00.72	1st Mass production.

Reissued: 21-Jul-09

Model: Model SY-P1	Date: 07-Jan-08	No.: RG186001d
--------------------	-----------------	----------------

RTB Reissue

The items in bold italics have been corrected.

Subject: Firmware Release Note: Engine Firmware (Package)		Prepared by: K. Hamada	
From: 2nd Tech. Support Sec. Service Support Dept.			
Classification:	<input type="checkbox"/> Troubleshooting	<input type="checkbox"/> Part information	<input type="checkbox"/> Action required
	<input type="checkbox"/> Mechanical	<input type="checkbox"/> Electrical	<input type="checkbox"/> Service manual revision
	<input type="checkbox"/> Paper path	<input type="checkbox"/> Transmit/receive	<input type="checkbox"/> Retrofit information
	<input type="checkbox"/> Product Safety	<input checked="" type="checkbox"/> Other ()	<input checked="" type="checkbox"/> Tier 2

This RTB has been issued to announce the firmware release information for the Engine Firmware (Package)

Version	Program No.	Effective Date
1.50.00.114	G1868630D	May 2009 production
1.50.00.99	G1868630C	August 2008 production
1.50.00.92	G1868630B	January 2008 production
1.50.00.77	G1868630A	July 2007 production
1.50.00.72	G1888630A	1st Mass production.

Version	Modified Points or Symptom Corrected
1.50.00.114	Engine: 1.00.37 → 1.00.39 1. To tighten controls on fusing error conditions when the machine is warming up or ready. 2. Improve text density by LD power in dark mode. PCL5e: 5.67 → 5.92 1. Minor bug correction PCL6: 5.72 → 5.93 1. Minor bug correction PS: 1.85 → 1.94 1. Minor bug correction Network: 3.02.04 → 3.02.05 1. Minor bug correction
1.50.00.99	Symptom corrected: 1. The status of the operation returns to "Ready" but this is not reflected in SDM for Admin's Device properties 2. Fixed paper source problem in case option tray's delayed initialization. 3. Fixed Red question mark display in status of Power Save mode 4. Fixed a problem that Default Type of PS driver and default Type of PCL driver works differently. 5. Delay time to inform status of option tray.
1.50.00.92	Minor bug correction.

Reissued: 21-Jul-09

Model: Model SY-P1		Date: 07-Jan-08	No.: RG186001d
Version	Modified Points or Symptom Corrected		
1.50.00.77	<ol style="list-style-type: none">1. Modified a fuser reference temperature in Ready mode for Blue Angel.2. Output format of fonts does not align with table in form printing. (GFPR#RA07040001)3. Abnormal printing of ruled lines in form printing. (GFPR#RA7060001)		
1.50.00.72	1st Mass production.		

Model: SY-P1		Date: 17-Aug-09	No.: RG186002
Subject: Parts information		Prepared by: K. Hamada	
From: 2nd Tech Support Sec. Service Support Dept.			
Classification:	<input type="checkbox"/> Troubleshooting <input type="checkbox"/> Mechanical <input type="checkbox"/> Paper path <input type="checkbox"/> Product Safety	<input checked="" type="checkbox"/> Part information <input type="checkbox"/> Electrical <input type="checkbox"/> Transmit/receive <input type="checkbox"/> Other ()	<input type="checkbox"/> Action required <input type="checkbox"/> Service manual revision <input type="checkbox"/> Retrofit information <input type="checkbox"/> Tier 2

Old part number	New part number	Description	Q'ty	Int	Page	Index	Note
	G1868755	Decal	0-1	-	5	8	

Change/Reason: The above part is added.

G1868755:



Reissued: 13-Oct-09

Model: Model SY-P1	Date: 07-Jan-08	No.: RG186001e
--------------------	-----------------	----------------

RTB Reissue

The items in bold italics have been corrected.

Subject: Firmware Release Note: Engine Firmware (Package)		Prepared by: K. Hamada	
From: 2nd Tech. Support Sec. Service Support Dept.			
Classification:	<input type="checkbox"/> Troubleshooting <input type="checkbox"/> Mechanical <input type="checkbox"/> Paper path <input type="checkbox"/> Product Safety	<input type="checkbox"/> Part information <input type="checkbox"/> Electrical <input type="checkbox"/> Transmit/receive <input checked="" type="checkbox"/> Other ()	<input type="checkbox"/> Action required <input type="checkbox"/> Service manual revision <input type="checkbox"/> Retrofit information <input checked="" type="checkbox"/> Tier 2

This RTB has been issued to announce the firmware release information for the Engine Firmware (Package)

Version	Program No.	Effective Date
<i>1.50.00.121</i>	<i>G1868630E</i>	<i>August 2009 production</i>
1.50.00.114	G1868630D	May 2009 production
1.50.00.99	G1868630C	August 2008 production
1.50.00.92	G1868630B	January 2008 production
1.50.00.77	G1868630A	July 2007 production
1.50.00.72	G1888630A	1st Mass production.

Version	Modified Points or Symptom Corrected
<i>1.50.00.121</i>	<i>Engine: 1.00.39 →1.00.43</i> <i>1.Minor bug correction.</i>
1.50.00.114	Engine: 1.00.37 →1.00.39 1. To tighten controls on fuser error condition when the machine is warming up or ready. 2. Improve text density by LD power in dark mode. PCL5e: 5.67 → 5.92 1. Minor bug correction PCL6: 5.72 → 5.93 1. Minor bug correction PS: 1.85 → 1.94 1. Minor bug correction Network: 3.02.04 → 3.02.05 1. Minor bug correction
1.50.00.99	Symptom corrected: 1. The status of the operation returns to "Ready" but this is not reflected in SDM for Admin's Device properties 2. Fixed paper source problem in case option tray's delayed initialization. 3. Fixed Red question mark display in status of Power Save mode 4. Fixed a problem that Default Type of PS driver and default Type of PCL driver works differently. 5. Delay time to inform status of option tray.

Reissued: 13-Oct-09

Model: Model SY-P1		Date: 07-Jan-08	No.: RG186001e
Version	Modified Points or Symptom Corrected		
1.50.00.92	Minor bug correction.		
1.50.00.77	<ol style="list-style-type: none">1. Modified a fuser reference temperature in Ready mode for Blue Angel.2. Output format of fonts does not align with table in form printing. (GFPR#RA07040001)3. Abnormal printing of ruled lines in form printing. (GFPR#RA7060001)		
1.50.00.72	1st Mass production.		

Model: SY-P1		Date: 16-Oct-09	No.: RG186003
Subject: added part		Prepared by: K. Hamada	
From: 2nd Tech Support Sec. Service Support Dept.			
Classification:	<input type="checkbox"/> Troubleshooting <input type="checkbox"/> Mechanical <input type="checkbox"/> Paper path <input type="checkbox"/> Product Safety	<input checked="" type="checkbox"/> Part information <input type="checkbox"/> Electrical <input type="checkbox"/> Transmit/receive <input type="checkbox"/> Other ()	<input type="checkbox"/> Action required <input type="checkbox"/> Service manual revision <input type="checkbox"/> Retrofit information <input type="checkbox"/> Tier 2

Old part number	New part number	Description	Q'ty	Int	Page	Index	Note
	G1861306	MEA_Unit-Exit	1	-	7	41	
	G1861360	Gear-Feed	1	-	9	98	
	G1861362	Spring_ETC_SEP	5		11	1-28	

Change: These parts in the table were added.

Reason: To meet requests received from the field.

G1861306: (The illustration below is on Page 6 in the parts catalog.)

3.Frame Assembly 1 (G186)

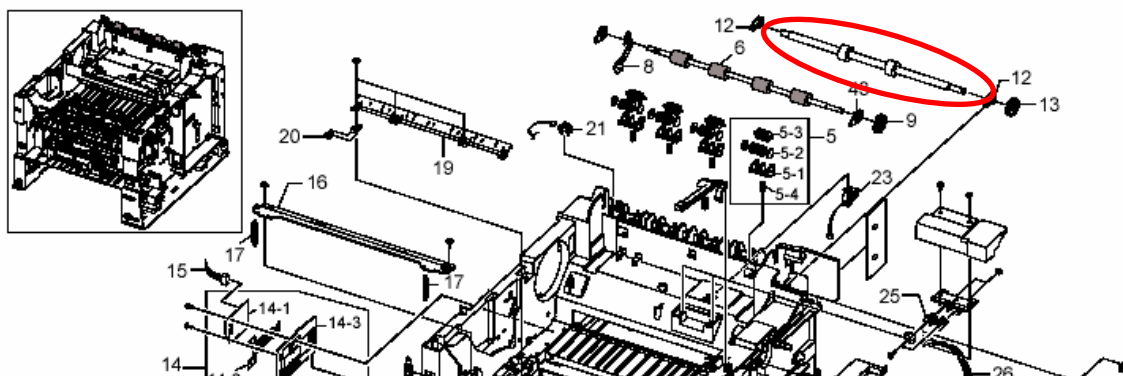

Model: SY-P1

Date: 16-Oct-09

No.: RG186003

G1861360: (The illustration below is from Page 8 in the parts catalog.)

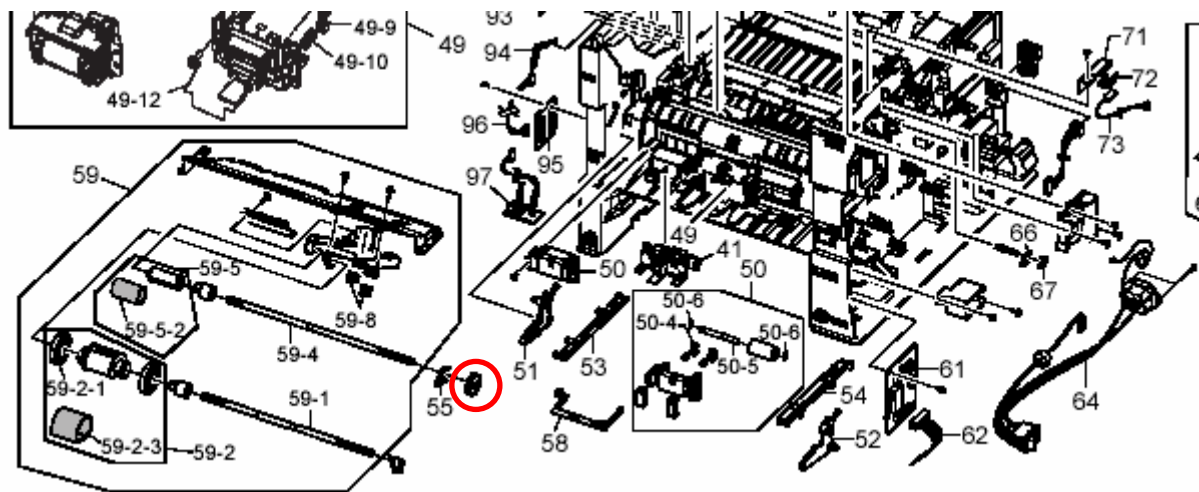

G1861362: (The illustration below is from Page 10 in the parts catalog.)

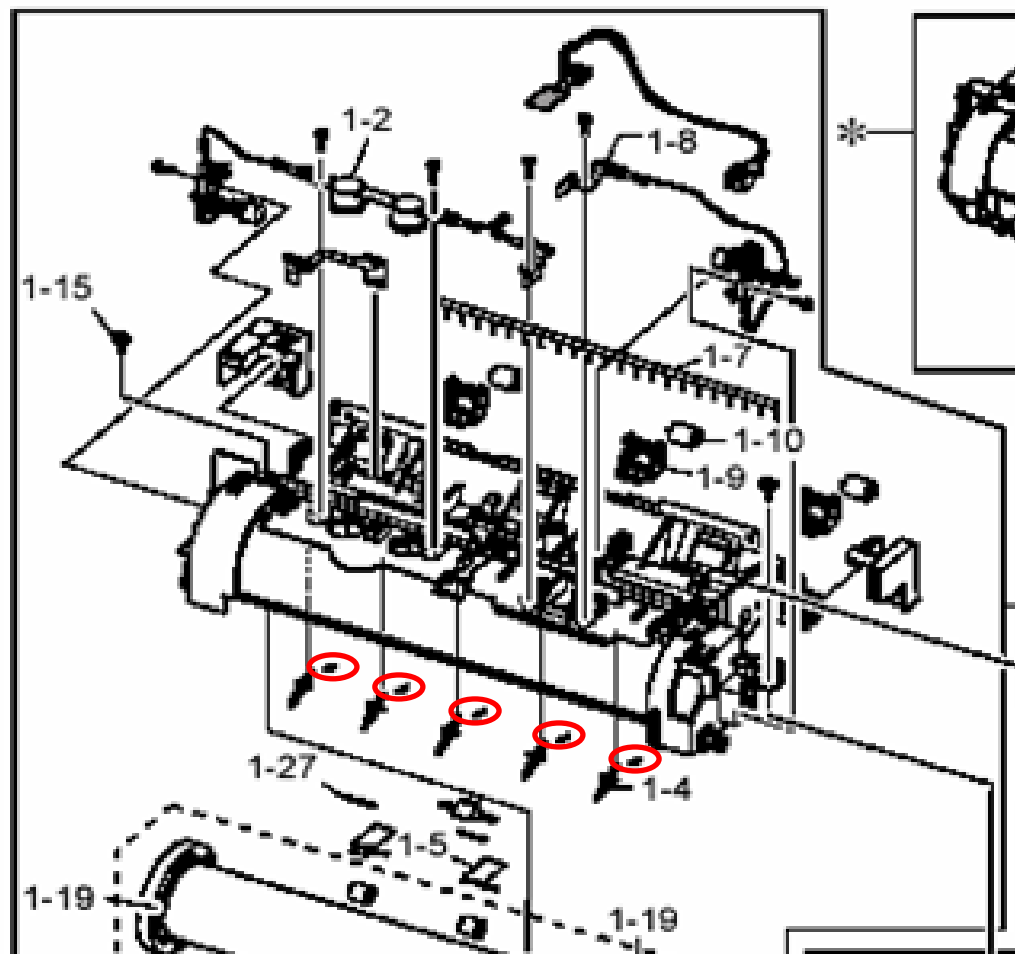

Model: SY-P1		Date: 10-Nov-09	No.: RG186004
Subject: Thermistor		Prepared by: K. Hamada	
From: 2nd Tech Support Sec. Service Support Dept.			
Classification:	<input type="checkbox"/> Troubleshooting <input type="checkbox"/> Mechanical <input type="checkbox"/> Paper path <input type="checkbox"/> Product Safety	<input checked="" type="checkbox"/> Part information <input type="checkbox"/> Electrical <input type="checkbox"/> Transmit/receive <input type="checkbox"/> Other ()	<input type="checkbox"/> Action required <input type="checkbox"/> Service manual revision <input type="checkbox"/> Retrofit information <input type="checkbox"/> Tier 2

Old part number	New part number	Description	Q'ty	Int	Page	Index	Note
	G1861363	Thermistor	0-1	-	10	1-8	
	G1861364	Electrode	0-1	-	10	1-6	

Change: These parts in the table were added.

Reason: To meet requests received from the field.

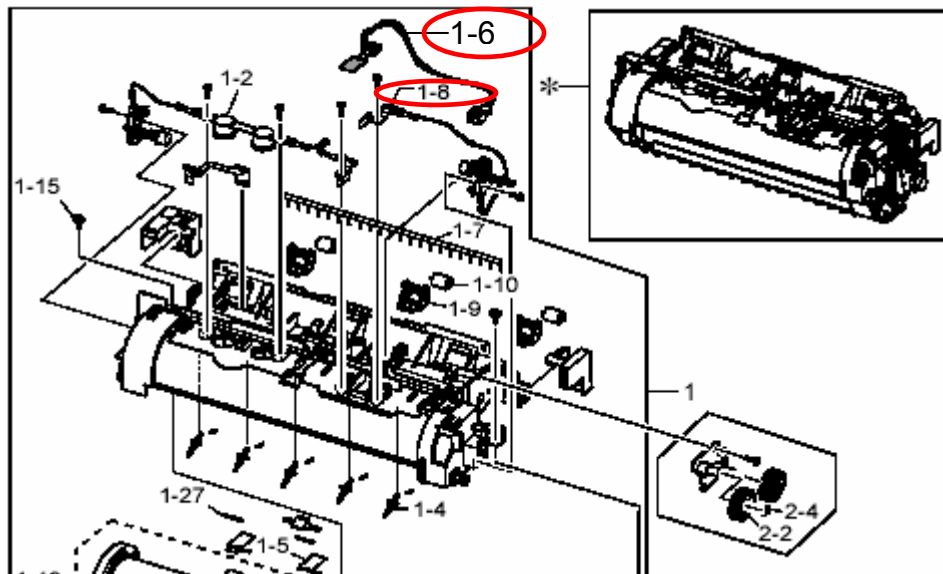

Model: SY-P1		Date: 30-Apr-10	No.: RG186005
Subject: Replacement of bushing for pressure roller		Prepared by: K. Hamada	
From: 1st Overseas Tech Support Sec., 1st PQM Dept.			
Classification:	<input checked="" type="checkbox"/> Troubleshooting <input type="checkbox"/> Mechanical <input type="checkbox"/> Paper path <input type="checkbox"/> Product Safety	<input type="checkbox"/> Part information <input type="checkbox"/> Electrical <input type="checkbox"/> Transmit/receive <input type="checkbox"/> Other ()	<input checked="" type="checkbox"/> Action required <input type="checkbox"/> Service manual revision <input type="checkbox"/> Retrofit information <input type="checkbox"/> Tier 2

SYMPTOM

Noise is generated after jammed paper is removed from the fusing unit.

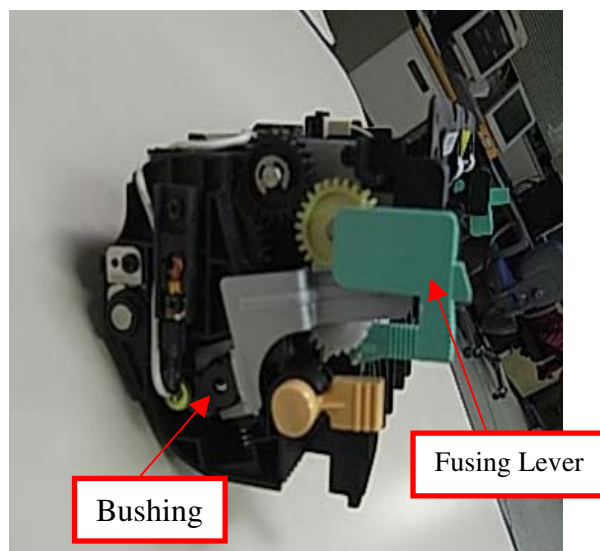
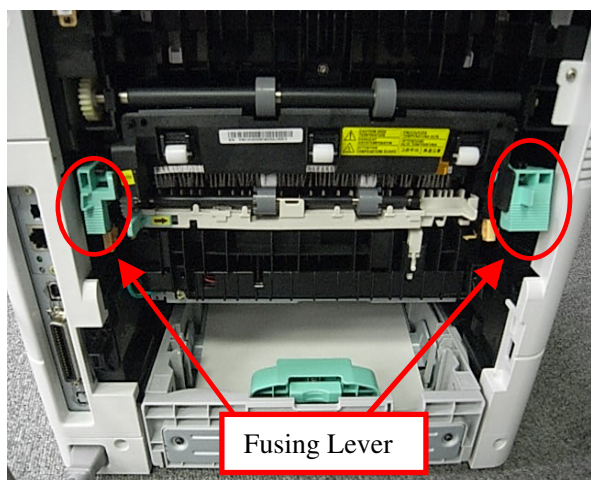

CAUSE

The vendor that produces the pressure roller bushing used the wrong material on the production line. As a result, the bushing breaks when the fusing lever is pushed upward to remove the jammed paper.

SOLUTION

If this symptom is reported on the affected units (see below), replace the bushing with the following part (replacement procedure below):

P/N G1869900 Bushing: Pressure roller

Note: This service part includes two bushings.

Important: The bushing has already been replaced on some affected units before they were shipped to the field. You **DO NOT** need to replace fusing units that are marked with a **blue dot** (see below).

Model: SY-P1

Date: 30-Apr-10

No.: RG186005

Affected units:

This issue affects the following Sy-P1 mainframes.

Model Name	Code	Serial Number
Sy-P1	G186-17	S2108500001 to S2108500600 S2108600001 to S2108600120
	G186-27	S2108520001 to S2108520240 S2108620001 to S2108620480

Important: Bushings have already been replaced on fusing units that are marked with a blue dot (see the photo). You DO NOT need to replace these units for this symptom.

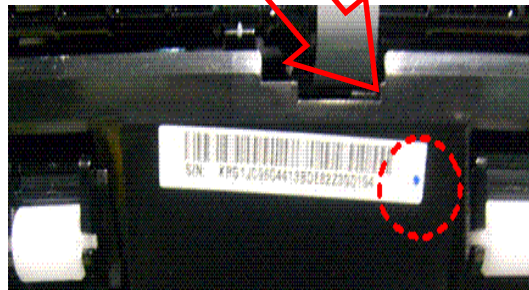
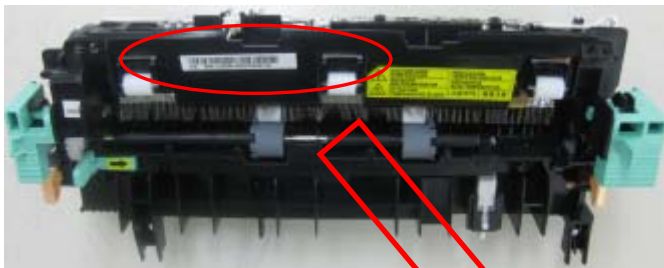

Model: SY-P1

Date: 30-Apr-10

No.: RG186005

Bushing Replacement Procedure

1. Remove the lower cover.

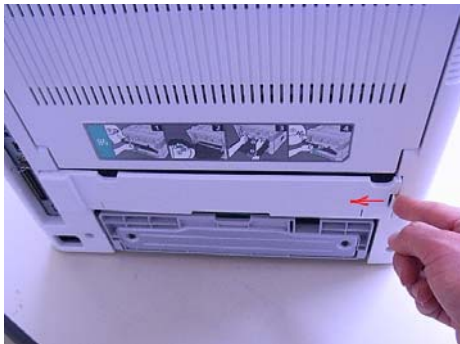

2. Open the rear cover



3. Remove the strip shown in the photo from the rear cover.



4. Pull the left side of the cover toward you.
5. Lift the right side of the cover and pull it toward you.

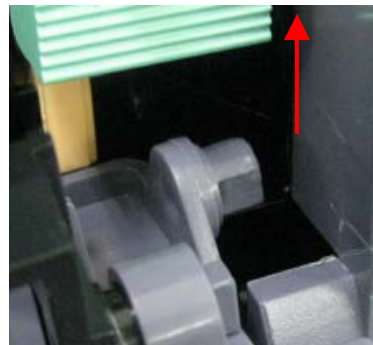
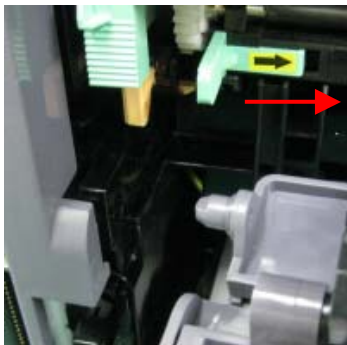
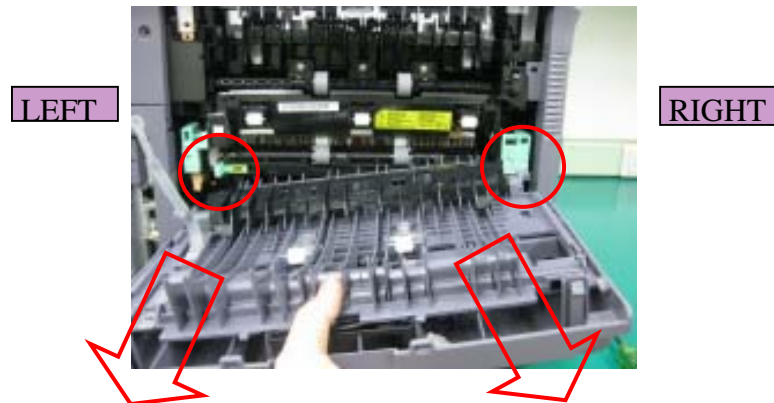

6. Remove the four screws shown from the fusing unit.



7. Pull down the two levers shown at the same time.

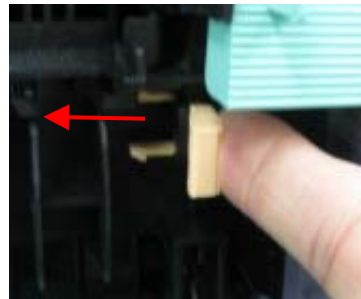
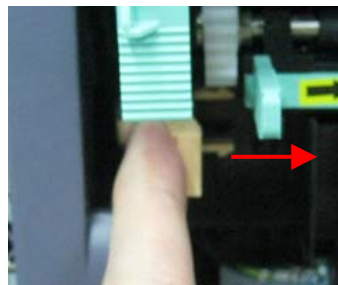
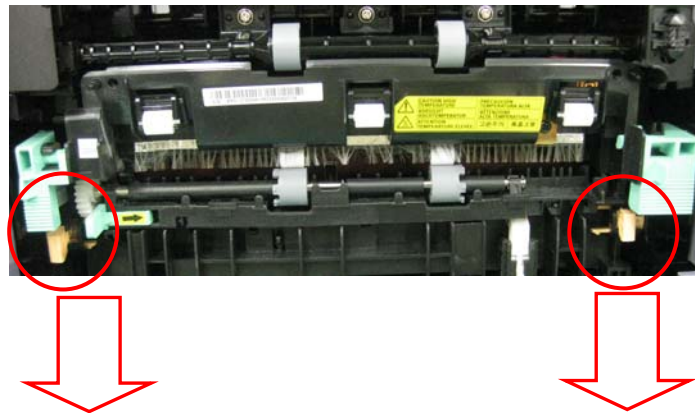

8. Pull out the fusing unit.

Important: Set the unit down so that the gear is on your right side.

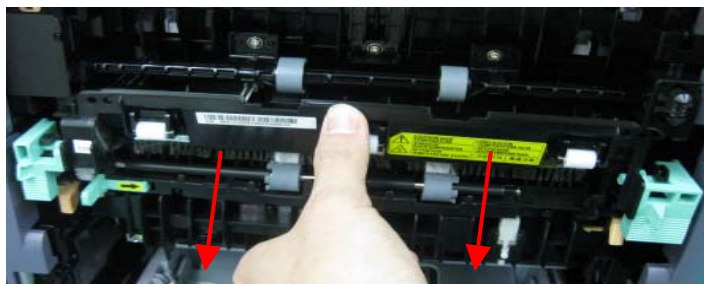

LEFT



RIGHT

Model: SY-P1

Date: 30-Apr-10

No.: RG186005

9. Remove the screw shown.



10. Pull the release lever on the right side of the unit.



11. Slide the release lever in the direction of the arrow.

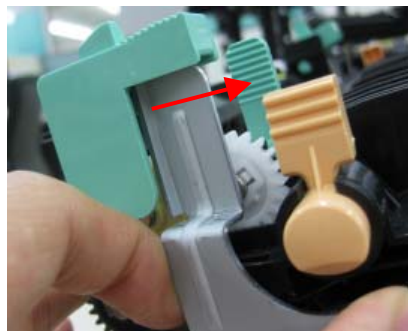

12. Rotate the Holder-M-PR-Shaft in the direction of the arrow.



Model: SY-P1

Date: 30-Apr-10

No.: RG186005

13. Remove the pressure roller bushing.



14. Attach the new pressure roller bushing (P/N G1869900).

15. Rotate the new bushing to fix it in place.



16. Attach the release lever to the right side of the unit (screw x 1).



Model: SY-P1

Date: 30-Apr-10

No.: RG186005

17. Remove the release lever on the left side of the unit (screw x 1).

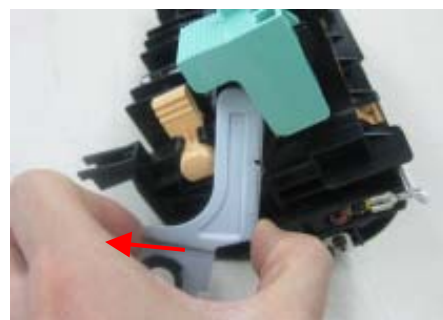
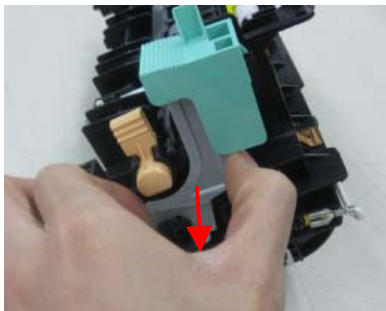

18. Rotate the pressure roller bushing in the direction of the arrow.



19. Remove the pressure roller bushing.



Model: SY-P1

Date: 30-Apr-10

No.: RG186005

20. Attach the new pressure roller bushing (P/N: G1869900).



21. Rotate the new bushing to fix it in place.



22. Attach the release lever to the left side of the unit (screw x 1).

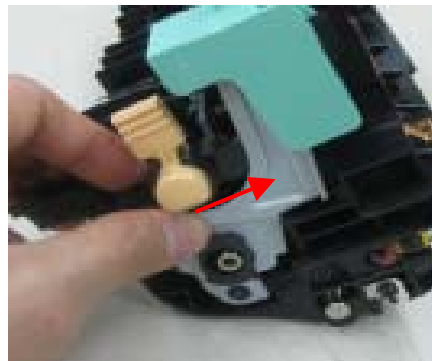

Model: SY-P1		Date: 15-Jun-10	No.: RG186006
Subject: PCB:Power Supply-HVPS		Prepared by: T. Nihei	
From: 1st Overseas Tech Support Sec., 1st PQM Dept.			
Classification:	<input type="checkbox"/> Troubleshooting <input type="checkbox"/> Mechanical <input type="checkbox"/> Paper path <input type="checkbox"/> Product Safety	<input checked="" type="checkbox"/> Part information <input type="checkbox"/> Electrical <input type="checkbox"/> Transmit/receive <input type="checkbox"/> Other ()	<input type="checkbox"/> Action required <input type="checkbox"/> Service manual revision <input type="checkbox"/> Retrofit information <input type="checkbox"/> Tier 2

Old part number	New part number	Description	Q'ty	Int	Page	Index	Note
	G1861382	RZL : HVPS : JC44-00112A	1		3	40	

Change: This part was newly added.

Reason: To meet requests received from the field.

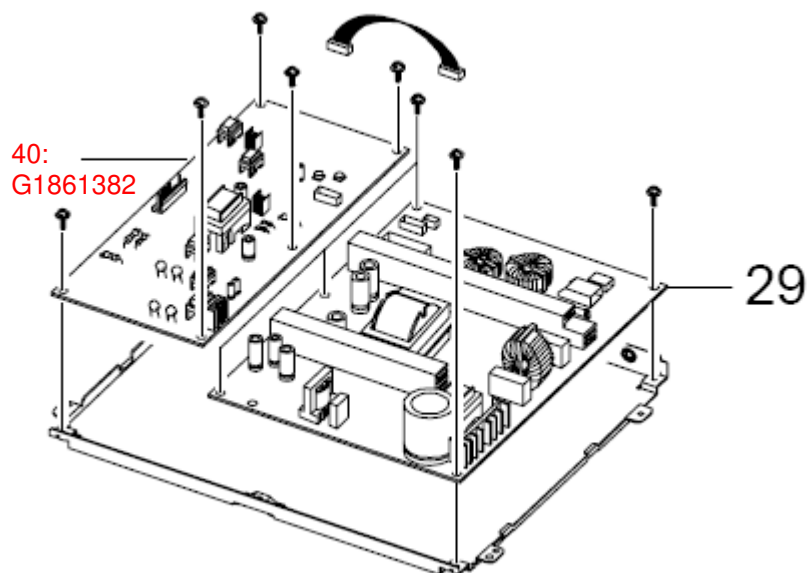

Model: SY-P1		Date: 15-Jun-10	No.: RG186007
Subject: Rear Cover Guide		Prepared by: T. Nihei	
From: 1st Overseas Tech Support Sec., 1st PQM Dept.			
Classification:	<input type="checkbox"/> Troubleshooting <input type="checkbox"/> Mechanical <input type="checkbox"/> Paper path <input type="checkbox"/> Product Safety	<input checked="" type="checkbox"/> Part information <input type="checkbox"/> Electrical <input type="checkbox"/> Transmit/receive <input type="checkbox"/> Other ()	<input type="checkbox"/> Action required <input type="checkbox"/> Service manual revision <input type="checkbox"/> Retrofit information <input type="checkbox"/> Tier 2

Old part number	New part number	Description	Q'ty	Int	Page	Index	Note
	G1861228	RZL:COVERMREARGUIDE:JC6300726A	1		11	4-5	

Change: This part was newly added.

Reason: To meet requests received from the field.

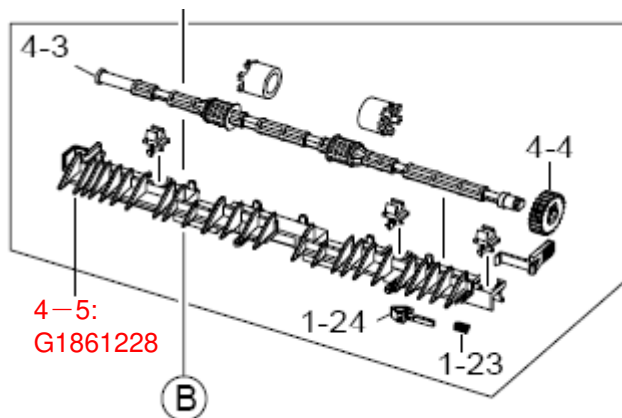

Model: SY-P1		Date: 15-Jun-10	No.: RG186008
Subject: Ground cassette		Prepared by: K. Hamada	
From: 1st Overseas Tech Support Sec., 1st PQM Dept.			
Classification:	<input type="checkbox"/> Troubleshooting <input type="checkbox"/> Mechanical <input type="checkbox"/> Paper path <input type="checkbox"/> Product Safety	<input checked="" type="checkbox"/> Part information <input type="checkbox"/> Electrical <input type="checkbox"/> Transmit/receive <input type="checkbox"/> Other ()	<input type="checkbox"/> Action required <input type="checkbox"/> Service manual revision <input type="checkbox"/> Retrofit information <input type="checkbox"/> Tier 2

Old part number	New part number	Description	Q'ty	Int	Page	Index	Note
	G1861380	GROUNDCASSETTE:	0-1	-	21	27	

Change: This part in the table was added.
Reason: To meet requests received from the field.

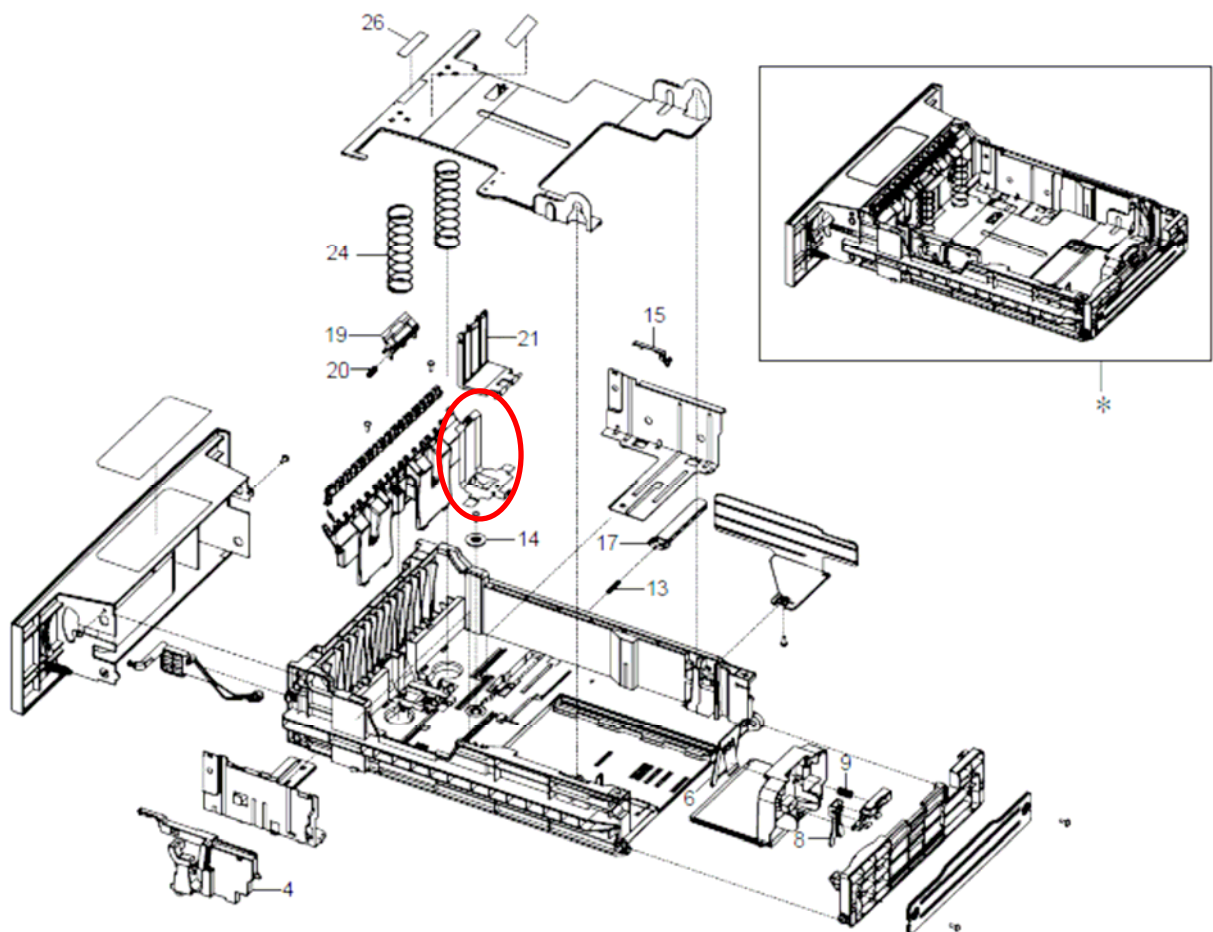

Model: SY-P1		Date: 28-Jun-10	No.: RG186009
Subject: Top Cover		Prepared by: T. Nihei	
From: 1st Overseas Tech Support Sec., 1st PQM Dept.			
Classification:	<input type="checkbox"/> Troubleshooting <input type="checkbox"/> Mechanical <input type="checkbox"/> Paper path <input type="checkbox"/> Product Safety	<input checked="" type="checkbox"/> Part information <input type="checkbox"/> Electrical <input type="checkbox"/> Transmit/receive <input type="checkbox"/> Other ()	<input type="checkbox"/> Action required <input type="checkbox"/> Service manual revision <input type="checkbox"/> Retrofit information <input type="checkbox"/> Tier 2

Old part number	New part number	Description	Q'ty	Int	Page	Index	Note
	G1861381	RZL:COVER-M_TOP:JC63-00699B	1		5	1-19	

Change: This part was newly added.

Reason: To meet requests received from the field.

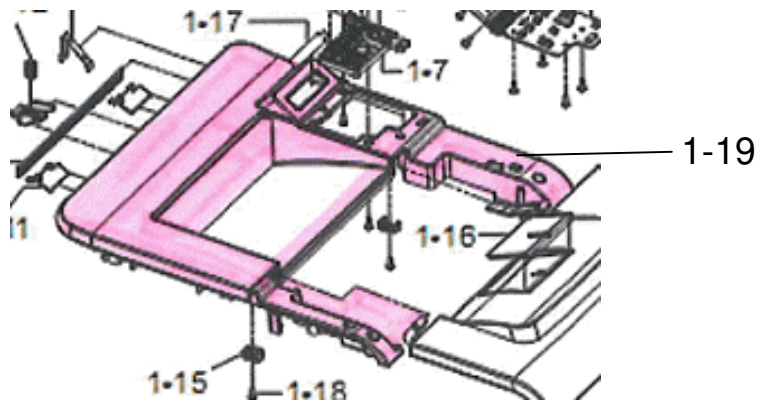

Model: SY-P1		Date: 07-Jul-10	No.: RG186010
Subject: Gear-Fuser		Prepared by: T. Nihei	
From: 2nd Overseas Tech Support Sec. 2nd PQM Dept			
Classification:	<input type="checkbox"/> Troubleshooting <input type="checkbox"/> Mechanical <input type="checkbox"/> Paper path <input type="checkbox"/> Product Safety	<input checked="" type="checkbox"/> Part information <input type="checkbox"/> Electrical <input type="checkbox"/> Transmit/receive <input type="checkbox"/> Other ()	<input type="checkbox"/> Action required <input type="checkbox"/> Service manual revision <input type="checkbox"/> Retrofit information <input type="checkbox"/> Tier 2

Old part number	New part number	Description	Q'ty	Int	Page	Index	Note
	G1861383	RZL:GEAR-FUSER:JC66-1266A	0-1		11	1-20	

Change: This part was newly added.

Reason: To meet requests received from the field.

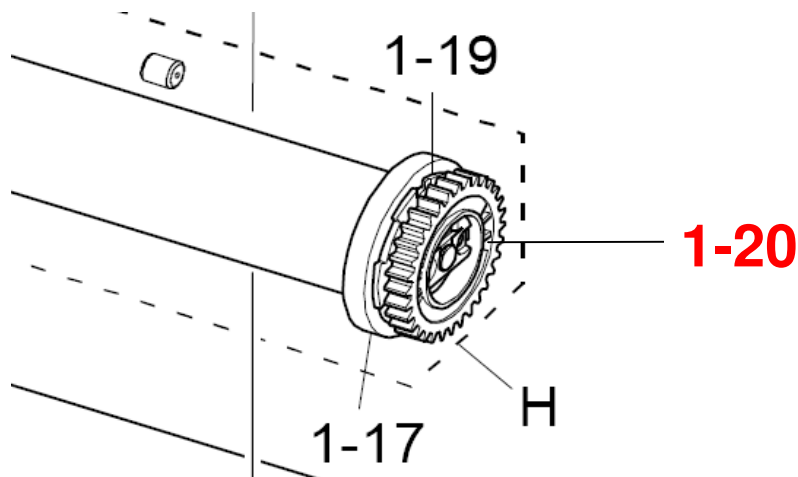

Reissued:16-Aug-10

Model: SY-P1	Date: 07-Jul-10	No.: RG186011a
--------------	-----------------	----------------

RTB Reissue

The items in ***bold italics*** have been corrected.

Subject: Added parts		Prepared by: T. Nihei	
From: 1st Overseas Tech Support Sec., 1st PQM Dept.			
Classification:	<input type="checkbox"/> Troubleshooting <input type="checkbox"/> Mechanical <input type="checkbox"/> Paper path <input type="checkbox"/> Product Safety	<input checked="" type="checkbox"/> Part information <input type="checkbox"/> Electrical <input type="checkbox"/> Transmit/receive <input type="checkbox"/> Other ()	<input type="checkbox"/> Action required <input type="checkbox"/> Service manual revision <input type="checkbox"/> Retrofit information <input type="checkbox"/> Tier 2

Old part number	New part number	Description	Q'ty	Int	Page	Index	Note
	G1861359	DUPLEX UNIT:JC9603412F	0-1		3	37	
	G1861320	DEV MOTOR HARNESS:JC3900438A	0-1		17	9	

Change: These parts were newly added.

Reason: To meet requests received from the field.

(1) G1861320

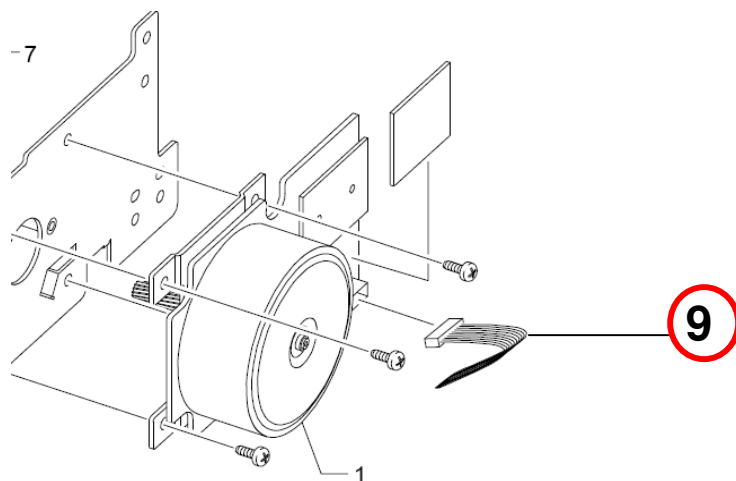

Model: SY-P1		Date: 22-Nov-10	No.: RG186012
Subject: Cassette guide		Prepared by: T. Nihei	
From: 1st Overseas Tech Support Sec., 1st PQM Dept.			
Classification:	<input type="checkbox"/> Troubleshooting <input type="checkbox"/> Mechanical <input type="checkbox"/> Paper path <input type="checkbox"/> Product Safety	<input checked="" type="checkbox"/> Part information <input type="checkbox"/> Electrical <input type="checkbox"/> Transmit/receive <input type="checkbox"/> Other ()	<input type="checkbox"/> Action required <input type="checkbox"/> Service manual revision <input type="checkbox"/> Retrofit information <input type="checkbox"/> Tier 2

Old part number	New part number	Description	Q'ty	Int	Page	Index	Note
	G1861384	RZL:GUIDR_M:JC61-01226C	0-1		21	28	

Change: This part was newly added.

Reason: To meet requests received from the field.

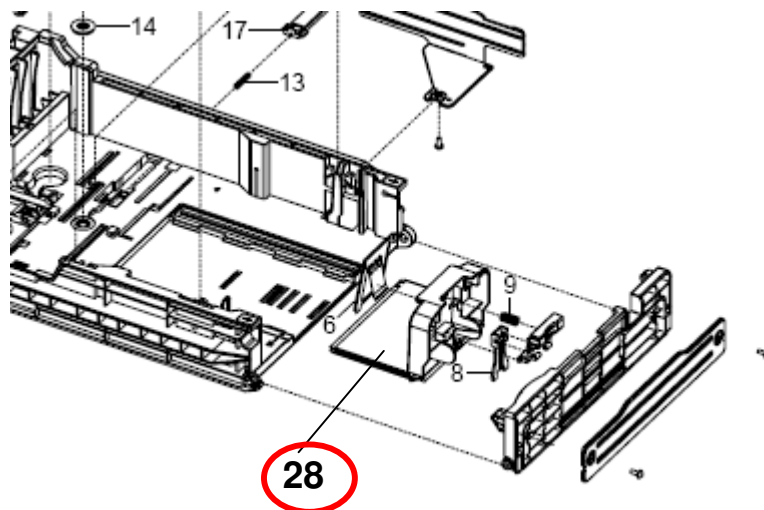

Model: SY-P1		Date: 05-Jan-11	No.: RG186013
Subject: Bushing & Sensor		Prepared by: T. Nihei	
From: 1st Overseas Tech Support Sec., 1st PQM Dept.			
Classification:	<input type="checkbox"/> Troubleshooting <input type="checkbox"/> Mechanical <input type="checkbox"/> Paper path <input type="checkbox"/> Product Safety	<input checked="" type="checkbox"/> Part information <input type="checkbox"/> Electrical <input type="checkbox"/> Transmit/receive <input type="checkbox"/> Other ()	<input type="checkbox"/> Action required <input type="checkbox"/> Service manual revision <input type="checkbox"/> Retrofit information <input type="checkbox"/> Tier 2

(1)

Old part number	New part number	Description	Q'ty	Int	Page	Index	Note
	G1861141	EXIT ROLLER BUSHING:JC7241191B	0-2	-	7	43	

Change: This part in the table was added.

Reason: To meet requests received from the field.

(2) Please correct your parts catalog as follows.

Wrong part number	Correct part number	Description	Q'ty	Int	Page	Index	Note
G1861141	G1861385	RZL:ELAUNITCHECK:JC96-04120A			9	41	

(1)

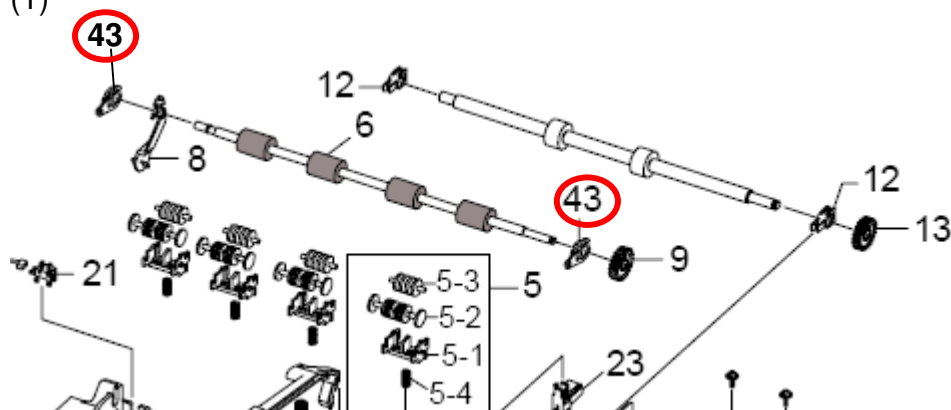

(2)

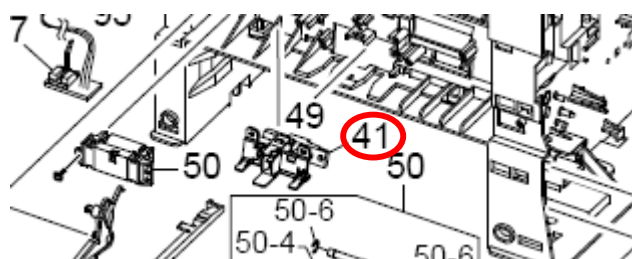

Model: SY-P1		Date: 20-Jul-11	No.: RG186014
Subject: Parts Catalog Correction (Plate Pad)		Prepared by: T. Nihei	
From: 1st Overseas Tech Support Sec., 1st PQM Dept.			
Classification:	<input type="checkbox"/> Troubleshooting <input type="checkbox"/> Mechanical <input type="checkbox"/> Paper path <input type="checkbox"/> Product Safety	<input checked="" type="checkbox"/> Part information <input type="checkbox"/> Electrical <input type="checkbox"/> Transmit/receive <input type="checkbox"/> Other ()	<input type="checkbox"/> Action required <input type="checkbox"/> Service manual revision <input type="checkbox"/> Retrofit information <input type="checkbox"/> Tier 2

Part Number	Description	Q'ty	Int	Page	Index	Note
G1861335	IPR-Plate Pad	1-0		21	19-4	

Change: The part shown was deleted.

Reason: Parts Catalog error.

14	G186 1007	Gear-Pinion	1
15	G186 1301	Cap-M-Guide Side,L	1
17	G186 1303	PMO-Locker Plate	1
19	G186 1305	MEA Unit-Holder Pad	1
19-4	G186 1335	IPR-Plate Pad	1
20	G186 1108	Spring Etc-Exit Roll FD	1
21	G186 1307	Holder-M-Pad_Housing	1
24	G186 1310	Spring Etc-Plate K/Up	1
26	G186 1312	RPR-Pad Cassette	1

Reissued: 20-May-13

Model: Model SY-P1	Date: 07-Jan-08	No.: RG186001g
--------------------	-----------------	----------------

RTB Reissue

The items in bold italics have been corrected.

Subject: Firmware Release Note: Engine Firmware (Package)		Prepared by: J. Mochizuki	
From: 3rd Tech Service Sect., MFP/Printer Tech Service Dept.			
Classification:	<input type="checkbox"/> Troubleshooting <input type="checkbox"/> Mechanical <input type="checkbox"/> Paper path <input type="checkbox"/> Product Safety	<input type="checkbox"/> Part information <input type="checkbox"/> Electrical <input type="checkbox"/> Transmit/receive <input checked="" type="checkbox"/> Other ()	<input type="checkbox"/> Action required <input type="checkbox"/> Service manual revision <input type="checkbox"/> Retrofit information <input checked="" type="checkbox"/> Tier 2

This RTB has been issued to announce the firmware release information for the **Engine Firmware (Package)**.

Version	Program No.	Effective Date
1.50.00.140	G1868630G	<i>Production discontinued</i>
1.50.00.128	G1868630F	<i>January 2010 production</i>
1.50.00.121	G1868630E	August 2009 production
1.50.00.114	G1868630D	May 2009 production
1.50.00.99	G1868630C	August 2008 production
1.50.00.92	G1868630B	January 2008 production
1.50.00.77	G1868630A	July 2007 production
1.50.00.72	G1888630A	1st Mass production

Version	Modified Points or Symptom Corrected
1.50.00.140	<i>Symptom corrected:</i> <i>Main: 1.50.00.128 -> 1.50.00.140</i> <i>1. IDPT failure issue has been fixed.</i> <i>2. Other minor bug corrections.</i>
1.50.00.128	<i>Symptom corrected:</i> <i>Main : 1.50.00.122 -> 1.50.00.128</i> <i>1. Only separator pages are printed. The rest of the job is not output.</i> <i>This only affected devices with the optional</i> <i>HDD. PCL 5e: 5.92 -> 5.92.01</i> <i>1. Black barcodes might be printed in grey.</i> <i>Network: 3.02.05 -> 3.02.06</i> <i>1. The device might become unreachable if a static IP</i> <i>address is used in a CIDR environment.</i>
1.50.00.121	Engine: 1.00.39 ->1.00.43 1.Minor bug correction.
1.50.00.114	Engine: 1.00.37 ->1.00.39 1. To tighten controls on fuser error condition when the machine is warming up or ready. 2. Improve text density by LD power in dark mode. PCL5e: 5.67 -> 5.92 1. Minor bug correction

Reissued: 20-May-13

Model: Model SY-P1		Date: 07-Jan-08	No.: RG186001g
Version	Modified Points or Symptom Corrected		
	PCL6: 5.72 -> 5.93 1. Minor bug correction PS: 1.85 -> 1.94 1. Minor bug correction Network: 3.02.04 -> 3.02.05 1. Minor bug correction		
1.50.00.99	Symptom corrected: 1. The status of the operation returns to "Ready" but this is not reflected in SDM for Admin's Device properties 2. Fixed paper source problem in case option tray's delayed initialization. 3. Fixed Red question mark display in status of Power Save mode 4. Fixed a problem that Default Type of PS driver and default Type of PCL driver works differently. 5. Delay time to inform status of option tray.		
1.50.00.92	Minor bug correction.		
1.50.00.77	1. Modified a fuser reference temperature in Ready mode for Blue Angel. 2. Output format of fonts does not align with table in form printing. (GFPR#RA07040001) 3. Abnormal printing of ruled lines in form printing. (GFPR#RA7060001)		
1.50.00.72	1st Mass production		