

# Quick Installation Guide



Read this manual carefully before you use the product and keep it handy for future reference. For safe and correct use, please be sure to read "Safety Information" before using the machine.

## 1 Where to Put the Printer

The printer's location should be carefully chosen because environmental conditions greatly affect its performance.

### Warning

- The supplied power cord is for use with this equipment only. Do not use with other appliances. Doing so may result in fire, electric shock, or injury.
- Connect the machine to the power source specified in "Safety Information" and do not use any other power sources. Connect the power cord directly to a wall outlet and do not use an extension cord. Power sources not specified in "Safety Information" and extension cords are electric shock or fire hazards.
- Power cords that are damaged, broken, modified, trapped under heavy objects, pulled hard, or bent severely are electric shock and fire hazards.

### Caution

- It is dangerous to handle the plug with wet hands. Doing this may result in receiving an electric shock.
- Keep the machine in an area that is within optimum environmental conditions. Operating the machine in an environment that is outside the recommended ranges of humidity and temperature can cause an electrical fire hazard. Keep the area around the socket free of dust. Accumulated dust can become an electrical fire hazard.
- Place the machine on a strong and level surface. Otherwise, it might fall and injure someone.
- If you use the machine in a confined space, ensure there is continuous air circulation.

### Space Required for Installation

Leave enough space around the printer to operate it freely. The recommended minimum space is as follows:

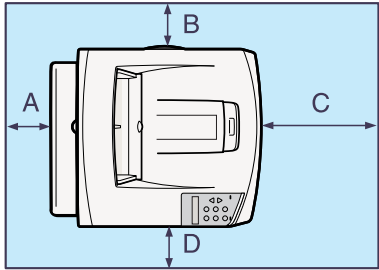

- A : 10 cm (4.0 inches) or more  
B : 10 cm (4.0 inches) or more  
C : 40 cm (15.8 inches) or more  
D : 10 cm (4.0 inches) or more

### Optimum Environmental Conditions

Permissible and recommended temperature and humidity ranges are as follows:

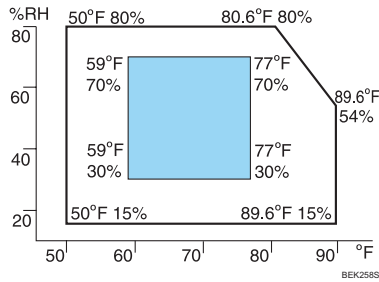
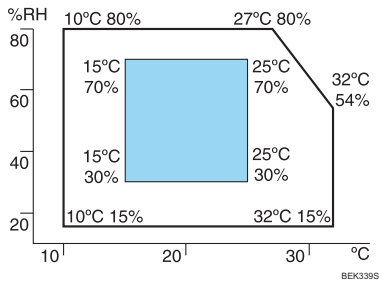

- White area: Permissible Range
- Gray area: Recommended Range

### Note

- The machine must be level within 5 mm, 0.2" from both front to rear and left to right.
- To avoid possible build-up of ozone, locate this machine in a large well ventilated room that has an air turnover of more than 30 m<sup>3</sup>/hr/person.
- When you use this machine for a long time in a confined space without good ventilation, you may detect a smell. To keep the workplace comfortable, we recommend you keep it well ventilated.

### Environments to Avoid

### Important

Do not use the printer in the following environments:

- Areas exposed to direct sunlight or strong light
- Dusty areas
- Areas with corrosive gases
- Areas that are excessively cold, hot, or humid
- Locations near air conditioners or humidifiers
- Locations near other electronic equipment
- Locations subject to frequent strong vibration

### Power Source

Connect the power cord to a power source of the following specification:

- 220 - 240 V, 50/60 Hz, 4.3 A or more

## 2 Unpacking the Printer and Checking the Contents of the Box

Follow the procedure below to verify the items that come with the printer.

### Caution

- When lifting the machine, use the inset grips on both side and then lift the printer slowly. Lifting it carelessly or dropping it may cause an injury. The printer could break or cause an injury if dropped.

### Important

- The interface cable is not supplied in the box. It is your responsibility to provide the interface cable appropriate for the computer that you are using.

### 1 Ensure that the box contains all items listed below. If there are any missing or defective items, contact your sales representative.

#### Manuals and CD-ROMs

- ☒ Quick Installation Guide (this sheet)
- ☐ Safety Information
- ☐ CD-ROM "Printer Drivers and Utilities"
- ☐ CD-ROM "Manuals"
- ☐ CD-ROM "Document Management Utility"
- ☐ Power Cord
- ☐ Paper Tray Cover

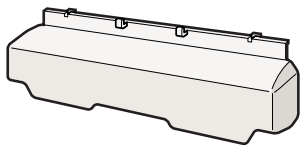

- ☐ Ferrite Core x 1

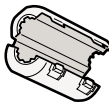

- ☐ Additional Documentation

### Note

- This package does not include an interface cable. Purchase one as necessary to connect to the printer.

### 2 Remove the plastic bag. Lift the printer and move it to the place where you want to install it.

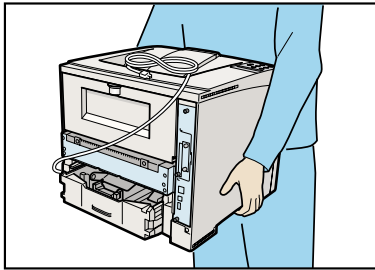

### 3 Remove the orange adhesive tape.

Do not remove the tape shown in the illustration. Remove this tape when the toner cartridge is installed.

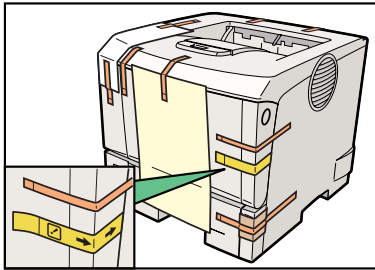

### Important

- Lower the machine slowly and carefully to prevent trapping your hands.

## 3 Installing the Toner Cartridge

The following procedure describes how to install the toner cartridge.

### Warning

- Do not incinerate used toner or toner containers. Toner dust might ignite when exposed to an open flame. Dispose of used toner containers in accordance with local regulations.
- Do not store toner, used toner, or toner containers in a place with an open flame. The toner might ignite and cause burns or a fire.

### Caution

- Keep toner (used or unused) and toner containers out of reach of children.
- If toner or used toner is inhaled, gargle with plenty of water and move into a fresh air environment. Consult a doctor if necessary.
- If toner or used toner gets into your eyes, flush immediately with large amounts of water. Consult a doctor if necessary.
- If toner or used toner is swallowed, dilute by drinking a large amount of water. Consult a doctor if necessary.
- Avoid getting toner on your clothes or skin when removing a paper jam or replacing toner. If your skin comes into contact with toner, wash the affected area thoroughly with soap and water.
- If toner gets on your clothing, wash with cold water. Hot water will set the toner into the fabric and may make removing the stain impossible.

### Important

- Do not expose the toner cartridge to a light for a long time. If you do, the toner cartridge will be damaged and the print quality might be reduced.

### Note

- The toner cartridge that comes with the printer will allow you to print up to about 6,000 pages. But the actual number of pages will vary depending on the paper type, size, contents, and settings.
- Toner Cartridge (consumable) is not covered by warranty. However, if there is a problem, contact the dealer where you purchased the printer.
- Toner cartridge mouths may become dirty during quality inspection.

### 1 Open the front cover by pushing the front cover release button.

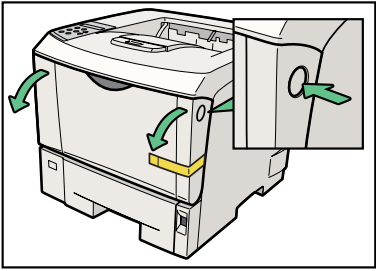

### 2 Remove the fixing material inserted between toner cartridge and the printer.

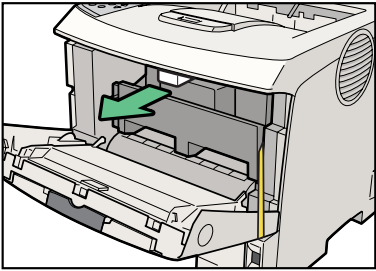

### 3 Lift the front side of the toner cartridge, and then pull it out of the printer.

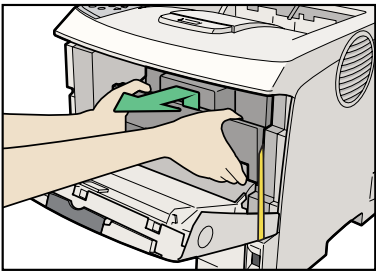

### Note

- Do not hold the toner cartridge upside down or stand it vertically.
- Do not put the toner cartridge on an unstable or tilted surface.

### 4 Place the toner cartridge on at a flat surface. Remove the tape as shown in the illustration.

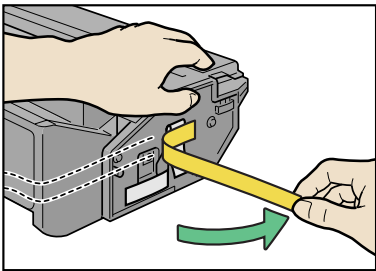

- 5** Pull out the tape inside the unit horizontally while holding the cartridge with one hand as shown in the illustration.

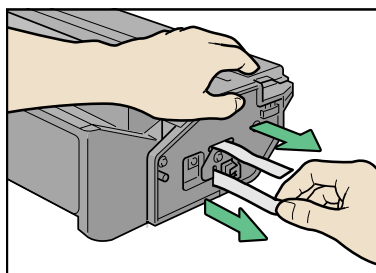

### ★ Important

- Be sure to remove the tape completely before installing the toner cartridge. Otherwise, the printer might be damaged.
- If you pull out the strips when the toner cartridge is slant or standing on its side, the cartridge might cause trouble with the printer.
- Be sure to pull the tape horizontally. Pulling it upward or downward may cause the toner to scatter.
- After pulling the tape out of the cartridge, toner scatters easily. Do not shake the cartridge.

- 6** Hold the grips of the toner cartridge, and then insert it into the printer until it stops.

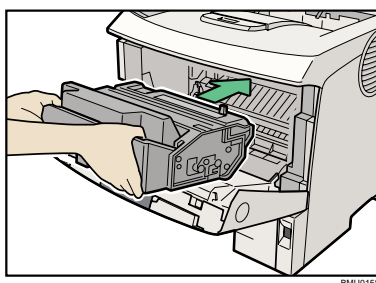

- 7** Lower the toner cartridge when it touches the back.

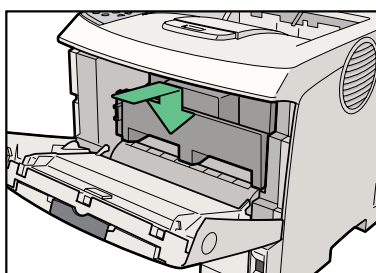

- 8** Close the front cover.

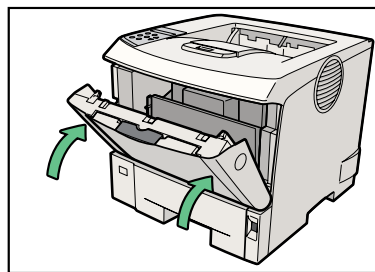

### ★ Important

- Do not close the front cover with force. If you cannot close the cover easily, pull out the toner cartridge from the printer and insert it again. After that, close the front cover again.
- Dispose of removed fixing material and tape in the same manner as ordinary plastic waste.

## 4 Loading Paper

The following describes how to load paper into the standard paper tray (Tray 1). For settings other than the default paper size, and information about the paper sizes that can be set in the paper tray, see "Paper and Other Media", *Hardware Guide* (⑧).

### ⚠ Caution

- Do not pull out the paper tray forcefully. If you do, the tray might fall and cause an injury.

### ★ Important

- To avoid paper jams, make sure paper is not stacked higher than the upper limit mark inside the paper tray. Paper misfeeds might occur.
- Do not mix different types of paper in the same paper tray.

- 1** Pull out the paper tray until it stops.

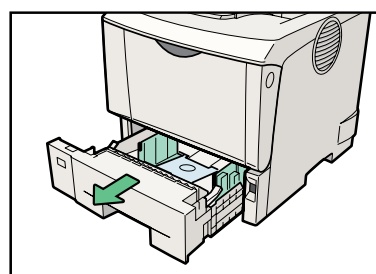

### ⚠ Note

- Do not touch the three white pins on the left front side of the printer.

- 2** Lift the front side of the tray, and then pull it out of the printer.

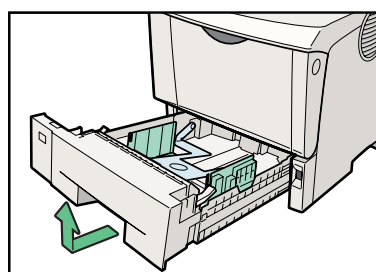

- 3** Fan the paper before loading paper in the paper tray.

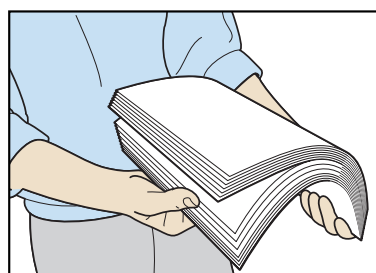

- 4** Load the new paper into paper tray with print side up.

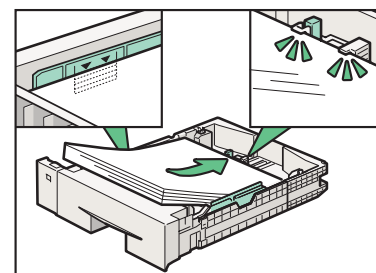

### ★ Important

- Confirm that the top of the stack is not higher than the limit mark inside the tray.
- Confirm that the paper fits under the rear guide.

- 5** Carefully slide the paper tray into the printer until it stops.

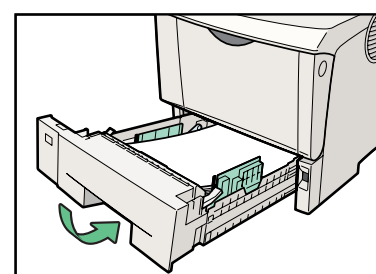

### ★ Important

- Confirm that the setting of the paper size dial matches the size and feed direction of the paper in the tray. Otherwise, the printer might be damaged or a printing problem might occur.
- Do not slide the paper tray in and out with force. If you do, the front and side paper guides will move out of the place.

- 6** Insert the paper tray aligning the ▼ mark on the back of the printer with the ▲ mark on the paper tray cover, and then push in the paper tray cover in the direction shown by the arrow in the illustration.

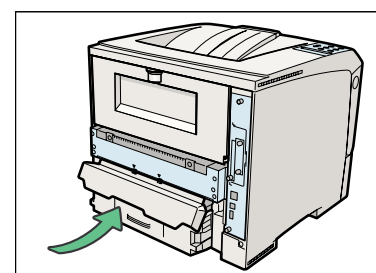

### ⚠ Note

- Do not install the paper tray cover if the duplex unit is installed.

### 📖 Reference

- For details about usable types of paper, see "Loading Paper", *Hardware Guide* (⑧).

## 5 Turning the Power On

Follow the procedure below to turn the power on.

### ⚠ Warning

- The supplied power cord is for use with this equipment only. Do not use with other appliances. Doing so may result in fire, electric shock, or injury.

### ⚠ Caution

- Do not handle the plug with wet hands. Doing this might cause an electric shock.

### ★ Important

- Make sure the power cable is plugged securely into the wall outlet.
- Turn the power off when plugging and unplugging the power plug.

- 1** Confirm that the printer power is turned off. If it is on, turn it off.

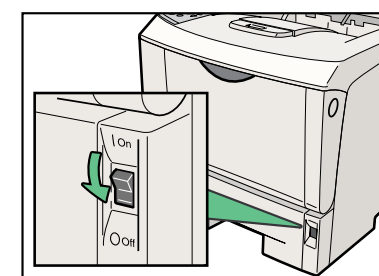

- 2** Connect the power cable to the connector on the back of the printer.

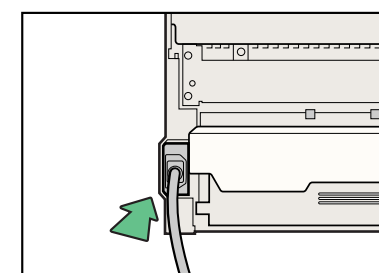

- 3** Insert the plug of the power cord securely into the wall outlet.

- 4** Turn on the printer power.

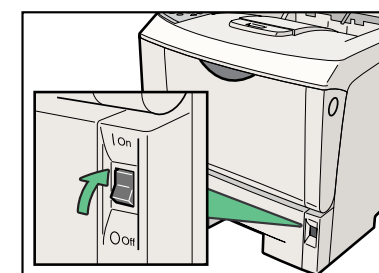

After the printer warms up, the ready message appears on the panel display.

### ⚠ Note

- The first time you turn the printer on after installation or after replacing the fusing unit, it will make several loud noises. This is due to the fusing unit initializing and is perfectly normal.

## 6 Selecting the Display Language

### ⚠ Note

- You can select one of the following languages: English, German, French, Italian, Dutch, Swedish, Norwegian, Danish, Spanish, Finnish, Portuguese, Czech, Polish, or Hungarian.
- The default setting is English.
- If you want to use the English panel display, the following procedure is not necessary.

- 1** Press the [Menu] key.

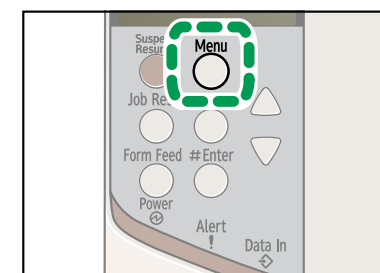

- 2** Press the [▼] or [▲] key to display [Language], and then press the [# Enter] key.

Menu:  
Language

- 3** Press the [▼] or [▲] key to select the language, and then press the [# Enter] key.

Menu:  
English

The following message appears on the panel display for two seconds, and the panel display automatically returns to the previous menu.

Menu:  
\*French

- 4** Press the [Menu] key to return to the initial screen.

## 7 Printing the Test Page

Print a test print in order to verify that the printer is working normally. Test printing checks printer performance only; it does not test the connection to the computer.

1 Press the **[Menu]** key.

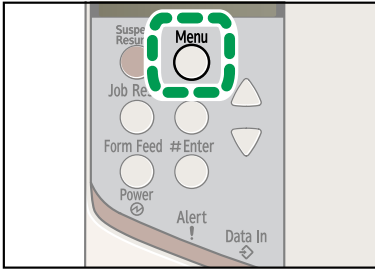

BMUJ0985

2 Press the **[▼]** or **[▲]** key to display **[List/Test Print]**, and then press the **[# Enter]** key.

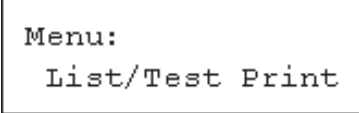

3 Press the **[▼]** or **[▲]** key to display **[Config-page]**, and then press the **[# Enter]** key.

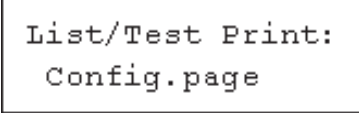

In a short time, the test printing will start.

4 Press the **[Menu]** key to return to the initial screen.

### ★ Important

- If you cannot complete the test printing correctly, check if an error message appeared on the panel display. For more information on error messages, see “Troubleshooting”, *Hardware Guide* (📖).

## 8 Network Connection

Prepare a hub and other network devices, and connect the Ethernet cable to the printer. Connect 10BASE-T or 100BASE-TX cable to the printer's Ethernet port.

### ⚠ Caution

- Properly shielded and grounded cables and connectors must be used for connections to a host computer (and/or peripheral) in order to meet emission limits.
- A network interface cable with a ferrite core must be used for RF interference suppression.

### ★ Important

- The Ethernet cable must be an Unshielded Twisted Pair cable (UTP) or Shielded Twisted Pair cable (STP), and Category type 5 or more.
- An Ethernet cable is not supplied with this printer. Select your cable according to the network environment.

1 Attach the supplied ferrite core at the printer end of the Ethernet cable.

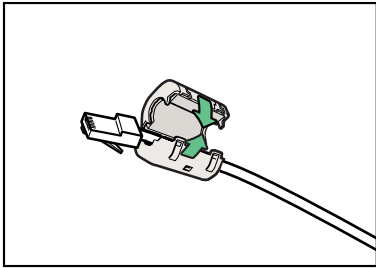

BMUJ2125

2 Connect the Ethernet cable to the Ethernet port.

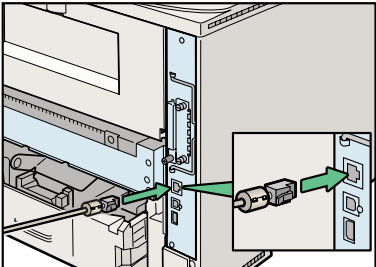

BMUJ0975

3 Connect the other end of the cable to the printer's network, such as a hub.

### ⬇ Note

- The printer's Ethernet and USB ports are not available when the Gigabit Ethernet board is attached to the printer.

### 📖 Reference

- For details about network environment settings, see *Software Guide* (📖).

### ❖ Reading the LED Lamps

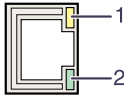

BMUJ2145

- Yellow: comes on when 100BASE-TX is being used. It comes off when 10BASE-T is being used.
- Green: comes on when the printer is properly connected to the network.

## 9 USB Connection

### ⚠ Caution

- Properly shielded and grounded cables and connectors must be used for connections to a host computer (and/or peripheral) in order to meet emission limits.

### ★ Important

- The USB cable is not supplied with this printer. Select your cable according to the computer.
- USB connection is possible under Windows 2000/XP/Vista, Windows Server 2003/2003 R2/2008, Mac OS 9 and Mac OS X.
- USB connection with Macintosh is only possible via the printer's USB port.

1 Connect the square-shaped connector of the USB cable to USB port B.

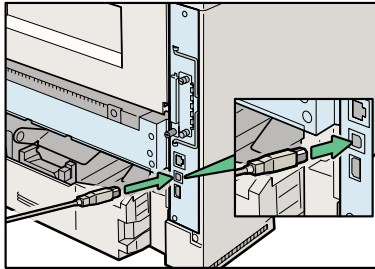

BMUJ0375

2 Connect the opposite end's flat connector to devices such as your computer's USB interface, or a USB hub.

## 10 Ethernet Configuration

Make the following network settings according to the network interface you are using. You can use SmartDeviceMonitor for Admin or a Web browser to make IP address-related settings in a TCP/IP-capable environment.

### ⚠ Caution

- Properly shielded and grounded cables and connectors must be used for connections to a host computer (and/or peripheral) in order to meet emission limits.

### ★ Important

- After configuring the network setting, configure the security settings.
- We recommend that you first make the following setting.
  - Installing the server certificate
  - Enabling SSL
- The following table shows the control panel settings and their default values. These items appear in the “Host Interface” menu.

Setting Name	Value
IPv4 Settings	
DHCP	On
IPv4 Address	11.22.33.44
Subnet Mask	0.0.0.0
Gateway Address	0.0.0.0
IPv6 Settings	Stateless Sett.: Active
IPsec	Not Active
Frame Type (NW)	Auto Select
Active Protocol	
IPv4	Active
IPv6	Not Active
NetWare	Active
SMB	Active
AppleTalk	Active
Ethernet Speed	Auto Select
IEEE802.1X	Inactive
LAN Type	Ethernet

### ⬇ Note

- If DHCP is in use on your network, the IP address, subnet mask, and gateway address are all set automatically.
- If the printer is already placed on a TCP/IP-capable environment, you can also use SmartDeviceMonitor for Admin or a Web browser to configure IP address-related settings.
- Make this setting only when it is necessary. See *Software Guide* (📖).

### ❖ Receiving an IP Address Automatically (DHCP)

### ★ Important

- When [DHCP] is selected, you cannot make settings for the following items:
  - IP Address
  - Subnet Mask
  - Gateway Address
- Consult your network administrator for information about making network settings.

1 Press the **[Menu]** key.

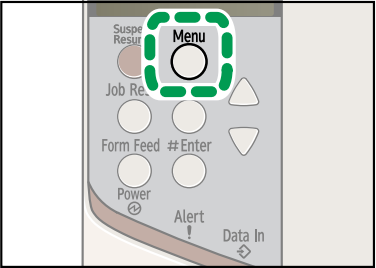

BMUJ0985

2 Press the **[▼]** or **[▲]** key to display **[Host Interface]**, and then press the **[# Enter]** key.

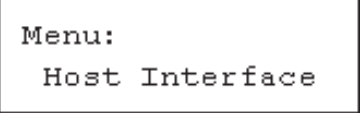

3 Press the **[▼]** or **[▲]** key to display **[Network setup]**, and then press the **[# Enter]** key.

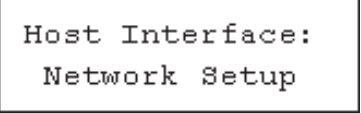

4 Press the **[▼]** or **[▲]** key to display **[IPv4 Settings]**, and then press the **[# Enter]** key.

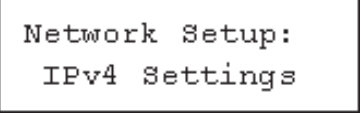

5 Press the **[▼]** or **[▲]** key to display **[DHCP]**, and then press the **[# Enter]** key.

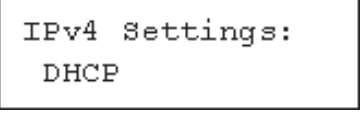

- 6 Press the [▼] or [▲] key to set [On] or [Off], and then press the [# Enter] key.

DHCP:  
\*On

- 7 Press the [Menu] key to return to the initial screen.

- 8 Print a configuration page to confirm the settings made.

#### Reference

- For details about printing the configuration page, see “Printing the Test Page”.

#### ❖ Specifying an IP Address (No DHCP)

- 1 Press the [Menu] key.

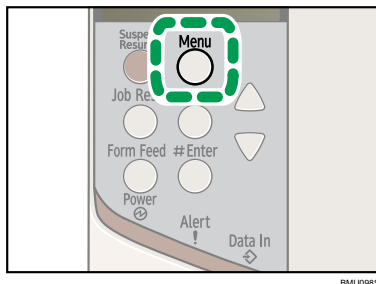

- 2 Press the [▼] or [▲] key to display [Host Interface], and then press the [# Enter] key.

Menu:  
Host Interface

- 3 Press the [▼] or [▲] key to display [Network setup], and then press the [# Enter] key.

Host Interface:  
Network Setup

- 4 Press the [▼] or [▲] key to display [Active Protocol], and then press the [# Enter] key.

Network Setup:  
Active Protocol

- 5 Press the [▼] or [▲] key to select the network protocol, and then press the [# Enter] key.

Active Protocol:  
IPv4

- 6 Press the [▼] or [▲] key to set [Active] or [Not Active], and then press the [# Enter] key.

IPv4:  
\*Active

Set other protocols you need to set in the same way.

- Select [Not Active] for unused protocols.
- Enable IPv4 to use the Pure IPv4 environment of NetWare 5/5.1, NetWare 6/6.5.

- 7 Press the [Escape] key until the screen returns to the [Network Setup] menu.

Network Setup:  
Active Protocol

- 8 If your network uses IPv4, assign the IPv4 address to the printer. Press the [▼] or [▲] key to display [IPv4 Settings], and then press the [# Enter] key.

Network Setup:  
IPv4 Settings

To get the IP address for the printer, contact your network administrator.

- 9 To specify the IPv4 Address, press the [▼] or [▲] key to display [IPv4 Address], and then press the [# Enter] key.

IPv4 Settings:  
IPv4 Address

If you use IPv4, also assign subnet mask and gateway address.

- 10 Press the [▼] or [▲] key to enter the address, and then press the [# Enter] key.

IPv4 Address:  
192. 0. 0. 0

Press the [▼] or [▲] key to enter the left most entry field of the address. After entering the left field, press the [# Enter] key, and then you can enter the next field. After completing to enter in the all fields, press the [# Enter] key.

Do not set “11.22.33.44” as the IPv4 address.

- 11 If you use IPv4, use this method of assigning IPv4 address to assign subnet mask and gateway address.

Press the [▼] or [▲] key to select [Subnet mask] or [Gateway Address], and then press the [# Enter] key.

- 12 Press the [Menu] key to return to the initial screen.

- 13 Print a configuration page to confirm the settings made.

#### Reference

- For details about printing the configuration page, see “Printing the Test Page”.

## 11 Installing the Printer Driver

You can install the printer drivers and software easily from the CD-ROM labeled “Printer Drivers and Utilities”.

Click [Quick Install] in the window of the CD-ROM to install PCL and RPCS printer drivers. To install the PostScript 3 printer driver, click the [PostScript 3 Printer Driver] button. For more information about the PostScript 3 printer driver, see *Software Guide* on the CD-ROM labeled “Manuals”.

When the TCP/IP protocol is used, SmartDevice Monitor for Client will be installed as well.

When using with TCP/IP protocol, confirm the followings:

- ☐ The printer is connected to the network with Category 5 interface cable.
- ☐ The TCP/IP protocol is enabled.
- ☐ The IP address is set for the printer and the computer.

#### ★ Important

- To install printer driver under Windows 2000/XP Professional/Vista, or Windows Server 2003/2003 R2/2008, you must have an account that has Manage Printers permission. Log on as an Administrator.
- For details about installing the printer drivers, see “Preparing for Printing”, *Software Guide* (④).
- When using this printer under parallel connection, only the printer drivers are installed and not SmartDeviceMonitor for Client.
- Quick Install is not available when using this printer under USB connection. If you connect using USB, see *Software Guide* (④).

- 1 Quit all applications currently running.

- 2 Insert the CD-ROM into the CD-ROM drive.

The installer starts.  
Auto Run may not work with the certain operating system settings. If this happens, launch “Setup.exe” on the CD-ROM root directory.

- 3 Select an interface language, and then click [OK].

The default interface language is English.

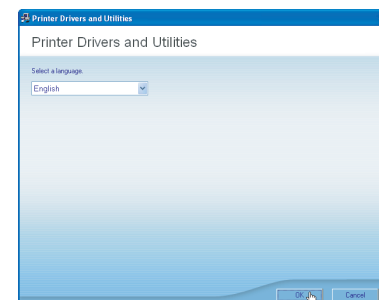

- 4 Click [Quick Install].

The software license agreement appears in the [License Agreement] dialog box.

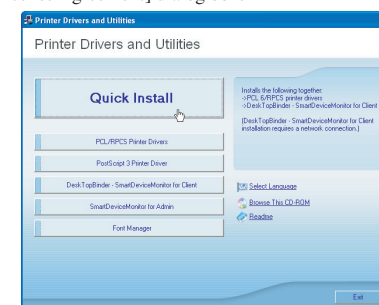

This is an example when English is selected in step 3.

- 5 After reading through all of the contents, click [I accept the agreement] to agree with the License Agreement, and then click [Next >].

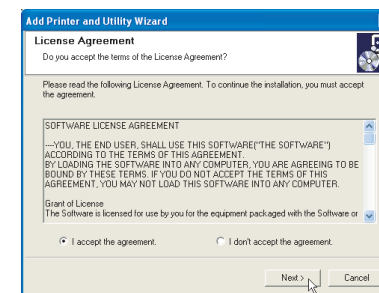

- 6 Select the printer model you want to install in the “Select Printer” dialog box.

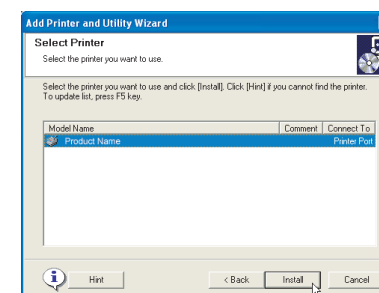

#### Note

- For a network connection via TCP/IP, select the printer whose IP address is displayed in [Connect to]. In this case, SmartDeviceMonitor for Client will also be installed.
- For parallel connection, select the printer whose printer port is displayed in [Connect to].

- 7 Click [Install].

The following display appears while installing the printer driver.

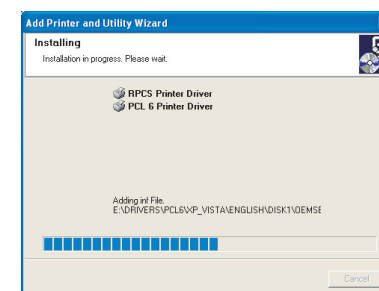

- 8 Click [Finish].

A message about restarting the computer may appear. Restart the computer to complete installation.

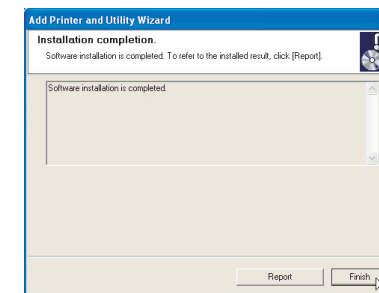

- 9 Click [Exit] in the first dialog box of the installer, and then take out the CD-ROM.

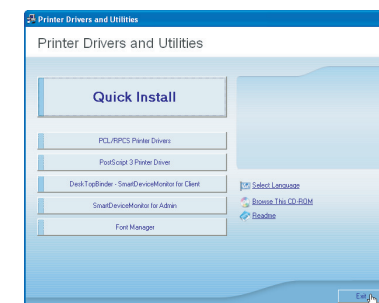

#### Note

- To stop installation of the selected software, click [Cancel] before installation is completed.

#### Reference

- Quick Install is not available for parallel connection unless bidirectional communication between the printer and computer is enabled. For details about bidirectional communication between the printer and computer, see “Printing with Parallel Connection”, *Software Guide* (④).