

Reissued: 13-Apr-07

Model: S-P1	Date: 15-Jan-07	No.: RG176001a
-------------	-----------------	----------------

RTB Reissue

The items in bold italics have been changed.

This RTB is only for S-P1b. (31ppm)

Subject: Firmware Release Note: Engine for S-P1b (31ppm)		Prepared by: Y.Murata	
From: 1st Tech. Support Sec. Service Support Dept.			
Classification:	<input type="checkbox"/> Troubleshooting <input type="checkbox"/> Mechanical <input type="checkbox"/> Paper path <input checked="" type="checkbox"/> Other ()	<input type="checkbox"/> Part information <input type="checkbox"/> Electrical <input type="checkbox"/> Transmit/receive	<input type="checkbox"/> Action required <input type="checkbox"/> Service manual revision <input type="checkbox"/> Retrofit information

This RTB has been issued to announce the firmware release information for the Engine.

Version	Program No.	Effective Date
1.01.0	G1755112B	March 2007 production
01.00.00	G1755112A	1st Mass production.

Version	Modified Points or Symptom Corrected
1.01.0	Other changes: Improved the registration along the paper feed direction for thick paper.
01.00.00	1st Mass production.

Reissued: 13-Apr-07

Model: S-P1	Date: 15-Jan-07	No.: RG176002a
-------------	-----------------	----------------

RTB Reissue

The items in bold italics have been changed.

This RTB is only for S-P1c. (36ppm)

Subject: Firmware Release Note: Engine for S-P1c (36ppm)		Prepared by: Y.Murata	
From: 1st Tech. Support Sec. Service Support Dept.			
Classification:	<input type="checkbox"/> Troubleshooting	<input type="checkbox"/> Part information	<input type="checkbox"/> Action required
	<input type="checkbox"/> Mechanical	<input type="checkbox"/> Electrical	<input type="checkbox"/> Service manual revision
	<input type="checkbox"/> Paper path	<input type="checkbox"/> Transmit/receive	<input type="checkbox"/> Retrofit information
	<input checked="" type="checkbox"/> Other ()		

This RTB has been issued to announce the firmware release information for the Engine.

Version	Program No.	Effective Date
1.01.0	<i>G1755111B</i>	<i>March 2007 production</i>
01.00.00	G1755111A	1st Mass production.

Version	Modified Points or Symptom Corrected
1.01.0	<i>Other changes:</i> <i>Improved the registration along the paper feed direction for thick paper.</i>
01.00.00	1st Mass production.

Reissued: 01-June-07

Model: S-P1	Date: 15-Jan-07	No.: RG176003d
-------------	-----------------	----------------

RTB Reissue

The items in ***bold italics*** have been added.

Subject: Firmware Release Note: Printer		Prepared by: Y.Murata	
From: 1st Tech. Support Sec. Service Support Dept.			
Classification:	<input type="checkbox"/> Troubleshooting	<input type="checkbox"/> Part information	<input type="checkbox"/> Action required
	<input type="checkbox"/> Mechanical	<input type="checkbox"/> Electrical	<input type="checkbox"/> Service manual revision
	<input type="checkbox"/> Paper path	<input type="checkbox"/> Transmit/receive	<input type="checkbox"/> Retrofit information
	<input checked="" type="checkbox"/> Other ()		

This RTB has been issued to announce the firmware release information for the Printer.

Version	Program No.	Effective Date
<i>1.05</i>	<i>G1765440D</i>	<i>Aug 2007 production</i>
<i>1.04</i>	<i>G1765440C</i>	<i>July 2007 production</i>
1.03	G1765440B	June 2007 production
1.02	G1765440A	April 2007 production
1.01	G1765440	1st Mass production.

Version	Modified Points or Symptom Corrected
<i>1.05</i>	<i>Other changes:</i> <i>Machine warm-up time was shortened by about five seconds (some unnecessary procedures at power on were deleted).</i> <i>Important: To apply the above change, you also need to update the Printer firmware to v1.05 or later.</i>
<i>1.04</i>	<i>Symptom corrected:</i> <i>1. PCL jobs containing character codes that are not on the font SD card, might cause the device to stall.</i> <i>2. Jobs containing bitmapped PCL fonts might cause the device to stall.</i> <i>3. When the job is created using SAP DeviceType or Barcode & OCR package for SAP System DT, the following issues will occur.</i> - <i>When sending a BOP job, the printer status stays at "Processing" and the job is not printed.</i> - <i>Memory leak occurs when printing a bitmap font with insufficient memory condition.</i>
1.03	The firmware version was changed to v1.03, in accordance with the release of System firmware v1.03. (the contents of the Printer firmware were not changed).
1.02	The firmware version was changed to v1.02, in accordance with the release of System firmware v1.02. (the contents of the Printer firmware were not changed).
1.01	1st Mass production.

Reissued: 21-May-07

Model: S-P1	Date: 15-Jan-07	No.: RG176004a
-------------	-----------------	----------------

RTB Reissue

The items in bold italics have been added.

Subject: Firmware Release Note: Web Support		Prepared by: Y.Murata	
From: 1st Tech. Support Sec. Service Support Dept.			
Classification:	<input type="checkbox"/> Troubleshooting <input type="checkbox"/> Mechanical <input type="checkbox"/> Paper path <input checked="" type="checkbox"/> Other ()	<input type="checkbox"/> Part information <input type="checkbox"/> Electrical <input type="checkbox"/> Transmit/receive	<input type="checkbox"/> Action required <input type="checkbox"/> Service manual revision <input type="checkbox"/> Retrofit information

This RTB has been issued to announce the firmware release information for the Web Support.

Version	Program No.	Effective Date
1.01	G1765433A	<i>June 2007 production</i>
1.00	G1765433	1st Mass production.

Version	Modified Points or Symptom Corrected
1.01	<i>Symptom corrected:</i> <i>1. WeblmageMonitor contained wording errors.</i> - <i>"Aantal geregistreerden" was shown as "Nummer geregistreerde" in Dutch.</i> - <i>"RC Gate Firmware bijwerken" was shown as "RS Gate Firmware bijwerken" in Dutch.</i> - <i>"Type de papier standard" was shown as "Type de papier utilisateur" in French.</i> <i>2. The XSS vulnerability on WIM. (TechMail#OTS-2007-2118)</i> <i>3. Using WeblmageMonitor in the Safari browser, address book back-up files cannot be downloaded.</i>
1.00	1st Mass production.

Reissued: 01-June-07

Model: S-P1	Date: 15-Jan-07	No.: RG176005b
-------------	-----------------	----------------

RTB Reissue

The items in ***bold italics*** have been added.

Subject: Firmware Release Note: System		Prepared by: Y.Murata	
From: 1st Tech. Support Sec. Service Support Dept.			
Classification:	<input type="checkbox"/> Troubleshooting	<input type="checkbox"/> Part information	<input type="checkbox"/> Action required
	<input type="checkbox"/> Mechanical	<input type="checkbox"/> Electrical	<input type="checkbox"/> Service manual revision
	<input type="checkbox"/> Paper path	<input type="checkbox"/> Transmit/receive	<input type="checkbox"/> Retrofit information
	<input checked="" type="checkbox"/> Other ()		

This RTB has been issued to announce the firmware release information for the System.

Version	Program No.	Effective Date
<i>1.03</i>	<i>G1765430B</i>	<i>June 2007 production</i>
1.02	G1765430A	April 2007 production
1.01	G1765430	1st Mass production.

Version	Modified Points or Symptom Corrected
<i>1.03</i>	<i>Symptom corrected: Incorrect user names and user codes are listed in the log for Document Server files printed out.</i>
1.02	Symptom corrected: The "Lanier" model name was missing from the PnP (Plug and Play) SP setting.
1.01	1st Mass production.

Reissued: 01-June-07

Model: S-P1	Date: 15-Jan-07	No.: RG176005d
-------------	-----------------	----------------

RTB Reissue

The items in ***bold italics*** have been added.

Subject: Firmware Release Note: System		Prepared by: Y.Murata	
From: 1st Tech. Support Sec. Service Support Dept.			
Classification:	<input type="checkbox"/> Troubleshooting	<input type="checkbox"/> Part information	<input type="checkbox"/> Action required
	<input type="checkbox"/> Mechanical	<input type="checkbox"/> Electrical	<input type="checkbox"/> Service manual revision
	<input type="checkbox"/> Paper path	<input type="checkbox"/> Transmit/receive	<input type="checkbox"/> Retrofit information
	<input checked="" type="checkbox"/> Other ()		

This RTB has been issued to announce the firmware release information for the System.

Version	Program No.	Effective Date
<i>1.05</i>	<i>G1765430D</i>	<i>Aug 2007 production</i>
<i>1.04</i>	<i>G1765430C</i>	<i>July 2007 production</i>
1.03	G1765430B	June 2007 production
1.02	G1765430A	April 2007 production
1.01	G1765430	1st Mass production.

Version	Modified Points or Symptom Corrected
<i>1.05</i>	<i>Other changes:</i> <i>Machine warm-up time was shortened by about five seconds (some unnecessary procedures at power on were deleted).</i> <i>Important: To apply the above change, you also need to update the Printer firmware to v1.05 or later.</i>
<i>1.04</i>	<i>Symptom correction:</i> <i>If the machine power is turned OFF during an RFU (remote firmware update) to a machine that has the Data Security Module installed, the RFU does not resume the next time the machine is turned ON.</i>
1.03	Symptom corrected: Incorrect user names and user codes are listed in the log for Document Server files printed out.
1.02	Symptom corrected: The "Lanier" model name was missing from the PnP (Plug and Play) SP setting.
1.01	1st Mass production.

Reissued: 14-May-07

Model: S-P1	Date: 15-Jan-07	No.: RG176006b
-------------	-----------------	----------------

RTB Reissue

The items in bold italics have been added.

Subject: Firmware Release Note: Network Support		Prepared by: Y.Murata	
From: 1st Tech. Support Sec. Service Support Dept.			
Classification:	<input type="checkbox"/> Troubleshooting	<input type="checkbox"/> Part information	<input type="checkbox"/> Action required
	<input type="checkbox"/> Mechanical	<input type="checkbox"/> Electrical	<input type="checkbox"/> Service manual revision
	<input type="checkbox"/> Paper path	<input type="checkbox"/> Transmit/receive	<input type="checkbox"/> Retrofit information
	<input checked="" type="checkbox"/> Other ()		

This RTB has been issued to announce the firmware release information for the Network Support.

Version	Program No.	Effective Date
6.06	<i>G1765432B</i>	<i>August 2007 production</i>
6.04	<i>G1765432A</i>	<i>June 2007 production</i>
6.02	G1765432	1st Mass production.

Version	Modified Points or Symptom Corrected
6.06	<i>Symptom corrected:</i> <i>1. The performance of WIM might be reduced if SSDP is enabled on the device.</i>
6.04	<i>Symptom corrected:</i> <i>1. A 404 error will be returned by WIM after the "Date and time" setting is configured via a Web SmartDeviceMonitor ver.2.x Batch Configuration.</i> <i>2. The device will not be registered with a DNS server by a DHCP relay agent.</i> <i>3. The device fails to renew with the DDNS server, it will not try again.</i> <i>4. IPP clients might not print to devices that joined the network using mDNS (Bonjour).</i>
6.02	1st Mass production.

Model: S-P1	Date: 23-Jan-07	No.: RB176007
-------------	-----------------	---------------

Subject: Firmware Release Note: NetworkDocBox		Prepared by: Y.Murata	
From: 1st Tech. Support Sec. Service Support Dept.			
Classification:	<input type="checkbox"/> Troubleshooting <input type="checkbox"/> Mechanical <input type="checkbox"/> Paper path <input checked="" type="checkbox"/> Other ()	<input type="checkbox"/> Part information <input type="checkbox"/> Electrical <input type="checkbox"/> Transmit/receive	<input type="checkbox"/> Action required <input type="checkbox"/> Service manual revision <input type="checkbox"/> Retrofit information

This RTB has been issued to announce the firmware release information for the NetworkDocBox.

Version	Program No.	Effective Date
1.10.1	G1765435	1st Mass production.

Version	Modified Points or Symptom Corrected
1.10.1	1st Mass production.

Model: Model S-P1		Date: 13-Dec-07	No.: RG176008
Subject: Service manual revision		Prepared by: Y.Murata	
From: 1st Tech. Support Sec. Service Support Dept.			
Classification:	<input type="checkbox"/> Troubleshooting <input type="checkbox"/> Part information <input type="checkbox"/> Action required <input type="checkbox"/> Mechanical <input type="checkbox"/> Electrical <input checked="" type="checkbox"/> Service manual revision <input type="checkbox"/> Paper path <input type="checkbox"/> Transmit/receive <input type="checkbox"/> Retrofit information <input type="checkbox"/> Other ()		

The Service Manual was corrected as follows:

Pg. 121

- In the table below:
 - **Change** "1: 3K" to "**1: 6K**"
 - **Delete** "2: 6K"

Illustration (please correct the incorrect information shown here):

		4: Asia
		Acquires value at "04H" on the AIO ID chip and for the part code number displays:
7931 005	Kind ID	1: 3K
		2: 6K
		3: 15K

Reissued: 25-Dec-07

Model: S-P1	Date: 15-Jan-07	No.: RG176003e
-------------	-----------------	----------------

RTB Reissue

The items in ***bold italics*** have been added.

Subject: Firmware Release Note: Printer		Prepared by: Y.Murata	
From: 1st Tech. Support Sec. Service Support Dept.			
Classification:	<input type="checkbox"/> Troubleshooting	<input type="checkbox"/> Part information	<input type="checkbox"/> Action required
	<input type="checkbox"/> Mechanical	<input type="checkbox"/> Electrical	<input type="checkbox"/> Service manual revision
	<input type="checkbox"/> Paper path	<input type="checkbox"/> Transmit/receive	<input type="checkbox"/> Retrofit information
	<input checked="" type="checkbox"/> Other ()		

This RTB has been issued to announce the firmware release information for the Printer.

Version	Program No.	Effective Date
1.06	G1765440E	Dec 2007 production
1.05	G1765440D	Aug 2007 production
1.04	G1765440C	July 2007 production
1.03	G1765440B	June 2007 production
1.02	G1765440A	April 2007 production
1.01	G1765440	1st Mass production.

Version	Modified Points or Symptom Corrected
1.06	Symptom corrected: <ol style="list-style-type: none"> Various printing anomalies when printing PowerPoint2007 jobs that have Autoshapes and shadows. This can occur if printing with both of the following RPCS driver settings: <ul style="list-style-type: none"> Resolution: 1800 x 600 dpi Job Load Distribution: Shift load to driver PCL jobs containing fonts with a number of characters that is evenly divisible by 256 might cause the device to stall. (GFPR#RE0706006, RA07090001) Subsequent PCL jobs will be canceled after the device prints a large number of jobs (more than 2000) submitted by the PCL 6 driver. (GFPR#RE07080008)
1.05	Other changes: Machine warm-up time was shortened by about five seconds (some unnecessary procedures at power on were deleted). Important: To apply the above change, you also need to update the Printer firmware to v1.05 or later.

Reissued: 25-Dec-07

Model: S-P1		Date: 15-Jan-07	No.: RG176003e
Version	Modified Points or Symptom Corrected		
1.04	Symptom corrected: 1. PCL jobs containing character codes that are not on the font SD card, might cause the device to stall. 2. Jobs containing bitmapped PCL fonts might cause the device to stall. 3. When the job is created using SAP DeviceType or Barcode & OCR package for SAP System DT, the following issues will occur. - When sending a BOP job, the printer status stays at "Processing" and the job is not printed. - Memory leak occurs when printing a bitmap font with insufficient memory condition.		
1.03	The firmware version was changed to v1.03, in accordance with the release of System firmware v1.03. (the contents of the Printer firmware were not changed).		
1.02	The firmware version was changed to v1.02, in accordance with the release of System firmware v1.02. (the contents of the Printer firmware were not changed).		
1.01	1st Mass production.		

Reissued: 25-Dec-07

Model: S-P1	Date: 15-Jan-07	No.: RG176005e
-------------	-----------------	----------------

RTB Reissue

The items in ***bold italics*** have been added.

Subject: Firmware Release Note: System		Prepared by: Y.Murata	
From: 1st Tech. Support Sec. Service Support Dept.			
Classification:	<input type="checkbox"/> Troubleshooting <input type="checkbox"/> Mechanical <input type="checkbox"/> Paper path <input checked="" type="checkbox"/> Other ()	<input type="checkbox"/> Part information <input type="checkbox"/> Electrical <input type="checkbox"/> Transmit/receive	<input type="checkbox"/> Action required <input type="checkbox"/> Service manual revision <input type="checkbox"/> Retrofit information

This RTB has been issued to announce the firmware release information for the System.

Version	Program No.	Effective Date
1.06	G1765430E	Dec 2007 production
1.05	G1765430D	Aug 2007 production
1.04	G1765430C	July 2007 production
1.03	G1765430B	June 2007 production
1.02	G1765430A	April 2007 production
1.01	G1765430	1st Mass production.

Version	Modified Points or Symptom Corrected
1.06	<p><i>Symptom corrected:</i></p> <ol style="list-style-type: none"> <i>Some mainframe error messages are not displayed in multiple languages.</i> <i>SC868 occurs when the power is turned ON if there is an SD card inserted in the machine slot.</i> <i>An RFU that was interrupted by the power turning off cannot be retried, even after the machine is rebooted.</i> <i>There is no error message displayed when the AIO cartridge is not installed.</i> <i>The device might not be able to access the network under the following conditions (FPR#RC07050005):</i> <ul style="list-style-type: none"> <i>The device is connected to a hub that has link flapping enabled.</i> <i>The device "Ethernet speed" is not "Auto".</i> <i>2 separate jobs are stored on the HDD as a single job with overlapping page images. This can only happen if all of the following conditions occur:</i> <ol style="list-style-type: none"> <i>The device stalls while the first job is being stored to the HDD.</i> <i>After the stall, the printer is rebooted and another job is submitted for storage.</i> <i>The first and second store must be to/from the same application (Copy/Scanner/Printer).</i>
1.05	<p>Other changes:</p> <p>Machine warm-up time was shortened by about five seconds (some unnecessary procedures at power on were deleted).</p> <p>Important: To apply the above change, you also need to update the Printer firmware to v1.05 or later.</p>

Reissued: 25-Dec-07

Model: S-P1		Date: 15-Jan-07	No.: RG176005e
Version	Modified Points or Symptom Corrected		
1.04	Symptom correction: If the machine power is turned OFF during an RFU (remote firmware update) to a machine that has the Data Security Module installed, the RFU does not resume the next time the machine is turned ON.		
1.03	Symptom corrected: Incorrect user names and user codes are listed in the log for Document Server files printed out.		
1.02	Symptom corrected: The "Lanier" model name was missing from the PnP (Plug and Play) SP setting.		
1.01	1st Mass production.		

Reissued: 06-Feb-08

Model: S-P1	Date: 15-Jan-07	No.: RG176003f
-------------	-----------------	----------------

RTB Reissue

The items in ***bold italics*** have been added.

Subject: Firmware Release Note: Printer		Prepared by: Y.Murata	
From: 1st Tech. Support Sec. Service Support Dept.			
Classification:	<input type="checkbox"/> Troubleshooting	<input type="checkbox"/> Part information	<input type="checkbox"/> Action required
	<input type="checkbox"/> Mechanical	<input type="checkbox"/> Electrical	<input type="checkbox"/> Service manual revision
	<input type="checkbox"/> Paper path	<input type="checkbox"/> Transmit/receive	<input type="checkbox"/> Retrofit information
	<input checked="" type="checkbox"/> Other ()		

This RTB has been issued to announce the firmware release information for the Printer.

Version	Program No.	Effective Date
<i>1.08</i>	<i>G1765440F</i>	<i>Sep 2008 production</i>
1.06	G1765440E	Dec 2007 production
1.05	G1765440D	Aug 2007 production
1.04	G1765440C	July 2007 production
1.03	G1765440B	June 2007 production
1.02	G1765440A	April 2007 production
1.01	G1765440	1st Mass production.

Version	Modified Points or Symptom Corrected
<i>1.08</i>	<i>The firmware version was changed to v1.08, in accordance with the release of System firmware v1.08 (the contents of the Printer firmware were not changed).</i>
1.06	Symptom corrected: 1. Various printing anomalies when printing PowerPoint2007 jobs that have Autoshapes and shadows. This can occur if printing with both of the following RPCS driver settings: - Resolution: 1800 x 600 dpi - Job Load Distribution: Shift load to driver 2. PCL jobs containing fonts with a number of characters that is evenly divisible by 256, might cause the device to stall. (GFPR#RE0706006, RA07090001) 3. Subsequent PCL jobs will be canceled after the device prints a large number of jobs (more than 2000) submitted by the PCL 6 driver. (GFPR#RE07080008)
1.05	Other changes: Machine warm-up time was shortened by about five seconds (some unnecessary procedures at power on were deleted). Important: To apply the above change, you also need to update the Printer firmware to v1.05 or later.

Reissued: 06-Feb-08

Model: S-P1		Date: 15-Jan-07	No.: RG176003f
Version	Modified Points or Symptom Corrected		
1.04	Symptom corrected: 1. PCL jobs containing character codes that are not on the font SD card, might cause the device to stall. 2. Jobs containing bitmapped PCL fonts might cause the device to stall. 3. When the job is created using SAP DeviceType or Barcode & OCR package for SAP System DT, the following issues will occur. - When sending a BOP job, the printer status stays at "Processing" and the job is not printed. - Memory leak occurs when printing a bitmap font with insufficient memory condition.		
1.03	The firmware version was changed to v1.03, in accordance with the release of System firmware v1.03. (the contents of the Printer firmware were not changed).		
1.02	The firmware version was changed to v1.02, in accordance with the release of System firmware v1.02. (the contents of the Printer firmware were not changed).		
1.01	1st Mass production.		

Reissued: 05-Feb-08

Model: S-P1	Date: 15-Jan-07	No.: RG176004b
-------------	-----------------	----------------

RTB Reissue

The items in bold italics have been added.

Subject: Firmware Release Note: Web Support		Prepared by: Y.Murata	
From: 1st Tech. Support Sec. Service Support Dept.			
Classification:	<input type="checkbox"/> Troubleshooting <input type="checkbox"/> Mechanical <input type="checkbox"/> Paper path <input checked="" type="checkbox"/> Other ()	<input type="checkbox"/> Part information <input type="checkbox"/> Electrical <input type="checkbox"/> Transmit/receive	<input type="checkbox"/> Action required <input type="checkbox"/> Service manual revision <input type="checkbox"/> Retrofit information

This RTB has been issued to announce the firmware release information for the Web Support.

Version	Program No.	Effective Date
1.03	G1765433B	<i>September 2008 production</i>
1.01	G1765433A	June 2007 production
1.00	G1765433	1st Mass production.

Version	Modified Points or Symptom Corrected
1.03	<p><i>Symptom corrected:</i></p> <p><i>1. Logged in users can change WIM's "Configuration > System> Device Name" setting without being granted the necessary privileges.</i></p> <p><i>Other changes:</i></p> <p><i>1. The new WLAN card is now available. (TechMail#OTS-2008-543)</i> <i>Note: To use this new card, System firmware (version 1.08 or later), Websys firmware (version 1.03) and NCS firmware (version 6.10 or later) needs to be applied to the device.</i></p>
1.01	<p>Symptom corrected:</p> <p>1. WebImageMonitor contained wording errors.</p> <ul style="list-style-type: none"> - "Aantal geregistreerden" was shown as "Nummer geregistreerde" in Dutch. - "RC Gate Firmware bijwerken" was shown as "RS Gate Firmware bijwerken" in Dutch. - "Type de papier standard" was shown as "Type de papier utilisateur" in French. <p>2. The XSS vulnerability on WIM. (TechMail#OTS-2007-2118)</p> <p>3. Using WebImageMonitor in the Safari browser, address book back-up files cannot be downloaded.</p>
1.00	1st Mass production.

Reissued: 06-Feb-08

Model: S-P1	Date: 15-Jan-07	No.: RG176005f
-------------	-----------------	----------------

RTB Reissue

The items in ***bold italics*** have been added.

Subject: Firmware Release Note: System		Prepared by: Y.Murata	
From: 1st Tech. Support Sec. Service Support Dept.			
Classification:	<input type="checkbox"/> Troubleshooting <input type="checkbox"/> Part information <input type="checkbox"/> Action required		
	<input type="checkbox"/> Mechanical <input type="checkbox"/> Electrical <input type="checkbox"/> Service manual revision		
	<input type="checkbox"/> Paper path <input type="checkbox"/> Transmit/receive <input type="checkbox"/> Retrofit information		
	<input checked="" type="checkbox"/> Other ()		

This RTB has been issued to announce the firmware release information for the System.

Version	Program No.	Effective Date
1.08	G1765430F	Sep 2008 production
1.06	G1765430E	Dec 2007 production
1.05	G1765430D	Aug 2007 production
1.04	G1765430C	July 2007 production
1.03	G1765430B	June 2007 production
1.02	G1765430A	April 2007 production
1.01	G1765430	1st Mass production.

Version	Modified Points or Symptom Corrected
1.08	<i>Other changes:</i> <i>1. The new WLAN card is now available. (TechMail#OTS-2008-543)</i> <i>Note: To use this new card, System firmware (version 1.08 or later), Websys firmware (version 1.03) and NCS firmware (version 6.10 or later) needs to be applied to the device.</i>
1.06	Symptom corrected: 1. Some mainframe error messages are not displayed in multiple languages. 2. SC868 occurs when the power is turned ON if there is an SD card inserted in the machine slot. 3. An RFU that was interrupted by the power turning off cannot be retried, even after the machine is rebooted. 4. There is no error message displayed when the AIO cartridge is not installed. 5. Device might not be able to access the network under the following conditions (FPR#RC07050005): - The device is connected to a HUB that has link flapping enabled. - The device "Ethernet speed" is not "Auto". 6. 2 separate jobs are stored on the HDD as a single job with overlapping page images. This can only happen if all of the following conditions occur: 1. The device stalls while the first job is being stored to the HDD. 2. After the stall, the printer is rebooted and another job is submitted for storage. 3. The first and second store must be to/from the same application (Copy/Scanner/Printer).

Reissued: 06-Feb-08

Model: S-P1		Date: 15-Jan-07	No.: RG176005f
Version	Modified Points or Symptom Corrected		
1.05	Other changes: Machine warm-up time was shortened by about five seconds (some unnecessary procedures at power on were deleted). Important: To apply the above change, you also need to update the Printer firmware to v1.05 or later.		
1.04	Symptom correction: If the machine power is turned OFF during an RFU (remote firmware update) to a machine that has the Data Security Module installed, the RFU does not resume the next time the machine is turned ON.		
1.03	Symptom corrected: Incorrect user names and user codes are listed in the log for Document Server files printed out.		
1.02	Symptom corrected: The "Lanier" model name was missing from the PnP (Plug and Play) SP setting.		
1.01	1st Mass production.		

Reissued: 20-Feb-08

Model: S-P1	Date: 15-Jan-07	No.: RG176006c
-------------	-----------------	----------------

RTB Reissue

The items in bold italics have been added.

Subject: Firmware Release Note: Network Support		Prepared by: Y.Murata	
From: 1st Tech. Support Sec. Service Support Dept.			
Classification:	<input type="checkbox"/> Troubleshooting	<input type="checkbox"/> Part information	<input type="checkbox"/> Action required
	<input type="checkbox"/> Mechanical	<input type="checkbox"/> Electrical	<input type="checkbox"/> Service manual revision
	<input type="checkbox"/> Paper path	<input type="checkbox"/> Transmit/receive	<input type="checkbox"/> Retrofit information
	<input checked="" type="checkbox"/> Other ()		

This RTB has been issued to announce the firmware release information for the Network Support.

Version	Program No.	Effective Date
6.10	G1765432C	<i>February 2008 production</i>
6.06	G1765432B	August 2007 production
6.04	G1765432A	June 2007 production
6.02	G1765432	1st Mass production.

Version	Modified Points or Symptom Corrected
6.10	<p><i>Symptom corrected:</i></p> <ol style="list-style-type: none"> <i>The machine freezes and displays "Processing..." if a print job is performed with USB connection disabled.</i> <i>LPR jobs containing a ustatus readback will cause devices to stall if the USB interface is disabled. "Processing" will be displayed in the operation panel. (FPR# RC07050011)</i> <i>The device will stall if a PCL job is submitted via sftp while the printer spooler (off by default) or sftp spooler (on by default) are stopped.</i> <i>Jobs submitted from Mac OS via AppleTalk might result in an error or be discarded completely by the printer.</i> <i>An SSL2.0 client code fails to properly check for NULL (CVE-2006-4343). (TechMail#OTS-2008-185)</i> <i>Multiple RSA implementations fail to properly handle signatures (CVE-2006-4339). (TechMail#OTS-2008-276)</i> <i>The connection to a WLAN might be dropped if the device has been connected for an extended period of time and was authenticated using WPA.</i> <i>If WLAN is enabled, an SC991 might be displayed on the Operation Panel if either of the following settings are changed:</i> <ul style="list-style-type: none"> <i>The Ethernet Speed is changed to any setting except "Auto Select", from the operation panel.</i> <i>The Communication Mode is changed to "Ad hoc mode" and then User Tools is exited.</i> <i>The Interface Speed in NIB summary will be shown as "Link down" if WLAN is enabled.</i>

Reissued: 20-Feb-08

Model: S-P1		Date: 15-Jan-07	No.: RG176006c
Version	Modified Points or Symptom Corrected		
	Other changes: 1. The new WLAN card is now available. (TechMail#OTS-2008-543) Note: To use this new card, System firmware (version 1.08 or later), Websys firmware (version 1.03) and NCS firmware (version 6.10 or later) needs to be applied to the device.		
6.06	Symptom corrected: 1. The performance of WIM might be reduced if SSDP is enabled on the device.		
6.04	Symptom corrected: 1. A 404 error will be returned by WIM after the "Date and time" setting is configured via a Web SmartDeviceMonitor ver.2.x Batch Configuration. 2. The device will not be registered with a DNS server by a DHCP relay agent. 3. The device fails to renew with the DDNS server, it will not try again. 4. IPP clients might not print to devices that joined the network using mDNS (Bonjour).		
6.02	1st Mass production.		

Model: S-P1L	Date: 20-Feb-08	No.: RG176009
---------------------	-----------------	---------------

Subject: Firmware Release Note: Engine		Prepared by: M.Ishihara	
From: 1st Tech. Support Sec. Service Support Dept.			
Classification:	<input type="checkbox"/> Troubleshooting	<input type="checkbox"/> Part information	<input type="checkbox"/> Action required
	<input type="checkbox"/> Mechanical	<input type="checkbox"/> Electrical	<input type="checkbox"/> Service manual revision
	<input type="checkbox"/> Paper path	<input type="checkbox"/> Transmit/receive	<input type="checkbox"/> Retrofit information
	<input checked="" type="checkbox"/> Other ()		

This RTB has been issued to announce the firmware release information for the **Engine**.

Version	Program No.	Effective Date
1.00	G1755113	1st Mass production.

Version	Modified Points or Symptom Corrected
1.00	1st Mass production.

Reissued: 11-Mar-09

Model: S-P1L	Date: 20-Feb-08	No.: RG176010c
--------------	-----------------	----------------

RTB Reissue

 The items in ***bold italics*** have been added.

Subject: Firmware Release Note: Printer		Prepared by: Y.Gaman	
From: 1st Tech. Support Sec. Service Support Dept.			
Classification:	<input type="checkbox"/> Troubleshooting	<input type="checkbox"/> Part information	<input type="checkbox"/> Action required
	<input type="checkbox"/> Mechanical	<input type="checkbox"/> Electrical	<input type="checkbox"/> Service manual revision
	<input type="checkbox"/> Paper path	<input type="checkbox"/> Transmit/receive	<input type="checkbox"/> Retrofit information
	<input checked="" type="checkbox"/> Other ()		

 This RTB has been issued to announce the firmware release information for the **Printer**.

Version	Program No.	Effective Date
1.02	G1765540B	Mar 2009 production
1.01	G1765540A	July 2008 production
1.00	G1765540	1st Mass production.

Version	Modified Points or Symptom Corrected
1.02	<p>Symptom corrected:</p> <p>1. The device function used to rotate a job by 180 degrees will have no effect in either of the following situations:</p> <ul style="list-style-type: none"> - Printing from the bypass tray or a tray containing slip sheets or cover sheets. - Finishing functions including duplex and collate are cancelled by the device during printing. <p>Note: This problem doesn't affect the driver's rotation function.</p> <p>2.</p> <ul style="list-style-type: none"> - The PCL5 line pitch might be printed larger than the original. - The printable area of a PCL5 page might extend beyond the border on the right side. <p>Other changes:</p> <p>The following error messages were deleted from the operation panel display, as it is not necessary to notify end users of these conditions (and therefore would be confusing):</p> <p>"Proxy setting or connection error" (embedded type)</p> <p>"RC Gate connection Error" (external box)</p>
1.01	(Minor changes applied).
1.00	1st Mass production.

Reissued: 30-Jun-08

Model: S-P1L	Date: 20-Feb-08	No.: RG176011b
--------------	-----------------	----------------

RTB Reissue

The items in ***bold italics*** have been added.

Subject: Firmware Release Note: System		Prepared by: Y.Yoshida	
From: 1st Tech. Support Sec. Service Support Dept.			
Classification:	<input type="checkbox"/> Troubleshooting <input type="checkbox"/> Mechanical <input type="checkbox"/> Paper path <input checked="" type="checkbox"/> Other ()	<input type="checkbox"/> Part information <input type="checkbox"/> Electrical <input type="checkbox"/> Transmit/receive	<input type="checkbox"/> Action required <input type="checkbox"/> Service manual revision <input type="checkbox"/> Retrofit information

This RTB has been issued to announce the firmware release information for the **System**.

Version	Program No.	Effective Date
<i>1.01</i>	<i>G1765530A</i>	<i>July 2008 production</i>
1.00	G1765530	1st Mass production.

Version	Modified Points or Symptom Corrected
<i>1.01</i>	<i>The firmware was modified to support Engine v2.0.0 and newer.</i> <i>Important: If you want to install Engine firmware v2.00 or later via firmware update (and not by board replacement), you must first update the System firmware to v1.01 or later. If you do not, the Engine firmware update will fail.</i>
1.00	1st Mass production.

Model: General		Date: 12-Mar-08	No.: RGene027
Subject: New Wireless LAN Option		Prepared by: H.K.	
From: 1st Tech. Support Sec. Service Support Dept.			
Classification:	<input type="checkbox"/> Troubleshooting <input type="checkbox"/> Mechanical <input type="checkbox"/> Paper path <input type="checkbox"/> Product Safety	<input type="checkbox"/> Part information <input type="checkbox"/> Electrical <input type="checkbox"/> Transmit/receive <input type="checkbox"/> Other ()	<input checked="" type="checkbox"/> Action required <input checked="" type="checkbox"/> Service manual revision <input type="checkbox"/> Retrofit information

Important Information on the Release of a New Wireless LAN Option

Overview

1. Production of a new wireless LAN option, the **IEEE 802.11b Interface Unit Type N**, began in March 2008. This will replace the current wireless LAN options listed below, as the vendor discontinued production on a key part contained in these options.
2. Make sure to see below for the target models and action in the field, including the necessary firmware versions.

Details

1. Discontinued wireless LAN options:

for US

Code	EDP	Description	Note
B736-06	412176	IEEE 802.11b Interface Unit Type E	discontinued in 1st 2007
G813-01	402345	802.11b Interface Unit Type F	discontinued in 1st 2007 due to country origin issue
G813-08	403019	802.11b Interface Unit Type F	change from EDP:402345
G813-04	402378	IEEE802.11b Interface Unit Type H	discontinued in 1st 2007 due to country origin issue
G813-07	403018	IEEE802.11b Interface Unit Type H	change from EDP:402378
G874-39	402631	IEEE802.11b Interface Unit Type I	discontinued in 1st 2007 due to country origin issue
G874-48	403017	IEEE802.11b Interface Unit Type I	change from EDP:402631

for EU and Asia

Code	EDP	Description	Note
B736-07	412177	IEEE 802.11b Interface Unit Type E	discontinued in 1st 2007
G813-02	402358	802.11b Interface Unit Type F	discontinued in 1st 2007 due to country origin issue
G813-10	403020	802.11b Interface Unit Type F	change from EDP:402358
G813-05	402379	IEEE802.11b Interface Unit Type H	discontinued in 1st 2006 due to RoHS
G813-45	412996	IEEE802.11b Interface Unit Type H	discontinued in 1st 2007 due to country origin issue
G813-09	414421	IEEE802.11b Interface Unit Type H	change from EDP:412996

2. Specifications of the new wireless LAN option:



Print_B7367059.pc

Specification Sheet:

Model Name: IEEE 802.11b Interface Unit Type N
 Machine code: B736-16
 EDP code: 414525
 Package: All-in-one (PCB, LAN card, and cover are pre-assembled)
 Channel freq. range: 2412 MHz to 2462 MHz (11ch.)
 Transmission speed: 1Mbps, 2Mbps, 5.5 Mbps, 11Mbps

Model: General

Date: 12-Mar-08

No.: RGene027

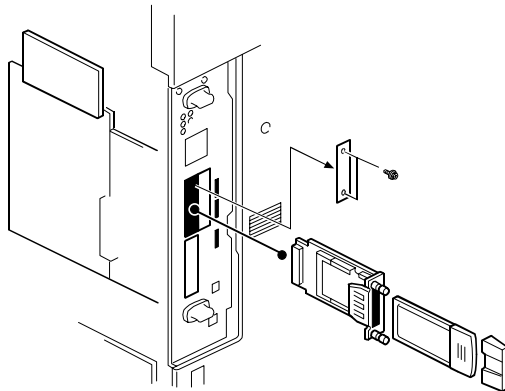

Previous types:
PCB, LAN card, and cover are
separate

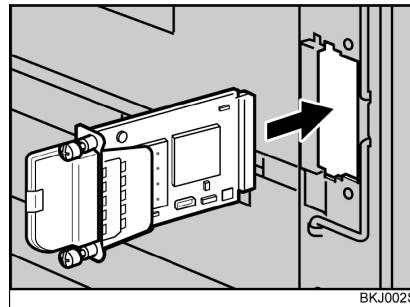

New Type (IEEE802.11b
Interface Unit Type N):
Pre-assembled

Action in the Field

1. MFP Models

Update the firmware on the target MFP models to the necessary versions at the installation.

See “Target Models” below.

2. LP Models

Update the firmware on the target LP models to the necessary versions if the customer requests it. The following notice to customers (from the Operating Instructions) lists the firmware versions necessary to use the new wireless LAN option. If a firmware update is necessary, the customer contacts their sales or service representative.

See “Target Models” below.

Notice to users (excerpt on next page):



print_B7367058.pdf

Excerpt from the Operating Instructions for LP models
Installing the Optional Wireless LAN Interface Unit
Important:

- Before handling the wireless LAN interface unit, ground yourself by touching something metal to discharge any static electricity. Static electricity can damage the wireless LAN interface unit.
 - Do not subject the wireless LAN interface unit to physical shocks.
1. Turn off the power of the printer, and then unplug the power cable and the interface cable.
 2. Remove the two screws from the interface unit's slot cover, and then remove the slot cover.
The removed cover is not used when installing the wireless LAN interface unit. Keep it for possible future use.

For details about the location of the interface unit slot, see the manual provided with your printer.

3. Attach the wireless LAN interface unit.

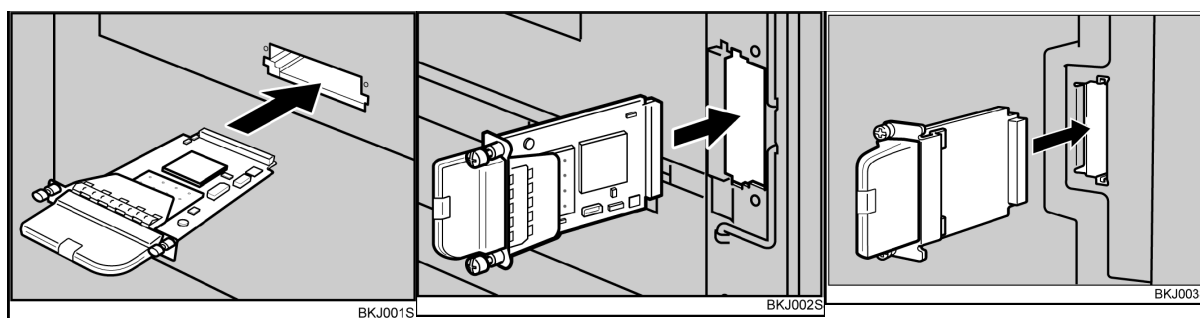

Insert the end of the wireless LAN interface unit into the slot.

Slot types vary according to device. For details, see the manual provided with your printer.

4. Fasten the wireless LAN interface unit to the controller board with the two screws.
Check the wireless LAN interface unit is connected firmly to be controller board.

Note

- Use a coin or similar object if the screws do not turn easily.
- After finishing installation, you can check the wireless LAN interface unit is properly installed: Print the configuration page from the [List / Test Print] menu. If it is installed properly, the name of wireless LAN interface unit will appear for "Device Connection" on the configuration page.
- If the wireless LAN interface unit is not installed properly, reinstall it following this procedure. If you cannot install it properly even after attempting reinstallation, contact your sales or service representative.
- You need to make settings with the control panel before using the wireless LAN interface unit. For more information, see the manual provided with your printer.

Model: General

Date: 12-Mar-08

No.: RGene027

Checking the Connection

To check the connection, use the two lights on the optional wireless LAN interface unit.

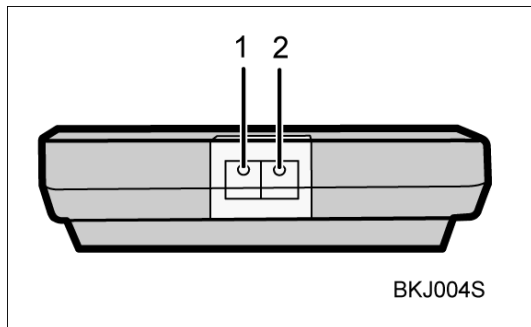

1. The orange light indicates normal network connectivity.
2. The green light indicates that the optional wireless LAN interface unit is properly powered.

If both lights are lit, the wireless connection is fully operational.

Model: General

Date: 12-Mar-08

No.: RGene027

Target Models

MFP

	Model	System firmware	NCS firmware	Websys firmware	Applied to the production line
01.	Athena-C1/C1k	1.68	5.17	1.12	2008 February
02.	Apollon-C1	1.67	5.17	1.09	2008 February
03.	Pegasus-C1	(1.31)	(5.17)	(1.08)	2008 March
04.	Kir-C3(GW)	1.08	6.14	1.07	2008 March
05.	Stella-C3(GW)	1.05	6.14	1.06	2008 March
06.	Parisian-C1(GW)	1.02	6.14	1.03	2008 March
07.	Neptune-C2	(2.00)	(6.10)	(1.08)	2008 May
08.	Martini-C3.5	3.01	5.56	2.03	2008 April

Note:

- The old wireless LAN options can be used with both the old and new firmware.
- The following models only support the old wireless LAN options:
Bellini-C3, Themis-C1, Adonis-C4.5, Russian-C4.5, Jupiter-C2, Martini-C2.5, Martini-C3

LP

	Model	System firmware	NCS firmware	Websys firmware	Applied to the production line
01.	Gaia-P2	(1.12)	T.B.D	T.B.D	2008 April
02.	Gaia-P2L	(1.01)	T.B.D	T.B.D	2008 April
03.	Apollon-P1d	1.07	6.05.7	1.03	2008 March
04.	Adonis-P4	(1.08)	T.B.D	T.B.D	2008 April
05.	Martini-P2	(1.10)	T.B.D	T.B.D	2008 April
06.	Sincere-P1	1.08*	6.10	1.03	2008 February
07.	Neptune-P1	T.B.D	T.B.D	T.B.D	2008 May

Note:

- The old wireless LAN options can be used with both the old and new firmware.
- The following models only support the old wireless LAN options:
Kir-P4, Ares-P2, Jupiter-P4
- *: The notice to customers for Sincere -P1 mentions “version 1.07” for the System firmware, but 1.07 was not used for the production. The correct version is 1.08.

Reissued: 30-Jun-08

Model: S-P1L	Date: 20-Feb-08	No.: RG176009b
--------------	-----------------	----------------

RTB Reissue

The items in ***bold italics*** have been added.

Subject: Firmware Release Note: Engine		Prepared by: Y.Yoshida	
From: 1st Tech. Support Sec. Service Support Dept.			
Classification:	<input type="checkbox"/> Troubleshooting <input type="checkbox"/> Mechanical <input type="checkbox"/> Paper path <input checked="" type="checkbox"/> Other ()	<input type="checkbox"/> Part information <input type="checkbox"/> Electrical <input type="checkbox"/> Transmit/receive	<input type="checkbox"/> Action required <input type="checkbox"/> Service manual revision <input type="checkbox"/> Retrofit information

This RTB has been issued to announce the firmware release information for the **Engine**.

Version	Program No.	Effective Date
<i>2.00</i>	<i>G1755113A</i>	<i>July 2008 production</i>
1.00	G1755113	1st Mass production.

Version	Modified Points or Symptom Corrected
<i>2.00</i>	<i>Other changes:</i> <i>Idle rotation of the registration clutch is not performed while the transfer roller is being cleaned.</i> <i>Important: If you want to install Engine firmware v2.00 or later via firmware update (and not by board replacement), you must first update the System firmware to v1.01 or later. If you do not, the Engine firmware update will fail.</i>
1.00	1st Mass production.

Model: S-P1L		Date: 23-July-08	No.: RG176012
Subject: Notes when update Engine firmware		Prepared by: Y,Gaman	
From: 1st Tech. Support Sec. Service Support Dept.			
Classification:	<input type="checkbox"/> Troubleshooting <input type="checkbox"/> Mechanical <input type="checkbox"/> Paper path <input type="checkbox"/> Product Safety	<input type="checkbox"/> Part information <input type="checkbox"/> Electrical <input type="checkbox"/> Transmit/receive <input type="checkbox"/> Other ()	<input checked="" type="checkbox"/> Action required <input type="checkbox"/> Service manual revision <input type="checkbox"/> Retrofit information <input checked="" type="checkbox"/> Tier 2

Important Note:

If you want to install Engine firmware **v2.00 or later via firmware update**, before you do this, **update the System firmware to v1.01 or later first**. If you do not, the Engine firmware update will fail.

Note: You do not have to do this when you replace the board. This only applies when you update the firmware only.

This is written in the RTB, "Firmware Release Note: Engine" as below

Version	Program No.	Effective Date
2.00	G1755113A	July 2008 production
1.00	G1755113	1st Mass production.

Version	Modified Points or Symptom Corrected
2.00	<p>Other changes: <i>Idle rotation of the registration clutch is not performed while the transfer roller is being cleaned.</i></p> <p>Important: <i>If you want to install Engine firmware v2.00 or later via firmware update (and not by board replacement), you must first update the System firmware to v1.01 or later. If you do not, the Engine firmware update will fail.</i></p>
1.00	1st Mass production.

Reissued: 01-Aug-08

Model: S-P1	Date: 15-Jan-07	No.: RG176001b
-------------	-----------------	----------------

RTB Reissue

The items in bold italics have been changed.

This RTB is only for S-P1b. (31ppm)

Subject: Firmware Release Note: Engine for S-P1b (31ppm)		Prepared by: Y.Yoshida	
From: 1st Tech. Support Sec. Service Support Dept.			
Classification:	<input type="checkbox"/> Troubleshooting <input type="checkbox"/> Mechanical <input type="checkbox"/> Paper path <input checked="" type="checkbox"/> Other ()	<input type="checkbox"/> Part information <input type="checkbox"/> Electrical <input type="checkbox"/> Transmit/receive	<input type="checkbox"/> Action required <input type="checkbox"/> Service manual revision <input type="checkbox"/> Retrofit information

This RTB has been issued to announce the firmware release information for the Engine.

Version	Program No.	Effective Date
1.02.0	G1755112C	August 2008 production
1.01.0	G1755112B	March 2007 production
01.00.00	G1755112A	1st Mass production.

Version	Modified Points or Symptom Corrected
1.02.0	<i>Other changes: Idle rotation of the registration clutch is not performed anymore when the transfer roller is cleaned, in order to minimize noise from the machine.</i>
1.01.0	Other changes: Improved the registration along the paper feed direction for thick paper.
01.00.00	1st Mass production.

Reissued: 01-Aug-08

Model: S-P1	Date: 15-Jan-07	No.: RG176002b
-------------	-----------------	----------------

RTB Reissue

The items in bold italics have been changed.

This RTB is only for S-P1c. (36ppm)

Subject: Firmware Release Note: Engine for S-P1c (36ppm)		Prepared by: Y.Yoshida	
From: 1st Tech. Support Sec. Service Support Dept.			
Classification:	<input type="checkbox"/> Troubleshooting	<input type="checkbox"/> Part information	<input type="checkbox"/> Action required
	<input type="checkbox"/> Mechanical	<input type="checkbox"/> Electrical	<input type="checkbox"/> Service manual revision
	<input type="checkbox"/> Paper path	<input type="checkbox"/> Transmit/receive	<input type="checkbox"/> Retrofit information
	<input checked="" type="checkbox"/> Other ()		

This RTB has been issued to announce the firmware release information for the Engine.

Version	Program No.	Effective Date
1.02.0	G1755111C	August 2008 production
1.01.0	G1755111B	March 2007 production
01.00.00	G1755111A	1st Mass production.

Version	Modified Points or Symptom Corrected
1.02.0	Other changes: <i>Idle rotation of the registration clutch is not performed anymore when the transfer roller is cleaned, in order to minimize noise from the machine.</i>
1.01.0	Other changes: Improved the registration along the paper feed direction for thick paper.
01.00.00	1st Mass production.

Model: S-P1	Date: 29-Sep-08	No.: RG176013
--------------------	-----------------	---------------

This RTB is only for the S-P1b Taiwan model.

Subject: Firmware Release Note: Engine for S-P1b Taiwan model.		Prepared by: Y.Gaman	
From: 1st Tech. Support Sec. Service Support Dept.			
Classification:	<input type="checkbox"/> Troubleshooting	<input type="checkbox"/> Part information	<input type="checkbox"/> Action required
	<input type="checkbox"/> Mechanical	<input type="checkbox"/> Electrical	<input type="checkbox"/> Service manual revision
	<input type="checkbox"/> Paper path	<input type="checkbox"/> Transmit/receive	<input type="checkbox"/> Retrofit information
	<input checked="" type="checkbox"/> Other ()		

This RTB has been issued to announce the firmware release information for the Engine.

Version	Program No.	Effective Date
1.02	G1755114	1st Mass production.

Version	Modified Points or Symptom Corrected
1.02	1st Mass production.

Model: S-P1	Date: 29-Sep-08	No.: RG1760014
--------------------	-----------------	----------------

This RTB is only for the S-P1b Taiwan model.

Subject: Firmware Release Note: Web Support for S-P1b Taiwan model.		Prepared by: Y.Gaman	
From: 1st Tech. Support Sec. Service Support Dept.			
Classification:	<input type="checkbox"/> Troubleshooting <input type="checkbox"/> Mechanical <input type="checkbox"/> Paper path <input checked="" type="checkbox"/> Other ()	<input type="checkbox"/> Part information <input type="checkbox"/> Electrical <input type="checkbox"/> Transmit/receive	<input type="checkbox"/> Action required <input type="checkbox"/> Service manual revision <input type="checkbox"/> Retrofit information

This RTB has been issued to announce the firmware release information for the Web Support.

Version	Program No.	Effective Date
1.50	G1765633	1st Mass production.

Version	Modified Points or Symptom Corrected
1.50	1st Mass production.

Reissued: 15-Apr-09

Model: S-P1	Date: 29-Sep-08	No.: RG176015a
-------------	-----------------	----------------

This RTB is only for S-P1b Taiwan model.

Subject: Firmware Release Note: System for S-P1b Taiwan model.		Prepared by: Y.Gaman	
From: 1st Tech. Support Sec. Service Support Dept.			
Classification:	<input type="checkbox"/> Troubleshooting <input type="checkbox"/> Mechanical <input type="checkbox"/> Paper path <input checked="" type="checkbox"/> Other ()	<input type="checkbox"/> Part information <input type="checkbox"/> Electrical <input type="checkbox"/> Transmit/receive	<input type="checkbox"/> Action required <input type="checkbox"/> Service manual revision <input type="checkbox"/> Retrofit information

This RTB has been issued to announce the firmware release information for the System.

Version	Program No.	Effective Date
1.01	G1765630A	March 2009 production
1.00	G1765630	1st Mass production.

Version	Modified Points or Symptom Corrected
1.01	Symptom corrected: 1. The job processing speed is slower when the DataOverwriteSecurity option is installed. 2. Unwanted line might be added to the bottom of each page. 3. The wording of some @Remote-related error messages was revised. 4. The result of RFU is not informed to the @Remote center.
1.00	1st Mass production

Reissued: 10-Mar-09

Model: S-P1	Date: 29-Sep-08	No.: RG176016a
-------------	-----------------	----------------

This RTB is only for S-P1b Taiwan model.

Subject: Firmware Release Note: Printer for S-P1b Taiwan model.		Prepared by: Y.Gaman	
From: 1st Tech. Support Sec. Service Support Dept.			
Classification:	<input type="checkbox"/> Troubleshooting <input type="checkbox"/> Mechanical <input type="checkbox"/> Paper path <input checked="" type="checkbox"/> Other ()	<input type="checkbox"/> Part information <input type="checkbox"/> Electrical <input type="checkbox"/> Transmit/receive	<input type="checkbox"/> Action required <input type="checkbox"/> Service manual revision <input type="checkbox"/> Retrofit information

This RTB has been issued to announce the firmware release information for the Printer.

Version	Program No.	Effective Date
1.01	G1765640A	March 2009 production
1.00	G1765640	1st Mass production.

Version	Modified Points or Symptom Corrected
1.01	<p>Symptom corrected:</p> <p>1. The device function used to rotate a job by 180 degrees will have no effect in either of the following situations:</p> <ul style="list-style-type: none"> - Printing from the bypass tray or a tray containing slip sheets or cover sheets. - Finishing functions including duplex and collate are cancelled by the device during printing. <p>Note: This problem doesn't affect the driver's rotation function.</p> <p>2.</p> <ul style="list-style-type: none"> - The PCL5 line pitch might be printed larger than the original. - The printable area of a PCL5 page might extend beyond the border on the right side. <p>Other changes:</p> <p>The following error messages were deleted from the operation panel display, as it is not necessary to notify end users of these conditions (and therefore would be confusing):</p> <p>"Proxy setting or connection error" (embedded type)</p> <p>"RC Gate connection Error" (external box)</p>
1.00	1st Mass production.

Reissued: 06-Oct-08

Model: S-P1	Date: 15-Jan-07	No.: RG176003g
-------------	-----------------	----------------

RTB Reissue

The items in ***bold italics*** have been added.

Subject: Firmware Release Note: Printer		Prepared by: Y.Gaman	
From: 1st Tech. Support Sec. Service Support Dept.			
Classification:	<input type="checkbox"/> Troubleshooting <input type="checkbox"/> Part information <input type="checkbox"/> Action required <input type="checkbox"/> Mechanical <input type="checkbox"/> Electrical <input type="checkbox"/> Service manual revision <input type="checkbox"/> Paper path <input type="checkbox"/> Transmit/receive <input type="checkbox"/> Retrofit information <input checked="" type="checkbox"/> Other ()		

This RTB has been issued to announce the firmware release information for the Printer.

Version	Program No.	Effective Date
1.09	G1765440G	Oct 2008 production
1.08	G1765440F	Sep 2008 production
1.06	G1765440E	Dec 2007 production
1.05	G1765440D	Aug 2007 production
1.04	G1765440C	July 2007 production
1.03	G1765440B	June 2007 production
1.02	G1765440A	April 2007 production
1.01	G1765440	1st Mass production.

Version	Modified Points or Symptom Corrected
1.09	<i>Symptom corrected:</i> <i>1. Some pages are printed only on one side when duplex printing is selected:</i> <i>Other changes:</i> <i>2. Added, "orientation auto detect" to bit switch #8.</i> <i>Note: This function automatically chooses the page orientation for PostScript jobs or PDF jobs (Landscape or Portrait) based on the content.</i> <i>Please refer to RTB No.RG1760017 for details.</i>
1.08	The firmware version was changed to v1.08, in accordance with the release of System firmware v1.08. (the contents of the Printer firmware were not changed).
1.06	Symptom corrected: 1. Various printing anomalies when printing PowerPoint2007 jobs that have Autoshapes and shadows. This can occur if printing with both of the following RPCS driver settings: - Resolution: 1800 x 600 dpi - Job Load Distribution: Shift load to driver 2. PCL jobs containing fonts with a number of characters that is evenly divisible by 256, might cause the device to stall. (GFPR#RE0706006, RA07090001) 3. Subsequent PCL jobs will be canceled after the device prints a large number of jobs (more than 2000) submitted by the PCL 6 driver. (GFPR#RE07080008)

Reissued: 06-Oct-08

Model: S-P1		Date: 15-Jan-07	No.: RG176003g
Version	Modified Points or Symptom Corrected		
1.05	Other changes: Machine warm-up time was shortened by about five seconds (some unnecessary procedures at power on were deleted). Important: To apply the above change, you also need to update the Printer firmware to v1.05 or later.		
1.04	Symptom corrected: 1. PCL jobs containing character codes that are not on the font SD card, might cause the device to stall. 2. Jobs containing bitmapped PCL fonts might cause the device to stall. 3. When the job is created using SAP DeviceType or Barcode & OCR package for SAP System DT, the following issues will occur. - When sending a BOP job, the printer status stays at "Processing" and the job is not printed. - Memory leak occurs when printing a bitmap font with insufficient memory condition.		
1.03	The firmware version was changed to v1.03, in accordance with the release of System firmware v1.03. (the contents of the Printer firmware were not changed).		
1.02	The firmware version was changed to v1.02, in accordance with the release of System firmware v1.02. (the contents of the Printer firmware were not changed).		
1.01	1st Mass production.		

Model: Model S-P1		Date: 09-Oct-08	No.: RG176017
Subject: Service manual revision		Prepared by: Y.Gaman	
From: 1st Tech. Support Sec. Service Support Dept.			
Classification:	<input type="checkbox"/> Troubleshooting <input type="checkbox"/> Part information <input type="checkbox"/> Action required <input type="checkbox"/> Mechanical <input type="checkbox"/> Electrical <input checked="" type="checkbox"/> Service manual revision <input type="checkbox"/> Paper path <input type="checkbox"/> Transmit/receive <input type="checkbox"/> Retrofit information <input type="checkbox"/> Other ()		

The Service Manual was corrected as follows:

The "Orientation Auto Detect" function was added to bit switch #8.

# 8	Title	Explanation	Settings		
			0	1	Default
6	[PS]: Orientation Auto Detect Function	Automatically chooses page orientations of PostScript jobs (Landscape or Portrait) based on the content.	Enabled	Disabled	0
7	[PDF]: Orientation Auto Detect Function	Automatically chooses page orientations of PDF jobs (Landscape or Portrait) based on the content.	Enabled	Disabled	0

Important: To apply this change, you need to update the Printer firmware to **v1.09 or later**.

Model: S-P1b (Taiwan Model)		Date: 9-Oct-08	No.: RG176018
Subject: Technical information for Sincere-P1b (Taiwan)		Prepared by: Y.Yoshida	
From: 1st Tech. Support Sec. Service Support Dept.			
Classification:	<input type="checkbox"/> Troubleshooting <input type="checkbox"/> Mechanical <input type="checkbox"/> Paper path <input type="checkbox"/> Product Safety	<input type="checkbox"/> Part information <input type="checkbox"/> Electrical <input type="checkbox"/> Transmit/receive <input checked="" type="checkbox"/> Other ()	<input type="checkbox"/> Action required <input checked="" type="checkbox"/> Service manual revision <input type="checkbox"/> Retrofit information <input type="checkbox"/> Tier 2

This RTB shows the differences between the SincereP1b Taiwan Model and the NA model.

● Overview

The Taiwan model is based on the NA model. It has minor changes to fit it to the 110V power source.

- Base model: Sincere-P1b NA model
- Model Name: Ricoh Aficio SP 4100N
- Code: G176 -13
- Options: Same as Sincere-P1b

● Main Differences from the SincereP1b-NA

1. Units:

PCB and Power Supply Part Numbers

Page	Index No	Description	Part Number
27	6	PCB:CTL:Sincere-P1C:Sub-Ass'y (S-P1b/c)	G1775317
		PCB:CTL:Sincere-P1C:Sub-Ass'y (S-P1b Taiwan)	G1765313
27	10	Engine Board - LT (S-P1b)	G1755603
		Engine Board - LT (S-P1b Taiwan)	G1755119
25	106	Power Supply Code:125V 15A NA	11500373
		Power Supply Code:110V 15A Taiwan	11500409

Exterior covers (Page 2-6)

The Taiwan model uses the same exterior covers as the EU model.

2. Firmware for Taiwan model.

Engine Firmware (Version 1.02) : G1755114
 Printer Firmware (Version 1.00) : G1765640
 System Firmware (Version 1.00) : G1765630
 Web Support Firmware(Version 1.50): G1765633

3. Main Differences in the Service Manual

SP1-916-001/002 has been added to the Taiwan model to enforce fusing stability in the 110V environment. (See Sincere-P1 Service Manual 3rd edition / Page 81)

4. Training

Same as Sincere P1b at <ftp://133.139.157.43/l2e/> Sincere-P1_l2e

Model: S-P1		Date: 3-Dec-08	No.: RG176019
Subject: Service manual revision		Prepared by: Y.Gaman	
From: 1st Tech. Support Sec. Service Support Dept.			
Classification:	<input type="checkbox"/> Troubleshooting <input type="checkbox"/> Mechanical <input type="checkbox"/> Paper path <input type="checkbox"/> Product Safety	<input type="checkbox"/> Part information <input type="checkbox"/> Electrical <input type="checkbox"/> Transmit/receive <input type="checkbox"/> Other ()	<input type="checkbox"/> Action required <input checked="" type="checkbox"/> Service manual revision <input type="checkbox"/> Retrofit information <input type="checkbox"/> Tier 2

The Service Manual was corrected as follows:

Service Mode Table

SP8XXX: Data Log 2:

Delete the description for SP8781, as this model does not have this function.

Note: Instead, the counter remains at "0" after the AIO is replaced.

Reissued: 10-Mar-09

Model: S-P1	Date: 15-Jan-07	No.: RG176003h
-------------	-----------------	----------------

RTB Reissue

The items in ***bold italics*** have been added.

Subject: Firmware Release Note: Printer		Prepared by: Y.Gaman	
From: 1st Tech. Support Sec. Service Support Dept.			
Classification:	<input type="checkbox"/> Troubleshooting <input type="checkbox"/> Mechanical <input type="checkbox"/> Paper path <input checked="" type="checkbox"/> Other ()	<input type="checkbox"/> Part information <input type="checkbox"/> Electrical <input type="checkbox"/> Transmit/receive	<input type="checkbox"/> Action required <input type="checkbox"/> Service manual revision <input type="checkbox"/> Retrofit information

This RTB has been issued to announce the firmware release information for the Printer.

Version	Program No.	Effective Date
<i>1.10</i>	<i>G1765440H</i>	<i>Mar 2009 production</i>
1.09	G1765440G	Oct 2008 production
1.08	G1765440F	Sep 2008 production
1.06	G1765440E	Dec 2007 production
1.05	G1765440D	Aug 2007 production
1.04	G1765440C	July 2007 production
1.03	G1765440B	June 2007 production
1.02	G1765440A	April 2007 production
1.01	G1765440	1st Mass production.

Version	Modified Points or Symptom Corrected
<i>1.10</i>	<p><i>Symptom corrected:</i></p> <p><i>1. The device function used to rotate a job by 180 degrees will have no effect in either of the following situations:</i></p> <ul style="list-style-type: none"> - <i>Printing from the bypass tray or a tray containing slip sheets or cover sheets.</i> - <i>Finishing functions including duplex and collate are cancelled by the device during printing.</i> <p><i>Note: This problem doesn't affect the driver's rotation function.</i></p> <p><i>2.</i></p> <ul style="list-style-type: none"> - <i>The PCL5 line pitch might be printed larger than the original.</i> - <i>The printable area of a PCL5 page might extend beyond the border on the right side.</i> <p><i>Other changes:</i></p> <p><i>The following error messages were deleted from the operation panel display, as it is not necessary to notify end users of these conditions (and therefore would be confusing):</i></p> <p><i>"Proxy setting or connection error" (embedded type)</i></p> <p><i>"RC Gate connection Error" (external box)</i></p>

Reissued: 10-Mar-09

Model: S-P1			Date: 15-Jan-07		No.: RG176003h																								
Version	Modified Points or Symptom Corrected																												
1.09	<p>Symptom corrected:</p> <p>1. Some pages are printed only on one side when duplex printing is selected:</p> <p>Other changes:</p> <p>2. Added, "orientation auto detect" to bitswich #8.</p> <p>Note: This function automatically chooses the page orientation for PostScript jobs or PDF jobs (Landscape or Portrait) based on the content.</p> <table><tr><th>#8</th><th>Title</th><th>Explanation</th><th colspan="2">Settings</th><th></th></tr><tr><th></th><th></th><th></th><th>0</th><th>1</th><th>default</th></tr><tr><td>6</td><td>[PS]: Orientation Auto Detect Fuction</td><td>Automatically chooses page orientations of PostScript jobs (Landscape or Portrait) based on the content.</td><td>Enabled</td><td>Disabled</td><td>0</td></tr><tr><td>7</td><td>[PDF]: Orientation Auto Detect Fuction</td><td>Automatically chooses page orientations of PDF jobs (Landscape or Portrait) based on the content.</td><td>Enabled</td><td>Disabled</td><td>0</td></tr></table>					#8	Title	Explanation	Settings						0	1	default	6	[PS]: Orientation Auto Detect Fuction	Automatically chooses page orientations of PostScript jobs (Landscape or Portrait) based on the content.	Enabled	Disabled	0	7	[PDF]: Orientation Auto Detect Fuction	Automatically chooses page orientations of PDF jobs (Landscape or Portrait) based on the content.	Enabled	Disabled	0
#8	Title	Explanation	Settings																										
			0	1	default																								
6	[PS]: Orientation Auto Detect Fuction	Automatically chooses page orientations of PostScript jobs (Landscape or Portrait) based on the content.	Enabled	Disabled	0																								
7	[PDF]: Orientation Auto Detect Fuction	Automatically chooses page orientations of PDF jobs (Landscape or Portrait) based on the content.	Enabled	Disabled	0																								
1.08	<p>The firmware version was changed to v1.08, in accordance with the release of System firmware v1.08.</p> <p>(the contents of the Printer firmware were not changed).</p>																												
1.06	<p>Symptom corrected:</p> <p>1. Various printing anomalies when printing PowerPoint2007 jobs that have Autoshapes and shadows.</p> <p>This can occur if printing with both of the following RPCS driver settings:</p> <ul style="list-style-type: none">- Resolution: 1800 x 600 dpi- Job Load Distribution: Shift load to driver <p>2. PCL jobs containing fonts with a number of characters that is evenly divisible by 256, might cause the device to stall. (GFPR#RE0706006, RA07090001)</p> <p>3. Subsequent PCL jobs will be canceled after the device prints a large number of jobs (more than 2000) submitted by the PCL 6 driver. (GFPR#RE07080008)</p>																												
1.05	<p>Other changes:</p> <p>Machine warm-up time was shortened by about five seconds (some unnecessary procedures at power on were deleted).</p> <p>Important: To apply the above change, you also need to update the Printer firmware to v1.05 or later.</p>																												
1.04	<p>Symptom corrected:</p> <p>1. PCL jobs containing character codes that are not on the font SD card, might cause the device to stall.</p> <p>2. Jobs containing bitmapped PCL fonts might cause the device to stall.</p> <p>3. When the job is created using SAP DeviceType or Barcode &OCR package for SAP System DT, the following issues will occur.</p> <ul style="list-style-type: none">- When sending a BOP job, the printer status stays at "Processing" and the job is not printed.- Memory leak occurs when printing a bitmap font with insufficient memory condition.																												
1.03	<p>The firmware version was changed to v1.03, in accordance with the release of System firmware v1.03.</p> <p>(the contents of the Printer firmware were not changed).</p>																												

Reissued: 10-Mar-09

Model: S-P1		Date: 15-Jan-07	No.: RG176003h
Version	Modified Points or Symptom Corrected		
1.02	The firmware version was changed to v1.02, in accordance with the release of System firmware v1.02. (the contents of the Printer firmware were not changed).		
1.01	1st Mass production.		

Reissued: 25-Mar-09

Model: S-P1	Date: 15-Jan-07	No.: RG176006d
-------------	-----------------	----------------

RTB Reissue

The items in bold italics have been added.

Subject: Firmware Release Note: Network Support		Prepared by: Y.Gaman	
From: 1st Tech. Support Sec. Service Support Dept.			
Classification:	<input type="checkbox"/> Troubleshooting <input type="checkbox"/> Mechanical <input type="checkbox"/> Paper path <input checked="" type="checkbox"/> Other ()	<input type="checkbox"/> Part information <input type="checkbox"/> Electrical <input type="checkbox"/> Transmit/receive	<input type="checkbox"/> Action required <input type="checkbox"/> Service manual revision <input type="checkbox"/> Retrofit information

This RTB has been issued to announce the firmware release information for the Network Support.

Version	Program No.	Effective Date
6.12	G1765432D	<i>March 2009 production</i>
6.10	G1765432C	February 2008 production
6.06	G1765432B	August 2007 production
6.04	G1765432A	June 2007 production
6.02	G1765432	1st Mass production.

Version	Modified Points or Symptom Corrected
6.12	<i>Symptom corrected:</i> <i>1. The device might not be able to access the network after the Log collection tool is run.</i> <i>2. IPP print jobs are cancelled. This happened very infrequently.</i> <i>3. After a job consisting of a multiple of exactly 8KB (8192 bytes) is submitted via IPP, the device will no longer accept any more jobs until rebooted.</i>
6.10	Symptom corrected: 1. The machine freezes and displays "Processing..." if a print job is performed with USB connection disabled. 2. LPR jobs containing an ustatus readback will cause devices to stall if the USB interface is disabled. "Processing" will be displayed in the operation panel. (FPR# RC07050011) 3. The device will stall if a PCL job is submitted via sftp while the printer spooler (off by default) or sftp spooler (on by default) is stopped. 4. Jobs submitted from Mac OS via AppleTalk might result in an error or be discarded completely by the printer. 5. An SSL2.0 client code fails to properly check for NULL (CVE-2006-4343). (TechMail#OTS-2008-185) 6. Multiple RSA implementations fail to properly handle signatures (CVE-2006-4339). (TechMail#OTS-2008-276) 7. The connection to a WLAN might be dropped if the device has been connected for an extended period of time and was authenticated using WPA. 8. If WLAN is enabled, an SC991 might be displayed on the Operation Panel if either of the following settings are changed: – The Ethernet Speed is changed to any setting except "Auto Select", from the

Reissued: 25-Mar-09

Model: S-P1		Date: 15-Jan-07	No.: RG176006d
Version	Modified Points or Symptom Corrected		
	<p>operation panel.</p> <ul style="list-style-type: none">– The Communication Mode is changed to "Ad hoc mode" and then User Tools is exited. <p>9. The Interface Speed in NIB summary will be shown as "Link down" if WLAN is enabled.</p> <p>Other changes:</p> <ol style="list-style-type: none">1. The new WLAN card is now available. (TechMail#OTS-2008-543) Note: To use this new card, System firmware (version 1.08 or later), Websys firmware (version 1.03) and NCS firmware (version 6.10 or later) needs to be applied to the device.		
6.06	<p>Symptom corrected:</p> <ol style="list-style-type: none">1. The performance of WIM might be reduced if SSDP is enabled on the device.		
6.04	<p>Symptom corrected:</p> <ol style="list-style-type: none">1. A 404 error will be returned by WIM after the "Date and time" setting is configured via a Web SmartDeviceMonitor ver.2.x Batch Configuration.2. The device will not be registered with a DNS server by a DHCP relay agent.3. The device fails to renew with the DDNS server, it will not try again.4. IPP clients might not print to devices that joined the network using mDNS (Bonjour).		
6.02	1st Mass production.		

Reissued: 15-Apr-09

Model: S-P1	Date: 15-Jan-07	No.: RG176005g
-------------	-----------------	----------------

RTB Reissue

The items in ***bold italics*** have been added.

Subject: Firmware Release Note: System		Prepared by: Y. Gaman	
From: 1st Tech. Support Sec. Service Support Dept.			
Classification:	<input type="checkbox"/> Troubleshooting	<input type="checkbox"/> Part information	<input type="checkbox"/> Action required
	<input type="checkbox"/> Mechanical	<input type="checkbox"/> Electrical	<input type="checkbox"/> Service manual revision
	<input type="checkbox"/> Paper path	<input type="checkbox"/> Transmit/receive	<input type="checkbox"/> Retrofit information
	<input checked="" type="checkbox"/> Other ()		

This RTB has been issued to announce the firmware release information for the System.

Version	Program No.	Effective Date
<i>1.10</i>	<i>G1765430G</i>	<i>Mar 2009 production</i>
1.08	G1765430F	Sep 2008 production
1.06	G1765430E	Dec 2007 production
1.05	G1765430D	Aug 2007 production
1.04	G1765430C	July 2007 production
1.03	G1765430B	June 2007 production
1.02	G1765430A	April 2007 production
1.01	G1765430	1st Mass production.

Version	Modified Points or Symptom Corrected
<i>1.10</i>	<i>Symptom corrected:</i> <ol style="list-style-type: none"> <i>The job processing speed is slower when the DataOverwriteSecurity option is installed.</i> <i>IPv6 Type 0 Route Headers allow senders to control routing (CVE-2007-2242)</i> <i>Unwanted line might be added to the bottom of each page.</i> <i>The wording of some @Remote-related error messages was revised.</i> <i>The result of RFU is not informed to the @Remote center.</i>
1.08	Other changes: <ol style="list-style-type: none"> The new WLAN card is now available. (TechMail#OTS-2008-543) Note: To use this new card, System firmware (version 1.08 or later), Websys firmware (version 1.03) and NCS firmware (version 6.10 or later) needs to be applied to the device.
1.06	Symptom corrected: <ol style="list-style-type: none"> Some mainframe error messages are not displayed in multiple languages. SC868 occurs when the power is turned ON if there is an SD card inserted in the machine slot. An RFU that was interrupted by the power turning off cannot be retried, even after the machine is rebooted. There is no error message displayed when the AIO cartridge is not installed. Device might not be able to access the network under the following conditions (FPR#RC07050005): <ul style="list-style-type: none"> The device is connected to a HUB that has link flapping enabled. The device "Ethernet speed" is not "Auto".

Reissued: 15-Apr-09

Model: S-P1		Date: 15-Jan-07	No.: RG176005g
Version	Modified Points or Symptom Corrected		
	6. 2 separate jobs are stored on the HDD as a single job with overlapping page images. This can only happen if all of the following conditions occur: 1. The device stalls while the first job is being stored to the HDD. 2. After the stall, the printer is rebooted and another job is submitted for storage. 3. The first and second store must be to/from the same application (Copy/Scanner/Printer).		
1.05	Other changes: Machine warm-up time was shortened by about five seconds (some unnecessary procedures at power on were deleted). Important: To apply the above change, you also need to update the Printer firmware to v1.05 or later.		
1.04	Symptom correction: If the machine power is turned OFF during an RFU (remote firmware update) to a machine that has the Data Security Module installed, the RFU does not resume the next time the machine is turned ON.		
1.03	Symptom corrected: Incorrect user names and user codes are listed in the log for Document Server files printed out.		
1.02	Symptom corrected: The "Lanier" model name was missing from the PnP (Plug and Play) SP setting.		
1.01	1st Mass production.		

Reissued: 15-Apr-09

Model: S-P1L	Date: 20-Feb-08	No.: RG176011c
--------------	-----------------	----------------

RTB Reissue

The items in ***bold italics*** have been added.

Subject: Firmware Release Note: System		Prepared by: Y.Gaman	
From: 1st Tech. Support Sec. Service Support Dept.			
Classification:	<input type="checkbox"/> Troubleshooting <input type="checkbox"/> Mechanical <input type="checkbox"/> Paper path <input checked="" type="checkbox"/> Other ()	<input type="checkbox"/> Part information <input type="checkbox"/> Electrical <input type="checkbox"/> Transmit/receive	<input type="checkbox"/> Action required <input type="checkbox"/> Service manual revision <input type="checkbox"/> Retrofit information

This RTB has been issued to announce the firmware release information for the **System**.

Version	Program No.	Effective Date
<i>1.02</i>	<i>G1765530B</i>	<i>Mach 2009 production</i>
1.01	G1765530A	July 2008 production
1.00	G1765530	1st Mass production.

Version	Modified Points or Symptom Corrected
<i>1.02</i>	<i>Symptom corrected:</i> <i>1. The job processing speed is slower when the DataOverwriteSecurity option is installed.</i> <i>2. Unwanted line might be added to the bottom of each page.</i> <i>3. The wording of some @Remote-related error messages was revised.</i> <i>4. The result of RFU is not informed to the @Remote center.</i>
1.01	The firmware was modified to support Engine v2.0.0 and newer. Important: If you want to install Engine firmware v2.00 or later via firmware update (and not by board replacement), you must first update the System firmware to v1.01 or later. If you do not, the Engine firmware update will fail.
1.00	1st Mass production.

Reissued: 06-Jul-09

Model: S-P1 (MICR)	Date: 16-Apr-09	No.: RG176020a
---------------------------	-----------------	----------------

RTB Reissue

The items in bold italics have been corrected.

Subject: Firmware Release Note: Printer		Prepared by: Y. Murata	
From: 1st Tech. Support Sec. Service Support Dept.			
Classification:	<input type="checkbox"/> Troubleshooting	<input type="checkbox"/> Part information	<input type="checkbox"/> Action required
	<input type="checkbox"/> Mechanical	<input type="checkbox"/> Electrical	<input type="checkbox"/> Service manual revision
	<input type="checkbox"/> Paper path	<input type="checkbox"/> Transmit/receive	<input type="checkbox"/> Retrofit information
	<input type="checkbox"/> Product Safety	<input checked="" type="checkbox"/> Other ()	<input checked="" type="checkbox"/> Tier 2

This RTB has been issued to announce the firmware release information for the **Printer** for the MICR model *1.

***1 The MICR model is unique to the Americas market only.**

Make sure not to use this firmware to update models other than MICR models.

Version	Program No.	Effective Date
1.03	G1765740A	July 2009 production
1.02	G1765740	1st Mass production

Version	Modified Points or Symptom Corrected
1.03	<i>The default setting for the Energy Saver timer was changed from 5 minutes to 1 minute.</i> <i>Symptom corrected:</i> <i>1. Jobs submitted by certain SDK applications (PDL Filter for example) might cause the device to stall.</i>
1.02	1st Mass production

Reissued: 02-Jul-09

Model: S-P1 (MICR)	Date: 16-Apr-09	No.: RG176021a
--------------------	-----------------	----------------

RTB Reissue

The items in ***bold italics*** have been added.

Subject: Firmware Release Note: System		Prepared by: Y. Murata	
From: 1st Tech. Support Sec. Service Support Dept.			
Classification:	<input type="checkbox"/> Troubleshooting	<input type="checkbox"/> Part information	<input type="checkbox"/> Action required
	<input type="checkbox"/> Mechanical	<input type="checkbox"/> Electrical	<input type="checkbox"/> Service manual revision
	<input type="checkbox"/> Paper path	<input type="checkbox"/> Transmit/receive	<input type="checkbox"/> Retrofit information
	<input type="checkbox"/> Product Safety	<input checked="" type="checkbox"/> Other ()	<input checked="" type="checkbox"/> Tier 2

This RTB has been issued to announce the firmware release information for the **System** for MICR models *1.

***1 The MICR model is unique to the Americas market only.**

Make sure not to use this firmware to update models other than MICR models.

Version	Program No.	Effective Date
<i>1.03</i>	<i>G1765730A</i>	<i>July 2009 production</i>
1.02	G1765730	1st Mass production

Version	Modified Points or Symptom Corrected
<i>1.03</i>	<i>The default setting for the Energy Saver timer was changed from 5 minutes to 1 minute.</i>
1.02	1st Mass production

Model: S-P1 (MICR)	Date: 16-Apr-09	No.: RG176022
---------------------------	-----------------	---------------

Subject: Firmware Release Note: Web Support		Prepared by: Y. Murata	
From: 1st Tech. Support Sec. Service Support Dept.			
Classification:	<input type="checkbox"/> Troubleshooting <input type="checkbox"/> Mechanical <input type="checkbox"/> Paper path <input type="checkbox"/> Product Safety	<input type="checkbox"/> Part information <input type="checkbox"/> Electrical <input type="checkbox"/> Transmit/receive <input checked="" type="checkbox"/> Other ()	<input type="checkbox"/> Action required <input type="checkbox"/> Service manual revision <input type="checkbox"/> Retrofit information <input checked="" type="checkbox"/> Tier 2

This RTB has been issued to announce the firmware release information for the **Web Support** for MICR model *1.

***1 MICR model is unique in Americas market only.**
Make sure not to update this firmware except for MICR model.

Version	Program No.	Effective Date
1.31	G1765733	1st Mass production

Version	Modified Points or Symptom Corrected
1.31	1st Mass production

Model: S-P1 (MICR)	Date: 16-Apr-09	No.: RG176023
---------------------------	-----------------	---------------

Subject: Firmware Release Note: PDL Filter		Prepared by: Y. Murata	
From: 1st Tech. Support Sec. Service Support Dept.			
Classification:	<input type="checkbox"/> Troubleshooting <input type="checkbox"/> Mechanical <input type="checkbox"/> Paper path <input type="checkbox"/> Product Safety	<input type="checkbox"/> Part information <input type="checkbox"/> Electrical <input type="checkbox"/> Transmit/receive <input checked="" type="checkbox"/> Other ()	<input type="checkbox"/> Action required <input type="checkbox"/> Service manual revision <input type="checkbox"/> Retrofit information <input checked="" type="checkbox"/> Tier 2

This RTB has been issued to announce the firmware release information for the **PDL Filter** for MICR model *1.

***1 MICR model is unique in Americas market only.
Make sure not to update this firmware except for MICR model.**

Version	Program No.	Effective Date
1.00	G1765750	1st Mass production

Version	Modified Points or Symptom Corrected
1.00	1st Mass production

Model: S-P1 (MICR)	Date: 16-Apr-09	No.: RG176024
---------------------------	-----------------	---------------

This RTB is only for S-P1c. (36ppm)

Subject: Firmware Release Note: Engine		Prepared by: Y. Murata	
From: 1st Tech. Support Sec. Service Support Dept.			
Classification:	<input type="checkbox"/> Troubleshooting	<input type="checkbox"/> Part information	<input type="checkbox"/> Action required
	<input type="checkbox"/> Mechanical	<input type="checkbox"/> Electrical	<input type="checkbox"/> Service manual revision
	<input type="checkbox"/> Paper path	<input type="checkbox"/> Transmit/receive	<input type="checkbox"/> Retrofit information
	<input type="checkbox"/> Product Safety	<input checked="" type="checkbox"/> Other ()	<input checked="" type="checkbox"/> Tier 2

This RTB has been issued to announce the firmware release information for the **Engine** for MICR model *1.

***1 MICR model is unique in Americas market only.**

Make sure not to update this firmware except for MICR model.

Version	Program No.	Effective Date
1.03.0	G1755115	1st Mass production

Version	Modified Points or Symptom Corrected
1.03.0	1st Mass production

Model: Model S-P1	Date: 13-May-09	No.: RG176025
-------------------	-----------------	---------------

Subject: Added the new part		Prepared by: Y.Murata	
From: 1st Tech. Support Sec. Service Support Dept.			
Classification:	<input type="checkbox"/> Troubleshooting <input type="checkbox"/> Mechanical <input type="checkbox"/> Paper path <input type="checkbox"/> Other ()	<input checked="" type="checkbox"/> Part information <input type="checkbox"/> Electrical <input type="checkbox"/> Transmit/receive	<input type="checkbox"/> Action required <input checked="" type="checkbox"/> Service manual revision <input type="checkbox"/> Retrofit information

Old P/N	New P/N	Description	Q'ty	Int	Page	Index	Note
-	G1754629	FRAME:FUSING:UPPER:A SS'Y	1	-	17	29	-

Change/Reason: Added the following parts.

-Illustration-

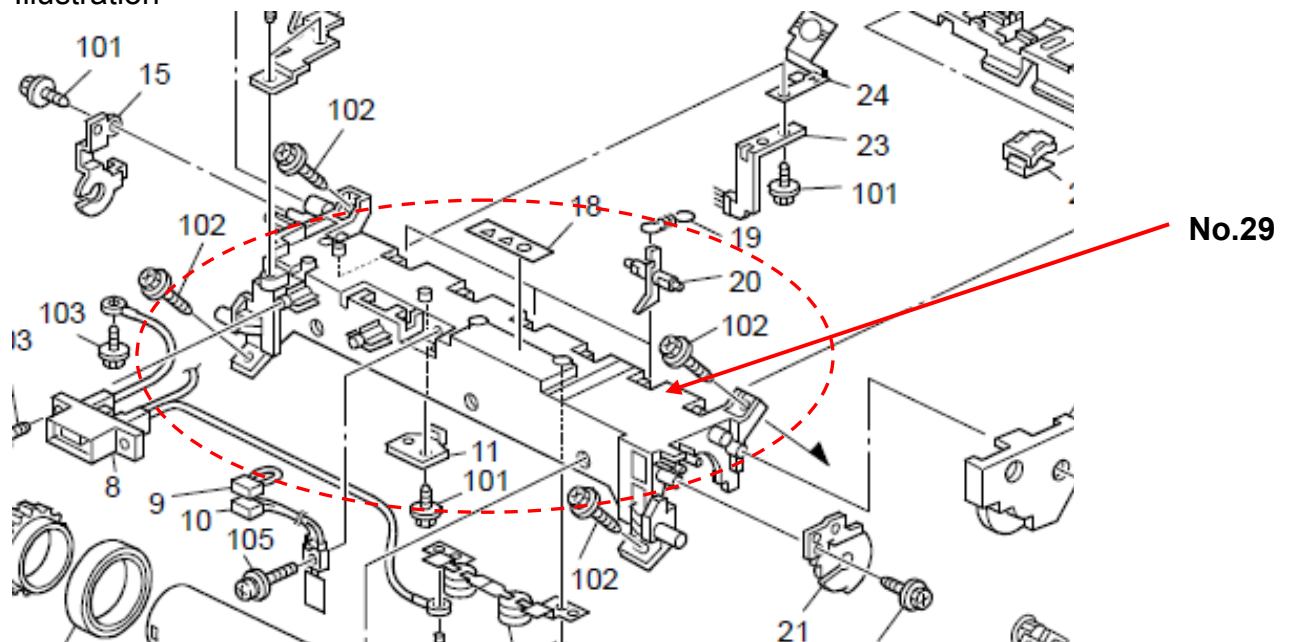

Reissued: 09-Jun-09

Model: S-P1	Date: 15-Jan-07	No.: RG176003i
-------------	-----------------	----------------

RTB Reissue

The items in ***bold italics*** have been added.

Subject: Firmware Release Note: Printer		Prepared by: Y. Murata	
From: 1st Tech. Support Sec. Service Support Dept.			
Classification:	<input type="checkbox"/> Troubleshooting <input type="checkbox"/> Part information <input type="checkbox"/> Action required <input type="checkbox"/> Mechanical <input type="checkbox"/> Electrical <input type="checkbox"/> Service manual revision <input type="checkbox"/> Paper path <input type="checkbox"/> Transmit/receive <input type="checkbox"/> Retrofit information <input checked="" type="checkbox"/> Other ()		

This RTB has been issued to announce the firmware release information for the Printer.

Version	Program No.	Effective Date
<i>1.11</i>	<i>G1765440J</i>	<i>July 2009 production</i>
1.10	G1765440H	Mar 2009 production
1.09	G1765440G	Oct 2008 production
1.08	G1765440F	Sep 2008 production
1.06	G1765440E	Dec 2007 production
1.05	G1765440D	Aug 2007 production
1.04	G1765440C	July 2007 production
1.03	G1765440B	June 2007 production
1.02	G1765440A	April 2007 production
1.01	G1765440	1st Mass production.

Version	Modified Points or Symptom Corrected
<i>1.11</i>	<i>The default setting for the Energy Saver timer was changed from 5 minutes to 1 minute.</i>
1.10	<p>Symptom corrected:</p> <ol style="list-style-type: none"> The device function used to rotate a job by 180 degrees will have no effect in either of the following situations: <ul style="list-style-type: none"> - Printing from the bypass tray or a tray containing slip sheets or cover sheets. - Finishing functions including duplex and collate are cancelled by the device during printing. <p>Note: This problem doesn't affect the driver's rotation function.</p> <ol style="list-style-type: none"> <ul style="list-style-type: none"> - The PCL5 line pitch might be printed larger than the original. - The printable area of a PCL5 page might extend beyond the border on the right side. <p>Other changes:</p> <p>The following error messages were deleted from the operation panel display, as it is not necessary to notify end users of these conditions (and therefore would be confusing):</p> <p>"Proxy setting or connection error" (embedded type)</p> <p>"RC Gate connection Error" (external box)</p>

Reissued: 09-Jun-09

Model: S-P1			Date: 15-Jan-07		No.: RG176003i																								
Version	Modified Points or Symptom Corrected																												
1.09	<p>Symptom corrected:</p> <p>1. Some pages are printed only on one side when duplex printing is selected:</p> <p>Other changes:</p> <p>2. Added, "orientation auto detect" to bitswich #8.</p> <p>Note: This function automatically chooses the page orientation for PostScript jobs or PDF jobs (Landscape or Portrait) based on the content.</p> <table><tr><td>#8</td><td>Title</td><td>Explanation</td><td colspan="2">Settings</td><td></td></tr><tr><td></td><td></td><td></td><td>0</td><td>1</td><td>default</td></tr><tr><td>6</td><td>[PS]: Orientation Auto Detect Fuction</td><td>Automatically chooses page orientations of PostScript jobs (Landscape or Portrait) based on the content.</td><td>Enabled</td><td>Disabled</td><td>0</td></tr><tr><td>7</td><td>[PDF]: Orientation Auto Detect Fuction</td><td>Automatically chooses page orientations of PDF jobs (Landscape or Portrait) based on the content.</td><td>Enabled</td><td>Disabled</td><td>0</td></tr></table>					#8	Title	Explanation	Settings						0	1	default	6	[PS]: Orientation Auto Detect Fuction	Automatically chooses page orientations of PostScript jobs (Landscape or Portrait) based on the content.	Enabled	Disabled	0	7	[PDF]: Orientation Auto Detect Fuction	Automatically chooses page orientations of PDF jobs (Landscape or Portrait) based on the content.	Enabled	Disabled	0
#8	Title	Explanation	Settings																										
			0	1	default																								
6	[PS]: Orientation Auto Detect Fuction	Automatically chooses page orientations of PostScript jobs (Landscape or Portrait) based on the content.	Enabled	Disabled	0																								
7	[PDF]: Orientation Auto Detect Fuction	Automatically chooses page orientations of PDF jobs (Landscape or Portrait) based on the content.	Enabled	Disabled	0																								
1.08	<p>The firmware version was changed to v1.08, in accordance with the release of System firmware v1.08.</p> <p>(the contents of the Printer firmware were not changed).</p>																												
1.06	<p>Symptom corrected:</p> <p>1. Various printing anomalies when printing PowerPoint2007 jobs that have Autoshapes and shadows.</p> <p>This can occur if printing with both of the following RPCS driver settings:</p> <ul style="list-style-type: none">- Resolution: 1800 x 600 dpi- Job Load Distribution: Shift load to driver <p>2. PCL jobs containing fonts with a number of characters that is evenly divisible by 256, might cause the device to stall. (GFPR#RE0706006, RA07090001)</p> <p>3. Subsequent PCL jobs will be canceled after the device prints a large number of jobs (more than 2000) submitted by the PCL 6 driver. (GFPR#RE07080008)</p>																												
1.05	<p>Other changes:</p> <p>Machine warm-up time was shortened by about five seconds (some unnecessary procedures at power on were deleted).</p> <p>Important: To apply the above change, you also need to update the Printer firmware to v1.05 or later.</p>																												
1.04	<p>Symptom corrected:</p> <p>1. PCL jobs containing character codes that are not on the font SD card, might cause the device to stall.</p> <p>2. Jobs containing bitmapped PCL fonts might cause the device to stall.</p> <p>3. When the job is created using SAP DeviceType or Barcode &OCR package for SAP System DT, the following issues will occur.</p> <ul style="list-style-type: none">- When sending a BOP job, the printer status stays at "Processing" and the job is not printed.- Memory leak occurs when printing a bitmap font with insufficient memory condition.																												
1.03	<p>The firmware version was changed to v1.03, in accordance with the release of System firmware v1.03.</p> <p>(the contents of the Printer firmware were not changed).</p>																												

Reissued: 09-Jun-09

Model: S-P1		Date: 15-Jan-07	No.: RG176003i
Version	Modified Points or Symptom Corrected		
1.02	The firmware version was changed to v1.02, in accordance with the release of System firmware v1.02. (the contents of the Printer firmware were not changed).		
1.01	1st Mass production.		

Reissued: 09-Jun-09

Model: S-P1	Date: 15-Jan-07	No.: RG176005h
-------------	-----------------	----------------

RTB Reissue

The items in ***bold italics*** have been added.

Subject: Firmware Release Note: System		Prepared by: Y. Murata	
From: 1st Tech. Support Sec. Service Support Dept.			
Classification:	<input type="checkbox"/> Troubleshooting	<input type="checkbox"/> Part information	<input type="checkbox"/> Action required
	<input type="checkbox"/> Mechanical	<input type="checkbox"/> Electrical	<input type="checkbox"/> Service manual revision
	<input type="checkbox"/> Paper path	<input type="checkbox"/> Transmit/receive	<input type="checkbox"/> Retrofit information
	<input checked="" type="checkbox"/> Other ()		

This RTB has been issued to announce the firmware release information for the System.

Version	Program No.	Effective Date
<i>1.11</i>	<i>G1765430H</i>	<i>July 2009 production</i>
1.10	G1765430G	Mar 2009 production
1.08	G1765430F	Sep 2008 production
1.06	G1765430E	Dec 2007 production
1.05	G1765430D	Aug 2007 production
1.04	G1765430C	July 2007 production
1.03	G1765430B	June 2007 production
1.02	G1765430A	April 2007 production
1.01	G1765430	1st Mass production.

Version	Modified Points or Symptom Corrected
<i>1.11</i>	<i>The default setting for the Energy Saver timer was changed from 5 minutes to 1 minute.</i>
1.10	Symptom corrected: 1. The job processing speed is slower when the DataOverwriteSecurity option is installed. 2. IPv6 Type 0 Route Headers allow sender to control routing (CVE-2007-2242) 3. Unwanted line might be added to the bottom of each page. 4. The wording of some @Remote-related error messages was revised. 5. The result of RFU is not informed to @Remote center.
1.08	Other changes: 1. The new WLAN card is now available. (TechMail#OTS-2008-543) Note: To use this new card, System firmware (version 1.08 or later), Websys firmware (version 1.03) and NCS firmware (version 6.10 or later) needs to be applied to the device.
1.06	Symptom corrected: 1. Some mainframe error messages are not displayed in multiple languages. 2. SC868 occurs when the power is turned ON if there is an SD card inserted in the machine slot. 3. An RFU that was interrupted by the power turning off cannot be retried, even after the machine is rebooted. 4. There is no error message displayed when the AIO cartridge is not installed. 5. Device might not be able to access the network under the following conditions (FPR#RC07050005):

Reissued: 09-Jun-09

Model: S-P1		Date: 15-Jan-07	No.: RG176005h
Version	Modified Points or Symptom Corrected		
	<ul style="list-style-type: none"> - The device is connected to a HUB that has link flapping enabled. - The device "Ethernet speed" is not "Auto". <p>6. 2 separate jobs are stored on the HDD as a single job with overlapping page images. This can only happen if all of the following conditions occur:</p> <ol style="list-style-type: none"> 1. The device stalls while the first job is being stored to the HDD. 2. After the stall, the printer is rebooted and another job is submitted for storage. 3. The first and second store must be to/from the same application (Copy/Scanner/Printer). 		
1.05	<p>Other changes: Machine warm-up time was shortened by about five seconds (some unnecessary procedures at power on were deleted). Important: To apply the above change, you also need to update the Printer firmware to v1.05 or later.</p>		
1.04	<p>Symptom correction: If the machine power is turned OFF during an RFU (remote firmware update) to a machine that has the Data Security Module installed, the RFU does not resume the next time the machine is turned ON.</p>		
1.03	<p>Symptom corrected: Incorrect user names and user codes are listed in the log for Document Server files printed out.</p>		
1.02	<p>Symptom corrected: The "Lanier" model name was missing from the PnP (Plug and Play) SP setting.</p>		
1.01	1st Mass production.		

Reissued: 09-Jun-09

Model: S-P1L	Date: 20-Feb-08	No.: RG176010d
--------------	-----------------	----------------

RTB Reissue

The items in ***bold italics*** have been added.

Subject: Firmware Release Note: Printer		Prepared by: Y. Murata	
From: 1st Tech. Support Sec. Service Support Dept.			
Classification:	<input type="checkbox"/> Troubleshooting <input type="checkbox"/> Mechanical <input type="checkbox"/> Paper path <input checked="" type="checkbox"/> Other ()	<input type="checkbox"/> Part information <input type="checkbox"/> Electrical <input type="checkbox"/> Transmit/receive	<input type="checkbox"/> Action required <input type="checkbox"/> Service manual revision <input type="checkbox"/> Retrofit information

This RTB has been issued to announce the firmware release information for the **Printer**.

Version	Program No.	Effective Date
<i>1.03</i>	<i>G1765540C</i>	<i>July 2009 production</i>
1.02	G1765540B	Mar 2009 production
1.01	G1765540A	July 2008 production
1.00	G1765540	1st Mass production.

Version	Modified Points or Symptom Corrected
<i>1.03</i>	<i>The default setting for the Energy Saver timer was changed from 5 minutes to 1 minute.</i>
1.02	Symptom corrected: 1. The device function used to rotate a job by 180 degrees will have no effect in either of the following situations: - Printing from the bypass tray or a tray containing slip sheets or cover sheets. - Finishing functions including duplex and collate are cancelled by the device during printing. Note: This problem doesn't affect the driver's rotation function. 2. - The PCL5 line pitch might be printed larger than the original. - The printable area of a PCL5 page might extend beyond the border on the right side. Other changes: The following error messages were deleted from the operation panel display, as it is not necessary to notify end users of these conditions (and therefore would be confusing): "Proxy setting or connection error" (embedded type) "RC Gate connection Error" (external box)
1.01	(Minor changes applied).
1.00	1st Mass production.

Reissued: 09-Jun-09

Model: S-P1L	Date: 20-Feb-08	No.: RG176011d
--------------	-----------------	----------------

RTB Reissue

The items in ***bold italics*** have been added.

Subject: Firmware Release Note: System		Prepared by: Y.Murata	
From: 1st Tech. Support Sec. Service Support Dept.			
Classification:	<input type="checkbox"/> Troubleshooting <input type="checkbox"/> Mechanical <input type="checkbox"/> Paper path <input checked="" type="checkbox"/> Other ()	<input type="checkbox"/> Part information <input type="checkbox"/> Electrical <input type="checkbox"/> Transmit/receive	<input type="checkbox"/> Action required <input type="checkbox"/> Service manual revision <input type="checkbox"/> Retrofit information

This RTB has been issued to announce the firmware release information for the **System**.

Version	Program No.	Effective Date
<i>1.03</i>	<i>G1765530C</i>	<i>July 2009 production</i>
1.02	G1765530B	Mach 2009 production
1.01	G1765530A	July 2008 production
1.00	G1765530	1st Mass production.

Version	Modified Points or Symptom Corrected
<i>1.03</i>	<i>The default setting for the Energy Saver timer was changed from 5 minutes to 1 minute.</i>
1.02	Symptom corrected: 1. The job processing speed is slower when the DataOverwriteSecurity option is installed. 2. Unwanted line might be added to the bottom of each page. 3. The wording of some @Remote-related error messages was revised. 4. The result of RFU is not informed to @Remote center.
1.01	The firmware was modified to support Engine v2.0.0 and newer. Important: If you want to install Engine firmware v2.00 or later via firmware update (and not by board replacement), you must first update the System firmware to v1.01 or later. If you do not, the Engine firmware update will fail.
1.00	1st Mass production.

Reissued: 09-Jun-09

Model: S-P1	Date: 29-Sep-08	No.: RG176015b
-------------	-----------------	----------------

This RTB is only for S-P1b Taiwan model.

Subject: Firmware Release Note: System for S-P1b Taiwan model.		Prepared by: Y.Murata	
From: 1st Tech. Support Sec. Service Support Dept.			
Classification:	<input type="checkbox"/> Troubleshooting <input type="checkbox"/> Mechanical <input type="checkbox"/> Paper path <input checked="" type="checkbox"/> Other ()	<input type="checkbox"/> Part information <input type="checkbox"/> Electrical <input type="checkbox"/> Transmit/receive	<input type="checkbox"/> Action required <input type="checkbox"/> Service manual revision <input type="checkbox"/> Retrofit information

This RTB has been issued to announce the firmware release information for the System.

Version	Program No.	Effective Date
1.02	G1765630B	July 2009 production
1.01	G1765630A	March 2009 production
1.00	G1765630	1st Mass production.

Version	Modified Points or Symptom Corrected
1.02	<i>The default setting for the Energy Saver timer was changed from 5 minutes to 1 minute.</i>
1.01	Symptom corrected: 1. The job processing speed is slower when the DataOverwriteSecurity option is installed. 2. Unwanted line might be added to the bottom of each page. 3. The wording of some @Remote-related error messages was revised. 4. The result of RFU is not informed to @Remote center.
1.00	1st Mass production

Reissued: 09-Jun-09

Model: S-P1	Date: 29-Sep-08	No.: RG176016b
-------------	-----------------	----------------

This RTB is only for S-P1b Taiwan model.

Subject: Firmware Release Note: Printer for S-P1b Taiwan model.		Prepared by: Y. Murata	
From: 1st Tech. Support Sec. Service Support Dept.			
Classification:	<input type="checkbox"/> Troubleshooting <input type="checkbox"/> Mechanical <input type="checkbox"/> Paper path <input checked="" type="checkbox"/> Other ()	<input type="checkbox"/> Part information <input type="checkbox"/> Electrical <input type="checkbox"/> Transmit/receive	<input type="checkbox"/> Action required <input type="checkbox"/> Service manual revision <input type="checkbox"/> Retrofit information

This RTB has been issued to announce the firmware release information for the Printer.

Version	Program No.	Effective Date
1.02	G1765640B	July 2009 production
1.01	G1765640A	March 2009 production
1.00	G1765640	1st Mass production.

Version	Modified Points or Symptom Corrected
1.02	<i>The default setting for the Energy Saver timer was changed from 5 minutes to 1 minute.</i>
1.01	<p>Symptom corrected:</p> <ol style="list-style-type: none"> The device function used to rotate a job by 180 degrees will have no effect in either of the following situations: <ul style="list-style-type: none"> - Printing from the bypass tray or a tray containing slip sheets or cover sheets. - Finishing functions including duplex and collate are cancelled by the device during printing. <p>Note: This problem doesn't affect the driver's rotation function.</p> <ol style="list-style-type: none"> <ul style="list-style-type: none"> - The PCL5 line pitch might be printed larger than the original. - The printable area of a PCL5 page might extend beyond the border on the right side. <p>Other changes:</p> <p>The following error messages were deleted from the operation panel display, as it is not necessary to notify end users of these conditions (and therefore would be confusing):</p> <p>"Proxy setting or connection error" (embedded type)</p> <p>"RC Gate connection Error" (external box)</p>
1.00	1st Mass production.

Model: S-P1		Date: 18-SEp-09	No.: RG176026
Subject: SC code correction		Prepared by: Y. Murata	
From: 1st Tech. Support Sec. Service Support Dept.			
Classification:	<input checked="" type="checkbox"/> Troubleshooting <input type="checkbox"/> Mechanical <input type="checkbox"/> Paper path <input type="checkbox"/> Other ()	<input type="checkbox"/> Part information <input type="checkbox"/> Electrical <input type="checkbox"/> Transmit/receive	<input type="checkbox"/> Action required <input checked="" type="checkbox"/> Service manual revision <input type="checkbox"/> Retrofit information <input checked="" type="checkbox"/> Tier2

Change/Reason: SC code correction.

1. Please delete the following SCs from the service manual.

621/634/635/669/672/838/880/995

2. Please add the following SCs to the service manual.

SC	Description	Cause / Required action
671	Engine board mismatch error	<ul style="list-style-type: none"> • Wrong engine board installed. • Wrong controller board installed.
	Engine board and controller mismatch detected.	<ul style="list-style-type: none"> • Check the type of engine board and controller board. 1. Replace the engine board. 2. Replace the controller board.
818	System timeout error	<ul style="list-style-type: none"> • Defective controller • Replace the controller if it occurs frequently.
877	HDD Data Overwrite Security SD card error	<ul style="list-style-type: none"> • Defective SD card. • SD card not installed
	The 'all delete' function cannot be executed but the Data Overwrite Security Unit is installed and activated.	<ul style="list-style-type: none"> 1. Replace the NVRAM and then install the new SD card. 2. Check and reinstall the SD card.
921	Printer font error	<ul style="list-style-type: none"> • A necessary font is not found in the SD card.
	A necessary font is not found in the SD card.	<ul style="list-style-type: none"> • The SD card data is corrupted. Check that the SD card has the correct data.
992	Printer font error	<ul style="list-style-type: none"> • A necessary font is not found in the SD card.
	A necessary font is not found in the SD card.	<ul style="list-style-type: none"> • The SD card data is corrupted. • Check that the SD card stores correct data.
998	Application start error	<ul style="list-style-type: none"> • Loose connection of RAM-DIMM, ROM-DIMM
	No applications start within 60 seconds after the power is turned on.	<ul style="list-style-type: none"> • Defective controller • Software problem 1. Check if the RAM-DIMM and ROM-DIMM are correctly connected. 2. Reinstall the controller system firmware. 3. Replace the controller board.

Reissued: 29-Jan-10

Model: S-P1L	Date: 20-Feb-08	No.: RG176011e
--------------	-----------------	----------------

RTB Reissue

The items in ***bold italics*** have been added.

Subject: Firmware Release Note: System		Prepared by: K.Nakano	
From: 2nd Overseas Tech Support Sec., 2nd PQM Dept.			
Classification:	<input type="checkbox"/> Troubleshooting	<input type="checkbox"/> Part information	<input type="checkbox"/> Action required
	<input type="checkbox"/> Mechanical	<input type="checkbox"/> Electrical	<input type="checkbox"/> Service manual revision
	<input type="checkbox"/> Paper path	<input type="checkbox"/> Transmit/receive	<input type="checkbox"/> Retrofit information
	<input checked="" type="checkbox"/> Other ()		

This RTB has been issued to announce the firmware release information for the **System**.

Version	Program No.	Effective Date
<i>1.04</i>	<i>G1765530D</i>	<i>February 2010 production</i>
1.03	G1765530C	July 2009 production
1.02	G1765530B	Mach 2009 production
1.01	G1765530A	July 2008 production
1.00	G1765530	1st Mass production.

Version	Modified Points or Symptom Corrected
<i>1.04</i>	<i>Symptom corrected: Unable to connect to the network when the MAC address Ricoh vendor code is changed from 00-00-74 to the new address 00-26-73.</i>
1.03	The default setting for the Energy Saver timer was changed from 5 minutes to 1 minute.
1.02	Symptom corrected: 1. The job processing speed is slower when the DataOverwriteSecurity option is installed. 2. Unwanted line might be added to the bottom of each page. 3. The wording of some @Remote-related error messages was revised. 4. The result of RFU is not informed to @Remote center.
1.01	The firmware was modified to support Engine v2.0.0 and newer. Important: If you want to install Engine firmware v2.00 or later via firmware update (and not by board replacement), you must first update the System firmware to v1.01 or later. If you do not, the Engine firmware update will fail.
1.00	1st Mass production.

Reissued: 04-Feb-10

Model: S-P1L	Date: 20-Feb-08	No.: RG176010e
--------------	-----------------	----------------

RTB Reissue

The items in ***bold italics*** have been added.

Subject: Firmware Release Note: Printer		Prepared by: K.Nakano	
From: 2nd Overseas Tech Support Sec., 2nd PQM Dept.			
Classification:	<input type="checkbox"/> Troubleshooting <input type="checkbox"/> Part information <input type="checkbox"/> Action required		
	<input type="checkbox"/> Mechanical <input type="checkbox"/> Electrical <input type="checkbox"/> Service manual revision		
	<input type="checkbox"/> Paper path <input type="checkbox"/> Transmit/receive <input type="checkbox"/> Retrofit information		
	<input checked="" type="checkbox"/> Other ()		

This RTB has been issued to announce the firmware release information for the **Printer**.

Version	Program No.	Effective Date
<i>1.04</i>	<i>G1765540D</i>	<i>February 2010 production</i>
1.03	G1765540C	July 2009 production
1.02	G1765540B	March 2009 production
1.01	G1765540A	July 2008 production
1.00	G1765540	1st Mass production

Version	Modified Points or Symptom Corrected
<i>1.04</i>	<i>Symptom corrected: Jobs that use the PS Type 42 wrapper to call TrueType fonts might cause the device to stall.</i>
1.03	The default setting for the Energy Saver timer was changed from 5 minutes to 1 minute.
1.02	<p>Symptom corrected:</p> <ol style="list-style-type: none"> The device function used to rotate a job by 180 degrees will have no effect in either of the following situations: <ul style="list-style-type: none"> Printing from the bypass tray or a tray containing slip sheets or cover sheets. Finishing functions including duplex and collate are cancelled by the device during printing. <p>Note: This problem doesn't affect the driver's rotation function.</p> <ol style="list-style-type: none"> <ul style="list-style-type: none"> The PCL5 line pitch might be printed larger than the original. The printable area of a PCL5 page might extend beyond the border on the right side. <p>Other changes:</p> <p>The following error messages were deleted from the operation panel display, as it is not necessary to notify end users of these conditions (and therefore would be confusing):</p> <p>"Proxy setting or connection error" (embedded type)</p> <p>"RC Gate connection Error" (external box)</p>
1.01	(Minor changes applied).
1.00	1st Mass production.

Model: S-P1		Date: 18-Feb-10	No.: RG176027
Subject: Parts Catalog Correction		Prepared by: K. Nakano	
From: 2nd Overseas Tech Support Sec., 2nd PQM Dept.			
Classification:	<input type="checkbox"/> Troubleshooting <input type="checkbox"/> Mechanical <input type="checkbox"/> Paper path <input type="checkbox"/> Product Safety	<input checked="" type="checkbox"/> Part information <input type="checkbox"/> Electrical <input type="checkbox"/> Transmit/receive <input type="checkbox"/> Other (Firmware)	<input type="checkbox"/> Action required <input type="checkbox"/> Service manual revision <input type="checkbox"/> Retrofit information <input type="checkbox"/> Tier 2

Change/Reason: Indices #8 and #10 were corrected (they were reversed).

Parts Catalog, pg. 2

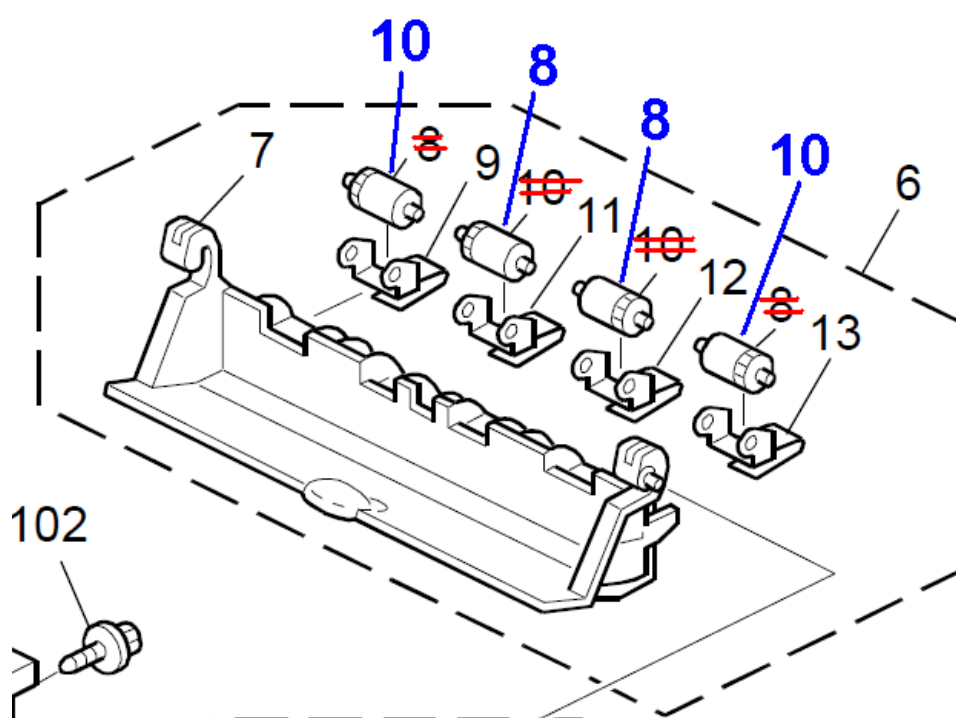

6	G096 1509	Paper Exit Sub-unit Ass'y	1
7	G096 1512	Exit Cover	1
8	G052 4875	Inner Exit Cover Roller	2
9	G052 4871	Left Holder - Exit Driven Roller	1
10	G052 4873	Outer Exit Cover Roller	2
11	G052 4876	Left Spring Plate	1

Reissued: 06-Apr-10

Model: S-P1	Date: 15-Jan-07	No.: RG176003j
-------------	-----------------	----------------

RTB Reissue

The items in ***bold italics*** have been added.

Subject: Firmware Release Note: Printer		Prepared by: K.Nakano	
From: 2nd Overseas Tech Support Sec., 2nd PQM Dept.			
Classification:	<input type="checkbox"/> Troubleshooting	<input type="checkbox"/> Part information	<input type="checkbox"/> Action required
	<input type="checkbox"/> Mechanical	<input type="checkbox"/> Electrical	<input type="checkbox"/> Service manual revision
	<input type="checkbox"/> Paper path	<input type="checkbox"/> Transmit/receive	<input type="checkbox"/> Retrofit information
	<input checked="" type="checkbox"/> Other ()		

This RTB has been issued to announce the firmware release information for the Printer.

Version	Program No.	Effective Date
<i>1.12</i>	<i>G1765440K</i>	<i>May 2010 production</i>
1.11	G1765440J	July 2009 production
1.10	G1765440H	Mar 2009 production
1.09	G1765440G	Oct 2008 production
1.08	G1765440F	Sep 2008 production
1.06	G1765440E	Dec 2007 production
1.05	G1765440D	Aug 2007 production
1.04	G1765440C	July 2007 production
1.03	G1765440B	June 2007 production
1.02	G1765440A	April 2007 production
1.01	G1765440	1st Mass production.

Version	Modified Points or Symptom Corrected
<i>1.12</i>	<i>Symptom corrected:</i> <i>1. If the Auto Continue setting is "Immediate" and the source tray runs out of paper, the device will stall. This only occurred if the paper ran out after several small jobs (30 or 40) were submitted back to back.</i> <i>2. Jobs that use the PS Type 42 wrapper to call TrueType fonts might cause the device to stall.</i>
1.11	The default setting for the Energy Saver timer was changed from 5 minutes to 1 minute.
1.10	Symptom corrected: 1. The device function used to rotate a job by 180 degrees will have no effect in either of the following situations: - Printing from the bypass tray or a tray containing slip sheets or cover sheets. - Finishing functions including duplex and collate are cancelled by the device during printing. Note: This problem doesn't affect the driver's rotation function. 2. - The PCL5 line pitch might be printed larger than the original. - The printable area of a PCL5 page might extend beyond the border on the right side. Other changes: The following error messages were deleted from the operation panel display, as it is not necessary to notify end users of these conditions (and therefore would be

Reissued: 06-Apr-10

Model: S-P1			Date: 15-Jan-07		No.: RG176003j	
Version	Modified Points or Symptom Corrected					
	confusing): "Proxy setting or connection error" (embedded type) "RC Gate connection Error" (external box)					
1.09	Symptom corrected: 1. Some pages are printed only on one side when duplex printing is selected: Other changes: 2. Added, "orientation auto detect" to bitswich #8. Note: This function automatically chooses the page orientation for PostScript jobs or PDF jobs (Landscape or Portrait) based on the content.					
	#8	Title	Explanation	Settings		
				0	1	
				default		
	6	[PS]: Orientation Auto Detect Fuction	Automatically chooses page orientations of PostScript jobs (Landscape or Portrait) based on the content.	Enabled	Disabled	
	7	[PDF]: Orientation Auto Detect Fuction	Automatically chooses page orientations of PDF jobs (Landscape or Portrait) based on the content.	Enabled	Disabled	
				0	0	
1.08	The firmware version was changed to v1.08, in accordance with the release of System firmware v1.08. (the contents of the Printer firmware were not changed).					
1.06	Symptom corrected: 1. Various printing anomalies when printing PowerPoint2007 jobs that have Autoshapes and shadows. This can occur if printing with both of the following RPCS driver settings: - Resolution: 1800 x 600 dpi - Job Load Distribution: Shift load to driver 2. PCL jobs containing fonts with a number of characters that is evenly divisible by 256, might cause the device to stall. (GFPR#RE0706006, RA07090001) 3. Subsequent PCL jobs will be canceled after the device prints a large number of jobs (more than 2000) submitted by the PCL 6 driver. (GFPR#RE07080008)					
1.05	Other changes: Machine warm-up time was shortened by about five seconds (some unnecessary procedures at power on were deleted). Important: To apply the above change, you also need to update the Printer firmware to v1.05 or later.					
1.04	Symptom corrected: 1. PCL jobs containing character codes that are not on the font SD card, might cause the device to stall. 2. Jobs containing bitmapped PCL fonts might cause the device to stall. 3. When the job is created using SAP DeviceType or Barcode &OCR package for SAP System DT, the following issues will occur. - When sending a BOP job, the printer status stays at "Processing" and the job is not printed. - Memory leak occurs when printing a bitmap font with insufficient memory condition.					
1.03	The firmware version was changed to v1.03, in accordance with the release of System firmware v1.03.					

Reissued: 06-Apr-10

Model: S-P1		Date: 15-Jan-07	No.: RG176003j
Version	Modified Points or Symptom Corrected		
	(the contents of the Printer firmware were not changed).		
1.02	The firmware version was changed to v1.02, in accordance with the release of System firmware v1.02. (the contents of the Printer firmware were not changed).		
1.01	1st Mass production.		

Reissued: 01-Apr-10

Model: S-P1	Date: 15-Jan-07	No.: RG176005i
-------------	-----------------	----------------

RTB Reissue

The items in ***bold italics*** have been added.

Subject: Firmware Release Note: System		Prepared by: K.Nakano	
From: 2nd Overseas Tech Support Sec., 2nd PQM Dept.			
Classification:	<input type="checkbox"/> Troubleshooting <input type="checkbox"/> Part information <input type="checkbox"/> Action required		
	<input type="checkbox"/> Mechanical <input type="checkbox"/> Electrical <input type="checkbox"/> Service manual revision		
	<input type="checkbox"/> Paper path <input type="checkbox"/> Transmit/receive <input type="checkbox"/> Retrofit information		
	<input checked="" type="checkbox"/> Other ()		

This RTB has been issued to announce the firmware release information for the System.

Version	Program No.	Effective Date
<i>1.12</i>	<i>G1765430J</i>	<i>May 2010 production</i>
1.11	G1765430H	July 2009 production
1.10	G1765430G	Mar 2009 production
1.08	G1765430F	Sep 2008 production
1.06	G1765430E	Dec 2007 production
1.05	G1765430D	Aug 2007 production
1.04	G1765430C	July 2007 production
1.03	G1765430B	June 2007 production
1.02	G1765430A	April 2007 production
1.01	G1765430	1st Mass production

Version	Modified Points or Symptom Corrected
<i>1.12</i>	<i>Symptom corrected: Unable to connect to the network when the MAC address Ricoh vendor code is changed from 00-00-74 to the new address, 00-26-73.</i>
1.11	The default setting for the Energy Saver timer was changed from 5 minutes to 1 minute.
1.10	Symptom corrected: 1. The job processing speed is slower when the DataOverwriteSecurity option is installed. 2. IPv6 Type 0 Route Headers allow sender to control routing (CVE-2007-2242) 3. Unwanted line might be added to the bottom of each page. 4. The wording of some @Remote-related error messages was revised. 5. The result of RFU is not informed to @Remote center.
1.08	Other changes: 1. The new WLAN card is now available. (TechMail#OTS-2008-543) Note: To use this new card, System firmware (version 1.08 or later), Websys firmware (version 1.03) and NCS firmware (version 6.10 or later) needs to be applied to the device.
1.06	Symptom corrected: 1. Some mainframe error messages are not displayed in multiple languages. 2. SC868 occurs when the power is turned ON if there is an SD card inserted in the machine slot. 3. An RFU that was interrupted by the power turning off cannot be retried, even

Reissued: 01-Apr-10

Model: S-P1		Date: 15-Jan-07	No.: RG176005i
Version	Modified Points or Symptom Corrected		
	<p>after the machine is rebooted.</p> <ol style="list-style-type: none"> 4. There is no error message displayed when the AIO cartridge is not installed. 5. Device might not be able to access the network under the following conditions (FPR#RC07050005): <ul style="list-style-type: none"> - The device is connected to a HUB that has link flapping enabled. - The device "Ethernet speed" is not "Auto". 6. 2 separate jobs are stored on the HDD as a single job with overlapping page images. This can only happen if all of the following conditions occur: <ol style="list-style-type: none"> 1. The device stalls while the first job is being stored to the HDD. 2. After the stall, the printer is rebooted and another job is submitted for storage. 3. The first and second store must be to/from the same application (Copy/Scanner/Printer). 		
1.05	<p>Other changes: Machine warm-up time was shortened by about five seconds (some unnecessary procedures at power on were deleted). Important: To apply the above change, you also need to update the Printer firmware to v1.05 or later.</p>		
1.04	<p>Symptom correction: If the machine power is turned OFF during an RFU (remote firmware update) to a machine that has the Data Security Module installed, the RFU does not resume the next time the machine is turned ON.</p>		
1.03	<p>Symptom corrected: Incorrect user names and user codes are listed in the log for Document Server files printed out.</p>		
1.02	<p>Symptom corrected: The "Lanier" model name was missing from the PnP (Plug and Play) SP setting.</p>		
1.01	1st Mass production.		

Reissued: 07-Apr-10

Model: S-P1	Date: 15-Jan-07	No.: RG176006e
-------------	-----------------	----------------

RTB Reissue

The items in bold italics have been added.

Subject: Firmware Release Note: Network Support		Prepared by: K.Nakano	
From: 2nd Overseas Tech Support Sec., 2nd PQM Dept.			
Classification:	<input type="checkbox"/> Troubleshooting <input type="checkbox"/> Mechanical <input type="checkbox"/> Paper path <input checked="" type="checkbox"/> Other ()	<input type="checkbox"/> Part information <input type="checkbox"/> Electrical <input type="checkbox"/> Transmit/receive	<input type="checkbox"/> Action required <input type="checkbox"/> Service manual revision <input type="checkbox"/> Retrofit information

This RTB has been issued to announce the firmware release information for the Network Support.

Version	Program No.	Effective Date
6.14	G1765432E	March 2010 production
6.12	G1765432D	March 2009 production
6.10	G1765432C	February 2008 production
6.06	G1765432B	August 2007 production
6.04	G1765432A	June 2007 production
6.02	G1765432	1st Mass production

Version	Modified Points or Symptom Corrected
6.14	Symptom corrected: 1. Windows authentication might fail on a domain controller whose hostname contains 2 byte characters. 2. The printer's IP address lease renewal request is incorrectly formatted and rejected by DHCP relay agents. This will result in a loss of connectivity that lasts until the printer reinitializes the network connection (10 seconds).
6.12	Symptom corrected: 1. The device might not be able to access the network once the Log collection tool is run. 2. IPP print jobs are cancelled. This happened very infrequently. 3. After a job consisting of a multiple of exactly 8KB (8192 bytes) is submitted via IPP, the device will no longer accept any more jobs until rebooted.
6.10	Symptom corrected: 1. The machine freezes and displays "Processing..." if a print job is performed with USB connection disabled. 2. LPR jobs containing an ustatus readback will cause devices to stall if the USB interface is disabled. "Processing" will be displayed in the operation panel. (FPR# RC07050011) 3. The device will stall if a PCL job is submitted via sftp while the printer spooler (off by default) or sftp spooler (on by default) is stopped. 4. Jobs submitted from Mac OS via AppleTalk might result in an error or be discarded completely by the printer. 5. An SSL2.0 client code fails to properly check for NULL (CVE-2006-4343). (TechMail#OTS-2008-185)

Reissued: 07-Apr-10

Model: S-P1		Date: 15-Jan-07	No.: RG176006e
Version	Modified Points or Symptom Corrected		
	<ol style="list-style-type: none"> 6. Multiple RSA implementations fail to properly handle signatures (CVE-2006-4339). (TechMail#OTS-2008-276) 7. The connection to a WLAN might be dropped if the device has been connected for an extended period of time and was authenticated using WPA. 8. If WLAN is enabled, an SC991 might be displayed on the Operation Panel if either of the following settings are changed: <ul style="list-style-type: none"> – The Ethernet Speed is changed to any setting except "Auto Select", from the operation panel. – The Communication Mode is changed to "Ad hoc mode" and then User Tools is exited. 9. The Interface Speed in NIB summary will be shown as "Link down" if WLAN is enabled. <p>Other changes:</p> <ol style="list-style-type: none"> 1. The new WLAN card is now available. (TechMail#OTS-2008-543) Note: To use this new card, System firmware (version 1.08 or later), Websys firmware (version 1.03) and NCS firmware (version 6.10 or later) needs to be applied to the device. 		
6.06	Symptom corrected: <ol style="list-style-type: none"> 1. The performance of WIM might be reduced if SSDP is enabled on the device. 		
6.04	Symptom corrected: <ol style="list-style-type: none"> 1. A 404 error will be returned by WIM after the "Date and time" setting is configured via a Web SmartDeviceMonitor ver.2.x Batch Configuration. 2. The device will not be registered with a DNS server by a DHCP relay agent. 3. The device fails to renew with the DDNS server, it will not try again. 4. IPP clients might not print to devices that joined the network using mDNS (Bonjour). 		
6.02	1st Mass production.		

Reissued: 01-Apr-10

Model: S-P1	Date: 29-Sep-08	No.: RG176015c
-------------	-----------------	----------------

This RTB is only for S-P1b Taiwan model.

Subject: Firmware Release Note: System for S-P1b Taiwan model.		Prepared by: K.Nakano	
From: 2nd Overseas Tech Support Sec., 2nd PQM Dept.			
Classification:	<input type="checkbox"/> Troubleshooting <input type="checkbox"/> Mechanical <input type="checkbox"/> Paper path <input checked="" type="checkbox"/> Other ()	<input type="checkbox"/> Part information <input type="checkbox"/> Electrical <input type="checkbox"/> Transmit/receive	<input type="checkbox"/> Action required <input type="checkbox"/> Service manual revision <input type="checkbox"/> Retrofit information

This RTB has been issued to announce the firmware release information for the System.

Version	Program No.	Effective Date
1.03	G1765630C	May 2010 production
1.02	G1765630B	July 2009 production
1.01	G1765630A	March 2009 production
1.00	G1765630	1st Mass production

Version	Modified Points or Symptom Corrected
1.03	Symptom corrected: Unable to connect to the network when the MAC address Ricoh vendor code is changed from 00-00-74 to the new address, 00-26-73.
1.02	The default setting for the Energy Saver timer was changed from 5 minutes to 1 minute.
1.01	Symptom corrected: 1. The job processing speed is slower when the DataOverwriteSecurity option is installed. 2. Unwanted line might be added to the bottom of each page. 3. The wording of some @Remote-related error messages was revised. 4. The result of RFU is not informed to @Remote center.
1.00	1st Mass production

Reissued: 06-Apr-10

Model: S-P1	Date: 29-Sep-08	No.: RG176016c
-------------	-----------------	----------------

This RTB is only for S-P1b Taiwan model.

Subject: Firmware Release Note: Printer for S-P1b Taiwan model.		Prepared by: K.Nakano	
From: 2nd Overseas Tech Support Sec., 2nd PQM Dept.			
Classification:	<input type="checkbox"/> Troubleshooting <input type="checkbox"/> Part information <input type="checkbox"/> Action required <input type="checkbox"/> Mechanical <input type="checkbox"/> Electrical <input type="checkbox"/> Service manual revision <input type="checkbox"/> Paper path <input type="checkbox"/> Transmit/receive <input type="checkbox"/> Retrofit information <input checked="" type="checkbox"/> Other ()		

This RTB has been issued to announce the firmware release information for the Printer.

Version	Program No.	Effective Date
1.03	G1765640C	May 2010 production
1.02	G1765640B	July 2009 production
1.01	G1765640A	March 2009 production
1.00	G1765640	1st Mass production.

Version	Modified Points or Symptom Corrected
1.03	Symptom corrected: 1. If the Auto Continue setting is "Immediate" and the source tray runs out of paper, the device will stall. This only occurred if the paper ran out after several small jobs (30 or 40) were submitted back to back. 2. Jobs that use the PS Type 42 wrapper to call TrueType fonts might cause the device to stall.
1.02	The default setting for the Energy Saver timer was changed from 5 minutes to 1 minute.
1.01	Symptom corrected: 1. The device function used to rotate a job by 180 degrees will have no effect in either of the following situations: - Printing from the bypass tray or a tray containing slip sheets or cover sheets. - Finishing functions including duplex and collate are cancelled by the device during printing. Note: This problem doesn't affect the driver's rotation function. 2. - The PCL5 line pitch might be printed larger than the original. - The printable area of a PCL5 page might extend beyond the border on the right side. Other changes: The following error messages were deleted from the operation panel display, as it is not necessary to notify end users of these conditions (and therefore would be confusing): "Proxy setting or connection error" (embedded type) "RC Gate connection Error" (external box)
1.00	1st Mass production.

Reissued: 06-Apr-10

Model: S-P1 (MICR)	Date: 16-Apr-09	No.: RG176020b
---------------------------	-----------------	----------------

RTB Reissue

The items in bold italics have been corrected.

Subject: Firmware Release Note: Printer		Prepared by: K.Nakano	
From: 2nd Overseas Tech Support Sec., 2nd PQM Dept.			
Classification:	<input type="checkbox"/> Troubleshooting	<input type="checkbox"/> Part information	<input type="checkbox"/> Action required
	<input type="checkbox"/> Mechanical	<input type="checkbox"/> Electrical	<input type="checkbox"/> Service manual revision
	<input type="checkbox"/> Paper path	<input type="checkbox"/> Transmit/receive	<input type="checkbox"/> Retrofit information
	<input type="checkbox"/> Product Safety	<input checked="" type="checkbox"/> Other ()	<input checked="" type="checkbox"/> Tier 2

This RTB has been issued to announce the firmware release information for the **Printer** for MICR model *1.

***1 MICR model is unique in the Americas market only.**

Make sure not to use this firmware except for the MICR model.

Version	Program No.	Effective Date
1.04	G1765740B	May 2010 production
1.03	G1765740A	July 2009 production
1.02	G1765740	1st Mass production

Version	Modified Points or Symptom Corrected
1.04	Symptom corrected: <ol style="list-style-type: none"> <i>If the Auto Continue setting is "Immediate" and the source tray runs out of paper, the device will stall. This only occurred if the paper ran out after several small jobs (30 or 40) were submitted back to back.</i> <i>Jobs that use the PS Type 42 wrapper to call TrueType fonts might cause the device to stall.</i>
1.03	The default setting for the Energy Saver timer was changed from 5 minutes to 1 minute. Symptom corrected: <ol style="list-style-type: none"> Jobs submitted by certain SDK applications (PDL Filter for example) might cause the device to stall.
1.02	1st Mass production

Reissued: 01-Apr-10

Model: S-P1 (MICR)	Date: 16-Apr-09	No.: RG176021b
--------------------	-----------------	----------------

RTB Reissue

The items in ***bold italics*** have been added.

Subject: Firmware Release Note: System		Prepared by: K.Nakano	
From: 2nd Overseas Tech Support Sec., 2nd PQM Dept.			
Classification:	<input type="checkbox"/> Troubleshooting	<input type="checkbox"/> Part information	<input type="checkbox"/> Action required
	<input type="checkbox"/> Mechanical	<input type="checkbox"/> Electrical	<input type="checkbox"/> Service manual revision
	<input type="checkbox"/> Paper path	<input type="checkbox"/> Transmit/receive	<input type="checkbox"/> Retrofit information
	<input type="checkbox"/> Product Safety	<input checked="" type="checkbox"/> Other ()	<input checked="" type="checkbox"/> Tier 2

This RTB has been issued to announce the firmware release information for the **System** for MICR model *1.

***1 MICR model is unique in Americas market only.**
Make sure not to update this firmware except for MICR model.

Version	Program No.	Effective Date
<i>1.04</i>	<i>G1765730B</i>	<i>May 2010 production</i>
1.03	G1765730A	July 2009 production
1.02	G1765730	1st Mass production

Version	Modified Points or Symptom Corrected
<i>1.04</i>	<i>Symptom corrected: Unable to connect to the network when the MAC address Ricoh vendor code is changed from 00-00-74 to the new address 00-26-73</i>
1.03	The default setting for the Energy Saver timer was changed from 5 minutes to 1 minute.
1.02	1st Mass production

Model: S-P1		Date: 28-May-12	No.: RG176028
Subject: Parts number change		Prepared by: Y.Nishida	
From: 3rd Tech Service Sect., MFP/Printer Tech Service Dept.			
Classification:	<input type="checkbox"/> Troubleshooting <input checked="" type="checkbox"/> Part information <input type="checkbox"/> Action required <input type="checkbox"/> Mechanical <input type="checkbox"/> Electrical <input type="checkbox"/> Service manual revision <input type="checkbox"/> Paper path <input type="checkbox"/> Transmit/receive <input type="checkbox"/> Retrofit information <input type="checkbox"/> Product Safety <input type="checkbox"/> Other () <input type="checkbox"/> Tier 2		

Old part number	New part number	Description	Q'ty	Int	Page	Index	Note
11029650	11035455	CONNECTOR:10236-59A3MB	1	1	39	109	
03525080N	08010213	SCREW - M2.6X8	2	2	27	106	

Change: Vendor change

Reason: Due to the flood in Thailand (RMT)

Important: If one of the old parts needs to be replaced, install both of the new parts **together as a set.**

Model: S-P1		Date: 27-July-15	No.RG176029
Subject: Parts catalog correction "Drive Section"		Prepared by: N.Yasuda	
From: 1st Tech. Support Sec. Service Support Dept.			
Classification:	<input type="checkbox"/> Troubleshooting <input checked="" type="checkbox"/> Part information <input type="checkbox"/> Action required <input type="checkbox"/> Mechanical <input type="checkbox"/> Electrical <input type="checkbox"/> Service manual revision <input type="checkbox"/> Paper path <input type="checkbox"/> Transmit/receive <input type="checkbox"/> Retrofit information <input type="checkbox"/> Product Safety <input type="checkbox"/> Other () <input type="checkbox"/> Tier 2		

Change: Part number of the following gear

Old part number	New part number	Description	Q'ty	Int	Note
G0881103	G1681110	GEAR:OPC:ASS'Y	1	X/O	Change of the material

11. Drive Section (G176/G177)

Index No.	Part No.	Description	Q'ty Per Assembly
1	G175 1050	Brushless Motor - DC 31W	1
2	G052 1102	Drive Unit Bracket	1
3	G175 3209	Magnetic Clutch	1
4	G175 2554	Spring Clutch Bracket	1
5	G129 2551	Magnetic Clutch:1turn:Z41	1
6	G052 1104	Gear - Fusing 1	1
7	G052 1108	Gear - Paper Feed 1	1
8	G052 1109	Gear - Paper Feed 2	1
9	G052 1113	Gear - Paper Feed 6	1
10	G052 1112	Gear - Paper Feed 5	1
11	G052 1111	Gear - Paper Feed 4	1
12	G052 1110	Gear - Paper Feed 3	1
13	G175 1106	Gear - 45Z	1
14	G052 1107	Gear - Pulley - Fusing	1
15	5353 1803	Wave Washer	1
16	G052 1120	Spring - Paper Exit Release	1
17	G052 1121	Drive Belt	1
18	G052 1123	Spacer - Drive Unit	1
19	G088 1103	Gear:PCU	1
20	G052 1105	Gear - Fusing 2	1
21	G175 2555	Harness Holder	1

Index No.	Part No.	Description	Q'ty Per Assembly
101	0450 3010N	Tapping Screw - M3x10	
102	1105 0292	Wire Saddle	
103	0450 4010N	Tapping Screw:M4x10	
104	0805 0089	Retaining Ring - M4	

G0881103 ⇒ **G1681110**
GEAR:OPC:ASS'Y

