

Model: Model K-P4		Date: 12-Jan-05	No.: MG116001
Modified Article: Paper Tray Rear Cover		Prepared by: A. Ishiyama	
From: 1st Technical Support Sec. Service Support Dept.			
Reason for Modification:	<input checked="" type="checkbox"/> Parts catalog correction <input type="checkbox"/> To facilitate assembly <input type="checkbox"/> Part standardization	<input type="checkbox"/> Vendor change <input type="checkbox"/> To improve reliability <input type="checkbox"/> Other	<input type="checkbox"/> To meet standards ()
Modification Schedule:	From first mass production.		

Please apply the following P/N corrections to your Parts Catalogs.

Incorrect Part Number	Correct Part Number	Description	Q'ty	Int	Page	Index	Note
G0523111	G1166651	Paper Tray Rear Cover	1→1	X/O	19	26	

Reason:

1. The color of the part used in the new machine is not the same as the color of the part used in the previous machine.

Model: Model K-P4		Date: 25-Mar-05	No.: MG116002
Modified Article: Pressure Roller Lever		Prepared by: A. Ishiyama	
From: 1st Technical Support Sec. Service Support Dept.			
Reason for Modification:	<input checked="" type="checkbox"/> Parts catalog correction <input type="checkbox"/> To facilitate assembly <input type="checkbox"/> Part standardization	<input type="checkbox"/> Vendor change <input type="checkbox"/> To improve reliability <input type="checkbox"/> Other	<input type="checkbox"/> To meet standards ()
Modification Schedule:	From first mass production.		

Old Part Number	New Part Number	Description	Q'ty	Int	Page	Index	Note
G0524662	G1114065	Pressure Roller Lever	1→1	X/O	17	9	

Change: The shape of the lever was changed.

Reason: To improve the reliability of the lever spring.

Note: The old part (G0524662) is still used on the K-P1/P2/P3 and C-P1/P2.

Model: Model K-P4		Date: 25-Mar-05	No.: MG116003
Modified Article: Ferrite Core		Prepared by: A. Ishiyama	
From: 1st Technical Support Sec. Service Support Dept.			
Reason for Modification:	<input checked="" type="checkbox"/> Parts catalog correction <input type="checkbox"/> To facilitate assembly <input type="checkbox"/> Part standardization	<input type="checkbox"/> Vendor change <input type="checkbox"/> To improve reliability <input type="checkbox"/> Other	<input type="checkbox"/> To meet standards ()
Modification Schedule:	From first mass production.		

Old Part Number	New Part Number	Description	Q'ty	Int	Page	Index	Note
-	16071092	Ferrite Core – RFC-10	0→1	-	3	106	

Change: This part was added.

Reason: It was missing from the Parts Catalog.

Model: Model K-P4		Date: 25-Mar-05	No.: MG116004
Modified Article: Energy Star Decal		Prepared by: A. Ishiyama	
From: 1st Technical Support Sec. Service Support Dept.			
Reason for Modification:	<input checked="" type="checkbox"/> Parts catalog correction <input type="checkbox"/> To facilitate assembly <input type="checkbox"/> Part standardization	<input type="checkbox"/> Vendor change <input type="checkbox"/> To improve reliability <input type="checkbox"/> Other	<input type="checkbox"/> To meet standards ()
Modification Schedule:	From first mass production.		

Old Part Number	New Part Number	Description	Q'ty	Int	Page	Index	Note
-	G0942374	Decal – ES+PS	0→1	-	3 57	31 8	

Change: This part was added.

Reason: It was missing from the Parts Catalog.

Note: This part is also used on the C-P1/P2 and G-P1. The part used on the K-P3 is different.

Reissued: 4-Jun-07

Model: K-P4	Date: 25-Mar-05	No.: MG116005a
-------------	-----------------	----------------

MB Reissue

The items in ***bold italics*** were changed, and some items were deleted.

Modified Article: Bypass Tray Paper Pick-up Mechanism		Prepared by: Y.Yoshida	
From: 1st Tech. Support Sec. Service Support Dept.			
Reason for Modification:	<input checked="" type="checkbox"/> Parts catalog correction	<input type="checkbox"/> Vendor change	<input type="checkbox"/> Other
	<input type="checkbox"/> To facilitate assembly	<input type="checkbox"/> To improve reliability	<input type="checkbox"/> To meet standards (RoHs compliant)
	<input type="checkbox"/> Part standardization	<input type="checkbox"/> Product Safety	

Original Part Number	New Part Number	Description	Q'ty	Int	Page	Index	Note
G1292551		Magnetic Clutch : 1 turn:Z41	1→1	X/X	21	4	*
	→ G0883297	Spring Clutch : Manual Feed					
G1292550		Stopper : Magnetic Clutch	1→0	-	21	21	
	G0523388	Solenoid – DC24V	0→1	-	21	3	
G1112601		Bypass Feed Roller	1→1	X/X	9	13	
	→ G0523288	Bypass Feed Roller					

Clutch System

Solenoid System

Change: The paper feed mechanism was ***permanently changed*** to a solenoid system.
(This is the same system that is used on the C-P1/K-P3).

Reason: To ensure high reliability of the paper feed system.

Note:

- See **RTB RG116009** for more details.
- This change is for the C-P2b/P2c and K-P4.

Model: Model K- P4		Date: 19-Apr-05	No.: MG116006
Modified Article: Model Name Plate and Front Door Ass'y		Prepared by: A. Ishiyama	
From: 1st Technical Support Sec. Service Support Dept.			
Reason for Modification:	<input checked="" type="checkbox"/> Parts catalog correction <input type="checkbox"/> To facilitate assembly <input type="checkbox"/> Part standardization	<input type="checkbox"/> Vendor change <input type="checkbox"/> To improve reliability <input type="checkbox"/> Other	<input type="checkbox"/> To meet standards ()
Modification Schedule:	From first mass production		

Old Part Number	New Part Number	Description	Q'ty	Int	Page	Index	Note
	G1167053	MODEL NAME PLATE:SAN:NA:G116	0→1	-	3	17	*1
	G1167054	MODEL NAME PLATE:LAN:NA:G116	0→1	-	3	17	*1
	G1167055	MODEL NAME PLATE:GES:NA:G116	0→1	-	3	17	*1
	G1167050	MODEL NAME PLATE:GES:G116-22	0→1	-	3	17	NRG EU
	G1167051	MODEL NAME PLATE:REX:G116-22	0→1	-	3	17	NRG EU
	G1167052	MODEL NAME PLATE:NST:G116-22	0→1	-	3	17	NRG EU

*1: These parts are for North America only.

Change: These parts were added.

Reason: They were missing from the Parts Catalog.

Model: Model K- P4		Date: 19-Apr-05	No.: MG116007
Modified Article: Controller NVRAM		Prepared by: A. Ishiyama	
From: 1st Technical Support Sec. Service Support Dept.			
Reason for Modification:	<input checked="" type="checkbox"/> Parts catalog correction <input type="checkbox"/> To facilitate assembly <input type="checkbox"/> Part standardization	<input type="checkbox"/> Vendor change <input type="checkbox"/> To improve reliability <input type="checkbox"/> Other	<input type="checkbox"/> To meet standards ()
Modification Schedule:	From first mass production		

Old Part Number	New Part Number	Description	Q'ty	Int	Page	Index	Note
14076249		RAM:FM25L256-PG	1→0	O/O	40, 45	130	
	14076465	RAM:FM25L256-PG(REV.AG)	0→1				

Change/Reason: Parts standardization.

Model: Model K-P4		Date: 27-Jul-06	No.: MG116008
Modified Article: Environmental Correspondence: Choke Coil		Prepared by: Y. Murata	
From: 1st Technical Support Sec. Service Support Dept.			
Reason for Modification:	<input type="checkbox"/> Parts catalog correction <input type="checkbox"/> To facilitate assembly <input checked="" type="checkbox"/> Part standardization	<input type="checkbox"/> Vendor change <input type="checkbox"/> To improve reliability <input type="checkbox"/> Other	<input type="checkbox"/> To meet standards ()
Modification Schedule:	From January '06 production.		

Old Number	New Number	Description	Q'ty	Int	Page	Index	Note
G0523522	G1113522	Discharge Lamp:P3	1	O/O	19	21	
G0525404	G1115404	Harness-Tonner End Sesor	1	O/O	11	15	
G0885400	G1115600	Harness:FST:Co nnecting	1	O/O	11	11	
G0883539	G1113539	Internal Thermistor	1	O/O	3	6	

Reason:

1. Change of the materials used in the part in accordance with environmental restrictions.

Model: K-P4		Date: 7-Aug-06	No.: MG116009
Modified Article: Power Supply Unit 124W EU		Prepared by: Y.Murata	
From: 1st Tech. Support Sec. Service Support Dept.			
Reason for Modification:	<input type="checkbox"/> Parts catalog correction <input type="checkbox"/> Vendor change <input type="checkbox"/> Other <input type="checkbox"/> To facilitate assembly <input type="checkbox"/> To improve reliability <input checked="" type="checkbox"/> To meet standards (RoHS compliant) <input type="checkbox"/> Part standardization <input type="checkbox"/> Product Safety		

Old part number	New part number	Description	Q'ty	Int	Page	Index	Note
G0885211	G1115211	Power Supply Unit 124W EU	1	O/O	23	12	

Change: The materials for these parts were changed.

Reason: To comply with the RoHS Directive.

Reissued:21-Aug-06

Model: K-P4	Date: 7-Aug-06	No.: MG116010a
-------------	----------------	----------------

MB Reissue

The items in bold italics have been corrected or added.

Modified Article: Power Pack BCT		Prepared by: Y.Murata	
From: 1st Tech. Support Sec. Service Support Dept.			
Reason for Modification:	<input type="checkbox"/> Parts catalog correction <input type="checkbox"/> To facilitate assembly <input type="checkbox"/> Part standardization	<input type="checkbox"/> Vendor change <input type="checkbox"/> To improve reliability <input type="checkbox"/> Product Safety	<input type="checkbox"/> Other <input checked="" type="checkbox"/> To meet standards (RoHS compliant)

Old part number	New part number	Description	Q'ty	Int	Page	Index	Note
<i>G0965300</i>	G1295300	Power Pack BCT	1	O/O	23	9	

Change: The materials for these parts were changed.

Reason: To comply with the RoHS Directive.

Model: Kir-P4		Date: 7-Sep-06	No.: MG116011
Modified Article: Brushless Motor:24V:20W:RoHs		Prepared by: Y.Murata	
From: 1st Tech. Support Sec. Service Support Dept.			
Reason for Modification:	<input type="checkbox"/> Parts catalog correction <input type="checkbox"/> To facilitate assembly <input type="checkbox"/> Part standardization	<input type="checkbox"/> Vendor change <input type="checkbox"/> To improve reliability <input type="checkbox"/> Product Safety	<input type="checkbox"/> Other <input checked="" type="checkbox"/> To meet standards (RoHs compliant)

Old part number	New part number	Description	Q'ty	Int	Page	Index	Note
G1291050	G1111035	Brushless Motor:24V:20W:RoHs	1	O/O	21	1	

Change: The materials for these parts were changed.

Reason: To comply with the RoHS Directive.

Model:K-P4		Date: 29-Sep-06	No.: MG116012
Modified Article: Imaging Unit		Prepared by: Y.Murata	
From: 1st Tech. Support Sec. Service Support Dept.			
Reason for Modification:	<input type="checkbox"/> Parts catalog correction <input type="checkbox"/> Vendor change <input type="checkbox"/> Other <input type="checkbox"/> To facilitate assembly <input type="checkbox"/> To improve reliability <input checked="" type="checkbox"/> To meet standards (RoHs compliant) <input type="checkbox"/> Part standardization <input type="checkbox"/> Product Safety		

Oldest part number	Old part number	New part number	Description	Q'ty	Int	Page	Index	Note
G1111904	G1111906	G1111907	Imaging Unit:EU:Ass'y	1	O/O	5	1	
G1291912	G1291915	G1291922	Laser Diode Unit:EXP:Ass'y	1	O/O	5	4	

Change: The materials of these parts have changed.

Reason: To comply with RoHs Directive.

Model: Model K-P4		Date: 14-Sep-07	No.: MG116013
Modified Article: Friction Pad		Prepared by: Y.Yoshida	
From: 1st Technical Support Sec. Service Support Dept.			
Reason for Modification:	<input type="checkbox"/> Parts catalog correction <input type="checkbox"/> To facilitate assembly <input type="checkbox"/> Part standardization	<input type="checkbox"/> Vendor change <input type="checkbox"/> To improve reliability <input type="checkbox"/> Other	<input checked="" type="checkbox"/> To meet standards ()
Modification Schedule:			

Old Part Number	New Part Number	Description	Q'ty	Int	Page	Index	Note
G0883135	G1112588	Friction Pad	1→1	X/O	7	6	

Change: The material of this part was changed.

Reason: To conform to the RoHS Directive.

Model: Model K-P4		Date: 4-Feb-08	No.: MG116014
Modified Article: Parts number change-Clutch		Prepared by: Y.Yoshida	
From: 1st Technical Support Sec. Service Support Dept.			
Reason for Modification:	<input checked="" type="checkbox"/> Parts catalog correction <input type="checkbox"/> To facilitate assembly <input type="checkbox"/> Part standardization	<input type="checkbox"/> Vendor change <input checked="" type="checkbox"/> To improve reliability <input type="checkbox"/> Other	<input type="checkbox"/> To meet standards ()
Modification Schedule:			

Old Part Number	New Part Number	Description	Q'ty	Int	Page	Index	Note
G0763205	G1292585	Magnetic Clutch Ass'y – Regist (G091 G116)	1→1		11	3	
AX200209		Magnetic Clutch-Z25(G091)	1→0		21	2	
G1202582	GX200026	Magnetic clutch registration :0.35N·M:Z45 (G091 G116)	1→1		21	2	
G1112590	GX200027	Magnetic clutch – internal :0.25N·M:Z25 (G091 G116)	1→1		21	2	

Change:

- 1) P/N AX200209 was deleted from the Parts Catalog
- 2) The type of grease applied to the clutches on the production line was changed.

Reason:

- 1) P/N AX200209 and its description were incorrect.
- 2) To improve the reliability of these clutches.

Note: P/N G1292585 (pg. 11, index #3) includes P/N GX200026.

5.PAPER REGISTRATION (G091/G116)

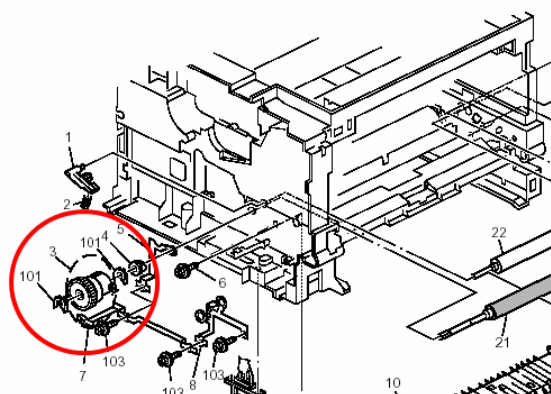

10.DRIVE SECTION (G091/G116)

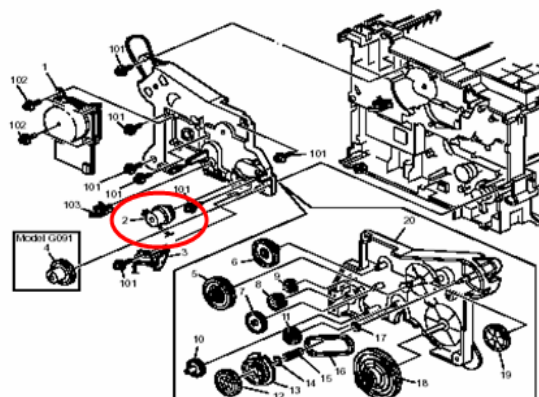

Model: Model K- P4		Date: 13-Feb-08	No.: MG116015
Modified Article: Controller Board		Prepared by: Y. Yoshida	
From: 1st Technical Support Sec. Service Support Dept.			
Reason for Modification:	<input checked="" type="checkbox"/> Parts catalog correction <input type="checkbox"/> To facilitate assembly <input type="checkbox"/> Part standardization	<input type="checkbox"/> Vendor change <input type="checkbox"/> To improve reliability <input type="checkbox"/> Other	<input checked="" type="checkbox"/> To meet standards ()
Modification Schedule:			

Old Part Number	New Part Number	Old Description	Description	Q'ty	Int	Page	Index	Note
G0915702	G0915703	PCB:TYPE-K3: EXP:NIC	PCB:TYPE-K3: EXP:NIC	1→1	O/O	25	7	MB4
G0915702	G1165317	PCB:TYPE-K3: EXP:NIC	PCB:KIR-P4D:PROGRAM: EXP:NIC	1→1	O/O	25	7	

Change:

- 1) The material for the G0915702 PCB was changed. (Kir-P3)
- 2) P/N G1165317 was added to the Parts Catalog. (Kir-P4)

Reason:

- 1) RoHS compliance
- 2) The P/N was missing from the catalog. (Kir-P4)

Model: K-P4		Date: 9-Sep-08	No.: MG116016
Modified Article: EEPROM and DIP Switch (Engine Board)		Prepared by: Y.Gaman	
From: 1st Tech. Support Sec. Service Support Dept.			
Reason for Modification:	<input type="checkbox"/> Parts catalog correction <input type="checkbox"/> Vendor change <input type="checkbox"/> Other <input type="checkbox"/> To facilitate assembly <input type="checkbox"/> To improve reliability <input type="checkbox"/> To meet standards <input checked="" type="checkbox"/> Part standardization <input type="checkbox"/> Product Safety ()		

Old part number	New part number	Description	Q'ty	Int	Page	Index	Note
14075271	14076588	EEPROM - M24C02- WBN6P	1	O/O	63	131	
12042415	12042801	DIP SWITCH	1	O/O	63	120	

Change/Reason: Parts standardization.

Model: Model K-P4		Date: 24-Oct-08	No.: MG116017
Modified Article: Drive Unit Bracket		Prepared by: Y.Yoshida	
From: 1st Technical Support Sec. Service Support Dept.			
Reason for Modification:	<input type="checkbox"/> Parts catalog correction <input type="checkbox"/> To facilitate assembly <input type="checkbox"/> Part standardization	<input type="checkbox"/> Vendor change <input checked="" type="checkbox"/> To improve reliability <input type="checkbox"/> Other	<input type="checkbox"/> To meet standards ()
Modification Schedule:			

Old Part Number	New Part Number	Description	Q'ty	Int	Page	Index	Note
G0521102	M0011122	Drive Unit Bracket	1→1		21	20	

Change: The material of the shaft was changed.

Reason: To further improve the performance of the drum drive mechanism.

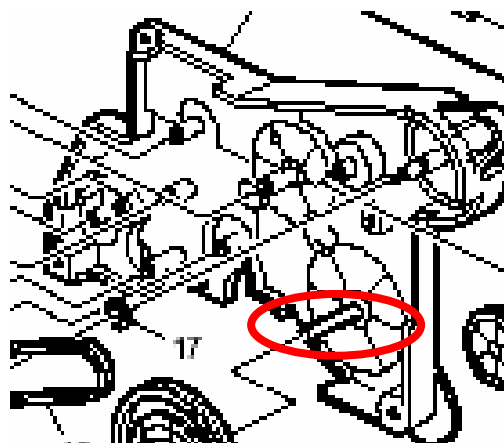



Part Change Information List

Date: May 30, 2009

Model	Code	PCIL Number	PCIL Correction	Old part number	New part number	Description	Old Q'ty	New Q'ty	Int	3DPC	Page	Index	Set	Set Int	RTB	Note	Ref Number
K-P4	G111	200905		G0524699	G0964692	FUSING RIGHT COVER	1	1	X/O		15	10					V0901196
K-P4	G114	200905		G0524699	G0964692	FUSING RIGHT COVER	1	1	X/O		15	10					V0901196
K-P4	G115	200905		G0524699	G0964692	FUSING RIGHT COVER	1	1	X/O		15	10					V0901196
K-P4	G116	200905		G0524699	G0964692	FUSING RIGHT COVER	1	1	O/O		15	10					V0901196



Part Change Information List

Date: September 30, 2009

Model	Code	PCIL Nr.	PCIL Correction	Old part number	New part number	Description	Old Q'ty	New Q'ty	Int	3DPC	Page	Index	Set	Set Int	RTB	Note	Ref. Nr.	ECN Nr.
K-P4	G116	200909			G1111203	COVER:FRONT:EU:ASS'Y	0	1			3	50			Y		V0901628	



Part Change Information List

Date: October 30, 2009

Model	Code	PCIL Nr.	PCIL Correction	Old part number	New part number	Description	Old Q'ty	New Q'ty	Int	3DPC	Page	Index	Set	Set Int	RTB	Note	Ref. Nr.	ECN Nr.
K-P4	G116	200910			G1111206	COVER:FRONT:ASS'Y	0	1			3	50			Y		V0901628	



Part Change Information List

Date: November 30, 2010

Model	Code	PCIL Nr.	PCIL Correctio	Old part number	New part number	Description	Old Q'ty	New Q'ty	Int	3DPC	Page	Index	Set	Set Int	RTB	Note	Ref. Nr.	ECN Nr.
K-P4	G116	201011		G0521518	G0521525	Spring - Lock Lever	1	1	X/O		3	12					V1001674	10050174

RICOH**Part Change Information List**

Date: July 30, 2013

Model	Code	PCIL Number	PCIL Correction	Old part number	New part number	Description	Old Q'ty	New Q'ty	Int	3DPC	Page	Index	Set	Set Int	RTB	Note	Ref Number	ECN Number
K-P4	G116	201307		G0525060	M0015250	PCB:SYNC DETECTOR BOARD	1	1	O/O		5	15					V1301110	13021099



Part Change Information List

Date: May 30, 2014

Model	Code	PCIL Number	PCIL Correction	Old part number	New part number	Description	Old Q'ty	New Q'ty	Int	3DPC	Page	Index	Set	Set Int	RTB	Note	Ref Number	ECN Number
K-P4	G111	201405		G0525060	M0015250	PCB:SYNC DETECTOR BOARD	1	1	O/O		5	15					V1301122	
K-P4	G114	201405		G0525060	M0015250	PCB:SYNC DETECTOR BOARD	1	1	O/O		5	15					V1301122	
K-P4	G115	201405		G0525060	M0015250	PCB:SYNC DETECTOR BOARD	1	1	O/O		5	15					V1301122	
K-P4	G114	201405		G1152562	G3982562	PAPER TRAY:REAR	1	1	X/O		7	18					V1304152	
K-P4	G115	201405		G1152562	G3982562	PAPER TRAY:REAR	1	1	X/O		7	18					V1304152	



Part Change Information List

Date: October 31, 2014

Model	Code	PCIL Number	PCIL Correction	Old part number	New part number	Description	Old Q'ty	New Q'ty	Int	3DPC	Page	Index	Set	Set Int	RTB	Note	Ref Number	ECN Number
K-P4	G111	201410		G0521274	M0791274	LEVER:MICRO SWITCH:REAR	1	1	X/O		19	1					V1402928	
K-P4	G114	201410		G0521274	M0791274	LEVER:MICRO SWITCH:REAR	1	1	X/O		19	1					V1402928	
K-P4	G115	201410		G0521274	M0791274	LEVER:MICRO SWITCH:REAR	1	1	X/O		19	1					V1402928	
K-P4	G116	201410		G0521274	M0791274	LEVER:MICRO SWITCH:REAR	1	1	X/O		19	1					V1402928	