

Model: Paper Feed Unit for Model Ti-P1		Date: 05-Sep-13	No.: RM406001
Subject: Upper Left Cover & Frame		Prepared by: H.K.	
From: 3rd Tech Service Sect., MFP/P Tech Service Dept.			
Classification:	<input type="checkbox"/> Troubleshooting <input type="checkbox"/> Mechanical <input type="checkbox"/> Paper path <input type="checkbox"/> Product Safety	<input checked="" type="checkbox"/> Part information <input type="checkbox"/> Electrical <input type="checkbox"/> Transmit/receive <input type="checkbox"/> Other ()	<input type="checkbox"/> Action required <input type="checkbox"/> Service manual revision <input type="checkbox"/> Retrofit information <input type="checkbox"/> Tier 2

Old part number	New part number	Description	Q'ty	Int	Page	Index	Note
M4061003	M4069500	COVER:UPPER:LEFT	1 - 1	O/O			
M4069500	M4081003	COVER:UPPER:LEFT	1 - 1	X/X			

Change: The shapes of the left upper cover and left side frame (non service parts) were changed.

Reason: To standardize these parts with future models

See Important Notes below.

Left upper cover:

1. The two concave rectangles were added.
2. The length of the cover was increased by 30 mm.

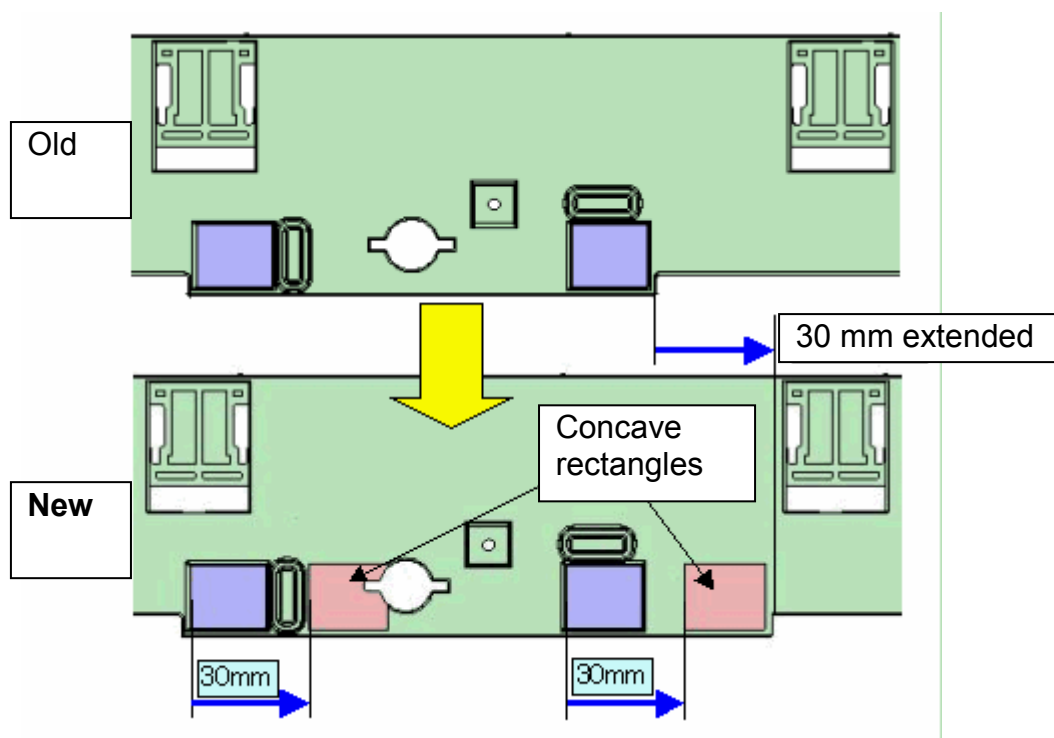

Left side frame

1. A 3 mm section was cut from the area of the rib shown.
2. The length of the frame was increased by 30 mm.

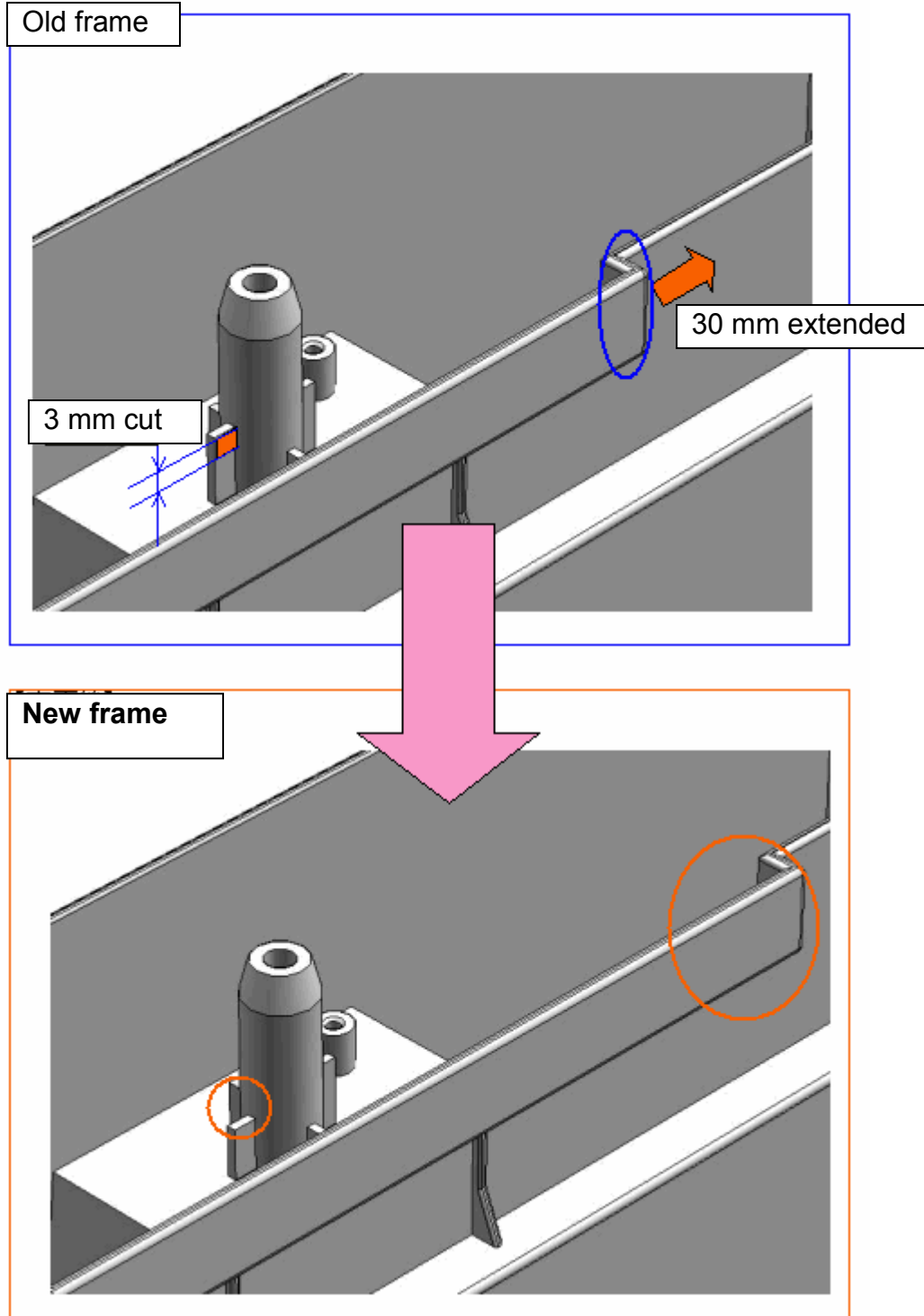

Important notes about interchangeability

- Interchangeability of production machines:
 - M4061003 → M4081003 = X/X
- Interchangeability of old machines in the field:
 - M4061003 → M4069500 = O/O
- The M4081003 cover cannot be installed on old machines in the field due to physical incompatibility with the new frame.
 - M4081003: For attachment to new machines in the field
 - M4061003 and M4069500: For attachment on old machines in the field.

Note: M4069500 has been specially modified so that it is compatible with the frame on old machines.

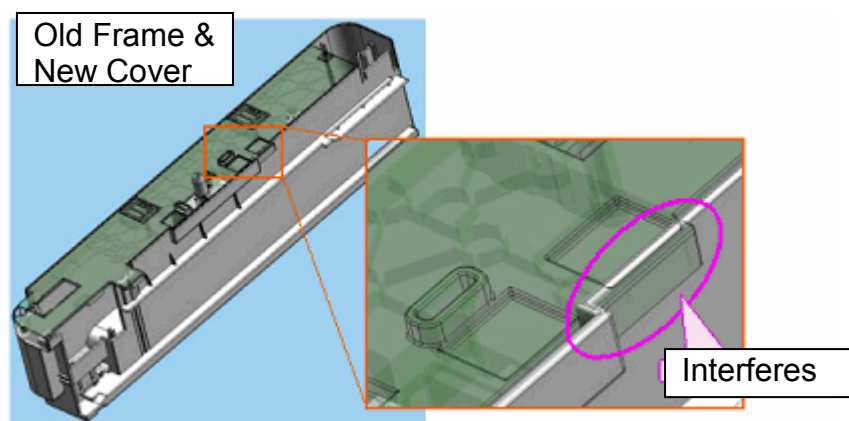

RAI (China) Production

MODEL NAME	V/Hz	DESTINATION	CODE	SERIAL NUMBER
Paper Feed Unit TK2000	115/60, 220/50	USA, Europe, Asia	M406-17	T443Q310001
Paper Feed Unit TK2000	220/50	China	M406-21	From First Production

Model: Paper Feed Unit for Model Ti-P1		Date: 18-Oct-13	No.: RM406002
Subject: RUBBER FOOT		Prepared by: H.K.	
From: 3rd Tech Service Sect., MFP/P Tech Service Dept.			
Classification:	<input type="checkbox"/> Troubleshooting <input type="checkbox"/> Mechanical <input type="checkbox"/> Paper path <input type="checkbox"/> Product Safety	<input checked="" type="checkbox"/> Part information <input type="checkbox"/> Electrical <input type="checkbox"/> Transmit/receive <input type="checkbox"/> Other ()	<input type="checkbox"/> Action required <input type="checkbox"/> Service manual revision <input type="checkbox"/> Retrofit information <input type="checkbox"/> Tier 2

Old part number	New part number	Description	Q'ty	Int	Note
	G5551057	RUBBER FOOT	2 - 3		

Change: The quantity for this part was increased from 2 to 3.

Reason: To further improve the stability of the tray when placed on a desk or table.

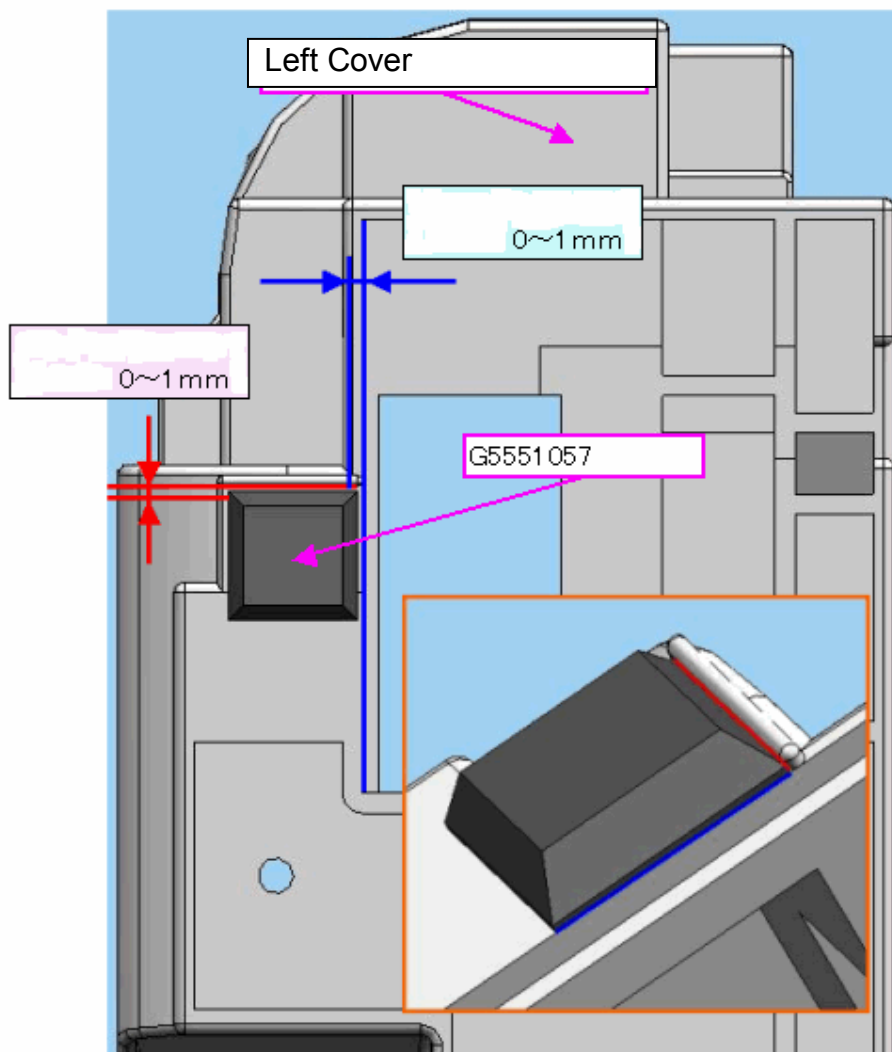
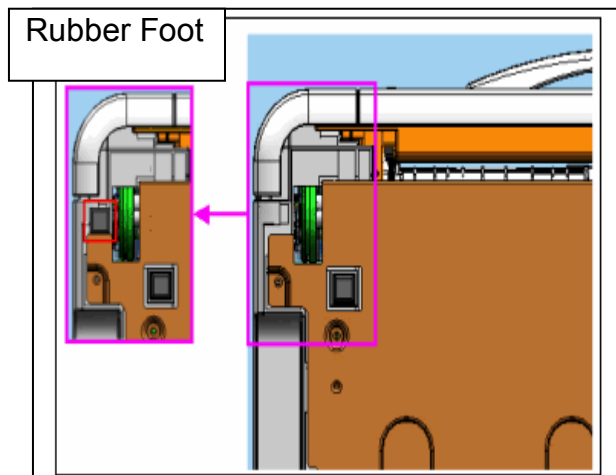

Model: Paper Feed Unit for Model Ti-P1	Date: 18-Oct-13	No.: RM406002
--	-----------------	---------------

RCP (China) Production

MODEL NAME	V/Hz	DESTINATION	CODE	SERIAL NUMBER
Paper Feed Unit TK2000	115/60, 220/50	USA, Europe, Asia	M406-17	T443QBxxxxx
Paper Feed Unit TK2000	220/50	China	M406-21	T443QBxxxxx

Reissued:6-Jun-14

Model: Paper Feed Unit for Model Ti-P1	Date: 21-Apr-14	No.: RM406003a
--	-----------------	----------------

RTB Reissue

The items in bold italics have been corrected or added.

Subject: A Non-Feed Jam (164g or more)		Prepared by: H.K.	
From: 3rd Tech Service Sect., MFP/P Tech Service Dept.			
Classification:	<input checked="" type="checkbox"/> Troubleshooting <input type="checkbox"/> Mechanical <input type="checkbox"/> Paper path <input type="checkbox"/> Product Safety	<input checked="" type="checkbox"/> Part information <input type="checkbox"/> Electrical <input type="checkbox"/> Transmit/receive <input type="checkbox"/> Other ()	<input type="checkbox"/> Action required <input type="checkbox"/> Service manual revision <input type="checkbox"/> Retrofit information <input checked="" type="checkbox"/> Tier 2

SYMPTOM

A non-feed jam occurs when feeding thick paper types (164g or more).

CAUSE

The friction between sheets of paper is high, causing one or more extra sheets to be fed together with the top sheet. The sheets hit the friction pad plate, and the plate lowers. As a result, the top sheet is held in place by the plate and is not fed.

SOLUTION

The shapes of the friction pad holder and cover were changed.

Old part number	New part number	Description	Q'ty	Int	Note
M4062623	M4062627	HOLDER:FRICITION PAD	1 - 1	X/X	<i>*:1</i>
M4062624	M4062628	COVER:FRICITION PAD	1 - 1	X/X	<i>*:1</i>
<i>M4062540</i>		<i>SHEET:HOLDER:PAPER TRAY</i>	<i>1 - 0</i>		<i>*:2</i>

Note:

1. This modification enables the holder and cover to stop ***the friction pad plate from lowering. (Modification 1)***
2. ***The paper tray holder sheet was eliminated on the modified machines since it was no longer necessary to prevent non-feed jams, but it is still available as a Service part for older machines. (Modification 2)***

IMPORTANT: If you need to replace the old friction pad holder or cover in the field, make sure to install the new parts **together as a set**.

Reissued:6-Jun-14

Model: Paper Feed Unit for Model Ti-P1

Date: 21-Apr-14

No.: RM406003a

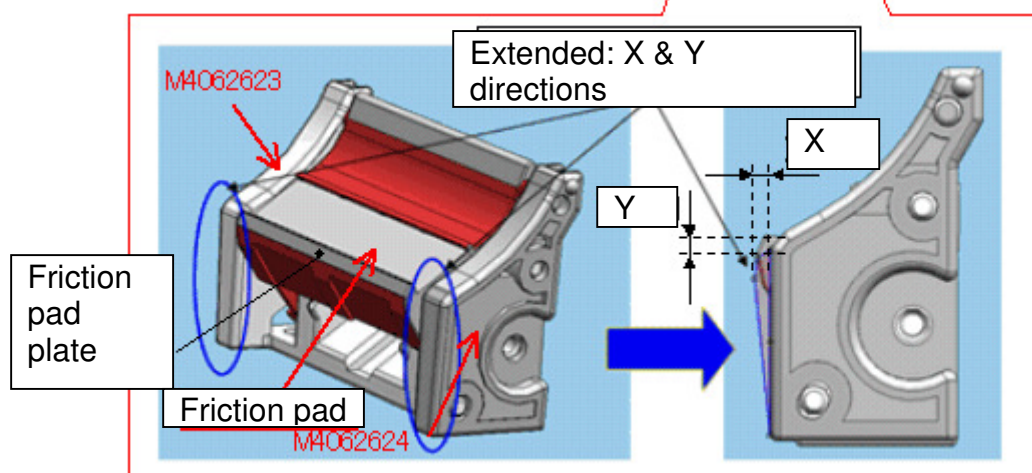
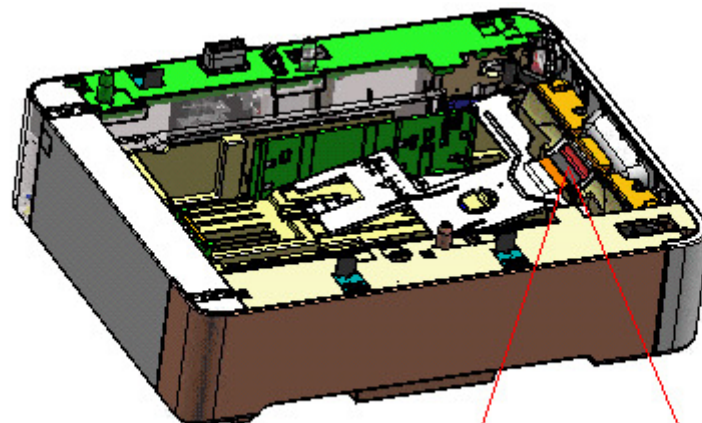

RCP (China) Production (Modification 1)

MODEL NAME	V/Hz	DESTINATION	CODE	SERIAL NUMBER
Paper Feed Unit TK2000	115/60, 220/50	USA, Europe, Asia	M406-17	T443QB10001
Paper Feed Unit TK2000	220/50	China	M406-21	T443QBxxxxx

Reissued:6-Jun-14

Model: Paper Feed Unit for Model Ti-P1	Date: 21-Apr-14	No.: RM406003a
--	-----------------	----------------

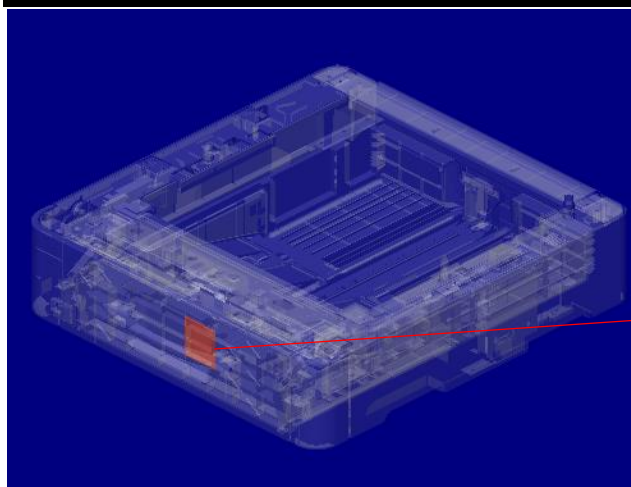

Paper tray holder
sheet

RCP (China) Production (*Modification 2*)

MODEL NAME	V/Hz	DESTINATION	CODE	SERIAL NUMBER
Paper Feed Unit TK2000	115/60, 220/50	USA, Europe, Asia	M406-17	T444Q2xxxxx
Paper Feed Unit TK2000	220/50	China	M406-21	T444Q2xxxxx

Model: Ti-P1 Paper Feed Unit TK2000 (M406)		Date: 2-Apr-15	No.: RM406004
Subject: Troubleshooting for Jam of additional paper tray		Prepared by: T.Suzuki	
From: 3rd Tech Service Sec., MFP Tech Service Dept.,			
Classification:	<input checked="" type="checkbox"/> Troubleshooting <input type="checkbox"/> Mechanical <input type="checkbox"/> Paper path <input type="checkbox"/> Product Safety	<input type="checkbox"/> Part information <input type="checkbox"/> Electrical <input type="checkbox"/> Transmit/receive <input type="checkbox"/> Other ()	<input type="checkbox"/> Action required <input type="checkbox"/> Service manual revision <input type="checkbox"/> Retrofit information <input type="checkbox"/> Tier 2

SYMPTOM

A jam occurs in the additional paper feed tray.

CAUSE

1. The spring is deformed

The spring is deformed and the paper feed pressure is lowered. Deformation of the spring is caused by the states below (a. and b.).

a. The operator inserts the paper feed tray with one side tilted (see the photo).

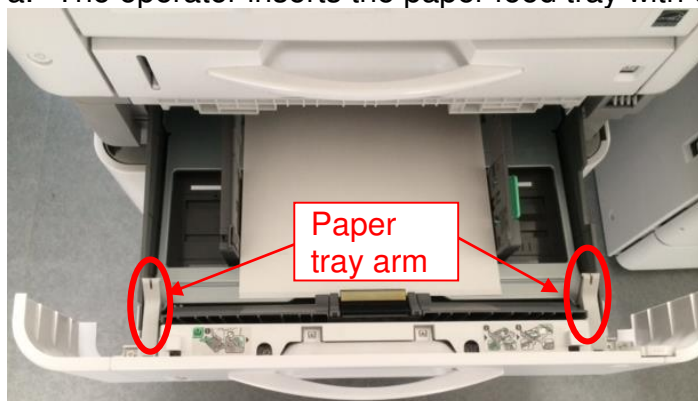

b. The spring is attached in the tilted state.

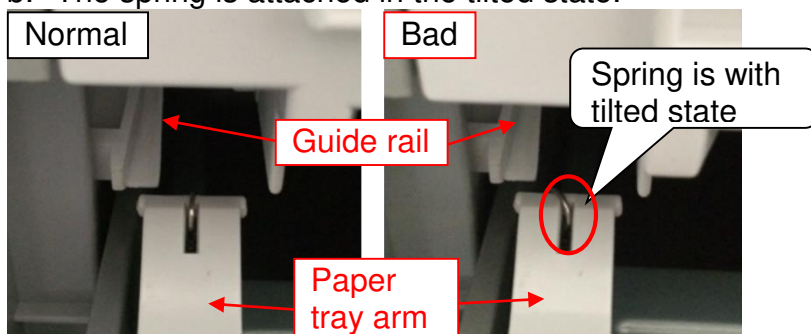

As a result of the above state, the spring contacts the guide rail and is deformed.

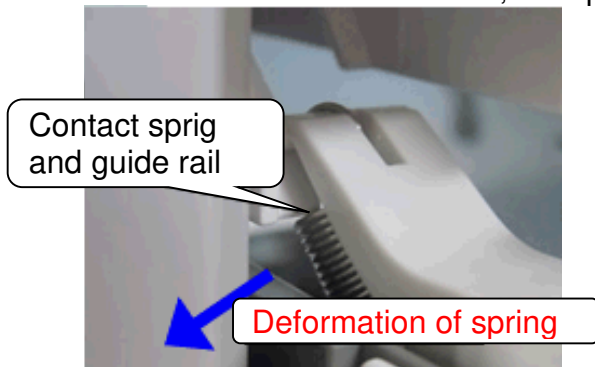

2. The guide rail for the paper feed arm breaks

The operator lifts up the paper tray (see the photos) when pulling out the tray. This causes the guide rail to be broken by contact with the tray (see the photos). As a result, the paper tray base plate cannot lift up to the position of the paper.

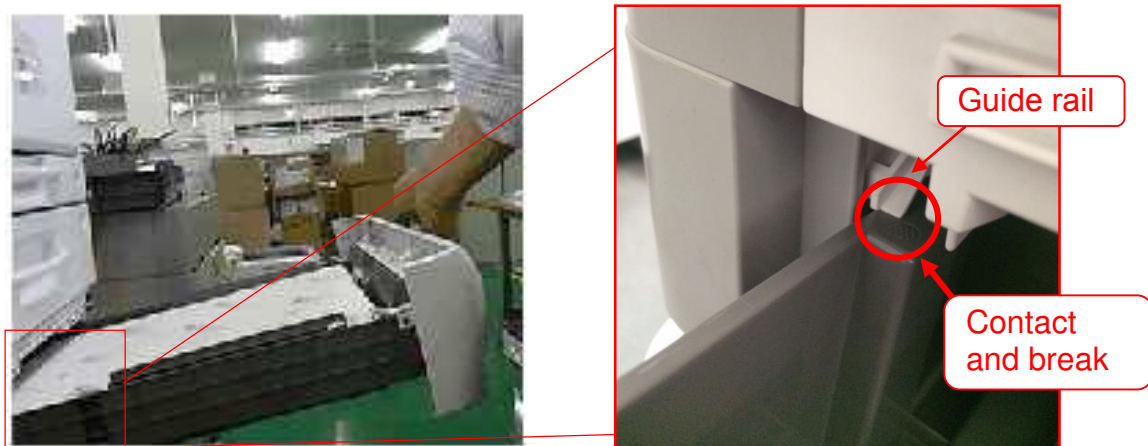

Model: Ti-P1 Paper Feed Unit TK2000 (M406)

Date: 2-Apr-15

No.: RM406004

SOLUTION

Temporary solution:

Install the following new part.

Old part number	New part number	Description	Q'ty	Int	Page	Index	Note
	M4059103	ARM ADDITION SUPPORT PLATE - 2PCS/SET	1 - 1	-	-	-	Add



The new part was added to the additional paper feed tray as shown.

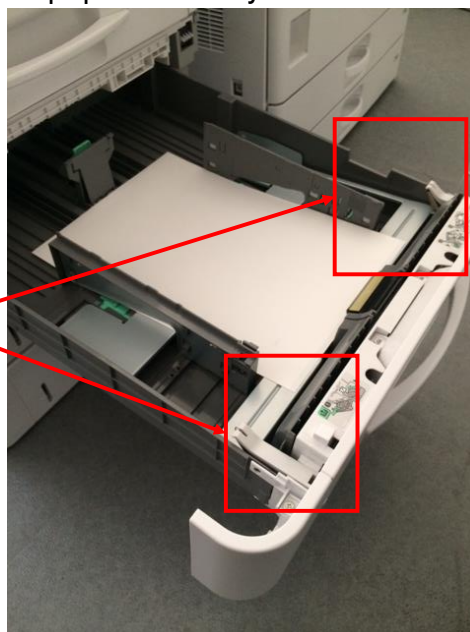

Attachment procedure

1. Remove the paper tray arm

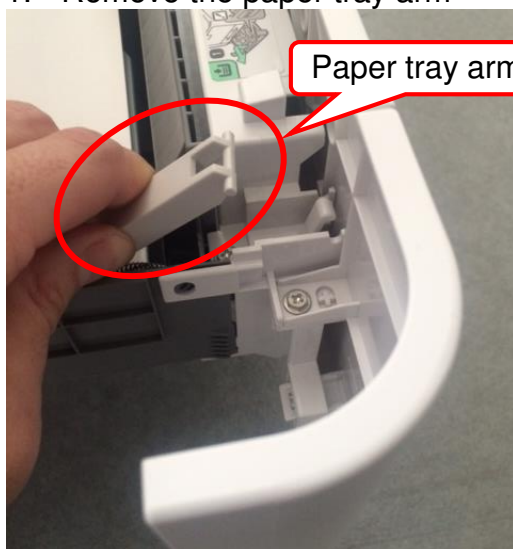

2. Remove the coated paper from the new part.
3. Attach the new part to the additional paper feed tray.

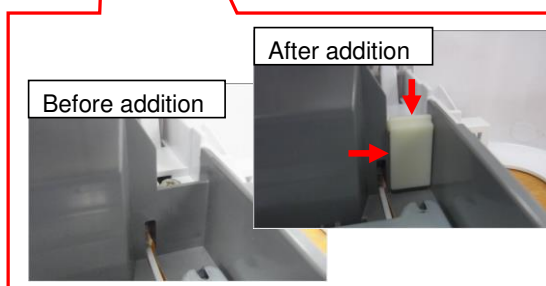
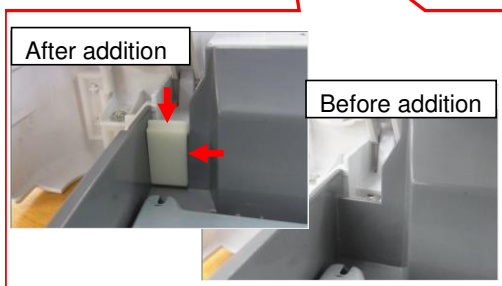
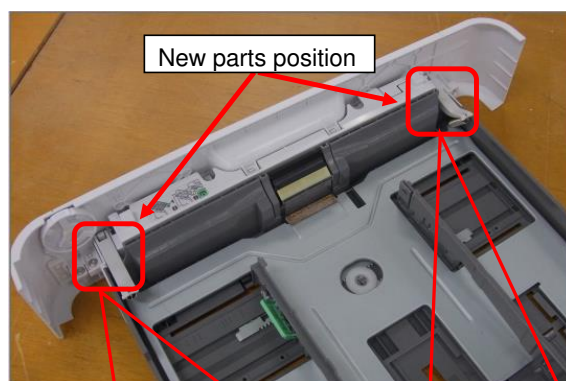

4. Reattach the paper tray arm.

Model: Ti-P1 Paper Feed Unit TK2000 (M406)

Date: 2-Apr-15

No.: RM406004

Permanent solution:

1. The height of the rib (see the photo) was increased on both sides.

Note: This is to prevent contact between the spring and guiderail. The lengthening of these ribs minimizes the rattling of the tray.

Old part number	New part number	Description	Q'ty	Int	Page	Index	Note
M4062550	M4062520	PAPER TRAY:ASS'Y	1 - 1	-	-	-	O/O

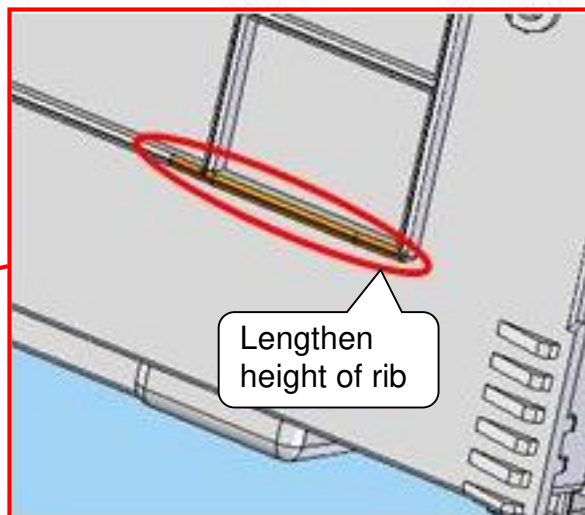
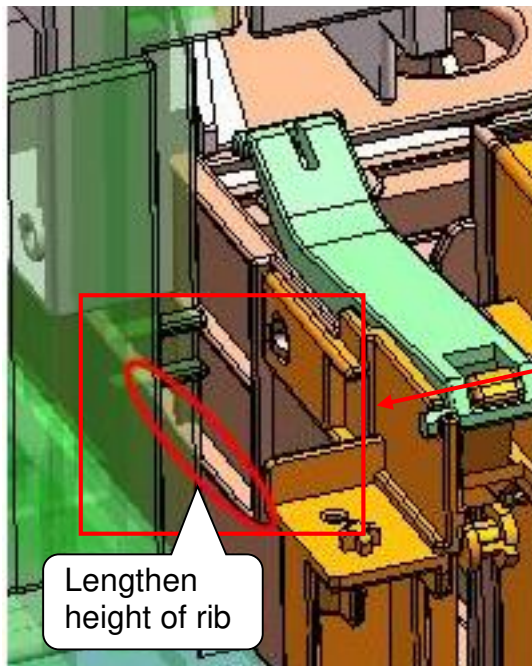

2. The guide rail was strengthened

Old part number	New part number	Description	Q'ty	Int	Page	Index	Note
M4062551	M4062553	HOUSING:PAPER FEED UNIT	1 - 1	-	-	-	O/O

Model: Ti-P1 Paper Feed Unit TK2000 (M406)

Date: 2-Apr-15

No.: RM406004

CUT-IN SERIAL NUMBERS

1. The height of the rib (see the photo) was increased on both sides.

RCP (Shenzhen) Production

MODEL NAME	V/Hz	DESTINATION	CODE	SERIAL NUMBER
Paper Feed Unit TK2000	-	USA, Europe, Asia	M406-17	T445Qxxxxxx

2. The guiderail was strengthened

RCP (Shenzhen) Production

MODEL NAME	V/Hz	DESTINATION	CODE	SERIAL NUMBER
Paper Feed Unit TK2000	-	USA, Europe, Asia	M406-17	T443Q810001

Model: Ti-P1 Paper Feed Unit TK2000 (M406)		Date: 2-Apr-15	No.: RM406005
Subject: Troubleshooting for additional paper tray		Prepared by: T.Suzuki	
From: 3rd Tech Service Sec., MFP Tech Service Dept.			
Classification:	<input checked="" type="checkbox"/> Troubleshooting	<input type="checkbox"/> Part information	<input type="checkbox"/> Action required
	<input type="checkbox"/> Mechanical	<input type="checkbox"/> Electrical	<input type="checkbox"/> Service manual revision
	<input type="checkbox"/> Paper path	<input type="checkbox"/> Transmit/receive	<input type="checkbox"/> Retrofit information
	<input type="checkbox"/> Product Safety	<input type="checkbox"/> Other ()	<input type="checkbox"/> Tier 2

SYMPTOM

A jam occurs in the additional paper feed tray.

CAUSE

The paper tray arm detaches easily.

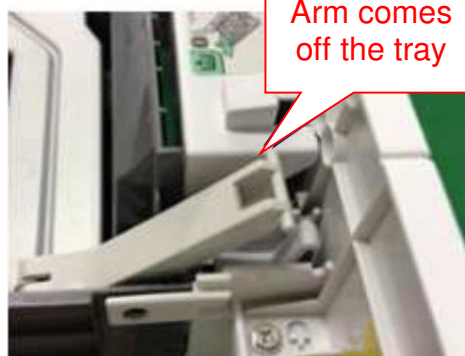

Model: Ti-P1 Paper Feed Unit TK2000 (M406)

Date: 2-Apr-15

No.: RM406005

SOLUTION

Temporary solution

Attach the following new part to the additional paper feed tray.

Old part number	New part number	Description	Q'ty	Int	Page	Index	Note
	M4059101	STRENGTHEN PART:ARM	1 - 1	-	-	-	Add



Attachment position:

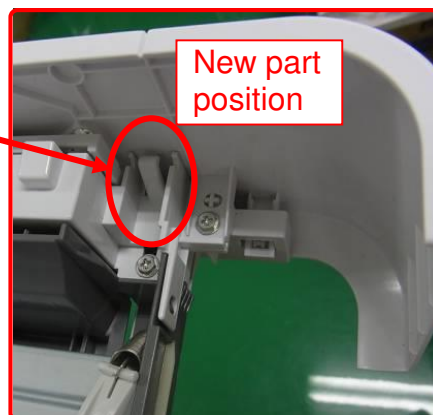

Attachment procedure

1. Remove the paper tray arm

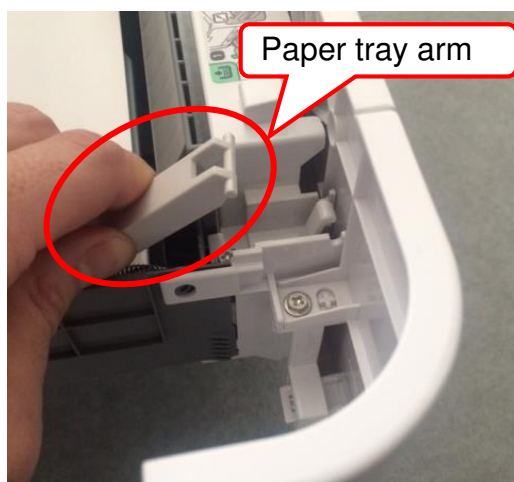

Model: Ti-P1 Paper Feed Unit TK2000 (M406)

Date: 2-Apr-15

No.: RM406005

2. Remove the coated paper from the new part.
3. Attach the new part as shown to the additional paper feed tray.



4. Reattach the paper tray arm.



Model: Ti-P1 Paper Feed Unit TK2000 (M406)

Date: 2-Apr-15

No.: RM406005

Permanent solution

Two ribs were added to the additional paper feed tray.

Note: This is to prevent the paper tray arm from detaching easily.

Old part number	New part number	Description	Q'ty	Int	Page	Index	Note
M4062520	M4062560	PAPER TRAY ASS'Y	1 - 1	-	-	-	X/O

Modification position

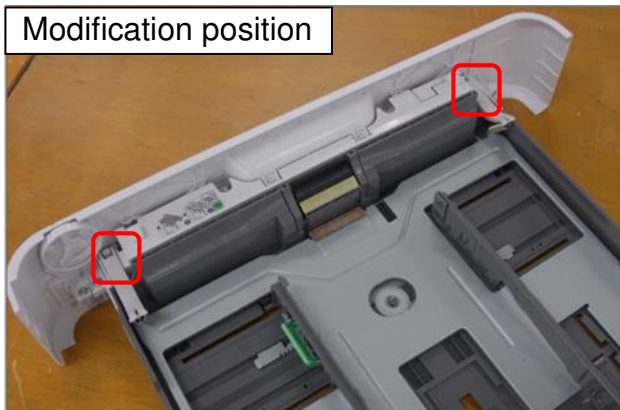

Before modification



After modification

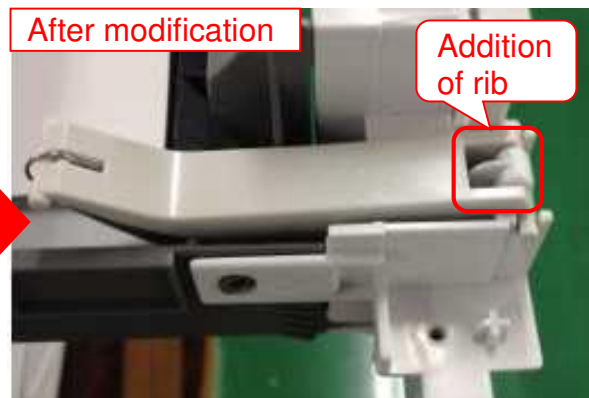

CUT-IN SERIAL NUMBERS

RCP (Shenzhen) Production

MODEL NAME	V/Hz	DESTINATION	CODE	SERIAL NUMBER
Paper Feed Unit TK2000	-	USA, Europe, Asia	M406-17	T443Q910001