

Reissued: 3-Mar-03

Model: Martini-C1/Bellini-C2 Finisher (SR840)	Date: 27-Feb-03	No.: MB478001a
---	-----------------	----------------

MB Correction

The items in bold italics have been corrected or added.

Modified Article: Main Control Board and EPROM		Prepared by: K. Miura	
From: Technical Services Sec. Service Planning Dept.			
Reason for Modification:	<input type="checkbox"/> Parts catalog correction	<input type="checkbox"/> Vendor change	<input type="checkbox"/> To meet standards ()
	<input type="checkbox"/> To facilitate assembly	<input checked="" type="checkbox"/> To improve reliability	
	<input type="checkbox"/> Part standardization	<input type="checkbox"/> Other	

The Main control EPROM and Main Control Board have been changed as follows:

Step	PCB: Main Control (P. 41-17)	EPROM: Main Control (P. 41-37)	Reason for Modification
—	B4785120	(B4785103)	1st Production (EPROM is not mentioned in Parts Catalog)
1	B4785130	B4785105	<ul style="list-style-type: none"> ● Punch Unit not working. ● SC726 and 732 may not be displayed. ● Jogger Unit does not work if the exit tray is not at its home position when printing begins. ● If the front door is open when the exit tray is moved, the exit tray will be out of position for the next feeding. ● The Finisher sometimes does not restart after a jam occurs in the Cover Interposer Tray. ● If the jogger size is changed during a continuous job, the Jogger Unit will not work during the second job. ● Paper remaining in the finisher may be not fed out even during the next job, causing a finisher jam.
2	B4785132	B4785107	SP6121 (Staple Jogging Repeat Setting) does not work. Note: Bellini-C2 only.

<Page 41 Index 17, 37>

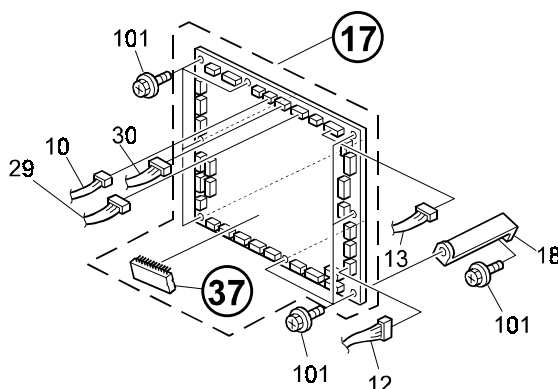

Reissued: 3-Mar-03

Model: Martini-C1/Bellini-C2 Finisher (SR840)	Date: 27-Feb-03	No.: MB478001a
---	-----------------	----------------

[Step 1]

[RCL (Japan) Production]

MODEL NAME	V/Hz	DESTINATION	CODE	SERIAL NO.
SR840	120/60	USA,	B478-17	J4921000551
SR840	220-240/50, 60	Europe, etc.	B478-26	9P31120001

[Step 2]

[RCL (Japan) Production]

MODEL NAME	V/Hz	DESTINATION	CODE	SERIAL NO.
SR840	120/60	USA,	B478-57	J4930100001
SR840	220-240/50, 60	Europe, etc.	B478-66	9R20130001

Model: Finisher (SR840) for Martini-C1/Bellini-C2		Date: 19-May-03	No.: MB478002
Modified Article: Parts Catlog		Prepared by: F.Noguchi	
From: 2nd Tech Support Sec. Service Support Dept.			
Reason for Modification:	<input checked="" type="checkbox"/> Parts catalog correction <input type="checkbox"/> To facilitate assembly <input type="checkbox"/> Part standardization	<input type="checkbox"/> Vendor change <input type="checkbox"/> To improve reliability <input type="checkbox"/> Other	<input type="checkbox"/> To meet standards ()

Please apply the following corrections to your Parts Catalogs.

	Part number	Description	Q'ty	Page	Index	Note
Incorrect	B3024254	Stapler Motor Bracket	1	15	3	
	B3024236	1st Folder - Stapler Unit	1	17	3	
Correct	B3024258	Stay: Stapler: Ass'y	1	15	3	
	B3024248	Holder: Middle: Stapler: Ass'y	1	17	3	

Model: Martini-C1/Bellini-C2 Finisher		Date: 22-May-03	No.: MB478003
Modified Article: Positioning Roller Bracket		Prepared by: M. Matsuda	
From: 2nd Tech. Support Sec. Service Support Dept.			
Reason for Modification:	<input type="checkbox"/> Parts catalog correction <input type="checkbox"/> To facilitate assembly <input type="checkbox"/> Part standardization	<input type="checkbox"/> Vendor change <input type="checkbox"/> To improve reliability <input checked="" type="checkbox"/> Other	<input type="checkbox"/> To meet standards ()

The shape of the following bracket has been changed to ensure it does not contact the Positioning Roller Arm.

Old part number	New part number	Description	Q'ty	Int	Page	Index	Note
B3022118	B3022124	Positioning Roller Bracket	1	X/O	25	17	

[RCL (Japan) Production]

MODEL NAME	V/Hz	DESTINATION	CODE	SERIAL NO.
SR840	120/60	USA, Europe, etc	B478-17	J4920900001

Reissued: 6-Jun-03

Model: Martini-C1/Bellini-C2 Finisher	Date: 29-May-03	No.: MB478004a
---------------------------------------	-----------------	----------------

MB Correction

The items in bold italics have been corrected or added.

Modified Article: Decal - R7		Prepared by: M. Matsuda	
From: 1st Tech. Support Sec. Service Support Dept.			
Reason for Modification:	<input type="checkbox"/> Parts catalog correction	<input type="checkbox"/> Vendor change	<input type="checkbox"/> To meet standards ()
	<input type="checkbox"/> To facilitate assembly	<input type="checkbox"/> To improve reliability	
	<input checked="" type="checkbox"/> Part standardization	<input type="checkbox"/> Other	

The following has been changed due to parts standardization with other models.

Old part number	New part number	Description	Q'ty	Int	Page	Index	Note
B3027707	B3125715	Decal – R7	1	O/O	9 47	8 7	

[RCL (Japan) Production]

MODEL NAME	V/Hz	DESTINATION	CODE	SERIAL NO.
SR840	120/60	USA,	B478-17	J49303xxxxx
SR840	220-240/50, 60	Europe, etc.	B478-26	9P3033xxxx
SR840	120/60	USA,	B478-57	J4930100511
SR840	220-240/50, 60	Europe, etc.	B478-66	9R20230017

Model: Martini-C1/Bellini-C2 Finisher		Date: 29-May-03	No.: MB478005
Modified Article: Upper Cover & Table		Prepared by: M. Matsuda	
From: 2nd Tech. Support Sec. Service Support Dept.			
Reason for Modification:	<input type="checkbox"/> Parts catalog correction <input type="checkbox"/> To facilitate assembly <input type="checkbox"/> Part standardization	<input type="checkbox"/> Vendor change <input type="checkbox"/> To improve reliability <input checked="" type="checkbox"/> Other	<input type="checkbox"/> To meet standards ()

The following parts have been combined as shown below in accordance with a vendor request.

Old part number	New part number	Description	Q'ty	Int	Page	Index	Note
B4786121	B4786120	Upper Cover	1	O/O	7	27	
B4786461		Label: Table					
B4786451	B4786450	Table	1	O/O	7	5	
B4786461		Label: Table					

Model: Martini-C1/Bellini-C2 Finisher		Date: 29-May-03	No.: MB478006
Modified Article: Guide:Feeler:Paper Sensor		Prepared by: M. Matsuda	
From: 2nd Tech. Support Sec. Service Support Dept.			
Reason for Modification:	<input type="checkbox"/> Parts catalog correction <input type="checkbox"/> To facilitate assembly <input type="checkbox"/> Part standardization	<input type="checkbox"/> Vendor change <input type="checkbox"/> To improve reliability <input checked="" type="checkbox"/> Other	<input type="checkbox"/> To meet standards ()

A Guide Mylar has been added to the sensor feeler to ensure the trailing edge of the paper does not get caught on the feeler.

Old part number	New part number	Description	Q'ty	Int	Page	Index	Note
-	B4783554	Guide:Feeler:Paper Sensor	1	-	37	*36	

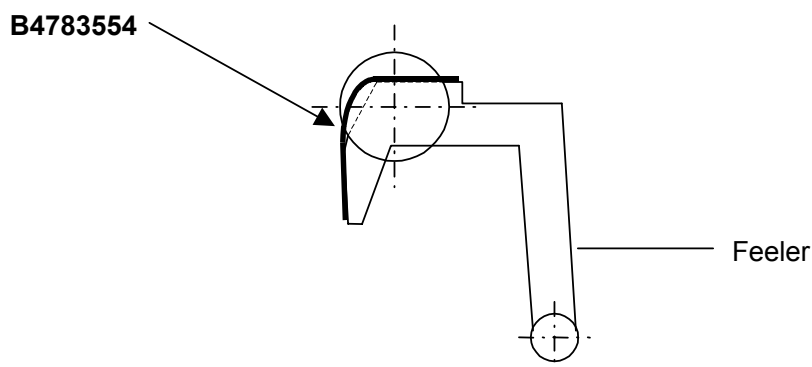
[RCL (Japan) Production]

MODEL NAME	V/Hz	DESTINATION	CODE	SERIAL NO.
SR840	120/60	USA,	B478-17	J4920900001
SR840	220-240/50, 60	Europe, etc.	B478-26	9P31020001

Model: Martini-C1/Belini-C2 Finisher		Date: 30-May-03	No.: MB478007
Modified Article: GUIDE:PAPER:INNER BACK		Prepared by: M. Matsuda	
From: 2nd Tech. Support Sec. Service Support Dept.			
Reason for Modification:	<input type="checkbox"/> Parts catalog correction <input type="checkbox"/> To facilitate assembly <input type="checkbox"/> Part standardization	<input type="checkbox"/> Vendor change <input type="checkbox"/> To improve reliability <input checked="" type="checkbox"/> Other	<input type="checkbox"/> To meet standards ()

A Guide Mylar has been added to the rear standard fence to ensure that paper in the stapler tray does not skew and cause a stapling error.

Old part number	New part number	Description	Q'ty	Int	Page	Index	Note
-	B4784527	GUIDE:PAPER:INNER BACK	1	-	13	*27	

*: New Index

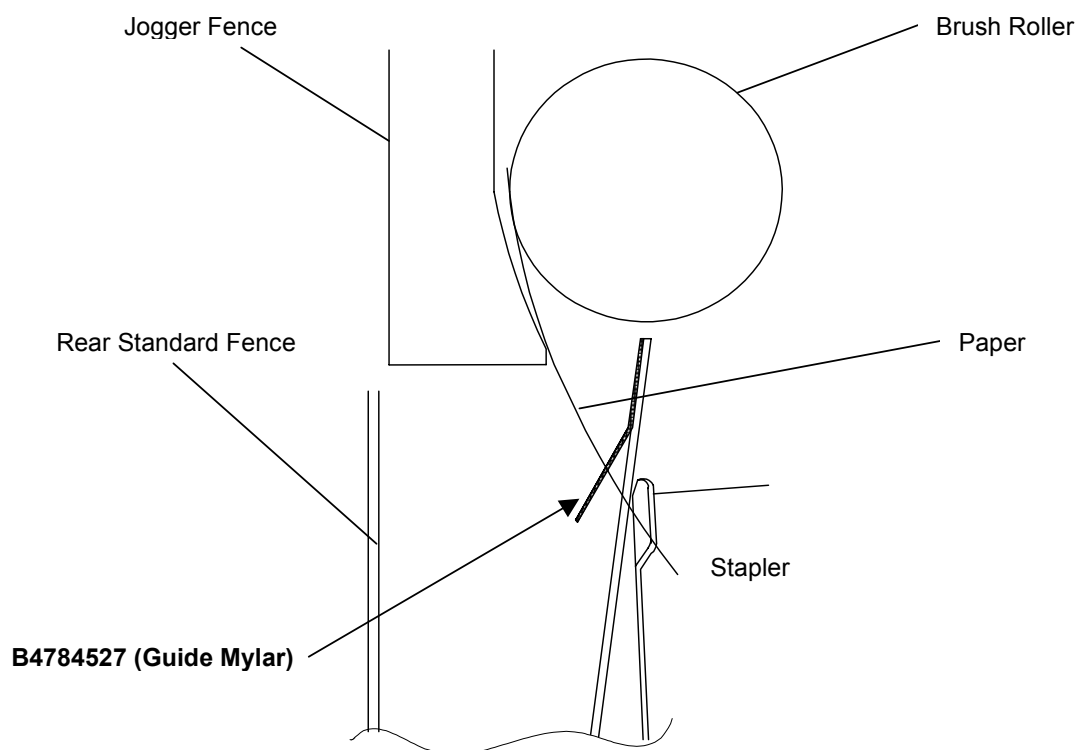

[RCL (Japan) Production]

MODEL NAME	V/Hz	DESTINATION	CODE	SERIAL NO.
SR840	120/60	USA,	B478-17	J4920900001
SR840	220-240/50, 60	Europe, etc.	B478-26	9P31020001

Model: Martini-C1/Bellini-C2 Finisher		Date: 30-May-03	No.: MB478008
Modified Article: Harness: Shift Tray Section		Prepared by: M. Matsuda	
From: 2nd Tech. Support Sec. Service Support Dept.			
Reason for Modification:	<input type="checkbox"/> Parts catalog correction <input type="checkbox"/> To facilitate assembly <input type="checkbox"/> Part standardization	<input checked="" type="checkbox"/> Vendor change <input type="checkbox"/> To improve reliability <input type="checkbox"/> Other	<input type="checkbox"/> To meet standards ()

The following has been changed due to a vendor change.

Old part number	New part number	Description	Q'ty	Int	Page	Index	Note
B4785300	B4785301	Harness: Shift Tray Section	1	X/O	35	1 20	

[RCL (Japan) Production]

MODEL NAME	V/Hz	DESTINATION	CODE	SERIAL NO.
SR840	120/60	USA,	B478-17	J4920900001
SR840	220-240/50, 60	Europe, etc.	B478-26	9P31020001

Model: Martini-C1/Bellini-C2 Finisher		Date: 30-May-03	No.: MB478009
Modified Article: Worm Gear		Prepared by: M. Matsuda	
From: 2nd Tech. Support Sec. Service Support Dept.			
Reason for Modification:	<input type="checkbox"/> Parts catalog correction <input type="checkbox"/> To facilitate assembly <input type="checkbox"/> Part standardization	<input type="checkbox"/> Vendor change <input checked="" type="checkbox"/> To improve reliability <input type="checkbox"/> Other	<input type="checkbox"/> To meet standards ()

The material of the Worm Gear has been changed to increase its durability and minimize gear wearing.

Old part number	New part number	Description	Q'ty	Int	Page	Index	Note
AB013709	A3002736	Worm Gear	1	X/O	31	10	

[RCL (Japan) Production]

MODEL NAME	V/Hz	DESTINATION	CODE	SERIAL NO.
SR840	120/60	USA,	B478-17	J4920900001
SR840	220-240/50, 60	Europe, etc.	B478-26	9P31020001

Model: Martini-C1/Bellini-C2 Finisher		Date: 30-May-03	No.: MB478010
Modified Article: Bracket - Return Support Sensor		Prepared by: M. Matsuda	
From: 2nd Tech. Support Sec. Service Support Dept.			
Reason for Modification:	<input type="checkbox"/> Parts catalog correction <input type="checkbox"/> To facilitate assembly <input type="checkbox"/> Part standardization	<input type="checkbox"/> Vendor change <input type="checkbox"/> To improve reliability <input checked="" type="checkbox"/> Other	<input type="checkbox"/> To meet standards ()

The shapes of the following have been changed to increase the gap between the bracket below and the Stapler Base Slider, in order to ensure that these two parts do not contact each other and generate noise.

Old part number	New part number	Description	Q'ty	Int	Page	Index	Note
AW020086		Photointerruptor	3-2	X/O	15	22	*1
	AW020114		0-1				
B3024298	B3024297	Bracket – Return Support Sensor	1	X/O	15	28	*1

***1: These parts should be replaced together as a set.**

[RCL (Japan) Production]

MODEL NAME	V/Hz	DESTINATION	CODE	SERIAL NO.
SR840	120/60	USA,	B478-17	J4921000001
SR840	220-240/50, 60	Europe, etc.	B478-26	9P31020001

Model: Martini-C1/Bellini-C2 Finisher		Date: 30-May-03	No.: MB478011
Modified Article: Cover: Connector		Prepared by: M. Matsuda	
From: 2nd Tech. Support Sec. Service Support Dept.			
Reason for Modification:	<input type="checkbox"/> Parts catalog correction <input type="checkbox"/> To facilitate assembly <input type="checkbox"/> Part standardization	<input type="checkbox"/> Vendor change <input type="checkbox"/> To improve reliability <input checked="" type="checkbox"/> Other	<input type="checkbox"/> To meet standards ()

The shape of the Connector Cover has been changed to ensure it does not contact the connector bracket.

Old part number	New part number	Description	Q'ty	Int	Page	Index	Note
B4781127	B4781129	Cover: connector	1	X/O	27	23	

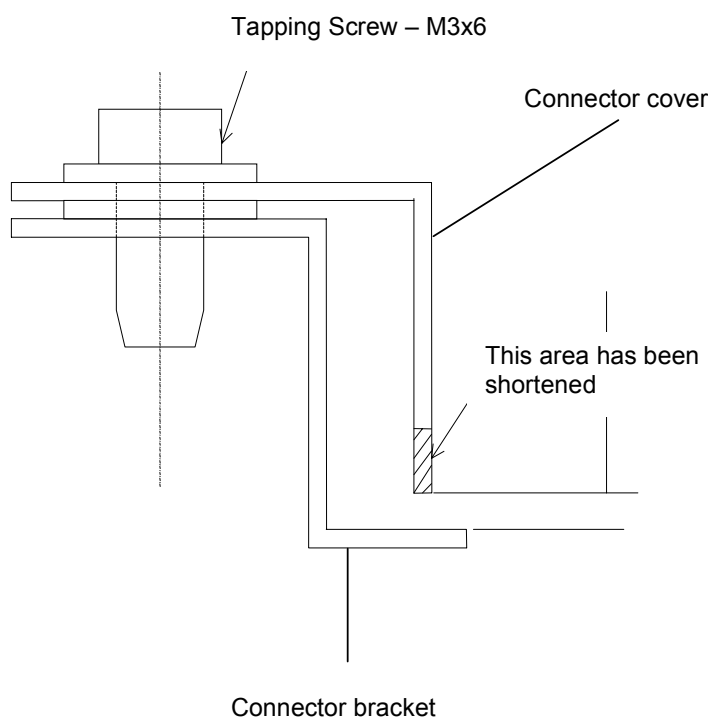

[RCL (Japan) Production]

MODEL NAME	V/Hz	DESTINATION	CODE	SERIAL NO.
SR840	120/60	USA,	B478-17	J4921100001
SR840	220-240/50, 60	Europe, etc.	B478-26	9P31120001

Model: Martini-C1/Bellini-C2 Finisher (SR840)		Date: 22-Jan-04	No.: MB478012
Modified Article: Harness		Prepared by: M. Matsuda	
From: 2nd Tech. Support Sec. Service Support Dept.			
Reason for Modification:	<input type="checkbox"/> Parts catalog correction <input checked="" type="checkbox"/> To facilitate assembly <input type="checkbox"/> Part standardization	<input type="checkbox"/> Vendor change <input type="checkbox"/> To improve reliability <input type="checkbox"/> Other	<input type="checkbox"/> To meet standards ()

Old part number	New part number	Description	Q'ty	Int	Page	Index	Note
B4785230	B4785231	Harness:Sensor:Main:Entrance Sensor	1	X/O	41	11	
B4785260	B4785261	Harness: Proof Tray: Connecting	1	X/O	27	15	
B4785240	B4785241	Harness: Entrance Sensor: Connecting	1	X/O	19	8	
B4785430	B4785431	Harness:Motor:Return	1	X/O	37	2	

To facilitate assembly for the harness, the length and color of the connectors have been changed.

[RCL (Japan) Production]

MODEL NAME	V/Hz	DESTINATION	CODE	SERIAL NO.
SR840	120/60	USA,	B478-17	Service Parts Only
SR840	220-240/50, 60	Europe, etc.	B478-26	Service Parts Only
SR840	120/60	USA,	B478-57	J49331100044
SR840	220-240/50, 60	Europe, etc.	B478-66	9R20930002

Model: Martini-C1/Bellini-C2 Finisher (SR840)		Date: 22-Jan-04	No.: MB478013
Modified Article: Harness – Jogger Shift Motor		Prepared by: M. Matsuda	
From: 2nd Tech. Support Sec. Service Support Dept.			
Reason for Modification:	<input type="checkbox"/> Parts catalog correction <input type="checkbox"/> To facilitate assembly <input type="checkbox"/> Part standardization	<input type="checkbox"/> Vendor change <input checked="" type="checkbox"/> To improve reliability <input type="checkbox"/> Other	<input type="checkbox"/> To meet standards ()

Old part number	New part number	Description	Q'ty	Int	Page	Index	Note
B4785465	B4785466	Harness – Jogger Shift Motor	1	X/O	41	29	
B4785480	B4785481	Harness – Stop Switch	1	X/O	41	30	

To ensure the surface of the harness tube does not get damaged, the material has been changed adding more strength.

[RCL (Japan) Production]

MODEL NAME	V/Hz	DESTINATION	CODE	SERIAL NO.
SR840	120/60	USA,	B478-17	Service Parts Only
SR840	220-240/50, 60	Europe, etc.	B478-26	Service Parts Only
SR840	120/60	USA,	B478-57	J4930700006
SR840	220-240/50, 60	Europe, etc.	B478-66	9R20730001

Model: Martini-C1/Bellini-C2 Finisher (SR840)		Date: 26-Jan-04	No.: MB478014
Modified Article: End Fence:Ass'y		Prepared by: M. Matsuda	
From: 2nd Tech. Support Sec. Service Support Dept.			
Reason for Modification:	<input type="checkbox"/> Parts catalog correction <input type="checkbox"/> To facilitate assembly <input type="checkbox"/> Part standardization	<input type="checkbox"/> Vendor change <input checked="" type="checkbox"/> To improve reliability <input type="checkbox"/> Other	<input type="checkbox"/> To meet standards ()

Old part number	New part number	Description	Q'ty	Int	Page	Index	Note
B4783109	B4783107	End Fence:Ass'y	1	X/O	35	16	

When the paper stack gradually increases on the shift tray, the end fence may come into contact with the end fence cover. To prevent this, the contact part of the end fence has been cut off.

[RCL (Japan) Production]

MODEL NAME	V/Hz	DESTINATION	CODE	SERIAL NO.
SR840	120/60	USA,	B478-17	Service Parts Only
SR840	220-240/50, 60	Europe, etc.	B478-26	Service Parts Only
SR840	120/60	USA,	B478-57	J4930600421
SR840	220-240/50, 60	Europe, etc.	B478-66	9R20730001

Model: Martini-C1/Bellini-C2 Finisher (SR840)		Date: 26-Jan-04	No.: MB478015
Modified Article: PCB: Main Control		Prepared by: M. Matsuda	
From: 2nd Tech. Support Sec. Service Support Dept.			
Reason for Modification:	<input type="checkbox"/> Parts catalog correction <input type="checkbox"/> To facilitate assembly <input type="checkbox"/> Part standardization	<input type="checkbox"/> Vendor change <input checked="" type="checkbox"/> To improve reliability <input type="checkbox"/> Other	<input type="checkbox"/> To meet standards ()

Old part number	New part number	Description	Q'ty	Int	Page	Index	Note
B4785132	B4785135	PCB: Main Control	1	X/O	41	17	
B4785107	B4785110	EPROM: Main Control	1	X/O	41	37	

The above parts have been changed in accordance with the software modification.
Note: Refer to the finisher (SR840) firmware release note for details of the modification.

[RCL (Japan) Production]

MODEL NAME	V/Hz	DESTINATION	CODE	SERIAL NO.
SR840	120/60	USA,	B478-17	Service Parts Only
SR840	220-240/50, 60	Europe, etc.	B478-26	Service Parts Only
SR840	120/60	USA,	B478-57	J4930700467
SR840	220-240/50, 60	Europe, etc.	B478-66	9R20730001

Model: Martini-C1/Bellini-C2 Finisher (SR840)		Date: 5-Oct-04	No.: MB478016
Modified Article: Harness:motor		Prepared by: S.Ishizu	
From: 2nd Tech. Support Sec. Service Support Dept.			
Reason for Modification:	<input type="checkbox"/> Parts catalog correction <input type="checkbox"/> To facilitate assembly <input checked="" type="checkbox"/> Part standardization	<input type="checkbox"/> Vendor change <input type="checkbox"/> To improve reliability <input type="checkbox"/> Other	<input type="checkbox"/> To meet standards ()

Old part number	New part number	Description	Q'ty	Int	Page	Index	Note
B4785220	B4785221	HARNESS:MOTOR:SHIFTTRAY	1→1	×/○	41	10	
B4785466	B4785467	HARNESS:MOTOR CONTROL:SHIFT:JOGGER	1→1	×/○	41	29	
B4785370	B4785371	HARNESS:MOTOR:STAPLE TRAY	1→1	○/○	11	22	

Change/Reason: Parts standardization with the Victoria-D.

[RCL (Japan) Production]

MODEL NAME	V/Hz	DESTINATION	CODE	SERIAL NO.
SR840	120/60	USA,	B478-17	Service Parts Only
SR840	220-240/50, 60	Europe, etc.	B478-26	Service Parts Only
SR840	120/60	USA,	B478-57	J4940700006
SR840	220-240/50, 60	Europe, etc.	B478-66	9R20940001

Model: Martini-C1/Bellini-C2 Finisher (SR840)		Date: 20-Dec-04	No.: MB478017
Modified Article: Exit Guide Plate		Prepared by: S. Ishizu	
From: 2nd Tech. Support Sec. Service Support Dept.			
Reason for Modification:	<input type="checkbox"/> Parts catalog correction <input type="checkbox"/> To facilitate assembly <input checked="" type="checkbox"/> Part standardization	<input type="checkbox"/> Vendor change <input type="checkbox"/> To improve reliability <input type="checkbox"/> Other	<input type="checkbox"/> To meet standards ()

Old part number	New part number	Description	Q'ty	Int	Page	Index	Note
A3792521	B7062521	EXIT GUIDE PLATE	1	O/O	23	18	
B3024312	B4784311	SIDE PLATE:FRONT:STAPLER	1	O/O	15	18	
B3026612	B4786612	INNER COVER:FRONT	1	O/O	7	14	
B3026651	B4786651	INNER COVER:STAPLER UNIT	1	O/O	9	1	
B3024712	B4784712	GUIDE PLATE:STAPLER TRAY	1	X/O	11	14	
B3024749	B4784749	STAY:STAPLER:MIDDLE	1	O/O	11	9	
B3024748	B4784748	STAY:STAPLER:LOWER	1	O/O	13	11	
B4781141	B4781143	BRACKET:COUPLING:GROUN D PLATE:FRONT	1	O/O	7	22	
B3021124	B4781134	SUPPORTING PLATE:FRAME	1	X/O	45	15	
B3021194	B4781192	BRACKET:COUPLING:UPPER	1	X/O	31	9	
B4784411	B4784412	SIDE PLATE:REAR:STAPLER:ASS'Y	1	X/O	15	4	

Change: Shape change.

Reason: To enable parts standardization with the Victoria and Victoria-D.

Model: Martini-C1/Bellini-C2 Finisher (SR840)		Date: 25-Mar-05	No.: MB478018
Modified Article: P/C Correction		Prepared by: S.Ishizu	
From: 2nd Tech. Support Sec. Service Support Dept.			
Reason for Modification:	<input checked="" type="checkbox"/> Parts catalog correction <input type="checkbox"/> To facilitate assembly <input type="checkbox"/> Part standardization	<input type="checkbox"/> Vendor change <input type="checkbox"/> To improve reliability <input type="checkbox"/> Other	<input type="checkbox"/> To meet standards ()

Incorrect Part Number	Correct Part Number	Incorrect Description	Correct Description	Q'ty	Page	Index	Note
B4785440	AW020086	Harness:sensor: return:paper Sensor	Photo Interruptor	1	35	12	

Change/Reason: The P/N and description were corrected.

Model: Martini-C1/Bellini-C2 Finisher (SR840)		Date: 27-Apr-05	No.: MB478019
Modified Article: PCB: MAIN CONTROL		Prepared by: S.Ishizu	
From: 2nd Tech. Support Sec. Service Support Dept.			
Reason for Modification:	<input type="checkbox"/> Parts catalog correction <input type="checkbox"/> To facilitate assembly <input type="checkbox"/> Part standardization	<input type="checkbox"/> Vendor change <input checked="" type="checkbox"/> To improve reliability <input type="checkbox"/> Other	<input type="checkbox"/> To meet standards ()

Old part number	New part number	Description	Q'ty	Int	Page	Index	Note
B4785136	B4785137	PCB: MAIN CONTROL	1	X/O	41	17	
B4785111	B4785112	EPROM:MAIN CONTROL	1	X/O	41	37	

Change/Reason: Software modification.

Note: See RTB #051 for the details (SR840 firmware release note).

[RCL (Japan) Production]

MODEL NAME	V/Hz	DESTINATION	CODE	SERIAL NO.
SR840	120/60	USA,	B478-17	Service Parts Only
SR840	220-240/50, 60	Europe, etc.	B478-26	Service Parts Only
SR840	120/60	USA,	B478-57	J4940500081
SR840	220-240/50, 60	Europe, etc.	B478-66	9R20840001

Model: Martini-C1/Bellini-C2 Finisher (SR840)		Date: 27-Jul-06	No.: MB478020
Modified Article: Harness:shift Tray:connecting		Prepared by: S.Ishizu	
From: 2nd Tech. Support Sec. Service Support Dept.			
Reason for Modification:	<input type="checkbox"/> Parts catalog correction <input type="checkbox"/> To facilitate assembly <input type="checkbox"/> Part standardization	<input type="checkbox"/> Vendor change <input checked="" type="checkbox"/> To improve reliability <input type="checkbox"/> Other	<input type="checkbox"/> To meet standards ()

Old part number	New part number	Description	Q'ty	Int	Page	Index	Note
B4785270	B4785271	Harness:shift Tray:connecting	1	x/.	29	13	

Change: The thickness of the harness was increased.

Reason: To improve the durability of the harness.

[RCL (Japan) Production]

MODEL NAME	V/Hz	DESTINATION	CODE	SERIAL NO.
SR840	120/60	USA,	B478-17	J4921200001
SR840	220-240/50, 60	Europe, etc.	B478-26	9P31220001



Part Change Information List

Date: August 31, 2009

Model	Code	PCIL Nr.	PCIL Correction	Old part number	New part number	Description	Old Q'ty	New Q'ty	Int	3DPC	Page	Index	Set	Set Int	RTB	Note	Ref. Nr.	ECN Nr.
MT-C1/B-C2 Finisher (SR840)	B478	200908		12042384	12042848	SWITCH:FA1L-AJAE	1	1	X/O		43	105					V0901516	9050233



Part Change Information List

Date: February 26, 2010

Model	Code	PCIL Nr.	PCIL Correction	Old part number	New part number	Description	Old Q'ty	New Q'ty	Int	3DPC	Page	Index	Set	Set Int	RTB	Note	Ref. Nr.	ECN Nr.
MT-C1/B-C2 Finisher (SR840)	B478	201002		B4784714	B4784715	GUIDE PLATE:STAPLER TRAY	1	1	O/O		11	14					V0902298	9070929
MT-C1/B-C2 Finisher (SR840)	B478	201002		A6972160	D4602160	GUIDE PLATE:AUXILIARY:PUNCH:ASS'Y	1	1	X/O		19	6					V0903265	



Part Change Information List

Date: April 30, 2010

Model	Code	PCIL Nr.	PCIL Correction	Old part number	New part number	Description	Old Q'ty	New Q'ty	Int	3DPC	Page	Index	Set	Set Int	RTB	Note	Ref. Nr.	ECN Nr.
MT-C1/B-C2 Finisher (SR840)	B478	201004		B7064785	B7064786	SHAFT:EXIT:UPPER	1	1	O/O		15	20					V0902298	9070929
MT-C1/B-C2 Finisher (SR840)	B478	201004		B3022124	D4602124	BRACKET:GATHERING ROLLER	1	1	X/X		24	17	A		RB706006		V1000603	8120495
MT-C1/B-C2 Finisher (SR840)	B478	201004		B4782111	D4602111	ARM:GATHERING ROLLER:ASS'Y	1	1	X/X		24	23	A		RB706006		V1000603	8120495



Part Change Information List

Date: May 31, 2011

Model	Code	PCIL Nr.	PCIL Correction	Old part number	New part number	Description	Old Q'ty	New Q'ty	Int	3DPC	Page	Index	Set	Set Int	RTB	Note	Ref. Nr.	ECN Nr.
MT-C1/B-C2 Finisher (SR840)	B478	201105		B3024248	D4604248	HOLDER:MIDDLE:STAPLER:ASS'Y	1	1	O/O		25	3					V1100829	11030856





Part Change Information List

Date: June 30, 2011

Model	Code	PCIL Nr.	PCIL Correction	Old part number	New part number	Description	Old Q'ty	New Q'ty	Int	3DPC	Page	Index	Set	Set Int	RTB	Note	Ref. Nr.	ECN Nr.
MT-C1/B-C2 Finisher (SR840)	B478	201106		B4782333	D4602333	GUIDE PLATE:EXIT:LOWER:SUB-ASS'Y	1	1	O/O		33	22					V1100404	

RICOH**Part Change Information List**

Date: August 31, 2011

Model	Code	PCIL Nr.	PCIL Correction	Old part number	New part number	Description	Old Q'ty	New Q'ty	Int	3DPC	Page	Index	Set	Set Int	RTB	Note	Ref. Nr.	ECN Nr.
MT-C1/B-C2 Finisher (SR840)	B478	201108		B4785400	D4605402	HARNESS:STAPLER	1	1	O/O		41	14					V1100829	11030856



Part Change Information List

Date: June 29, 2012

Model	Code	PCIL Nr.	PCIL Correction	Old part number	New part number	Description	Old Q'ty	New Q'ty	Int	3DPC	Page	Index	Set	Set Int	RTB	Note	Ref. Nr.	ECN Nr.
MT-C1/B-C2 Finisher (SR840)	B478	201206		D4602124	D4602127	BRACKET:GATHERING ROLLER	1	1	X/O		25	17					V1200800	

Model	Code	PCIL Nr.	PCIL Correction	Old part number	New part number	Description	Old Q'ty	New Q'ty	Int	3DPC	Page	Index	Set	Set Int	RTB	Note	Ref. Nr.	ECN Nr.
MT-C1/B-C2 Finisher (SR840)	B478	201211		B4785400	B4785402	HARNES:STAPLER	1	1			41	14					V1202805	



Part Change Information List

Date: January 31, 2014

Model	Code	PCIL Number	PCIL Correction	Old part number	New part number	Description	Old Q'ty	New Q'ty	Int	3DPC	Page	Index	Set	Set Int	RTB	Note	Ref Number	ECN Number
MT-C1/B-C2 Finisher (SR840)	B478	201401		B4786262	D4606262	COVER:COVER:LEFT UPPER	1	1	O/O		7	30					V1300600	13020357



Part Change Information List

Date: February 27, 2015

Model	Code	PCIL Number	PCIL Correction	Old part number	New part number	Description	Old Q'ty	New Q'ty	Int	3DPC	Page	Index	Set	Set Int	RTB	Note	Ref Number	ECN Number
MT-C1/B-C2 Finisher (SR840)	B478	201502		B4781137	D4601137	COVER:SAFETY SWITCH	1	1	X/O		43	17					V0901244	



Part Change Information List

Date: July 2, 2015

Model	Code	PCIL Number	PCIL Correction	Old part number	New part number	Description	Old Q' ty	New Q' ty	Int	3DPC	Page	Index	Set	Set Int	RTB	Note	Ref Number	ECN Number
MT-C1/B-C2 Finisher (SR840)	B478	201506		B7062224	B8302224	COMPRESSION SPRING:TRANSPORT:6.5N	2	2	X/O	N	21	5					V1403673	



Change Information List

Date: March 1, 2018

Model	Code	PCIL Number	PCIL Correction	Old part number	New part number	Description	Old Q'ty	New Q'ty	Int	3DPC	Page	Index	Set	Set Int	RTB	Note	Ref Number	ECN Number
MT-C1_B-C2 Finisher_SR840_	B478	201802		AA120099	B7002317	DISCHARGE BRUSH	1	1	O/O	N	25	10					V1700089	0