

Reissued: 09-May-12

Model: Finisher SR3110/SR3120	Date: 13-Jan-12	No.: RD637001a
-------------------------------	-----------------	----------------

RTB Reissue

The items in bold italics have been corrected or added.

Subject: Firmware Release Note: Finisher SR3110/SR3120		Prepared by: T.Hirakawa	
From: 1st Tech Service Sect., MFP/Printer Tech Service Dept			
Classification:	<input type="checkbox"/> Troubleshooting	<input type="checkbox"/> Part information	<input type="checkbox"/> Action required
	<input type="checkbox"/> Mechanical	<input type="checkbox"/> Electrical	<input type="checkbox"/> Service manual revision
	<input type="checkbox"/> Paper path	<input type="checkbox"/> Transmit/receive	<input type="checkbox"/> Retrofit information
	<input type="checkbox"/> Product Safety	<input checked="" type="checkbox"/> Other (Firmware)	<input checked="" type="checkbox"/> Tier 2

This RTB has been issued to announce the firmware release information for the **Finisher SR3110/SR3120**.

Version	Program No.	Effective Date	Availability of RFU
<i>01.030:09</i>	<i>D6375300C</i>	<i>April 2012 production</i>	<i>Available</i>
01.000:06	D6375300B	1st Mass production	Available

Note: Definition of Availability of RFU via @Remote

“Available” The firmware can be updated via RFU or SD card.

“Not available”: The firmware can only be updated via SD card.

Version	Modified Points or Symptom Corrected
<i>01.030:09</i>	<i>Other changes: Supports detection of nonstandard paper sizes in accordance with the position of the paper joggers.</i>
01.000:06	1st Mass production

Reissued: 03-Sep-12

Model: Finisher SR3110/SR3120	Date: 13-Jan-12	No.: RD637001b
-------------------------------	-----------------	----------------

RTB Reissue

The items in bold italics have been corrected or added.

Subject: Firmware Release Note: Finisher SR3110/SR3120		Prepared by: T.Hirakawa	
From: 1st Tech Service Sect., MFP/Printer Tech Service Dept			
Classification:	<input type="checkbox"/> Troubleshooting	<input type="checkbox"/> Part information	<input type="checkbox"/> Action required
	<input type="checkbox"/> Mechanical	<input type="checkbox"/> Electrical	<input type="checkbox"/> Service manual revision
	<input type="checkbox"/> Paper path	<input type="checkbox"/> Transmit/receive	<input type="checkbox"/> Retrofit information
	<input type="checkbox"/> Product Safety	<input checked="" type="checkbox"/> Other (Firmware)	<input checked="" type="checkbox"/> Tier 2

This RTB has been issued to announce the firmware release information for the **Finisher SR3110/SR3120**.

Version	Program No.	Effective Date	Availability of RFU
<i>01.040:10</i>	<i>D6375300D</i>	<i>July 2012 production</i>	<i>Available</i>
01.030:09	D6375300C	April 2012 production	Available
01.000:06	D6375300B	1st Mass production	Available

Note: Definition of Availability of RFU via @Remote

“Available” The firmware can be updated via RFU or SD card.

“Not available”: The firmware can only be updated via SD card.

Version	Modified Points or Symptom Corrected
<i>01.040:10</i>	<i>Symptom corrected: A jam may occur when performing a copy job with the Punch feature, due to a discrepancy between the current position of the punch unit as detected by its control signal and the unit's actual position.</i>
01.030:09	Other changes: Supports detection of nonstandard paper sizes in accordance with the position of the paper joggers.
01.000:06	1st Mass production

Model: Finisher SR3110/SR3120

Date: 16-Jul-13

No.: RD637002

Subject: Parts information for Finisher SR3110

Prepared by: S.Hayami

From: 1st Tech Service Sect., MFP/Printer Tech Service Dept

Classification:

☐ Troubleshooting

☒ Part information

☐ Action required

☐ Mechanical

☐ Electrical

☐ Service manual revision

☐ Paper path

☐ Transmit/receive

☐ Retrofit information

☐ Product Safety

☐ Other (Firmware)

☒ Tier 2

Old part number	New part number	Description	Q'ty	Int	Page	Index	Note
-	B7002631	ARM:PLATE:ASS'Y	1	-	18	35	For SR3110
-	B8042730	CUSHION:LINK:ARM	1	-	18	36	For SR3110
-	B8042625	ROLLER:MM28	1	-	18	37	For SR3110
-	54472681	SNAP RING	1	-	18	38	For SR3110
-	B7002635	TENSION SPRING:RELEASE:PLATE	1	-	18	39	For SR3110

9.Staple Transfer Section 2 (D637)

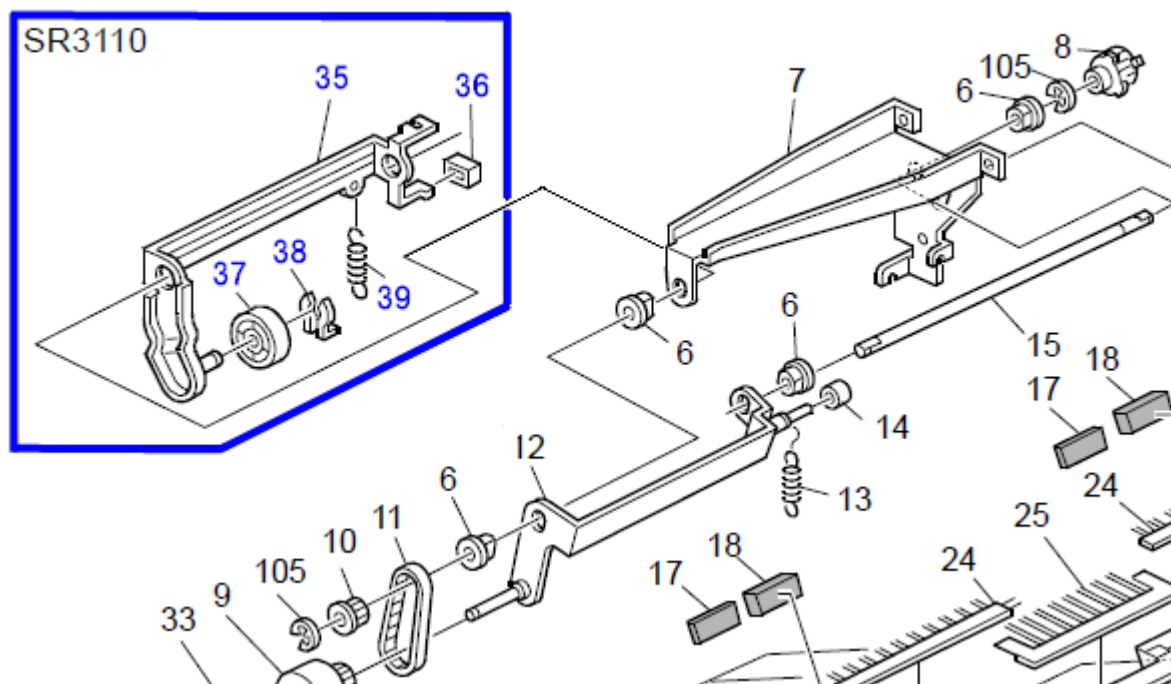

Model: AL-C2/AP-C3 Finisher_EUPHRATES-F		Date: 24-Jun-15	No.: RD637003
Subject: Parts catalog correction		Prepared by: Y. Ino	
From: 1st TechService Sec., MFP/Printer TechService Dept.			
Classification:	<input checked="" type="checkbox"/> Troubleshooting <input type="checkbox"/> Mechanical <input type="checkbox"/> Paper path <input type="checkbox"/> Product Safety	<input checked="" type="checkbox"/> Part information <input type="checkbox"/> Electrical <input type="checkbox"/> Transmit/receive <input type="checkbox"/> Other ()	<input type="checkbox"/> Action required <input type="checkbox"/> Service manual revision <input type="checkbox"/> Retrofit information <input type="checkbox"/> Tier 2

Change/Reason: The following part number and index was missing from the parts catalog.

New part number	Description	Q'ty	Int	Page	Index	Note
B8042235	GUIDE PLATE:PUNCH UNIT	1		8	33*	

***New Index**

4.Shift Transfer Section 2 (D637)

