

Reissued: 13-Mar-09

Model: B-C4	Date: 04-Mar-09	No.: RD447001a
-------------	-----------------	----------------

Subject: Firmware Release Note: Stacker_LOIRE1		Prepared by: T. Tadokoro	
From: PPBG QA/Service Planning Dept.			
Classification:	<input type="checkbox"/> Troubleshooting <input type="checkbox"/> Mechanical <input type="checkbox"/> Paper path <input type="checkbox"/> Product Safety	<input type="checkbox"/> Part information <input type="checkbox"/> Electrical <input type="checkbox"/> Transmit/receive <input checked="" type="checkbox"/> Other ()	<input type="checkbox"/> Action required <input type="checkbox"/> Service manual revision <input type="checkbox"/> Retrofit information <input type="checkbox"/> Tier 2

This RTB has been issued to announce the firmware release information for the **Stacker_LOIRE1**.

Version	Program No.	Effective Date
02.160:09	D4475104B_up	January 2009 production
02.140:09	D4475104A_up	1st Mass production

Version	Modified Points or Symptom Corrected
02.160:09	Symptom Corrected: SC990 occurs if the front/top doors on the LOIRE are opened/closed while the finisher is in operation.
02.140:09	1st Mass production

Reissued: 13-Mar-09

Model: B-C4	Date: 04-Mar-09	No.: RD447002a
-------------	-----------------	----------------

Subject: Firmware Release Note: Stacker_LOIRE2		Prepared by: T. Tadokoro	
From: PPBG QA/Service Planning Dept.			
Classification:	<input type="checkbox"/> Troubleshooting <input type="checkbox"/> Mechanical <input type="checkbox"/> Paper path <input type="checkbox"/> Product Safety	<input type="checkbox"/> Part information <input type="checkbox"/> Electrical <input type="checkbox"/> Transmit/receive <input checked="" type="checkbox"/> Other ()	<input type="checkbox"/> Action required <input type="checkbox"/> Service manual revision <input type="checkbox"/> Retrofit information <input type="checkbox"/> Tier 2

This RTB has been issued to announce the firmware release information for the **Stacker_LOIRE2**.

Version	Program No.	Effective Date
02.160:09	<i>D4475104B_down</i>	<i>January 2009 production</i>
02.140:09	D4475104A_down	1st Mass production

Version	Modified Points or Symptom Corrected
02.160:09	<i>Symptom Corrected: SC990 occurs if the front/top doors on the LOIRE are opened/closed while the finisher is in operation.</i>
02.140:09	1st Mass production

Reissued: 17-Apr-09

Model: B-C4	Date: 04-Mar-09	No.: RD447001b
-------------	-----------------	----------------

Subject: Firmware Release Note: Stacker_LOIRE1		Prepared by: T. Tadokoro	
From: PPBG QA/Service Planning Dept.			
Classification:	<input type="checkbox"/> Troubleshooting <input type="checkbox"/> Mechanical <input type="checkbox"/> Paper path <input type="checkbox"/> Product Safety	<input type="checkbox"/> Part information <input type="checkbox"/> Electrical <input type="checkbox"/> Transmit/receive <input checked="" type="checkbox"/> Other ()	<input type="checkbox"/> Action required <input type="checkbox"/> Service manual revision <input type="checkbox"/> Retrofit information <input type="checkbox"/> Tier 2

This RTB has been issued to announce the firmware release information for the **Stacker_LOIRE1**.

Version	Program No.	Effective Date
02.180:09	D4475104C_up	April 2009 production
02.160:09	D4475104B_up	January 2009 production
02.140:09	D4475104A_up	1st Mass production

Version	Modified Points or Symptom Corrected
02.180:09	Symptom Corrected: SC990 occurrence after a jam in a downstream finisher.
02.160:09	Symptom Corrected: SC990 occurs if the front/top doors on the LOIRE are opened/closed while the finisher is in operation.
02.140:09	1st Mass production

Reissued: 17-Apr-09

Model: B-C4	Date: 04-Mar-09	No.: RD447002b
-------------	-----------------	----------------

Subject: Firmware Release Note: Stacker_LOIRE2		Prepared by: T. Tadokoro	
From: PPBG QA/Service Planning Dept.			
Classification:	<input type="checkbox"/> Troubleshooting <input type="checkbox"/> Mechanical <input type="checkbox"/> Paper path <input type="checkbox"/> Product Safety	<input type="checkbox"/> Part information <input type="checkbox"/> Electrical <input type="checkbox"/> Transmit/receive <input checked="" type="checkbox"/> Other ()	<input type="checkbox"/> Action required <input type="checkbox"/> Service manual revision <input type="checkbox"/> Retrofit information <input type="checkbox"/> Tier 2

This RTB has been issued to announce the firmware release information for the **Stacker_LOIRE2**.

Version	Program No.	Effective Date
02.180:09	D4475104C_down	April 2009 production
02.160:09	D4475104B_down	January 2009 production
02.140:09	D4475104A_down	1st Mass production

Version	Modified Points or Symptom Corrected
02.180:09	Symptom Corrected: SC990 occurrence after a jam in a downstream finisher.
02.160:09	Symptom Corrected: SC990 occurs if the front/top doors on the LOIRE are opened/closed while the finisher is in operation.
02.140:09	1st Mass production

Reissued: 28-May-09

Model: B-C4	Date: 04-Mar-09	No.: RD447001c
-------------	-----------------	----------------

Subject: Firmware Release Note: Stacker_LOIRE1		Prepared by: T. Tadokoro	
From: PPBG QA/Service Planning Dept.			
Classification:	<input type="checkbox"/> Troubleshooting <input type="checkbox"/> Mechanical <input type="checkbox"/> Paper path <input type="checkbox"/> Product Safety	<input type="checkbox"/> Part information <input type="checkbox"/> Electrical <input type="checkbox"/> Transmit/receive <input checked="" type="checkbox"/> Other ()	<input type="checkbox"/> Action required <input type="checkbox"/> Service manual revision <input type="checkbox"/> Retrofit information <input type="checkbox"/> Tier 2

This RTB has been issued to announce the firmware release information for the **Stacker_LOIRE1**.

Version	Program No.	Effective Date
02.200:09	D4475104D_up	June 2009 production
02.180:09	D4475104C_up	April 2009 production
02.160:09	D4475104B_up	January 2009 production
02.140:09	D4475104A_up	1st Mass production

Version	Modified Points or Symptom Corrected
02.200:09	Symptom Corrected: <ul style="list-style-type: none"> <i>When two SK5000 stackers are connected and a jam occurs in the upstream SK5000, the jam is not recovered and the machine stalls in the "print in process" status.</i> <i>SC990 when the distance between the paper fed is shorter than 30mm due to a double-feed.</i>
02.180:09	Symptom Corrected: SC990 occurrence after Jam occurrence in a downstream Finisher.
02.160:09	Symptom Corrected: SC990 occurs if the front/top doors on the LOIRE are opened/closed while the finisher is in operation.
02.140:09	1st Mass production

Reissued: 28-May-09

Model: B-C4	Date: 04-Mar-09	No.: RD447002c
-------------	-----------------	----------------

Subject: Firmware Release Note: Stacker_LOIRE2		Prepared by: T. Tadokoro	
From: PPBG QA/Service Planning Dept.			
Classification:	<input type="checkbox"/> Troubleshooting <input type="checkbox"/> Mechanical <input type="checkbox"/> Paper path <input type="checkbox"/> Product Safety	<input type="checkbox"/> Part information <input type="checkbox"/> Electrical <input type="checkbox"/> Transmit/receive <input checked="" type="checkbox"/> Other ()	<input type="checkbox"/> Action required <input type="checkbox"/> Service manual revision <input type="checkbox"/> Retrofit information <input type="checkbox"/> Tier 2

This RTB has been issued to announce the firmware release information for the **Stacker_LOIRE2**.

Version	Program No.	Effective Date
02.200:09	D4475104D_down	June 2009 production
02.180:09	D4475104C_down	April 2009 production
02.160:09	D4475104B_down	January 2009 production
02.140:09	D4475104A_down	1st Mass production

Version	Modified Points or Symptom Corrected
02.200:09	Symptom Corrected: <ul style="list-style-type: none"> <i>When two SK5000 stackers are connected and a jam occurs in the upstream SK5000, the jam is not recovered and the machine stalls in the "print in process" status.</i> <i>SC990 when the distance between the paper fed is shorter than 30mm due to a double-feed.</i>
02.180:09	Symptom Corrected: SC990 occurrence after Jam occurrence in a downstream Finisher.
02.160:09	Symptom Corrected: SC990 occurs if the front/top doors on the LOIRE are opened/closed while the finisher is in operation.
02.140:09	1st Mass production

Reissued: 03-Dec-09

Model: B-C4	Date: 04-Mar-09	No.: RD447001d
-------------	-----------------	----------------

Subject: Firmware Release Note: Stacker_LOIRE1		Prepared by: T. Tadokoro	
From: PPBG QA/Service Planning Dept.			
Classification:	<input type="checkbox"/> Troubleshooting <input type="checkbox"/> Mechanical <input type="checkbox"/> Paper path <input type="checkbox"/> Product Safety	<input type="checkbox"/> Part information <input type="checkbox"/> Electrical <input type="checkbox"/> Transmit/receive <input checked="" type="checkbox"/> Other ()	<input type="checkbox"/> Action required <input type="checkbox"/> Service manual revision <input type="checkbox"/> Retrofit information <input type="checkbox"/> Tier 2

This RTB has been issued to announce the firmware release information for the **Stacker_LOIRE1**.

Version	Program No.	Effective Date
02.220:09	D4475104E_up	November 2009 production
02.200:09	D4475104D_up	June 2009 production
02.180:09	D4475104C_up	April 2009 production
02.160:09	D4475104B_up	January 2009 production
02.140:09	D4475104A_up	1st Mass production

Version	Modified Points or Symptom Corrected
02.220:09	Symptom Corrected: <ul style="list-style-type: none"> <i>When the outputs are designated to the stack tray and the feeding tray of the mainframe runs out of paper during the job, "please wait" is displayed on the panel and the job cannot be continued.</i>
02.200:09	Symptom Corrected: <ul style="list-style-type: none"> When two SK5000 stackers are connected and a jam occurs in the upstream SK5000, jam is not recovered and machine stalls in "print in process" status. SC990 occurrence when distance between the paper fed is shorter than 30mm due to a double-feed.
02.180:09	Symptom Corrected: SC990 occurrence after Jam occurrence in a downstream Finisher.
02.160:09	Symptom Corrected: SC990 occurs if the front/top doors on the LOIRE are opened/closed while the finisher is in operation.
02.140:09	1st Mass production

Reissued: 03-Dec-09

Model: B-C4	Date: 04-Mar-09	No.: RD447002d
-------------	-----------------	----------------

Subject: Firmware Release Note: Stacker_LOIRE2		Prepared by: T. Tadokoro	
From: PPBG QA/Service Planning Dept.			
Classification:	<input type="checkbox"/> Troubleshooting <input type="checkbox"/> Mechanical <input type="checkbox"/> Paper path <input type="checkbox"/> Product Safety	<input type="checkbox"/> Part information <input type="checkbox"/> Electrical <input type="checkbox"/> Transmit/receive <input checked="" type="checkbox"/> Other ()	<input type="checkbox"/> Action required <input type="checkbox"/> Service manual revision <input type="checkbox"/> Retrofit information <input type="checkbox"/> Tier 2

This RTB has been issued to announce the firmware release information for the **Stacker_LOIRE2**.

Version	Program No.	Effective Date
02.220:09	D4475104E_down	November 2009 production
02.200:09	D4475104D_down	June 2009 production
02.180:09	D4475104C_down	April 2009 production
02.160:09	D4475104B_down	January 2009 production
02.140:09	D4475104A_down	1st Mass production

Version	Modified Points or Symptom Corrected
02.220:09	Symptom Corrected: <ul style="list-style-type: none"> <i>When the outputs are designated to the stack tray and the feeding tray of the mainframe runs out of paper during the job, "please wait" is displayed on the panel and the job cannot be continued.</i>
02.200:09	Symptom Corrected: <ul style="list-style-type: none"> When two SK5000 stackers are connected and a jam occurs in the upstream SK5000, jam is not recovered and machine stalls in "print in process" status. SC990 occurrence when distance between the paper fed is shorter then 30mm due to a double-feed.
02.180:09	Symptom Corrected: SC990 occurrence after Jam occurrence in a downstream Finisher.
02.160:09	Symptom Corrected: SC990 occurs if the front/top doors on the LOIRE are opened/closed while the finisher is in operation.
02.140:09	1st Mass production

Model: High Capacity Stacker SK5010		Date: 04-Des-09	No.: RD447003
Subject: Request for Replacement of Parts Containing RoHS Restricted Substances		Prepared by: K. Tsutsui	
From: PP Service Planning Department 1G			
Classification:	<input type="checkbox"/> Troubleshooting <input type="checkbox"/> Mechanical <input type="checkbox"/> Paper path <input type="checkbox"/> Product Safety	<input type="checkbox"/> Part information <input type="checkbox"/> Electrical <input type="checkbox"/> Transmit/receive <input checked="" type="checkbox"/> Other ()	<input type="checkbox"/> Action required <input type="checkbox"/> Service manual revision <input type="checkbox"/> Retrofit information <input type="checkbox"/> Tier2

This RTB is applied only for the EU market.

PROBLEM

PBDE contained in the PSU exceeds the limit of 1000ppm, which is a regulation enforced by the RoHS. Therefore, the PSU is inapplicable.

REQUEST

Please replace the PSU with the modified PSU (P/N: G1789907 MODIFICATION: POWER: SUPPLY: UNIT) from ESPC inventory on your next service visit.

The removed unit contains substances which are restricted by the RoHS and must be disposed of accordingly with the local laws/regulations.

Model: High Capacity Stacker SK5010

Date: 04-Des-09

No.: RD447003

OBJECT SERIAL NUMBER

Please replace the PSU for field machines having the following S/N:

No.	Product Code	EDP Code	Serial Number	No.	Product Code	EDP Code	Serial Number
1	D447-27	404217	V559-0100008	34	D447-27	404217	V559-0400006
2	D447-27	404217	V559-0100014	35	D447-27	404217	V559-0400007
3	D447-27	404217	V559-0100021	36	D447-27	404217	V559-0400008
4	D447-27	404217	V559-0100027	37	D447-27	404217	V559-0400014
5	D447-27	404217	V559-0200013	38	D447-27	404217	V559-0400015
6	D447-27	404217	V559-0200014	39	D447-27	404217	V559-0400016
7	D447-27	404217	V559-0200015	40	D447-27	404217	V559-0400017
8	D447-27	404217	V559-0200021	41	D447-27	404217	V559-0500001
9	D447-27	404217	V559-0200022	42	D447-27	404217	V559-0500002
10	D447-27	404217	V559-0200026	43	D447-27	404217	V559-0500003
11	D447-27	404217	V559-0200028	44	D447-27	404217	V559-0500004
12	D447-27	404217	V559-0200029	45	D447-27	404217	V559-0500005
13	D447-27	404217	V559-0200038	46	D447-27	404217	V559-0500006
14	D447-27	404217	V559-0200055	47	D447-27	404217	V559-0500007
15	D447-27	404217	V559-0200069	48	D447-27	404217	V559-0500008
16	D447-27	404217	V559-0300001	49	D447-27	404217	V559-0500029
17	D447-27	404217	V559-0300002	50	D447-27	404217	V559-0600001
18	D447-27	404217	V559-0300006	51	D447-27	404217	V559-0600002
19	D447-27	404217	V559-0300007	52	D447-27	404217	V559-0600003
20	D447-27	404217	V559-0300008	53	D447-27	404217	V559-0600004
21	D447-27	404217	V559-0300009	54	D447-27	404217	V559-0600008
22	D447-27	404217	V559-0300010	55	D447-27	404217	V559-0600011
23	D447-27	404217	V559-0300012	56	D447-27	404217	V559-0600015
24	D447-27	404217	V559-0300014	57	D447-27	404217	V559-0600019
25	D447-27	404217	V559-0300017	58	D447-27	404217	V559-0600020
26	D447-27	404217	V559-0300018	59	D447-27	404217	V559-0700015
27	D447-27	404217	V559-0300019	60	D447-27	404217	V559-0700016
28	D447-27	404217	V559-0300020	61	D447-27	404217	V559-0700017
29	D447-27	404217	V559-0300021	62	D447-27	404217	V559-0700024
30	D447-27	404217	V559-0300025	63	D447-27	404217	V559-0700025
31	D447-27	404217	V559-0300026	64	D447-27	404217	V559-0700026
32	D447-27	404217	V559-0300027	65	D447-27	404217	V559-0700027
33	D447-27	404217	V559-0400005	66	D447-27	404217	V559-0700028









Model: High Capacity Stacker SK5010

Date: 04-Des-09

No.: RD447003

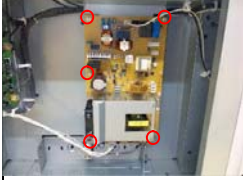
REPLACEMENT METHOD

Please refer to the procedure below for the replacement work. Work time is approximately 13 min.

Classification	Steps	Work Procedure		Notes	Required Parts (Removing parts)	Required Tools	Work Time (sec)
Cover removal	1	Remove the 4 silver screws and the rear-lower cover.			04513006N (M 3 x 6 silver screw) D4476175A (Rear lower cover)	Screwdriver	60
Machine no. check	2	Record the machine number indicated under the PSU bar code. * Numbers indicated in red in the right photo.	 	PSU Serial No: _____			30
	3	Check the serial number against the list shown in right. PSU replacement work is required if the serial number is included in the list. (If not, proceed to "Step 22" to attach the cover.)	Object Serial Numbers [GZ230028B] 0811232339~0811232358 0811232439~0811232538 0905001203~0905001282 [GZ230041] 0811232819~0811232878 090100281~090100340 095218219~095218398				30
PSU replacement	4	Disconnect the harness connected to the PSU [5 connections]					25
	5	Disconnect the jumper-connector on the PSU [x 1]					5
	6	Remove the 4 silver screws and 1 semi screw from the PSU. [screw x 5]					30
	7	Remove the PSU from the locking support.	 				15
	8	Set the modified PSU onto the locking support.					25

Model: High Capacity Stacker SK5010 (D447)		Date: 21-Jan-10	No.: RD447004
Subject: Parts Catalog Correction		Prepared by: T.Mimura	
From: PPMC Service Planning Department 1G			
Classification:	<input type="checkbox"/> Troubleshooting <input type="checkbox"/> Mechanical <input type="checkbox"/> Paper path <input type="checkbox"/> Product Safety	<input checked="" type="checkbox"/> Part information <input type="checkbox"/> Electrical <input type="checkbox"/> Transmit/receive <input type="checkbox"/> Other ()	<input type="checkbox"/> Action required <input type="checkbox"/> Service manual revision <input type="checkbox"/> Retrofit information <input type="checkbox"/> Tier2

Change/Reason: The part number was changed in the Parts Catalog.

Old part number	New part number	Old description	New description	Q'ty	Page	Index	Note
11071200	11071280	FUSE:BJS151100FCRK	FUSE:BJS1512F2	-	39	107	-

Reissued: 24-Mar-10

Model: B-C4	Date: 04-Mar-09	No.: RD447001e
-------------	-----------------	----------------

Subject: Firmware Release Note: Stacker_LOIRE1		Prepared by: T. Mimura	
From: PPBG Service Planning Dept.			
Classification:	<input type="checkbox"/> Troubleshooting <input type="checkbox"/> Mechanical <input type="checkbox"/> Paper path <input type="checkbox"/> Product Safety	<input type="checkbox"/> Part information <input type="checkbox"/> Electrical <input type="checkbox"/> Transmit/receive <input checked="" type="checkbox"/> Other ()	<input type="checkbox"/> Action required <input type="checkbox"/> Service manual revision <input type="checkbox"/> Retrofit information <input type="checkbox"/> Tier 2

This RTB has been issued to announce the firmware release information for the **Stacker_LOIRE1**.

Version	Program No.	Effective Date
02.230:09	D4475104F_up	March 2010 production
02.220:09	D4475104E_up	November 2009 production
02.200:09	D4475104D_up	June 2009 production
02.180:09	D4475104C_up	April 2009 production
02.160:09	D4475104B_up	January 2009 production
02.140:09	D4475104A_up	1st Mass production

Version	Modified Points or Symptom Corrected
02.230:09	Symptom Corrected: • <i>Jam occurrence fixed when consecutive hits of the down button.</i>
02.220:09	Symptom Corrected: • When the the outputs are designated to the stack tray and the feeding tray of the mainframe runs out of paper during the job, "please wait" is displayed on the panel and the job cannot be continued.
02.200:09	Symptom Corrected: • When two SK5000 stackers are connected and a jam occurs in the upstream SK5000, jam is not recovered and machine stalls in "print in process" status. • SC990 occurrence when distance between the paper fed is shorter then 30mm due to a double-feed.
02.180:09	Symptom Corrected: SC990 occurrence after Jam occurrence in a downstream Finisher.
02.160:09	Symptom Corrected: SC990 occurs if the front/top doors on the LOIRE are opened/closed while the finisher is in operation.
02.140:09	1st Mass production

Reissued: 24-Mar-10

Model: B-C4	Date: 04-Mar-09	No.: RD447002e
-------------	-----------------	----------------

Subject: Firmware Release Note: Stacker_LOIRE2		Prepared by: T. Mimura	
From: PPBG Service Planning Dept.			
Classification:	<input type="checkbox"/> Troubleshooting <input type="checkbox"/> Mechanical <input type="checkbox"/> Paper path <input type="checkbox"/> Product Safety	<input type="checkbox"/> Part information <input type="checkbox"/> Electrical <input type="checkbox"/> Transmit/receive <input checked="" type="checkbox"/> Other ()	<input type="checkbox"/> Action required <input type="checkbox"/> Service manual revision <input type="checkbox"/> Retrofit information <input type="checkbox"/> Tier 2

This RTB has been issued to announce the firmware release information for the **Stacker_LOIRE2**.

Version	Program No.	Effective Date
02.230:09	D4475104F_down	March 2010 production
02.220:09	D4475104E_down	November 2009 production
02.200:09	D4475104D_down	June 2009 production
02.180:09	D4475104C_down	April 2009 production
02.160:09	D4475104B_down	January 2009 production
02.140:09	D4475104A_down	1st Mass production

Version	Modified Points or Symptom Corrected
02.230:09	Symptom Corrected: • <i>Jam occurrence fixed when consecutive hits of the down button.</i>
02.220:09	Symptom Corrected: • When the the outputs are designated to the stack tray and the feeding tray of the mainframe runs out of paper during the job, "please wait" is displayed on the panel and the job cannot be continued.
02.200:09	Symptom Corrected: • When two SK5000 stackers are connected and a jam occurs in the upstream SK5000, jam is not recovered and machine stalls in "print in process" status. • SC990 occurrence when distance between the paper fed is shorter then 30mm due to a double-feed.
02.180:09	Symptom Corrected: SC990 occurrence after Jam occurrence in a downstream Finisher.
02.160:09	Symptom Corrected: SC990 occurs if the front/top doors on the LOIRE are opened/closed while the finisher is in operation.
02.140:09	1st Mass production

Reissued: 04-Oct-10

Model: B-C4	Date: 04-Mar-09	No.: RD447001f
-------------	-----------------	----------------

RTB Reissue

The items in bold italics have been corrected.

Subject: Firmware Release Note: Stacker_LOIRE1		Prepared by: J.Ohno	
From: PPBG Service Planning Dept.			
Classification:	<input type="checkbox"/> Troubleshooting	<input type="checkbox"/> Part information	<input type="checkbox"/> Action required
	<input type="checkbox"/> Mechanical	<input type="checkbox"/> Electrical	<input type="checkbox"/> Service manual revision
	<input type="checkbox"/> Paper path	<input type="checkbox"/> Transmit/receive	<input type="checkbox"/> Retrofit information
	<input type="checkbox"/> Product Safety	<input checked="" type="checkbox"/> Other ()	<input type="checkbox"/> Tier 2

This RTB has been issued to announce the firmware release information for the **Stacker_LOIRE1**.

Version	Program No.	Effective Date
02.260:09	D4475104G_up	August 2010 production
02.230:09	D4475104F_up	March 2010 production
02.220:09	D4475104E_up	November 2009 production
02.200:09	D4475104D_up	June 2009 production
02.180:09	D4475104C_up	April 2009 production
02.160:09	D4475104B_up	January 2009 production
02.140:09	D4475104A_up	1st Mass production

Version	Modified Points or Symptom Corrected
02.260:09	<p>Specification Change: <i>The Stacker will notify shift tray's full status to the mainframe and stop further feeding when curled sheets are continuously fed causing an instant tray full status.</i></p> <p>Symptoms Corrected:</p> <ul style="list-style-type: none"> - <i>Job status on the mainframe control panel remains 'copying' when a jam occurs while feeding sheets of different sizes to the shift tray.</i> - <i>Jam 260 (Main Machine Setting Incorrect: Stacker 1) occurs when switching the output trays in the following order: Shift tray --> Proof tray --> Shift tray.</i> - <i>SC990 when a jam occurs in the mainframe immediately after switching the output trays.</i> - <i>In the following configuration:</i> - <i>Mainframe + Decurl unit + Cover Interposer + Multi Folding Unit + GBC + High Capacity Stacker + Finisher,</i> <ul style="list-style-type: none"> a) <i>Jam 260 (Main Machine Setting Incorrect: Stacker 1) occurs when switching the output tray from the Stacker shift tray to the Finisher tray.</i> b) <i>With the GBC puncher installed, the shift tray junction gate motor is damaged from exceeding its prescribed temperature when the output trays are continuously alternated between the shift tray and the proof tray.</i> c) <i>With or without the GBC puncher installed, the proof tray</i>

Reissued: 04-Oct-10

Model: B-C4	Date: 04-Mar-09	No.: RD447001f
-------------	-----------------	----------------

Version	Modified Points or Symptom Corrected
	<i>junction gate motor is damaged from exceeding its prescribed temperature when the output trays are continuously alternated between the shift tray and the proof tray.</i>
02.230:09	Symptom Corrected: <ul style="list-style-type: none"> • Jam occurrence fixed when consecutive hits of the down button.
02.220:09	Symptom Corrected: <ul style="list-style-type: none"> • When the the outputs are designated to the stack tray and the feeding tray of the mainframe runs out of paper during the job, "please wait" is displayed on the panel and the job cannot be continued.
02.200:09	Symptom Corrected: <ul style="list-style-type: none"> • When two SK5000 stackers are connected and a jam occurs in the upstream SK5000, jam is not recovered and machine stalls in "print in process" status. • SC990 occurrence when distance between the paper fed is shorter then 30mm due to a double-feed.
02.180:09	Symptom Corrected: <p>SC990 occurrence after Jam occurrence in a downstream Finisher.</p>
02.160:09	Symptom Corrected: <p>SC990 occurs if the front/top doors on the LOIRE are opened/closed while the finisher is in operation.</p>
02.140:09	1st Mass production

Reissued: 04-Oct-10

Model: B-C4	Date: 04-Mar-09	No.: RD447002f
-------------	-----------------	----------------

RTB Reissue

The items in bold italics have been corrected.

Subject: Firmware Release Note: Stacker_LOIRE2		Prepared by: J.Ohno	
From: PPBG Service Planning Dept.			
Classification:	<input type="checkbox"/> Troubleshooting	<input type="checkbox"/> Part information	<input type="checkbox"/> Action required
	<input type="checkbox"/> Mechanical	<input type="checkbox"/> Electrical	<input type="checkbox"/> Service manual revision
	<input type="checkbox"/> Paper path	<input type="checkbox"/> Transmit/receive	<input type="checkbox"/> Retrofit information
	<input type="checkbox"/> Product Safety	<input checked="" type="checkbox"/> Other ()	<input type="checkbox"/> Tier 2

This RTB has been issued to announce the firmware release information for the **Stacker_LOIRE2**.

Version	Program No.	Effective Date
02.260:09	<i>D4475104G_down</i>	<i>August 2010 production</i>
02.230:09	D4475104F_down	March 2010 production
02.220:09	D4475104E_down	November 2009 production
02.200:09	D4475104D_down	June 2009 production
02.180:09	D4475104C_down	April 2009 production
02.160:09	D4475104B_down	January 2009 production
02.140:09	D4475104A_down	1st Mass production

Version	Modified Points or Symptom Corrected
02.260:09	<p><i>Specification Change:</i> <i>The Stacker will notify shift tray's full status to the mainframe and stop further feeding when curled sheets are continuously fed causing an instant tray full status.</i></p> <p><i>Symptoms Corrected:</i></p> <ul style="list-style-type: none"> - <i>Job status on the mainframe control panel remains 'copying' when a jam occurs while feeding sheets of different sizes to the shift tray.</i> - <i>Jam 260 (Main Machine Setting Incorrect: Stacker 1) occurs when switching the output trays in the following order: Shift tray --> Proof tray --> Shift tray.</i> - <i>SC990 when a jam occurs in the mainframe immediately after switching the output trays.</i> - <i>In the following configuration:</i> - <i>Mainframe + Decurl unit + Cover Interposer + Multi Folding Unit + GBC + High Capacity Stacker + Finisher,</i> <ul style="list-style-type: none"> a) <i>Jam 260 (Main Machine Setting Incorrect: Stacker 1) occurs when switching the output tray from the Stacker shift tray to the Finisher tray.</i> b) <i>With the GBC puncher installed, the shift tray junction gate motor is damaged from exceeding its prescribed temperature when the output trays are continuously alternated between the shift tray and the proof tray.</i> c) <i>With or without the GBC puncher installed, the proof tray</i>

Reissued: 04-Oct-10

Model: B-C4	Date: 04-Mar-09	No.: RD447002f
-------------	-----------------	----------------

Version	Modified Points or Symptom Corrected
	<i>junction gate motor is damaged from exceeding its prescribed temperature when the output trays are continuously alternated between the shift tray and the proof tray.</i>
02.230:09	Symptom Corrected: <ul style="list-style-type: none"> • Jam occurrence fixed when consecutive hits of the down button.
02.220:09	Symptom Corrected: <ul style="list-style-type: none"> • When the the outputs are designated to the stack tray and the feeding tray of the mainframe runs out of paper during the job, "please wait" is displayed on the panel and the job cannot be continued.
02.200:09	Symptom Corrected: <ul style="list-style-type: none"> • When two SK5000 stackers are connected and a jam occurs in the upstream SK5000, jam is not recovered and machine stalls in "print in process" status. • SC990 occurrence when distance between the paper fed is shorter then 30mm due to a double-feed.
02.180:09	Symptom Corrected: <p>SC990 occurrence after Jam occurrence in a downstream Finisher.</p>
02.160:09	Symptom Corrected: <p>SC990 occurs if the front/top doors on the LOIRE are opened/closed while the finisher is in operation.</p>
02.140:09	1st Mass production

Reissued: 19-Oct-10

Model: B-C4	Date: 04-Mar-09	No.: RD447001g
-------------	-----------------	----------------

RTB Reissue

The items in bold italics have been corrected.

Subject: Firmware Release Note: Stacker_LOIRE1		Prepared by: J. Ohno	
From: PPBG Service Planning Dept.			
Classification:	<input type="checkbox"/> Troubleshooting <input type="checkbox"/> Mechanical <input type="checkbox"/> Paper path <input type="checkbox"/> Product Safety	<input type="checkbox"/> Part information <input type="checkbox"/> Electrical <input type="checkbox"/> Transmit/receive <input checked="" type="checkbox"/> Other ()	<input type="checkbox"/> Action required <input type="checkbox"/> Service manual revision <input type="checkbox"/> Retrofit information <input type="checkbox"/> Tier 2

This RTB has been issued to announce the firmware release information for the **Stacker_LOIRE1**.

Version	Program No.	Effective Date
02.270:09	<i>D4475104H_up</i>	<i>November 2010 production</i>
02.260:09	D4475104G_up	August 2010 production
02.230:09	D4475104F_up	March 2010 production
02.220:09	D4475104E_up	November 2009 production
02.200:09	D4475104D_up	June 2009 production
02.180:09	D4475104C_up	April 2009 production
02.160:09	D4475104B_up	January 2009 production
02.140:09	D4475104A_up	1st Mass production

Version	Modified Points or Symptom Corrected
02.270:09	<i>Specification Change: SC763-07 has been changed to Jam268 when the Vibrating Plate is lifted up and the Tray Guard Sensors 1 & 2 are detected.</i>
02.260:09	<p>Specification Change: The Stacker will notify shift tray's full status to the mainframe and stop further feeding when curled sheets are continuously fed causing an instant tray full status.</p> <p>Symptoms Corrected:</p> <ul style="list-style-type: none"> - Job status on the mainframe control panel remains 'copying' when a jam occurs while feeding sheets of different sizes to the shift tray. - Jam 260 (Main Machine Setting Incorrect: Stacker 1) occurs when switching the output trays in the following order: Shift tray --> Proof tray --> Shift tray. - SC990 when a jam occurs in the mainframe immediately after switching the output trays. - In the following configuration: - Mainframe + Decurl unit + Cover Interposer + Multi Folding Unit + GBC + High Capacity Stacker + Finisher, <ul style="list-style-type: none"> a) Jam 260 (Main Machine Setting Incorrect: Stacker 1) occurs when switching the output tray from the Stacker shift tray to the Finisher tray. b) With the GBC puncher installed, the shift tray junction gate motor

Reissued: 19-Oct-10

Model: B-C4		Date: 04-Mar-09	No.: RD447001g
Version	Modified Points or Symptom Corrected		
	<p>is damaged from exceeding its prescribed temperature when the output trays are continuously alternated between the shift tray and the proof tray.</p> <p>c) With or without the GBC puncher installed, the proof tray junction gate motor is damaged from exceeding its prescribed temperature when the output trays are continuously alternated between the shift tray and the proof tray.</p>		
02.230:09	Symptom Corrected: <ul style="list-style-type: none"> • Jam occurrence fixed when consecutive hits of the down button. 		
02.220:09	Symptom Corrected: <ul style="list-style-type: none"> • When the the outputs are designated to the stack tray and the feeding tray of the mainframe runs out of paper during the job, "please wait" is displayed on the panel and the job cannot be continued. 		
02.200:09	Symptom Corrected: <ul style="list-style-type: none"> • When two SK5000 stackers are connected and a jam occurs in the upstream SK5000, jam is not recovered and machine stalls in "print in process" status. • SC990 occurrence when distance between the paper fed is shorter then 30mm due to a double-feed. 		
02.180:09	Symptom Corrected: SC990 occurrence after Jam occurrence in a downstream Finisher.		
02.160:09	Symptom Corrected: SC990 occurs if the front/top doors on the LOIRE are opened/closed while the finisher is in operation.		
02.140:09	1st Mass production		

Reissued: 19-Oct-10

Model: B-C4	Date: 04-Mar-09	No.: RD447002g
-------------	-----------------	----------------

RTB Reissue

The items in bold italics have been corrected.

Subject: Firmware Release Note: Stacker_LOIRE2		Prepared by: J. Ohno	
From: PPBG Service Planning Dept.			
Classification:	<input type="checkbox"/> Troubleshooting <input type="checkbox"/> Mechanical <input type="checkbox"/> Paper path <input type="checkbox"/> Product Safety	<input type="checkbox"/> Part information <input type="checkbox"/> Electrical <input type="checkbox"/> Transmit/receive <input checked="" type="checkbox"/> Other ()	<input type="checkbox"/> Action required <input type="checkbox"/> Service manual revision <input type="checkbox"/> Retrofit information <input type="checkbox"/> Tier 2

This RTB has been issued to announce the firmware release information for the **Stacker_LOIRE2**.

Version	Program No.	Effective Date
02.270:09	D4475104H_down	November 2010 production
02.260:09	D4475104G_down	August 2010 production
02.230:09	D4475104F_down	March 2010 production
02.220:09	D4475104E_down	November 2009 production
02.200:09	D4475104D_down	June 2009 production
02.180:09	D4475104C_down	April 2009 production
02.160:09	D4475104B_down	January 2009 production
02.140:09	D4475104A_down	1st Mass production

Version	Modified Points or Symptom Corrected
02.270:09	Specification Change SC763-07 has been changed to Jam268 when the Vibrating Plate is lifted up and the Tray Guard Sensors 1 & 2 are detected.
02.260:09	Specification Change: The Stacker will notify shift tray's full status to the mainframe and stop further feeding when curled sheets are continuously fed causing an instant tray full status. Symptoms Corrected: <ul style="list-style-type: none"> - Job status on the mainframe control panel remains 'copying' when a jam occurs while feeding sheets of different sizes to the shift tray. - Jam 260 (Main Machine Setting Incorrect: Stacker 1) occurs when switching the output trays in the following order: Shift tray --> Proof tray --> Shift tray. - SC990 when a jam occurs in the mainframe immediately after switching the output trays. - In the following configuration: - Mainframe + Decurl unit + Cover Interposer + Multi Folding Unit + GBC + High Capacity Stacker + Finisher, <ul style="list-style-type: none"> a) Jam 260 (Main Machine Setting Incorrect: Stacker 1) occurs when switching the output tray from the Stacker shift tray to the Finisher tray. b) With the GBC puncher installed, the shift tray junction gate motor

Reissued: 19-Oct-10

Model: B-C4		Date: 04-Mar-09	No.: RD447002g
Version	Modified Points or Symptom Corrected		
	<p>is damaged from exceeding its prescribed temperature when the output trays are continuously alternated between the shift tray and the proof tray.</p> <p>c) With or without the GBC puncher installed, the proof tray junction gate motor is damaged from exceeding its prescribed temperature when the output trays are continuously alternated between the shift tray and the proof tray.</p>		
02.230:09	Symptom Corrected: <ul style="list-style-type: none"> • Jam occurrence fixed when consecutive hits of the down button. 		
02.220:09	Symptom Corrected: <ul style="list-style-type: none"> • When the the outputs are designated to the stack tray and the feeding tray of the mainframe runs out of paper during the job, "please wait" is displayed on the panel and the job cannot be continued. 		
02.200:09	Symptom Corrected: <ul style="list-style-type: none"> • When two SK5000 stackers are connected and a jam occurs in the upstream SK5000, jam is not recovered and machine stalls in "print in process" status. • SC990 occurrence when distance between the paper fed is shorter then 30mm due to a double-feed. 		
02.180:09	Symptom Corrected: SC990 occurrence after Jam occurrence in a downstream Finisher.		
02.160:09	Symptom Corrected: SC990 occurs if the front/top doors on the LOIRE are opened/closed while the finisher is in operation.		
02.140:09	1st Mass production		

Model: High Capacity Stacker SK5010 (D447)		Date: 17-Dec-10	No.: RD447005
Subject: Mylars for the Shift Tray		Prepared by: T. Komori	
From: PP Service Planning Department 1G			
Classification:	<input type="checkbox"/> Troubleshooting <input checked="" type="checkbox"/> Part information <input type="checkbox"/> Action required <input type="checkbox"/> Mechanical <input type="checkbox"/> Electrical <input type="checkbox"/> Service manual revision <input type="checkbox"/> Paper path <input type="checkbox"/> Transmit/receive <input type="checkbox"/> Retrofit information <input type="checkbox"/> Product Safety <input type="checkbox"/> Other () <input type="checkbox"/> Tier 2		

Change: New mylars added for the shift tray

Reason: Better stacking on the shift tray

New Part Number	Description	Q'ty	Page	Index	Note
D4477578	SHEET:SHIFT TRAY:INNER BACK	1	31	13	Add
D4477579	SHEET:SHIFT TRAY:MIDDLE	1	31	14	Add
D4477581	SHEET:SHIFT TRAY:FRONT	1	31	15	Add

Static electricity could cause the first sheet to stick to the shift tray of the Stacker (indexed 4 in the diagram below) and the succeeding sheets to curl up. Three mylars have been added to discharge static electricity for better stacking.

15.Paper Cart Section (D447)

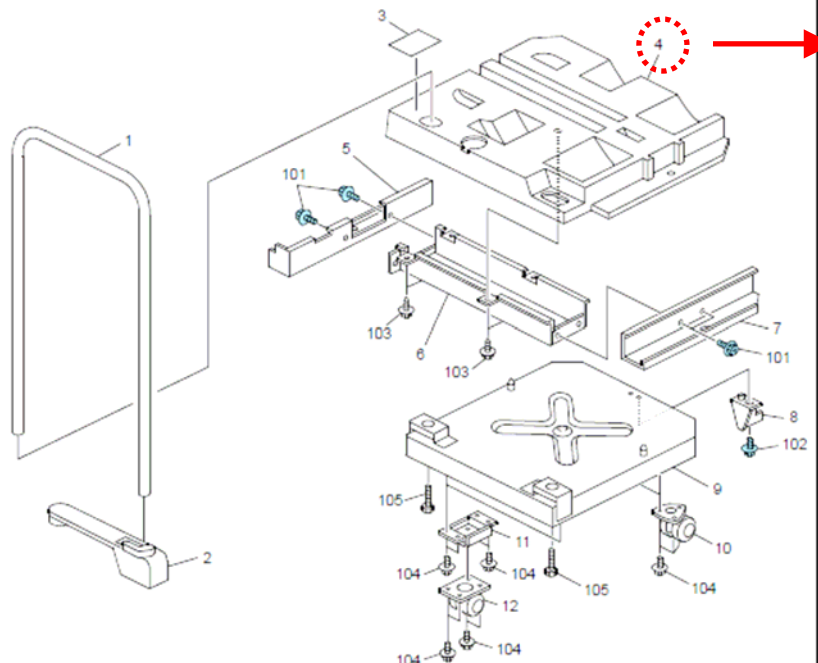

Mylar (black)

Notes on Attaching the Mylars

- Wipe the area with alcohol before attaching the mylar.
- Work carefully to avoid air bubbles. If air bubbles cannot be avoided, the only areas permissible are the two areas indicated in pink in the diagram below.
- Align the corners "A", "B", and "C" so that the edges are positioned within 2mm from the grooves.
- The curved areas "D" should be double-checked. Rub the mylars thoroughly for firm attachment.
- Wipe the surface of the mylars with alcohol to complete the procedure. (Make sure alcohol does not leak in between the mylar and the tray.)

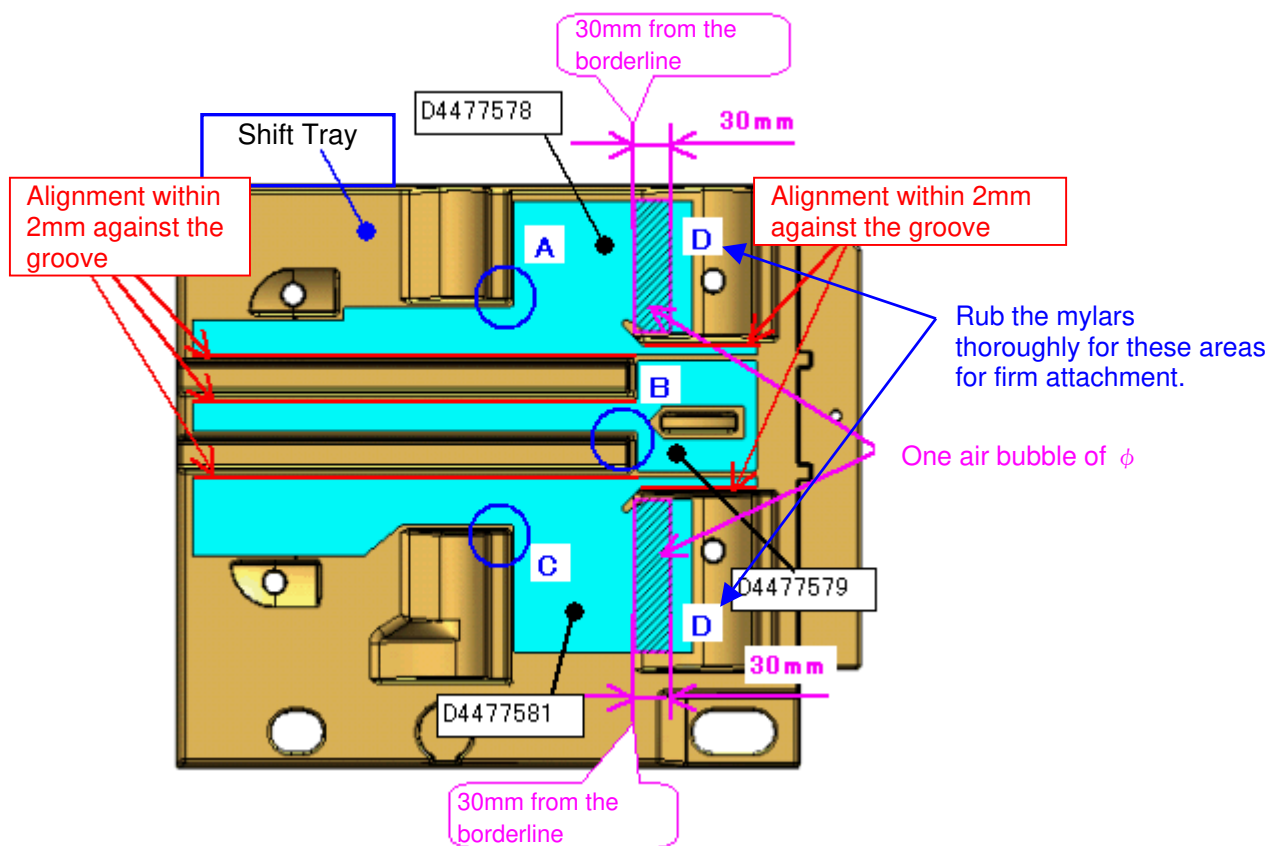

Model: High Capacity Stacker SK5010 (D447)		Date: 25-Mar-11	No.: RD447006
Subject: Parts Catalog Correction		Prepared by: T.Mimura	
From: PPMC Service Planning Department 1G			
Classification:	<input type="checkbox"/> Troubleshooting <input checked="" type="checkbox"/> Part information <input type="checkbox"/> Action required <input type="checkbox"/> Mechanical <input type="checkbox"/> Electrical <input type="checkbox"/> Service manual revision <input type="checkbox"/> Paper path <input type="checkbox"/> Transmit/receive <input type="checkbox"/> Retrofit information <input type="checkbox"/> Product Safety <input type="checkbox"/> Other () <input type="checkbox"/> Tier2		

Change/Reason: The part number was changed in the Parts Catalog.

Old part number	New part number	Old description	New description	Q'ty	Page	Index	Note
D4472126	D4472127	COMPRESSION SPRING:2N	COMPRESSION SPRING:3.6N	-	9	15	-
					11	8	
					13	17	

Reissued: 20-Apr-11

Model: Stacker_LOIRE1	Date: 04-Mar-09	No.: RD447001h
------------------------------	-----------------	----------------

RTB Reissue

The items in bold italics have been corrected.

Subject: Firmware Release Note: Stacker_LOIRE1		Prepared by: J. Ohno	
From: PPBG Service Planning Dept.			
Classification:	<input type="checkbox"/> Troubleshooting <input type="checkbox"/> Mechanical <input type="checkbox"/> Paper path <input type="checkbox"/> Product Safety	<input type="checkbox"/> Part information <input type="checkbox"/> Electrical <input type="checkbox"/> Transmit/receive <input checked="" type="checkbox"/> Other ()	<input type="checkbox"/> Action required <input type="checkbox"/> Service manual revision <input type="checkbox"/> Retrofit information <input type="checkbox"/> Tier 2

This RTB has been issued to announce the firmware release information for the **Stacker_LOIRE1**.

Version	Program No.	Effective Date	Availability of RFU
02.280:09	D4475104J_up	January 2011 production	-
02.270:09	D4475104H_up	November 2010 production	-
02.260:09	D4475104G_up	August 2010 production	-
02.230:09	D4475104F_up	March 2010 production	-
02.220:09	D4475104E_up	November 2009 production	-
02.200:09	D4475104D_up	June 2009 production	-
02.180:09	D4475104C_up	April 2009 production	-
02.160:09	D4475104B_up	January 2009 production	-
02.140:09	D4475104A_up	1st Mass production	-

Note: Definition of Availability of RFU
"Available": The firmware can be updated via RFU or SD card.

"Not available": The firmware can only be updated via SD card.

Version	Modified Points or Symptom Corrected
02.280:09	<i>Symptom Corrected:</i> <i>Jam/SC occurs when the stack exceeds the capacity before the tray alerts full capacity.</i>
02.270:09	Specification Change: SC763-07 has been changed to Jam268 when the Vibrating Plate is lifted up and the Tray Guard Sensors 1 & 2 are detected.
02.260:09	Specification Change: The Stacker will notify shift tray's full status to the mainframe and stop further feeding when curled sheets are continuously fed causing an instant tray full status. Symptoms Corrected: <ul style="list-style-type: none"> - Job status on the mainframe control panel remains 'copying' when a jam occurs while feeding sheets of different sizes to the shift tray. - Jam 260 (Main Machine Setting Incorrect: Stacker 1) occurs when switching the output trays in the following order: Shift tray --> Proof tray --> Shift tray. - SC990 when a jam occurs in the mainframe immediately after switching the

Reissued: 20-Apr-11

Model: Stacker_LOIRE1	Date: 04-Mar-09	No.: RD447001h
-----------------------	-----------------	----------------

Version	Modified Points or Symptom Corrected
	<p>output trays.</p> <ul style="list-style-type: none"> - In the following configuration: - Mainframe + Decurl unit + Cover Interposer + Multi Folding Unit + GBC + High Capacity Stacker + Finisher, <ul style="list-style-type: none"> a) Jam 260 (Main Machine Setting Incorrect: Stacker 1) occurs when switching the output tray from the Stacker shift tray to the Finisher tray. b) With the GBC puncher installed, the shift tray junction gate motor is damaged from exceeding its prescribed temperature when the output trays are continuously alternated between the shift tray and the proof tray. c) With or without the GBC puncher installed, the proof tray junction gate motor is damaged from exceeding its prescribed temperature when the output trays are continuously alternated between the shift tray and the proof tray.
02.230:09	Symptom Corrected: Jam occurrence fixed when consecutive hits of the down button.
02.220:09	Symptom Corrected: When the the outputs are designated to the stack tray and the feeding tray of the mainframe runs out of paper during the job, "please wait" is displayed on the panel and the job cannot be continued.
02.200:09	Symptom Corrected: <ul style="list-style-type: none"> - When two SK5000 stackers are connected and a jam occurs in the upstream SK5000, jam is not recovered and machine stalls in "print in process" status. - SC990 occurrence when distance between the paper fed is shorter then 30mm due to a double-feed.
02.180:09	Symptom Corrected: SC990 occurrence after Jam occurrence in a downstream Finisher.
02.160:09	Symptom Corrected: SC990 occurs if the front/top doors on the LOIRE are opened/closed while the finisher is in operation.
02.140:09	1st Mass production

Reissued: 20-Apr-11

Model: Stacker_LOIRE2	Date: 04-Mar-09	No.: RD447002h
------------------------------	-----------------	----------------

RTB Reissue

The items in bold italics have been corrected.

Subject: Firmware Release Note: Stacker_LOIRE2		Prepared by: J. Ohno	
From: PPBG Service Planning Dept.			
Classification:	<input type="checkbox"/> Troubleshooting <input type="checkbox"/> Mechanical <input type="checkbox"/> Paper path <input type="checkbox"/> Product Safety	<input type="checkbox"/> Part information <input type="checkbox"/> Electrical <input type="checkbox"/> Transmit/receive <input checked="" type="checkbox"/> Other ()	<input type="checkbox"/> Action required <input type="checkbox"/> Service manual revision <input type="checkbox"/> Retrofit information <input type="checkbox"/> Tier 2

This RTB has been issued to announce the firmware release information for the **Stacker_LOIRE2**.

Version	Program No.	Effective Date	Availability of RFU
02.280:09	<i>D4475104J_down</i>	<i>January 2011 production</i>	-
02.270:09	D4475104H_down	November 2010 production	-
02.260:09	D4475104G_down	August 2010 production	-
02.230:09	D4475104F_down	March 2010 production	-
02.220:09	D4475104E_down	November 2009 production	-
02.200:09	D4475104D_down	June 2009 production	-
02.180:09	D4475104C_down	April 2009 production	-
02.160:09	D4475104B_down	January 2009 production	-
02.140:09	D4475104A_down	1st Mass production	

Version	Modified Points or Symptom Corrected
02.280:09	<i>Specification Change; It is modified to occur the jam and SC when stacking over the acceptable weight before the tray makes end detection.</i>
02.270:09	Specification Change SC763-07 has been changed to Jam268 when the Vibrating Plate is lifted up and the Tray Guard Sensors 1 & 2 are detected.
02.260:09	Specification Change: The Stacker will notify shift tray's full status to the mainframe and stop further feeding when curled sheets are continuously fed causing an instant tray full status. Symptoms Corrected: <ul style="list-style-type: none"> - Job status on the mainframe control panel remains 'copying' when a jam occurs while feeding sheets of different sizes to the shift tray. - Jam 260 (Main Machine Setting Incorrect: Stacker 1) occurs when switching the output trays in the following order: Shift tray --> Proof tray --> Shift tray. - SC990 when a jam occurs in the mainframe immediately after switching the output trays. - In the following configuration: - Mainframe + Decurl unit + Cover Interposer + Multi Folding Unit + GBC +

Reissued: 20-Apr-11

Model: Stacker_LOIRE2	Date: 04-Mar-09	No.: RD447002h
-----------------------	-----------------	----------------

Version	Modified Points or Symptom Corrected
	<p>High Capacity Stacker + Finisher,</p> <ul style="list-style-type: none"> a) Jam 260 (Main Machine Setting Incorrect: Stacker 1) occurs when switching the output tray from the Stacker shift tray to the Finisher tray. b) With the GBC puncher installed, the shift tray junction gate motor is damaged from exceeding its prescribed temperature when the output trays are continuously alternated between the shift tray and the proof tray. c) With or without the GBC puncher installed, the proof tray junction gate motor is damaged from exceeding its prescribed temperature when the output trays are continuously alternated between the shift tray and the proof tray.
02.230:09	<p>Symptom Corrected:</p> <ul style="list-style-type: none"> • Jam occurrence fixed when consecutive hits of the down button.
02.220:09	<p>Symptom Corrected:</p> <ul style="list-style-type: none"> • When the the outputs are designated to the stack tray and the feeding tray of the mainframe runs out of paper during the job, "please wait" is displayed on the panel and the job cannot be continued.
02.200:09	<p>Symptom Corrected:</p> <ul style="list-style-type: none"> • When two SK5000 stackers are connected and a jam occurs in the upstream SK5000, jam is not recovered and machine stalls in "print in process" status. • SC990 occurrence when distance between the paper fed is shorter then 30mm due to a double-feed.
02.180:09	<p>Symptom Corrected:</p> <p>SC990 occurrence after Jam occurrence in a downstream Finisher.</p>
02.160:09	<p>Symptom Corrected:</p> <p>SC990 occurs if the front/top doors on the LOIRE are opened/closed while the finisher is in operation.</p>
02.140:09	1st Mass production

Reissued: 04-Oct-11

Model: Stacker_LOIRE1	Date: 04-Mar-09	No.: RD447001i
------------------------------	-----------------	----------------

RTB Reissue

The items in bold italics have been corrected.

Subject: Firmware Release Note: Stacker_LOIRE1		Prepared by: J. Ohno	
From: PP Tech Service Dept., 1st PP Tech Service Sect.			
Classification:	<input type="checkbox"/> Troubleshooting <input type="checkbox"/> Mechanical <input type="checkbox"/> Paper path <input type="checkbox"/> Product Safety	<input type="checkbox"/> Part information <input type="checkbox"/> Electrical <input type="checkbox"/> Transmit/receive <input checked="" type="checkbox"/> Other ()	<input type="checkbox"/> Action required <input type="checkbox"/> Service manual revision <input type="checkbox"/> Retrofit information <input type="checkbox"/> Tier 2

This RTB has been issued to announce the firmware release information for the **Stacker_LOIRE1**.

Version	Program No.	Effective Date	Availability of RFU
02.290:09	D4475104K_up	September 2011 production	-
02.280:09	D4475104J_up	January 2011 production	-
02.270:09	D4475104H_up	November 2010 production	-
02.260:09	D4475104G_up	August 2010 production	-
02.230:09	D4475104F_up	March 2010 production	-
02.220:09	D4475104E_up	November 2009 production	-
02.200:09	D4475104D_up	June 2009 production	-
02.180:09	D4475104C_up	April 2009 production	-
02.160:09	D4475104B_up	January 2009 production	-
02.140:09	D4475104A_up	1st Mass production	-

Version	Modified Points or Symptom Corrected
02.290:09	Addition of New Mainframes Supporting the Stacker: Aries-C1.5/P1.5, Katana-P1(Bellini-P1) Symptoms Corrected: <ol style="list-style-type: none"> The last sheet delivered to the finishing peripheral downstream of the Stacker is duplicated when recovering from a jam caused by opening the door of the GBC during print operation. Jam occurs in the Stacker when the feed tray runs out of paper immediately after switching the output tray from the shift to proof, and vice versa.
02.280:09	Symptom Corrected: Jam/SC occurs when the stack exceeds the capacity before the tray alerts full capacity.
02.270:09	Specification Change: SC763-07 has been changed to Jam268 when the Vibrating Plate is lifted up and the Tray Guard Sensors 1 & 2 are detected.
02.260:09	Specification Change: The Stacker will notify shift tray's full status to the mainframe and stop further feeding when curled sheets are continuously fed causing an instant tray full status.

Reissued: 04-Oct-11

Model: Stacker_LOIRE1	Date: 04-Mar-09	No.: RD447001i
-----------------------	-----------------	----------------

Version	Modified Points or Symptom Corrected
	<p>Symptoms Corrected:</p> <ul style="list-style-type: none"> - Job status on the mainframe control panel remains 'copying' when a jam occurs while feeding sheets of different sizes to the shift tray. - Jam 260 (Main Machine Setting Incorrect: Stacker 1) occurs when switching the output trays in the following order: Shift tray --> Proof tray --> Shift tray. - SC990 when a jam occurs in the mainframe immediately after switching the output trays. - In the following configuration: - Mainframe + Decurl unit + Cover Interposer + Multi Folding Unit + GBC + High Capacity Stacker + Finisher, <ul style="list-style-type: none"> a) Jam 260 (Main Machine Setting Incorrect: Stacker 1) occurs when switching the output tray from the Stacker shift tray to the Finisher tray. b) With the GBC puncher installed, the shift tray junction gate motor is damaged from exceeding its prescribed temperature when the output trays are continuously alternated between the shift tray and the proof tray. c) With or without the GBC puncher installed, the proof tray junction gate motor is damaged from exceeding its prescribed temperature when the output trays are continuously alternated between the shift tray and the proof tray.
02.230:09	<p>Symptom Corrected:</p> <p>Jam occurrence fixed when consecutive hits of the down button.</p>
02.220:09	<p>Symptom Corrected:</p> <p>When the the outputs are designated to the stack tray and the feeding tray of the mainframe runs out of paper during the job, "please wait" is displayed on the panel and the job cannot be continued.</p>
02.200:09	<p>Symptom Corrected:</p> <ul style="list-style-type: none"> - When two SK5000 stackers are connected and a jam occurs in the upstream SK5000, jam is not recovered and machine stalls in "print in process" status. - SC990 occurrence when distance between the paper fed is shorter then 30mm due to a double-feed.
02.180:09	<p>Symptom Corrected:</p> <p>SC990 occurrence after Jam occurrence in a downstream Finisher.</p>
02.160:09	<p>Symptom Corrected:</p> <p>SC990 occurs if the front/top doors on the LOIRE are opened/closed while the finisher is in operation.</p>
02.140:09	1st Mass production

Reissued: 04-Oct-11

Model: Stacker_LOIRE2	Date: 04-Mar-09	No.: RD447002i
------------------------------	-----------------	----------------

RTB Reissue

The items in bold italics have been corrected.

Subject: Firmware Release Note: Stacker_LOIRE2		Prepared by: J. Ohno	
From: PP Tech Service Dept., 1st PP Tech Service Sect.			
Classification:	<input type="checkbox"/> Troubleshooting <input type="checkbox"/> Mechanical <input type="checkbox"/> Paper path <input type="checkbox"/> Product Safety	<input type="checkbox"/> Part information <input type="checkbox"/> Electrical <input type="checkbox"/> Transmit/receive <input checked="" type="checkbox"/> Other ()	<input type="checkbox"/> Action required <input type="checkbox"/> Service manual revision <input type="checkbox"/> Retrofit information <input type="checkbox"/> Tier 2

This RTB has been issued to announce the firmware release information for the **Stacker_LOIRE2**.

Version	Program No.	Effective Date	Availability of RFU
02.290:09	<i>D4475104K_down</i>	<i>September 2011 production</i>	-
02.280:09	D4475104J_down	January 2011 production	-
02.270:09	D4475104H_down	November 2010 production	-
02.260:09	D4475104G_down	August 2010 production	-
02.230:09	D4475104F_down	March 2010 production	-
02.220:09	D4475104E_down	November 2009 production	-
02.200:09	D4475104D_down	June 2009 production	-
02.180:09	D4475104C_down	April 2009 production	-
02.160:09	D4475104B_down	January 2009 production	-
02.140:09	D4475104A_down	1st Mass production	

Version	Modified Points or Symptom Corrected
02.290:09	<i>Addition of New Mainframes Supporting the Stacker:</i> <i>Aries-C1.5/P1.5, Katana-P1(Bellini-P1)</i> <i>Symptoms Corrected:</i> <i>1. The last sheet delivered to the finishing peripheral downstream of the Stacker is duplicated when recovering from a jam caused by opening the door of the GBC during print operation.</i> <i>2. Jam occurs in the Stacker when the feed tray runs out of paper immediately after switching the output tray from the shift to proof, and vice versa.</i>
02.280:09	Specification Change; It is modified to occur the jam and SC when stacking over the acceptable weight before the tray makes end detection.
02.270:09	Specification Change SC763-07 has been changed to Jam268 when the Vibrating Plate is lifted up and the Tray Guard Sensors 1 & 2 are detected.
02.260:09	Specification Change: The Stacker will notify shift tray's full status to the mainframe and stop further feeding when curled sheets are continuously fed causing an instant tray full status.

Reissued: 04-Oct-11

Model: Stacker_LOIRE2	Date: 04-Mar-09	No.: RD447002i
-----------------------	-----------------	----------------

Version	Modified Points or Symptom Corrected
	<p>Symptoms Corrected:</p> <ul style="list-style-type: none"> - Job status on the mainframe control panel remains 'copying' when a jam occurs while feeding sheets of different sizes to the shift tray. - Jam 260 (Main Machine Setting Incorrect: Stacker 1) occurs when switching the output trays in the following order: Shift tray --> Proof tray --> Shift tray. - SC990 when a jam occurs in the mainframe immediately after switching the output trays. - In the following configuration: - Mainframe + Decurl unit + Cover Interposer + Multi Folding Unit + GBC + High Capacity Stacker + Finisher, <ul style="list-style-type: none"> a) Jam 260 (Main Machine Setting Incorrect: Stacker 1) occurs when switching the output tray from the Stacker shift tray to the Finisher tray. b) With the GBC puncher installed, the shift tray junction gate motor is damaged from exceeding its prescribed temperature when the output trays are continuously alternated between the shift tray and the proof tray. c) With or without the GBC puncher installed, the proof tray junction gate motor is damaged from exceeding its prescribed temperature when the output trays are continuously alternated between the shift tray and the proof tray.
02.230:09	<p>Symptom Corrected:</p> <ul style="list-style-type: none"> • Jam occurrence fixed when consecutive hits of the down button.
02.220:09	<p>Symptom Corrected:</p> <ul style="list-style-type: none"> • When the the outputs are designated to the stack tray and the feeding tray of the mainframe runs out of paper during the job, "please wait" is displayed on the panel and the job cannot be continued.
02.200:09	<p>Symptom Corrected:</p> <ul style="list-style-type: none"> • When two SK5000 stackers are connected and a jam occurs in the upstream SK5000, jam is not recovered and machine stalls in "print in process" status. • SC990 occurrence when distance between the paper fed is shorter then 30mm due to a double-feed.
02.180:09	<p>Symptom Corrected:</p> <p>SC990 occurrence after Jam occurrence in a downstream Finisher.</p>
02.160:09	<p>Symptom Corrected:</p> <p>SC990 occurs if the front/top doors on the LOIRE are opened/closed while the finisher is in operation.</p>
02.140:09	1st Mass production

Model: High Capacity Stacker SK5010 (D447)		Date: 05-Dec-11	No.: RD447007
Subject: Part Changes of High Capacity Stacker SK5010		Prepared by: S. Sasaki	
From: 1st PP Technical Service Section			
Classification:	<input type="checkbox"/> Troubleshooting <input checked="" type="checkbox"/> Part information <input type="checkbox"/> Action required <input type="checkbox"/> Mechanical <input type="checkbox"/> Electrical <input type="checkbox"/> Service manual revision <input type="checkbox"/> Paper path <input type="checkbox"/> Transmit/receive <input type="checkbox"/> Retrofit information <input type="checkbox"/> Product Safety <input type="checkbox"/> Other () <input type="checkbox"/> Tier 2		

This RTB has been issued to announce the following parts changes.

17. Drive Section 2 (D447)

Old Part Number	New Part Number	Description	Q'ty	Int	Page	Index	Note
D4474118	D4474121	Bracket:Protect:Drive Sub-unit	1	X/O As a set	35	4	*1
	D4474123	Bracket:Auxiliary:Timing Pulley :Ass'y	1		35	24	*2
D4474424	D4474425	Bracket:Protect:Shaft:Left Inner Rear	1	X/O	35	17	*1
D4474531	D4474534	Supporting Plate:Timing Belt	1	X/O	35	2	*1
	AE030030	Ball Bearing 8x19x6	3		35	115	*2
	07200060E	Retaining Ring	1		35	116	*2
	04514006N	Tapping Screw 4x6	2		35	117	*2

Note 1. The shape of the part was changed

Note 2. The part was newly added.

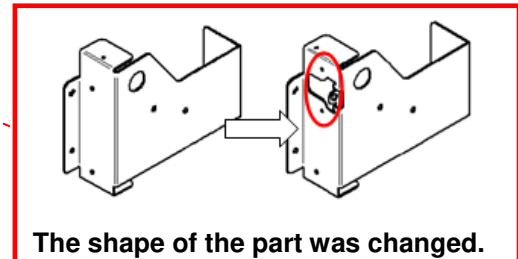
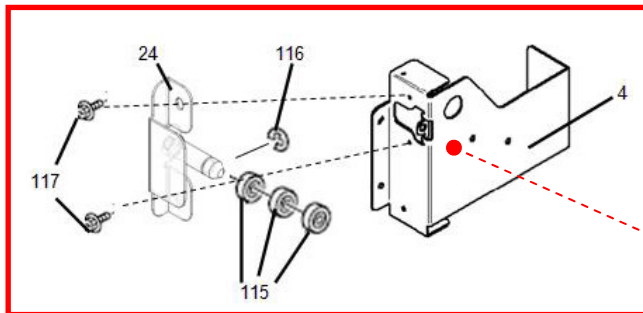

The shape of the part was changed.

17.Drive Section 2 (D447)

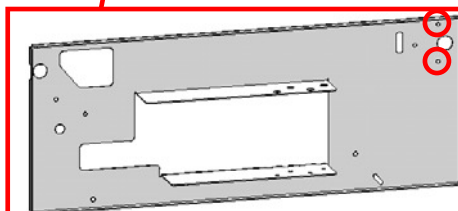
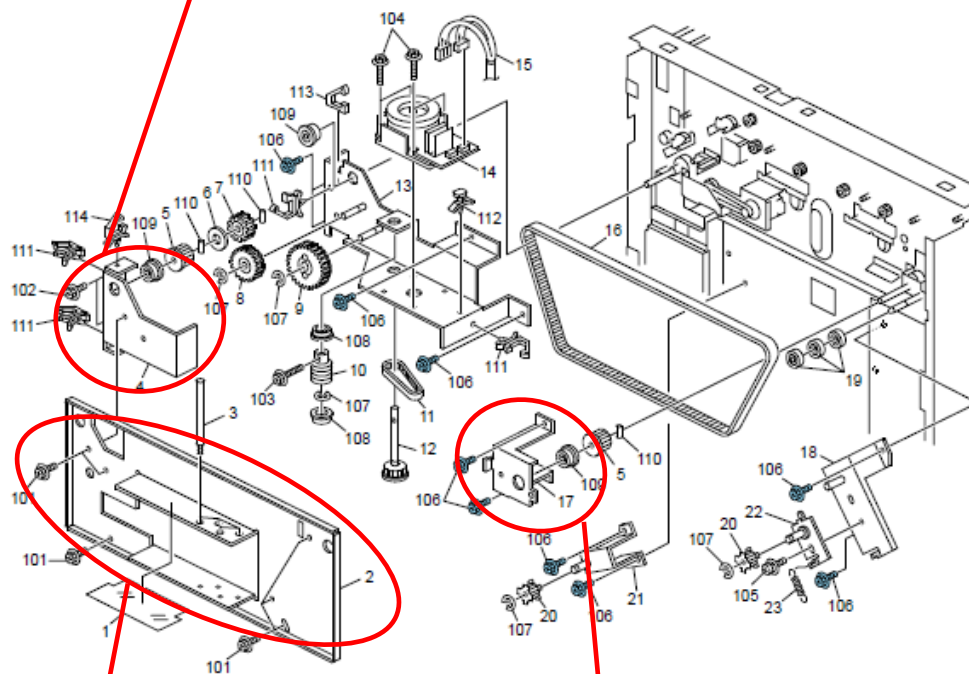

The two screw holes were added.

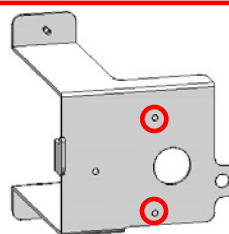

The two screw holes were added.

Reissued: 21-Feb-12

Model: Stacker_LOIRE1	Date: 04-Mar-09	No.: RD447001j
------------------------------	-----------------	----------------

RTB Reissue

The items in bold italics have been corrected.

Subject: Firmware Release Note: Stacker_LOIRE1		Prepared by: J. Ohno	
From: 1st PP Tech Service Sect., PP Tech Service Dept.			
Classification:	<input type="checkbox"/> Troubleshooting	<input type="checkbox"/> Part information	<input type="checkbox"/> Action required
	<input type="checkbox"/> Mechanical	<input type="checkbox"/> Electrical	<input type="checkbox"/> Service manual revision
	<input type="checkbox"/> Paper path	<input type="checkbox"/> Transmit/receive	<input type="checkbox"/> Retrofit information
	<input type="checkbox"/> Product Safety	<input checked="" type="checkbox"/> Other (Firmware)	<input checked="" type="checkbox"/> Tier 2

This RTB has been issued to announce the firmware release information for the **Stacker_LOIRE1**.

Version	Program No.	Effective Date	Availability of RFU
02.300:09	D4475104L_up	January 2012 production	Not available
02.290:09	D4475104K_up	September 2011 production	Not available
02.290:09	D4475104K_up	September 2011 production	Not available
02.280:09	D4475104J_up	January 2011 production	Not available
02.270:09	D4475104H_up	November 2010 production	Not available
02.260:09	D4475104G_up	August 2010 production	Not available
02.230:09	D4475104F_up	March 2010 production	Not available
02.220:09	D4475104E_up	November 2009 production	Not available
02.200:09	D4475104D_up	June 2009 production	Not available
02.180:09	D4475104C_up	April 2009 production	Not available
02.160:09	D4475104B_up	January 2009 production	Not available
02.140:09	D4475104A_up	1st Mass production	Not available

Note: Definition of Availability of RFU via @Remote
"Available": The firmware can be updated via RFU or SD card.

"Not available": The firmware can only be updated via SD card.

Version	Modified Points or Symptom Corrected
02.300:09	Specification Changes: <i>A span of 250msec to withhold the OFF signal was newly prescribed as a specification of the GBC Stream Punch.</i>
02.290:09	Addition of New Mainframes Supporting the Stacker: Aries-C1.5/P1.5, Katana-P1 (Bellini-P1) Symptoms Corrected: 1. The last sheet delivered to the finishing peripheral downstream of the Stacker is duplicated when recovering from a jam caused by opening the door of the GBC during print operation. 2. Jam occurs in the Stacker when the feed tray runs out of paper immediately after switching the output tray from the shift to proof, and vice versa.
02.280:09	Symptom Corrected: Jam/SC occurs when the stack exceeds the capacity before the tray alerts full capacity.
02.270:09	Specification Change: SC763-07 has been changed to Jam268 when the Vibrating Plate is lifted up

Reissued: 21-Feb-12

Model: Stacker_LOIRE1	Date: 04-Mar-09	No.: RD447001j
-----------------------	-----------------	----------------

Version	Modified Points or Symptom Corrected
	and the Tray Guard Sensors 1 & 2 is detected.
02.260:09	<p>Specification Change: The Stacker will notify shift tray's full status to the mainframe and stop further feeding when curled sheets are continuously fed causing an instant tray full status.</p> <p>Symptoms Corrected:</p> <ul style="list-style-type: none"> - Job status on the mainframe control panel remains 'copying' when a jam occurs while feeding sheets of different sizes to the shift tray. - Jam 260 (Main Machine Setting Incorrect: Stacker 1) occurs when switching the output trays in the following order: Shift tray --> Proof tray --> Shift tray. - SC990 when a jam occurs in the mainframe immediately after switching the output trays. - In the following configuration: - Mainframe + Decurl unit + Cover Interposer + Multi Folding Unit + GBC + High Capacity Stacker + Finisher, <ul style="list-style-type: none"> a) Jam 260 (Main Machine Setting Incorrect: Stacker 1) occurs when switching the output tray from the Stacker shift tray to the Finisher tray. b) With the GBC puncher installed, the shift tray junction gate motor is damaged from exceeding its prescribed temperature when the output trays are continuously alternated between the shift tray and the proof tray. c) With or without the GBC puncher installed, the proof tray junction gate motor is damaged from exceeding its prescribed temperature when the output trays are continuously alternated between the shift tray and the proof tray.
02.230:09	Symptom Corrected: Jam occurrence fixed when consecutive hits of the down button.
02.220:09	Symptom Corrected: When the the outputs are designated to the stack tray and the feeding tray of the mainframe runs out of paper during the job, "please wait" is displayed on the panel and the job cannot be continued.
02.200:09	<p>Symptom Corrected:</p> <ul style="list-style-type: none"> - When two SK5000 stackers are connected and a jam occurs in the upstream SK5000, jam is not recovered and machine stalls in "print in process" status. - SC990 occurrence when distance between the papers fed is shorter then 30mm due to a double-feed.
02.180:09	Symptom Corrected: SC990 occurrence after Jam occurrence in a downstream Finisher.
02.160:09	Symptom Corrected: SC990 occurs if the front/top doors on the LOIRE are opened/closed while the finisher is in operation.
02.140:09	1st Mass production

Reissued: 21-Feb-12

Model: Stacker_LOIRE2	Date: 04-Mar-09	No.: RD447002j
------------------------------	-----------------	----------------

RTB Reissue

The items in bold italics have been corrected.

Subject: Firmware Release Note: Stacker_LOIRE2		Prepared by: J. Ohno	
From: 1st PP Tech Service Sect., PP Tech Service Dept.			
Classification:	<input type="checkbox"/> Troubleshooting <input type="checkbox"/> Mechanical <input type="checkbox"/> Paper path <input type="checkbox"/> Product Safety	<input type="checkbox"/> Part information <input type="checkbox"/> Electrical <input type="checkbox"/> Transmit/receive <input checked="" type="checkbox"/> Other (Firmware)	<input type="checkbox"/> Action required <input type="checkbox"/> Service manual revision <input type="checkbox"/> Retrofit information <input checked="" type="checkbox"/> Tier 2

This RTB has been issued to announce the firmware release information for the **Stacker_LOIRE2**.

Version	Program No.	Effective Date	Availability of RFU
02.300:09	<i>D4475104L_down</i>	<i>January 2012 production</i>	<i>Not available</i>
02.290:09	D4475104K_down	September 2011 production	Not available
02.280:09	D4475104J_down	January 2011 production	Not available
02.270:09	D4475104H_down	November 2010 production	Not available
02.260:09	D4475104G_down	August 2010 production	Not available
02.230:09	D4475104F_down	March 2010 production	Not available
02.220:09	D4475104E_down	November 2009 production	Not available
02.200:09	D4475104D_down	June 2009 production	Not available
02.180:09	D4475104C_down	April 2009 production	Not available
02.160:09	D4475104B_down	January 2009 production	Not available
02.140:09	D4475104A_down	1st Mass production	Not available

Note: Definition of Availability of RFU via @Remote
“Available”: The firmware can be updated via RFU or SD card.

“Not available”: The firmware can only be updated via SD card.

Version	Modified Points or Symptom Corrected
02.300:09	<i>Specification Changes: A span of 250msec to withhold the OFF signal was newly prescribed as a specification of the GBC Stream Punch.</i>
02.290:09	Addition of New Mainframes Supporting the Stacker: Aries-C1.5/P1.5, Katana-P1 (Bellini-P1) Symptoms Corrected: 1. The last sheet delivered to the finishing peripheral downstream of the Stacker is duplicated when recovering from a jam caused by opening the door of the GBC during print operation. 2. Jam occurs in the Stacker when the feed tray runs out of paper immediately after switching the output tray from the shift to proof, and vice versa.
02.280:09	Specification Change; It is modified to occur the jam and SC when stacking over the acceptable weight before the tray makes end detection.
02.270:09	Specification Change SC763-07 has been changed to Jam268 when the Vibrating Plate is lifted up and the Tray Guard Sensors 1 & 2 is detected.

Reissued: 21-Feb-12

Model: Stacker_LOIRE2	Date: 04-Mar-09	No.: RD447002j
-----------------------	-----------------	----------------

Version	Modified Points or Symptom Corrected
02.260:09	<p>Specification Change: The Stacker will notify shift tray's full status to the mainframe and stop further feeding when curled sheets are continuously fed causing an instant tray full status.</p> <p>Symptoms Corrected:</p> <ul style="list-style-type: none"> - Job status on the mainframe control panel remains 'copying' when a jam occurs while feeding sheets of different sizes to the shift tray. - Jam 260 (Main Machine Setting Incorrect: Stacker 1) occurs when switching the output trays in the following order: Shift tray --> Proof tray --> Shift tray. - SC990 when a jam occurs in the mainframe immediately after switching the output trays. - In the following configuration: - Mainframe + Decurl unit + Cover Interposer + Multi Folding Unit + GBC + High Capacity Stacker + Finisher, <ul style="list-style-type: none"> a) Jam 260 (Main Machine Setting Incorrect: Stacker 1) occurs when switching the output tray from the Stacker shift tray to the Finisher tray. b) With the GBC puncher installed, the shift tray junction gate motor is damaged from exceeding its prescribed temperature when the output trays are continuously alternated between the shift tray and the proof tray. c) With or without the GBC puncher installed, the proof tray junction gate motor is damaged from exceeding its prescribed temperature when the output trays are continuously alternated between the shift tray and the proof tray.
02.230:09	<p>Symptom Corrected:</p> <ul style="list-style-type: none"> • Jam occurrence fixed when consecutive hits of the down button.
02.220:09	<p>Symptom Corrected:</p> <ul style="list-style-type: none"> • When the the outputs are designated to the stack tray and the feeding tray of the mainframe runs out of paper during the job, "please wait" is displayed on the panel and the job cannot be continued.
02.200:09	<p>Symptom Corrected:</p> <ul style="list-style-type: none"> • When two SK5000 stackers are connected and a jam occurs in the upstream SK5000, jam is not recovered and machine stalls in "print in process" status. • SC990 occurrence when distance between the papers fed is shorter then 30mm due to a double-feed.
02.180:09	<p>Symptom Corrected:</p> <p>SC990 occurrence after Jam occurrence in a downstream Finisher.</p>
02.160:09	<p>Symptom Corrected:</p> <p>SC990 occurs if the front/top doors on the LOIRE are opened/closed while the finisher is in operation.</p>
02.140:09	1st Mass production

Model: High Capacity Stacker SK5010 (D447)		Date: 24-Feb-12	No.: RD447008
Subject: Part Changes – Proof Tray Guide Plate / Roller		Prepared by: J. Ohno	
From: PP Tech Service Dept., 1st PP Tech Service Sect.			
Classification:	<input type="checkbox"/> Troubleshooting <input type="checkbox"/> Mechanical <input type="checkbox"/> Paper path <input type="checkbox"/> Product Safety	<input checked="" type="checkbox"/> Part information <input type="checkbox"/> Electrical <input type="checkbox"/> Transmit/receive <input type="checkbox"/> Other ()	<input type="checkbox"/> Action required <input type="checkbox"/> Service manual revision <input type="checkbox"/> Retrofit information <input type="checkbox"/> Tier 2

Change: Shapes of the Guide Plate and the Roller of the Proof Tray

Reason: To prevent interference of the Guide Plate and the Roller

6. Proof Tray Exit Section (D447)

Old Part Number	New Part Number	Description	Q'ty	Int	Page	Index	Note
D4472428	D4472434	GUIDE PLATE: PROOF TRAY: LEFT UPPER: ASS'Y	1	X/O	13	11	*1,*2
D4472426	D4472432	ROLLER: EXIT: AUXILIARY: ASS'Y	1	X/O	13	13	*1,*2

Note 1: When replacing the above parts, replace D4472434 and D4472432 as a set.

Note 2: GUIDE PLATE: PROOF TRAY: LEFT UPPER: ASS'Y has been modified as follows: D4472421 → D4472428 → D4472434.

ROLLER: EXIT: AUXILIARY: ASS'Y has been modified as follows:
B4782231 → D4472426 → D4472432.

Model: High Capacity Stacker SK5010 (D447)

Date: 24-Feb-12

No.: RD447008

6.Proof Tray Exit Section (D447)

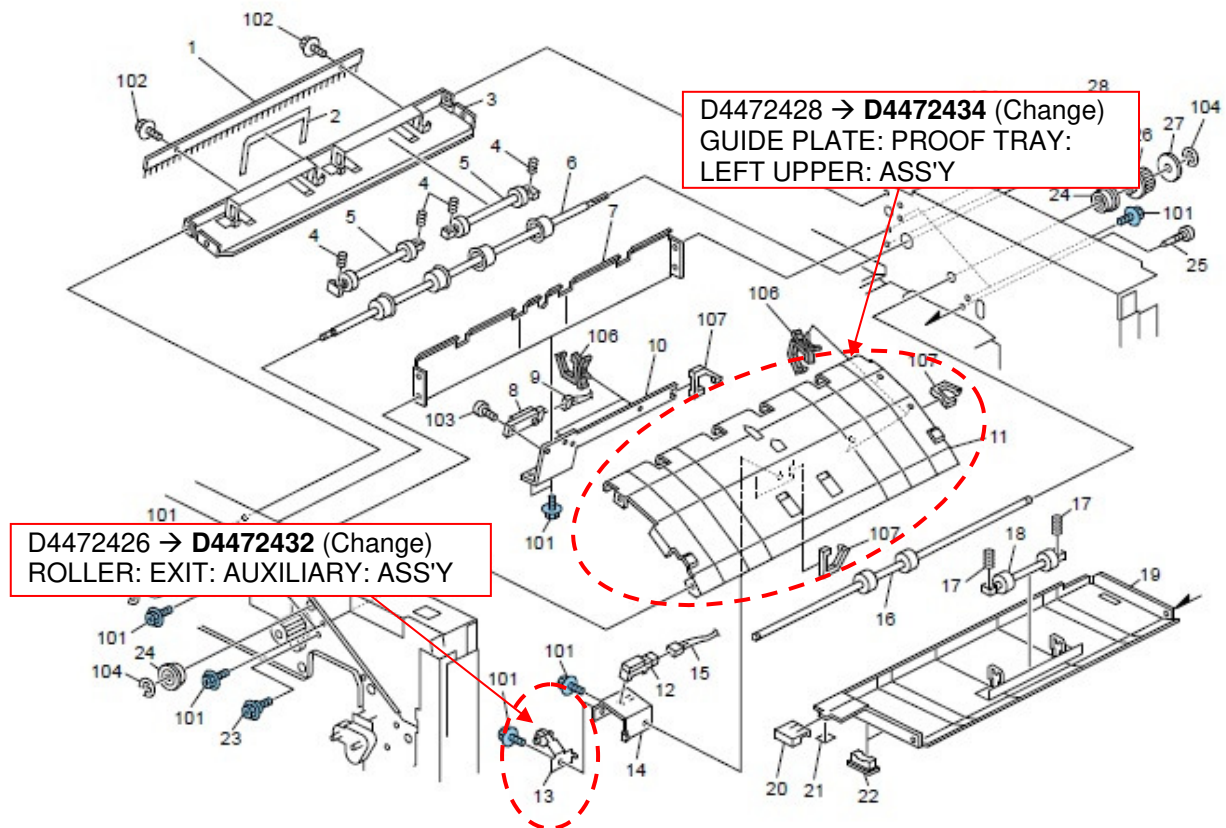

Model: High Capacity Stacker SK5010 (D447)		Date: 22-Jun-2012	No.: RD447009
Subject: P/N of modified paper exit rollers		Prepared by: J. Ohno	
From: 1st PP Tech Service Sec., PP Tech Service Dept.			
Classification:	<input type="checkbox"/> Troubleshooting <input type="checkbox"/> Mechanical <input type="checkbox"/> Paper path <input type="checkbox"/> Product Safety	<input checked="" type="checkbox"/> Part information <input type="checkbox"/> Electrical <input type="checkbox"/> Transmit/receive <input type="checkbox"/> Other ()	<input type="checkbox"/> Action required <input type="checkbox"/> Service manual revision <input type="checkbox"/> Retrofit information <input type="checkbox"/> Tier2

Change: Rollers that feed out paper to the Shift tray and the Proof tray were modified.

Reason: To prevent roller marks when feeding paper out to the Shift and Proof trays.

Proof tray section

Old Part Number	New Part Number	Description	Q'ty	Int	Page	Index	Note
AF022148	D4342551	EXIT ROLLER:DRIVEN: PROOF TRAY:ASS'Y	2	X/O	13	5	-
-	AA080237	BUSHING - 4X5X7	4	-	13	29	Add
D4472451	D4472454	GUIDE PLATE:END FENCE:PROOF TRAY	1	X/O	13	7	-

When replacing any of the above parts for the first time, replace as a set along with the following parts that were announced in RTB RD447008:

D4472434 Guide Plate: Proof Tray: Left Upper: Ass'y

D4472432 Roller: Exit: Auxiliary: Ass'y

6.Proof Tray Exit Section (D447)

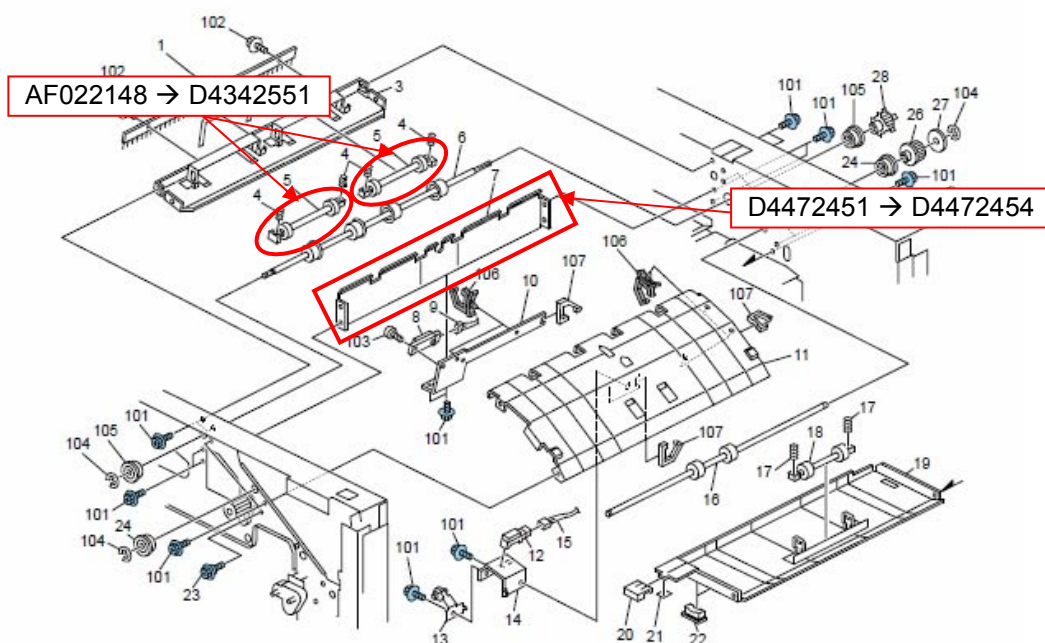

Model: High Capacity Stacker SK5010 (D447)

Date: 22-Jun-2012

No.: RD447009

Shift tray section

Old Part Number	New Part Number	Description	Q'ty	Int	Page	Index	Note
D4472836	D4472876	EXIT ROLLER:SHIFT:ASS'Y	1	X/O	19	13	-
-	D4342474	ROLLER:EXIT ROLLER:SHIFT	2	-	19	30	Add
-	D4472877	SHAFT:EXIT ROLLER:SHIFT	1	-	19	29	Add
-	06330120G	PARALLEL PIN - 3X12	6	-	19	31	Add

D4472876 consists of the following sub-parts :

D4342474, D4472877, 06330120G, 07200060E

Old Part Number	New Part Number	Description	Q'ty	Int	Page	Index	Note
B4782328	D4342459	ROLLER:DRIVEN:RUBBER:50: DIA22	2	X/O	19	11	-
D4472838	D4472879	SHAFT:SHIFT:DRIVEN	1	X/O	19	10	-

Old Part Number	New Part Number	Description	Q'ty	Int	Page	Index	Note
D4472822	D4472852	END FENCE:SHIFT:ASS'Y	1	X/O	19	22	-

9.Paper Tray Exit Section (D447)

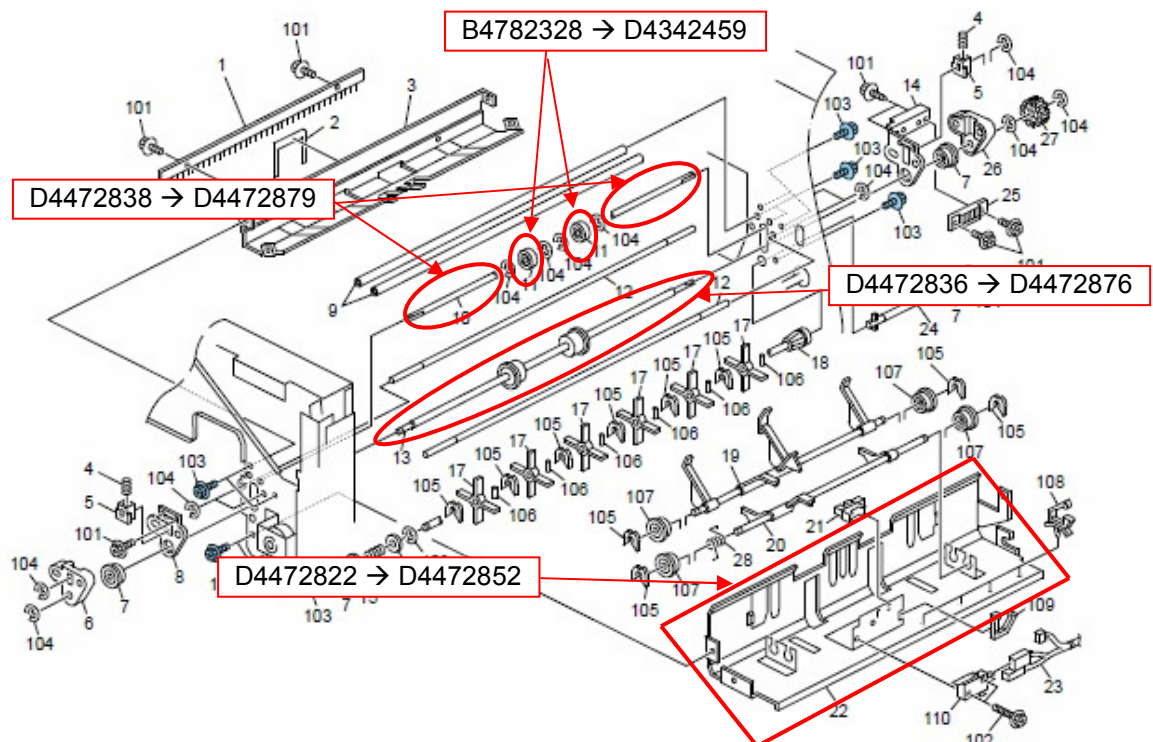

Model: High Capacity Stacker SK5010 (D447)		Date: 10-Jul-2012	No.: RD447010
Subject: New P/N of the Door-lock Bracket		Prepared by: J. Ohno	
From: 1 st PP Tech Service Sec., PP Tech Service Dept.			
Classification:	<input type="checkbox"/> Troubleshooting <input type="checkbox"/> Mechanical <input type="checkbox"/> Paper path <input type="checkbox"/> Product Safety	<input checked="" type="checkbox"/> Part information <input type="checkbox"/> Electrical <input type="checkbox"/> Transmit/receive <input type="checkbox"/> Other ()	<input type="checkbox"/> Action required <input type="checkbox"/> Service manual revision <input type="checkbox"/> Retrofit information <input type="checkbox"/> Tier2

Change 1: The door-lock bracket was modified.

Change 2: The Mylar Sheet attached to the door-lock bracket was eliminated.

Reason: To prevent a jammed door (See page 3 for details)

Old P/N	New P/N	Description	Q'ty	Int	Page	Index	Note
D447 6143	D447 6150	Bracket: Lock: Door	1	X/O	3	7	Change
D447 1178	-	Sheet: Door: Lock	1	-	43	2	Delete

1.Exterior 1 (D447)

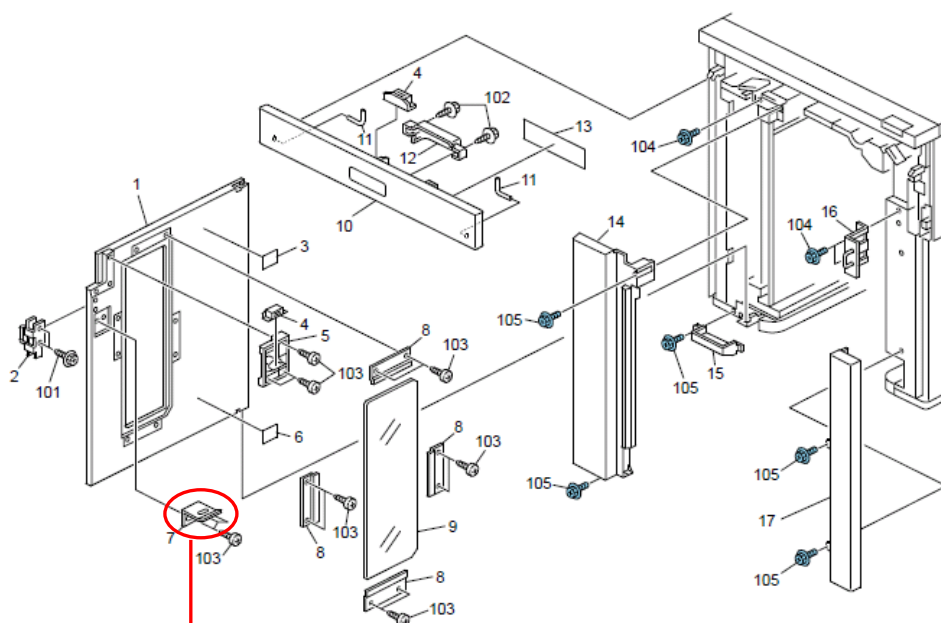

D447 6143 → D447 6150

21. Electrical Section 3 (D447)

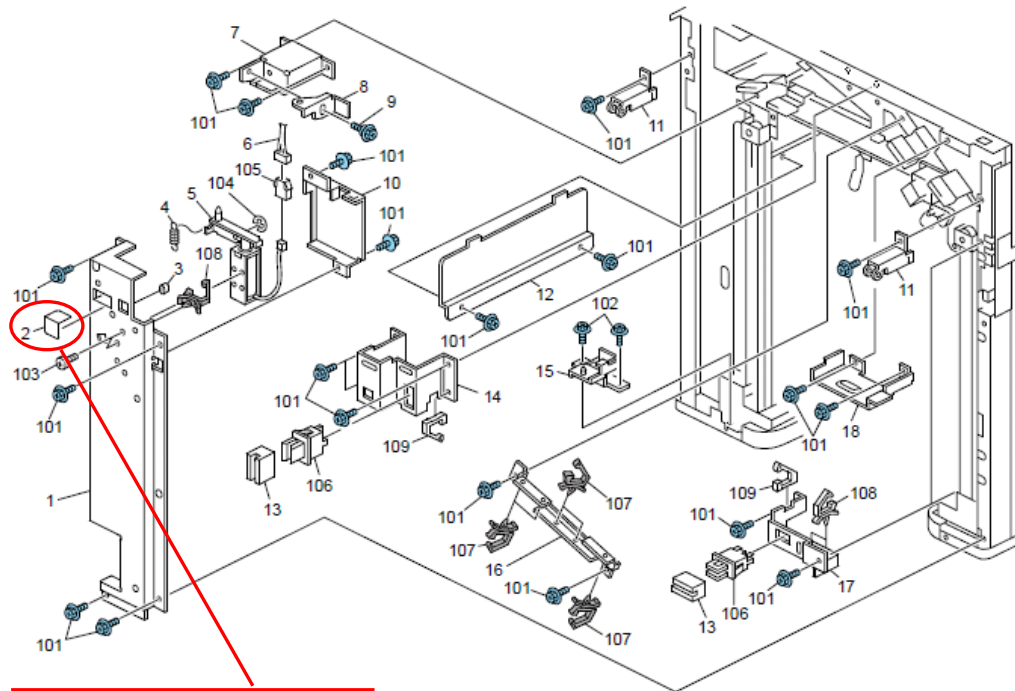

D447 1178 → Deleted

Model: High Capacity Stacker SK5010 (D447)

Date: 10-Jul-2012

No.: RD447010

Opening and closing the front door many times could cause the Mylar Sheet, which is attached to the door-lock bracket to prevent friction between the door bracket and the mainframe bracket, to come off over time. When the Mylar Sheet comes off, the double-sided adhesive tape remains on the bracket, and causes the door to jam.

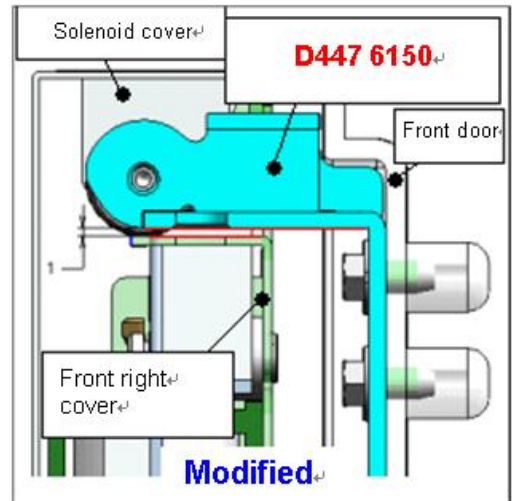
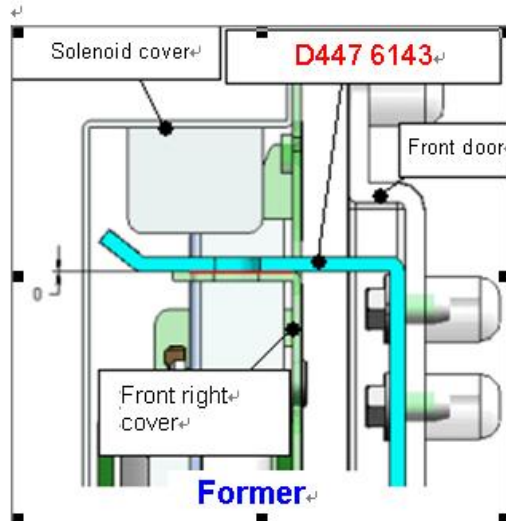

As a substitute for the Mylar Sheet, the modified Bracket incorporates a roller to reduce the friction between the brackets.

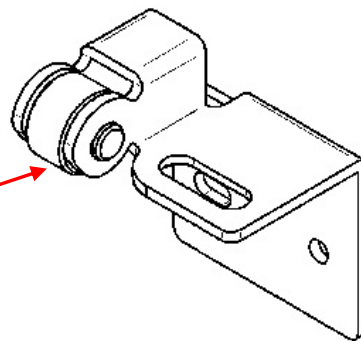

This photo shows the Bracket missing the Mylar Sheet, leaving only the double-sided adhesive tape.

Model: High Capacity Stacker SK5010 (D447)		Date: 13-Nov-2013	No.: RD447011
Subject: DOOR LOCK BRACKET CHANGE		Prepared by: T. Tanimoto	
From: PP Technical Service Department 1G			
Classification:	<input type="checkbox"/> Troubleshooting <input checked="" type="checkbox"/> Mechanical <input type="checkbox"/> Paper path <input type="checkbox"/> Product Safety	<input type="checkbox"/> Part information <input type="checkbox"/> Electrical <input type="checkbox"/> Transmit/receive <input type="checkbox"/> Other ()	<input type="checkbox"/> Action required <input type="checkbox"/> Service manual revision <input type="checkbox"/> Retrofit information <input type="checkbox"/> Tier2

Change:

- Removing mylar sheet
- Adding the pressure roller to the door lock bracket

Reason:

There is a possibility that the mylar sheet of the Door Lock Component is easily stripped after a certain time use. To prevent this, a pressure roller is added to the door lock bracket and that mylar sheet is removed.

The part number was changed in the Parts Catalog.

Old part number	New part number	Old description	New description	Q'ty	Page	Index	Note
D4471176		SHEET:DOOR:LOCK	-	0	43	2	
D4476143	D4476150	BRACKET:LOCK:DOOR	←-	1	3	7	

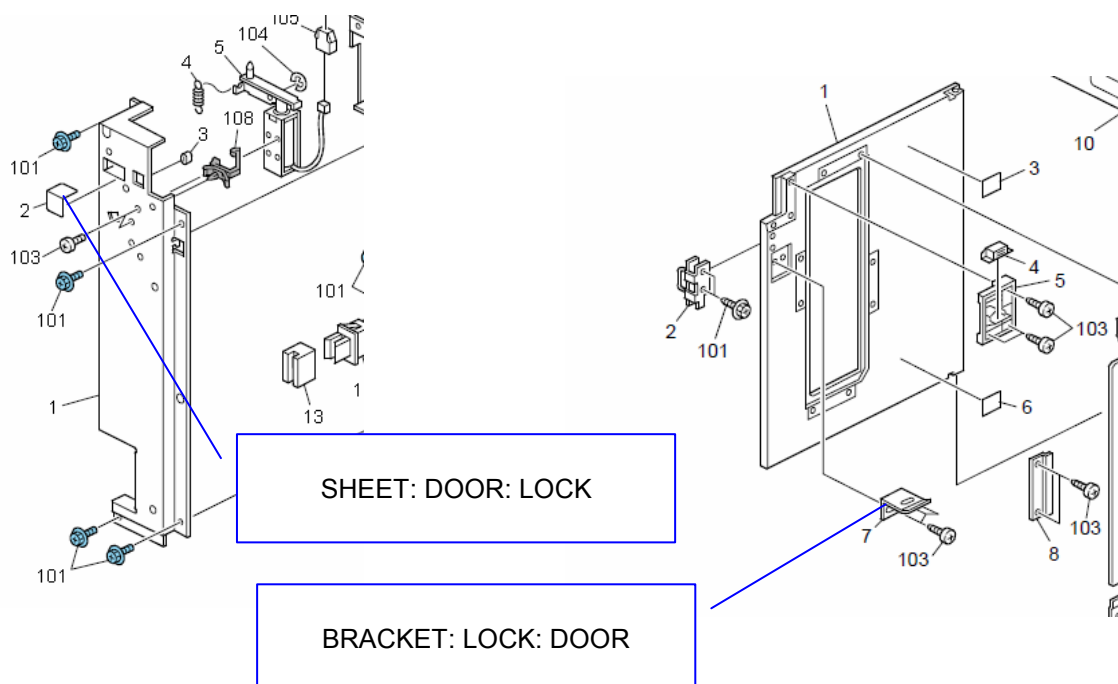

Model: High Capacity Stacker SK5010 (D447)	Date: 13-Nov-2013	No.: RD447011
--	-------------------	---------------

Picture: SHEET: DOOR: LOCK



Picture: BRACKET: LOCK: DOOR

BEFORE

AFTER

