

Model: Model K-P1 1 Bin Shift Sort Tray		Date: 23-May-01	No.: MG554001
Modified Article: Parts Catalog		Prepared by: K. Kitajima	
From: Technical Services Dept., GTS Division			
Reason for Modification:	<input checked="" type="checkbox"/> Parts catalog correction <input type="checkbox"/> To facilitate assembly <input type="checkbox"/> Part standardization	<input type="checkbox"/> Vendor change <input type="checkbox"/> To improve reliability <input type="checkbox"/> Other	<input type="checkbox"/> To meet standards ()

Please make the following corrections to your Parts Catalogs:

A. Call-out Correction

3. 1 Bin Sorter 3 (G554)

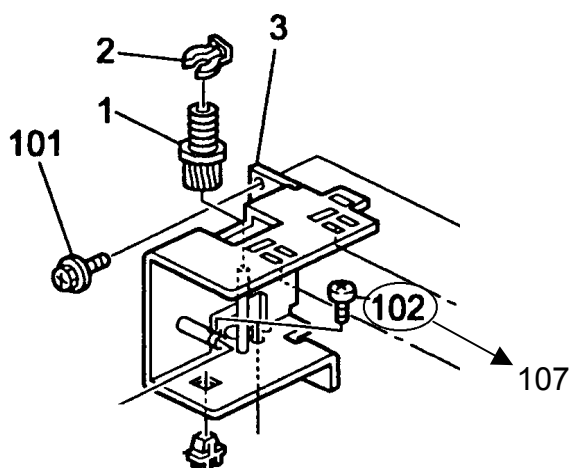

B. Parts Description - Add

The corresponding part for the above call-out was also not listed, so please add the description as follows:

Part number	Description	Q'ty	Page	Index	Note
08000072	Philips Pan Head Screw – M2.6 x 4	n	7	*107	*: New Index

Model: Model K-P1/P2 1 Bin Shift Sort Tray		Date: 11-Jun-02	No.: MG554002
Modified Article: Stepping Motor		Prepared by: A. Ishiyama	
From: Technical Services sec. Service Planning Dept.			
Reason for Modification:	<input type="checkbox"/> Parts catalog correction <input type="checkbox"/> To facilitate assembly <input checked="" type="checkbox"/> Part standardization	<input type="checkbox"/> Vendor change <input type="checkbox"/> To improve reliability <input type="checkbox"/> Other	<input type="checkbox"/> To meet standards ()
Modification Schedule:	From April '02 production		

The Stepping Motor has been changed so that the 1-Bin Sort Tray will be compatible with the next mainframe model, which will have a faster engine than the current product.

Old part number	New part number	Description	Q'ty	Int	Page	Index	Note
AX040201A	AX040103	Stepping Motor – 24V 65 ohm	1	*	7	20	

- * Interchangeability with current products (Model K-P1/P2):
- * Interchangeability with products following:

O/O
X/O

Note:

As shown above, 1-Bin Trays with the new motor can be used on both the current and next mainframe models, whereas Trays with the old motor can only be used on the current mainframe model.

To distinguish the Trays containing the old motor vs. those containing the new, a circular black sticker will be affixed to the box of the new Tray.

Reissued: 10-Sep-03

Model: Model K-P1/P2 1 Bin Shift Sort Tray Type 2600	Date: 3-Jul-03	No.: MG554003a
--	----------------	----------------

MB Correction

The items in bold italics have been corrected or added.

Modified Article: Parts Catalog Correction		Prepared by: A. Ishiyama	
From: 1st Technical Support Sec. Service Support Dept.			
Reason for Modification:	<input checked="" type="checkbox"/> Parts catalog correction	<input type="checkbox"/> Vendor change	<input type="checkbox"/> To meet standards ()
	<input type="checkbox"/> To facilitate assembly	<input type="checkbox"/> To improve reliability	
	<input type="checkbox"/> Part standardization	<input type="checkbox"/> Other	

The following have been added to the Parts Catalog for the above option, as they were found to be missing during catalog revisions in preparation for the K-P3 (G091) launch.

Note: The Parts Catalog will be re-released in July 2003 together with the K-P3 Service Manual, containing all recent revisions made.

Incorrect part number	Correct part number	Description	Q'ty	Int	Page	Index	Note
	16071129	Ferrite Core: 2643-625002	0→1		7	108	
	08050089	Retaining Ring – M4	0→1		7	109	
	03260220G 06230220G	Spring Pin 3x22	0→1		7	110	