

| | | | |
|---|---|--|--|
| Model: LCIT RT5030 (D452) | | Date: 21-Aug-09 | No.: RD452001 |
| Subject: Service Manual Correction: CIS Image Position Adjustment | | Prepared by: M. Abe | |
| From: PPMC Service Planning Department 1G | | | |
| Classification: | <input type="checkbox"/> Troubleshooting <input type="checkbox"/> Mechanical <input type="checkbox"/> Paper path <input type="checkbox"/> Product Safety | <input type="checkbox"/> Part information <input type="checkbox"/> Electrical <input type="checkbox"/> Transmit/receive <input type="checkbox"/> Other () | <input type="checkbox"/> Action required <input checked="" type="checkbox"/> Service manual revision <input type="checkbox"/> Retrofit information <input type="checkbox"/> Tier2 |

Please apply the following 2 corrections concerning the CIS Image Position Adjustment to your service manual.

Location of the Incorrect Description 1

Replacement and Adjustment > Adjustment > Adjusting Image Position Sensor Strength and Side-To-Side Registration; step 6

Incorrect Description 1

Do SP1909 -2 (CIS Image Position Adjustment: PWM After Adjustment - LCIT).

- If the displayed value is between **10 (Ah) and 40 (28h)**, the CIS is calibrated successfully. (The display is in hexadecimal code.)
- If the value is outside this range, do SP 1910 -2 and 1909 -2 again. If the value does not come between **20 and 40**, the CIS may be defective.

Correction

Do SP1909 -2 (CIS Image Position Adjustment: PWM After Adjustment - LCIT).

- If the displayed value is between **Ah (10) and 28h (40)**, the CIS is calibrated successfully. (The display is in hexadecimal code.)
- If the value is outside this range, do SP 1910 -2 and 1909 -2 again. If the value does not come between **Ah and 28h**, the CIS may be defective.

NOTE: Value is displayed in hexadecimal code on the operation panel. Values shown in brackets are decimal code for reference.

Model: LCIT RT5030 (D452)

Date: 21-Aug-09

No.: RD452001

Location of the Incorrect Description 2

Replacement and Adjustment > Adjustment > Adjusting Image Position Sensor Strength and Side-To-Side Registration; step 11

Incorrect Description 2

Exit from **SP 1911** and return to the SP mode menu.

Correction

Exit from **[User Tools] > [Adjust Settings for Operators]** and return to the SP mode menu.

| | | | |
|---|--|--|--|
| Model: LCIT RT5030 (D452) | | Date: 14-Dec-10 | No.: RD452002 |
| Subject: New P/N for Tray Indication Decals | | Prepared by: K. Tsutsui | |
| From: PP Service Planning Department 1G | | | |
| Classification: | <input type="checkbox"/> Troubleshooting | <input checked="" type="checkbox"/> Part information | <input type="checkbox"/> Action required |
| | <input type="checkbox"/> Mechanical | <input type="checkbox"/> Electrical | <input type="checkbox"/> Service manual revision |
| | <input type="checkbox"/> Paper path | <input type="checkbox"/> Transmit/receive | <input type="checkbox"/> Retrofit information |
| | <input type="checkbox"/> Product Safety | <input type="checkbox"/> Other () | <input type="checkbox"/> Tier2 |

Change: Three separate tray indication decals for trays 4, 5, & 6 have been combined.

Reason: To reduce production cost

| Old P/N | New P/N | Description | Q'ty | Int | Page | Index |
|----------|-------------------|----------------------|------|-----|------|-------|
| D4521312 | | DECAL:PAPER TRAY:4 | 1 | 0/0 | 2 | 23 |
| D4521313 | | DECAL:PAPER TRAY:5 | 1 | 0/0 | 2 | 24 |
| D4521314 | | DECAL:PAPER TRAY:6 | 1 | 0/0 | 2 | 25 |
| | ▶ D4521310 | DECAL:PAPER TRAY:LCT | 1 | 0/0 | 2 | 26 |

1.Exterior 1 (D452)

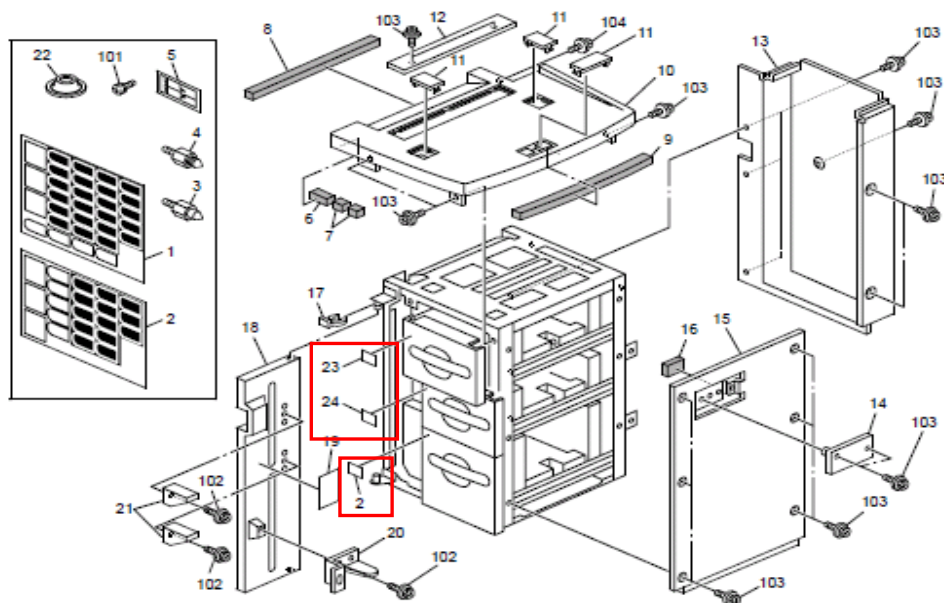

2

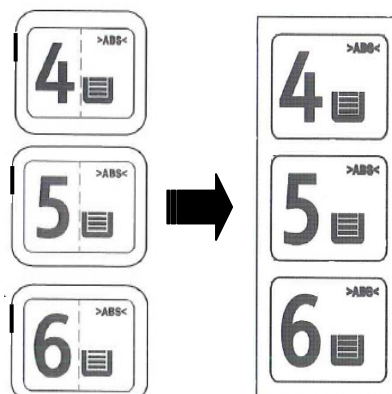

| | | | |
|--|---|--|--|
| Model: LCIT RT5030 (D452) | | Date: 23-Jan-12 | No.: RD452003 |
| Subject: Part Changes; Handle assembly and Shoe | | Prepared by: A. Takada | |
| From: PP Tech Service Dept., 1st PP Tech Service Sect. | | | |
| Classification: | <input type="checkbox"/> Troubleshooting <input type="checkbox"/> Mechanical <input type="checkbox"/> Paper path <input type="checkbox"/> Product Safety | <input checked="" type="checkbox"/> Part information <input type="checkbox"/> Electrical <input type="checkbox"/> Transmit/receive <input type="checkbox"/> Other () | <input type="checkbox"/> Action required <input type="checkbox"/> Service manual revision <input type="checkbox"/> Retrofit information <input type="checkbox"/> Tier 2 |

Change: Shape of the Handle assembly and Shoe

Reason: To enable usage of common parts with different products

Changed parts

A : Shoe: Handle: Release

Shape of the Shoe was partially modified.

B : Handle: Ass'y

Handle was also modified in accordance with the shape change of the Shoe.
(Shape of the plate was also modified.)

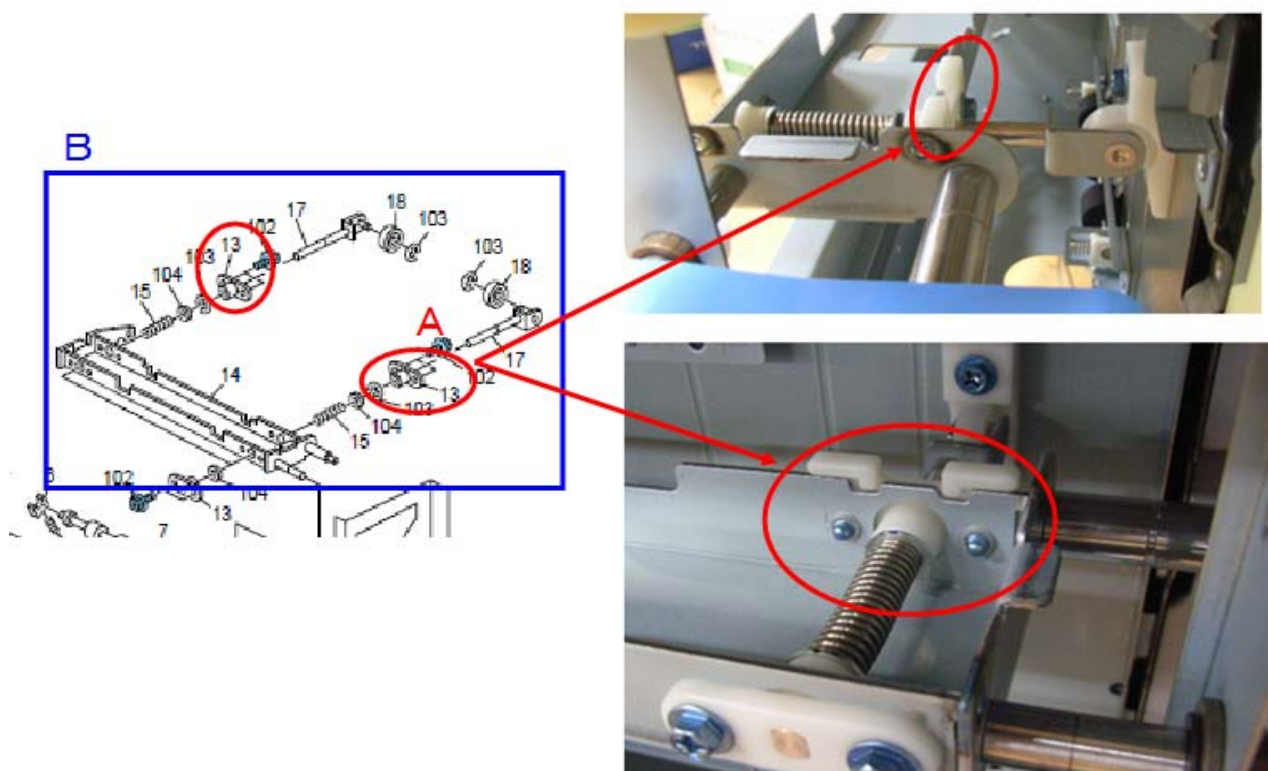

Model: LCIT RT5030 (D452)

Date: 23-Jan-12

No.: RD452003

Model: LCT RT5030 (D452)

| Old Part Number | New Part Number | Description | Q'ty | Int | Page | Index | Note |
|-----------------|-----------------|---------------------|------|-----|------|-------|------|
| D3553844 | D5163847 | Shoe:Handle:Release | 4 | X/O | 31 | 22 | - |

- The modification described in this bulletin also applies to LCT RT5040 (D453).

15.Paper Transfer 4 (D452)

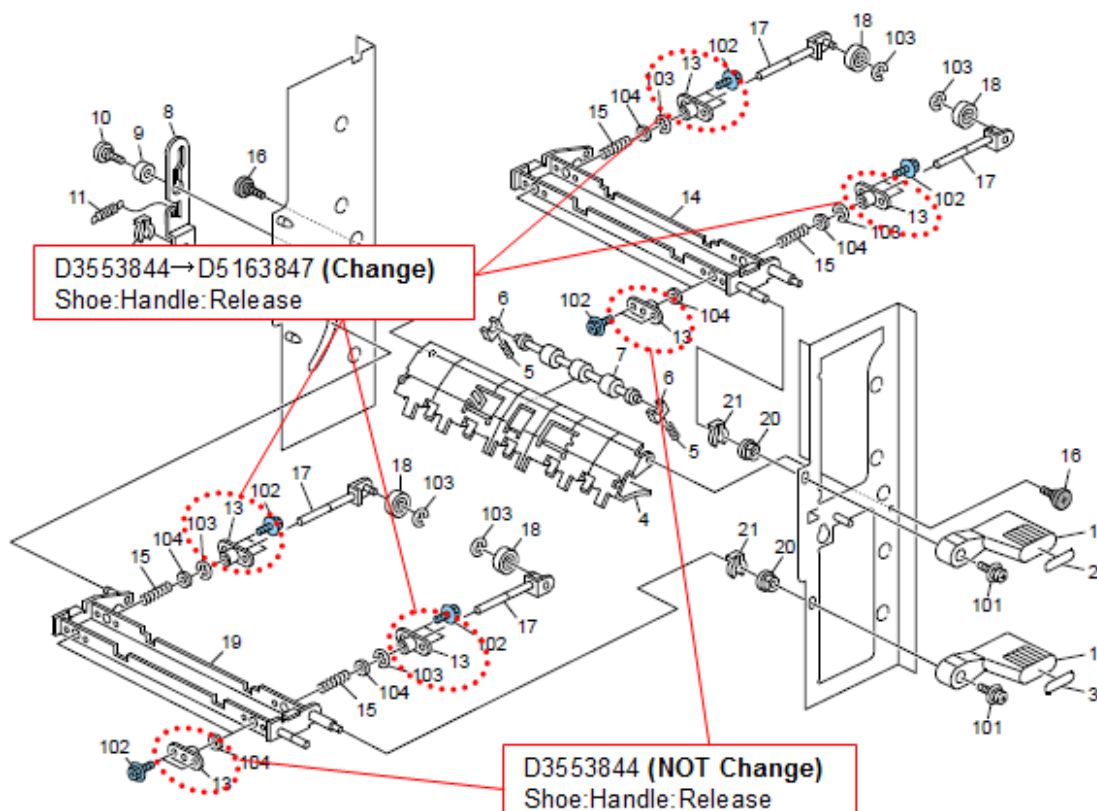

| | | | |
|--|---|--|--|
| Model: LCIT RT5030 (D452) | | Date: 11-May-12 | No.: RD452004 |
| Subject: Newly registered base plate | | Prepared by: A. Takada | |
| From: PP Tech Service Dept., 1st PP Tech Service Sect. | | | |
| Classification: | <input type="checkbox"/> Troubleshooting <input type="checkbox"/> Mechanical <input type="checkbox"/> Paper path <input type="checkbox"/> Product Safety | <input checked="" type="checkbox"/> Part information <input type="checkbox"/> Electrical <input type="checkbox"/> Transmit/receive <input type="checkbox"/> Other () | <input type="checkbox"/> Action required <input type="checkbox"/> Service manual revision <input type="checkbox"/> Retrofit information <input type="checkbox"/> Tier 2 |

Change: The Tray Base Plate was added as a service part.

Reason: To meet requests received from the field.

| Old Part Number | New Part Number | Description | Q'ty | Int | Page | Index | Note |
|-----------------|-----------------|---------------------------|------|-----|------|-------|------|
| - | B8322830 | RISING UNIT:TRAY:1K:ASS'Y | 1 | - | 16 | 26 | Add |

[Note]

The Ass'y consists of the following parts:

| P/N | Description | Page | Index | Q'ty |
|-----------|--------------------------------|------|-------|------|
| - | BASE:PAPER TRAY | - | - | 1 |
| A6672656 | Friction Pad 1 | 16 | 1 | 1 |
| B5112439 | Bracket : Paper Tray : Front 1 | 16 | 3 | 1 |
| B5112438 | Bracket : Paper Tray : Rear 1 | 16 | 4 | 1 |
| B5112737 | Weight Plate | 16 | 5 | 1 |
| 04504014N | Tapping Screw:4x14 | 16 | 101 | 6 |

8.Tray 6 Unit 3 (D452)

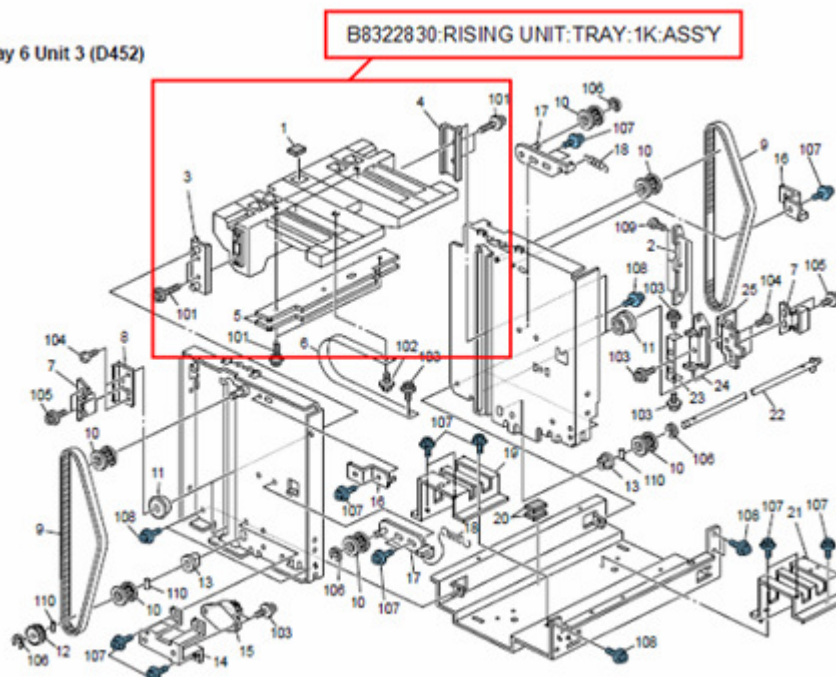

Replacement procedure

1. Pull out and remove the tray by referring to the procedure in the service manual.



2. Remove the Tray Front Cover. (Screw x4)

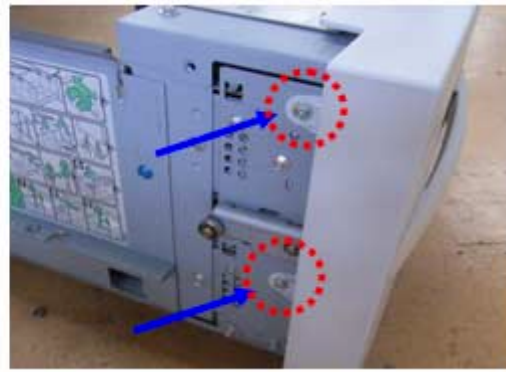

3. Remove the Handle Unit. (Screw x4)

IMPORTANT

The screws fixing the Handle Unit also adjust the side-to-side registration. If the screws are in a specific position, note that position and make sure the screws are fastened in the same position when reassembling the unit.

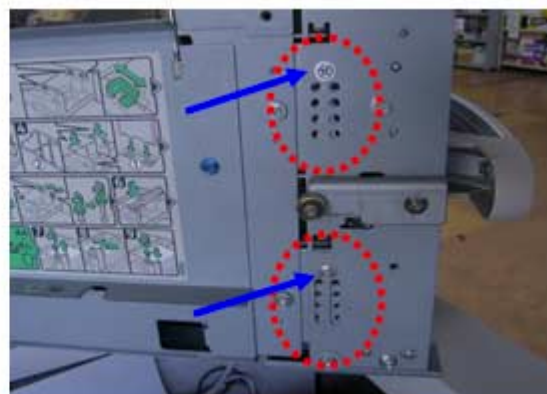

Model: LCIT RT5030 (D452)

Date: 11-May-12

No.: RD452004

4. Remove the Cover Tray and the Grip Paper Tray Unit.



5. Remove the Stay (bottom).

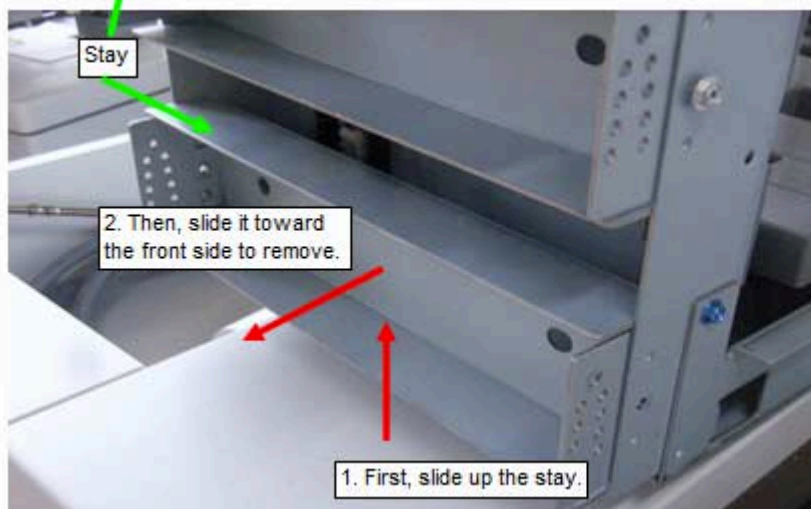
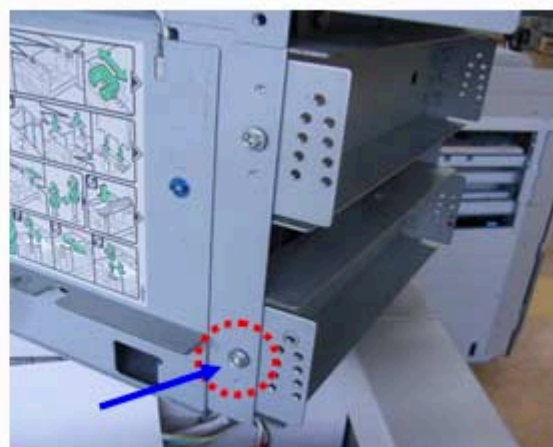
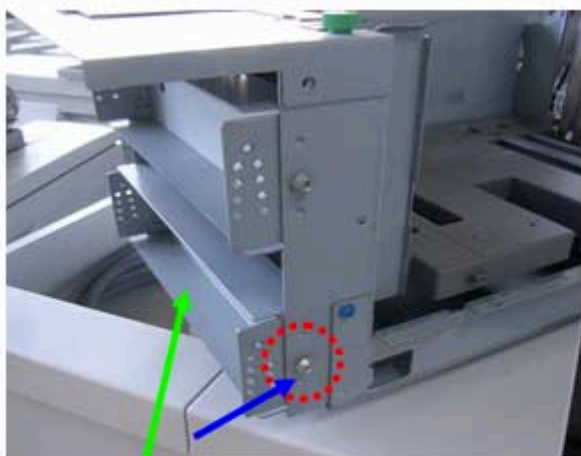

Model: LCIT RT5030 (D452)

Date: 11-May-12

No.: RD452004

6. Remove the Base Plate Fixing Screws (x4) and the Bushings (x4).

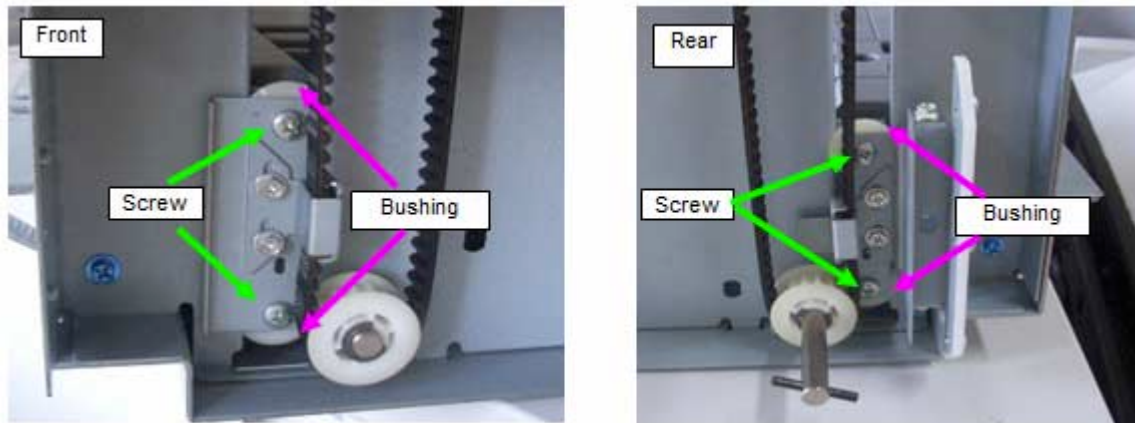

7. Remove the Base Plate.

NOTE: For the Bottom Tray 6, also remove the Stopper Belt.

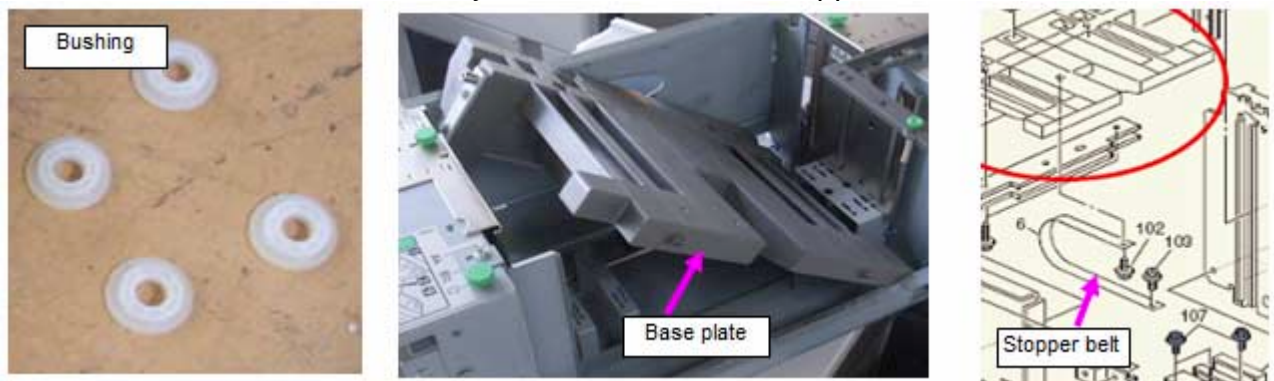

8. Replace with the new Base Plate (B8322830 RISING UNIT:TRAY:1K:ASS'Y).

NOTE 1: Make sure the Base Plate is positioned to the lowest position.

NOTE 2: For the Bottom Tray 6, work carefully to prevent the Stopper Belt from twisting.

9. To check if the Base Plate is level, lift up the Base Plate with your hands to the highest position so that the surface aligns with the top edge of the guide plate (+/- 1mm).

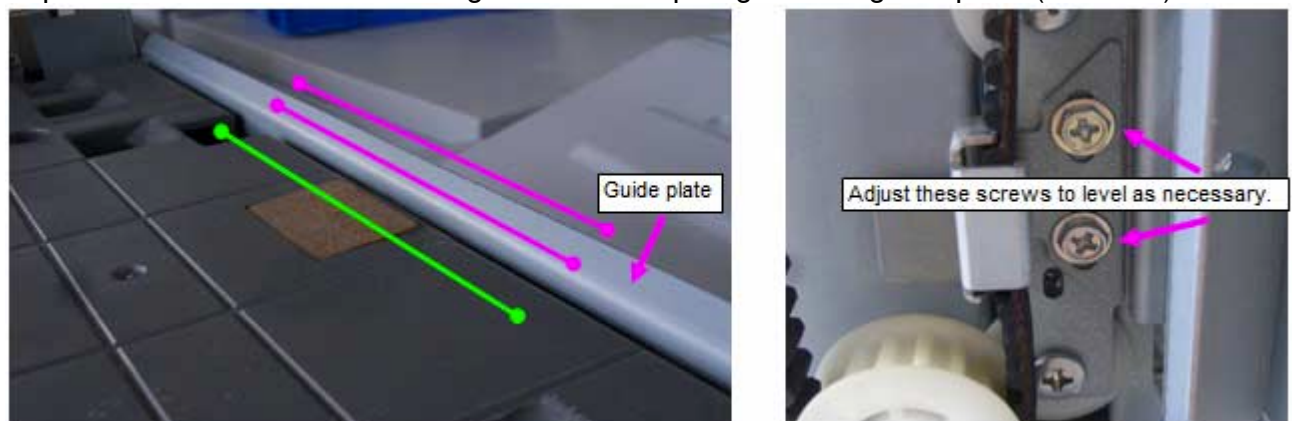

10. Follow the steps in reverse order to complete the procedure.

| | | | |
|---|--|---|---|
| Model: LCIT RT4000 (D350) / RT5040 (D453) / RT5060 (D516) / RT5030 (D452) | | Date: 2-Jul-13 | No.: RD453008 |
| Subject: Broken Casters on LCIT | | Prepared by: S. Sasaki | |
| From: 1 st PP Tech Service Sec., PP Tech Service Dept. | | | |
| Classification: | <input checked="" type="checkbox"/> Troubleshooting <input type="checkbox"/> Mechanical <input type="checkbox"/> Paper path <input type="checkbox"/> Product Safety | <input type="checkbox"/> Part information <input type="checkbox"/> Electrical <input type="checkbox"/> Transmit/receive <input type="checkbox"/> Other () | <input type="checkbox"/> Action required <input type="checkbox"/> Service manual revision <input type="checkbox"/> Retrofit information <input type="checkbox"/> Tier2 |

Symptom

Broken caster on the following LCITs:

RT4000 (D350), RT5040 (D453), RT5060 (D516), RT5030 (D452)



Cause

One lot of casters was manufactured with an incorrect molding process, resulting in lower durability.

Occurrence Rate

Extremely Low

Among 118 affected casters, 2.8% (= approx 3 pcs) may break according to factory test results.

Action

Replace the caster (p/n: AH012050) when a unit with a broken caster is found.
See the following page for the replacement procedure.

| | | |
|---|----------------|---------------|
| Model: LCIT RT4000 (D350) / RT5040 (D453) / RT5060 (D516) / RT5030 (D452) | Date: 2-Jul-13 | No.: RD453008 |
|---|----------------|---------------|

Caster Replacement Procedure

IMPORTANT: 3 persons are required to secure working safety.

1. Remove all trays from the LCT. See the following section of the field service manual.
LCIT RT5040, LCIT RT5060

1. Replacement and Adjustment > Removing Trays

LCIT RT4000

1. Replacement and Adjustment > Common Procedures > Trays

LCIT RT5030

1. Replacement and adjustment > Trays

2. Lay the LCT down so that the side to which the mainframe docks faces up.

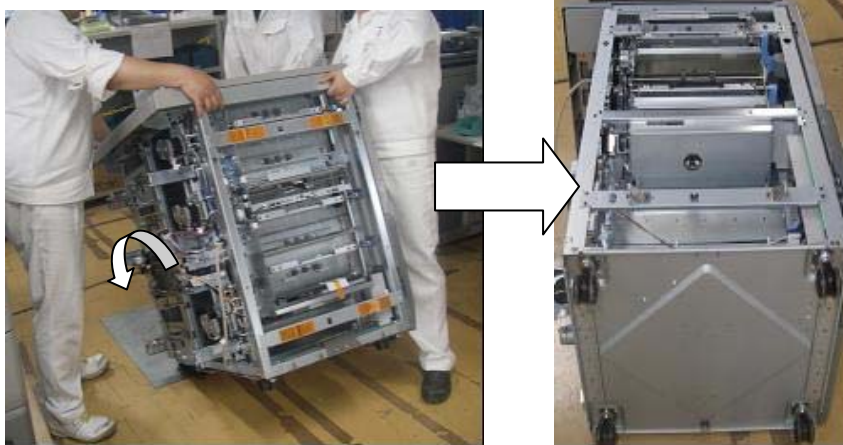

3. Replace the broken caster with a new one. (Screw x4)



4. Put the LCT back to its normal position.
5. Install the trays into the LCT to complete the procedure.

Model: LCIT RT4000 (D350) / RT5040 (D453) / RT5060
(D516) / RT5030 (D452)

Date: 2-Jul-13

No.: RD453008

Serial Numbers of the Possibly Affected Units

Units with the following serial numbers may have the affected casters.

LCIT RT5030

| NA | EU/AP |
|----------------------------|----------------------------|
| V5621100001 to V5621100160 | V5621100161 to V5621100175 |
| V5621200001 to V5621200051 | V5621100176 to V5621100197 |
| V5630100015 to V5630100160 | V5621200052 to V5621200085 |
| V5630200001 to V5630200073 | V5630100161 to V5630100172 |
| V5630300001 to V5630300083 | V5630200074 to V5630200113 |
| V5630300139 to V5630300147 | V5630300084 to V5630300123 |
| | V5630300124 to V5630300138 |

LCIT RT5040

| NA | EU/AP |
|----------------------------|----------------------------|
| V5721100001 to V5721100019 | V5721100020 to V5721100051 |
| V5721200001 to V5721200043 | V5721200044 to V5721200110 |
| V5730100001 to V5730100116 | V5730200032 to V5730200063 |
| V5730200001 to V5730200031 | V5730300051 to V5730300102 |
| V5730300001 to V5730300050 | |

LCIT RT5060

| NA | EU/AP |
|----------------------------|-------|
| W0121100001 to W0121100181 | None |
| W0121100182 to W0121100207 | |
| W0121200001 to W0121200224 | |
| W0130100001 to W0130100178 | |
| W0130200001 to W0130200043 | |
| W0130300001 to W0130300113 | |

LCIT RT4000

| NA | EU/AP |
|------|----------------------------|
| None | M8621200056 to M8621200065 |
| | M8630200007 to M8630200013 |
| | M8630300001 to M8630300004 |