

Model: Model AI-C1 LCIT RT3000		Date: 01-Apr-11	No.: RD353001
Subject: Part catalog correction		Prepared by: T.Hirakawa	
From: 1st Overseas Tech Support Sec., 1st PQM Dept.			
Classification:	<input type="checkbox"/> Troubleshooting <input type="checkbox"/> Mechanical <input type="checkbox"/> Paper path <input type="checkbox"/> Product Safety	<input checked="" type="checkbox"/> Part information <input type="checkbox"/> Electrical <input type="checkbox"/> Transmit/receive <input type="checkbox"/> Other ()	<input type="checkbox"/> Action required <input type="checkbox"/> Service manual revision <input type="checkbox"/> Retrofit information <input type="checkbox"/> Tier 2

Old part number	New part number	Description	Q'ty	Int	Page	Index	Note
D3535300	D3535310	INTERFACE CABLE:ASS'Y	1-1	X/O	9	7	-
11060289	-	Bushing - SR-5N-1	1-0	-	9	113	

Change: The "Bushing - SR-5N-1" was deleted as an individual service part and included in the "INTERFACE CABLE: ASS'Y".

Reason: This bushing cannot be replaced individually in the field.

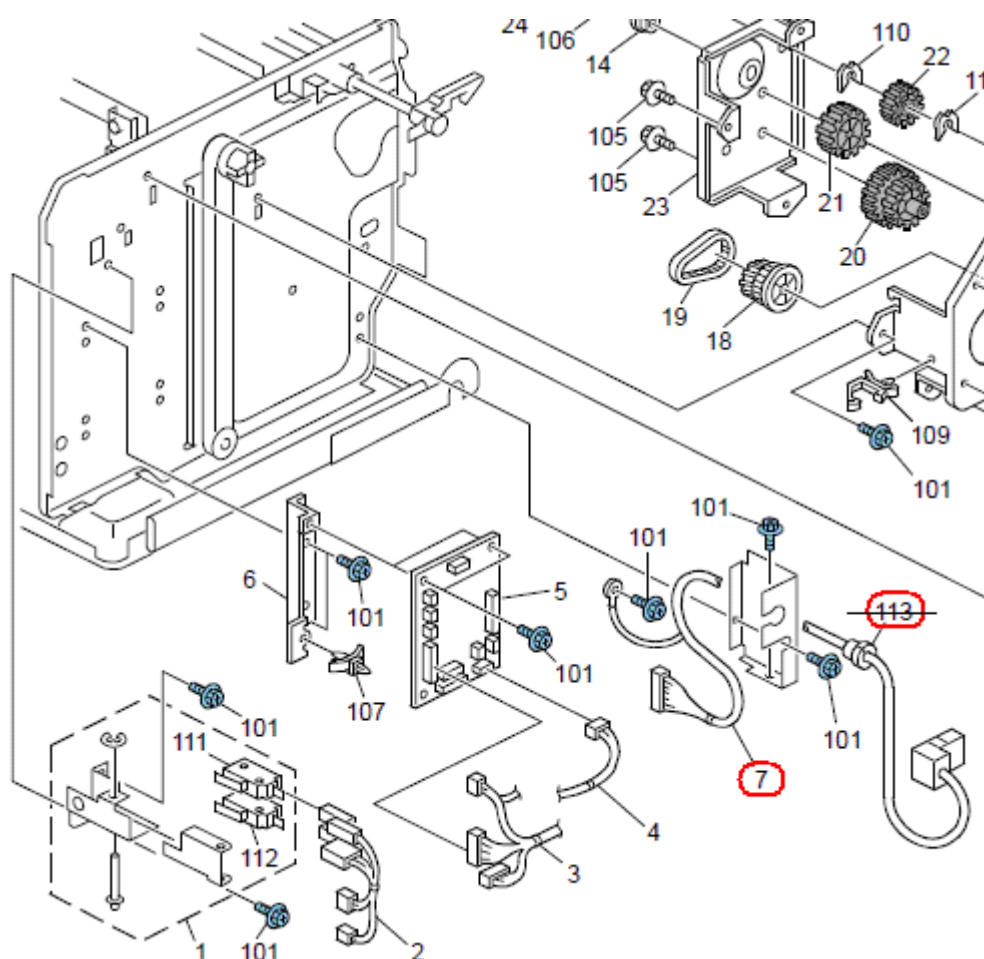

Model: RT3000		Date: 20-Dec-11	No.: RD353002
Subject: Protection plate for the front LCT set switch.		Prepared by: H. Tamaki	
From: 1st Tech Service Sect., MFP/P Tech Service Dept.			
Classification:	<input type="checkbox"/> Troubleshooting <input type="checkbox"/> Mechanical <input type="checkbox"/> Paper path <input type="checkbox"/> Product Safety	<input checked="" type="checkbox"/> Part information <input type="checkbox"/> Electrical <input type="checkbox"/> Transmit/receive <input type="checkbox"/> Other ()	<input type="checkbox"/> Action required <input type="checkbox"/> Service manual revision <input type="checkbox"/> Retrofit information <input type="checkbox"/> Tier 2

Old part number	New part number	Description	Q'ty	Int	Page	Index	Note
-	D5391255	PROTECTION:COUPLING:SWITCH	1	As a set	11	12	-
-	04543010Q	TAPPING SCREW:3X10	1		11	107	-

Change:

- 1) A protection plate was added to the front LCT set switch.
- 2) The length of the tapping screw was changed to attach the new protection plate.

Reason: To ensure that the push switch is not damaged when the LCT is set forcefully.

<Old>

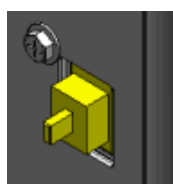

<New>

