

**Reissued: 18-Jul-08**

Model: Ring Binder RB5000	Date: 20-June -08	No.: RD392001a
---------------------------	-------------------	----------------

Subject: Firmware Release Note: Ring Binder_B1		Prepared by: T.Tadokoro	
From: PPBG QA/Service Planning Dept.			
Classification:	<input type="checkbox"/> Troubleshooting <input type="checkbox"/> Mechanical <input type="checkbox"/> Paper path <input checked="" type="checkbox"/> Other (      )	<input type="checkbox"/> Part information <input type="checkbox"/> Electrical <input type="checkbox"/> Transmit/receive	<input type="checkbox"/> Action required <input type="checkbox"/> Service manual revision <input type="checkbox"/> Retrofit information

This RTB has been issued to announce the firmware release information for the **Ring Binder\_B1**.

Version	Program No.	Effective Date
<b>01.060 :01</b>	<b>D3925510A</b>	<b>July 2008 production</b>
01.050 :01	D3925510	1st Mass production.

Version	Modified Points or Symptom Corrected
<b>01.060:01</b>	<b>Symptom Corrected:</b> <b>1. When the Binder Unit is replaced, while the Door Switch is forced ON, the temperature fuse blows.</b> <b>2. The temperature fuse blows if a communication error is experienced between downstream peripheral devices (positioned after the Ring Binder) when a System Reset command has been issued from the mainframe.</b>
01.050:01	1st Mass production.

Reissued: 12-Feb-09

Model: Ring Binder RB5000	Date: 20-June -08	No.: RD392002a
---------------------------	-------------------	----------------

RTB Reissue

The items in bold italics have been corrected.

Subject: Firmware Release Note: Ring Binder_B2		Prepared by: T.Tadokoro	
From: PPBG QA/Service Planning Dept.			
Classification:	<input type="checkbox"/> Troubleshooting <input type="checkbox"/> Mechanical <input type="checkbox"/> Paper path <input checked="" type="checkbox"/> Other (      )	<input type="checkbox"/> Part information <input type="checkbox"/> Electrical <input type="checkbox"/> Transmit/receive	<input type="checkbox"/> Action required <input type="checkbox"/> Service manual revision <input type="checkbox"/> Retrofit information

This RTB has been issued to announce the firmware release information for the **Ring Binder\_B2**.

Version	Program No.	Effective Date
<b>01.050:01</b>	<b>D3925520B</b>	<b>February 2009 production</b>
01.000:01	D3925520	1st Mass production.

Version	Modified Points or Symptom Corrected
<b>01.050:01</b>	<p><b>Symptom Corrected:</b></p> <p>(1) <b>Correct information on parts number and software version is not transmitted to the main frame in configuration of Venus-C2+Ring Binder.</b></p> <p>(2) <b>Reboot function does not operate when ATN is received from an upstream peripheral devices after its connection has been made.</b></p> <p>(3) <b>Jam occurs when punching a few sheets (1-3 sheets) with big curls in punch mode.</b></p> <p><b>=NOTE=</b></p> <p><b>·Please update both main board and sub board concurrently as they function in combination.</b></p> <p><b>Ring Binder_B1:D3925510C:Ver01.270:04</b></p> <p><b>Ring Binder_B2:D3925520B:Ver01.050:01</b></p> <p><b>·Please update version when connecting Bellini-C4, Aegis-P1/C1 or Venus-C2.</b></p>
01.000:01	1st Mass production.

**Reissued: 10-Feb-09**

Model: Ring Binder RB5000	Date: 20-June -08	No.: RD392001b
---------------------------	-------------------	----------------

Subject: Firmware Release Note: Ring Binder_B1		Prepared by: T.Tadokoro	
From: PPBG QA/Service Planning Dept.			
Classification:	<input type="checkbox"/> Troubleshooting <input type="checkbox"/> Mechanical <input type="checkbox"/> Paper path <input checked="" type="checkbox"/> Other (      )	<input type="checkbox"/> Part information <input type="checkbox"/> Electrical <input type="checkbox"/> Transmit/receive	<input type="checkbox"/> Action required <input type="checkbox"/> Service manual revision <input type="checkbox"/> Retrofit information

This RTB has been issued to announce the firmware release information for the **Ring Binder\_B1**.

Version	Program No.	Effective Date
<b>01.270:04</b>	<b>D3925510C</b>	<b>January 2009 production</b>
01.060 :01	D3925510A	July 2008 production
01.050 :01	D3925510	1st Mass production.

Version	Modified Points or Symptom Corrected
<b>01.270:04</b>	<p><b>Symptom Corrected:</b></p> <ol style="list-style-type: none"> <li>(1) <b>JAM indication appears when the power switch is turned on when punch unit has been removed.</b></li> <li>(2) <b>Correct information on parts number and software version is not transmitted to the main frame in the configuration of Venus-C2+Ring Binder.</b></li> <li>(3) <b>Holds a WAIT status when release of energy saving is executed during non-energy saving mode.</b></li> <li>(4) <b>Command cannot be sent from Ring Binder to mainframe when ACK transmission interposes during a command transmission.</b></li> <li>(5) <b>Reboot function does not operate when ATN is received from an upstream peripheral device after its connection has been made.</b></li> <li>(6) <b>Book binding function does not operate when malfunction in network is found in the downstream peripheral devices.</b></li> <li>(7) <b>Jam occurs when punching a few sheets (1-3 sheets) with big curls in punch mode.</b></li> </ol> <p><b>Other changes:</b></p> <ol style="list-style-type: none"> <li>(1) <b>Support in low linear speed action (for Venus-C2)</b></li> <li>(2) <b>Change in linear speed acceleration point (for Aegis-C1/P1) Acceleration point has been shifted 10mm towards downstream peripheral devices.</b></li> </ol> <p><b>=NOTE=</b></p> <p><b>· Please update both main board and sub board concurrently as they function in combination.</b></p> <p><b>Ring Binder_B1:D3925510C:Ver01.270:04</b>  <b>Ring Binder_B2:D3925520B:Ver01.050:01</b></p>

**Reissued: 10-Feb-09**

Model: Ring Binder RB5000	Date: 20-June -08	No.: RD392001b
---------------------------	-------------------	----------------

Version	Modified Points or Symptom Corrected
	<b>· Please update your version when connecting Bellini-C4, Aegis-P1/C1 or Venus-C2.</b>
01.060:01	Symptom Corrected: 1. When the Binder Unit is replaced, while the Door Switch is forced ON, the temperature fuse blows. 2. The temperature fuse blows if a communication error is experienced between downstream peripheral devices (positioned after the Ring Binder), when a System Reset command has been issued from the mainframe.
01.050:01	1st Mass production.

**Reissued: 19-Mar-09**

Model: Ring Binder RB5000	Date: 20-June -08	No.: RD392001c
---------------------------	-------------------	----------------

Subject: Firmware Release Note: Ring Binder_B1		Prepared by: T.Tadokoro	
From: PPBG QA/Service Planning Dept.			
Classification:	<input type="checkbox"/> Troubleshooting <input type="checkbox"/> Mechanical <input type="checkbox"/> Paper path <input checked="" type="checkbox"/> Other (      )	<input type="checkbox"/> Part information <input type="checkbox"/> Electrical <input type="checkbox"/> Transmit/receive	<input type="checkbox"/> Action required <input type="checkbox"/> Service manual revision <input type="checkbox"/> Retrofit information

This RTB has been issued to announce the firmware release information for the **Ring Binder\_B1**.

Version	Program No.	Effective Date
<b>01.280:04</b>	<b>D3925510D</b>	<b>April 2009 production</b>
01.270:04	D3925510C	January 2009 production
01.060 :01	D3925510A	July 2008 production
01.050 :01	D3925510	1st Mass production.

Version	Modified Points or Symptom Corrected
<b>01.280:04</b>	<p><b>Symptom Corrected:</b>  <i>On occasion of a jam occurrence on a machine downstream to the Ring Binder during a staple operation, even when the jammed paper is removed, the mainframe does not recover its operation.</i></p> <p><b>=NOTE=</b>  <i>When updating RingBinder_B1 to D3925510D (Ver01.280:04), please apply D3925520B (Ver01.050:01) onward for Ring_Binder_B2.</i></p> <p><i>When operating Ring Binder with the Aegis-C1/P1, please apply D3925510D (Ver01.280:04) onward for RingBinder_B1, and D3925520B (Ver01.050:01) onward for RingBinder_B2.</i></p>
01.270:04	<p>Symptom Corrected:</p> <ol style="list-style-type: none"> <li>(1) JAM indication appears when power switch is turned on under the condition of punch unit having been removed.</li> <li>(2) Correct information on parts number and software version is not transmitted to the main frame in configuration of Venus-C2+Ring Binder.</li> <li>(3) Holds a WAIT status when release of energy saving is executed during non-energy saving mode.</li> <li>(4) Command cannot be sent from Ring Binder to mainframe when ACK transmission interposes during a command transmission.</li> <li>(5) Reboot function does not operate when ATN is received from an upstream peripheral devices after its connection has been made.</li> <li>(6) Book binding function does not operate when malfunction in network is found in the downstream peripheral devices.</li> <li>(7) Jam occurs when punching a few sheets (1-3 sheets) with big curls in punch mode.</li> </ol>

**Reissued: 19-Mar-09**

Model: Ring Binder RB5000		Date: 20-June -08	No.: RD392001c
Version	Modified Points or Symptom Corrected		
	<p>Other changes:</p> <p>(1) Support in low linear speed action (for Venus-C2)</p> <p>(2) Change in linear speed acceleration point (for Aegis-C1/P1) Acceleration point has been shifted 10mm towards downstream peripheral devices.</p> <p>=NOTE=</p> <p>- Please update both main board and sub board concurrently as they function in combination.</p> <p>Ring Binder_B1:D3925510C:Ver01.270:04</p> <p>Ring Binder_B2:D3925520B:Ver01.050:01</p> <p>- Please update your version when connecting Bellini-C4, Aegis-P1/C1 or Venus-C2.</p>		
01.060:01	<p>Symptom Corrected:</p> <ol style="list-style-type: none"><li>1. When the Binder Unit is replaced, while the Door Switch is forced ON, the temperature fuse blows.</li><li>2. The temperature fuse blows if a communication error is experienced between downstream peripheral devices (positioned after the Ring Binder), when a System Reset command has been issued from the mainframe.</li></ol>		
01.050:01	1st Mass production.		

**Reissued: 23-Apr-09**

Model: Ring Binder RB5000	Date: 20-June -08	No.: RD392002b
---------------------------	-------------------	----------------

**RTB Reissue**

The items in bold italics have been corrected.

Subject: Firmware Release Note: Ring Binder_B2		Prepared by: T.Tadokoro	
From: PPBG QA/Service Planning Dept.			
Classification:	<input type="checkbox"/> Troubleshooting	<input type="checkbox"/> Part information	<input type="checkbox"/> Action required
	<input type="checkbox"/> Mechanical	<input type="checkbox"/> Electrical	<input type="checkbox"/> Service manual revision
	<input type="checkbox"/> Paper path	<input type="checkbox"/> Transmit/receive	<input type="checkbox"/> Retrofit information
	<input checked="" type="checkbox"/> Other (       )		

This RTB has been issued to announce the firmware release information for the **Ring Binder\_B2**.

Version	Program No.	Effective Date
<b>01.060:01</b>	<b>D3925520C</b>	<b>April 2009 production</b>
01.050:01	D3925520B	February 2009 production
01.000:01	D3925520	1st Mass production.

Version	Modified Points or Symptom Corrected
<b>01.060:01</b>	<p><b>Symptom corrected:</b></p> <ul style="list-style-type: none"> <li>· <b>Occurrence of JAM262 when output to the Ring Binder in a low temperature environment.</b></li> </ul> <p><b>&lt;NOTE&gt;</b>  <b>When using the Ring Binder with the Venus-C2, please ensure the following:</b>  <b>RingBinder_B1 must be D3925510D (ver 01.280:04) or later,</b>  <b>RingBinder_B2 must be D3925520C (ver 01.060:01) or later.</b></p>
01.050:01	<p>Symptom Corrected:</p> <ol style="list-style-type: none"> <li>(1) Correct information on parts number and software version is not transmitted to the main frame in configuration of Venus-C2+Ring Binder.</li> <li>(2) Reboot function does not operate when ATN is received from an upstream peripheral devices after its connection has been made.</li> <li>(3) Jam occurs when punching a few sheets (1-3 sheets) with big curls in punch mode.</li> </ol> <p>=NOTE=          · Please update both main board and sub board concurrently as they function in combination.          Ring Binder_B1:D3925510C:Ver01.270:04          Ring Binder_B2:D3925520B:Ver01.050:01          · Please update version when connecting Bellini-C4, Aegis-P1/C1 or Venus-C2.</p>
01.000:01	1st Mass production.

**Reissued: 23-Apr-09**

Model: Ring Binder RB5000	Date: 20-June -08	No.: RD392002b
---------------------------	-------------------	----------------



**Reissued:9-Jun-09**

Model: Model: Ring Binder RB5000		Date: 8-Jun-09	No.: RD392003a
Subject: Bracket:Coupling:Main:Ass'y		Prepared by: Nobuo iida	
From: PPBG QA/Service Planning Dept.			
Classification:	<input type="checkbox"/> Troubleshooting <input type="checkbox"/> Mechanical <input type="checkbox"/> Paper path <input type="checkbox"/> Product Safety	<input checked="" type="checkbox"/> Part information <input type="checkbox"/> Electrical <input type="checkbox"/> Transmit/receive <input type="checkbox"/> Other (     )	<input type="checkbox"/> Action required <input type="checkbox"/> Service manual revision <input type="checkbox"/> Retrofit information <input type="checkbox"/> Tier 2

## RTB Reissue

The items in ***bold italics*** were corrected or added.

Old part number	New part number	Description	Q'ty	Int	Page	Index	Note
D4341471	D4341476	Bracket:Coupling:Main:Ass'y	1	X/O	3	16	

Change: Shape of the Bracket:Coupling:Main:Ass'y

Reason: To enable direct installation of the Ring Binder onto the Aegis mainframe

## Background & Purpose of Change

The docking bracket included in the Ring Binder package is applied to install the Ring Binder directly onto the Aegis mainframe, but the device could not be installed due to interference with the Decurler Unit. The shape of this bracket has been changed as shown below to resolve this problem. The modified bracket is included in the Ring Binder package from November 2008 production.

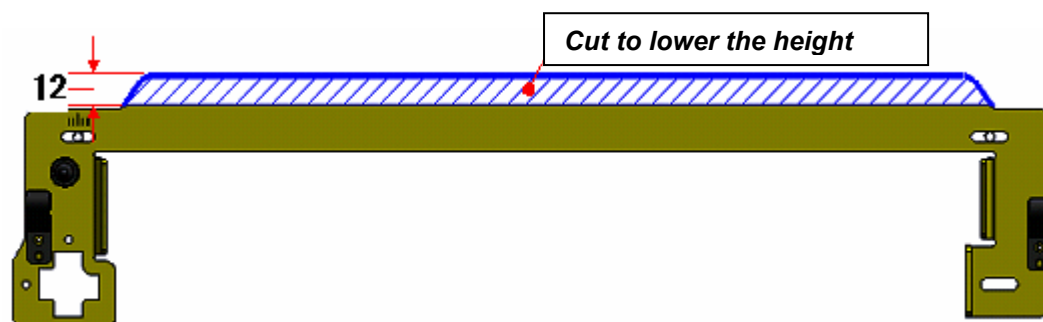

## Request

When installing the Ring Binder directly onto the Aegis mainframe, please install a Ring Binder of production after November 2008.

If you must use a Ring Binder that does not have this modification, please procure the modified docking bracket "D4341476" to enable installation.

**Reissued:9-Jun-09**

Model: Model: Ring Binder RB5000	Date: 8-Jun-09	No.: RD392003a
----------------------------------	----------------	----------------

<i>MODEL NAME</i>	<i>V/Hz</i>	<i>DESTINATION</i>	<i>CODE</i>	<i>SERIAL NUMBER</i>
<i>Ring Binder RB5000</i>	<i>120 - 240V, 50/60Hz</i>	<i>NA/EU</i>	<i>D392-17/27</i>	<i>V0290400001</i>

Model: Ring Binder RB5000		Date: 23-Jun-09	No.: RD392004
Subject: GUIDE PLATE:CONNECTING:ASS'Y		Prepared by: T.Tadokoro	
From: PPBG QA/Service Planning Dept.			
Classification:	<input type="checkbox"/> Troubleshooting <input type="checkbox"/> Mechanical <input type="checkbox"/> Paper path <input type="checkbox"/> Product Safety	<input checked="" type="checkbox"/> Part information <input type="checkbox"/> Electrical <input type="checkbox"/> Transmit/receive <input type="checkbox"/> Other (     )	<input type="checkbox"/> Action required <input type="checkbox"/> Service manual revision <input type="checkbox"/> Retrofit information <input type="checkbox"/> Tier 2

The following parts have been added to support the Venus-C2.

New part number	Description	Q'ty	Int	Page	Index	Note
B4082191	GUIDE PLATE:CONNECTING:LOWER	1	-	2	24	Add
B4682196	GUIDE PLATE:CONNECTING:UPPER	1	-	2	25	Add
08025276	TAPPING SCREW:ROUND POINT:M3X6	2	-	2	26	Add
B468T021	GUIDE PLATE:CONNECTING:ASS'Y	1	-	2	27	Add

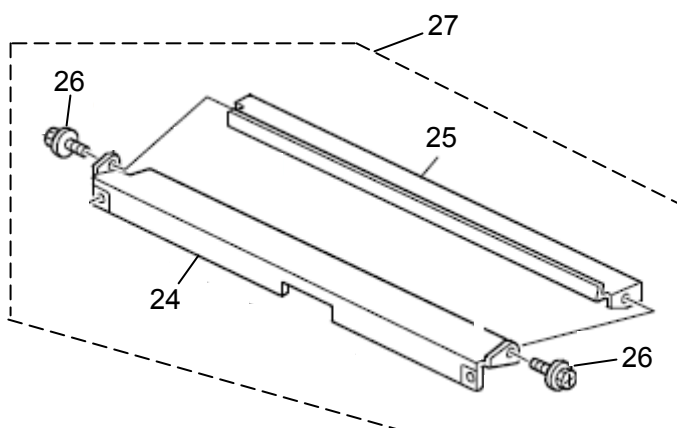

**Reissued: 30-Jul-09**

Model: Ring Binder RB5000	Date: 20-June -08	No.: RD392001d
---------------------------	-------------------	----------------

Subject: Firmware Release Note: Ring Binder_B1		Prepared by: T.Tadokoro	
From: PPBG QA/Service Planning Dept.			
Classification:	<input type="checkbox"/> Troubleshooting <input type="checkbox"/> Mechanical <input type="checkbox"/> Paper path <input checked="" type="checkbox"/> Other (      )	<input type="checkbox"/> Part information <input type="checkbox"/> Electrical <input type="checkbox"/> Transmit/receive	<input type="checkbox"/> Action required <input type="checkbox"/> Service manual revision <input type="checkbox"/> Retrofit information

This RTB has been issued to announce the firmware release information for the **Ring Binder\_B1**.

Version	Program No.	Effective Date
<b>01.290:04</b>	<b>D3925510E</b>	<b>August 2009 production</b>
01.280:04	D3925510D	April 2009 production
01.270:04	D3925510C	January 2009 production
01.060 :01	D3925510A	July 2008 production
01.050 :01	D3925510	1st Mass production.

Version	Modified Points or Symptom Corrected
<b>01.290:04</b>	<p><b>Symptom Corrected:</b>  <b>SC990 caused by data suspended in the Ring Binder, unable to transfer to both upstream and downstream peripherals.</b></p> <p><b>=NOTE=</b>  <b>• Please upgrade the main and sub boards concurrently as they work in a set.</b>  <b>Ring Binder_B1 : D3925510E : Ver01.290:04</b>  <b>Ring Binder_B2 : D3925520C : Ver01.060:01</b></p>
01.280:04	<p>Symptom Corrected:  On occasion of a jam occurrence on a machine downstream to the Ring Binder during a staple operation, even when the jammed paper is removed, the mainframe does not recover its operation.</p> <p><b>=NOTE=</b>  When updating RingBinder_B1 to D3925510D (Ver01.280:04), please apply D3925520B (Ver01.050:01) onward for Ring_Binder_B2.</p> <p>When operating Ring Binder with the Aegis-C1/P1, please apply D3925510D (Ver01.280:04) onward for RingBinder_B1, and D3925520B (Ver01.050:01) onward for RingBinder_B2.</p>
01.270:04	<p>Symptom Corrected:</p> <ol style="list-style-type: none"> <li>(1) JAM indication appears when power switch is turned on under the condition of punch unit having been removed.</li> <li>(2) Correct information on parts number and software version is not transmitted to the main frame in configuration of Venus-C2+Ring Binder.</li> </ol>

**Reissued: 30-Jul-09**

Model: Ring Binder RB5000	Date: 20-June -08	No.: RD392001d
---------------------------	-------------------	----------------

Version	Modified Points or Symptom Corrected
	<p>(3) Holds a WAIT status when release of energy saving is executed during non-energy saving mode.</p> <p>(4) Command cannot be sent from Ring Binder to mainframe when ACK transmission interposes during a command transmission.</p> <p>(5) Reboot function does not operate when ATN is received from an upstream peripheral devices after its connection has been made.</p> <p>(6) Book binding function does not operate when malfunction in network is found in the downstream peripheral devices.</p> <p>(7) Jam occurs when punching a few sheets (1-3 sheets) with big curls in punch mode.</p> <p>Other changes:</p> <p>(1) Support in low linear speed action (for Venus-C2)</p> <p>(2) Change in linear speed acceleration point (for Aegis-C1/P1) Acceleration point has been shifted 10mm towards downstream peripheral devices.</p> <p>=NOTE= - Please update both main board and sub board concurrently as they function in combination. Ring Binder_B1:D3925510C:Ver01.270:04 Ring Binder_B2:D3925520B:Ver01.050:01 - Please update your version when connecting Bellini-C4, Aegis-P1/C1 or Venus-C2.</p>
01.060:01	<p>Symptom Corrected:</p> <ol style="list-style-type: none"> <li>When the Binder Unit is replaced, while the Door Switch is forced ON, the temperature fuse blows.</li> <li>The temperature fuse blows if a communication error is experienced between downstream peripheral devices (positioned after the Ring Binder), when a System Reset command has been issued from the mainframe.</li> </ol>
01.050:01	1st Mass production.

Model: Ring Binder RB5000(D392)		Date: 17-Aug-09	No.: RD392005
Subject: Service manual revision: SP6504 adjustment		Prepared by: K.Tsutsui	
From: PPMC Service Planning Department 1G			
Classification:	<input type="checkbox"/> Troubleshooting <input type="checkbox"/> Mechanical <input type="checkbox"/> Paper path <input type="checkbox"/> Product Safety	<input type="checkbox"/> Part information <input type="checkbox"/> Electrical <input type="checkbox"/> Transmit/receive <input type="checkbox"/> Other (     )	<input type="checkbox"/> Action required <input checked="" type="checkbox"/> Service manual revision <input type="checkbox"/> Retrofit information <input type="checkbox"/> Tier2

The following description has been added to the service manual. Please apply this change accordingly in the field.

## Newly Added Description

When adjusting SP6504, close the front door of the Ring Binder.

After the adjustment, keep the front door of the Ring Binder closed and turn the main power switch OFF and ON.

## Added to Sections

- a. Replacement and Adjustment > Common Procedure > SP6504 Adjustment.
- b. Replacement and Adjustment > Boards > Main Control Board.

Model: Ring Binder RB5000		Date: 12-Nov-09	No.: RD392006
Subject: CASTER:BWP-50N:MB10506		Prepared by: T.Tadokoro	
From: PPBG Service Planning Dept.			
Classification:	<input type="checkbox"/> Troubleshooting <input type="checkbox"/> Mechanical <input type="checkbox"/> Paper path <input type="checkbox"/> Product Safety	<input checked="" type="checkbox"/> Part information <input type="checkbox"/> Electrical <input type="checkbox"/> Transmit/receive <input type="checkbox"/> Other (     )	<input type="checkbox"/> Action required <input type="checkbox"/> Service manual revision <input type="checkbox"/> Retrofit information <input type="checkbox"/> Tier 2

The following 2 parts have been newly registered.

New part number	Description	Q'ty	Int	Page	Index	Note
D3921325	CASTER:BWP-50N:MB10506	4	-	57	22	Add
D3923164	PAN HEAD SCREW:M5X10:AA03513	12	-	57	23	Add

## 28.Frame Section (D392)

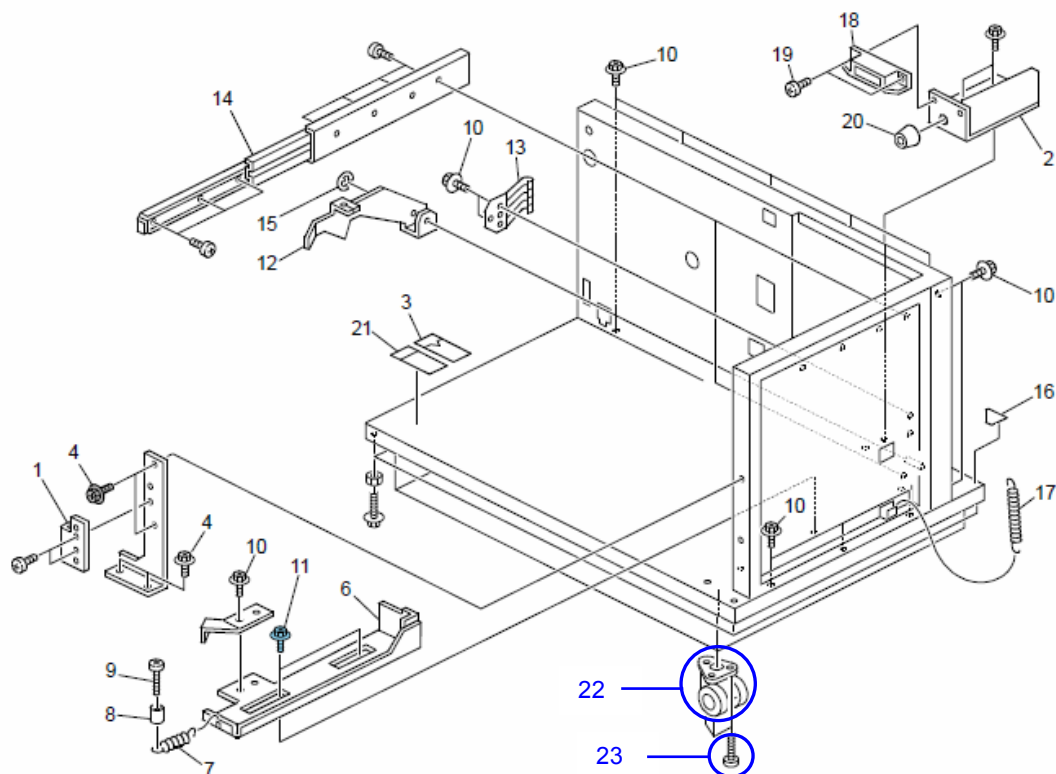

Model: Ring Binder RB5000(D392)		Date: 05-Mar-10	No.: RD392007
Subject: Do NOT use F/W Version "D3925510E"		Prepared by: K.Tsutsui	
From: PP Service Planning Department 1G			
Classification:	<input type="checkbox"/> Troubleshooting <input type="checkbox"/> Mechanical <input type="checkbox"/> Paper path <input type="checkbox"/> Product Safety	<input type="checkbox"/> Part information <input type="checkbox"/> Electrical <input type="checkbox"/> Transmit/receive <input checked="" type="checkbox"/> Other (     )	<input type="checkbox"/> Action required <input type="checkbox"/> Service manual revision <input type="checkbox"/> Retrofit information <input type="checkbox"/> Tier2

## Request

Please do NOT use the firmware version "RingBinder\_B1 D3925510E (01.290:04)".

## Symptom

Application of the above F/W version could result in a jam caused by malfunction of the motor located in the horizontal paper path (for downstream delivery and binding).

## Occurrence Rate

Very low

## S/N and Number of Affected Units Installed Originally with F/W Version RingBinder\_B1 D3925510E (01.290:04)

NA	V0290800001 - V0291200002	46 units
RE	V0290800009 - V0291100001	16 units

## Action

Please update the F/W to "RingBinder\_B1 D3925510F (01.300:04)" which will soon be uploaded on the Download Center.

For field machines, please update the F/W on your next service visit  
For initial installation, please update the F/W after installation.

For field machines registered with S/N other than the aforementioned; units originally installed with an older F/W version that have the possibility of having been updated to "D3925510E", please update the F/W on your next service visit.



**Reissued: 12-Mar-10**

Model: Ring Binder RB5000	Date: 20-June -08	No.: RD392001e
---------------------------	-------------------	----------------

Subject: Firmware Release Note: Ring Binder_B1		Prepared by: H. Kawamura	
From: PPBG Service Planning Dept.			
Classification:	<input type="checkbox"/> Troubleshooting <input type="checkbox"/> Mechanical <input type="checkbox"/> Paper path <input checked="" type="checkbox"/> Other (      )	<input type="checkbox"/> Part information <input type="checkbox"/> Electrical <input type="checkbox"/> Transmit/receive	<input type="checkbox"/> Action required <input type="checkbox"/> Service manual revision <input type="checkbox"/> Retrofit information

This RTB has been issued to announce the firmware release information for the **Ring Binder\_B1**.

Version	Program No.	Effective Date
<b>01.300:04</b>	<b>D3925510F</b>	<b>February 2010 production</b>
01.290:04	D3925510E	August 2009 production
01.280:04	D3925510D	April 2009 production
01.270:04	D3925510C	January 2009 production
01.060 :01	D3925510A	July 2008 production
01.050 :01	D3925510	1st Mass production

Version	Modified Points or Symptom Corrected
<b>01.300:04</b>	<b>Symptom Corrected:</b> <b>To prevent the failure of loss of synchronism of the paper exit motor when the Ring Binder _B1 transfers media to downstream peripherals.</b>  <b>=NOTE=</b> <b>For Ring Binder_B2, please use the firmware D3925520 or newer version</b>
01.290:04	Symptom Corrected: SC990 caused by data suspending in the Ring Binder, unable to transfer to both upstream and downstream peripherals.  =NOTE= • Please upgrade the main and sub boards concurrently as they work in a set. Ring Binder_B1 : D3925510E : Ver01.290:04 Ring Binder_B2 : D3925520C : Ver01.060:01
01.280:04	Symptom Corrected: On occasion of a jam occurrence on a machine downstream to the Ring Binder during a staple operation, even when the jammed paper is removed, the mainframe does not recover its operation.  =NOTE= When updating RingBinder_B1 to D3925510D (Ver01.280:04), please apply D3925520B (Ver01.050:01) onward for Ring_Binder_B2.  When operating Ring Binder with the Aegis-C1/P1, please apply

**Reissued: 12-Mar-10**

Model: Ring Binder RB5000	Date: 20-June -08	No.: RD392001e
---------------------------	-------------------	----------------

Version	Modified Points or Symptom Corrected
	D3925510D (Ver01.280:04) onward for RingBinder_B1, and D3925520B (Ver01.050:01) onward for RingBinder_B2.
01.270:04	<p>Symptom Corrected:</p> <ol style="list-style-type: none"> <li>1. JAM indication appears when power switch is turned on under the condition of punch unit having been removed.</li> <li>2. Correct information on parts number and software version is not transmitted to the main frame in configuration of Venus-C2+Ring Binder.</li> <li>3. Holds a WAIT status when release of energy saving is executed during non-energy saving mode.</li> <li>4. Command cannot be sent from Ring Binder to mainframe when ACK transmission interposes during a command transmission.</li> <li>5. Reboot function does not operate when ATN is received from an upstream peripheral devices after its connection has been made.</li> <li>6. Book binding function does not operate when malfunction in network is found in the downstream peripheral devices.</li> <li>7. Jam occurs when punching a few sheets (1-3 sheets) with big curls in punch mode.</li> </ol> <p>Other changes:</p> <ol style="list-style-type: none"> <li>1. Support in low linear speed action (for Venus-C2)</li> <li>2. Change in linear speed acceleration point (for Aegis-C1/P1) Acceleration point has been shifted 10mm towards downstream peripheral devices.</li> </ol> <p>=NOTE=  - Please update both main board and sub board concurrently as they function in combination.  Ring Binder_B1:D3925510C:Ver01.270:04  Ring Binder_B2:D3925520B:Ver01.050:01  - Please update your version when connecting Bellini-C4, Aegis-P1/C1 or Venus-C2.</p>
01.060:01	<p>Symptom Corrected:</p> <ol style="list-style-type: none"> <li>1. When the Binder Unit is replaced, while the Door Switch is forced ON, the temperature fuse blows.</li> <li>2. The temperature fuse blows if a communication error is experienced between downstream peripheral devices (positioned after the Ring Binder), when a System Reset command has been issued from the mainframe.</li> </ol>
01.050:01	1st Mass production

**Reissued: 20-Oct-10**

Model: Ring Binder RB5000	Date: 20-Jun -08	No.: RD392001f
---------------------------	------------------	----------------

**RTB Reissue**

The items in bold italics have been added.

Subject: Firmware Release Note: Ring Binder_B1		Prepared by: J. Ohno	
From: PPBG Service Planning Dept.			
Classification:	<input type="checkbox"/> Troubleshooting <input type="checkbox"/> Mechanical <input type="checkbox"/> Paper path <input checked="" type="checkbox"/> Other (      )	<input type="checkbox"/> Part information <input type="checkbox"/> Electrical <input type="checkbox"/> Transmit/receive	<input type="checkbox"/> Action required <input type="checkbox"/> Service manual revision <input type="checkbox"/> Retrofit information

This RTB has been issued to announce the firmware release information for the **Ring Binder\_B1**.

Version	Program No.	Effective Date
<b>01.310:04</b>	<b>D3925510G</b>	<b>December 2010 production</b>
01.300:04	D3925510F	February 2010 production
01.290:04	D3925510E	August 2009 production
01.280:04	D3925510D	April 2009 production
01.270:04	D3925510C	January 2009 production
01.060:01	D3925510A	July 2008 production
01.050:01	D3925510	1st Mass production

Version	Modified Points or Symptom Corrected
<b>01.310:04</b>	<b>Symptoms Corrected:</b> <b><i>In a configuration consisting of a Ring Binder RB5000 and multiple peripherals installed downstream of it, if a jam occurs in one of the downstream peripherals the RB5000 does not notify the jam to the mainframe. This may cause the mainframe and the downstream peripherals to remain in idling status; initialization behavior.</i></b>
01.300:04	Symptom Corrected: To prevent the failure of loss of synchronism of paper exit motor, when the Ring Binder_B1 transfers media to downstream peripherals.  =NOTE= For Ring Binder_B2, please use the firmware D3925520 or newer version.
01.290:04	Symptom Corrected: SC990 caused by data suspending in the Ring Binder, unable to transfer to both upstream and downstream peripherals.  =NOTE= • Please upgrade the main and sub boards concurrently as they work in a set. Ring Binder_B1:D3925510E:Ver01.290:04 Ring Binder_B2:D3925520C:Ver01.060:01
01.280:04	Symptom Corrected: On occasion of a jam occurrence on a machine downstream to the Ring Binder during a staple operation, even when the jammed paper is removed, the mainframe does not recover its

**Reissued: 20-Oct-10**

Model: Ring Binder RB5000	Date: 20-Jun -08	No.: RD392001f
---------------------------	------------------	----------------

Version	Modified Points or Symptom Corrected
	<p>operation.</p> <p>=NOTE= When updating RingBinder_B1 to D3925510D (Ver01.280:04), please apply D3925520B (Ver01.050:01) onward for Ring_Binder_B2.</p> <p>When operating Ring Binder with the Aegis-C1/P1, please apply D3925510D (Ver01.280:04) onward for RingBinder_B1, and D3925520B (Ver01.050:01) onward for RingBinder_B2.</p>
01.270:04	<p>Symptom Corrected:</p> <ol style="list-style-type: none"> <li>1. JAM indication appears when power switch is turned on under the condition of punch unit having been removed.</li> <li>2. Correct information on parts number and software version is not transmitted to the main frame in configuration of Venus-C2+Ring Binder.</li> <li>3. Holds a WAIT status when release of energy saving is executed during non-energy saving mode.</li> <li>4. Command cannot be sent from Ring Binder to mainframe when ACK transmission interposes during a command transmission.</li> <li>5. Reboot function does not operate when ATN is received from an upstream peripheral devices after its connection has been made.</li> <li>6. Book binding function does not operate when malfunction in network is found in the downstream peripheral devices.</li> <li>7. Jam occurs when punching a few sheets (1-3 sheets) with big curls in punch mode.</li> </ol> <p>Other changes:</p> <ol style="list-style-type: none"> <li>1. Support in low linear speed action (for Venus-C2)</li> <li>2. Change in linear speed acceleration point (for Aegis-C1/P1) Acceleration point has been shifted 10mm towards downstream peripheral devices.</li> </ol> <p>=NOTE= - Please update both main board and sub board concurrently as they function in combination. Ring Binder_B1:D3925510C:Ver01.270:04 Ring Binder_B2:D3925520B:Ver01.050:01 - Please update your version when connecting Bellini-C4, Aegis-P1/C1 or Venus-C2.</p>
01.060:01	<p>Symptom Corrected:</p> <ol style="list-style-type: none"> <li>1. When the Binder Unit is replaced, while the Door Switch is forced ON, the temperature fuse blows.</li> <li>2. The temperature fuse blows if a communication error is experienced between downstream peripheral devices (positioned after the Ring Binder), when a System Reset command has been issued from the mainframe.</li> </ol>
01.050:01	1st Mass production

**Reissued: 12-Oct-11**

Model: Ring Binder RB5000	Date: 20-Jun -08	No.: RD392001g
---------------------------	------------------	----------------

**RTB Reissue**

The items in bold italics have been added.

Subject: Firmware Release Note: Ring Binder_B1		Prepared by: J. Ohno	
From: PP Tech Service Dept., 1st PP Tech Service Sect.			
Classification:	<input type="checkbox"/> Troubleshooting <input type="checkbox"/> Mechanical <input type="checkbox"/> Paper path <input checked="" type="checkbox"/> Other (      )	<input type="checkbox"/> Part information <input type="checkbox"/> Electrical <input type="checkbox"/> Transmit/receive	<input type="checkbox"/> Action required <input type="checkbox"/> Service manual revision <input type="checkbox"/> Retrofit information

This RTB has been issued to announce the firmware release information for the **Ring Binder\_B1**.

Version	Program No.	Effective Date
<b>01.320:04</b>	<b>D3925510H</b>	<b>July 2011 production</b>
01.310:04	D3925510G	December 2010 production
01.300:04	D3925510F	February 2010 production
01.290:04	D3925510E	August 2009 production
01.280:04	D3925510D	April 2009 production
01.270:04	D3925510C	January 2009 production
01.060:01	D3925510A	July 2008 production
01.050:01	D3925510	1st Mass production

Version	Modified Points or Symptom Corrected
<b>01.320:04</b>	<b>Symptoms Corrected:</b> <b><i>Feeding custom size tab stocks to peripherals downstream to the RingBinder causes lag jams at the entrance of the RingBinder. The problem was caused by a fault code sequence that occurs particularly when feeding custom size tab stocks.</i></b>
01.310:04	Symptoms Corrected: In a configuration consisted of a RingBinder RB5000 and multiple peripherals installed to its downstream, if a jam occurs in one of the downstream peripherals the RB5000 does not notify the jam to the mainframe and may cause the mainframe and the downstream peripherals to remain in idling status; initialization behavior.
01.300:04	Symptom Corrected: To prevent the failure of loss of synchronism of paper exit motor, when the Ring Binder_B1 transfers media to downstream peripherals.  =NOTE= For Ring Binder_B2, please use the firmware D3925520 or newer version.
01.290:04	Symptom Corrected: SC990 caused by data suspending in the Ring Binder, unable to transfer to both upstream and downstream peripherals.  =NOTE=

**Reissued: 12-Oct-11**

Model: Ring Binder RB5000			Date: 20-Jun -08	No.: RD392001g
Version	Modified Points or Symptom Corrected			
	<ul style="list-style-type: none"> <li>Please upgrade the main and sub boards concurrently as they work in a set. Ring Binder_B1:D3925510E:Ver01.290:04 Ring Binder_B2:D3925520C:Ver01.060:01</li> </ul>			
01.280:04	<p>Symptom Corrected: On occasion of a jam occurrence on a machine downstream to the Ring Binder during a staple operation, even when the jammed paper is removed, the mainframe does not recover its operation.</p> <p>=NOTE= When updating RingBinder_B1 to D3925510D (Ver01.280:04), please apply D3925520B (Ver01.050:01) onward for Ring_Binder_B2.</p> <p>When operating Ring Binder with the Aegis-C1/P1, please apply D3925510D (Ver01.280:04) onward for RingBinder_B1, and D3925520B (Ver01.050:01) onward for RingBinder_B2.</p>			
01.270:04	<p>Symptom Corrected:</p> <ol style="list-style-type: none"> <li>JAM indication appears when power switch is turned on under the condition of punch unit having been removed.</li> <li>Correct information on parts number and software version is not transmitted to the main frame in configuration of Venus-C2+Ring Binder.</li> <li>Holds a WAIT status when release of energy saving is executed during non-energy saving mode.</li> <li>Command cannot be sent from Ring Binder to mainframe when ACK transmission interposes during a command transmission.</li> <li>Reboot function does not operate when ATN is received from an upstream peripheral devices after its connection has been made.</li> <li>Book binding function does not operate when malfunction in network is found in the downstream peripheral devices.</li> <li>Jam occurs when punching a few sheets (1-3 sheets) with big curls in punch mode.</li> </ol> <p>Other changes:</p> <ol style="list-style-type: none"> <li>Support in low linear speed action (for Venus-C2)</li> <li>Change in linear speed acceleration point (for Aegis-C1/P1) Acceleration point has been shifted 10mm towards downstream peripheral devices.</li> </ol> <p>=NOTE= - Please update both main board and sub board concurrently as they function in combination. Ring Binder_B1:D3925510C:Ver01.270:04 Ring Binder_B2:D3925520B:Ver01.050:01 - Please update your version when connecting Bellini-C4, Aegis-P1/C1 or Venus-C2.</p>			

**Reissued: 12-Oct-11**

Model: Ring Binder RB5000	Date: 20-Jun -08	No.: RD392001g
---------------------------	------------------	----------------

Version	Modified Points or Symptom Corrected
01.060:01	Symptom Corrected: <ol style="list-style-type: none"><li>1. When the Binder Unit is replaced, while the Door Switch is forced ON, the temperature fuse blows.</li><li>2. The temperature fuse blows if a communication error is experienced between downstream peripheral devices (positioned after the Ring Binder), when a System Reset command has been issued from the mainframe.</li></ol>
01.050:01	1st Mass production

Model: Ring Binder RB5000		Date: 28-Nov-14	No.: RD392008
Subject: New service part – Guide plate in the binder unit		Prepared by: J. Ohno	
From: 3rd Tech Service Sect., PP Tech Service Dept.			
Classification:	<input type="checkbox"/> Troubleshooting <input type="checkbox"/> Mechanical <input type="checkbox"/> Paper path <input type="checkbox"/> Product Safety	<input checked="" type="checkbox"/> Part information <input type="checkbox"/> Electrical <input type="checkbox"/> Transmit/receive <input type="checkbox"/> Other (     )	<input type="checkbox"/> Action required <input type="checkbox"/> Service manual revision <input type="checkbox"/> Retrofit information <input type="checkbox"/> Tier 2

The following guide plate attached with a Mylar sheet was registered as a service part to meet requests received from the field.

Old p/n	New p/n	Description	Q'ty	Int	Page	Index	Note
-	D7371415	GUIDE MILER:UNIFORM:TRAILING EDGE:MB80015:ASS'Y	1	-	19	10	Add

## 9.Ring Binder Unit 1 (D392)

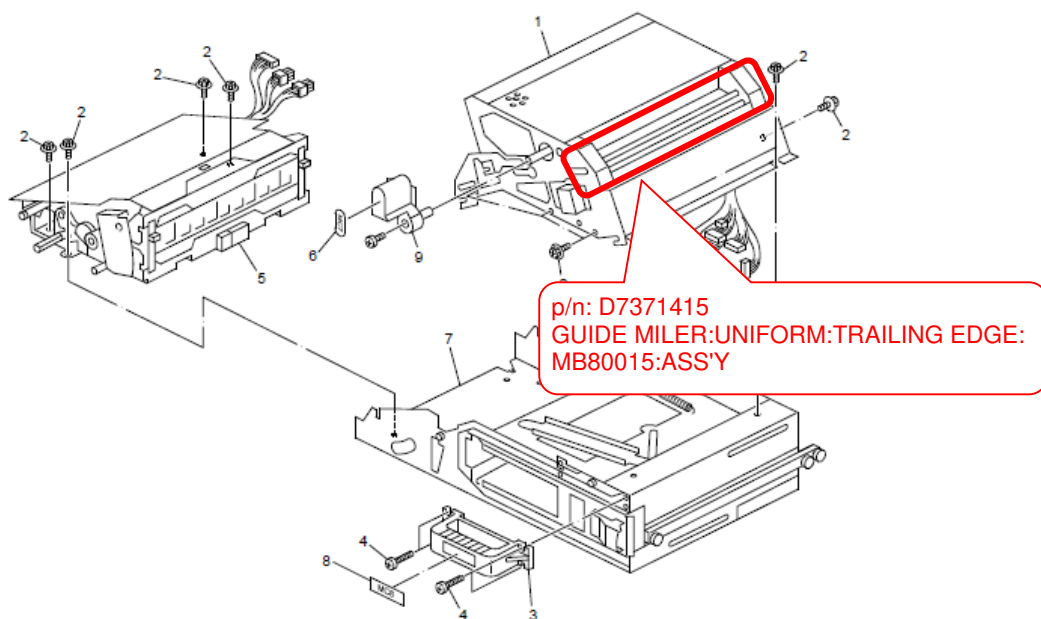



Model: Ring Binder RB5000

Date: 28-Nov-14

No.: RD392008

**Replacement procedure**

1. Pull out the Binder Unit.



2. Replace the guide plate (screws x2).

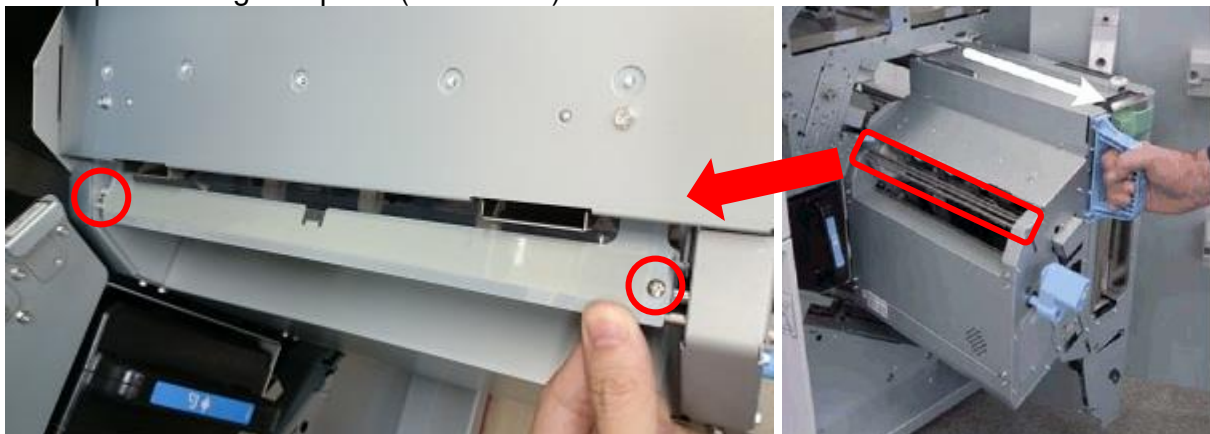

3. Slide the Binder Unit back in to complete the procedure.