

Model: R – C5 One-bin Tray		Date: 14-Jun-10	No.: RD367001
Subject: Guide Plate		Prepared by: T. Nihei	
From: 1st Overseas Tech Support Sec., 1st PQM Dept.			
Classification:	<input checked="" type="checkbox"/> Troubleshooting <input type="checkbox"/> Part information <input type="checkbox"/> Action required <input type="checkbox"/> Mechanical <input type="checkbox"/> Electrical <input type="checkbox"/> Service manual revision <input type="checkbox"/> Paper path <input type="checkbox"/> Transmit/receive <input type="checkbox"/> Retrofit information <input type="checkbox"/> Product Safety <input type="checkbox"/> Other ()		

Old part number	New part number	Description	Q'ty	Int	Page	Index	Note
D3674164	D3674165	GUIDE PLATE - GATE	1-1	X/O	3	21	

Change: The shape of the guide plate was changed.

Reason: To ensure that the separation guide plate does not interfere with the movement of the fusing pressure release lever.

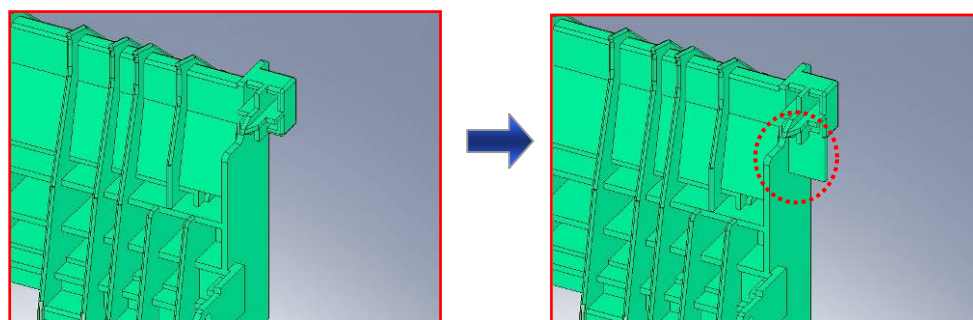

Before

After

Cut-in S/N:

Model code	Serial No.
D367-17	M6801401601~