

| | | | |
|--|---|--|---|
| Model: Adonis-C2 PT1045 | | Date: 14-Sep-01 | No.: MB376001 |
| Modified Article: Left Guide Plate - Middle | | Prepared by: E. Fukuyama | |
| From: Technical Services Dept., GTS Division | | | |
| Reason for Modification: | <input type="checkbox"/> Parts catalog correction <input type="checkbox"/> To facilitate assembly <input type="checkbox"/> Part standardization | <input type="checkbox"/> Vendor change <input checked="" type="checkbox"/> To improve reliability <input type="checkbox"/> Other | <input type="checkbox"/> To meet standards () |

To further ensure that the Middle Left Guide Plate stays securely attached, the width of the boss has been increased from 6 mm to 9 mm.

| Old part number | New part number | Description | Q'ty | Int | Page | Index | Note |
|-----------------|-----------------|---------------------------|------|-----|------|-------|------|
| A6842211 | B3762211 | Left Guide Plate - Middle | 1-1 | X/O | 5 | 20 | |

RCL (Japan) Production

| MODEL NAME | DESTINATION | CODE | SERIAL NO. |
|--------------|---------------------------|---------|--------------|
| 1 – BIN TRAY | USA, Canada, Europe, Asia | B376-17 | H7810500001 |
| 1 – BIN TRAY | USA, Canada, Europe, Asia | B376-14 | L08441050001 |
| 1 – BIN TRAY | USA, Canada, Europe, Asia | B376-26 | 4J70510001 |

| | | | |
|---|---|--|--|
| Model: Adonis-C2 PT1045 | | Date: 20-Mar-02 | No.: MB376002 |
| Modified Article: Upper Right Cover and Mylar | | Prepared by: E. Fukuyama | |
| From: Technical Services Dept., GTS Division | | | |
| Reason for Modification: | <input type="checkbox"/> Parts catalog correction | <input type="checkbox"/> Vendor change | <input type="checkbox"/> To meet standards () |
| | <input type="checkbox"/> To facilitate assembly | <input checked="" type="checkbox"/> To improve reliability | |
| | <input type="checkbox"/> Part standardization | <input type="checkbox"/> Other | |
| | | | |

To further ensure smooth paper transport and avoid paper jams, the shape of the Upper Right Cover has been changed and a Mylar has been added.

| Old part number | New part number | Description | Q'ty | Int | Page | Index |
|-----------------|-----------------|-------------------|------|-----|------|-------|
| B3761551 | B3761552 | Upper Right Cover | 1-1 | X/O | 3 | 2 |
| - | B3761556 | Paper Guide Mylar | 0-1 | - | 3 | 34 |

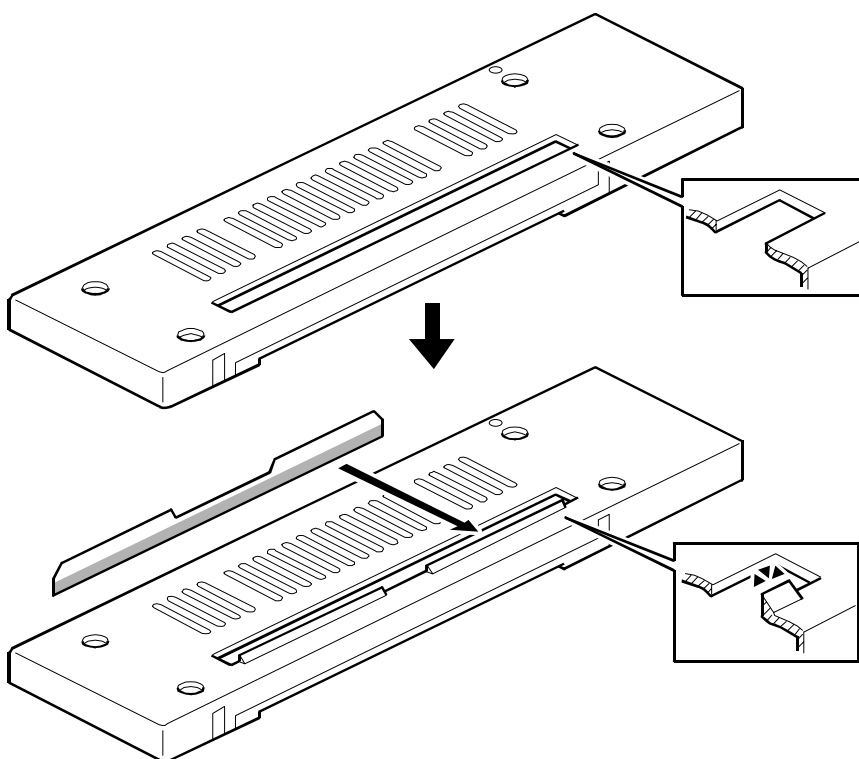

RCL (Japan) Production

| MODEL NAME | DESTINATION | CODE | SERIAL NO. |
|--------------|---------------------------|---------|-------------|
| 1 – BIN TRAY | USA, Canada, Europe, Asia | B376-17 | H7811100001 |
| 1 – BIN TRAY | USA, Canada, Europe, Asia | B376-14 | L0841110001 |
| 1 – BIN TRAY | USA, Canada, Europe, Asia | B376-26 | 4J71110001 |

| | | | |
|--|---|--|--|
| Model: Adonics-C2 1bin Tray (PT1045) | | Date: 25-Jul-02 | No.: MB376003 |
| Modified Article: Chromium Free | | Prepared by: K. Takagi | |
| From: Technical Services sec. Service Planning Dept. | | | |
| Reason for Modification: | <input type="checkbox"/> Parts catalog correction <input type="checkbox"/> To facilitate assembly <input type="checkbox"/> Part standardization | <input type="checkbox"/> Vendor change <input type="checkbox"/> To improve reliability <input checked="" type="checkbox"/> Other | <input type="checkbox"/> To meet standards () |

The following have been changed to chromium-free components to further minimize the impact on the environment.

| Old part number | New part number | Description | Q'ty | Int. | Page | Index | Note |
|-----------------|-----------------|--------------------------|------|------|------|-------|------|
| A6841111 | B5441111 | Side Plate - Front | 1 | O/O | 5 | 32 | |
| A6841112 | B5441112 | Transport Sensor Bracket | 1 | O/O | 5 | 3 | |
| A6841211 | B5441211 | Side Plate - Rear | 1 | O/O | 5 | 31 | |
| A6841212 | B5441212 | Safety Switch Bracket | 1 | O/O | 5 | 10 | |
| A6841213 | B5441213 | Sensor Bracket | 1 | O/O | 5 | 29 | |
| A6841214 | B5441214 | Main Board Bracket | 1 | O/O | 3 | 26 | |
| A6841311 | B5441311 | Upper Stay | 1 | O/O | 5 | 9 | |
| A6841401 | B5441401 | Base Assy | 1 | O/O | 5 | 33 | |
| A6841413 | B5441413 | Grounding Plate | 1 | O/O | 3 | 20 | |
| A6842332 | B5442332 | Pressure Release Bracket | 1 | O/O | 5 | 14 | |
| A6842511 | B5442511 | Motor Bracket | 1 | O/O | 5 | 1 | |
| A6843201 | B5443201 | Copy Tray Bracket | 1 | O/O | 3 | 10 | |
| B3761113 | B5441113 | Bracket - LED | 1 | O/O | 5 | 7 | |

RCL (Japan) Production

| MODEL NAME | DESTINATION | CODE | SERIAL NO. |
|--------------|---------------------------|---------|-------------|
| 1 – BIN TRAY | USA, Canada, Europe, Asia | B376-17 | H78208xxxxx |
| 1 – BIN TRAY | USA, Canada, Europe, Asia | B376-14 | L0842070034 |
| 1 – BIN TRAY | USA, Canada, Europe, Asia | B376-26 | 4J7082xxxx |

| | | | |
|--|---|--|---|
| Model: Adonis-C2 1 bin Tray (PT1045) | | Date: 19-Sep-03 | No.: MB376004 |
| Modified Article: Main Board | | Prepared by: Y.Urushihara | |
| From: 1st Tech. Support Sec. Service Support Dept. | | | |
| Reason for Modification: | <input type="checkbox"/> Parts catalog correction <input type="checkbox"/> To facilitate assembly <input type="checkbox"/> Part standardization | <input checked="" type="checkbox"/> Vendor change <input type="checkbox"/> To improve reliability <input type="checkbox"/> Other | <input type="checkbox"/> To meet standards () |

The following has been changed due to a vendor change.

| Old part number | New part number | Description | Q'ty | Int | Page | Index | Note |
|-----------------|-----------------|-------------|------|-----|------|-------|------|
| A6845100 | B5445100 | Main Board | 1 | O/O | 3 | 25 | |

RCL (Japan) Production

| MODEL NAME | DESTINATION | CODE | SERIAL NO. |
|--------------|---------------------------|---------|-------------|
| 1 – Bin Tray | USA, Canada, Europe, Asia | B376-14 | L0842100001 |
| 1 – Bin Tray | USA, Canada, Europe, Asia | B376-17 | H7820900722 |
| 1 – Bin Tray | USA, Canada, Europe, Asia | B376-26 | 4J71120001 |