

Model: Model U-C1 LCT (PS520)		Date: 22-Mar-05	No.: MB457001
Modified Article: Stand		Prepared by: S. Tomoe	
From: 1st Tech. Support Sec. Service Support Dept.			
Reason for Modification:	<input type="checkbox"/> Parts catalog correction <input type="checkbox"/> To facilitate assembly <input type="checkbox"/> Part standardization	<input checked="" type="checkbox"/> Vendor change <input type="checkbox"/> To improve reliability <input type="checkbox"/> Other	<input type="checkbox"/> To meet standards ()

Old part number	New part number	Description	Q'ty	Int	Page	Index	Note
G5696160	B4566160	Front Stand	1	X/O	3	1	
G5696161	B4566161	Rear Stand	1	X/O	3	2	

Change/Reason: Vendor change.

RCL (Japan) Production

Model	V/Hz	Destination	Code	Serial Number
PS520	120/60	All RICOH subsidiaries, NRG, SAVIN	B457-17	J4030400001
PS520	220-240/50, 60	All RICOH subsidiaries, NRG	B457-27	J4030400235
PS520	220-240/50, 60	Infotec	B457-26	6P60430001

Model: Model U-C1 LCT (PS520)		Date: 22-Mar-05	No.: MB457002
Modified Article: Rear Left Stand Bracket		Prepared by: S. Tomoe	
From: 1st Tech. Support Sec. Service Support Dept.			
Reason for Modification:	<input type="checkbox"/> Parts catalog correction <input type="checkbox"/> To facilitate assembly <input type="checkbox"/> Part standardization	<input type="checkbox"/> Vendor change <input type="checkbox"/> To improve reliability <input checked="" type="checkbox"/> Other	<input type="checkbox"/> To meet standards ()

Old part number	New part number	Description	Q'ty	Int	Page	Index	Note
G5696168	B6006168	Rear Left Stand Bracket	1-1	O/O	3	9	
G5696169	B6006169	Rear Right Stand Bracket	1-1	O/O	3	40	
G6971082	B6001082	Tray Holder	1-1	O/O	13	3	

Change: The materials for these parts were changed to more environmentally-friendly types.

Reason: This is part of Ricoh's ongoing application of in-house environmental standards.

Model: Model U-C1 LCT (PS520)		Date: 22-Mar-05	No.: MB457003
Modified Article: Torque Limiter		Prepared by: S. Tomoe	
From: 1st Tech. Support Sec. Service Support Dept.			
Reason for Modification:	<input type="checkbox"/> Parts catalog correction <input type="checkbox"/> To facilitate assembly <input type="checkbox"/> Part standardization	<input type="checkbox"/> Vendor change <input type="checkbox"/> To improve reliability <input checked="" type="checkbox"/> Other	<input type="checkbox"/> To meet standards ()

Old part number	New part number	Description	Q'ty	Int	Page	Index	Note
G0602900	B1802900	Torque Limiter – 40MN.M:MM18	1-1	O/O	9	22	

Change: The materials for these parts were changed to more environmentally-friendly types.

Reason: This is part of Ricoh's ongoing application of in-house environmental standards.

Model: Model U-C1 LCT (PS520)		Date: 22-Mar-05	No.: MB457004
Modified Article: Control Board		Prepared by: S. Tomoe	
From: 1st Tech. Support Sec. Service Support Dept.			
Reason for Modification:	<input type="checkbox"/> Parts catalog correction <input type="checkbox"/> To facilitate assembly <input type="checkbox"/> Part standardization	<input type="checkbox"/> Vendor change <input type="checkbox"/> To improve reliability <input checked="" type="checkbox"/> Other	<input type="checkbox"/> To meet standards ()

Old part number	New part number	Description	Q'ty	Int	Page	Index	Note
B4575100	B4575115	Interface Board	1-1	O/O	13	7	

Change: The materials for this part were changed to more environmentally-friendly types.

Reason: This is part of Ricoh's ongoing application of in-house environmental standards.

Reissued: 12-Apr-05

Model: Model U-C1 LCT (PS520)	Date: 22-Mar-05	No.: MB457005a
-------------------------------	-----------------	----------------

MB Correction

The items in bold italics have been corrected or added.

Modified Article: Vertical Guide		Prepared by: S. Tomoe	
From: 1st Tech. Support Sec. Service Support Dept.			
Reason for Modification:	<input type="checkbox"/> Parts catalog correction	<input type="checkbox"/> Vendor change	<input type="checkbox"/> To meet standards ()
	<input type="checkbox"/> To facilitate assembly	<input type="checkbox"/> To improve reliability	
	<input type="checkbox"/> Part standardization	<input checked="" type="checkbox"/> Other	

Old part number	New part number	Description	Q'ty	Int	Page	Index	Note
A2322785	<i>B0822785</i>	Vertical Guide	1-1	O/O	9	38	

Change: The position of the Mylar on the vertical guide was changed.

Reason: To minimize paper jams that occur when curled paper is used.

Model: Model U-C1 LCT (PS520)		Date: 29-Mar-05	No.: MB457006
Modified Article: Rollers		Prepared by: S. Tomoe	
From: 1st Tech. Support Sec. Service Support Dept.			
Reason for Modification:	<input type="checkbox"/> Parts catalog correction <input type="checkbox"/> To facilitate assembly <input type="checkbox"/> Part standardization	<input type="checkbox"/> Vendor change <input checked="" type="checkbox"/> To improve reliability <input type="checkbox"/> Other	<input type="checkbox"/> To meet standards ()

Old part number	New part number	Description	Q'ty	Int	Page	Index	Note
AF030049	AF030085	Pick-up Roller	1-1	X/O	9	2	
AF031049	AF031085	Feed Roller	1-1	X/O	9	14	
AF032049	AF032085	Separation Roller	1-1	X/O	9	23	
G5682650	G5682665	Paper Feed Unit	1-1	X/O	9	1	

Change: The materials for these parts were changed.

Reason: To improve the reliability of these parts.

Model: Model U-C1 LCT (PS520)		Date: 30-Mar-05	No.: MB457007
Modified Article: Heater Harnesses		Prepared by: S. Tomoe	
From: 1st Tech. Support Sec. Service Support Dept.			
Reason for Modification:	<input type="checkbox"/> Parts catalog correction <input type="checkbox"/> To facilitate assembly <input type="checkbox"/> Part standardization	<input type="checkbox"/> Vendor change <input type="checkbox"/> To improve reliability <input checked="" type="checkbox"/> Other	<input type="checkbox"/> To meet standards ()

Old part number	New part number	Description	Q'ty	Int	Page	Index	Note
B5685340	B4565350	Heater Harness	1-1	O/O	3	17	
	B4565360	Heater Sub Harness	0-1		3	41	

Changes:

- 1) The material of the I/F harness (heater harness) was changed to a more environmentally-friendly type.
- 2) A relay harness was added (heater sub harness).

Reasons:

- 1) This is part of Ricoh's ongoing application of in-house environmental standards.
- 2) So that the LCT can connect to the mainframe PSU.

Note: The position of the LCT connector on the TH-C1 PSU is different from the previous model.

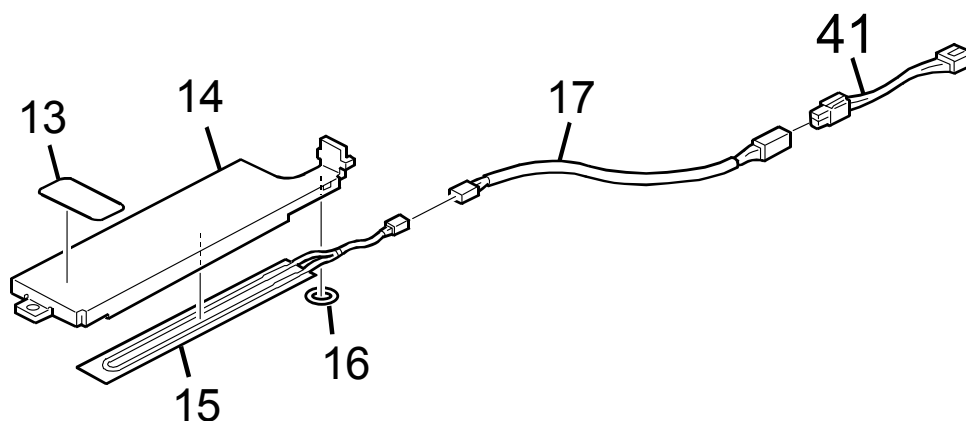

Model: Model U-C1 / TH-C1 LCT (PS520)		Date: 28-Jun-06	No.: MB457008
Modified Article: Front & Rear Side Fences		Prepared by: H.K.	
From: Technical Service Dept., GTS Division			
Reason for Modification:	<input type="checkbox"/> Parts catalog correction <input type="checkbox"/> To facilitate assembly <input type="checkbox"/> Part standardization	<input type="checkbox"/> Vendor change <input type="checkbox"/> To improve reliability <input checked="" type="checkbox"/> Other	<input type="checkbox"/> To meet standards ()

Old part number	New part number	Description	Q'ty	Int	Page	Index	Note
G5692640	B6002640	FRONT SIDE FENCE	1	O/O	7	9	
G5692650	B6002650	REAR SIDE FENCE	1	O/O	7	13	
B6002640	B6002645	FRONT SIDE FENCE	1	X/O	7	9	
B6002650	B6002655	REAR SIDE FENCE	1	X/O	7	13	

For details, please refer to RTB RB156027. 

RCL (Japan) Production

Model	V/Hz	Destination	Code	Serial Number
PS520	120/60	RICOH, NRG, SAVIN	B457-17	J40604xxxxx
PS520	220-240/50, 60	RICOH, NRG, Lanier	B457-27	J4060300001
PS520	220-240/50, 60	Infotec	B457-26	6P60360001

Model: Model TH-C1		Date: 6-Apr-06	No.: RB156027
Subject: LCT Jam or Noise		Prepared by: H.K.	
From: 1st Tech. Support Sec. Service Support Dept.			
Classification:	<input checked="" type="checkbox"/> Troubleshooting	<input type="checkbox"/> Part information	<input type="checkbox"/> Action required
	<input type="checkbox"/> Mechanical	<input type="checkbox"/> Electrical	<input type="checkbox"/> Service manual revision
	<input type="checkbox"/> Paper path	<input type="checkbox"/> Transmit/receive	<input type="checkbox"/> Retrofit information
	<input type="checkbox"/> Product Safety	<input type="checkbox"/> Other ()	

SYMPTOM

When the paper stack is moved from the left to the right in the LCT, the first sheet of the paper stack in the LCT jams, or noise occurs and the paper is not fed.

CAUSE

One or more of the following:

- The distance between the side fences is narrow. As a result, the paper is not moved correctly to the right side of the LCT, and the timing belt is overloaded.
- The paper is wider than specification or has burrs on its edge

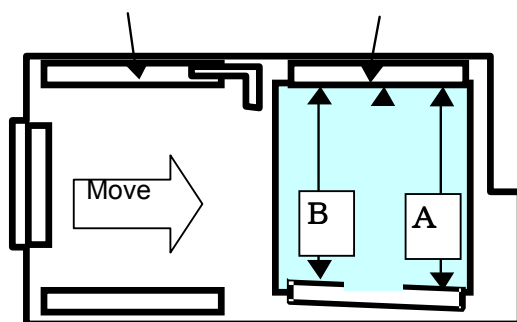

SOLUTION

Production Line

Temporary:

1. The distance between the side fences was increased by 0.5mm.
 - The length of the front side fence was changed (P/N B1809902)
2. The distance between the side fences is checked on the production line.
 - Cut-in S/N:

J4051100001 (from 2005 November production)

Model: Model TH-C1

Date: 6-Apr-06

No.: RB156027

Permanent:

1. The distance between the side fences was increased by 0.2mm
- The positions of the screw holes were moved 0.1mm.
2. The distance between the side fences is checked on the production line.

Old part number	New part number	Description	Q'ty	Int
G5692640 (B6002640)	B6002645	FRONT SIDE FENCE	1	X/O
G5692650 (B6002650)	B6002655	REAR SIDE FENCE	1	X/O

Note: G5692640 → B6002640, G5692650 → B6002650 O/O These change has been applied due to a vendor change.

Action in the Field

1. Replace the front side fence with **B1809902** (production line temporary solution).
- Or,
2. Replace the front side fence and rear side fence with **B6002645** and **B6002655**.

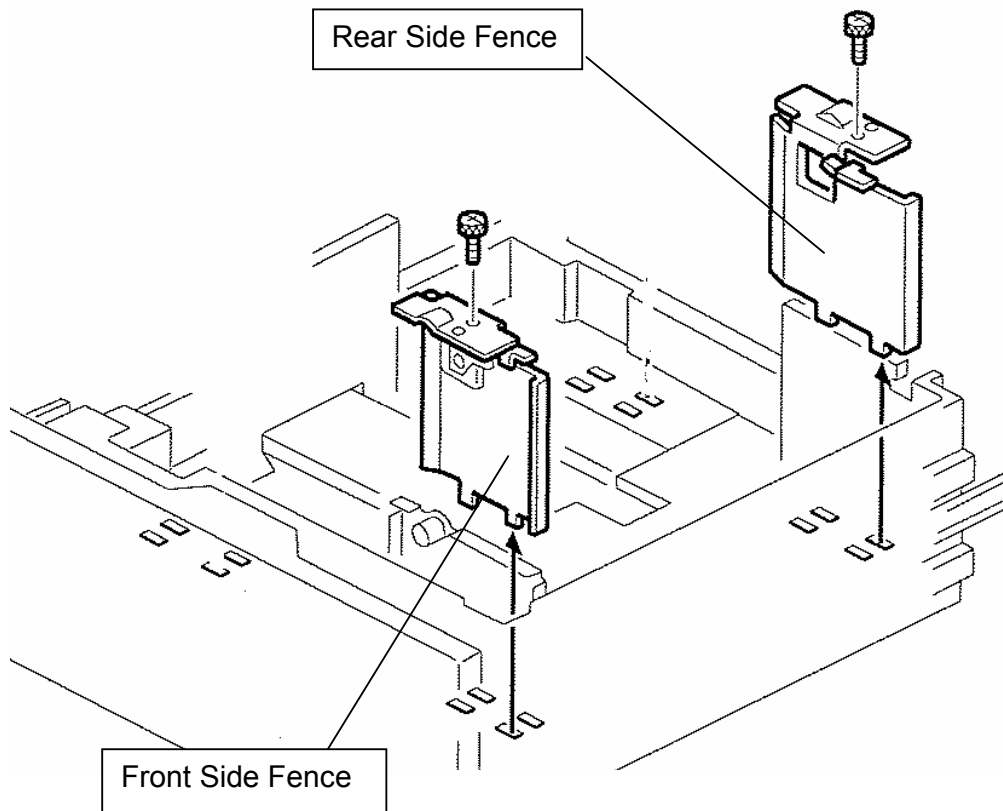

Model: Model U-C1 / TH-C1 LCT (PS520)		Date: 28-Jul-06	No.: MB457009
Modified Article: End Fence		Prepared by: H.K.	
From: 1st Tech. Support Sec. Service Support Dept.			
Reason for Modification:	<input type="checkbox"/> Parts catalog correction	<input type="checkbox"/> Vendor change	<input type="checkbox"/> Other
	<input type="checkbox"/> To facilitate assembly	<input checked="" type="checkbox"/> To improve reliability	<input type="checkbox"/> To meet standards
	<input type="checkbox"/> Part standardization	<input type="checkbox"/> Product Safety	()



Old part number	New part number	Description	Q'ty	Int	Page	Index	Note
G5692707	B6002707	End Fence –Tandem Tray	X/O	1-1	5	27	

Change: The shape of the end fence was changed.

Reason: To improve the accuracy of moving the paper stack from the left side to the right side of the tandem tray.

Note:

- This will also help to prevent SC503 occurrences.
- If the top of the paper stack collapses (see the illustration below), the top of the paper stack pushes the end fence open.

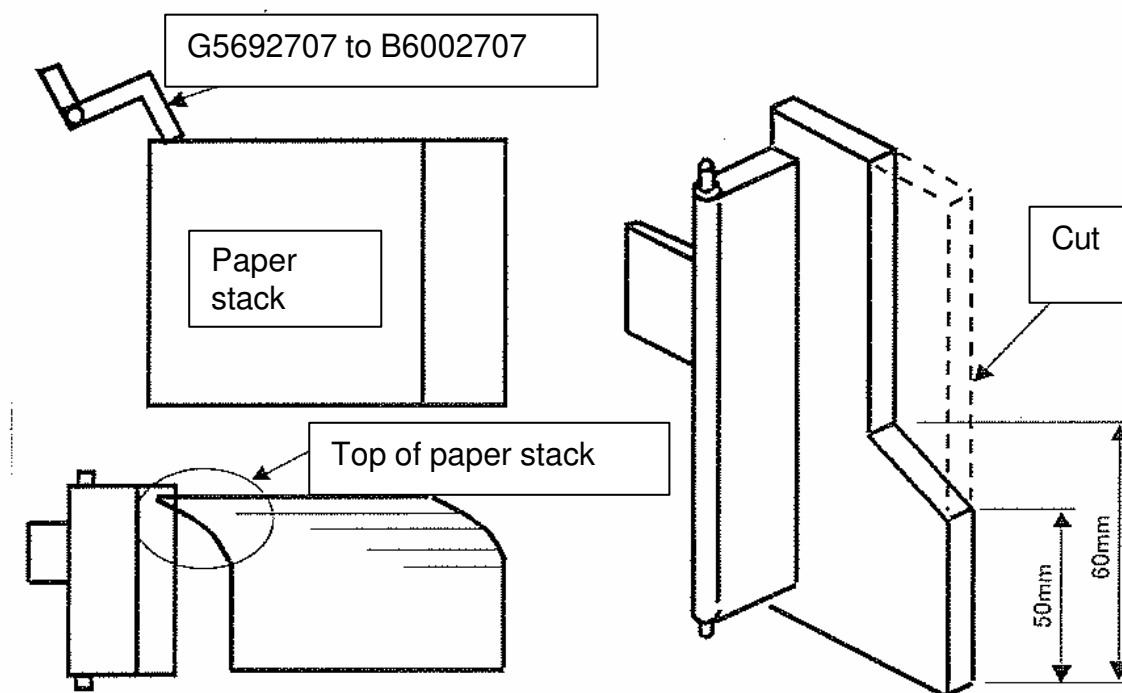

Model: Model U-C1 / TH-C1 LCT (PS520)

Date: 28-Jul-06

No.: MB457009

RCL (Japan) Production

Model	V/Hz	Destination	Code	Serial Number
PS520	120/60	All RICOH subsidiaries, NRG, SAVIN	B457-17	J40604xxxxx
PS520	220-240/50, 60	All RICOH subsidiaries, NRG	B457-27	J4051100071
PS520	220-240/50, 60	Infotec	B457-26	6P60160001

Model: Model U-C1/TH-C1 LCT		Date: 27-Jul-06	No.: MB457010
Modified Article: LCT Controll Board		Prepared by: H.K.	
From: Technical Service Dept., GTS Division			
Reason for Modification:	<input type="checkbox"/> Parts catalog correction <input type="checkbox"/> To facilitate assembly <input type="checkbox"/> Part standardization	<input type="checkbox"/> Vendor change <input type="checkbox"/> To improve reliability <input checked="" type="checkbox"/> Other	<input type="checkbox"/> To meet standards ()

Old part number	New part number	Description	Q'ty	Int	Page	Index	Note
B4575115	B4575116	LCT BOARD	1	X/O	13	7	

Change: The firmware for the LCT board was changed.

Reason: SC503 sometimes occurs when the LCT board communicates with the BICU board on Model TH-C1.

Note: This symptom occurs **only when** the LCT runs out of paper, and then the user turns the main power **OFF** and loads paper in the left side.

RCL (Japan) Production

Model	V/Hz	Destination	Code	Serial Number
PS520	120/60	All RICOH subsidiaries, NRG, SAVIN	B457-17	J40606xxxxx
PS520	220-240/50, 60	All RICOH subsidiaries, NRG	B457-27	J4060500004
PS520	220-240/50, 60	Infotec	B457-26	6P60560001

Reissued: 6-Jun-07

Model: Model U-C1 / TH-C1 LCT (PS520)	Date: 28-Jul-06	No.: MB457009a
---------------------------------------	-----------------	----------------

MB Correction

 The items in ***bold italics*** were corrected or added.

Modified Article: End Fence		Prepared by: H.K.	
From: 1st Tech. Support Sec. Service Support Dept.			
Reason for Modification:	<input type="checkbox"/> Parts catalog correction <input type="checkbox"/> Vendor change <input type="checkbox"/> Other		
	<input type="checkbox"/> To facilitate assembly <input checked="" type="checkbox"/> To improve reliability <input type="checkbox"/> To meet standards		
	<input type="checkbox"/> Part standardization <input type="checkbox"/> Product Safety ()		

Old part number	New part number	Description	Q'ty	Int	Page	Index	Note
G5692707	B6002707	End Fence –Tandem Tray	X/O	1-1	5	27	
<i>G5692705</i>	<i>B6002706</i>	<i>Side Fence: Tandem Tray: Sub-Ass'y</i>	<i>X/O</i>	<i>1-1</i>	<i>5</i>	<i>21</i>	
<i>G5692601</i>	<i>B6002604</i>	<i>Tandem LCT Ass'y - A4</i>	<i>X/O</i>	<i>1-1</i>	<i>5</i>	<i>4</i>	
<i>G5692605</i>	<i>B6002608</i>	<i>Tandem LCT Ass'y - LT</i>	<i>X/O</i>	<i>1-1</i>	<i>5</i>	<i>4</i>	

Change: The shape of the end fence was changed.

Reason: To improve the accuracy of moving the paper stack from the left side to the right side of the tandem tray.

Note:

- This will also help to prevent SC503 occurrences.
- If the top of the paper stack collapses (see the illustration below), the top of the paper stack pushes the end fence open.

Reissued: 6-Jun-07

Model: Model U-C1 / TH-C1 LCT (PS520)

Date: 28-Jul-06

No.: MB457009a

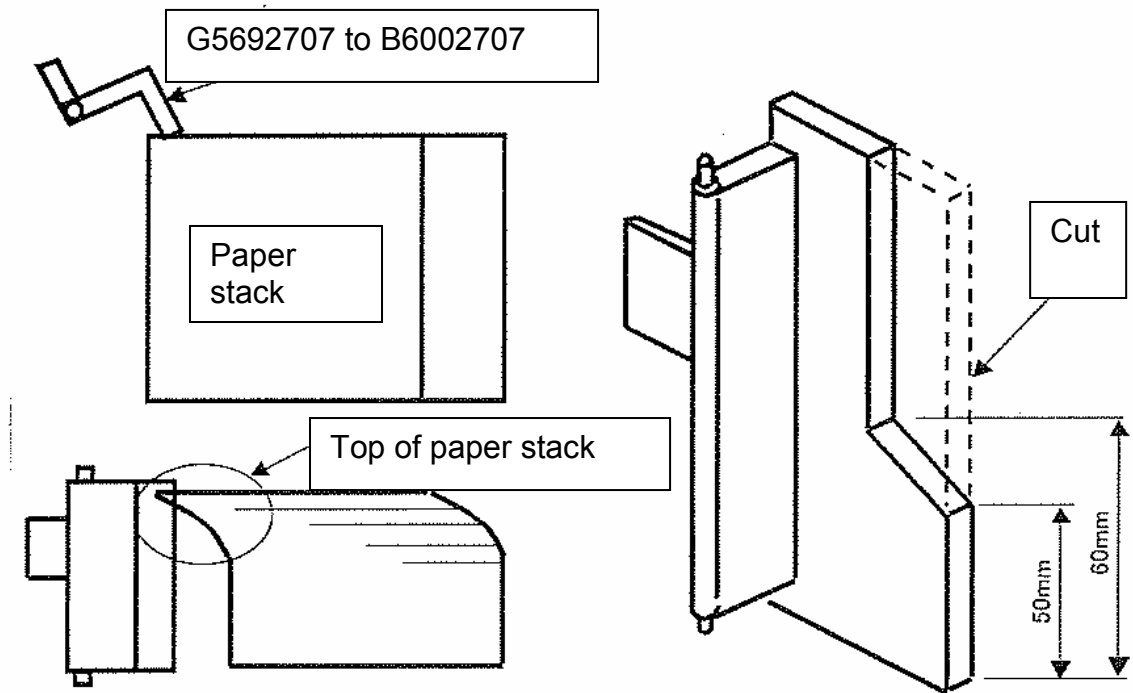

Reissued: 6-Jun-07

Model: Model U-C1 / TH-C1 LCT (PS520)	Date: 28-Jul-06	No.: MB457009a
---------------------------------------	-----------------	----------------

RCL (Japan) Production

Model	V/Hz	Destination	Code	Serial Number
PS520	120/60	All RICOH subsidiaries, NRG, SAVIN	B457-17	J40604xxxxx
PS520	220-240/50, 60	All RICOH subsidiaries, NRG	B457-27	J4051100071
PS520	220-240/50, 60	Infotec	B457-26	6P60160001

Model: Model U-C1 / TH-C1 LCT (PS520)		Date: 15-Jun-07	No.: MB457011
Modified Article: See Table		Prepared by: H.K.	
From: Technical Service Dept., GTS Division			
Reason for Modification:	<input type="checkbox"/> Parts catalog correction <input type="checkbox"/> To facilitate assembly <input type="checkbox"/> Part standardization	<input type="checkbox"/> Vendor change <input type="checkbox"/> To improve reliability <input type="checkbox"/> Other	<input checked="" type="checkbox"/> To meet standards (RoHS)

Old part number	New part number	Description	Q'ty	Int	Page	Index	Note
AX200158	AX200276	MAGNETIC CLUTCH:0.8NM:Z28	1	X/O	11	20	
A6821067	B5421067	STAY:UPPER:PROTECT	2	X/O	3	11	
A6822559	B5422559	STOPPER:LEVER:VERTICAL TRANSPORT	1	X/O	3	29	
A6822565	B5982565	STOPPER:VERTICAL TRANSPORT:PEEN	1	X/O	3	31	
G5682700	B5982700	BRACKET:STEPPER MOTOR:ASS'Y	1	X/O	11	24	
G5691087	B6001087	BRACKET:SAFETY	1	X/O	13	9	
G5692826	B6002826	BRACKET:MAGNETIC CLUTCH	1	X/O	11	15	
G5692827	B6002827	DRUM STAY:TIMING BELT	1	X/O	11	13	
G5692846	B6002846	DRUM STAY:FEED ROLLER:UPPER	1	X/O	11	6	
G5681187	B5981187	BRACKET:INTERFACE BOARD	1	X/O	13	8	
A2322881	B5982881	MICRO SWITCH:ON OFF DETECTOR:ASS'Y	1	X/O	13	1	
G5682702	B5982703	STEPPER MOTOR – DC 4.42W	1	X/O	11	25	
G5682830	B5982830	BRACKET:STEPPER MOTOR:PEEN	1	X/O	11	27	
G5686560	B5986560	HEAT SINK:HEATER	1	X/O	3	14	
G5692565	B6002565	GUIDE PLATE: VERTICAL TRANSPORT	1	X/O	3	26	
AX200221	AX200279	MAGNETIC CLUTCH - PAPER FEED	1	X/O	11	4	
G5682665	G5682675	PAPER FEED UNIT: PAPER BANK:ASS'Y	2	X/O	9	1	A
G5682675	B5982665	PAPER FEED UNIT: APER BANK: ASS'Y	2	X/O	9	1	A

Change: The materials for these parts were changed.

Reason: To comply with the RoHS Directive.

Model: Model U-C1 / TH-C1 LCT (PS520)

Date: 15-Jun-07

No.: MB457011

Note:

- The functions of these parts were not changed.
- “A”: The P/N for this part was changed as follows: G5682665 → G5682675 → B5982665.

IMPORTANT:

- The materials for the parts were changed before the part numbers were changed. To make sure the correct parts are used on the correct machines, please handle the parts as follows:

Parts with the **old** P/N:

Parts with the **new** P/N:

Non-RoHS compliant parts

RoHS compliant parts

	RoHS Compliant Parts	Non-RoHS Compliant Parts
RoHS Compliant Machines	OK	<u>DO NOT USE</u>
Non-RoHS Compliant Machines	OK	OK

- **Continue using** non-RoHS compliant parts on non-RoHS compliant machines **until the stock of these parts runs out**. Then, start using RoHS compliant parts on the non-RoHS compliant machines.
- **DO NOT use** non-RoHS compliant parts on RoHS compliant machines.
Note: This is to make sure that all machines are in full compliance with the RoHS Directive.

RCL (Japan) Production

Model	V/Hz	Destination	Code	Serial Number
PS520	120/60	All RICOH subsidiaries, NRG, SAVIN	B457-17	J40603xxxxx
PS520	220-240/50, 60	All RICOH subsidiaries, NRG	B457-27	J40603xxxxx
PS520	220-240/50, 60	Infotec	B457-26	6P6036xxxx

Model: Model U-C1 / TH-C1 LCT (PS520)		Date: 3-Jul-07	No.: MB457012
Modified Article: See Table		Prepared by: H.K.	
From: Technical Service Dept., GTS Division			
Reason for Modification:	<input type="checkbox"/> Parts catalog correction <input type="checkbox"/> To facilitate assembly <input type="checkbox"/> Part standardization	<input type="checkbox"/> Vendor change <input type="checkbox"/> To improve reliability <input type="checkbox"/> Other	<input checked="" type="checkbox"/> To meet standards (RoHS)

Old part number	New part number	Description	Q'ty	Int	Page	Index	Note
G5682689	B5982689	SHAFT:SEPARATE:DRIVE N:BANK:ASS'Y	1	X/O	9	21	
AW020131	AW020161	PHOTOINTERRUPTOR:VERTICAL TRANSPORT	1	X/O	9	7	
A2322780	B1802780	STAY:FEED	1	X/O	9	8	
A2322781	B0772781	BRACKET:SENSOR	1	X/O	9	6	
G0602725	B1802722	STAY:SEPARATE:NO.2:ASS'Y	1	X/O	9	24	
G5685370	B5985370	HARNESS:PAPER FEED UNIT:ASS'Y	1	X/O	9	10	

Change: The materials for these parts were changed.

Reason: To comply with the RoHS Directive.

Note:

- The functions of these parts were not changed.

IMPORTANT:

- The materials for the parts were changed before the part numbers were changed. To make sure the correct parts are used on the correct machines, please handle the parts as follows:

Parts with the **old** P/N:
Parts with the **new** P/N:

Non-RoHS compliant parts
RoHS compliant parts

	RoHS Compliant Parts	Non-RoHS Compliant Parts
RoHS Compliant Machines	OK	<u>DO NOT USE</u>
Non-RoHS Compliant Machines	OK	OK

- **Continue using** non-RoHS compliant parts on non-RoHS compliant machines **until the stock of these parts runs out**. Then, start using RoHS compliant parts on the non-RoHS compliant machines.

Model: Model U-C1 / TH-C1 LCT (PS520)	Date: 3-Jul-07	No.: MB457012
---------------------------------------	----------------	---------------

- **DO NOT use non-RoHS** compliant parts on RoHS compliant machines.
Note: This is to make sure that all machines are in full compliance with the RoHS Directive.

RCL (Japan) Production

Model	V/Hz	Destination	Code	Serial Number
PS520	120/60	All RICOH subsidiaries, NRG, SAVIN	B457-17	J40603xxxxx
PS520	220-240/50, 60	All RICOH subsidiaries, NRG	B457-27	J40603xxxxx
PS520	220-240/50, 60	Infotec	B457-26	6P6036xxxx



Part Change Information List

Date: April 30, 2009

Model	Code	PCIL Number	PCIL Correction	Old part number	New part number	Description	Old Q'ty	New Q'ty	Int	3DPC	Page	Index	Set	Set Int	RTB	Note	Ref Number
Model U-C1 LCT (PS520)	B457	200904		AA002010	AA001508	DECAL:SIDE FENCE:40X30	2	2	X/O		5,7,15	22 , 12 , 4					V0900426



Part Change Information List

Date: Jul 30, 2010

Model	Code	PCIL Nr.	PCIL Correction	Old part number	New part number	Description	Old Q'ty	New Q'ty	Int	3DPC	Page	Index	Set	Set Int	RTB	Note	Ref. Nr.	ECN Nr.
U-C1 LCT (PS520)	B457	201007		G5691175	B6001175	SLIDE RAIL:RIGHT	1	1	X/O		5	23					V1001166	4060443



Part Change Information List

Date: January 31, 2013

Model	Code	PCIL Number	PCIL Correction	Old part number	New part number	Description	Old Q'ty	New Q'ty	Int	3DPC	Page	Index	Set	Set Int	RTB	Note	Ref Number	ECN Number
U-C1 LCT (PS520)	B457	201301		AH012014	AH012050	CASTER:STOPPER:NO	2	2	O/O		3	3					V1203033	12091652