

Reissued: 16-Jul-03

Model: Model U-C1 Paper Tray Unit (PS510)	Date: 19-Jun-03	No.: MB456001a
---	-----------------	----------------

MB Correction

The items in bold italics have been corrected or added.

Modified Article: Stand		Prepared by: Y.Urushihara	
From: 1st Tech. Support Sec. Service Support Dept.			
Reason for Modification:	<input type="checkbox"/> Parts catalog correction	<input checked="" type="checkbox"/> Vendor change	<input type="checkbox"/> To meet standards ()
	<input type="checkbox"/> To facilitate assembly	<input type="checkbox"/> To improve reliability	
	<input type="checkbox"/> Part standardization	<input type="checkbox"/> Other	

The following have been changed due to a vendor change.

Old part number	New part number	Description	Q'ty	Int	Page	Index	Note
G5696160	B4566160	Front Stand	1	X/O	3	1	
G5696161	B4566161	Rear Stand	1	X/O	3	2	

RCL (Japan) Production

Model	V/Hz	Destination	Code	Serial Number
PS510	120/60	All RICOH subsidiaries, NRG, SAVIN	B456-17	J3930400001
PS510	220-240/50, 60	Infotec	B456-26	6P50430001

Model: Model U-C1 Paper Tray Unit (PS510)		Date: 25-Sep-03	No.: MB456002
Modified Article: Heater Harness		Prepared by: S. Tomoe	
From: 1st Tech. Support Sec. Service Support Dept.			
Reason for Modification:	<input checked="" type="checkbox"/> Parts catalog correction <input type="checkbox"/> To facilitate assembly <input type="checkbox"/> Part standardization	<input type="checkbox"/> Vendor change <input type="checkbox"/> To improve reliability <input type="checkbox"/> Other	<input type="checkbox"/> To meet standards ()

Please apply the following corrections to your Parts Catalogs.

Old part number	New part number	Description	Q'ty	Int	Page	Index	Note
B5685340	B4565340	Heater Harness	1-1		4	20	

Model: Model U-C1 Paper Tray Unit (PS510)		Date: 22-Mar-05	No.: MB456004
Modified Article: Torque Limiter		Prepared by: S. Tomoe	
From: 1st Tech. Support Sec. Service Support Dept.			
Reason for Modification:	<input type="checkbox"/> Parts catalog correction <input type="checkbox"/> To facilitate assembly <input type="checkbox"/> Part standardization	<input type="checkbox"/> Vendor change <input type="checkbox"/> To improve reliability <input checked="" type="checkbox"/> Other	<input type="checkbox"/> To meet standards ()

Old part number	New part number	Description	Q'ty	Int	Page	Index	Note
G0602900	B1802900	Torque Limiter – 40MN.M:MM18	1-1	O/O	7	22	

Change: The material for this part was changed to a more environmentally friendly type.

Reason: This is part of Ricoh's ongoing application of in-house environmental standards.

Reissued:2-Aug-06

Model: Model U-C1 Paper Tray Unit (PS510)	Date: 22-Mar-05	No.: MB456005a
---	-----------------	----------------

MB Reissue

The items in bold italics have been corrected or added.

Modified Article: Rollers		Prepared by: H.K	
From: 1st Tech. Support Sec. Service Support Dept.			
Reason for Modification:	<input type="checkbox"/> Parts catalog correction	<input type="checkbox"/> Vendor change	<input type="checkbox"/> To meet standards ()
	<input type="checkbox"/> To facilitate assembly	<input checked="" type="checkbox"/> To improve reliability	
	<input type="checkbox"/> Part standardization	<input type="checkbox"/> Other	

Old part number	New part number	Description	Q'ty	Int	Page	Index	Note
AF030049	AF030085	Pick-up Roller	1-1	X/O	7	2	
	<i>AA100014</i>	<i>Retaining Ring C – Separate</i>	<i>2-3</i>		<i>7</i>	<i>15</i>	
AF031049	AF031085	Feed Roller	1-1	X/O	7	14	
AF032049	AF032085	Separation Roller	1-1	X/O	7	23	
G5682650	G5682665	Paper Feed Unit	1-1	X/O	7	1	

Change: The material for these parts was changed.

Reason: To further improve the reliability of the parts.

Important: When you install the new pick-up roller for the first time, install it with the retaining ring together as a set.

Model: Model U-C1 Paper Tray Unit (PS510)		Date: 22-Mar-05	No.: MB456006
Modified Article: Control Board		Prepared by: S. Tomoe	
From: 1st Tech. Support Sec. Service Support Dept.			
Reason for Modification:	<input type="checkbox"/> Parts catalog correction <input type="checkbox"/> To facilitate assembly <input type="checkbox"/> Part standardization	<input type="checkbox"/> Vendor change <input type="checkbox"/> To improve reliability <input checked="" type="checkbox"/> Other	<input type="checkbox"/> To meet standards ()

Old part number	New part number	Description	Q'ty	Int	Page	Index	Note
B4565100	B4565115	Control Board	1-1	O/O	9	7	

Change: The materials for the board were changed to more environmentally-friendly types.

Reason: This is part of Ricoh's ongoing application of in-house environmental standards.

Reissued: 12-Apr-05

Model: Model U-C1 Paper Tray Unit (PS510)	Date: 22-Mar-05	No.: MB456007a
---	-----------------	----------------

MB Correction

The items in bold italics have been corrected or added.

Modified Article: Vertical Guide		Prepared by: S. Tomoe	
From: 1st Tech. Support Sec. Service Support Dept.			
Reason for Modification:	<input type="checkbox"/> Parts catalog correction	<input type="checkbox"/> Vendor change	<input type="checkbox"/> To meet standards ()
	<input type="checkbox"/> To facilitate assembly	<input type="checkbox"/> To improve reliability	
	<input type="checkbox"/> Part standardization	<input checked="" type="checkbox"/> Other	

Old part number	New part number	Description	Q'ty	Int	Page	Index	Note
A2322785	<i>B0822785</i>	Vertical Guide	1-1	O/O	7	38	

Change: The position of the Mylar on the vertical guide was changed.

Reason: To minimize paper jams that occur when feeding curled paper.

Reissued: 12-Apr-05

Model: Model U-C1 Paper Tray Unit (PS510)	Date: 22-Mar-05	No.: MB456008a
---	-----------------	----------------

MB Correction

The items in bold italics have been corrected or added.

Modified Article: Heater Harnesses		Prepared by: S. Tomoe	
From: 1st Tech. Support Sec. Service Support Dept.			
Reason for Modification:	<input type="checkbox"/> Parts catalog correction	<input type="checkbox"/> Vendor change	<input type="checkbox"/> To meet standards ()
	<input type="checkbox"/> To facilitate assembly	<input type="checkbox"/> To improve reliability	
	<input type="checkbox"/> Part standardization	<input checked="" type="checkbox"/> Other	

Old part number	New part number	Description	Q'ty	Int	Page	Index	Note
B4565340	B4565350	Heater Harness	1-1	O/O	3	20	
	<i>B4565360</i>	Heater Sub Harness	0-1		3	44	

Changes:

- 1) The material of the I/F harness (heater harness) was changed to a more environmentally-friendly type.
- 2) A relay harness was added (heater sub harness).

Reasons:

- 1) This is part of Ricoh's ongoing application of in-house environmental standards.
- 2) So that the LCT can connect to the mainframe PSU.

Note: The position of the LCT connector on the TH-C1 PSU is different from the previous model.

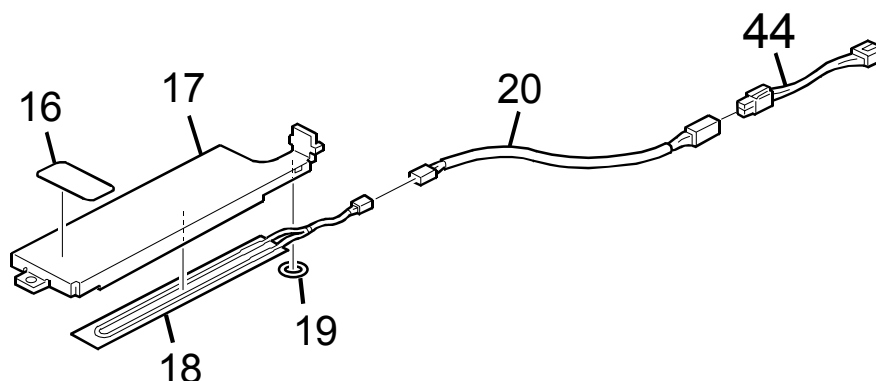

Model: Model U-C1 / TH-C1 Paper Tray Unit (PS510)		Date: 31-Jul-06	No.: MB456009
Modified Article: See Table		Prepared by: H.K.	
From: Technical Service Dept., GTS Division			
Reason for Modification:	<input type="checkbox"/> Parts catalog correction <input type="checkbox"/> To facilitate assembly <input type="checkbox"/> Part standardization	<input type="checkbox"/> Vendor change <input type="checkbox"/> To improve reliability <input type="checkbox"/> Other	<input checked="" type="checkbox"/> To meet standards (RoHS)

Old part number	New part number	Description	Q'ty	Int	Page	Index	Note
A2042972	B1802972	LEVER:RISE:TRAY BOTTOM PLATE	2	X/O	5	26	
G3132788	B5982788	CUSHION:BASE:2	2	X/O	5	29	
G3132952	B4562952	PAPER TRAY ASS'Y	2	X/O	5	1	
G5682665	G5682675	PAPER FEED UNIT: PAPER BANK:ASS'Y	2	X/O	7	1	A
G5682675	B5982660	PAPER FEED UNIT: APER BANK: ASS'Y	2	X/O	7	1	A
G5682770	B5982770	TRAY BOTTOM PLATE: HLTR: ASS'Y	2	X/O	5	12	
G5682781	G5682783	SIDE FENCE: FRONT: ASS'Y	2	X/O	5	6	
G5682782	B5982786	SIDE FENCE: REAR: ASS'Y	2	X/O	5	20	
G5682790	B5982790	COVER: PAPER SIZE SENSOR:PEEN	2	X/O	5	2	
G5696168	B6006168	BRACKET: STAND: REAR LEFT	1	X/O	3	13	
G5696169	B6006169	BRACKET: STAND: REAR RIGHT	1	X/O	3	42	

Change: The materials for these parts were changed.

Reason: To comply with the RoHS Directive.

Note:

- The functions of these parts were not changed.
- "A": The P/N for this part was changed as follows:G5682665→G5682675→B5982660.

IMPORTANT:

- The materials for the parts were changed before the part numbers were changed. To make sure the correct parts are used on the correct machines, please handle the parts as follows:

Parts with the **old** P/N:
Parts with the **new** P/N:

Non-RoHS compliant parts
RoHS compliant parts

Model: Model U-C1 / TH-C1 Paper Tray Unit (PS510)

Date: 31-Jul-06

No.: MB456009

	RoHS Compliant Parts	Non-RoHS Compliant Parts
RoHS Compliant Machines	OK	<u>DO NOT USE</u>
Non-RoHS Compliant Machines	OK	OK

- **Continue using** non-RoHS compliant parts on non-RoHS compliant machines **until the stock of these parts runs out**. Then, start using RoHS compliant parts on the non-RoHS compliant machines.
- **DO NOT use** non-RoHS compliant parts on RoHS compliant machines.
Note: This is to make sure that all machines are in full compliance with the RoHS Directive.

RCL (Japan) Production

Model	V/Hz	Destination	Code	Serial Number
PS510	120, 220-240/50, 60	All RICOH subsidiaries, NRG, SAVIN	B456-17	J39603xxxxx
PS510	220-240/50,60	Infotec	B456-26	6P5036xxxx

Model: Model U-C1 / TH-C1 Paper Tray Unit (PS510)		Date: 3-Oct-06	No.: MB456010
Modified Article: MAGNETIC CLUTCH - PAPER FEED		Prepared by: H.K.	
From: Global Tech. Support Sec. Service Support Dept.			
Reason for Modification:	<input type="checkbox"/> Parts catalog correction <input type="checkbox"/> Vendor change <input type="checkbox"/> Other <input type="checkbox"/> To facilitate assembly <input type="checkbox"/> To improve reliability <input checked="" type="checkbox"/> To meet standards (RoH S) <input type="checkbox"/> Part standardization <input type="checkbox"/> Product Safety		

Old part number	New part number	Description	Q'ty	Int	Page	Index	Note
AX200221	AX200279	MAGNETIC CLUTCH - PAPER FEED	1-1	X/O	11	5	

Change: The materials for these parts were changed.

Reason: To comply with the RoHS Directive.

Note:

- The functions of these parts were not changed.

IMPORTANT:

- The materials for the parts were changed before the part numbers were changed. To make sure the correct parts are used on the correct machines, please handle the parts as follows:

Parts with the **old** P/N:
Parts with the **new** P/N:

Non-RoHS compliant parts
RoHS compliant parts

	RoHS Compliant Parts	Non-RoHS Compliant Parts
RoHS Compliant Machines	OK	<u>DO NOT USE</u>
Non-RoHS Compliant Machines	OK	OK

- **Continue using** non-RoHS compliant parts on non-RoHS compliant machines **until the stock of these parts runs out**. Then, start using RoHS compliant parts on the non-RoHS compliant machines.
- **DO NOT use** non-RoHS compliant parts on RoHS compliant machines.
Note: This is to make sure that all machines are in full compliance with the RoHS Directive.

Model: Model U-C1 / TH-C1 Paper Tray Unit (PS510)**Date:** 3-Oct-06**No.:** MB456010

RCL (Japan) Production

Model	V/Hz	Destination	Code	Serial Number
PS510	120, 220-240/50, 60	All RICOH subsidiaries, NRG, SAVIN	B456-17	J39603xxxxx
PS510	220-240/50,60	Infotec	B456-26	6P5036xxxx

Model: Model U-C1 / TH-C1 Paper Tray Unit (PS510)		Date: 15-Jun-07	No.: MB456011
Modified Article: See Table		Prepared by: H.K.	
From: Technical Service Dept., GTS Division			
Reason for Modification:	<input type="checkbox"/> Parts catalog correction <input type="checkbox"/> To facilitate assembly <input type="checkbox"/> Part standardization	<input type="checkbox"/> Vendor change <input type="checkbox"/> To improve reliability <input type="checkbox"/> Other	<input checked="" type="checkbox"/> To meet standards (RoHS)

Old part number	New part number	Description	Q'ty	Int	Page	Index	Note
AX040128	AX040211	MOTOR – DC2.88W	2	X/O	9	4	
A2322881	B5982881	MICRO SWITCH:ON OFF DETECTOR:ASS'Y	1	X/O	9	2	
A6821067	B5421067	STAY:UPPER:PROTECT	1	X/O	3	12	
A6822559	B5422559	STOPPER:LEVER:VERTICAL TRANSPORT	1	X/O	3	31	
A6822565	B5982565	STOPPER:VERTICAL TRANSPORT:PEEN	1	X/O	3	36	
G5681187	B5981187	BRACKET:INTERFACE BOARD	1	X/O	9	8	
G5682700	B5982700	BRACKET:STEPPER MOTOR:ASS'Y	1	X/O	11	15	
G5682702	B5982703	STEPPER MOTOR – DC 4.2W	1	X/O	11	16	
G5682830	B5982830	BRACKET:STEPPER MOTOR:PEEN	1	X/O	11	18	
G5682842	B5982842	DRUM STAY:FEED ROLLER	1	X/O	11	14	
G5682990	B5982990	SUPPORTER:PAPER TRAY:ASS'Y	2	X/O	3	3	
G5685300	B5985300	HARNESS:MAIN:ASS'Y	1	X/O	9	5	
G5685310	B5985310	HARNESS:PAPER SIZE SENSOR:ASS'Y	1	X/O	9	6	
G5686560	B5986560	HEAT SINK:HEATER	1	X/O	3	17	
G5692565	B6002565	GUIDE PLATE:VERTICAL TRANSPORT	1	X/O	3	28	
G5692846	B6002846	DRUM STAY:FEED ROLLER:UPPER	1	X/O	11	7	

Change: The materials for these parts were changed.

Reason: To comply with the RoHS Directive.

Model: Model U-C1 / TH-C1 Paper Tray Unit (PS510)

Date: 15-Jun-07

No.: MB456011

Note:

- The functions of these parts were not changed.

IMPORTANT:

- The materials for the parts were changed before the part numbers were changed. To make sure the correct parts are used on the correct machines, please handle the parts as follows:

Parts with the **old** P/N: **Non-RoHS** compliant parts
Parts with the **new** P/N: **RoHS** compliant parts

	RoHS Compliant Parts	Non-RoHS Compliant Parts
RoHS Compliant Machines	OK	<u>DO NOT USE</u>
Non-RoHS Compliant Machines	OK	OK

- **Continue using** non-RoHS compliant parts on non-RoHS compliant machines **until the stock of these parts runs out**. Then, start using RoHS compliant parts on the non-RoHS compliant machines.
- **DO NOT use** non-RoHS compliant parts on RoHS compliant machines.
Note: This is to make sure that all machines are in full compliance with the RoHS Directive.

RCL (Japan) Production

Model	V/Hz	Destination	Code	Serial Number
PS510	120, 220-240/50, 60	All RICOH subsidiaries, NRG, SAVIN	B456-17	J39603xxxxx
PS510	220-240/50,60	Infotec	B456-26	6P5036xxxx

Model: Model U-C1 / TH-C1 Paper Tray Unit (PS510)		Date: 3-Jul-07	No.: MB456012
Modified Article: See Table		Prepared by: H.K.	
From: Technical Service Dept., GTS Division			
Reason for Modification:	<input type="checkbox"/> Parts catalog correction <input type="checkbox"/> To facilitate assembly <input type="checkbox"/> Part standardization	<input type="checkbox"/> Vendor change <input type="checkbox"/> To improve reliability <input type="checkbox"/> Other	<input checked="" type="checkbox"/> To meet standards (RoHS)

Old part number	New part number	Description	Q'ty	Int	Page	Index	Note
G5682689	B5982689	SHAFT:SEPARATE:DRIVE N:BANK:ASS'Y	1	X/O	7	21	
AW020131	AW020161	PHOTOINTERRUPTOR:VERTICAL TRANSPORT	1	X/O	7	7	
A2322780	B1802780	STAY:FEED	1	X/O	7	8	
A2322781	B0772781	BRACKET:SENSOR	1	X/O	7	6	
G0602725	B1802722	STAY: SEPARATE: NO.2: ASS'Y	1	X/O	7	24	
G5685370	B5985370	HARNESS: PAPER FEED UNIT:ASS'Y	1	X/O	7	10	

Change: The materials for these parts were changed.

Reason: To comply with the RoHS Directive.

Note:

- The functions of these parts were not changed.

IMPORTANT:

- The materials for the parts were changed before the part numbers were changed. To make sure the correct parts are used on the correct machines, please handle the parts as follows:

Parts with the **old** P/N:
Parts with the **new** P/N:

Non-RoHS compliant parts
RoHS compliant parts

	RoHS Compliant Parts	Non-RoHS Compliant Parts
RoHS Compliant Machines	OK	<u>DO NOT USE</u>
Non-RoHS Compliant Machines	OK	OK

- **Continue using** non-RoHS compliant parts on non-RoHS compliant machines **until the stock of these parts runs out**. Then, start using RoHS compliant parts on the non-RoHS compliant machines.

Model: Model U-C1 / TH-C1 Paper Tray Unit (PS510)

Date: 3-Jul-07

No.: MB456012

- **DO NOT use** non-RoHS compliant parts on RoHS compliant machines.

Note: This is to make sure that all machines are in full compliance with the RoHS Directive.

RCL (Japan) Production

Model	V/Hz	Destination	Code	Serial Number
PS510	120, 220-240/50, 60	All RICOH subsidiaries, NRG, SAVIN	B456-17	J39603xxxxx
PS510	220-240/50,60	Infotec	B456-26	6P5036xxxx



Part Change Information List

Date: January 31, 2013

Model	Code	PCIL Number	PCIL Correction	Old part number	New part number	Description	Old Q'ty	New Q'ty	Int	3DPC	Page	Index	Set	Set Int	RTB	Note	Ref Number	ECN Number
U-C1 Paper Tray Unit (PS510)	B456	201301		AH012014	AH012050	CASTER:STOPPER:NO	2	2	O/O		3	5					V1203033	12091652



Part Change Information List

Date: June 30, 2014

Model	Code	PCIL Number	PCIL Correction	Old part number	New part number	Description	Old Q'ty	New Q'ty	Int	3DPC	Page	Index	Set	Set Int	RTB	Note	Ref Number	ECN Number
U-C1 Paper Tray Unit (PS510)	B456	201406		AX040211	D0599500	MOTOR - DC2.88W	2	2	O/O		9	4					V1401371	