

Paper Tray Unit (Machine Code: B421)

INSTALLATION PROCEDURE FOR CUSTOMERS

For Code: H555/556/557 Facsimile Machines

CAUTION:

- When you move the machine, unplug the power cord from the wall outlet to avoid fire or electric shock. When you pull out the plug from the socket, grip the plug to avoid damaging the cord and causing a fire or electric shock.
- There is a risk of electric shock if you plug or unplug the power cord with wet hands.



Important

- ☐ Check the facsimile machine nameplate to confirm the model code.
- ☐ Make sure that 100% is shown on the display before you turn the power switch off or unplug the power cord. Fax files stored in memory will be deleted 12 hours after you turn the power switch off or unplug the power cord.
- ☐ Do not pull two paper trays out at the same time. Having two paper trays filled with paper in a fully extended position could cause the machine to fall over.



Note

- ☐ You can install one optional paper tray unit yourself. If your machine is H556 or H557, your service representative can install one more optional paper tray unit. If you want to install the second optional paper tray unit for H556/557, please contact your service representative.

- 1** Turn off the power switch of the machine.
- 2** Unplug the power cord of the machine from the outlet.
- 3** Unplug the telephone line from the machine.

- 4** Remove the tape at [A], and then remove the tape and cardboard at [B].

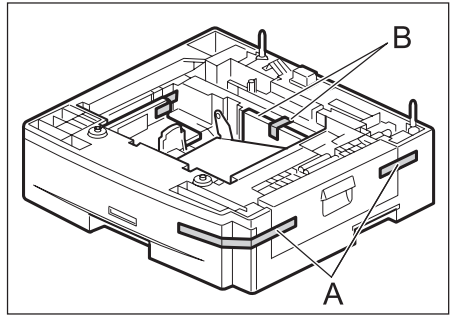

- 5** Pull the paper tray out of the unit, and then remove the tape and cardboard at [C] and [D].

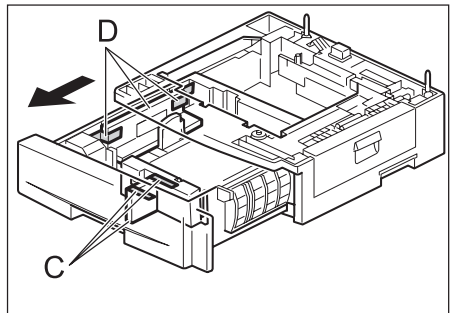

- 6** If necessary, adjust the paper size of the paper tray.



Reference

- ☐ For information about changing paper size, see "Changing the Paper Size in the Optional Paper Tray Unit" in the Advanced Features manual.

- 7** Push the paper tray in until it stops.



- 8** There are two pins on the top of the paper tray unit that point straight up. On the bottom of the machine there are two holes. Align the holes over the pins and lower the machine gently onto the paper tray unit.

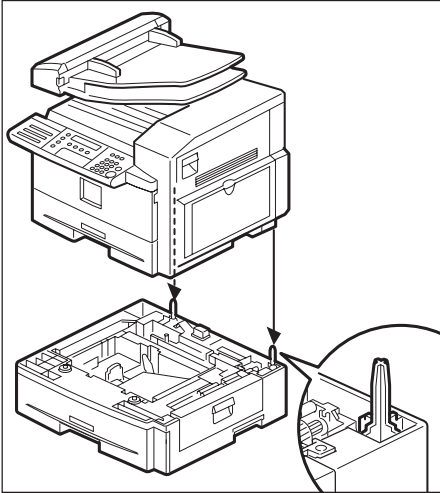

CAUTION:

- When lifting the machine, use the inset grips on both sides. The machine could be damaged or cause injury if dropped.

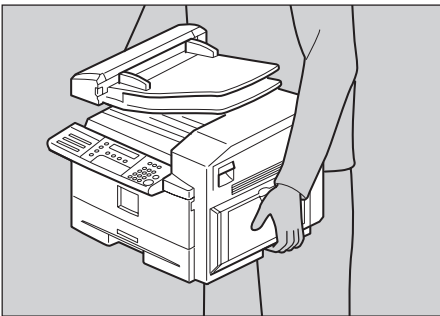

- 9** Stick the appropriate tray-number decal and paper-size decal onto the places indicated in the illustration.

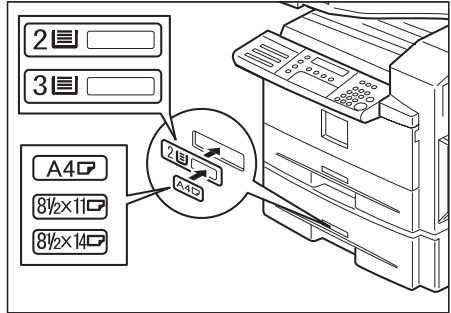

- 10** Connect the telephone line to the machine.
- 11** Plug the power cord of the machine back into the outlet, and then turn the power switch on.
- 12** If you changed the paper size of the paper tray, set the paper size with the User Tools.

Reference

- ☐ For information about setting paper size, see “Changing the Paper Size Setting” for H555 users or “Tray Paper Size” for H556 and 557 users in the Advanced Features manual.

After Setting the Paper Tray Unit

Reference

- ☐ For information about loading paper, see “Loading Paper in the Optional Paper Tray Unit” in the Advanced Features manual.

