

RTB CorrectionReissue date: **15- Jun -97**

The items in bold italic have been corrected and the illustrations have changed as shown below.

Model: AD-1		Date: 19-Mar-97	No: 26A
Subject: Paper jam		Prepared by: M.Horiike	
From: QAC 2nd Field Information Dept.			
Classification:	<input type="checkbox"/> Troubleshooting	<input checked="" type="checkbox"/> Part information	<input type="checkbox"/> Action required
	<input type="checkbox"/> Mechanical	<input type="checkbox"/> Electrical	<input type="checkbox"/> Service manual revision
	<input type="checkbox"/> Paper path	<input type="checkbox"/> Transmit/receive	<input type="checkbox"/> Retrofit information
	<input type="checkbox"/> Other ()		

SYMPTOM

Paper jam from the ***paper tray unit (PS 330)***.

CAUSE

The paper contacted the uneven edge of the upper guide paper feed.

SOLUTION

The shape of the upper guide - paper feed has been changed from January Production '97.

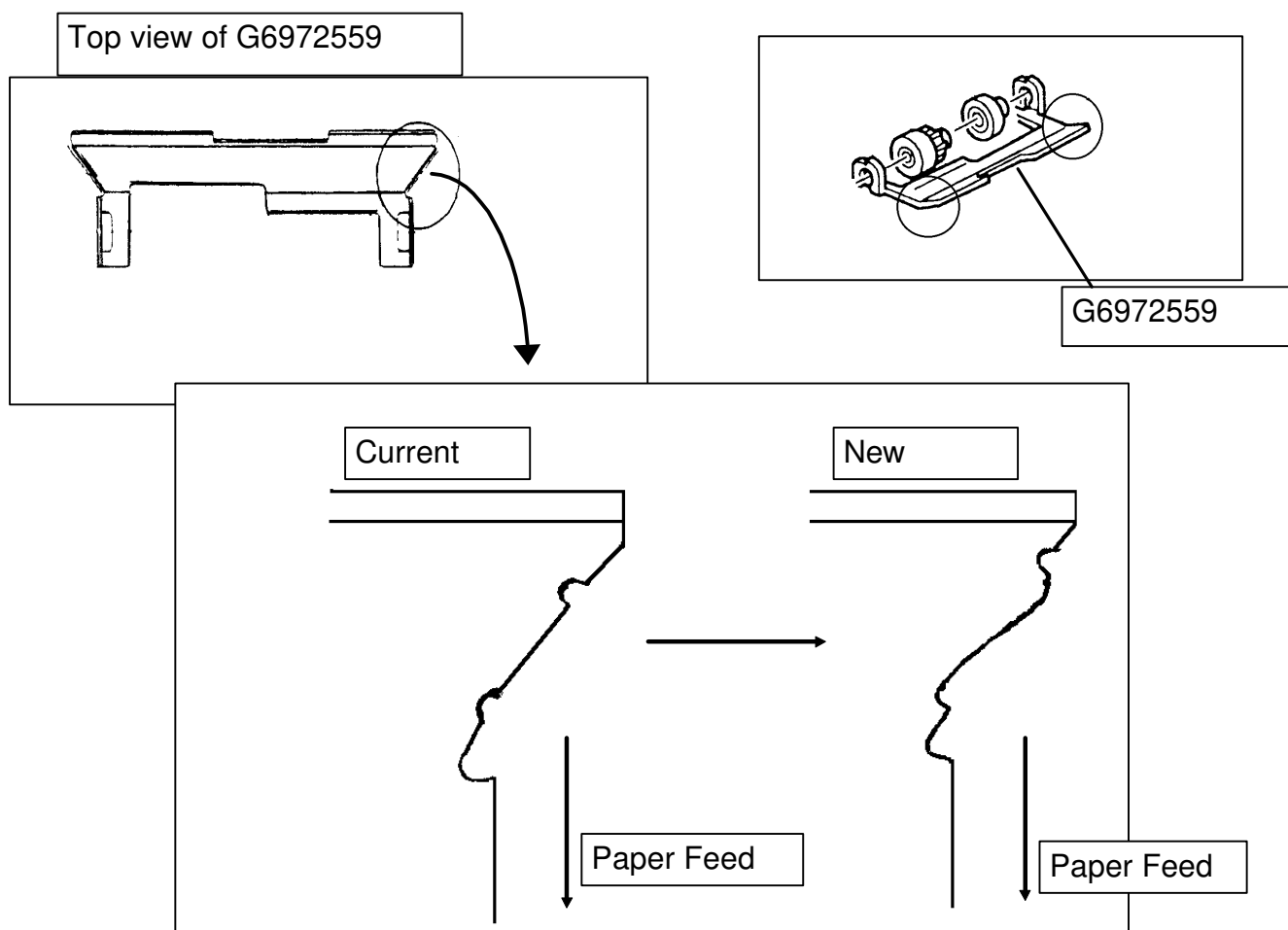

Model: AD1-Paper Tray Unit (PS330)		Date: 23-Jul-97	No: 36
Subject: Noise		Prepared by: K.Ugaeri	
From: QAC 2nd Field Information Dept.			
Classification:	<input type="checkbox"/> Troubleshooting	<input type="checkbox"/> Part information	<input checked="" type="checkbox"/> Action required
	<input type="checkbox"/> Mechanical	<input type="checkbox"/> Electrical	<input type="checkbox"/> Service manual revision
	<input type="checkbox"/> Paper path	<input type="checkbox"/> Transmit/receive	<input type="checkbox"/> Retrofit information
	<input type="checkbox"/> Other ()		

SYMPTOM

Noise from the bushing of the transport roller (AF02 0377).

CAUSE

The surface of some transport rollers are rough.

SOLUTION

Lubricate the bushing if the noise occurs.

* They are now selecting the transport roller on the production line.

Model: PS330 (Paper Tray for AD1/AD1-E)		Date: 15-Dec-97	No: 47
Subject: Paper Feed Roller		Prepared by: K.Ugaeri	
From: QAC Field Information Dept.			
Classification:	<input checked="" type="checkbox"/> Troubleshooting <input type="checkbox"/> Part information <input type="checkbox"/> Action required <input type="checkbox"/> Mechanical <input type="checkbox"/> Electrical <input type="checkbox"/> Service manual revision <input type="checkbox"/> Paper path <input type="checkbox"/> Transmit/receive <input type="checkbox"/> Retrofit information <input type="checkbox"/> Other ()		

SYMPTOM: Paper jam

CAUSE: Paper skewing or no feed from PS330 (Paper Tray)

Countermeasure: The diameter of the paper feed roller has been modified from 30φ to 32φ to improve paper feed.

Action Required: Ricoh has prepared a countermeasure roller kit for the machines in the field and sent them to each subsidiary.

RC: 2150 sets (4 rollers/set)

RE: 3750 sets (4rollers/set)

RH: 374 sets (4rollers/set)

* Use these new rollers for machines which have the paper jam problem.

2. Paper Feed Section (G697)

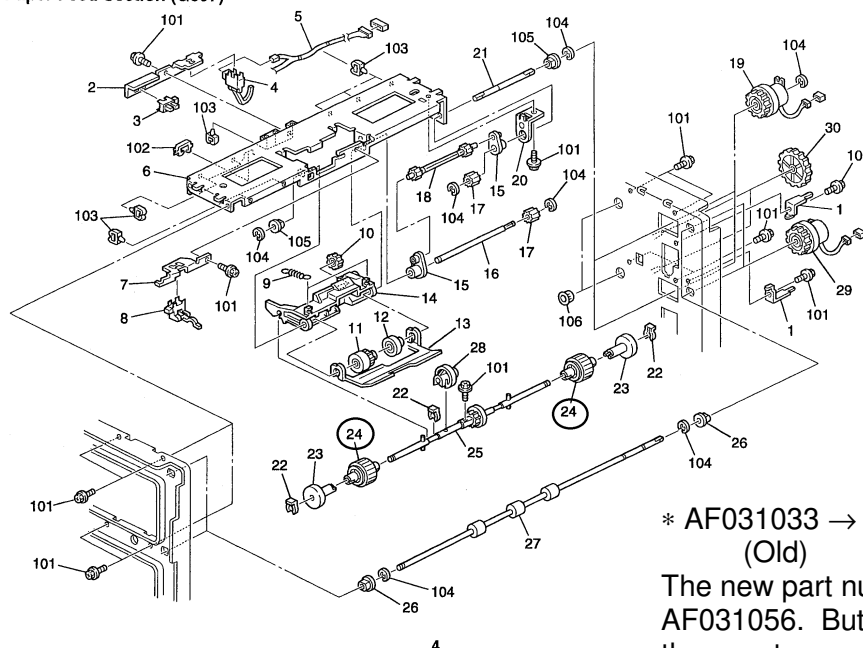

* AF031033 → AF031056
(Old) (New)

The new part number of the feed roller is AF031056. But do not order this part until the countermeasure kit is out of stock.

*The new rollers are available from September production '97