

ISSUED ON: March 31, '94

Model	LCT / Duplex Unit for C4MF	Volt/Hz	Date of Modification	Serial Number
Modified Article	Parts Catalog			
Reason for Modification	Parts catalog correction			

Please correct your parts catalog as follows:

P/N	Description	Incorrect Q'ty	Correct Q'ty	Parts Catalog	
				Index No.	Page
A3064730	Fork Gate Pawl - Large	2	1	18	23

S. Hamano, Assistant General Manager
Technical Support Department

MODEL NAME	V/Hz	DESTINATION	CODE	SERIAL NUMBER
Ricoh PS310	115/60	U. S. A.	A305-17	
Ricoh PS320	115/60	U. S. A.	A306-17	

Model	LCT / Duplex Unit for C4MF	Volt/Hz	Date of Modification	Serial Number
Modified Article	Microswitch and LED Sensor Type - T			
Reason for Modification	Parts standardization			

Due to parts standardization with the other products, the following parts have been changed. The interchangeability is O/O.

Old P/N	New P/N	Description	Q'ty Used	Parts Catalog	
				Index No.	Page
12042233	12042356	Microswitch - AH715254N	1 → 0	111	11
		Microswitch - AM51612A531	0 → 1	111	11
52055251	AW020041	LED Sensor Type - T	1 → 0	9	25
		Photointerruptor	0 → 1	9	25

S. Hamano, Assistant General Manager
Technical Support Department

MODEL NAME	V/Hz	DESTINATION	CODE	SERIAL NUMBER
Ricoh PS310	115/60	U. S. A.	A305-17	
Ricoh PS320	115/60	U. S. A.	A306-17	

MODIFICATION BULLETIN NO. 3

PAGE 1 OF 3

ISSUED ON: June 30, '94

[illegible]

Rank: A : Replace with new parts immediately. B : Replace with new parts at time of repair. C : Replace with new parts at time of overhaul.

Interchangeability:

(1) When old and new parts are not mutually interchangeable, use additional parts or an assembly part as indicated in "Parts needed for replacement by new part" to install the new part.

(2) The mark to the left of the slash indicates whether the old part can be used in the new machine, and the mark to the right indicates whether the new part can be used in the old machine. x = Not interchangeable o = Interchangeable

DETAILS OF MODIFICATION

The cylindrical pins on the reverse roller drive shafts have been changed to spring pins. To facilitate servicing, the assembled parts will be supplied as service parts in stead of the individual parts as shown below.

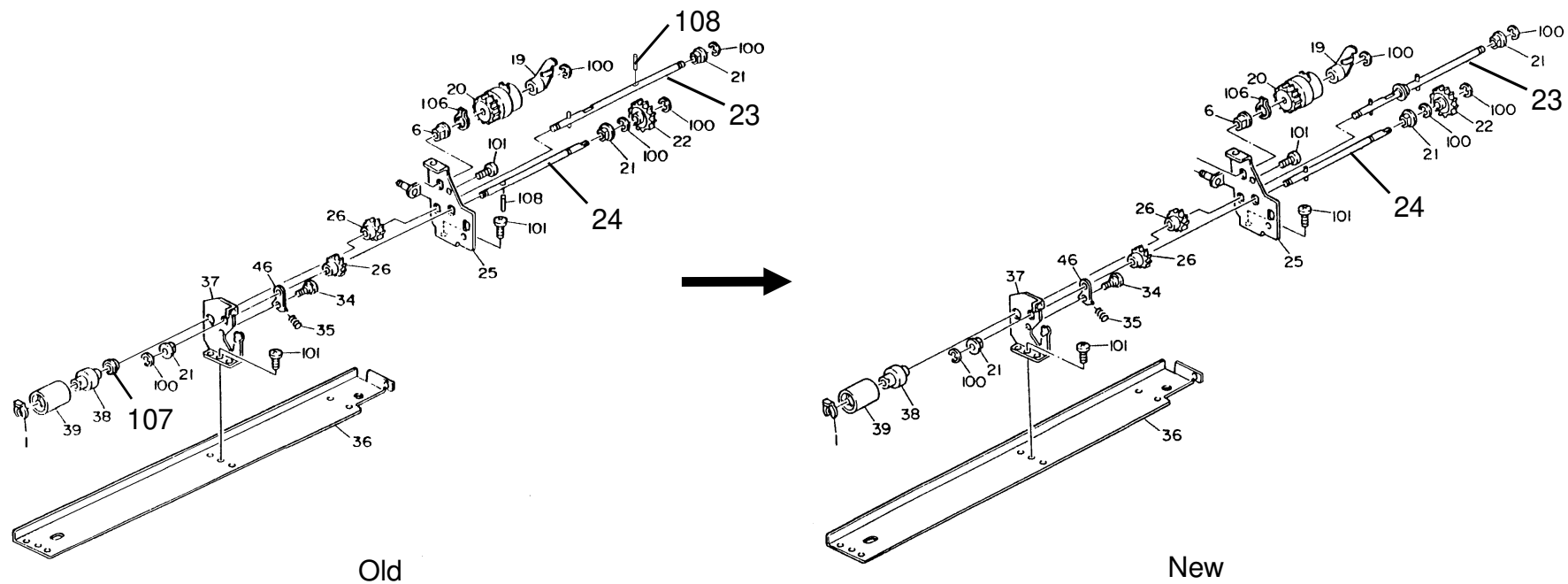

S. Hamano, Assistant General Manager
Technical Support Department

MODEL NAME	V/Hz	DESTINATION	CODE	SERIAL NUMBER
Ricoh PS310	115/60	U. S. A.	A305-17	A3254030001
Ricoh PS320	115/60	U. S. A.	A306-17	A3264030001

ISSUED ON: August 31, '94

Model	LCT / Duplex Unit for C4MF	Volt/Hz	Date of Modification	Serial Number
Modified Article	Parts Catalog			
Reason for Modification	Parts catalog correction			

Note: The modification bulletins for NRG start from this issue.

Please correct your parts catalog as follows:

Incorrect P/N	Incorrect Description	Correct P/N	Correct Description	Parts Catalog	
				Index No.	Page
52055251	LED Sensor Type - T	AW020041	Photointerruptor	9	25

S. Hamano, Assistant General Manager
Technical Support Department

MODEL NAME	V/Hz	DESTINATION	CODE	SERIAL NUMBER
Ricoh PS310	115/60	U. S. A.	A305-17	
Ricoh PS320	115/60	U. S. A.	A306-17	
Nashuatec / Gestetner DIGLCT1	220 ~ 240/50	Europe	A305-25	
Nashuatec / Gestetner DIGLCTD	220 ~ 240/50	Europe	A306-25	

Model	LCT / Duplex Unit for C4MF	Volt/Hz	Date of Modification	Serial Number
Modified Article	Caster - 150kg / Bolt			
Reason for Modification	To fully secure the casters.			

To ensure that the casters are secure, the bolt has been changed to a glue coated type.
(The caster has also been changed for parts standardization.)

Old P/N	New P/N	Description	Q'ty Used	Inter-change-ability	Parts Catalog	
					Index No.	Page
08055007		Caster - 150 Kg	n → n-2	O/	106	7
	AH012015	Caster - 1470N	0 → 2	/O	* 30	7
05760101B		Bolt - M6 x 10	n → n-12	X/	104	7
	A3211065	Hexagon Head Bolt - M6 x 10	0 → 12	/O	* 31	7

* New Index

M. Iwasa, Manager
Technical Support Department

MODEL NAME	V/Hz	DESTINATION	CODE	SERIAL NUMBER
Ricoh PS310	115/60	U. S. A.	A305-17	A325602XXXX
Ricoh PS320	115/60	U. S. A.	A306-17	A326602XXXX
Nashuatec / Gestetner DIGLCT1	220, 240/50	Europe	A305-25	549602XXXX
Nashuatec / Gestetner DIGLCTD	220, 240/50	Europe	A306-25	550602XXXX