

**Reissued:17-Nov-11**

Model: Orval-C1 Printer/Scanner Unit Type3352	Date: 16-Nov-11	No.: RD595001a
---	-----------------	----------------

**RTB Reissue**

The items in ***bold italics*** have been corrected.

Subject: Service Manual Correction		Prepared by: T. Nihei	
From: 2nd Tech Service Sect., MFP/P Tech Service Dept.			
Classification:	<input type="checkbox"/> Troubleshooting <input type="checkbox"/> Mechanical <input type="checkbox"/> Paper path <input type="checkbox"/> Product Safety	<input type="checkbox"/> Part information <input type="checkbox"/> Electrical <input type="checkbox"/> Transmit/receive <input type="checkbox"/> Other (            )	<input type="checkbox"/> Action required <input checked="" type="checkbox"/> Service manual revision <input type="checkbox"/> Retrofit information <input type="checkbox"/> Tier 2

**Service Manual Correction**

The areas in **bold** were added/corrected.

**D595 Service Manual**
**“1. Installation –SD card Appli Move ”**

Module Type	SD Card							
	SD Card provided with the SP model	Printer Unit	Scanner Enhance Option	Printer/Scanner Unit	VM card	PS3 Unit	IPDS Unit	Browser Unit
App2Me*	O	-	-	-	-	-	-	-
Printer	O	<b>O</b>	-	O	-	-	-	-
Scanner	O	-	O	O	-	-	-	-
PDF direct	<b>X</b>	X	-	<b>X</b>	-	<b>X</b>	-	-
Java-VM	O	-	-	-	X	-	-	-
PS	-	-	-	-	-	O	-	-
IPDS	-	-	-	-	-	-	O	-
Browser	-	-	-	-	-	-	-	O

**X:** Cannot move to another SD card.

\*: To use App2Me on models other than the SP model, it must be downloaded from the App2Me Web site. Java-VM is required.

The VM card and service SD cards must be installed in slot 2. Other SD cards can be installed in either slot.

**The Java-VM function on the VM card** cannot be moved to another card.

**The PDF direct function** cannot be moved to another card.

**Reissued:17-Nov-11****Model: Orval-C1 Printer/Scanner Unit Type3352****Date: 16-Nov-11****No.: RD595001a****“1. Installation –Printer and P/S Options ”**

SD Card Options	SD Card Size	Module Size
Printer Unit Type 3352	32 MB	8.3 MB
Printer/Scanner Unit Type 3352	<b>64 MB</b>	9.3 MB
Scanner Enhance Option Type3352	<b>32 MB</b>	3 MB
Post Script3 Unit type 3352	<b>32 MB</b>	14.6 MB
IPDS Unit Type 3352	32 MB	10.5 MB
Browser Unit Type E	32 MB	14.7 MB

- **The “size” refers to the maximum size for running each model.**

**“1. Installation –IPDS Unit ”**

1. Check the software versions.

Make sure the following versions are installed.

Firmware Name	Version	Firmware Number
System/Copy	<b>V1.04</b> or later	<b>D1205530A</b>
<b>Network Support</b>	<b>V10.65</b> or later	<b>D1205544A</b>
<b>Web Support</b>	<b>V1.01</b> or later	<b>D1205539A</b>
Printer	<b>V1.04</b> or later	<b>D1205547C</b>
IPDS	<b>V8.042</b> or later	<b>D1205563</b>

Model: OR-C1 Printer/Scanner Option Type 3352		Date: 26-Dec-11	No.: RD595002
Subject: Parts Catalog Correction (Bracket for D589)		Prepared by: T. Nihei	
From: 2nd Tech Service Sect., MFP/P Tech Service Dept.			
Classification:	<input type="checkbox"/> Troubleshooting <input type="checkbox"/> Mechanical <input type="checkbox"/> Paper path <input type="checkbox"/> Product Safety	<input checked="" type="checkbox"/> Part information <input type="checkbox"/> Electrical <input type="checkbox"/> Transmit/receive <input type="checkbox"/> Other (     )	<input type="checkbox"/> Action required <input type="checkbox"/> Service manual revision <input type="checkbox"/> Retrofit information <input type="checkbox"/> Tier 2

Part number	Description	Q'ty	Int	Page	Index	Note
D3775697	VELCRO FASTENER:COVER:ANTENNA:400	1		5	18	
D3775698	VELCRO FASTENER:COVER:ANTENNA:250	1		5	19	
D5931285	COVER:RIGHT:WELDING	1		5	20	
D5945601	HARNESS:CTL:GROUND WIRE:800	1		5	21	
03603006N	SCREW - M3X6	1		5	105	

**Change:** The parts in the table were newly added.

**Reason:** These parts are necessary when installing the D589 Booklet Finisher, in order to attach the USB/SD Slot.

USB2.0/SD Slot Type H (D594-31)

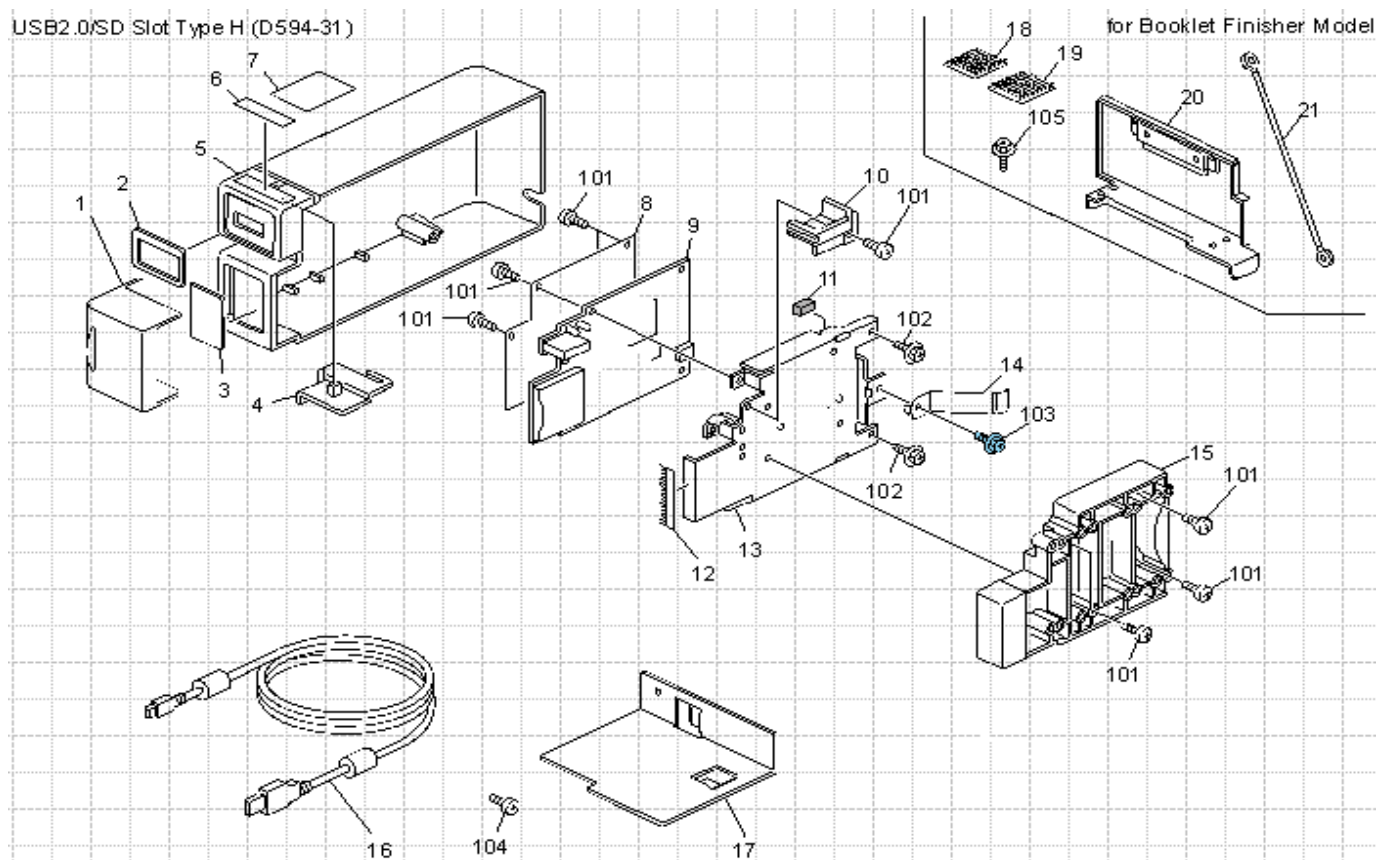

Model:OR-C1 Printer/Scanner Option Type 3352		Date: 01-Feb-12	No.: RD595003
Subject: Service Manual Correction (Service Tables)		Prepared by: T. Nihei	
From: 2nd Tech Service Sect., MFP/P Tech Service Dept.			
Classification:	<input type="checkbox"/> Troubleshooting <input type="checkbox"/> Mechanical <input type="checkbox"/> Paper path <input type="checkbox"/> Product Safety	<input type="checkbox"/> Part information <input type="checkbox"/> Electrical <input type="checkbox"/> Transmit/receive <input type="checkbox"/> Other (     )	<input type="checkbox"/> Action required <input checked="" type="checkbox"/> Service manual revision <input type="checkbox"/> Retrofit information <input type="checkbox"/> Tier 2

## Service Manual Correction

**Delete** the SP modes ~~crossed-out~~ below, and **add** the ones in regular text.

### D595 Service Manual

#### 2. Service Tables

##### - Printer Service Tables

<del>1005</del>	<del>[Display Version]</del>
<del>1005-1</del>	<del>Disp. Version</del>
	<del>Displays the version of the controller firmware.</del>

##### - Scanner Service Tables

1011	[Org Count Disp]	*CTL	[0 or 1 / 0 / -] 0: No display, 1: Display
1011 1	This SP code switches the original count display on/off.		

1012	[User Info Release]	*CTL	[0 or 1 / 1 / -] 0: Do not release, 1: Release
1012 1	This SP code sets the machine to release or not release the following items at job end. <ul style="list-style-type: none"> <li>• Destination (E-mail/Folder/CS)</li> <li>• Sender name</li> <li>• Mail text</li> <li>• Subject line</li> <li>• File name</li> </ul>		

1013	[Scan Media Device Setting]	*CTL	[0 or 1 / 1 / -]
------	-----------------------------	------	------------------

Model:OR-C1 Printer/Scanner Option Type 3352	Date: 01-Feb-12	No.: RD595003
--	-----------------	---------------

			0: Disable, 1: Enable
1013 1	This SP code enables/disables the multi-media function option (USB2.0/SD slot) mounted on the left rear corner of the machine. Operators can scan documents to either an SD card or a USB memory device inserted into this unit. This SP must be enabled (set to "1") in order for the device to function.		

2025	[Compression ratio of ClearLight PDF JPEG2000]		
	Selects the compression ratio for ClearLight PDF for the two settings that can be selected at the operation panel.		
2025 1	Compression Ratio (Normal) JPEG2000	*CTL	[5 to 95 / 25 / 1 /step]
2025 2	Compression Ratio (High) JPEG2000		5 to 95 / 25 / 1 /step]

Model: OR-C1 Printer/Scanner Option Type3352		Date: 23-Feb-12	No.: RD595004
Subject: P/S SD card for SP Model		Prepared by: T. Nihei	
From: 2nd Tech Service Sect., MFP/P Tech Service Dept.			
Classification:	<input type="checkbox"/> Troubleshooting <input type="checkbox"/> Mechanical <input type="checkbox"/> Paper path <input type="checkbox"/> Product Safety	<input checked="" type="checkbox"/> Part information <input type="checkbox"/> Electrical <input type="checkbox"/> Transmit/receive <input type="checkbox"/> Other (     )	<input type="checkbox"/> Action required <input type="checkbox"/> Service manual revision <input type="checkbox"/> Retrofit information <input type="checkbox"/> Tier 2

Part number	Description	Q'ty	Page	Index	Note
D1205524	SD-CARD:P/S/VM/CAL:EXP:ASS'Y	1	3	1	

**Change/Reason:** This part was missing from the Parts Catalog.

**Note:** This part is for the SP model only, and contains the Java VM and App2Me application.

Model: OR-C1 Printer/Scanner Option Type3352		Date: 19-Oct-12	No.: RD595005
Subject: Important Notice: Decal for IPDS Option		Prepared by: T. Nihei	
From: 2nd Tech Service Sect., MFP/P Tech Service Dept.			
Classification:	<input type="checkbox"/> Troubleshooting	<input type="checkbox"/> Part information	<input checked="" type="checkbox"/> Action required
	<input type="checkbox"/> Mechanical	<input type="checkbox"/> Electrical	<input type="checkbox"/> Service manual revision
	<input type="checkbox"/> Paper path	<input type="checkbox"/> Transmit/receive	<input type="checkbox"/> Retrofit information
	<input type="checkbox"/> Product Safety	<input checked="" type="checkbox"/> Other (Certification)	<input type="checkbox"/> Tier 2

## Important Notice About the Decal for the IPDS Option

**Do not** attach the “IBM Technology with IPDS” decal for the IPDS option **until the option has been certified by IBM**. As of the issuing of this RTB, IBM has not yet certified the option.

Decal:



### From the Service Manual:

#### Accessories

Check the accessories and their quantities against the table below.

No.	Description	Q'ty
1	IPDS Emulation SD Card	1
2	Decal	1

**Installation**

---

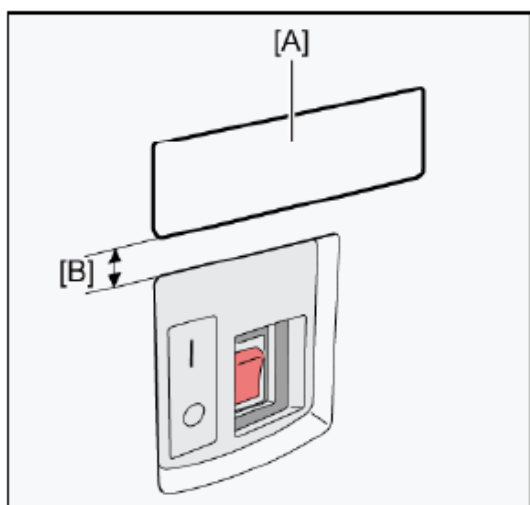

d596i514

8. Attach the decal [A] as shown above.

- Line up the left side of the decal with the left edge of the main power switch. ([B]: 10 mm or more)