

Model:Stella-C1

Date:20-Jun-02

No.: MB044001



Modified Article: Parts catalog correction

Prepared by: M.Ishihara

From: Technical Services sec. Service Planning Dept.

Reason for
Modification:

- ☒ Parts catalog correction
☐ To facilitate assembly
☐ Part standardization

- ☐ Vendor change
☐ To improve reliability
☐ Other

☐ To meet standards
()

Please make the following corrections to your Parts Catalogs.

- Please ADD the following:

| Part Number | Description | Q'ty | Int | Page | Index | Note |
|-------------|--------------------------------|------|-----|------|-------|------|
| B0457507 | Model Name Plate-REX (B045) | 1 | | 7 | 32 | |
| B0497507 | " (B049) | | | | | |
| B0447507 | " (B044) | | | | | |
| B0467507 | " (B046) | | | | | |
| B0457508 | Model Name Plate-GES EU (B045) | | | | | |
| B0497508 | " (B049) | | | | | |
| B0447508 | " (B044) | | | | | |
| B0467508 | " (B046) | | | | | |
| B0457501 | Model Name Plate-RIC (B045) | | | | | |
| B0497501 | " (B049) | | | | | |
| B0447501 | " (B044) | | | | | |
| B0467501 | " (B046) | | | | | |
| B0457502 | Model Name Plate-NSA (B045) | | | | | |
| B0497502 | " (B049) | | | | | |
| B0447502 | " (B044) | | | | | |
| B0467502 | " (B046) | | | | | |
| B0457503 | Model Name Plate-INF (B045) | | | | | |
| B0497503 | " (B049) | | | | | |
| B0447503 | " (B044) | | | | | |
| B0467503 | " (B046) | | | | | |
| B0457504 | Model Name Plate-LAN (B045) | | | | | |
| B0447504 | " (B049) | | | | | |
| B0467504 | " (B044) | | | | | |
| B0467504 | " (B046) | | | | | |
| AA003011 | Manual Feed Decal | 1 | | 11 | 18 | |

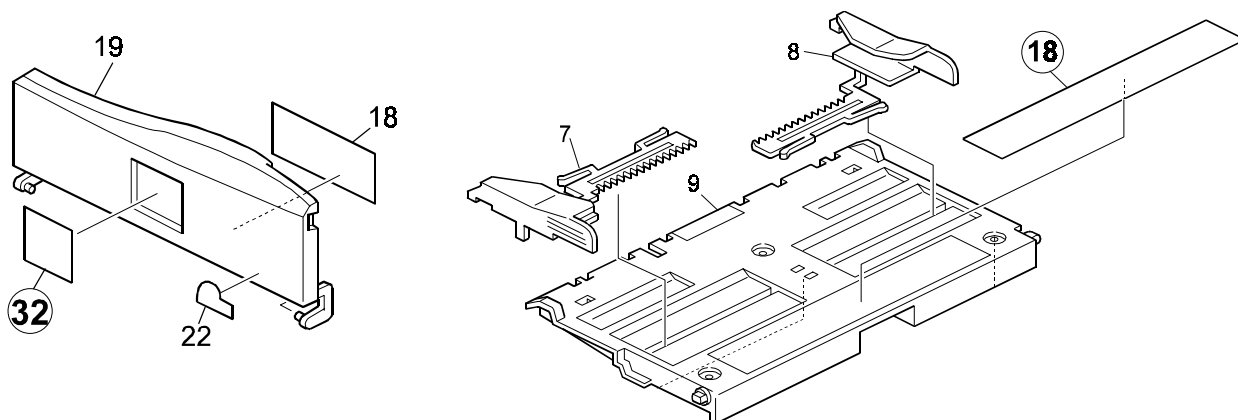

Model:Stella-C1

Date:20-Jun-02

No.: MB044001

- Please CORRECT the following:

| Part Number | Incorrect Description | Correct Description | Page | Index |
|-------------|-----------------------|-----------------------------|------|-------|
| B0441804 | Left Scale Ass'y - AA | Left Scale Ass'y - NA, ASIA | 7 | 12 |
| B0441831 | Left Scale | Left Scale Ass'y - NA, ASIA | 7 | 31 |

- Please CORRECT the following (pg. 18):
 Incorrect: In the illustration below, index #5 and #9 both point to the Platen Cover.
 Correct: Index #9 is for the Platen Cover, and index #5 is for the Original Table (B0444948).

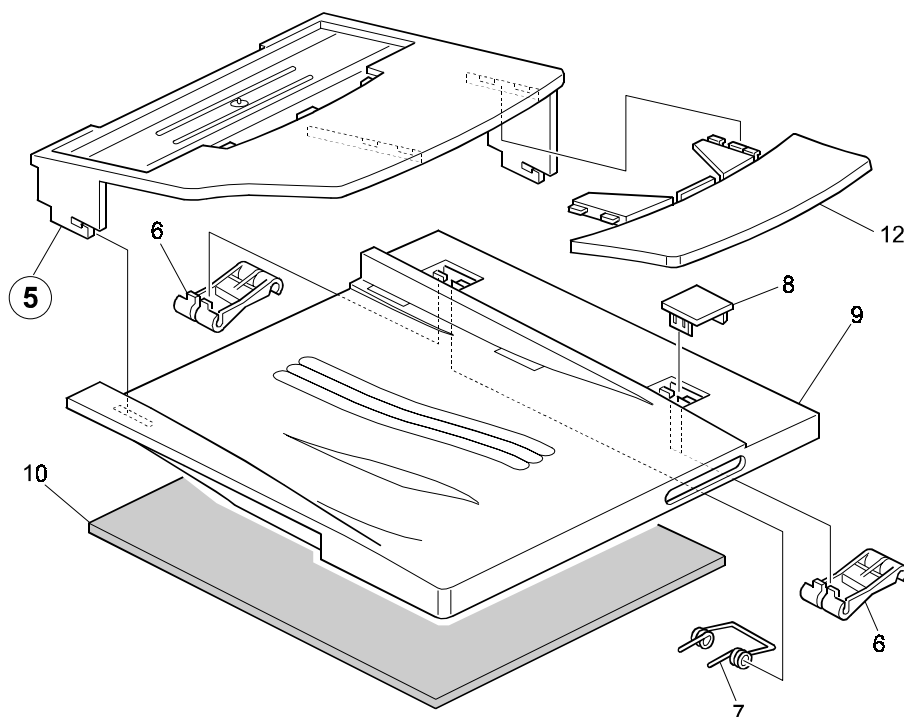

- Please DELETE the following:

<Printer Controller Type 1013 (B441)>

| Part Number | Description | Page | Index |
|-------------|--------------|------|-------|
| B4058594 | CD-ROM (NRG) | 2, 3 | 6 |
| B4418595 | CD-ROM (INF) | 2, 3 | 6 |
| B4418596 | CD-ROM (LAN) | 2, 3 | 6 |

| | | | |
|--|--|--|---|
| Model: Stella-C1/F1 Printer Controller | | Date: 10-Dec-02 | No.: MB441001 |
| Modified Article: Reviewing of Printer Option for S-F1 release | | Prepared by: A. Ishiyama | |
| From: Technical Services sec. Service Planning Dept. | | | |
| Reason for Modification: | <input checked="" type="checkbox"/> Parts catalog correction <input type="checkbox"/> To facilitate assembly <input type="checkbox"/> Part standardization | <input type="checkbox"/> Vendor change <input type="checkbox"/> To improve reliability <input type="checkbox"/> Other () | <input type="checkbox"/> To meet standards () |
| Modification Schedule: | All new parts are available from the first mass production of the S-F1. | | |

The following P/N have been changed due to parts standardization of the printer option for the S-C1 and S-F1.

Note: These changes have already been applied to the printer option parts catalog.

| Old part number | New part number | Description | Q'ty | Int | Page | Index | Note |
|-----------------|-----------------|----------------------------------|------|-----|------|-------|------|
| B4415170 | B4415175 | Controller Board S-C1/F1 | 1→1 | * | 3 | 1 | 1 |
| B4418607 | B4418857 | Operation Manual – REF-1 English | 1→1 | * | 3 | 5 | 1 |
| B4058594 | | CD ROM (NRG) | 1→0 | -- | 3 | 6 | 2 |
| B4418595 | | CD ROM (INF) | 1→0 | -- | 3 | 6 | 2 |
| B4418596 | | CD ROM (LAN) | 1→0 | -- | 3 | 6 | 2 |
| | B4411456 | Printer Decal – S-F1 : NA/Asia | 0→1 | -- | 3 | 10 | 3 |
| | B4411457 | Printer Decal – S-F1 : EU | 0→1 | -- | 3 | 10 | 3 |

Note:

- The interchangeability between these two parts is as follows:
Both can be used with the S-C1 printer, but the old part cannot be used with the S-F1 printer.
- This P/N change information was previously announced in MB044001.
- These parts are unique to the S-F1.

1.Printer Controller (B441)

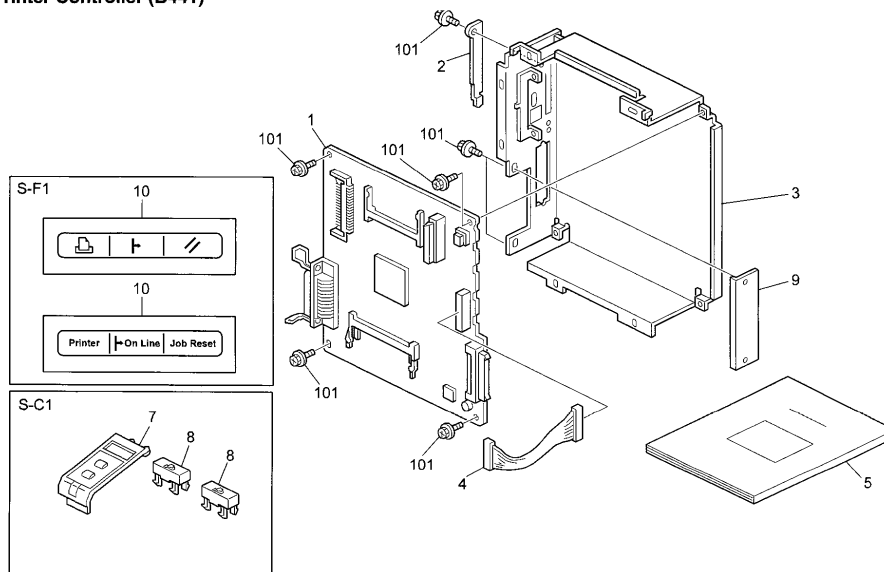

| | | | |
|--|--|--|--|
| Model: Stella-C1/F1 Printer Controller | | Date: 10-Dec-02 | No.: MB441002 |
| Modified Article: Reviewing of Printer Option for S-F2 release | | Prepared by: A. Ishiyama | |
| From: Technical Services sec. Service Planning Dept. | | | |
| Reason for Modification: | <input checked="" type="checkbox"/> Parts catalog correction <input type="checkbox"/> To facilitate assembly <input type="checkbox"/> Part standardization | <input type="checkbox"/> Vendor change <input type="checkbox"/> To improve reliability <input type="checkbox"/> Other () | <input type="checkbox"/> To meet standards () |
| Modification Schedule: | All new parts are available from the first mass production of the S-F2. | | |

The following P/N have been changed due to parts standardization of the printer option for the S-C1/F1 and S-F2.

Note: These changes will be applied to the printer option parts catalog for the S-F2 manual.

| Old part number | New part number | Description | Q'ty | Int | Page | Index | Note |
|-----------------|-----------------|------------------------|------|-----|------|-------|------|
| B4415175 | B4415162 | Controller Board | 1→1 | * | 3 | 1 | 1 |
| B4418857 | B4418877 | Operation Manual | 1→1 | * | 3 | 5 | 1 |
| | B4415801 | Printer Bracket - S-F2 | 0→1 | -- | 3 | 11 | 2 |

Note:

1. The interchangeability between these two parts is as follows:
Both can be used with the S-C1/F1 printer, but the old part cannot be used with the S-F2 printer.
2. This part is unique to the S-F2.

1. Printer Controller (B441)

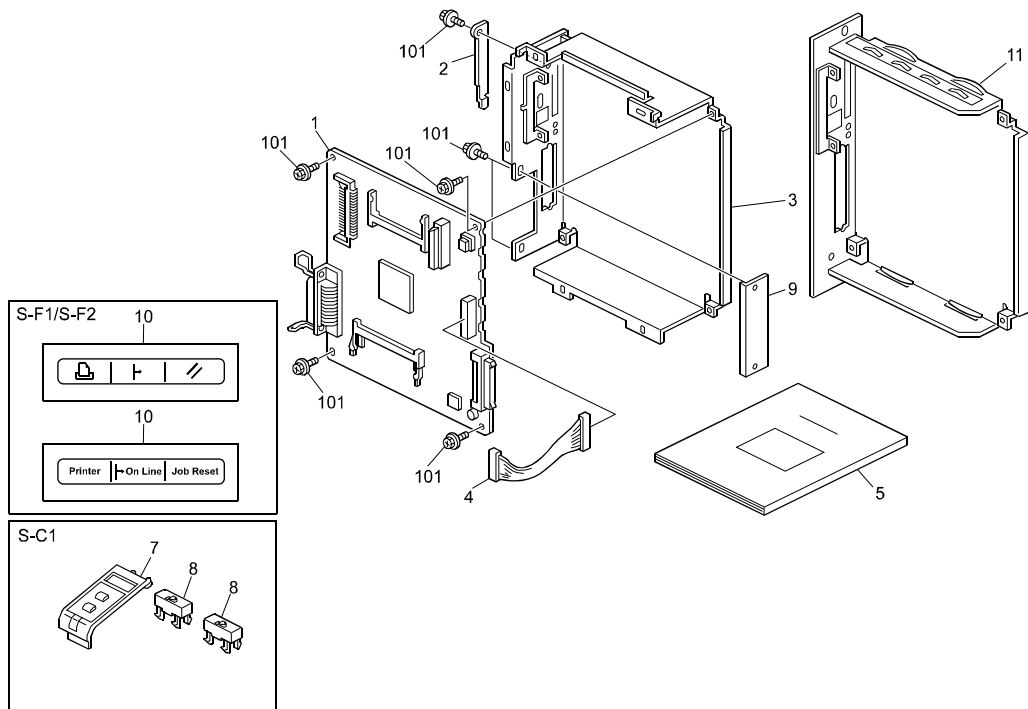

| | | | |
|--|--|---|---|
| Model: Model S-F2 | | Date: 31-Jan-03 | No.: MH556001 |
| Modified Article: Parts Catalog Corrections | | Prepared by: M. Mano | |
| From: Technical Services Sec. Service Planning Dept. | | | |
| Reason for Modification: | <input checked="" type="checkbox"/> Parts catalog correction <input type="checkbox"/> To facilitate assembly <input type="checkbox"/> Part standardization | <input type="checkbox"/> Vendor change <input type="checkbox"/> To improve reliability <input type="checkbox"/> Other | <input type="checkbox"/> To meet standards () |

Please apply the following P/N corrections to your Parts Catalogs.

Mainframe (H556/H557)

| Incorrect part number | Correct part number | Description | Q'ty | Int | Page | Index | Note |
|-----------------------|---------------------|----------------------------|------|-----|------|-------|------|
| B0444949 | B0444952 | Cover – Original Table | 1 | - | 3 | 9 | |
| H5561011 | H5561013 | Contact Image Sensor Ass'y | 1 | - | 15 | 16 | |
| H5561301 | H5561310 | Discharge Brush | 1 | - | 17 | 26 | |

Printer Controller (B441)

| Incorrect part number | Correct part number | Description | Q'ty | Int | Page | Index | Note |
|-----------------------|---------------------|------------------|------|-----|------|-------|------|
| B4415162 | B4415172 | Controller board | 1 | - | 3 | 1 | |