

Paper Feed Unit PB3120
Machine Code: D579
Field Service Manual

July, 2011
Subject to change

Safety and Symbols

Replacement Procedure Safety

CAUTION

- Turn off the main power switch and unplug the machine before beginning any of the replacement procedures in this manual.

Symbols Used in this Manual

This manual uses the following symbols.

 : See or Refer to

 : Screws

 : Connector

 : Clip ring

 : E-ring

TABLE OF CONTENTS

Safety and Symbols.....	1
Replacement Procedure Safety.....	1
Symbols Used in this Manual.....	1
1. Replacement and Adjustment	
Rear Cover.....	3
Motors, Clutch and Main Board.....	4
Lift Motor.....	4
Paper Feed Clutch.....	4
Paper Feed Motor.....	5
Main Board.....	6
Paper Feed Unit.....	7
Rollers and Sensors.....	9
Separation Roller, Feed Roller and Pick-Up Roller.....	9
Lift, Paper End, and Relay Sensors.....	10
INDEX	11

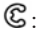

1. Replacement and Adjustment

Rear Cover

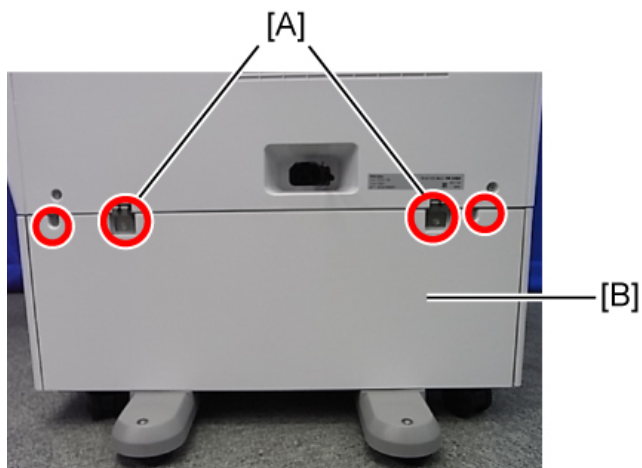
1



d579r100

1. Securing brackets [A] ( x 1 each)
2. Rear cover [B] ( x 2)

Motors, Clutch and Main Board

1

Lift Motor

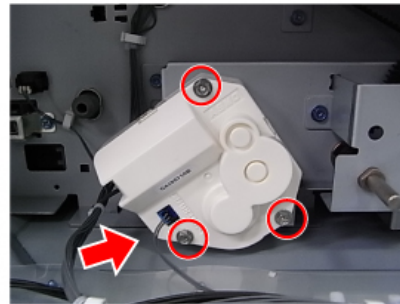
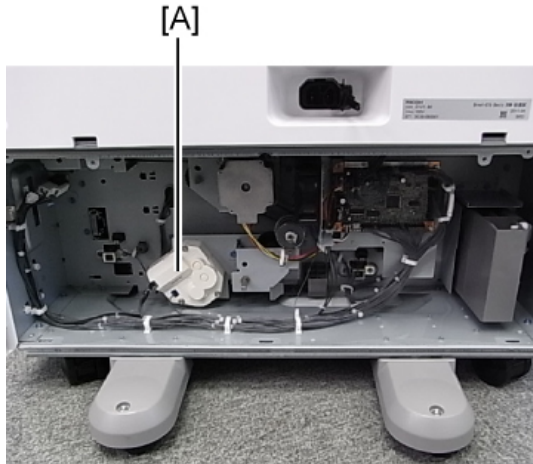

d579r101

1. Rear cover (🔧 p.3 "Rear Cover")
2. Lift motor [A] (🔧 x 3, 📦 x 1)

Paper Feed Clutch

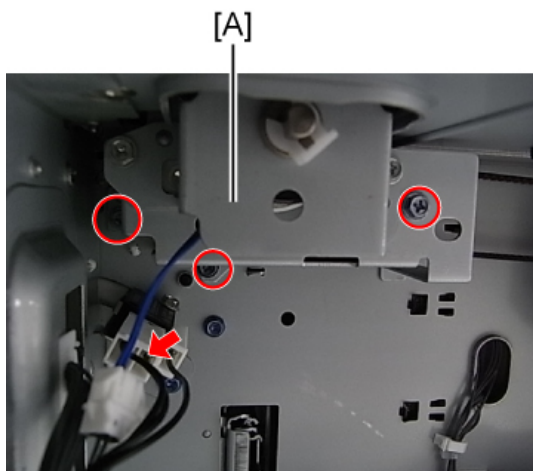

d579r102

1. Rear cover (🔧 p.3 "Rear Cover")
2. Paper feed gear unit [A] (🔧 x 3, 📦 x 1)

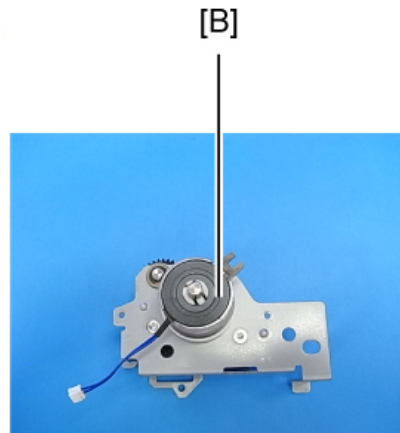
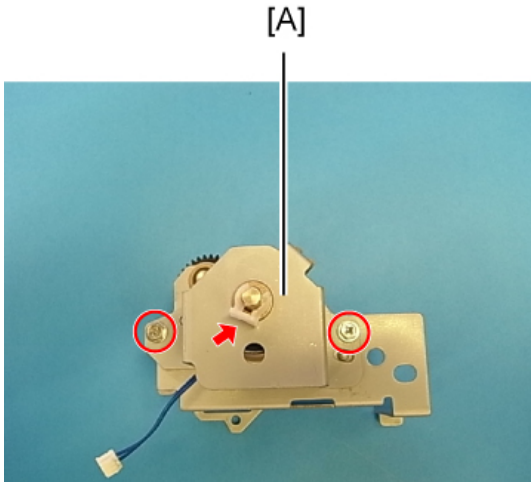

d579r103

1. Paper feed clutch bracket [A] (⌘ x 1, ⚙ x 2, bushing x 1)
2. Paper feed clutch [B]

Paper Feed Motor

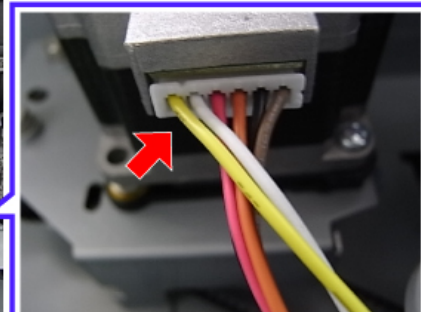
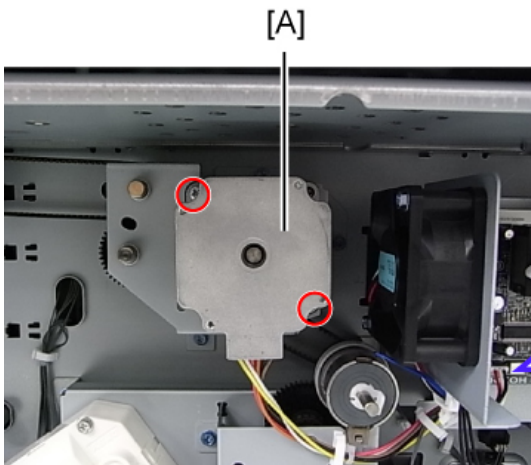

d579r104

1. Rear cover (⌘ p.3 "Rear Cover")
2. Paper feed motor [A] (⌘ x 1, ⚙ x 2)

Note

- When installing the paper feed motor, make sure that the gear of the paper feed motor holds the timing belt [B].

Main Board

1

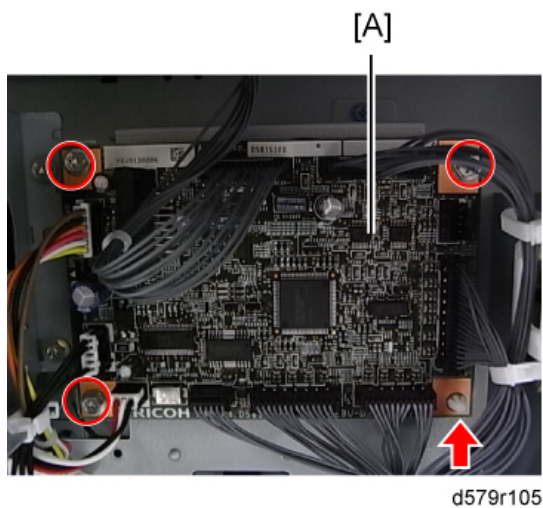

1. Rear cover (p.3 "Rear Cover")
2. Main board [A] (All screws, 3, snap pin x 1)

Paper Feed Unit

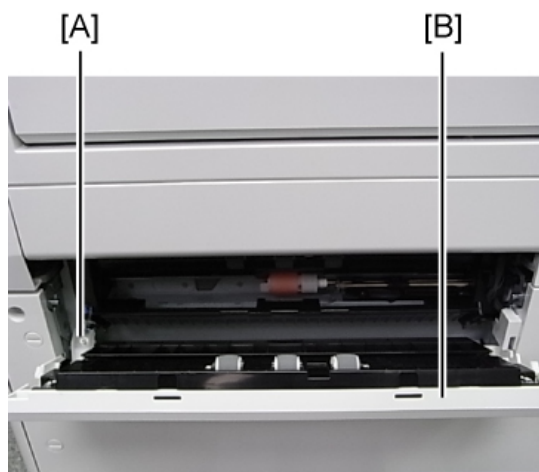

d579r106

1. Stopper [A] ( x 1)
2. Vertical transport guide [B] of the paper feed unit



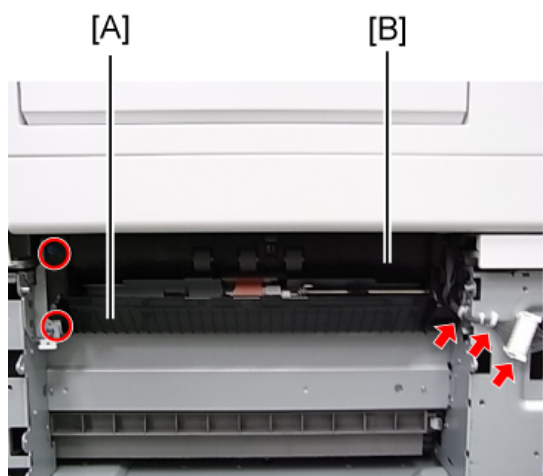

d579r107

3. Right cover [A] ( x 2)



d579r108

4. Pull tray 3.
5. Paper guide [A]
6. Paper feed unit [B] ( x 2,  x 1,  x 2)

Rollers and Sensors

Separation Roller, Feed Roller and Pick-Up Roller

1

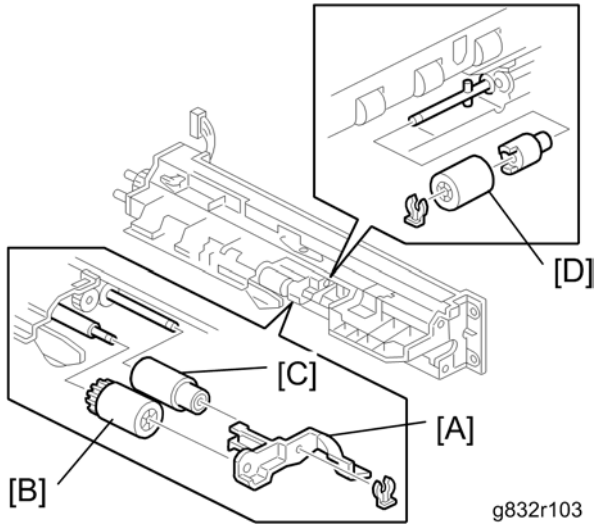

1. Paper feed unit (p.7 "Paper Feed Unit")
2. Roller holder [A] (x 1)
3. Pick-up roller [B] (x 1)
4. Paper feed roller [C]
5. Separation roller [D] (x 1)

Lift, Paper End, and Relay Sensors

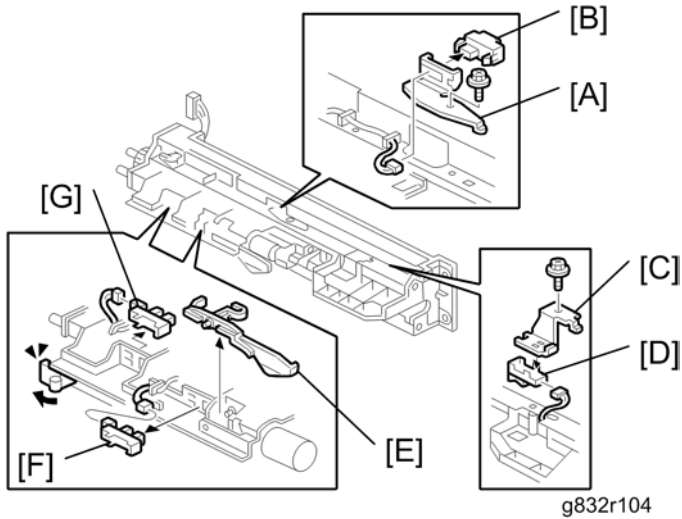

1. Paper feed unit (p.7 "Paper Feed Unit")
2. Vertical transport sensor bracket [A] (x 1)
3. Vertical transport sensor [B] (x 1)
4. Paper feed sensor bracket [C] (x 1)
5. Paper feed sensor [D] (x 1)
6. Paper end sensor feeler [E]
7. Paper end sensor [F] (x 1)
8. Lift sensor [G] (x 1)

INDEX

L

Lift Motor.....	4
Lift, Paper End, and Relay Sensors.....	10

M

Main Board.....	6
Motors, Clutch and Main Board.....	4

P

Paper Feed Clutch.....	4
Paper Feed Motor.....	5
Paper Feed Unit.....	7

R

Rear Cover.....	3
Replacement Procedure Safety.....	1
Rollers and Sensors.....	9

S

Safety and Symbols.....	1
Separation Roller, Feed Roller and Pick-Up Roller.	9
Symbols Used in this Manual.....	1

MEMO