

LCIT PB3110/PB3140
Machine Code: D538/D581
Field Service Manual

September, 2011
Subject to change

TABLE OF CONTENTS

1. Replacement and Adjustment

Exterior Cover.....	3
Left and Right Tray.....	3
Changing the Tray Size.....	4
Electrical Components.....	5
Paper Height Sensors on Paper Storage Side.....	5
End Fence HP Sensor/Paper End Sensor 2.....	6
Tray Lift Motor.....	6
Tray Motor.....	7
Main Board.....	8
Stack Transport Clutch.....	8
Feed.....	9
Paper Feed Unit.....	9
Pick-up, Feed and Separation Rollers.....	10
Paper Feed, Paper End, Lift and Relay Sensors.....	11
INDEX.....	13



1. Replacement and Adjustment

Exterior Cover

1

Left and Right Tray

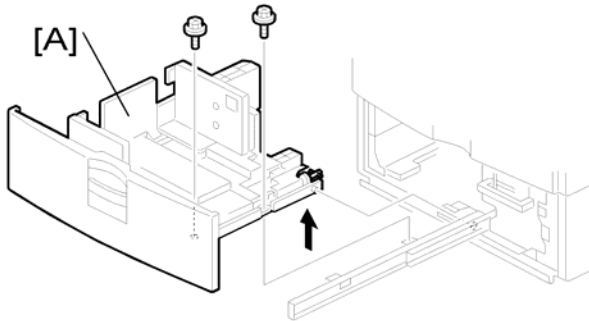

1. Pull the LCT drawer.

↓ Note

- If the right tray comes up with the left tray, push the right tray into the LCT.

2. Left tray [A] ( x 2)

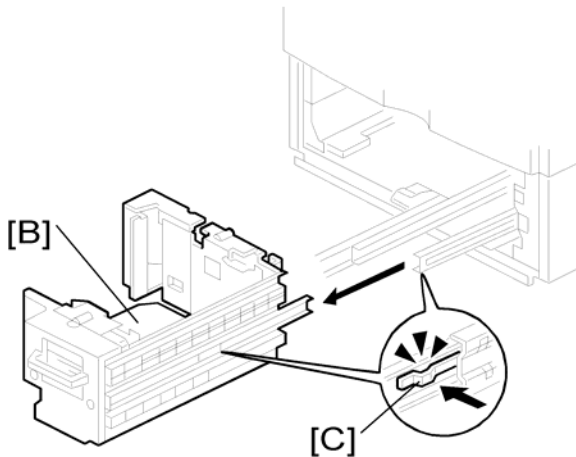



3. Remove the right tray [B] pressing down the stopper [C].

↓ Note

- When reinstalling the tray, set the tray on the guide rail and carefully push the tray in, making sure to keep the tray level.

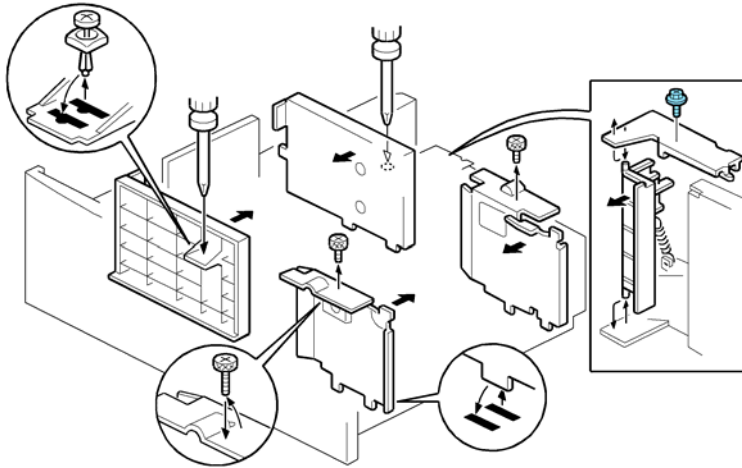
Changing the Tray Size



1. Remove the fence screws ( x 5).
2. Change the position of the fences.

Note

- Before fastening the screws, set paper in the tray.

Electrical Components

Paper Height Sensors on Paper Storage Side

1

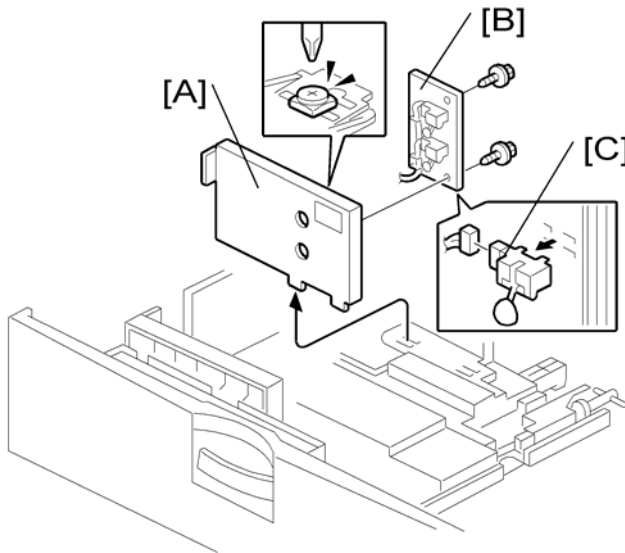



1. Tray (📄 "Left and Right Tray")
2. Rear fence [A] (🔩 x 1)
3. Rear fence bracket [B] (🔩 x 2)
4. Paper height sensors [C] (📄 x 1 each)

End Fence HP Sensor/Paper End Sensor 2

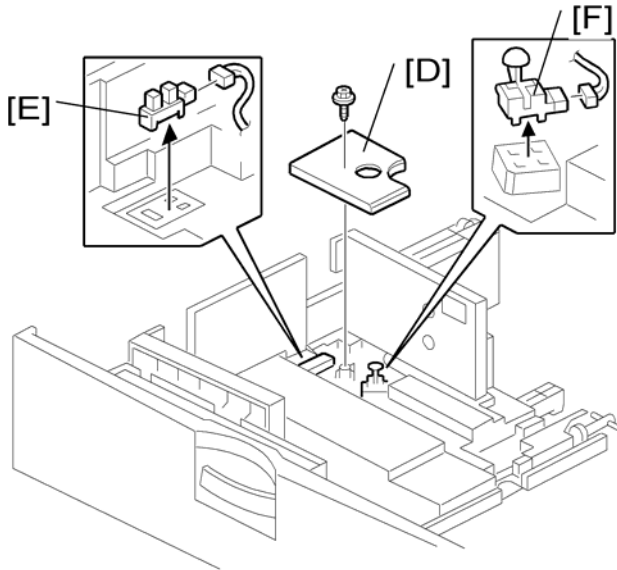

1

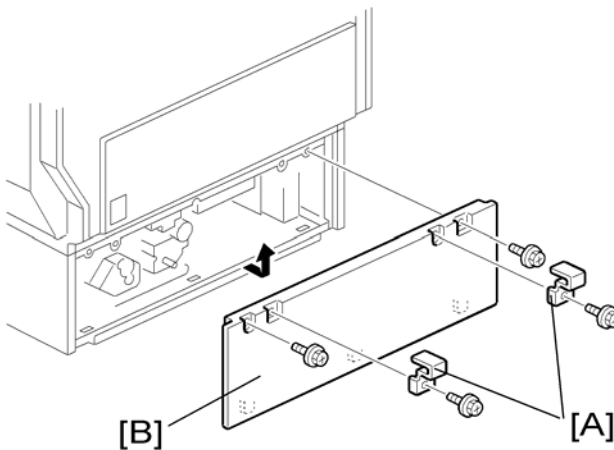

1. Bottom cover [D] ( x 1)
2. End fence HP sensor [E] ( x 1)
3. Paper end sensor 2 (paper storage side) [F] ( x 1)

Tray Lift Motor



1. Securing brackets [A] ( x 1 each)
2. Rear cover [B] ( x 2)

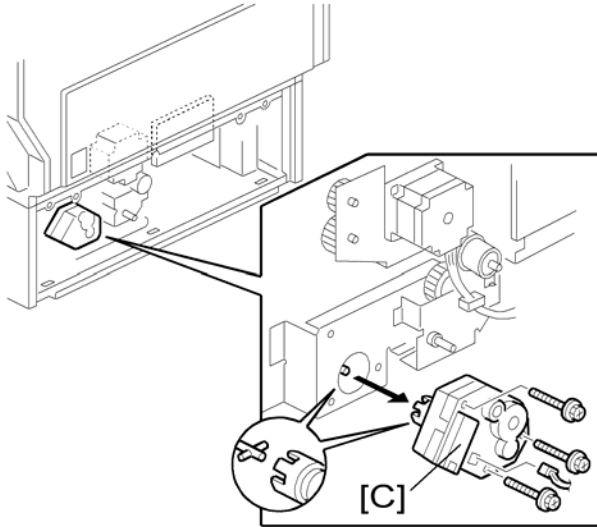

3. Tray lift motor [C] (🔌 x 1, 🔩 x 3)

Tray Motor

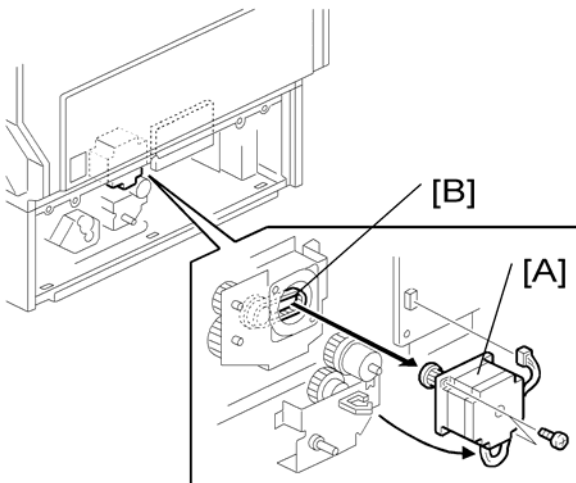

1. Rear cover (🔌 "Tray Lift Motor")
2. Tray motor [A] (🔌 x 1, 🔩 x 2)

⬇ Note

- When installing the tray motor, make sure that the gear of the tray motor holds the timing belt [B].

Main Board

1

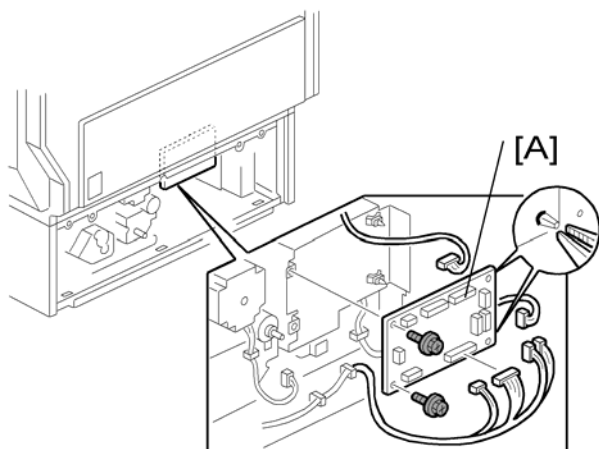

1. Rear cover (🔧 "Tray Lift Motor")
2. Main board [A] (All 📦 s, 🔧 x 2, snap x 2)

Stack Transport Clutch

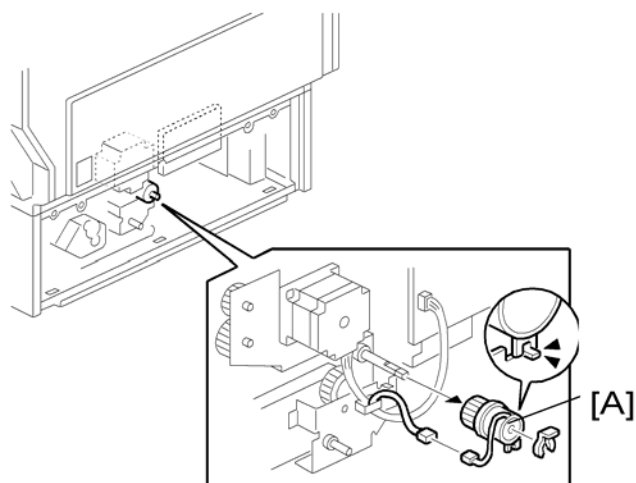

1. Rear cover (🔧 "Tray Lift Motor")
2. Stack transport clutch [A] (📦 x 1, 🔧 x 1)

Feed

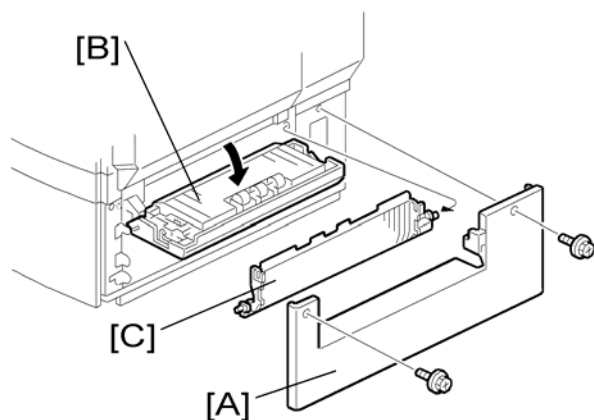

Paper Feed Unit

1

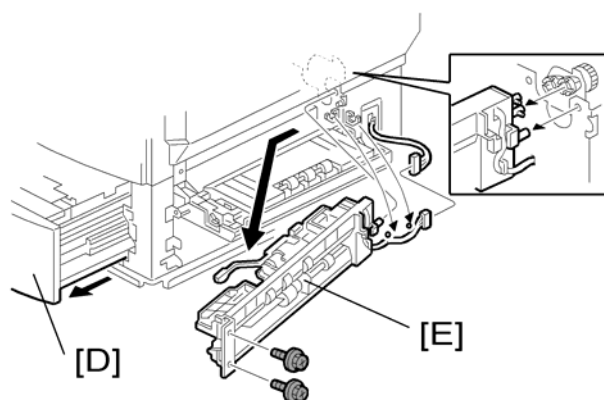

1. Right cover [A]
2. Open the vertical guide plate [B]
3. Guide plate [C]



4. Pull the LCT drawer [D].
5. Paper feed unit [E] ( x 2  x 1)

Pick-up, Feed and Separation Rollers

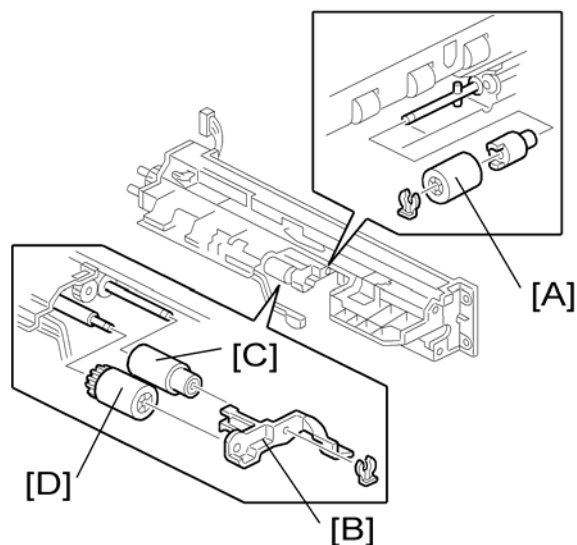

1. Paper feed unit (1 "Paper Feed Unit")
2. Separation roller [A] (1 x 1)
3. Roller holder [B] (1 x 1)
4. Feed roller [C] and pick-up roller [D]

Paper Feed, Paper End, Lift and Relay Sensors

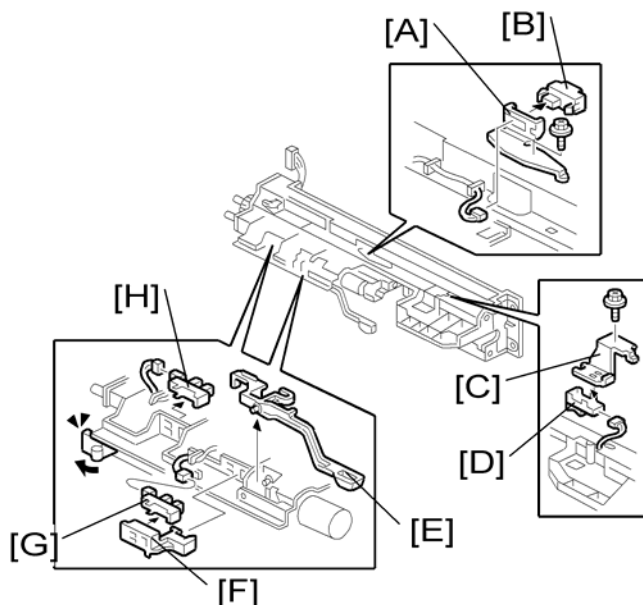

1. Paper feed unit (📄 "Paper Feed Unit")
2. Vertical transport sensor bracket [A] (🔑 x 1, 📦 x 1)
3. Relay sensor [B]
4. Paper feed sensor bracket [C]
5. Paper feed sensor [D]
6. Paper end feeler [E]
7. Paper end sensor holder [F] (hook x 3)
8. Paper end sensor [G] (📦 x 1, hook x 3)
9. Lift sensor (📦 x 1, hook x 3)

