

Paper Feed Unit PB3090
Machine Code: M374
Field Service Manual

25 October, 2009

Safety and Symbols

Replacement Procedure Safety

CAUTION

- Turn off the main power switch and unplug the machine before beginning any of the replacement procedures in this manual.

Symbols Used in this Manual

This manual uses the following symbols.

 : See or Refer to

 : Screws

 : Connector

 : Clamp

 : Clip ring

 : E-ring

TABLE OF CONTENTS

Safety and Symbols.....	1
Replacement Procedure Safety.....	1
1. Replacement and Adjustment	
Paper Feed.....	3
Paper Feed Unit.....	3
Paper Feed Roller.....	4
Friction Pad.....	5
Electrical Component.....	6
Paper Feed Motor.....	6
Main Board.....	7
Paper Size Switch.....	7
Paper Feed and End Sensors.....	7
Remaining Paper Sensors.....	8
Paper Feed Clutch.....	9

1. Replacement and Adjustment

Paper Feed

1

CAUTION

- Turn off the main power switch and unplug the machine before attempting any of the procedures in this section.

Paper Feed Unit

1. Remove the paper tray unit from the main unit.
2. Pull out the paper tray.

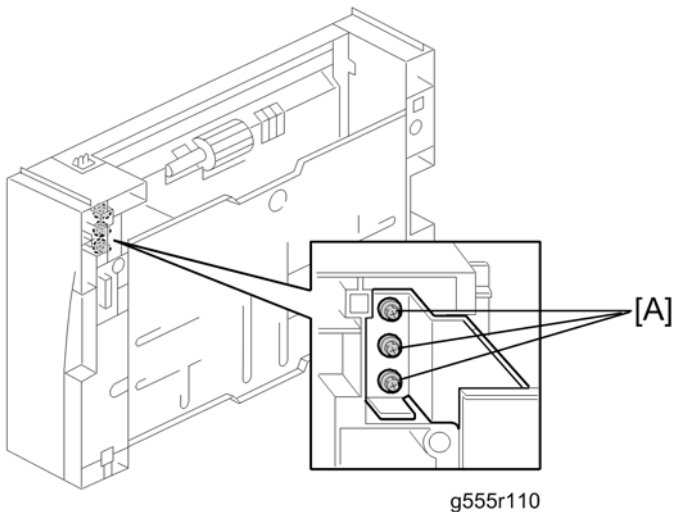

3. Turn the paper tray unit over and remove the three sliver screws [A] first. Do not remove the other screws from this side.

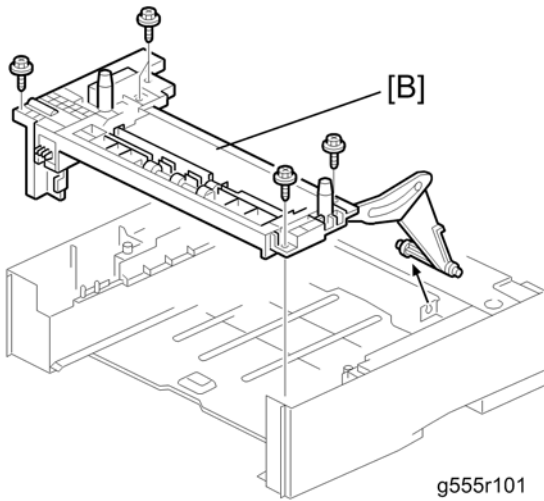

4. Remove the paper feed unit [B] (5 x).

Note

- You must remove eight screws in total to remove the paper feed unit [B].

Paper Feed Roller

1. Pull out the paper tray.

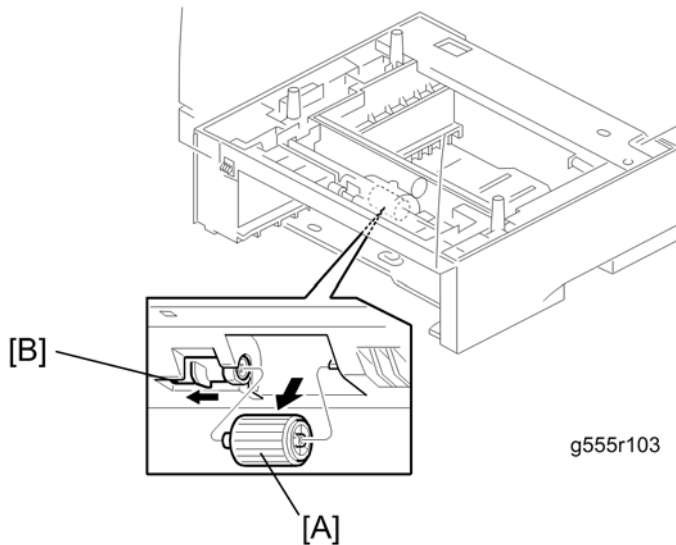

2. Paper feed roller [A] (move the lever [B] to the left.)

Friction Pad

1. Pull out the paper tray.

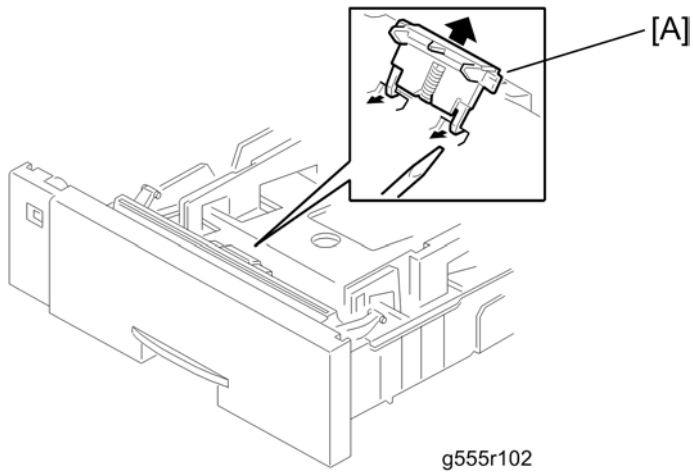

2. Friction pad [A]

Electrical Component

⚠ CAUTION

- Turn off the main power switch and unplug the machine before attempting any of the procedures in this section.

Paper Feed Motor

1. Paper feed unit (🔧 p.3)

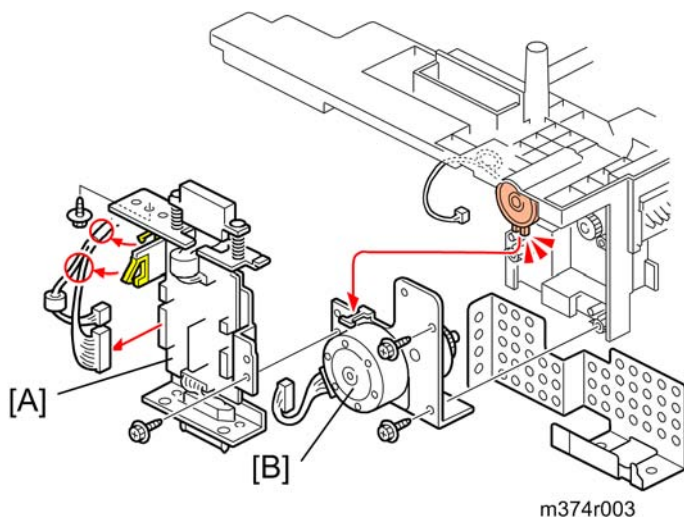

2. Main board bracket [A] (🔧 x 2, 🛠 x 2, 🛠 x 2)
3. Paper feed motor bracket (🔧 x 1, 🛠 x 2)

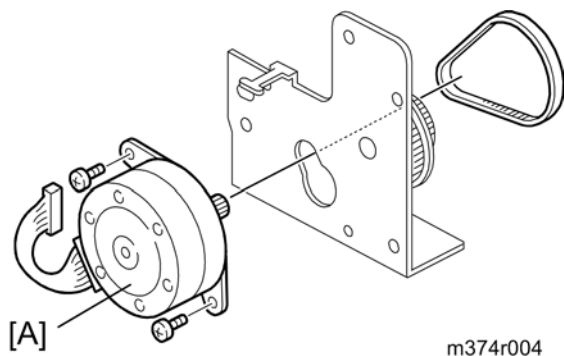

4. Paper feed motor [A] (🛠 x 2, timing belt x 1)

Main Board

1. Paper feed unit (🔧 p.3)

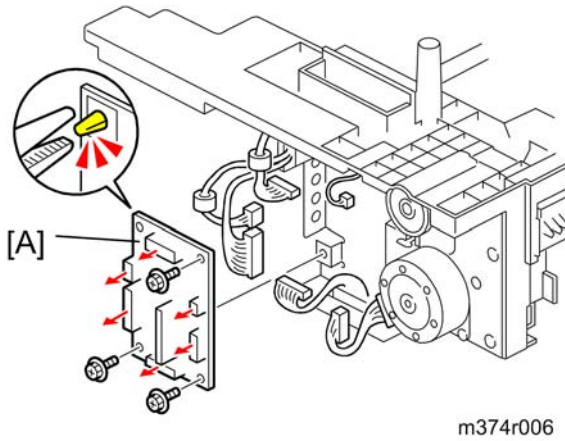

2. Main board [A] (all harnesses, 🛠 x 3, stand x 1)

Paper Size Switch

1. Paper feed unit (🔧 p.3)

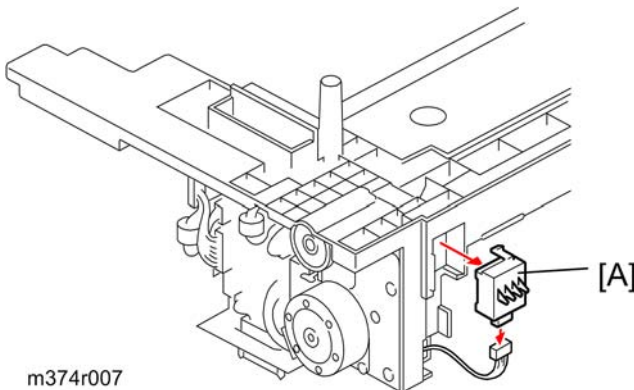



2. Paper size switch [A] (hooks, 🛠 x 1)

Paper Feed and End Sensors

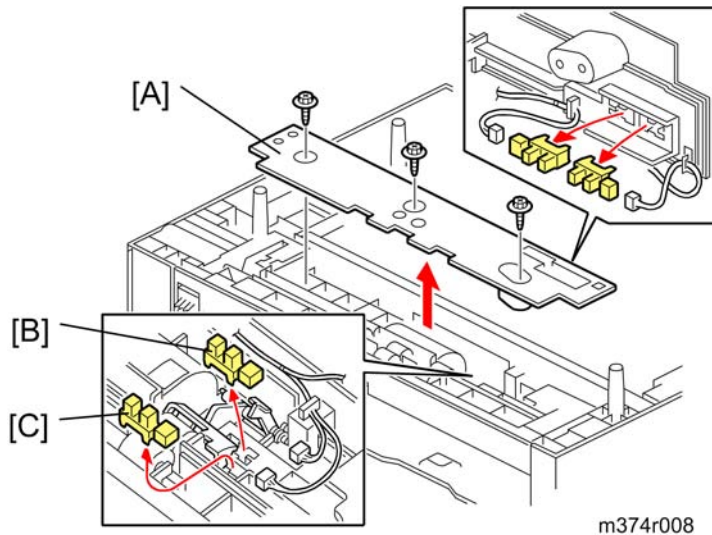
1. Pull out the paper tray.

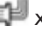

m374r008



2. Paper feed cover [A] (screws x 3)
3. Paper end sensor [B] (hooks,  x 1)
4. Paper feed sensor [C] (hooks,  x 1)

Remaining Paper Sensors

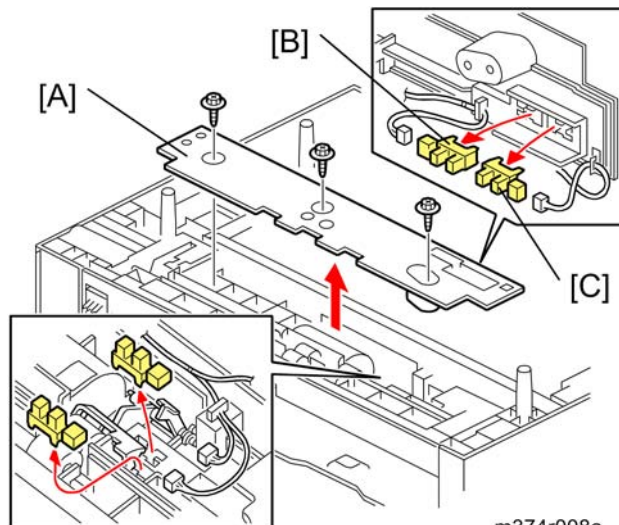
1. Pull out the paper tray.



m374r008a

2. Paper feed cover [A] (screws x 3)
3. Remaining paper sensor 1 [B] (hooks,  x 1)
4. Remaining paper sensor 2 [C] (hooks,  x 1)

Paper Feed Clutch

1. Paper feed unit (☛ p.3)
2. Paper feed motor (☛ p.6)

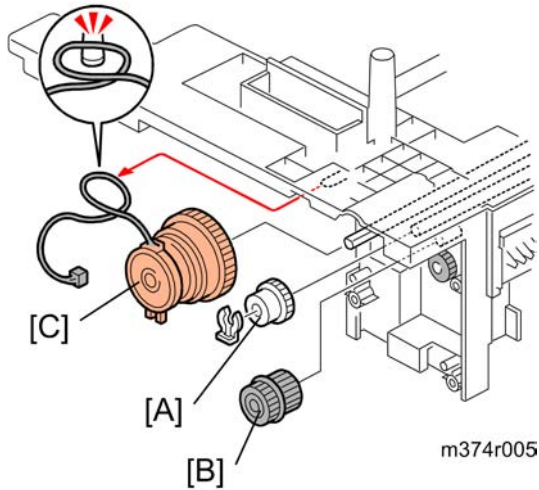

3. Paper feed gear [A] (☛ x 1)
4. Idle gear [B]
5. Paper feed clutch [C]

