

INTERCHANGE UNIT

(Machine Code: G305)

1. REPLACEMENT AND ADJUSTMENT

⚠ CAUTION

Turn off the main power switch and unplug the machine before beginning any of the procedures in this section.

NOTE: This manual uses the following symbols.

☞ : See or Refer to 🔩 : Screws 📡 : Connector

1.1 EXTERIOR COVER AND PAPER EXIT SENSOR

- [A]: Exterior cover
- [B]: Inner cover (🔩 x 3)
- [C]: Paper exit sensor (📡 x 1)

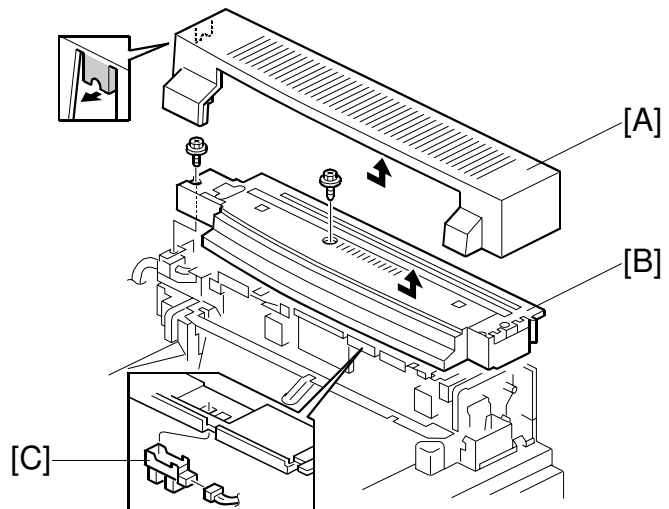

G305R101.WMF

1.2 CONTROL BOARD

- [A]: Control board (1 hook, 📡 x 9)

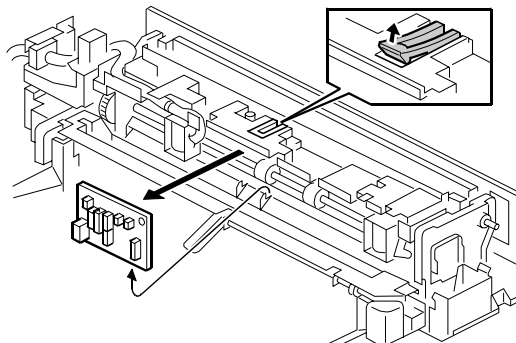

G305R102.WMF

Peripherals

2. DETAILED DESCRIPTIONS

2.1 ELECTRICAL COMPONENTS

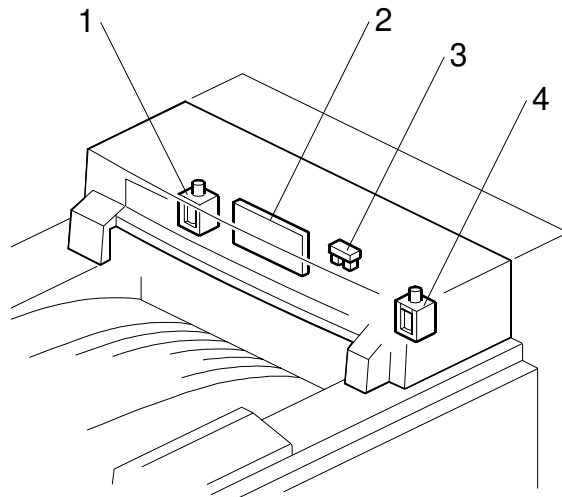

G305D102.WMF

- 1. Upper gate solenoid
- 2. Control board

- 3. Paper exit sensor
- 4. Lower gate solenoid

2.2 DRIVE

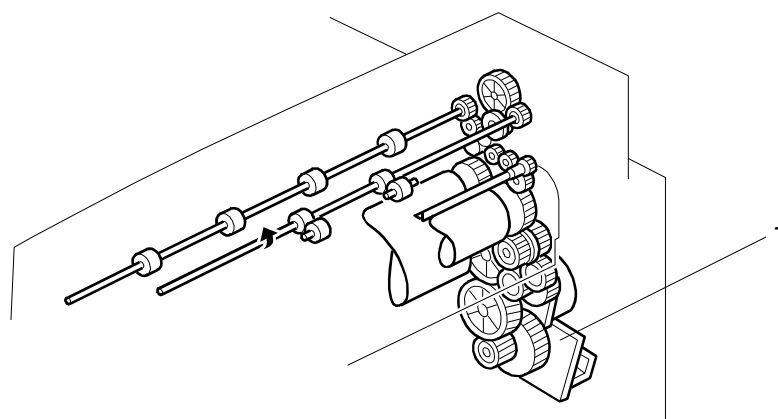

G305D103.WMF

- 1. Fusing unit motor (main body)

2.3 MECHANISM

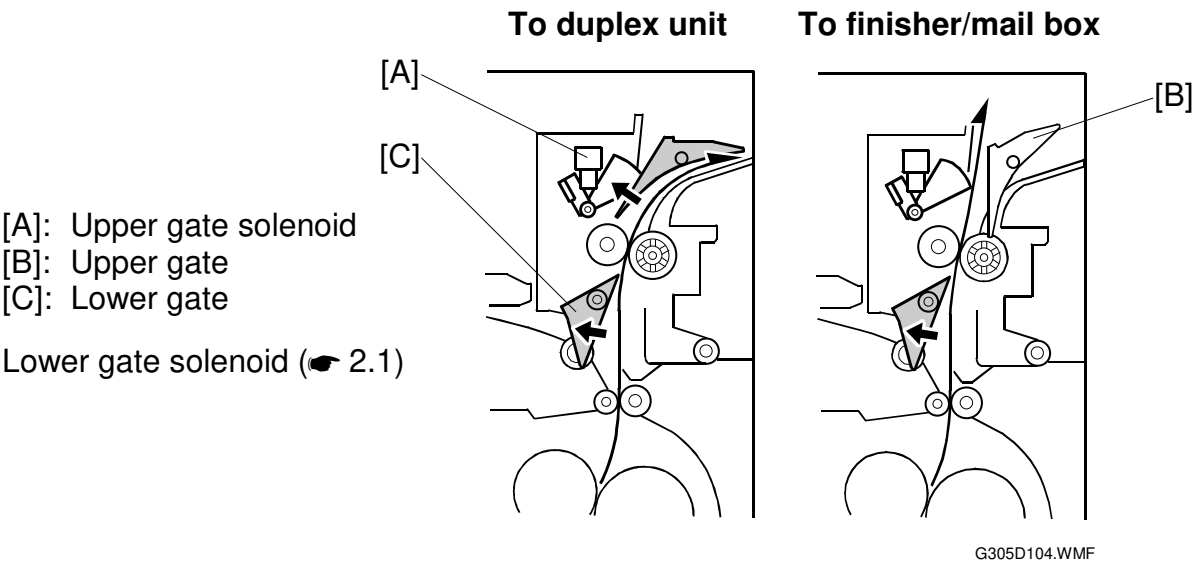

The arrows in the right-hand column indicate paper path directions through the junction gates.

To ...	Solenoid		Gate	
Main unit	Upper	Off	Upper	↑*
	Lower	Off	Lower	←
Duplex unit	Upper	On	Upper	→
	Lower	On	Lower	↑
Finisher/mail box	Upper	Off	Upper	↑
	Lower	On	Lower	↑

* Paper does not go through the upper gate.