

**Interchange Unit Type 3350
Machine Code: D371**

SERVICE MANUAL

Oct. 2007
Subject to change

Safety and Symbols

Replacement Procedure Safety

CAUTION

- Turn off the main power switch and unplug the machine before beginning any of the replacement procedures in this manual.

Symbols Used in this Manual

This manual uses the following symbols.

: See or Refer to

: Screws

: Connector

: Clip ring

: E-ring

: Clamp

TABLE OF CONTENTS

Safety and Symbols.....	1
Replacement Procedure Safety.....	1
1. Replacement and Adjustment	
Electrical Component.....	3
Interchange Motor.....	3
Junction Gate Jam Sensor.....	4
2. Detailed Section Descriptions	
Component Layout.....	5
Mechanical Component Layout.....	5
Drive Layout.....	6
Junction Gate Mechanism.....	7

1. Replacement and Adjustment

Electrical Component

1

Interchange Motor

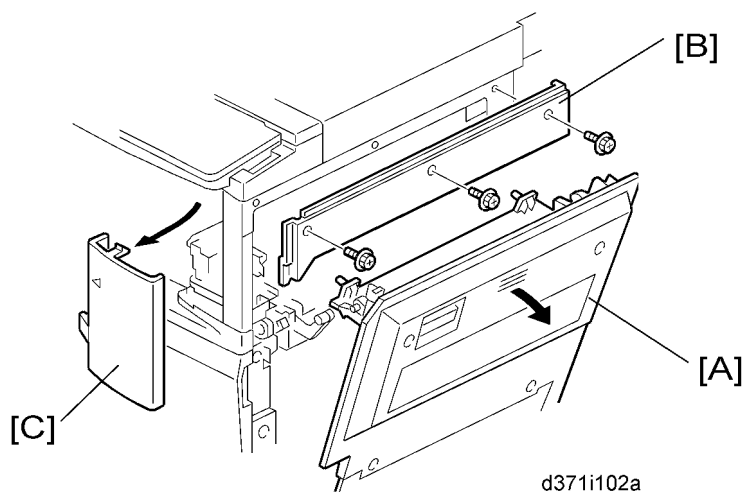

1. Open the right cover [A] or right door if the duplex unit is installed.
2. Right upper cover [B] (8 x 3)
3. Front right cover [C] (hook)

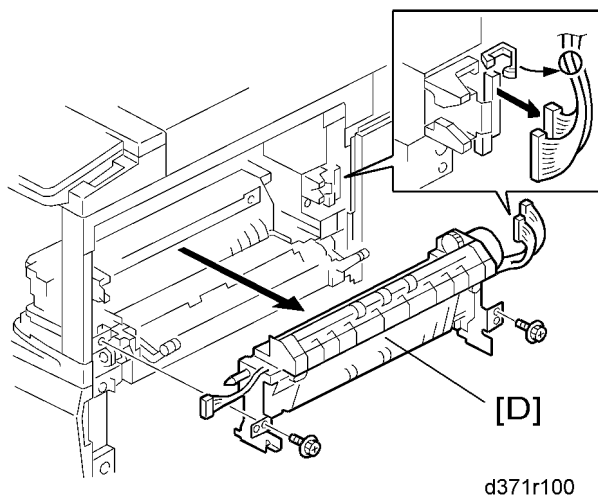

4. Interchange unit [D] (⚙ x 2, ⚙ x 2 or 3 (if 1-bin unit is installed))

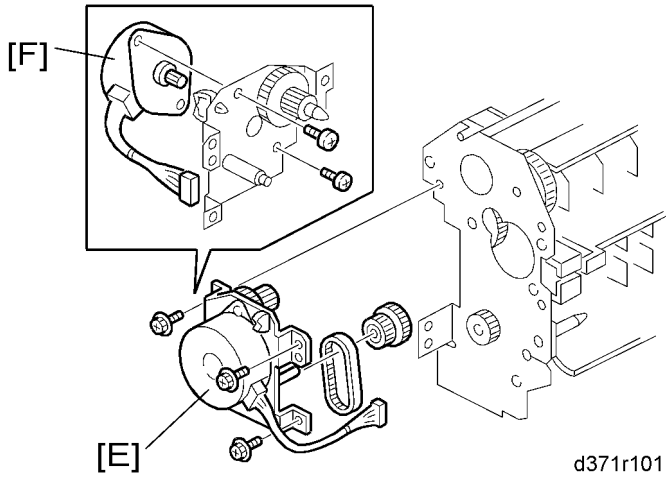

5. Interchange motor bracket [E] (⚙ x 3, gear x 1, timing belt x 1)
6. Interchange motor [F] (⚙ x 2)

Junction Gate Jam Sensor

1. Interchange unit (⚙ Interchange Motor)

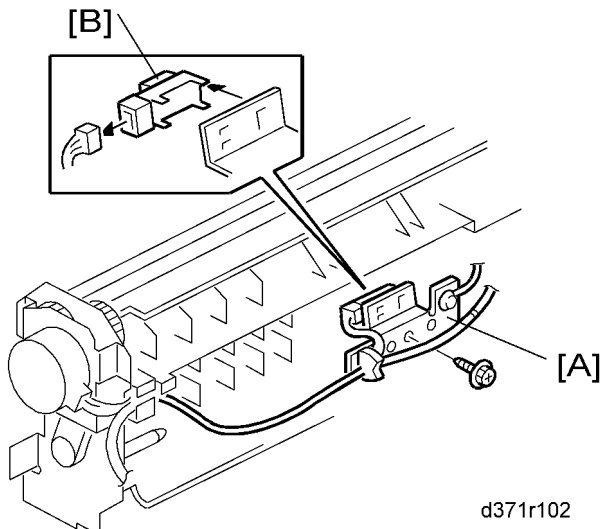

2. Sensor bracket [A] (⚙ x 1)
3. Junction gate jam sensor [B] (⚙ x 1, hooks)

2. Detailed Section Descriptions

Component Layout

Mechanical Component Layout

2

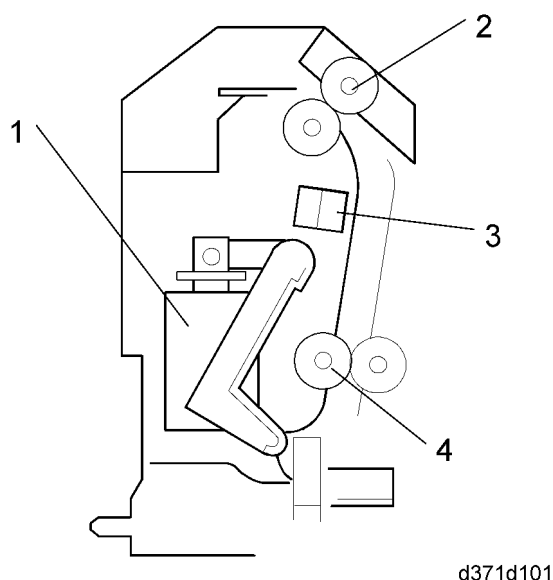

1. Junction Gate Solenoid	3. Junction Gate Jam Sensor
2. Paper Exit/ Inverter Roller	4. Paper Transport Roller

Drive Layout

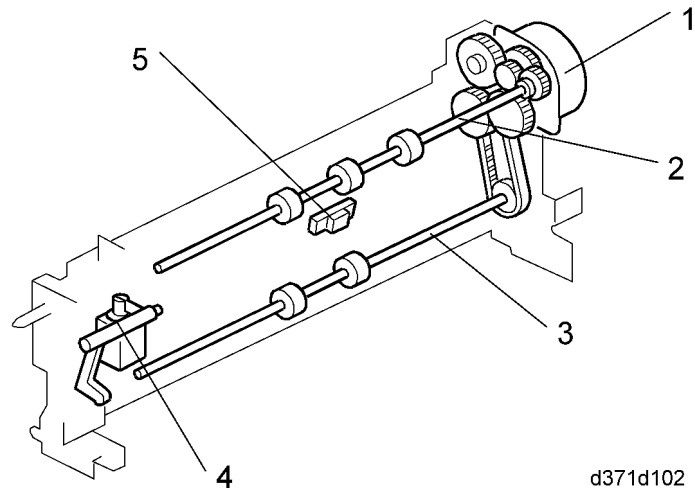

1. Interchange Motor	4. Junction Gate Solenoid
2. Paper Exit/ Inverter Roller	5. Junction Gate Jam Sensor
3. Paper Transport Roller	

The interchange motor drives the paper exit/inverter roller and paper transport roller through the gears and timing belt. This motor exits paper to the 1-bin tray if it is installed and 1-bin tray is selected as an output location. However, this motor also transports paper to the duplex path if the duplex unit is installed and the machine gets a duplex job.

Junction Gate Mechanism

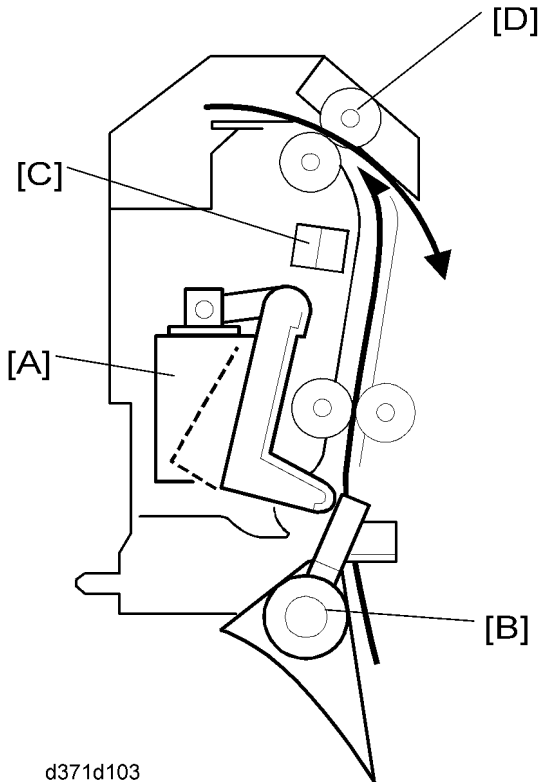

d371d103

Depending on the selected mode, the copies are directed to the output tray/ bridge unit path or 1-bin tray/duplex path by the exit junction gate [A]. These are controlled by the junction gate solenoid [B].

- **To the Exit Tray or Bridge Unit**

The exit junction gate solenoid stays off and the paper is directed to the copier exit unit.

- **To the 1-bin Tray**

The junction gate solenoid turns on. The paper is directed to the 1-bin tray.

- **To the Duplex Unit**

The junction gate solenoid turns on. When the junction gate jam sensor [C] detects a trailing edge of a sheet of paper, the machine stops the paper exit/inverter roller [D] and then drives its roller reversely. As a result, a sheet of paper is transported to the duplex path.

MEMO

