

Model: Kir-C2 GW Expansion Unit (B658)		Date: 6-Jul-04	No.: MB658001
Modified Article: Parts Catalog Correction		Prepared by: M. Ishihara	
From: 1 st Tech. Support Sec. Service Support Dept.			
Reason for Modification:	<input checked="" type="checkbox"/> Parts catalog correction <input type="checkbox"/> To facilitate assembly <input type="checkbox"/> Part standardization	<input type="checkbox"/> Vendor change <input type="checkbox"/> To improve reliability <input type="checkbox"/> Other	<input type="checkbox"/> To meet standards ()

Please correct your Parts Catalogs as follows:

Page 2 and 3

- Addition -

Part number	Description	Q'ty	Index	Note
B6201461	Fax Decal – NA ASIA	1	20	
B6201450	Fax Cover EU	1	21	
B6201421	Fax Cover NA	1	21	
B6581455	Expansion Sheet	1	22	

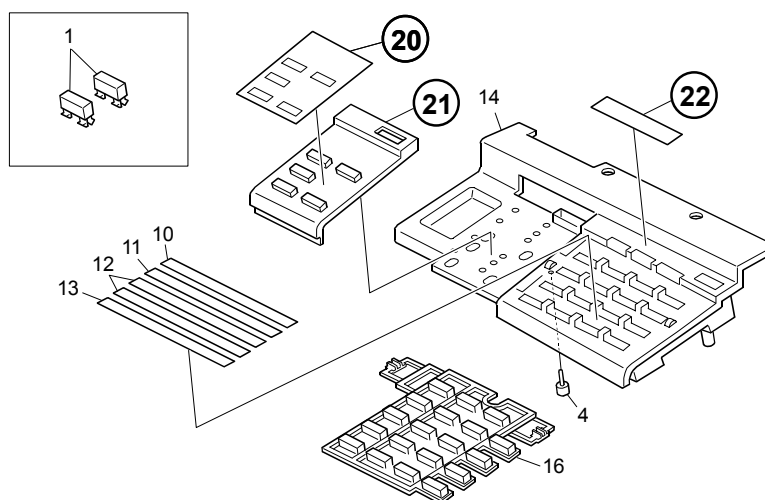

Model: Kir-C2 GW Expansion Unit (B658)		Date: 20-Jul-04	No.: MB658002
Modified Article: Fax Cover		Prepared by: M. Ishihara	
From: 1 st Tech. Support Sec. Service Support Dept.			
Reason for Modification:	<input type="checkbox"/> Parts catalog correction <input type="checkbox"/> To facilitate assembly <input type="checkbox"/> Part standardization	<input type="checkbox"/> Vendor change <input checked="" type="checkbox"/> To improve reliability <input type="checkbox"/> Other	<input type="checkbox"/> To meet standards ()

Please note the following changes:

1. A vinyl bag was added to the Fax Cover for more protection.

Note: This is the only difference, so both the new and old parts can be used in the field.

2. The page number for the Fax Cover was corrected:

Incorrect: pg. 12

Correct: pg. 3

Old part number	New part number	Description	Q'ty	Int	Page	Index	Note
B6201421	B6201415	Fax Cover NA	1-1	O/O	3	21	
B6201450	B6201422	Fax Cover EU	1-1	O/O	3	21	

NOTE: The first P/N for the Fax Cover was announced in MB658001.

Model: Kir-C2 GW Expansion Unit (B658)		Date: 22-Apr-05	No.: MB658003
Modified Article: PCB Ct I: Exp : Ass'y		Prepared by: M. Ishihara	
From: 1 st Tech. Support Sec. Service Support Dept.			
Reason for Modification:	<input type="checkbox"/> Parts catalog correction <input type="checkbox"/> To facilitate assembly <input type="checkbox"/> Part standardization	<input type="checkbox"/> Vendor change <input checked="" type="checkbox"/> To improve reliability <input type="checkbox"/> Other	<input type="checkbox"/> To meet standards ()

Old part number	New part number	Description	Q'ty	Int	Page	Index	Note
B6585700	B6585701	PCB Ct I: Exp : Ass'y	1-1	X/O	5	2	

Change: A jumper wire was added and a resistor (R524) was removed from the controller board.

Reason: To improve the power distribution to the Piccolo ASIC.

Note: This change was applied to the machine production line from October 2004.

Model: Kir-C2.5 GW Expansion Unit (B658-57)		Date:14-Dec-05	No.: MB658004
Modified Article: PCB CTL		Prepared by: M. Ishihara	
From: 1st Tech. Support Sec. Service Support Dept.			
Reason for Modification:	<input checked="" type="checkbox"/> Parts catalog correction <input type="checkbox"/> Vendor change <input type="checkbox"/> Other <input type="checkbox"/> To facilitate assembly <input type="checkbox"/> To improve reliability <input type="checkbox"/> To meet standards <input type="checkbox"/> Part standardization <input type="checkbox"/> Product Safety ()		

Kir-C2 Part Number	Kir-C2.5 Part Number	Description	Q'ty	Int	Page	Index	Note
B6585701	B6585757	PCB CTL	1-1	X/O	5	2	

Change/Reason: The controller PCB for the Kir-C2.5 was newly added.

Note: This PCB can also be used on the Kir-C2.



Part Change Information List

Date: April 30, 2009

Model	Code	PCIL Number	PCIL Correcti on	Old part number	New part number	Description	Old Q'ty	New Q'ty	Int	3DPC	Page	Index	Set	Set Int	RTB	Note	Ref Number
KIR-C2:Feature Expansion Board OP:EXP/GER	B658	200904		B6581421	B6581451	OPERATION SUB-UNIT:EXPAND:EXP:ASS'Y	1	1	O/O		2	*					