

Reissued:16-Jan-13

Model: AL-C2 Fax Connection Unit Type A	Date: 09-Apr-12	No.: RD629001a
-----------------------------------------	-----------------	----------------

RTB Reissue

The items in ***bold italics*** were corrected or added.

Subject: Installation Procedure for Fax Connection Unit Type A		Prepared by: Takuya Hirakawa	
From: 1st Tech Service Sect., MFP/P Tech Service Dept.			
Classification:	<input type="checkbox"/> Troubleshooting	<input type="checkbox"/> Part information	<input type="checkbox"/> Action required
	<input type="checkbox"/> Mechanical	<input type="checkbox"/> Electrical	<input checked="" type="checkbox"/> Service manual revision
	<input type="checkbox"/> Paper path	<input type="checkbox"/> Transmit/receive	<input type="checkbox"/> Retrofit information
	<input type="checkbox"/> Product Safety	<input type="checkbox"/> Other ()	<input type="checkbox"/> Tier 2

Service Manual Revision
D629

Fax Connection Unit Type A (Remote Fax)

Installation Procedure

This unit allows a machine without the fax unit installed ("Client-side Machine") to send and receive faxes via a machine with the fax unit installed ("Remote Machine").

Requirements:

- Both the Client-side Machine and Remote Machine must have this unit, the Printer unit, and Scanner unit installed.
- Up to six machines can be registered as the Client-side Machines.
- Machines that have the fax unit installed **cannot** be used as the Client-side Machine.
- Only one machine can be registered as the Remote Machine.
- Firmware for this unit: "**aics**" (software number: D6295750)
- Remote Fax transmissions are possible on a G3 line.
- The remote fax function does not support User Code Authentication. Disable the User Code Authentication on the Remote machine.
- Use this function to check the contents of a file that is stored in memory and not yet sent. Also, use this function to cancel a transmission from the Client-side Machine.

Reissued:16-Jan-13
Model: AL-C2 Fax Connection Unit Type A
Date: 09-Apr-12
No.: RD629001a
CAUTION:

Before installing this option:

- Upgrade the machine firmware to the following versions or newer.

Firmware	P/N	Suffix	Ver.
System/Copy	D1295751	F	2.00.3
Network Support	D1295754	D	11.77.2
Network DocBox	D1295757	D	2.01
Fax	D1295753	D	02.03.00
RemoteFax	D1295752	D	02.00.00
Websupport	D1295755	D	1.11
WebUapl	D1295756	D	1.04
JAVA (Standard)	D1295735	C	10.03.01
JAVA (Option)	D6405750	G	10.03.01
Scanner	D1295759	C	01.11
Printer	D1295763	C	1.06
PCL	D1295762	C	1.08
FCU	D6295570	C	02.00.00

1. Installing the application

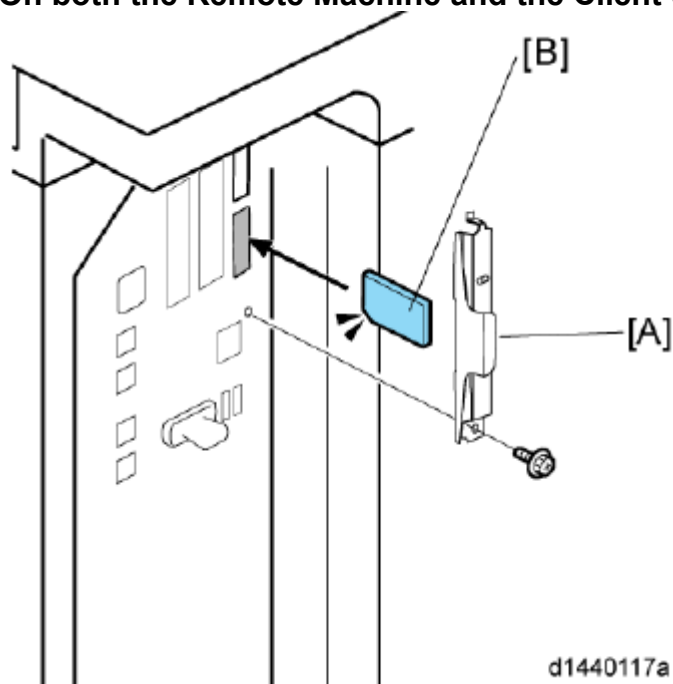
On both the Remote Machine and the Client-side Machines:

1. Remove the SD-card slot cover [A] from the SD card slots (Screw x 1)

Reissued:16-Jan-13

Model: AL-C2 Fax Connection Unit Type A

Date: 09-Apr-12

No.: RD629001a

2. Insert the SD card (Fax Connection Unit Type A) in SD slot 2 (lower) with its label face [B] towards the front of the machine. Then push it slowly into SD slot 2 (lower) until you hear a click.
3. Plug in, and then turn on the machine.
4. Move the Fax Connection Unit Type A application from the SD card in SD slot 2 (lower) to the SD card in SD slot 1 (upper) with SP5-873-001.
5. Turn off the machine.
6. Remove the SD card from SD slot 2 (lower), and then keep it in a safe place (see "SD Card Appli Move" in the manual for the main frame).
7. Attach the SD-card slot cover, and then turn on the machine (screw x 1)
8. Make sure that the machine can recognize the option (see 'Check All Connections' in the controller option section of the manual for the main frame)

2. Registering the Remote Machine

Note:

- Only one machine can be registered as the Remote Machine.

On the Client-side Machine(s):

1. Press the [User Tools/Counter] key on the operation panel
2. Press [Administrator Tools] .
3. **Press [Program/Change/Delete Remote Machine]**
4. Enter the IP address or host name of the Remote Machine.
5. Press [Set] to set after "connection test".
6. Press [Exit] to exit from the set-up procedure.

3. Registering the Client-side Machine(s)

Note:

- Up to six machines can be registered as the Client-side Machines.

On the Remote Machine:

1. Press the [User Tools/Counter] key on the operation panel
2. Press [Administrator Tools].
3. **Press [Program/Change/Delete Remote Machine]**
4. Enter the IP address or host name of the Client-side Machines.
5. Press [Set] to set after "connection test".

Reissued:16-Jan-13

Model: AL-C2 Fax Connection Unit Type A

Date: 09-Apr-12

No.: RD629001a

4. Configuring the Remote Reception Settings

Do the following procedure to enable the Client-side Machine(s) to receive faxes via the Remote Machine. You can forward or route received documents per line or special sender or box.

Note:

- By performing procedures #1-3 above, the Client-side Machines can **send** faxes via the Remote Machine. The procedures shown below are necessary to enable the Client-side Machines to **receive** faxes.

On the Remote Machine:

1) If you use "Remote Reception Setting per Line"

- Press [Facsimile Features].
- Press [Remote Reception Setting per Line] in [Reception Settings].
- Enter an IP address or a host name of the client-side machine to connect.
- Press [Set], and [Exit] to exit from the setting.

2) If you use "Remote Reception per Sender"

- Press [Facsimile Features] .
- Press [Program Special Sender] in [Reception Settings] .
- Select the Special Sender.

Program Special Sender		Exit	
Select destination to program or change.			
Program / Change		Delete	Initial Set Up
001 Tokyo branch	Full Agree	002 Head office of Osaka	Full Agree
003 branch	Part .Agree	004 ✕Not Programmed	Full Agree
005 ✕Not Programmed	Full Agree	006 ✕Not Programmed	Part .Agree
007 ✕Not Programmed	Full Agree	008 ✕Not Programmed	Full Agree
009 ✕Not Programmed	Full Agree	010 ✕Not Programmed	Full Agree
			1 / 2
			▲ Previous
			▼ Next

Reissued:16-Jan-13

Model: AL-C2 Fax Connection Unit Type A	Date: 09-Apr-12	No.: RD629001a
-----------------------------------------	-----------------	----------------

4. Press [Remote Reception Setting per Sender] .

Program / Change

Cancel OK

Check contents, then press [OK].

Own Name and Fax Number 1 Conditions: Full Agreement Partial Agreement

Authorized Reception per Sender Off Print 2 Sided per Sender Same as Basic Settings

RX File Print Qty per Sender Same as Basic Settings Memory Lock RX per Sender Same as Basic Settings

Forwarding per Sender Same as Basic Settings Paper Tray per Sender Same as Basic Settings

Remote Reception Setting per Sender On

▶ Remote Machine:

5. Press [On] and [Remote Machine] .

Remote Reception Setting per Sender

Cancel OK

Select item, then press [OK].

On Off

Remote Machine

6. Enter an IP address or a host name of the client-side machine to connect.
7. Press [OK] to exit from the setting.

Reissued:16-Jan-13

Model: AL-C2 Fax Connection Unit Type A

Date: 09-Apr-12

No.: RD629001a

3) If you use "Remote Reception per Box"

1. Press [Facsimile Features] .
2. Press [Box Setting] in [General Settings] .

The screenshot shows the 'Facsimile Features' menu with several tabs: General Settings, Scan Settings, Send Settings, Reception Settings, and Initial Settings. The 'General Settings' tab is active. Within this tab, the 'Box Setting' option is highlighted with a red box. Other options visible include Quick Operation Key 1, Quick Operation Key 2, Quick Operation Key 3, Switch Title, Search Destination, Communication Page Count, and Adjust Sound Volume.

3. Select the box.

The screenshot shows the 'Box Setting' screen with the instruction 'Select Box to program or change.' Below this, there are two columns of boxes. The first column contains boxes for 'sales department', 'accounting division', 'personnel division', and 'planning department'. The second column contains boxes for 'sales department', 'design division', 'secretarial division', and '* Not Programmed'. The '* Not Programmed' box is highlighted with a red box. Navigation buttons 'Previous' and 'Next' are visible on the right side.

Reissued:16-Jan-13

Model: AL-C2 Fax Connection Unit Type A	Date: 09-Apr-12	No.: RD629001a
-----------------------------------------	-----------------	----------------

4. Press [Personal Box] .

5. Enter a dial-in number.

6. Press [Remote Machine] .

7. Enter an IP address or a host name of the client-side machine to connect.

8. Press [OK] to exit from the set-up procedure.

Reissued:16-Jan-13

Model: AL-C2 Fax Connection Unit Type A

Date: 09-Apr-12

No.: RD629001a

5. Remote Fax Icon Addition for Remote Machine

This procedure allows the remote fax icon to appear on the home screen of the operation panel.

On both the Remote Machine and the Client-side Machines:

1. Press [User Tools].
2. Press [Edit Home].

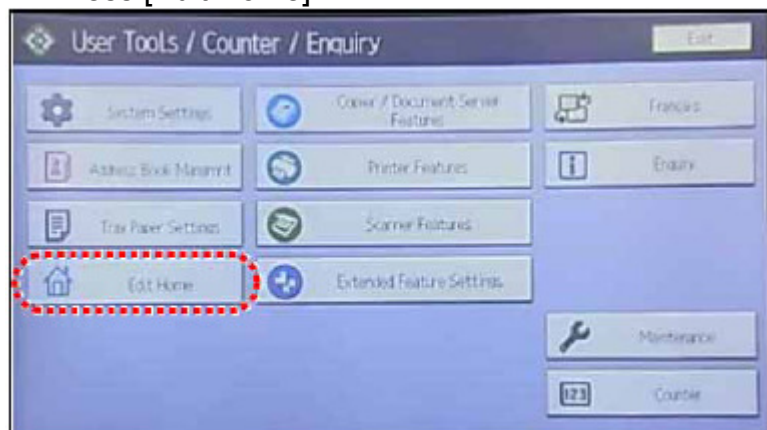

d1440144

3. Press [Add Icon].

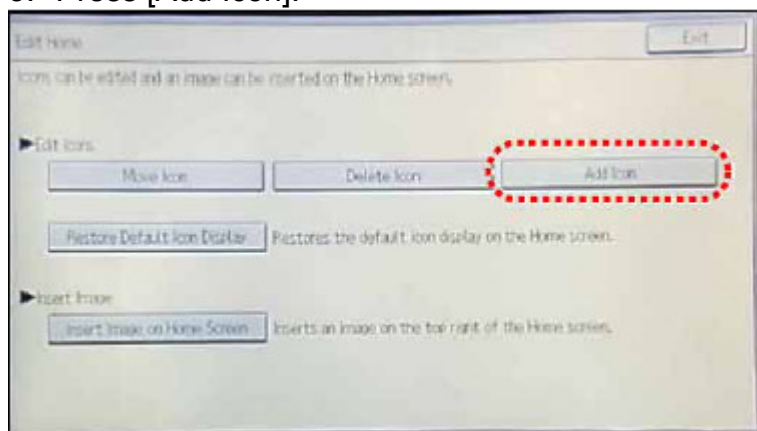

d1440145

Reissued:16-Jan-13

Model: AL-C2 Fax Connection Unit Type A	Date: 09-Apr-12	No.: RD629001a
-----------------------------------------	-----------------	----------------

4. Press [Remote Fax].

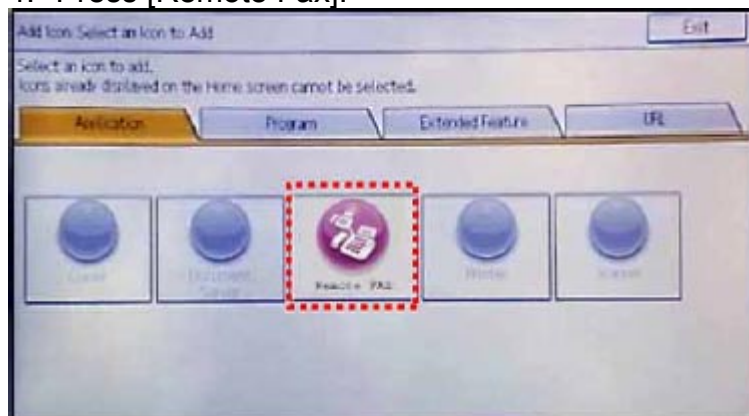

d1440146a

5. Press a [Blank] to set a location for the remote fax icon.

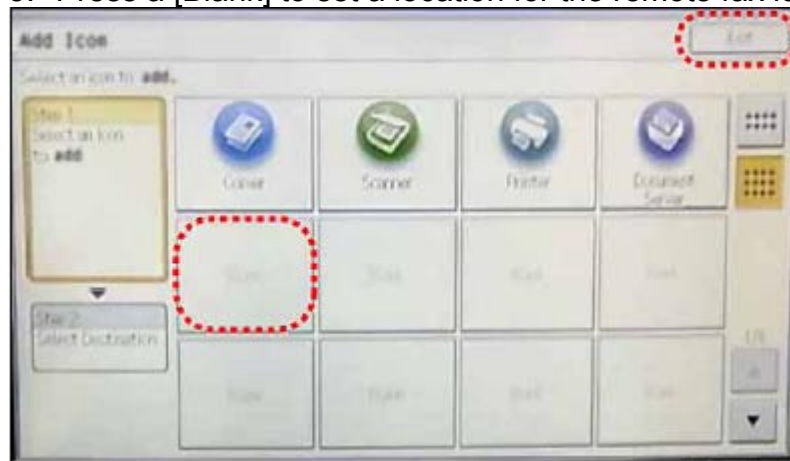

d1440147

6. Press [Exit] to exit from the set-up procedure.

Reissued: 10-Jul-17

Model: AL-C2	Date: 17-May-13	No.: RD129047b
--------------	-----------------	----------------

RTB Reissue

The items in ***bold italics*** were corrected or added.

Subject: Part Catalog Correction		Prepared by: A.Ishida	
From: 2nd Tech Service Sect., MFP/P Tech Service Dept.			
Classification:	<input type="checkbox"/> Troubleshooting <input type="checkbox"/> Mechanical <input type="checkbox"/> Paper path <input type="checkbox"/> Product Safety	<input checked="" type="checkbox"/> Part information <input type="checkbox"/> Electrical <input type="checkbox"/> Transmit/receive <input type="checkbox"/> Other ()	<input type="checkbox"/> Action required <input type="checkbox"/> Service manual revision <input type="checkbox"/> Retrofit information <input type="checkbox"/> Tier 2

Change/Reason: The following part number is revised from the previous RTB.

Index	New part number	Description	Q'ty	Int	Page	Note
1	D3465734	SPEAKER BRACKET	1		3	-
13	D6295731 D6295720	BRACKET:FAX CONTROL UNIT	1		3	-

1.Fax Option (D692)

