

Printer Controller EB-34

PARTS CATALOG

This catalog gives the numbers and names of parts on this machine.

1. Printer Controller EB-34	1 P
2. Printer Controller EB-34	3 P
3. Parts Index.....	5 P

1. Printer Controller EB-34

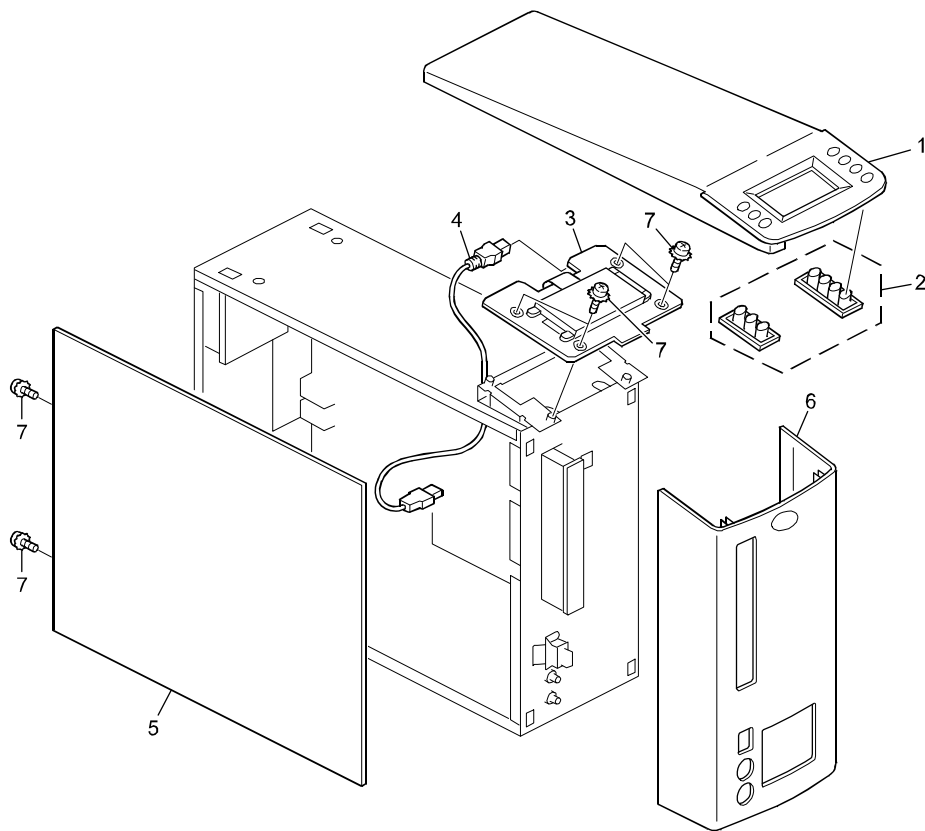

【MEDIA】

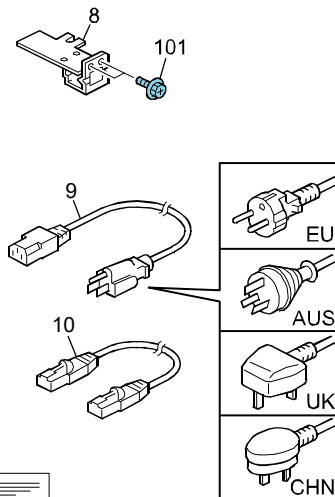

【SERVICE】

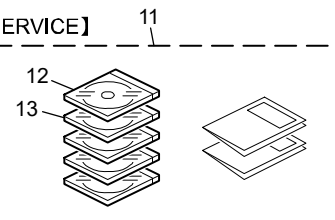

1. Printer Controller EB-34

[illegible][illegible]

2. Printer Controller EB-34

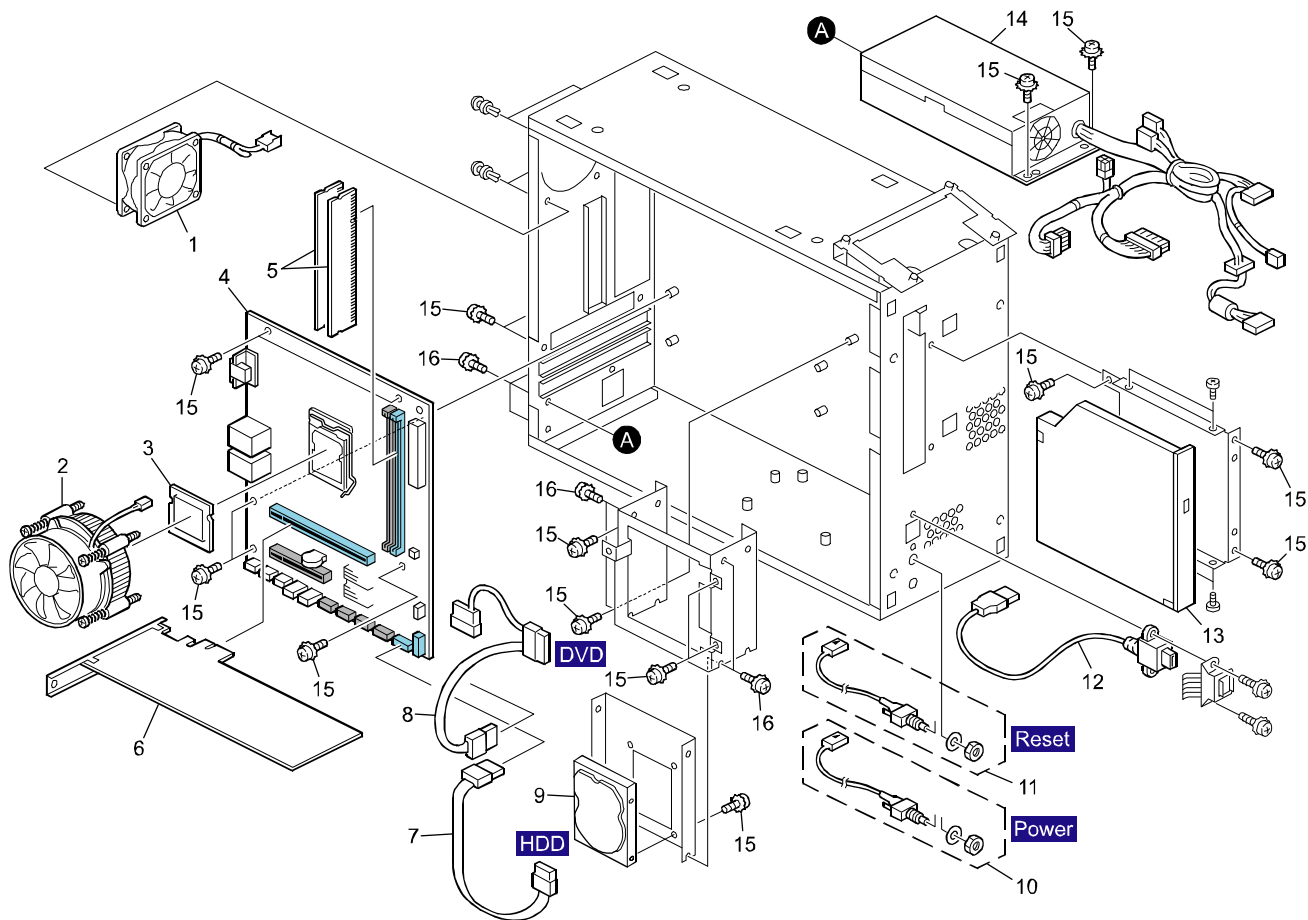

2. Printer Controller EB-34

[illegible][illegible]

3. Parts Index

Part No.	Description	Page and Index No.
04543006Q	TAPPING SCREW:3X6	2 - 101
D3DT6010	KIT:MOTHER BOARD:BR2:S5517:45151104	4 - 4
D3DT6106	KIT:FRONT_BEZEL:EXP:45151105	2 - 6
D3DT6613	KIT:SERVICE_V3.0:EXP:45152855	2 - 11
D3DT6636	DVD-ROM:USER_V3.0:EXP:45152841	2 - 12
D3DT6646	DVD-ROM:SYS_V3.0:EXP:45152840	2 - 13
D4501190	SCREW:M3X.5X6MM:LONG	2 - 7
D4501190	SCREW:M3X.5X6MM:LONG	4 - 15
D4501200	SCREW:#6 32X1/4:LONG	4 - 16
D4508610	KIT:POWER SUPPLY CORD:NA	2 - 9
D4508611	KIT:POWER SUPPLY CORD:UK	2 - 9
D4508612	KIT:POWER SUPPLY CORD:EU	2 - 9
D4508613	KIT:POWER SUPPLY CORD:AUS	2 - 9
D4731050	KIT:PCB:UIB	2 - 3
D4731080	KIT:FAN:CASE	4 - 1
D4731110	KIT:TOP BEZEL	2 - 1
D4731120	KIT:DRIVE:CD DVD	4 - 13
D4731130	KIT:SIDE PANEL	2 - 5
D4731140	KIT:CABLE:UIB20INCH	2 - 4
D4731150	KIT:ASM:POWER W	4 - 10
D4731160	KIT:ASM:RESET W	4 - 11
D4731170	KIT:CABLE:HDD:SATA	4 - 7
D4731180	KIT:CABLE:USB2.0:12IN	4 - 12
D4731190	KIT:BUTTON:UIB	2 - 2
D7266030	KIT:IC:CPU:G850	4 - 3
D7266040	KIT:COOLING:CPU	4 - 2
D7266070	KIT:POWER SUPPLY UNIT:180W	4 - 14
D7266090	KIT:HDD:500G	4 - 9
D7306036	PCB:GIGAETHERNET:PCIE:ASS'Y	2 - 8
M3828614	KIT:CABLE:GIGA NIC12M	2 - 10
M3911110	KIT:CABLE:DVD:SATA:45086560	4 - 8
M3918615	KIT:POWER SUPPLY CORD:CHN	2 - 11
M4361040	KIT:RAM:DDR3:2GB	4 - 5
M4686020	KIT:PCB:YUZU:WEF-D:45122142	4 - 6

[illegible]

Fiery Patch Release Notes

PAGE: 1/2

Model: Printer_Contrller EB-34 (BR-C2/P2) System Version: 3.0	Date: Oct 16, 2017	Revision:
Patch file: <ul style="list-style-type: none">● FIT101654790.exe (Security patch 001)● uninstall_sp.exe (uninstaller)		

Uninstallation Capability	<input checked="" type="checkbox"/> YES <input type="checkbox"/> NO
Uninstaller Patch File	uninstall_sp.exe

Table of Contents

- Issues addressed with this release
- Before installing FIT101654790.exe
- Patch installation instructions
- About the uninstaller (uninstall_sp.exe)
- Notes for uninstalling FIT101654790.exe
- Uninstaller patch installation instruction

Issues addressed with this release

Patch ID	Description
FIT101654790	Fiery Patch to address Security vulnerabilities. <ul style="list-style-type: none">● Apache : 2.2.31● PHP : 5.6.27● OpenSSL : 1.0.2J

Before installing FIT101654790.exe

1. Known issues listed below, read before installing **FIT101654790.exe** patch:
 - None.
2. The following prerequisite(s) must be installed in the order specified before applying the **FIT101654790.exe** patch:
 - SP1_FIT101567619
3. Do **NOT** install any of the following patch(es) after installing the **FIT101654790.exe** patch. If you must install any of the patch(es) below, do so before installing the **FIT101654790.exe** patch:
 - None.
4. This patch is exclusive, it must be installed by itself (no other patches should accompany this patch while installing), and the server must be rebooted or restarted once. After that, other patches can be applied to the server.

Note: If you have installed other non-exclusive patches before this patch you must reboot the server to apply those patches first.

5. In the case where the customer needs to install a patch which was previously skipped in the patch order, it is necessary to reinstall the system.

Patch installation instructions

1. Make sure that the Fiery printer controller reaches Idle.
2. Execute **FIT101654790.exe** and follow the instructions in the Fiery Patch Downloader.
3. Notes about the Fiery Patch Downloader
 - a. Logon must be admin. This is fixed and cannot be modified.
 - b. Password is the Fiery administrator login password.
 - c. Hostname can be the IP address or the Fiery server name.
4. After the patch is downloaded, and when prompted by the Fiery Patch Downloader, choose Reboot.
5. Wait until the Fiery controller reaches Idle and print the Configuration page.
6. If the controller does not eventually reach Idle, please manually start the Fiery service.
7. Verify that the System Updates Log section contains the patch number **FIT101654790**.

About the Uninstaller Patch

1. The uninstaller patch (**uninstall_sp.exe**) uninstalls the last patch applied to the system.
2. The uninstaller patch can only be used when the patch you intend to uninstall has the uninstallation capability.
3. The uninstaller patch uninstalls one patch at a time. Once the server reaches idle after uninstallation of the patch, the server will return to the state before the patch was first installed.
4. The uninstaller patch is exclusive and must be installed independently. Reboot the server, to install other patches.

Notes for uninstalling the FIT101654790.exe

This **FIT101654790.exe** patch has the uninstaller capability.

To uninstall this patch, make sure to use the uninstaller patch (**uninstall_sp.exe**) that is provided with **FIT101654790.exe** patch.

1. If **FIT101654790.exe** is not the last patch applied to the system, every patch installed after **FIT101654790.exe** must be uninstalled one by one before uninstalling **FIT101654790.exe**.
2. Important notes for uninstalling **FIT101654790.exe** patch with the uninstaller patch:
 - None

Uninstaller Patch installation instructions

1. Make sure that the Fiery printer controller reaches Idle.
2. Execute **uninstall_sp.exe** and follow the instructions in the Fiery Patch Downloader.
3. Notes about the Fiery Patch Downloader
 - a. Logon must be admin. This is fixed and cannot be modified.
 - b. Password is the Fiery administrator login password.
 - c. Hostname can be the IP address or the Fiery server name.
4. After the patch is downloaded, and when prompted by the Fiery Patch Downloader, choose Reboot. (If you choose to Restart later, make sure you manually reboot the server for the changes to take effect)
5. Wait until the Fiery controller reaches Idle and print the Configuration page.
6. Verify that the System Updates Log section does NOT contain **the patch number FIT101654790.exe**.