

Duplex Unit Type 7000

(Code: G348)

For Machine Code: G080 INSTALLATION GUIDE

⚠ Caution

- Before installing options, the machine should be turned off and unplugged for at least thirty minutes. Components inside the machine become very hot, and could result in a burn if touched.
- When lifting the machine, use the grips on both sides. The machine could break or cause injury if dropped.
- It is dangerous to handle the plug with wet hands. Doing this may result in receiving an electric shock.
- Before moving the machine, unplug the power cord from the outlet. If the cord is unplugged abruptly, it could become damaged. Damaged plugs or cords can cause an electrical or fire hazard.
- The inside of the machine becomes very hot. Do not touch the parts label "hot surface". Touching a "hot surface" could result in a burn.
- Do not let go of the duplex reversal unit until it is fastened in place. It could fall and cause injury.

● Important

- ☐ Check the printer nameplate to confirm the model code.
- ☐ If you want to use the optional paper feed unit at the same time, install the optional paper feed unit first, and then install the duplex unit.

1 Installing the Duplex Reversal Unit Stand

1 Check the contents of the box.

Description	Q'ty
Stand	1
Paper Guide	1
Short Screw	1
Long Screws	4
Duplex Reversal Unit	1
Duplex Feed Unit	1
Installation Guide (This sheet)	1

2 Remove the adhesive tape and packing materials.

● Important

- ☐ Do not remove the adhesive tape holding the auxiliary bar yet. Remove it in step 3 on 2 Installing the Duplex Reversal Unit.
- ☐ Do not remove the adhesive tape holding the cable of the duplex reversal unit yet. Remove it in step 7 on 2 Installing the Duplex Reversal Unit.

Duplex Reversal Unit

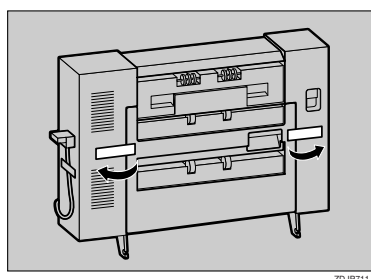

Duplex Feed Unit

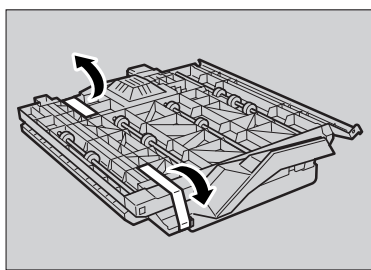

3 Turn off the power, and then unplug the power cable from the wall outlet.

4 Lift the external tray in the direction of the arrow (①), and then remove (②).

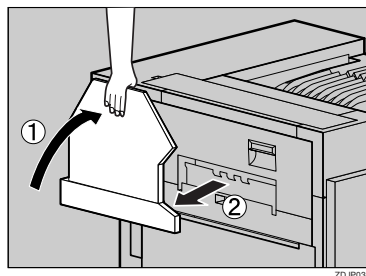

5 Remove the two small covers on the upper left cover of the printer.

① Open the upper left cover.

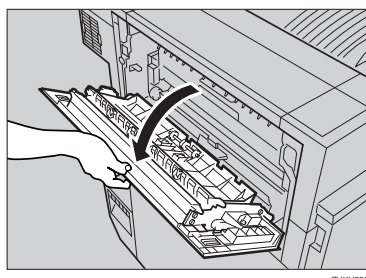

② Remove the two small covers by pinching and pulling them in the direction of the arrow.

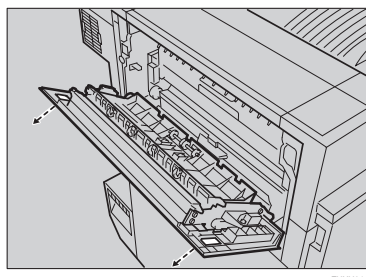

③ Close the upper left cover.

● Note

- ☐ You cannot use the two removed covers.

- 6** Remove the protective cover on the left side of the printer. Hold the protective cover by both sides, and while pushing the left side of the cover (①), open it in the direction of the arrow (②), and then remove (③).

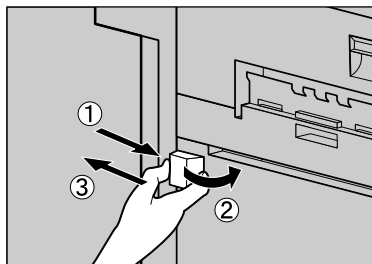

Note

- ❑ You cannot use the removed protective cover.

- 7** Attach the paper guide to the stand. Hold it so that the right side bends down as shown, and then while gripping lightly (①), insert it into the holes of the stand (②).

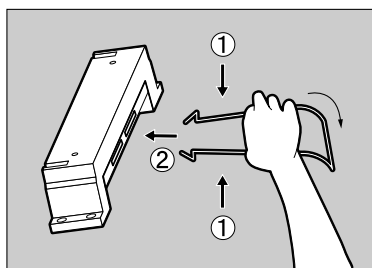

- 8** Insert the claws of the stand into the holes on the left side of the printer (①), and then push down (②).

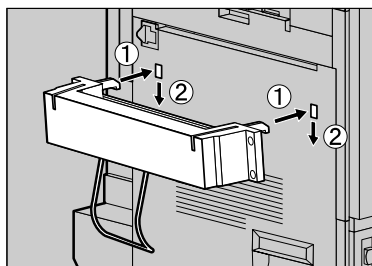

- 9** Slowly open the front cover by pulling on the two areas on the left and right.

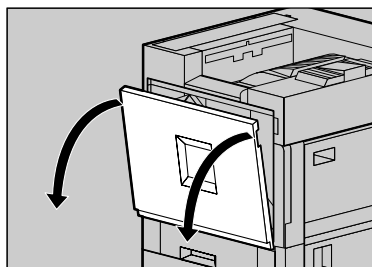

- 10** Remove the green screwdriver, and then close the front cover.

Use this screwdriver for all attachment and detachment of screws.

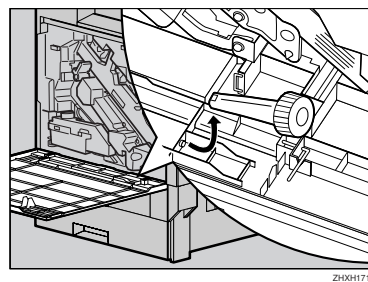

Note

- ❑ After using the screwdriver, return it to its original position on the inside of the front cover.

- 11** Tighten the four long screws fastening the duplex reversal unit stand, using provided screwdriver. Fasten in the order of ①⇒②⇒③⇒④, as shown.

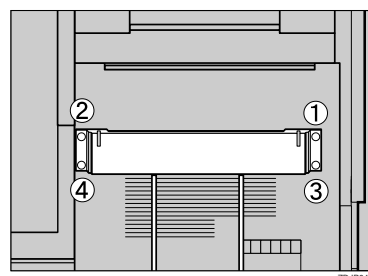

This completes the installation of the stand. Next, install the duplex reversal unit.

2 Installing the Duplex Reversal Unit

- 1** With both hands, hold the duplex reversal unit level, and then insert the hooks into the groove of the stand. Adjust the tip of the hooks to the line on the stand, as shown, and then insert slowly. Do not let go of the duplex reversal unit even after insertion.

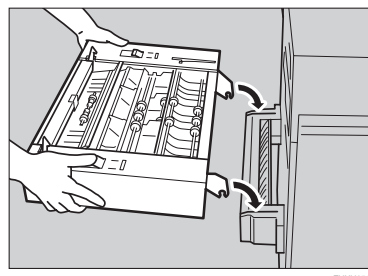

The hooks of the duplex reversal unit clip around the bar inside the groove of the stand.



2

While supporting the duplex reversal unit, remove the stopper of the printer's mounting bracket.

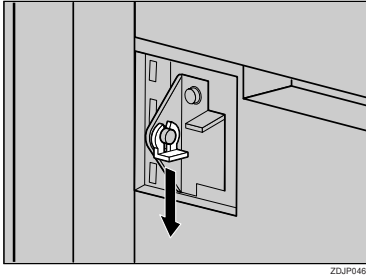

This stopper will be used in a later step 5, so take care not to lose it.

3

While supporting the duplex reversal unit, remove the adhesive tape, and then hold the auxiliary bar in front of the hook on the left side, and then stand it up.

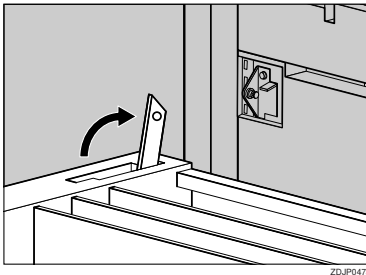

4

Hook the hole of the auxiliary bar onto the printer's mounting bracket.

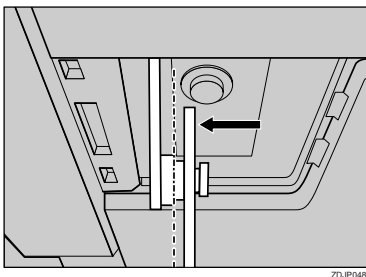

In step 5, move the auxiliary bar to the position with the perforated line, as shown.

5

Hang the auxiliary bar on the far left end, as shown, and then install the stopper removed in step 2.

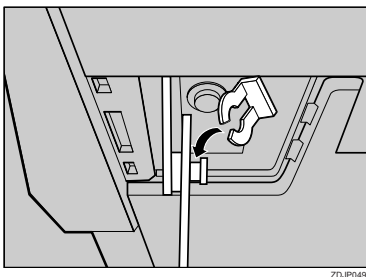

Make sure the auxiliary bar and stopper are installed in the positions, as shown.

6

Slowly raise the duplex reversal unit, and then fold it up to the printer.

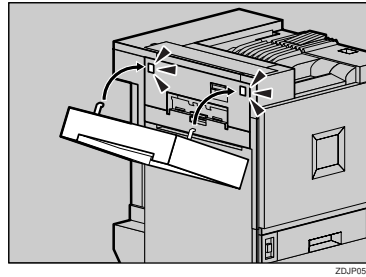

7

Remove the adhesive tape holding the cable, and then connect the cable from the duplex reversal unit to the upper connector on the back of the printer.

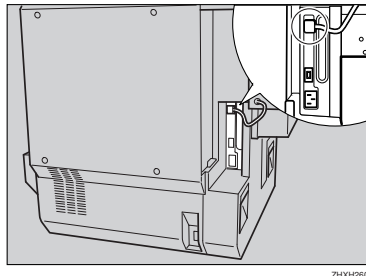

This completes installation of the duplex reversal unit. Install the duplex feed unit after the external tray.

8

Install the external tray.

1 Stand the external tray, and then insert it from the left side using both hands.

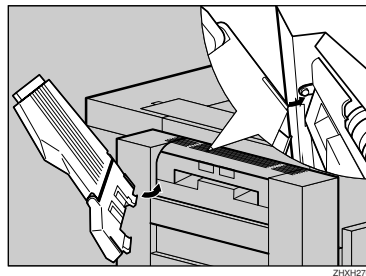

2 Pushing the right edge of the external tray lightly with your finger (1), insert it (2).

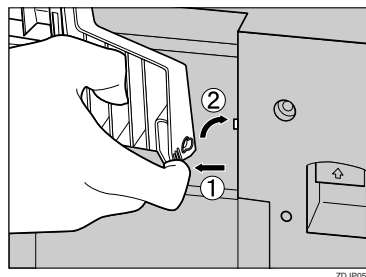

- 3 Lower the external tray toward you.

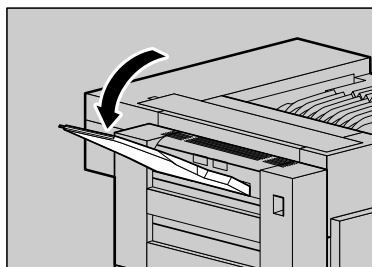

3 Installing the Duplex Feed Unit

- 1 Slowly open the front cover by pulling on the two areas on the left and right.

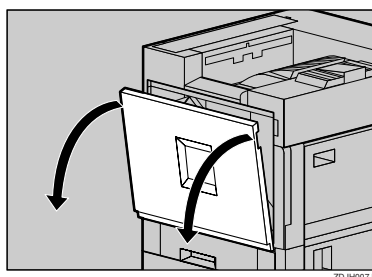

- 2 Slowly open the waste oil bottle in the direction of the arrow.

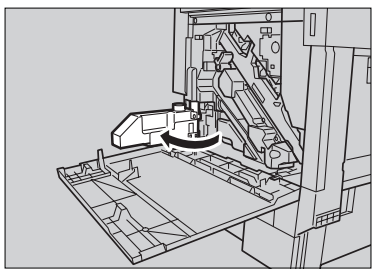

- 3 Holding the duplex feed unit using both hands, place it on the vertical rail, and then slide it slowly in until it stops.

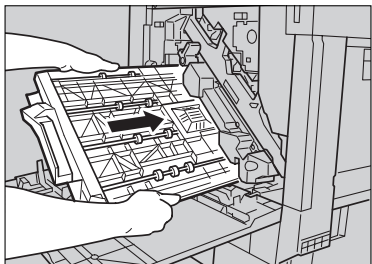

The vertical rail is in the position, as shown.

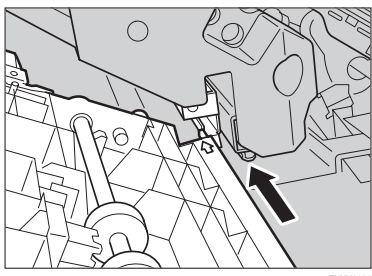

- 4 Fasten the duplex feed unit using a short screw and the provided screwdriver.

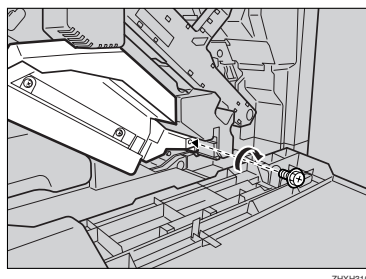

- 5 Be sure to return the provided screwdriver to its original position on the inside of the front cover.

This completes installation of the duplex feed unit.

- 6 Slowly push back the waste oil bottle in the direction of the arrow.

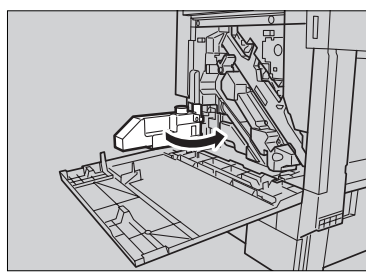

- 7 Slowly close the front cover by pressing the two areas on the left and right.

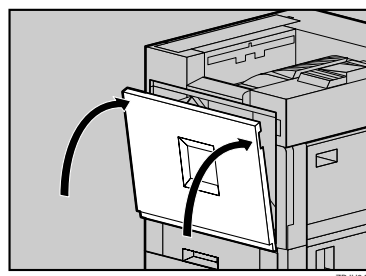

Note

- ☐ After finishing the installation, you can check the duplex unit is installed properly: Print the configuration page from the "List/Test Print" menu. If it is installed properly, you will see "Duplex Unit" appear in the "Options" list. (G080)
- ☐ If the duplex unit is not installed properly, repeat the procedure from step 1. If you cannot install it properly even after reinstallation, contact your sales or service representative.

- 8 Check for leftover parts. You will not need these.

