

Model: Triton-C1 ADF (DF81)		Date: 3-Jun-05	No.: MB721001
Modified Article: Grounding Tape		Prepared by: M. Tsuyuki	
From: 1st Tech. Support Sec. Service Support Dept.			
Reason for Modification:	<input type="checkbox"/> Parts catalog correction <input type="checkbox"/> To facilitate assembly <input type="checkbox"/> Part standardization	<input type="checkbox"/> Vendor change <input checked="" type="checkbox"/> To improve reliability <input type="checkbox"/> Other	<input type="checkbox"/> To meet standards ()

Old part number	New part number	Description	Q'ty	Int	Page	Index
	B7215006	Grounding Tape (6LA56652000)	1		11	6

Change: Grounding tape was added.

Reason: To reduce static electricity buildup and improve the stacking of the originals.

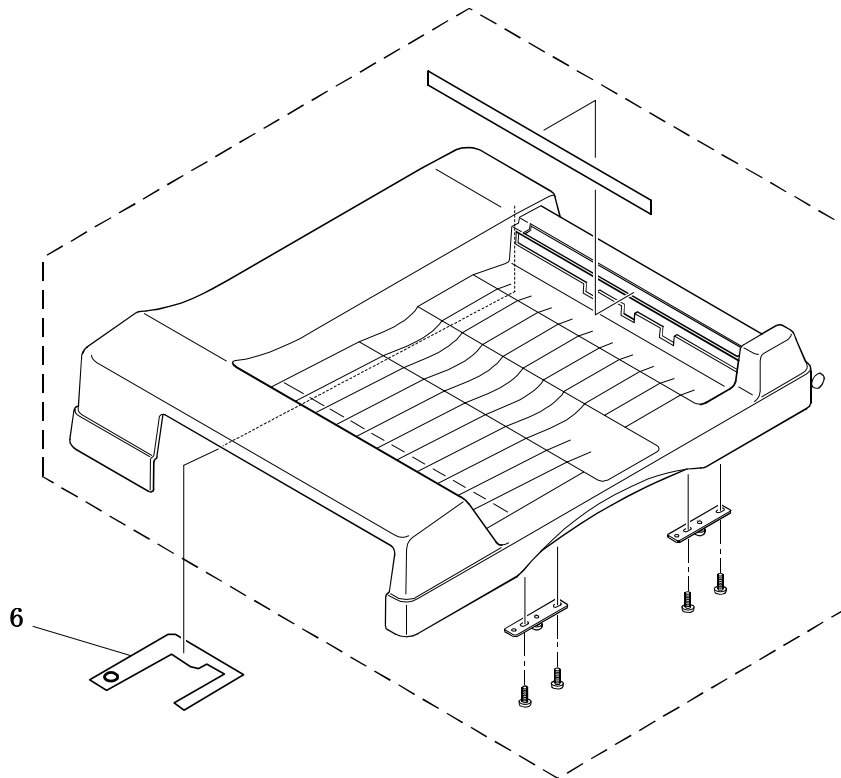

CUT-IN SERIAL NUMBERS

Model:
B186-17

From:
From First Production

Model: Triton-C1 ADF (DF81)		Date: 2-Aug-05	No.: MB721002
Modified Article: Holder Pad Etc.		Prepared by: M. Tsuyuki	
From: 1st Tech. Support Sec. Service Support Dept.			
Reason for Modification:	<input checked="" type="checkbox"/> Parts catalog correction <input type="checkbox"/> To facilitate assembly <input type="checkbox"/> Part standardization	<input type="checkbox"/> Vendor change <input type="checkbox"/> To improve reliability <input type="checkbox"/> Other	<input type="checkbox"/> To meet standards ()

Change/Reason: The Parts Catalog was corrected as follows.

Old part number	New part number	Description	Q'ty	Int	Page	Index
B7211030		Holder Pad (4408090680)	1->0		3	30
B7211032		Pad (4408692190)	1->0		3	32
B7211033		Mylar Hld Pad (4408690730)	1->0		3	33
B7213014	B7213214	Roller Exit (4408691210) Roller Exit (4408694720)	1	X/O	7	14
B7215102	B7215152	Spring Ass'y (4408691820) Spring Ass'y (4408693020)	1	X/O	13	3

1. ASM FEED

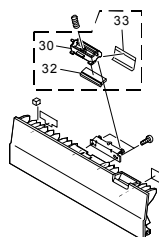

3. ASM EXIT

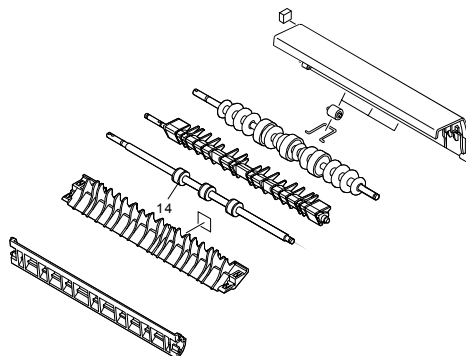

6. Hinge

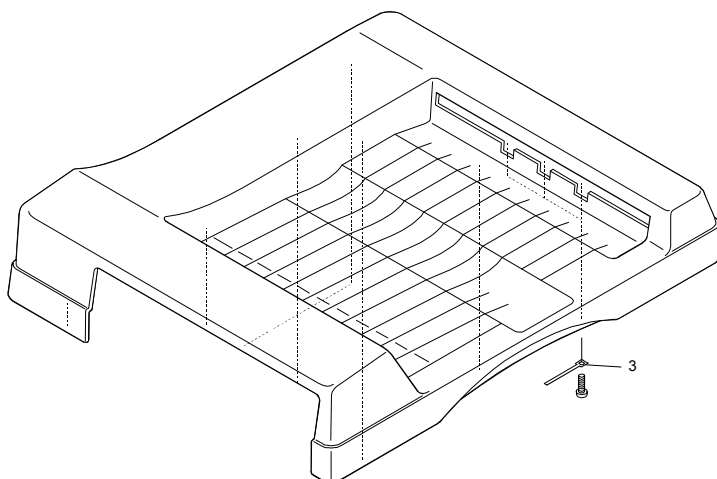

Model:DF81		Date: 28-Aug-06	No.: MB721003
Modified Article: SNR:ROM_512KBIT:6LE68179000		Prepared by: Y.Murata	
From: 1st Tech. Support Sec. Service Support Dept.			
Reason for Modification:	<input type="checkbox"/> Parts catalog correction <input type="checkbox"/> To facilitate assembly <input type="checkbox"/> Part standardization	<input type="checkbox"/> Vendor change <input type="checkbox"/> To improve reliability <input type="checkbox"/> Product Safety	<input type="checkbox"/> Other <input checked="" type="checkbox"/> To meet standards (RoHs compliant)

Old part number	New part number	Description	Q'ty	Int	Page	Index	Note
B7215108	B7215158	SNR:ROM_512KBIT:6LE68179000	1	X/O	13	9	

Change: Material of this part has changed.

Reason: To comply with RoHs standard.



Part Change Information List

Date: April 30, 2010

Model	Code	PCIL Nr.	PCIL Correction	Old part number	New part number	Description	Old Q'ty	New Q'ty	Int	3DPC	Page	Index	Set	Set Int	RTB	Note	Ref. Nr.	ECN Nr.
TR-C1 ADF (DF81)	B721	201004		B7211052	B7219752	SCREW M4X8 (X0-02577000)	3	3	O/O		3	54					V0903228	
TR-C1 ADF (DF81)	B721	201004		B7211052	B7219752	SCREW M4X8 (X0-02577000)	3	3	O/O		5	27					V0903228	



Part Change Information List

Date: May 31, 2010

Model	Code	PCIL Nr.	PCIL Correction	Old part number	New part number	Description	Old Q'ty	New Q'ty	Int	3DPC	Page	Index	Set	Set Int	RTB	Note	Ref. Nr.	ECN Nr.
TR-C1 ADF (DF81)	B721	201005		B7214038	B1869716	TAPPING SCREW - M3X6(X0-02592000)	14	14	O/O		9	38					V1000195	