

Model: AD1 (New DF65 Option)		Date: 15-Mar-98	No: 50
Subject: New Model for AD1E		Prepared by: K.Ugaeri	
From: QAC Field Information Dept.			
Classification:	<input type="checkbox"/> Troubleshooting <input type="checkbox"/> Mechanical <input type="checkbox"/> Paper path <input checked="" type="checkbox"/> Other ()	<input type="checkbox"/> Part information <input type="checkbox"/> Electrical <input type="checkbox"/> Transmit/receive	<input type="checkbox"/> Action required <input type="checkbox"/> Service manual revision <input type="checkbox"/> Retrofit information

We hereby inform you that a new ARDF has been launched with a new trailing edge sensor to speed up ARDF scanning for the AD1E (25 cpm). New product codes are as follows.

Product Code	Model Name	Current Product Code
A661-50	DF65 for Gestetner	A661-10
A661-30	DF65 for Savin	A661-15
A661-57	DF65 for Ricoh	A661-17
A661-66	DF65 for Danka	A661-26
A661-60	DF65 for Lanier	A661-55

New product can be installed on the AD1 and the AD1E. When installed on the AD1E, please change the dip switch on the ARDF control board from Normal to Ex position as shown the instruction manual. The different parts list between new product and old one is attached (Scanning speed with AD1E: 20cpm by 1 to 1 copy).

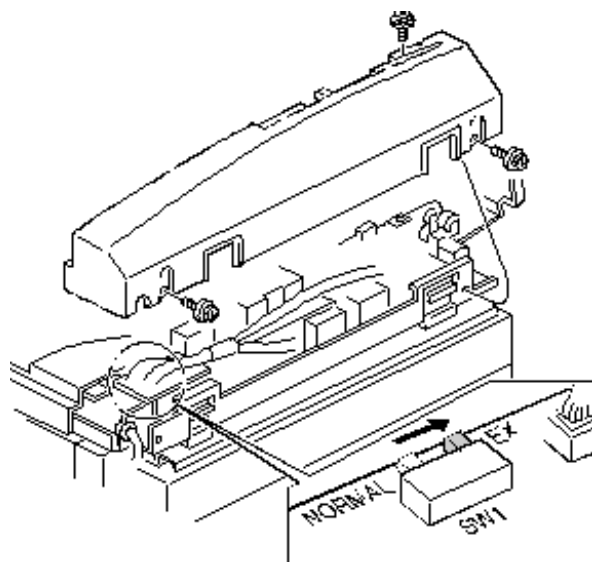

The old product can also be used with the AD1 and AD1E (its scanning speed for both models is 15 cpm for 1 to 1 copying).

Model: AD1 (New DF65 Option)

Date: 15-Mar-98

No:50

Different parts between old and new DF65

	New Part Number	Description	Index No
1.	A6612211	Side Fence	5-16
2.	A6615760	Relay Harness - Original Tray	5-22
3.	A6615765	Relay Harness - Trailing Edge Sensor	5-48 (new)
4.	A6612165C	Original Table Bracket	5-29
5.	A6612232	Bracket - Trailing Edge Sensor	5-49 (new)
6.	A6612141D	Front Original Table	5-47
7.	A6615510	ARDF Control Board 2	13-21
8.	AW010066	Photosensor-PS-R50D1-B	5-23 (new)

Note

Items 1, 2, 4, 6, & 7 can be used for the old DF65. Refer to MB no.2 for the DF65.

To standardize the service spare parts, you can use new parts for old DF65 units in the field.

Item 1:

The collar is removed so the new sensor will not be blocked.

Item 6:

A hole is made for the new sensor.

Item 8: New sensor

Item 3:

The harness between the ARDF control board and harness 22.

Item 5:

The bracket for new sensor.

Item 2:

Item 4:

Holes for installing the sensor have been made in the bracket.

