

ARDF DF3040
Machine Code: D540
Field Service Manual

6 August, 2010

TABLE OF CONTENTS

1. Replacement and Adjustment

Covers and Tray.....	3
Front and Rear Cover.....	3
Original Tray.....	3
Document Feed Components.....	5
Pick-Up Roller.....	5
Feed Belt.....	5
Separation Roller.....	7
Electrical Components.....	9
DF Drive Board.....	9
Original Length Sensors and Trailing Edge Sensor.....	9
Original Set, Separation, Skew Correction and Scanning Entrance Sensor.....	10
Original Width Sensors.....	11
Registration Sensor.....	12
Original Exit Sensor.....	13
DF Position Sensor.....	13
Cover Sensor.....	14
Pick-up Roller HP and Original Stopper HP Sensor.....	14
Stamp Solenoid.....	16
Original Feed Drive.....	18
ADF Feed Motor.....	18
ADF Inverter Motor.....	19
ADF Transport Motor.....	20
ADF Pick-up Motor.....	20
INDEX.....	23



1. Replacement and Adjustment

Covers and Tray

1

Front and Rear Cover

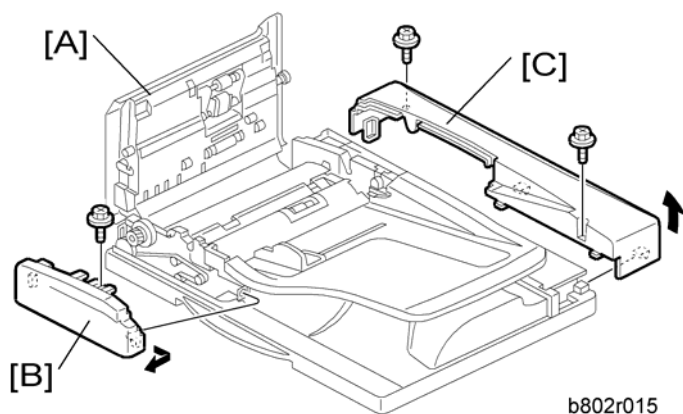



1. Open the left cover [A].
2. Front cover [B] (⚙ x 1, hook x 2)
3. Rear cover [C] (⚙ x 2, hook x 2)

Original Tray

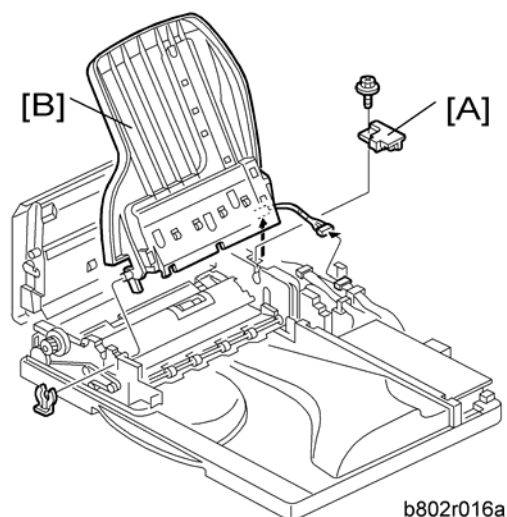
1. Open the left cover.
2. Rear cover (🖱 "Front and Rear Cover")
3. Front cover (🖱 "Front and Rear Cover")



4. Pivot cover [A] ( x 1)

5. Original tray [B] ( x 1,  x 1,  x 2)

Document Feed Components

Pick-Up Roller

1

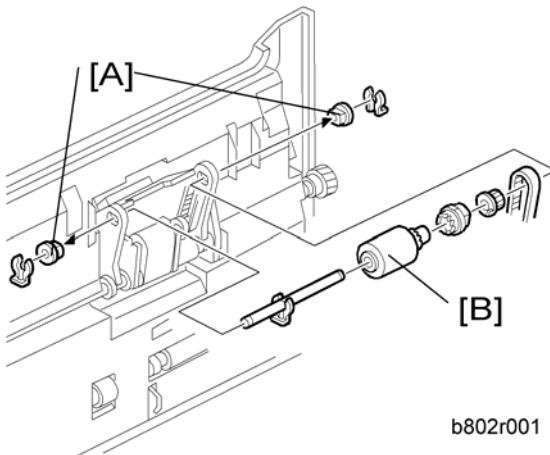

1. Open the left cover.
2. Bushings [A] (1x 1 each)
3. Pick-up roller [B] (gear x 1, one-way gear x 1)

Feed Belt

1. Open the left cover.

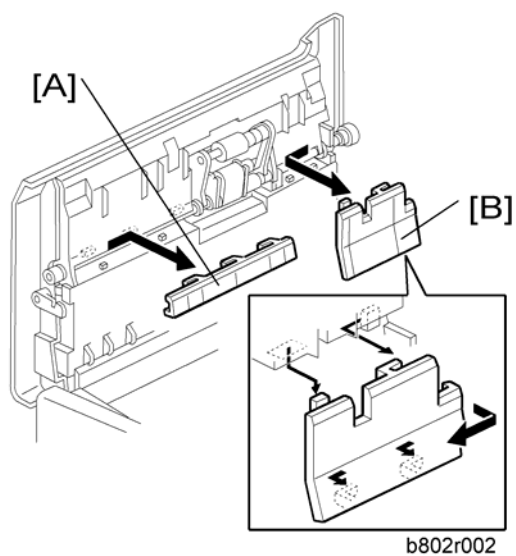

2. Front feed unit cover [A]

3. Rear feed unit cover [B] (hook x 2)

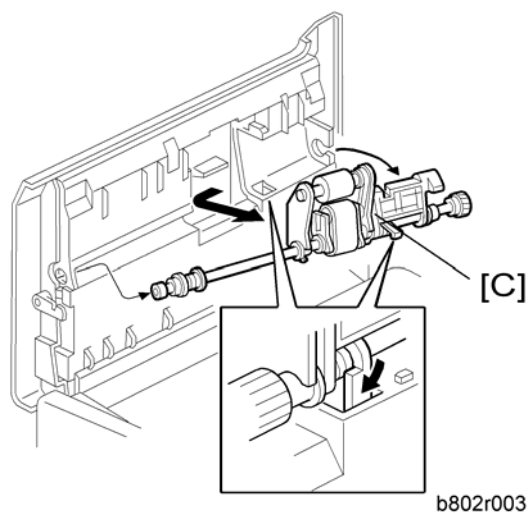

4. Feed belt unit [C]

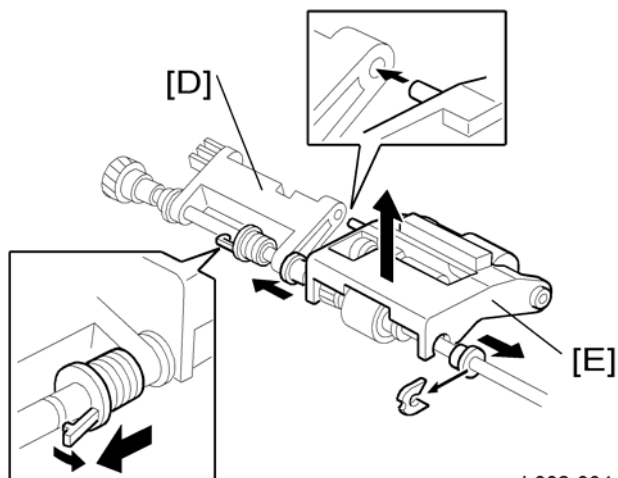

b802r004

5. Slide the tension plate [D] (hook)

6. Belt unit cover [E] (1)

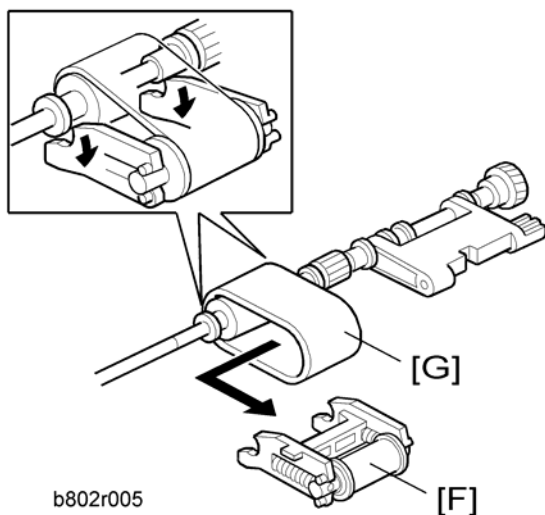

b802r005

7. Belt tension unit [F]

8. Feed belt [G]

Separation Roller

1. Open the left cover.

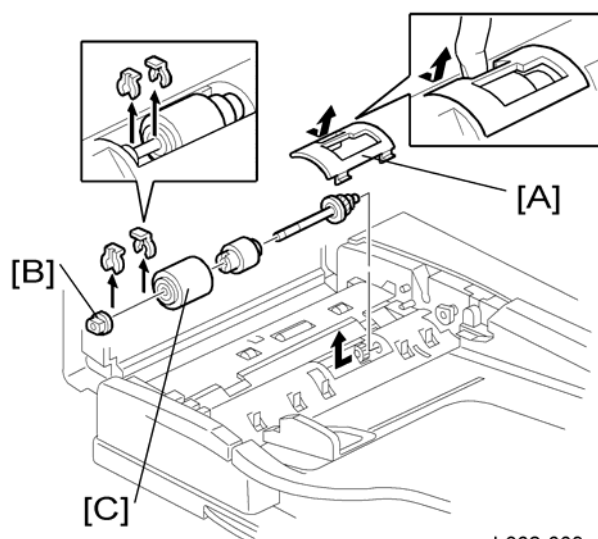

b802r009

2. Separation roller cover [A]
3. Remove the bushing [B] (1).
4. Slide the separation roller shaft to the front side, and then remove it.
5. Separation roller [C] (1)

Electrical Components

DF Drive Board

1

1. Rear cover (🔩 "Front and Rear Cover")

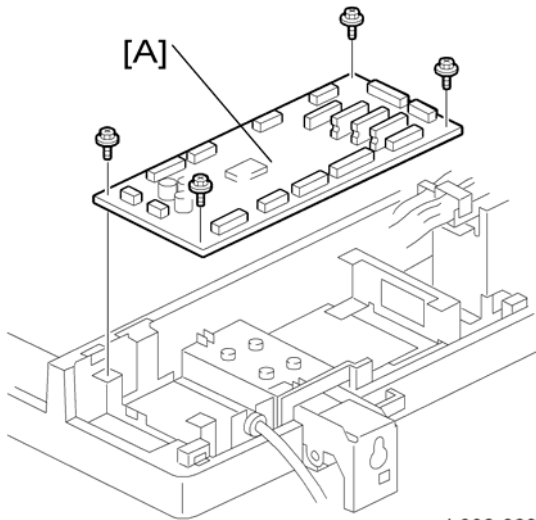



b802r023

2. DF drive board [A] (🔩 x 4, all 📦 s)

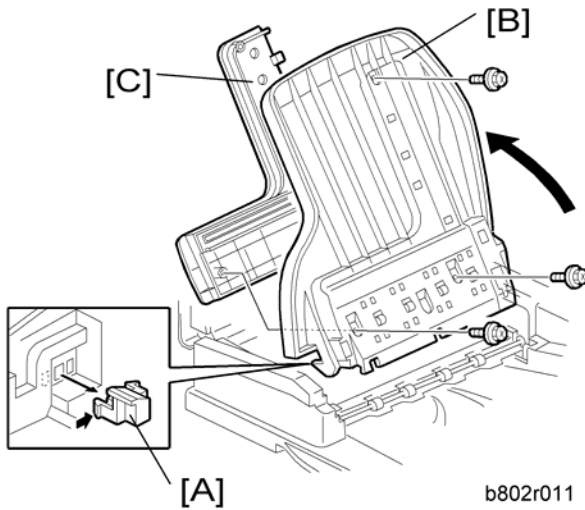

Original Length Sensors and Trailing Edge Sensor

1. Open the left cover.

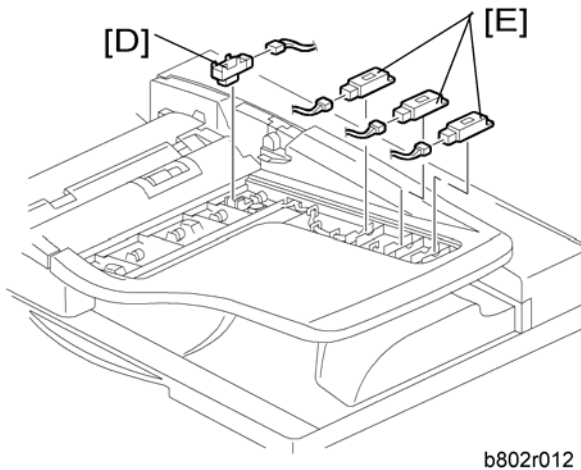

2. Remove the tray stopper [A], while pushing the hook with a screw driver.
3. Open the original tray [B].
4. Original tray cover [C] ( x 3)



5. Original trailing edge sensor [D] ( x 1, hook)
6. Original length sensors [E] ( x 1 each, hook)

Original Set, Separation, Skew Correction and Scanning Entrance Sensor

1. Open the left cover.

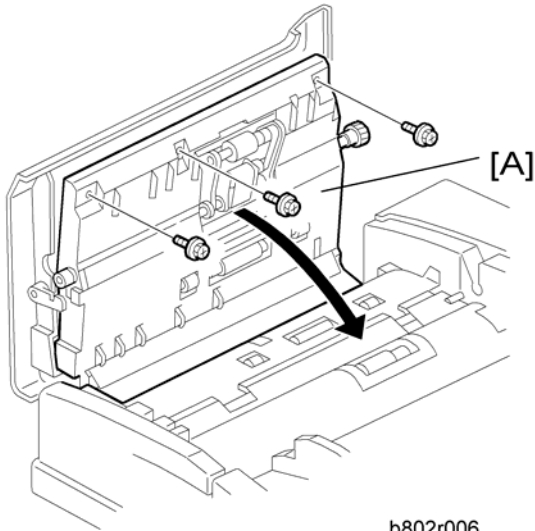

2. Open the inner upper cover [A] (stepped screw x 3).

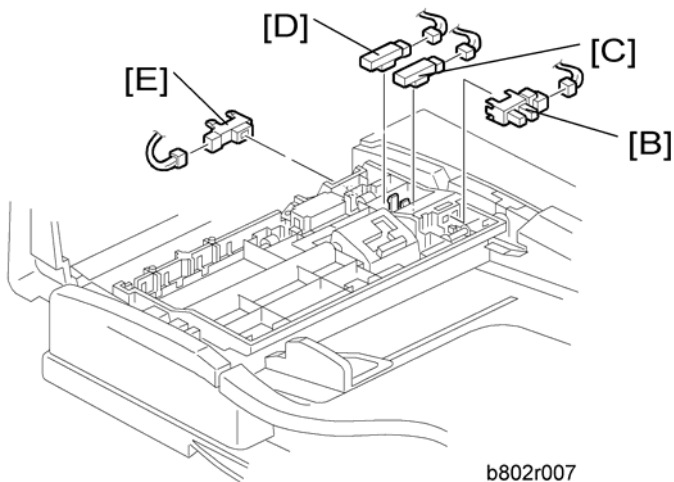

3. Original set sensor [B] (🔌 x 1, hook)
4. Separation sensor [C] (🔌 x 1, hook)
5. Skew correction sensor [D] (🔌 x 1, hook)
6. Scanning entrance sensor [E] (🔌 x 1, hook)

Original Width Sensors

1. Open the left cover.

2. Open the inner upper cover (Original Set, Separation, Skew Correction and Registration Sensor).

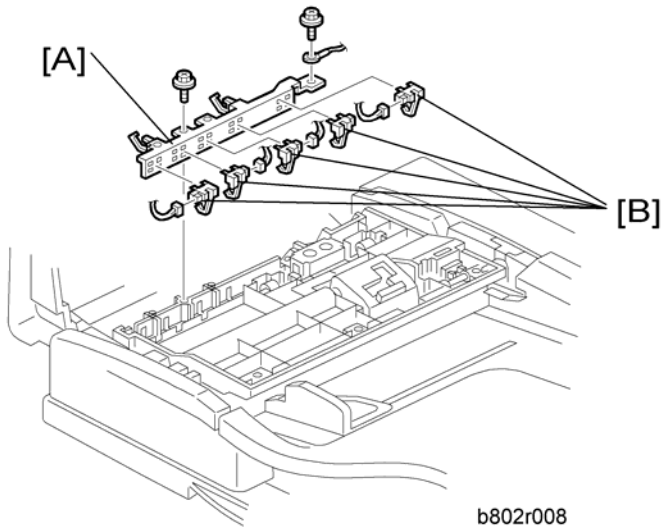

3. Original width sensor bracket [A] (Screw x 2, ground cable x 1).
4. Original width sensors [B] (Sensor x 1 each, hook)

Registration Sensor

1. Open the ARDF.

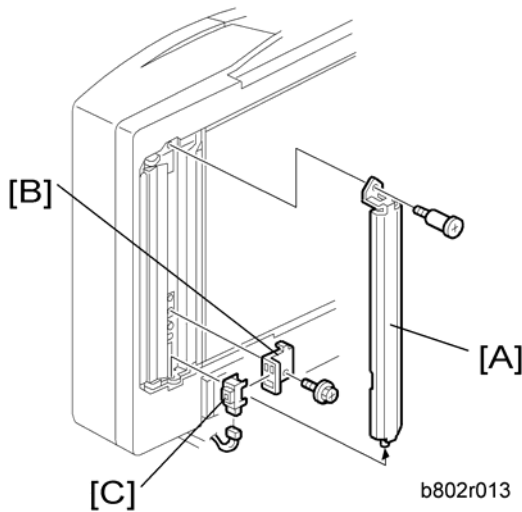

2. White plate [A] (stud screw x 1)
3. Registration sensor bracket [B] (Screw x 1)



4. Registration sensor [C] ( x 1)

Original Exit Sensor

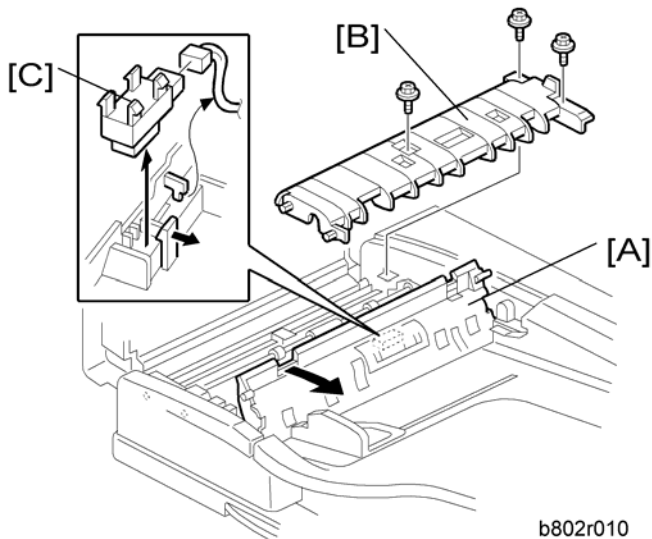

1

1. Open the left cover.



2. Open the feed-in guide plate [A].
 3. Guide plate [B] ( x 2, stepped screw x 1; front side)
 4. Original exit sensor [C] ( x 1, hook)

DF Position Sensor

1. Rear cover ( "Front and Rear Cover")
 2. ARDF drive board ( "ARDF Drive Board")

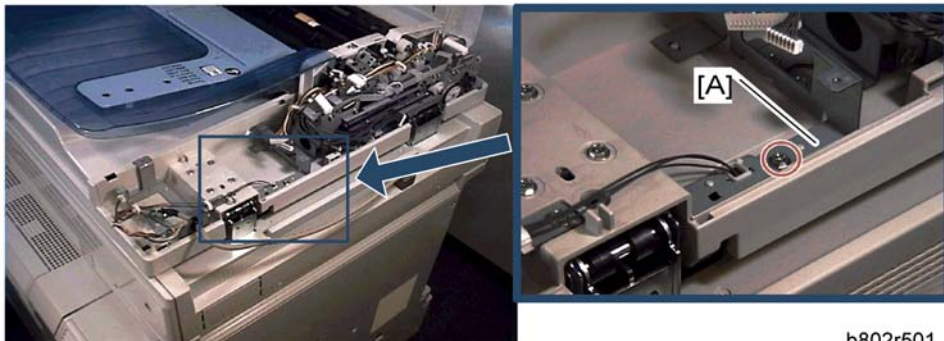

3. DF position sensor bracket [A] ( x 1)

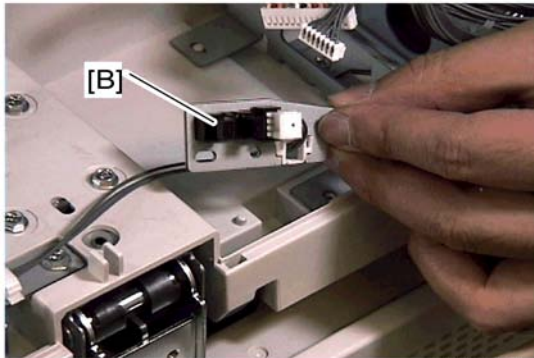

b802r502

4. DF position sensor [B] ( x 1, hook)

Cover Sensor

1. Open the left cover.
2. Rear cover ( "Front and Rear Cover")

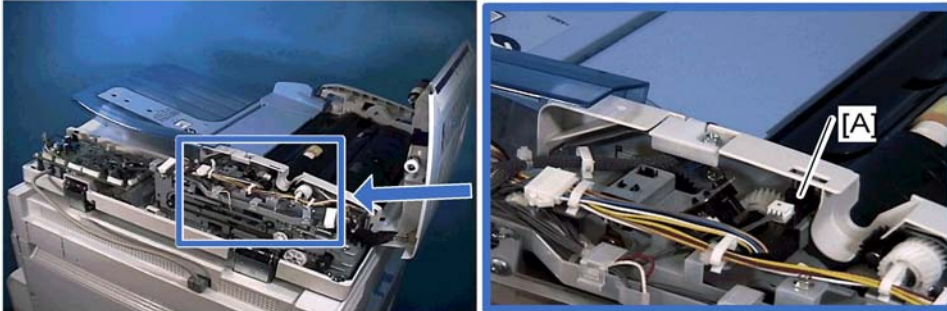

b802r503

3. Cover sensor [A] ( x 1, hook)

Pick-up Roller HP and Original Stopper HP Sensor

1. Open the left cover.
2. Rear cover ( "Front and Rear Cover")

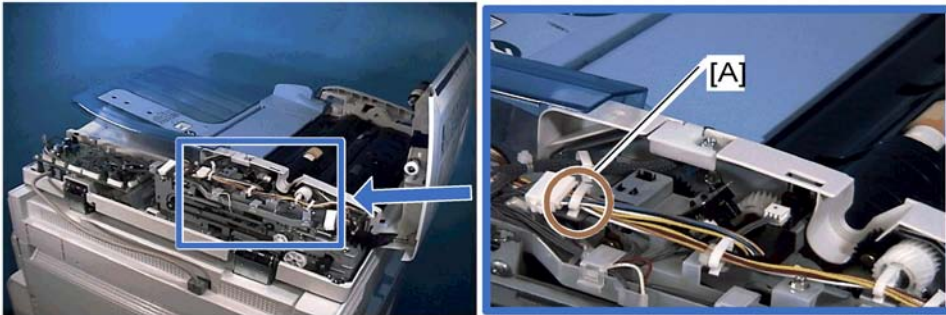

b802r504

3. Release the clamp [A] (🔧 x 1), and then slide the harnesses away.

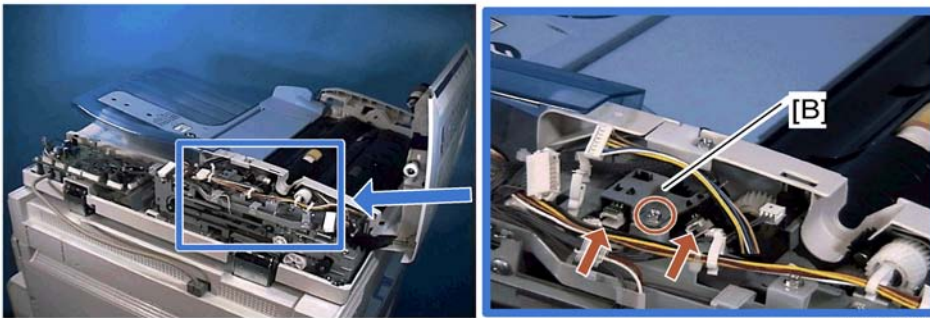

b802r505

4. Sensor bracket [B] (🔧 x 1, 📏 x 2)

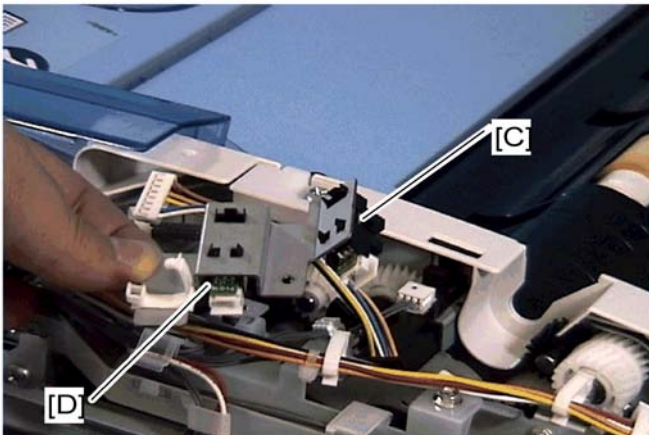



b802r506

5. Pick-up roller HP sensor [C] (hook)
6. Original stopper HP sensor [D] (hook)

Stamp Solenoid

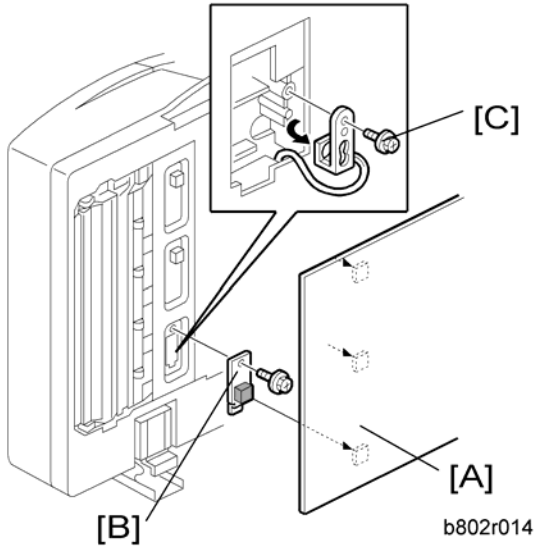
1. Open the left cover.



2. Remove the platen plate [A].
3. Stamp solenoid cover [B] ( x 1)
4. Remove the screw [C] ( x 1).

Note

- You cannot remove the stamp solenoid at this time.

5. Rear cover ( "Front and Rear Cover")

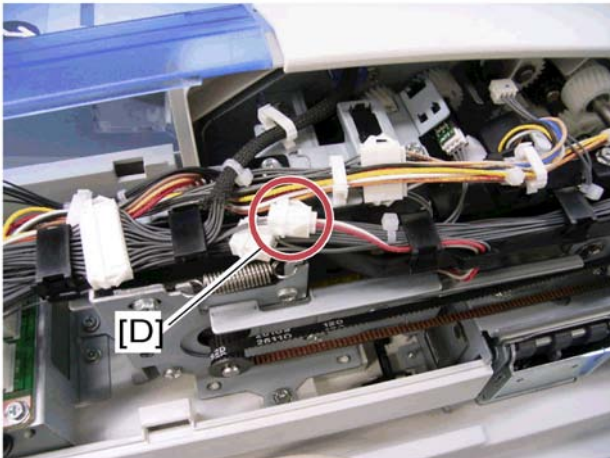

6. Disconnect the stamp solenoid harness [D].
7. ADF feed motor (ADF Feed Motor)

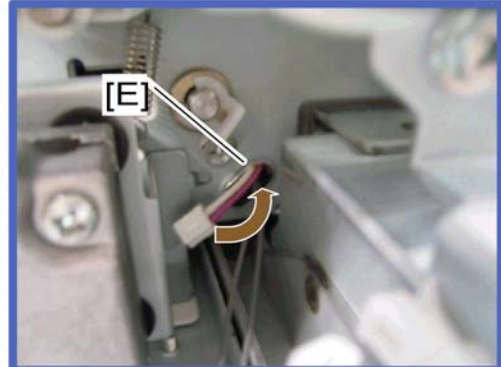
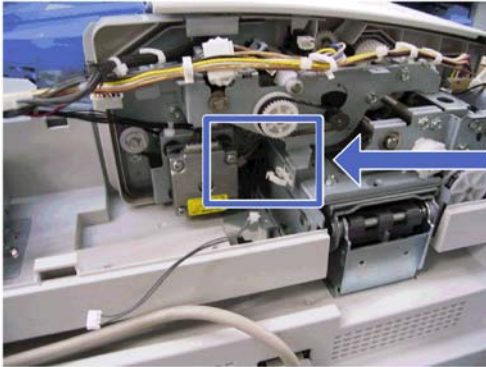

b802r508

8. Put the stamp solenoid harness into the cutout [E].

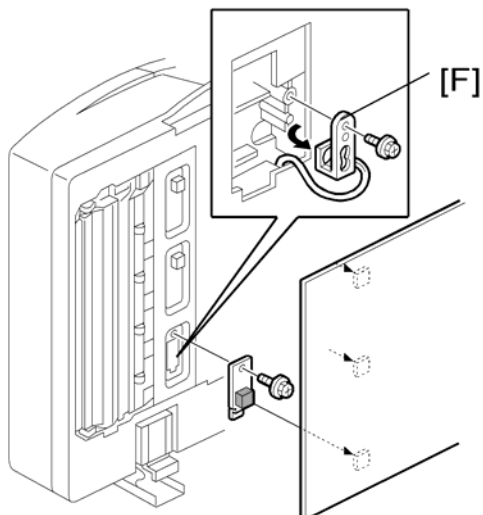

b802r014a

9. Pull out the stamp solenoid [F]

Original Feed Drive

1

ADF Feed Motor

1. Rear cover (🔧 "Front and Rear Cover")

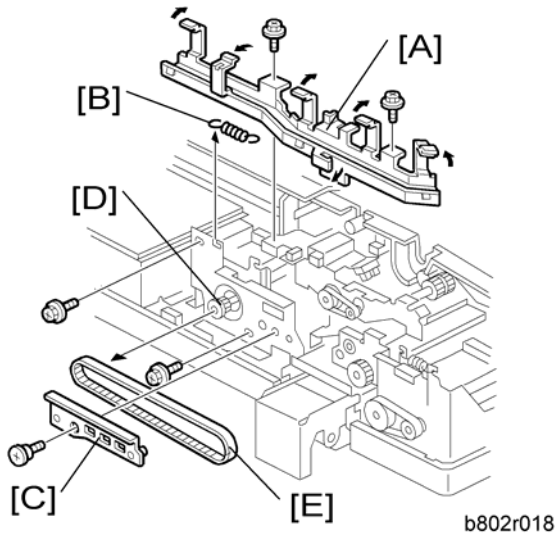

2. Harness guide [A] (🔧 x 2, all 🛠️s, all 📦s)
3. Remove the spring [B].
4. Stay bracket [C] (stepped screw x 1)
5. Slide the feed motor gear [D] to the left side (seen from the front of the machine), and then remove the timing belt [E].

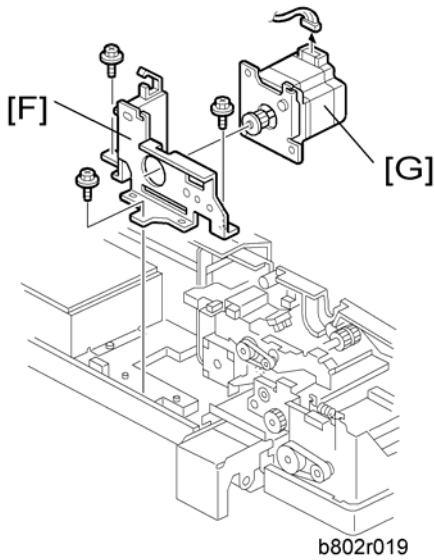

6. ADF feed motor bracket [F] ( x 3)

7. ADF feed motor [G] ( x 1)

ADF Inverter Motor

1. ADF feed motor ( "ADF Feed Motor")

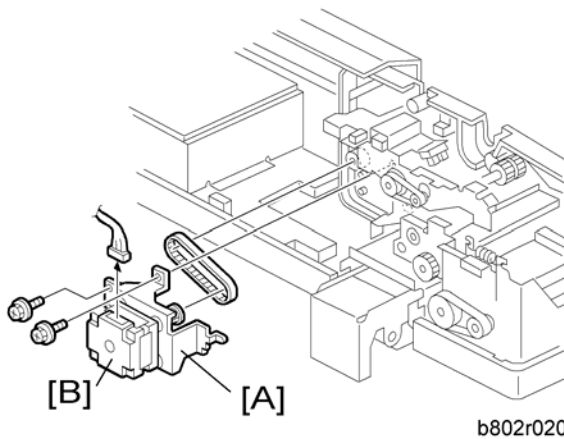

2. ADF inverter motor bracket [A] ( x 2,  x 1, timing belt)

3. ADF inverter motor [B] ( x 4)

ADF Transport Motor

1. Rear cover (📖 "Front and Rear Cover")

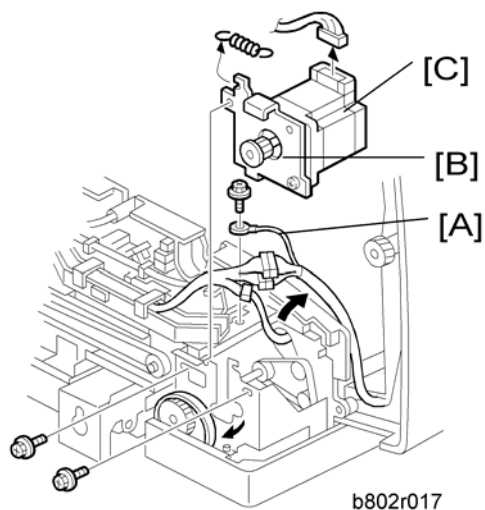





2. Ground cable [A] (🔩 x 1)
3. ADF transport motor bracket [B] (🔩 x 2, 📦 x 1)
4. ADF transport motor [C] (🔩 x 2)

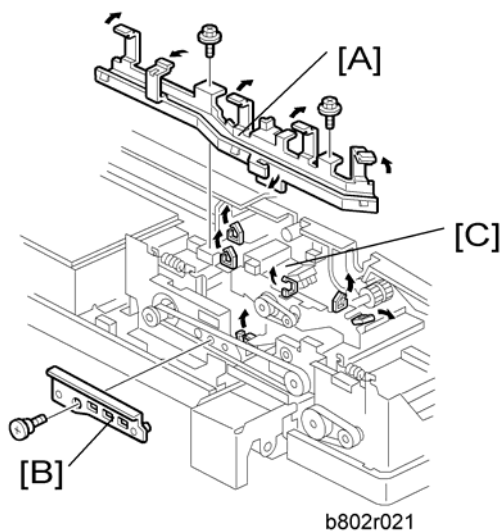



ADF Pick-up Motor

1. Rear cover (📖 "Front and Rear Cover")

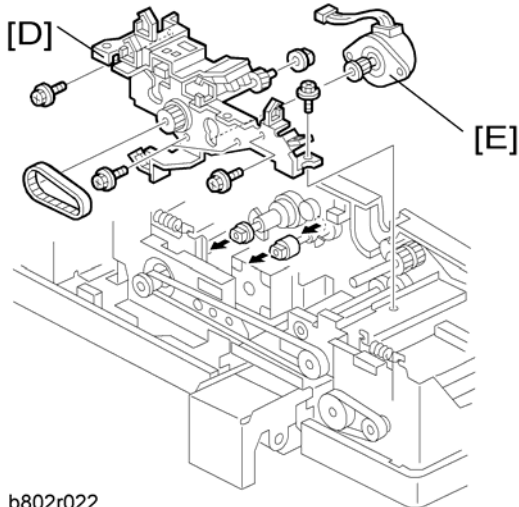

2. Harness guide [A] ( x 2, all s, all s)
3. Stay bracket [B] (stepped screw x 1)
4. Release 6 clamps on the ADF pick-up motor bracket [C] ( x 6).



5. ADF pick-up motor bracket [D] ( x 3,  x 1)
6. ADF pick-up motor [E] ( x 2,  x 1, timing belt)

