

**Reissued: 31-Mar-09**

Model: Model AT-C1 ARDF (DF3000)	Date: 28-Jun-06	No.: RB789001a
----------------------------------	-----------------	----------------

**RTB Reissue**

The items in bold italics have been corrected.

Subject: Firmware Release History (ARDF)		Prepared by: M. Kumagai	
From: 2nd Tech Support Sec. Service Support Dept.			
Classification:	<input type="checkbox"/> Troubleshooting	<input type="checkbox"/> Part information	<input type="checkbox"/> Action required
	<input type="checkbox"/> Mechanical	<input type="checkbox"/> Electrical	<input type="checkbox"/> Service manual revision
	<input type="checkbox"/> Paper path	<input type="checkbox"/> Transmit/receive	<input type="checkbox"/> Retrofit information
	<input type="checkbox"/> Product Safety	<input type="checkbox"/> Other (      )	

Version	Program No.	Effective Date
<b>2.33.06</b>	<b><i>B7895603</i></b>	<b><i>October 2006 production</i></b>
2.32.06	B7895602	1st mass production

Version	Symptom Corrected
<b>2.33.06</b>	<b><i>Symptom corrected: The machine stalls if it mis-detects the size of the original during a job set for "Original Feed Type/Stamp" and "Mixed Sizes".</i></b>
2.32.06	1st mass production

**Reissued: 31-Mar-09**

Model: Model AT-C1 ARDF (DF3000)	Date: 28-Jun-06	No.: RB789001b
----------------------------------	-----------------	----------------

**RTB Reissue**

The items in bold italics have been corrected.

Subject: Firmware Release History (ARDF)		Prepared by: M. Kumagai	
From: 2nd Tech Support Sec. Service Support Dept.			
Classification:	<input type="checkbox"/> Troubleshooting	<input type="checkbox"/> Part information	<input type="checkbox"/> Action required
	<input type="checkbox"/> Mechanical	<input type="checkbox"/> Electrical	<input type="checkbox"/> Service manual revision
	<input type="checkbox"/> Paper path	<input type="checkbox"/> Transmit/receive	<input type="checkbox"/> Retrofit information
	<input type="checkbox"/> Product Safety	<input type="checkbox"/> Other (      )	

Version	Program No.	Effective Date
<b>2.34.06</b>	<b>B7895604</b>	<b>November 2006 production</b>
2.33.06	B7895603	October 2006 production
2.32.06	B7895602	1st mass production

Version	Symptom Corrected
<b>2.34.06</b>	<b><i>Symptom corrected: SP6016-1 (Original size detection priority) does not work correctly.</i></b>
2.33.06	Symptom corrected: The machine stalls if it mis-detects the size of the original during a job set for "Original Feed Type/Stamp" and "Mixed Sizes".
2.32.06	1st mass production

**Reissued: 31-Mar-09**

Model: Model AT-C1 ARDF (DF3000)	Date: 28-Jun-06	No.: RB789001c
----------------------------------	-----------------	----------------

**RTB Reissue**

The items in bold italics have been corrected.

Subject: Firmware Release History (ARDF)		Prepared by: M. Kumagai	
From: 2nd Tech Support Sec. Service Support Dept.			
Classification:	<input type="checkbox"/> Troubleshooting	<input type="checkbox"/> Part information	<input type="checkbox"/> Action required
	<input type="checkbox"/> Mechanical	<input type="checkbox"/> Electrical	<input type="checkbox"/> Service manual revision
	<input type="checkbox"/> Paper path	<input type="checkbox"/> Transmit/receive	<input type="checkbox"/> Retrofit information
	<input type="checkbox"/> Product Safety	<input type="checkbox"/> Other (      )	

Version	Program No.	Effective Date
<b>2.35:06</b>	<b>B7895605</b>	<b><i>December 2007 production</i></b>
2.34.06	B7895604	November 2006 production
2.33.06	B7895603	October 2006 production
2.32.06	B7895602	1st mass production

Version	Symptom Corrected
<b>2.35:06</b>	<b><i>Symptom corrected: The tail end of the image is cut off if the original is scanned in duplex mode or using Original Feed Type/Stamp.</i></b>
2.34.06	Symptom corrected: SP6016-1 (Original size detection priority) does not work correctly.
2.33.06	Symptom corrected: The machine stalls if it mis-detects the size of the original during a job set for "Original Feed Type/Stamp" and "Mixed Sizes".
2.32.06	1st mass production

Model: DF3000		Date: 15-Sep-09	No.: RB789002
Subject: Parts Information		Prepared by: M. Kumagai	
From: 2nd Tech Support Sec. Service Support Dept.			
Classification:	<input type="checkbox"/> Troubleshooting <input checked="" type="checkbox"/> Part information <input type="checkbox"/> Action required <input type="checkbox"/> Mechanical <input type="checkbox"/> Electrical <input type="checkbox"/> Service manual revision <input type="checkbox"/> Paper path <input type="checkbox"/> Transmit/receive <input type="checkbox"/> Retrofit information <input type="checkbox"/> Product Safety <input type="checkbox"/> Other (      ) <input type="checkbox"/> Tier 2		

Old part number	New part number	Description	Q'ty	Int	Page	Index	Note
B7894215	D3664215	SHAFT:MAGNETIC CLUTCH:ASS'Y	1	X/O As a set	13	16	
AA082104	53041639	BUSHING - 8MM	1		13	15	
	08050088	RETAINING RING - M6	1		13	108	

**Change:** The shape of the magnetic clutch was changed and a retaining ring was added.  
**Reason:** To further improve original transport by minimizing original transport jams.

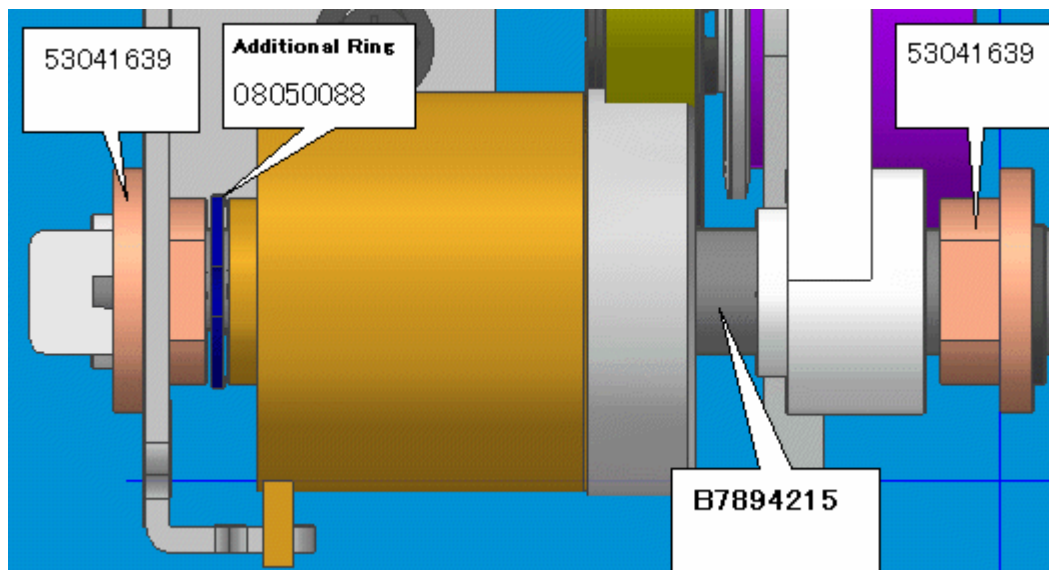

Model: Model AT-C1 ARDF (DF3000)		Date: 30-Jun-10	No.: RB789003
Subject: Parts catalog correction		Prepared by: M. Kumagai	
From: 1st Overseas Tech Support Sec., 1st PQM Dept.			
Classification:	<input type="checkbox"/> Troubleshooting	<input checked="" type="checkbox"/> Part information	<input type="checkbox"/> Action required
	<input type="checkbox"/> Mechanical	<input type="checkbox"/> Electrical	<input type="checkbox"/> Service manual revision
	<input type="checkbox"/> Paper path	<input type="checkbox"/> Transmit/receive	<input type="checkbox"/> Retrofit information
	<input type="checkbox"/> Product Safety	<input type="checkbox"/> Other (      )	<input type="checkbox"/> Tier 2

**Change/Reason:** The following index number on **MB# MB789004** was incorrect.

Old parts number	New parts number	Description	Q'ty	Int	Page	Incorrect Index	<b><i>Correct Index</i></b>
B7893422	B7893432	EXIT GUIDE PLATE	1		9	<del>12</del>	<b><i>11</i></b>

Model: Model AT-C1 ARDF (DF3000)		Date: 30-Jun-10	No.: RB789004
Subject: Parts catalog correction		Prepared by: M. Kumagai	
From: 1st Overseas Tech Support Sec., 1st PQM Dept.			
Classification:	<input type="checkbox"/> Troubleshooting <input type="checkbox"/> Mechanical <input type="checkbox"/> Paper path <input type="checkbox"/> Product Safety	<input checked="" type="checkbox"/> Part information <input type="checkbox"/> Electrical <input type="checkbox"/> Transmit/receive <input type="checkbox"/> Other (     )	<input type="checkbox"/> Action required <input type="checkbox"/> Service manual revision <input type="checkbox"/> Retrofit information <input type="checkbox"/> Tier 2

**Change/Reason:** The following parts number on **MB# MB789007** was incorrect.

Incorrect parts number	<b><i>Correct parts number</i></b>	Description	Q'ty	Int	Page	Index
B7893432	<b><i>B7894651</i></b>	SIDE FENCE	1		3	1

**Reissued: 05-Nov-10**

Model: Model ARDF (DF3000)	Date: 28-Jun-06	No.: RB789001d
----------------------------	-----------------	----------------

**RTB Reissue**

The items in bold italics have been corrected.

Subject: Firmware Release History (ARDF)		Prepared by: M. Kumagai	
From: 2nd Tech Support Sec. Service Support Dept.			
Classification:	<input type="checkbox"/> Troubleshooting	<input type="checkbox"/> Part information	<input type="checkbox"/> Action required
	<input type="checkbox"/> Mechanical	<input type="checkbox"/> Electrical	<input type="checkbox"/> Service manual revision
	<input type="checkbox"/> Paper path	<input type="checkbox"/> Transmit/receive	<input type="checkbox"/> Retrofit information
	<input type="checkbox"/> Product Safety	<input type="checkbox"/> Other (      )	

Version	Program No.	Effective Date
<b><i>02.360:07</i></b>	<b><i>B7895606</i></b>	<b><i>November 2010 production</i></b>
2.35:06	B7895605	December 2007 production
2.34.06	B7895604	November 2006 production
2.33.06	B7895603	October 2006 production
2.32.06	B7895602	1st mass production

Version	Symptom Corrected
<b><i>02.360:07</i></b>	<b><i>Other change: Minor bug correction</i></b>
2.35:06	Symptom corrected: The tail end of the image is cut off if the original is scanned in duplex mode or using Original Feed Type/Stamp.
2.34.06	Symptom corrected: SP6016-1 (Original size detection priority) does not work correctly.
2.33.06	Symptom corrected: The machine stalls if it mis-detects the size of the original during a job set for "Original Feed Type/Stamp" and "Mixed Sizes".
2.32.06	1st mass production

Model: Model AT-C1 ARDF (DF3000)		Date: 24-Dec-10	No.: RB789005
Subject: Cover		Prepared by: M. Kumagai	
From: 1st Overseas Tech Support Sec., 1st PQM Dept.			
Classification:	<input type="checkbox"/> Troubleshooting <input type="checkbox"/> Mechanical <input type="checkbox"/> Paper path <input type="checkbox"/> Product Safety	<input checked="" type="checkbox"/> Part information <input type="checkbox"/> Electrical <input type="checkbox"/> Transmit/receive <input type="checkbox"/> Other (     )	<input type="checkbox"/> Action required <input type="checkbox"/> Service manual revision <input type="checkbox"/> Retrofit information <input type="checkbox"/> Tier 2

Old part number	New part number	Description	Q'ty	Int	Page	Index	Note
	D3661947	COVER:BASE	0-1		3	24	
	04503008N	TAPPING SCREW - M3X8	0-3		3	102	

**Change:** The parts in the table were added.

**Reason:** To cover the ribs on the base.

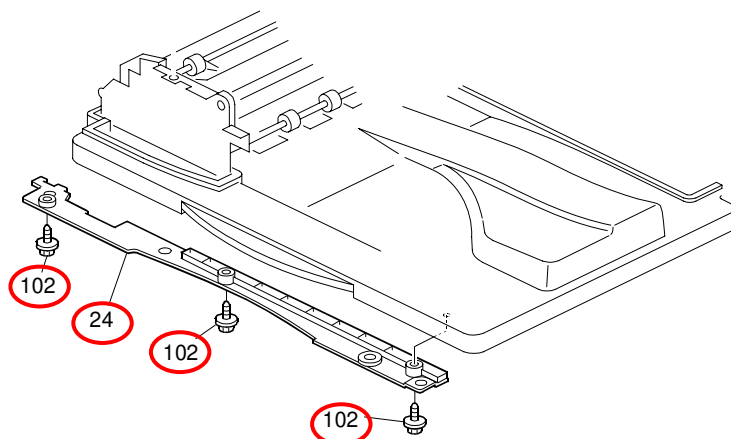



Model: AT-C1 ARDF (DF3000)		Date: 14-Apr-11	No.: RB789006
Subject: Parts catalog correction		Prepared by: M. Kumagai	
From: 1st Overseas Tech Support Sec., 1st PQM Dept.			
Classification:	<input type="checkbox"/> Troubleshooting <input type="checkbox"/> Mechanical <input type="checkbox"/> Paper path <input type="checkbox"/> Product Safety	<input checked="" type="checkbox"/> Part information <input type="checkbox"/> Electrical <input type="checkbox"/> Transmit/receive <input type="checkbox"/> Other (     )	<input type="checkbox"/> Action required <input type="checkbox"/> Service manual revision <input type="checkbox"/> Retrofit information <input type="checkbox"/> Tier 2

**Change/Reason:** The following part in the parts catalog was incorrect.

New part number	Description	Q'ty	Int	Page	Index	Note
B3514322	TAPE - PLATEN SHEET	3		15	28*	

**\*New Index**

7.Frame Section (D366)

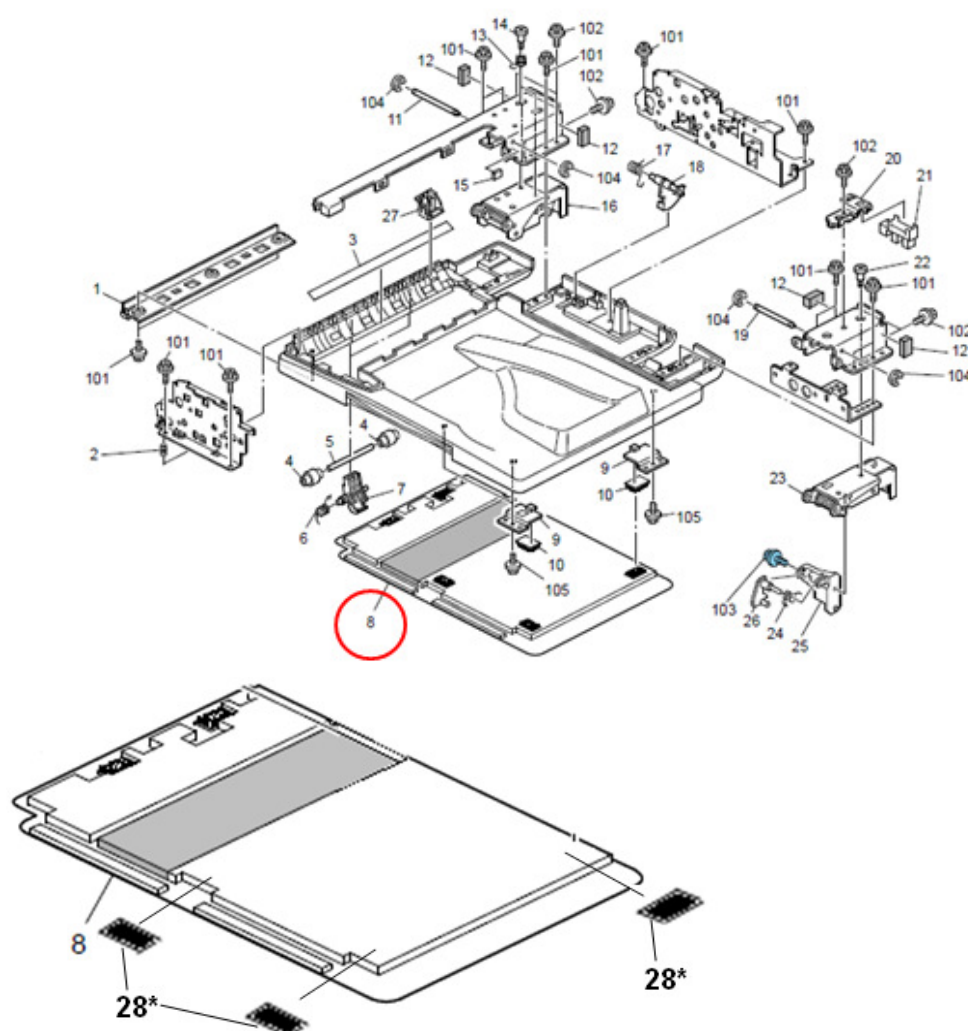

**Note:** Index 8 (PRESSURE PLATE ASS'Y) does not include index 28\* (TAPE - PLATEN SHEET).