

**Paper Cassette CT6510  
Machine Code: D3A3  
SERVICE MANUAL**

January, 2015







# Safety, Conventions, Trademarks

## Conventions

### Common Terms

This is a list of symbols and abbreviations used in this manual.

Symbol	What it means
	Screw
	Connector
	E-ring
	Clip ring
	Harness clamp
FFC	Flexible Film Cable
JG	Junction Gate
LE	Leading Edge of paper
LEF	Long Edge Feed
SEF	Short Edge Feed
TE	Trailing Edge of paper

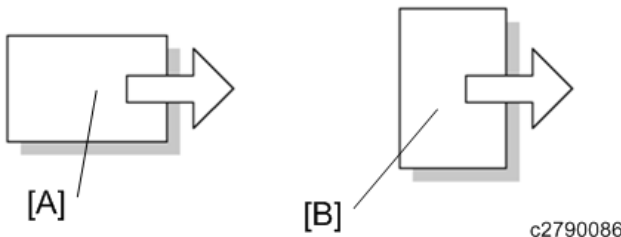

[A] Short Edge Feed (SEF)

[B] Long Edge Feed (LEF)

---

## Warnings, Cautions, Notes

---

In this manual, the following important symbols and notations are used.

In this manual, the following important symbols and notations are used.

### **WARNING**

- A Warning indicates a potentially hazardous situation. Failure to obey a Warning could result in death or serious injury.

### **CAUTION**

- A Caution indicates a potentially hazardous situation. Failure to obey a Caution could result in minor or moderate injury or damage to the machine or other property.

### **Important**

- Obey these guidelines to avoid problems such as misfeeds, damage to originals, loss of valuable data and to prevent damage to the machine.

### **Note**

- This information provides tips and advice about how to best service the machine.

---

## Responsibilities of the Customer Engineer

---

### Reference Material for Maintenance

---

- Maintenance shall be done using the special tools and procedures prescribed for maintenance of the machine described in the reference materials (service manuals, technical bulletins, operating instructions, and safety guidelines for customer engineers).
- Use only consumable supplies and replacement parts designed for use of the machine.

# TABLE OF CONTENTS

Safety, Conventions, Trademarks.....	1
Conventions.....	1
Common Terms.....	1
Warnings, Cautions, Notes.....	2
Responsibilities of the Customer Engineer.....	2
Reference Material for Maintenance.....	2

## 1. Replacement and Adjustment

Common Procedures.....	5
Cassette Unit.....	5
Paper Feed Unit.....	8
Motors.....	9
Cassette Feed Motor.....	9
Tray Lift Motors.....	9
Clutches.....	11
Paper Transport Clutch.....	11
Paper Feed Clutch.....	11
Sensors.....	13
Paper End Sensor, Feed Sensor.....	13
Vertical Feed Sensor, Tray Lift Sensor.....	13
Paper Size Sensors.....	15
Rollers.....	19
Pickup, Feed, Reverse Rollers.....	19
Board.....	20
Cassette Control Board.....	20

---

# 1. Replacement and Adjustment

## Common Procedures

1

### Cassette Unit

1. Left front cover [A] (⌀ x5)
2. Right front cover [B] (⌀ x5)

Do not remove any other covers shown in this illustration.

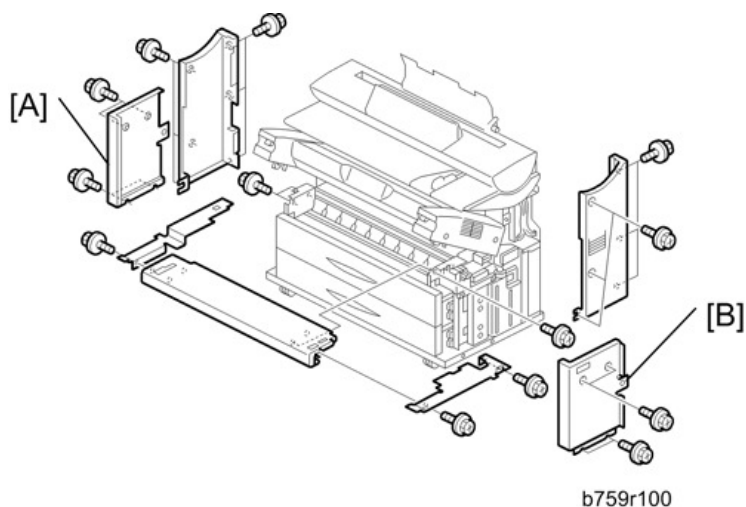

3. Cassettes. Pull out partially [A].
4. Left cover plate [B] (⌀ x2)
5. Right cover plate [C] (⌀ x2)

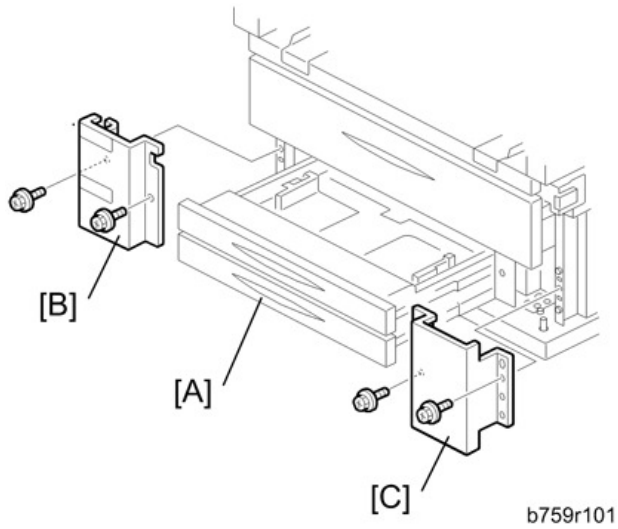

6. Push the cassettes into the machine.

7. Left lock pin [A] (⌚ x2)

8. Right lock pin [B] (⌚ x2)

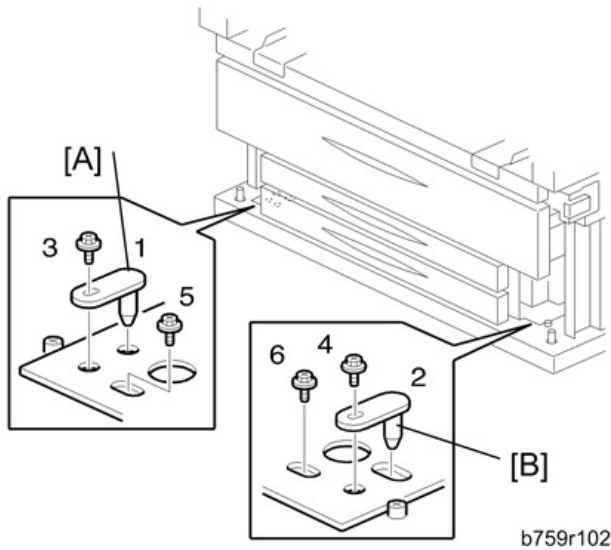

**Note**

- Ignore the numbers in the diagram. You can remove the screws in any order.

**Reinstallation**

1. Reattach the lock pins in the order indicated by the numbers in the diagram.
2. Left cover panel [A] (⌚ x1)



3. Right cover panel [B] (⚙️ x1)
4. Disengage the tabs as shown to remove the left and right cover panels [C].

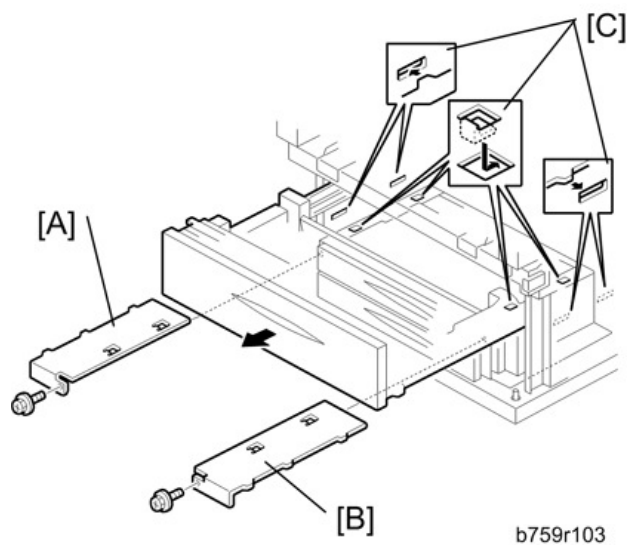

5. Left connector [A] (⚙️ x1)

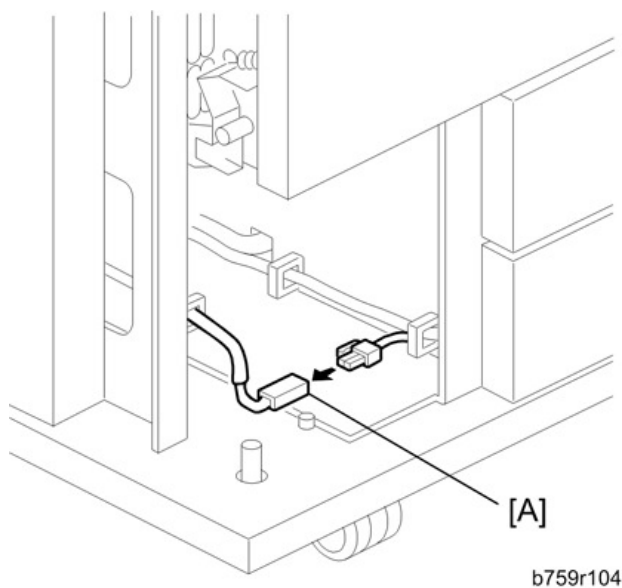

6. Pull the cassette unit [A] partially out of the machine until you can see the cassette tray control board.

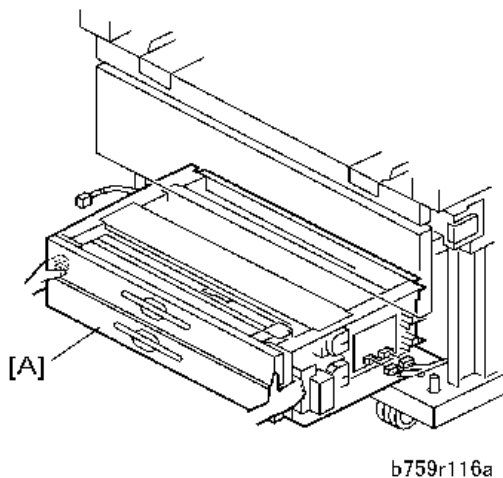

**Note**

- It is not necessary to remove the cassette unit from the machine.

## Paper Feed Unit

- Pull out the cassette.
- Cassette drawer cover [A] (🔩 x2)
  - Paper feed unit [B] (🔩 x7, 📦 x2)

Before you lift the paper feed unit, make sure the release tab ① is out in the direction of the arrow.

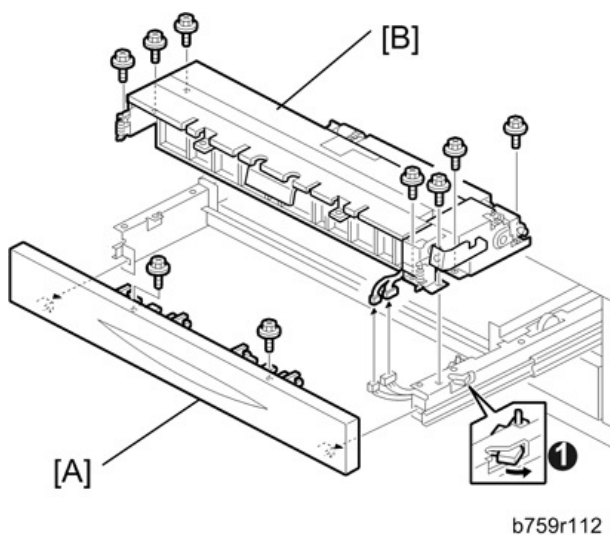

# Motors

## Cassette Feed Motor

1

- Remove the covers, panels, and lock pins, and pull the cassette unit partially out of the machine.

- Motor cover [A] (⌚ x2)
- Cassette feed motor [B] (⌚ x2, ⌚ x1, 🔩 x2)

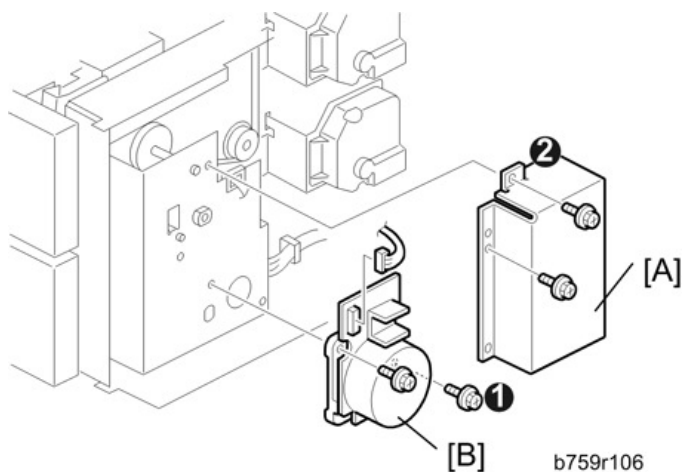

### Reinstallation

- Use long screws ① (M3x10) to reattach the motor bracket.
- When you reinstall the cover, attach the top screw ② first.

## Tray Lift Motors

- Remove the covers, panels, and lock pins
- Pull the cassette unit partially out of the machine.

- Upper tray lift motor [A] (⌚ x2, ⌚ x1)
- Lower tray lift motor [B] (⌚ x2, ⌚ x1)

1

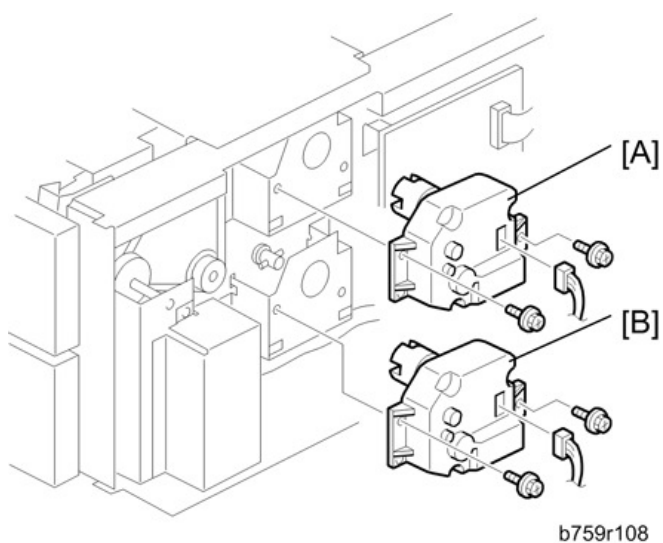

# Clutches

## Paper Transport Clutch

1

- Remove the covers, panels, and lock pins
- Pull the cassette unit partially out of the machine.

1. Clutch connector [A] (🔩x3, 📦 x1)
2. Paper feed clutch cover [B] (🔩x4)
3. Paper feed clutch bracket [C] (🔩x3)
4. Paper feed clutch [D] (📦 x2)

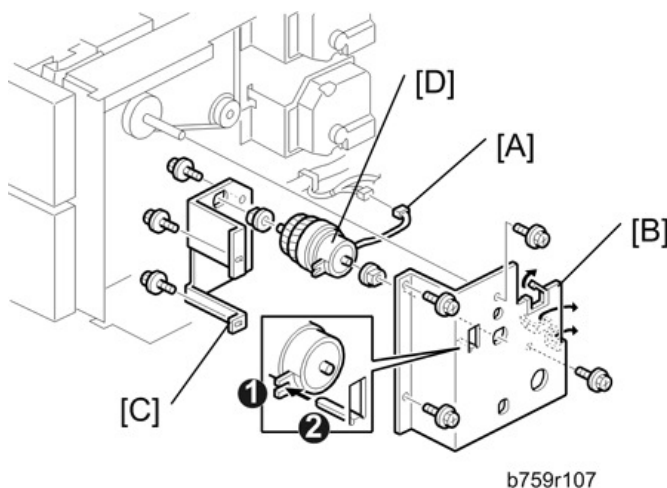

### Reinstallation

- Make sure that the notch ① is correctly engaged with the arm ②.

## Paper Feed Clutch

- Remove the paper feed unit
1. Release lever [A] (🔩x1, 📦 x1)
  2. Clutch cover [B] (🔩x1, 📦 x5)
  3. Paper feed clutch and support bracket [C] (🔩x3, 📦 x1)

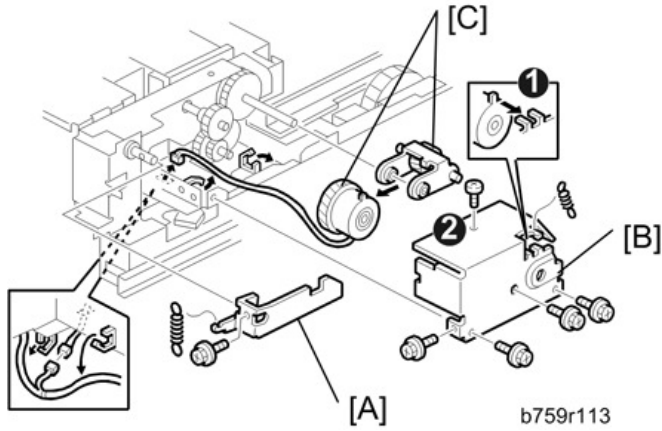

### Reinstallation

- The clutch tab must be vertical as shown to engage the notch of the cover ①.
- Reattach the flat-head screw on top of the cover ②.

# Sensors

## Paper End Sensor, Feed Sensor

1

- Pull out the cassette.
1. Cover [A] (⌚ x2)
  2. Paper near end sensor [B] (⌚ x1)
  3. Paper end sensor [C] (⌚ x1)

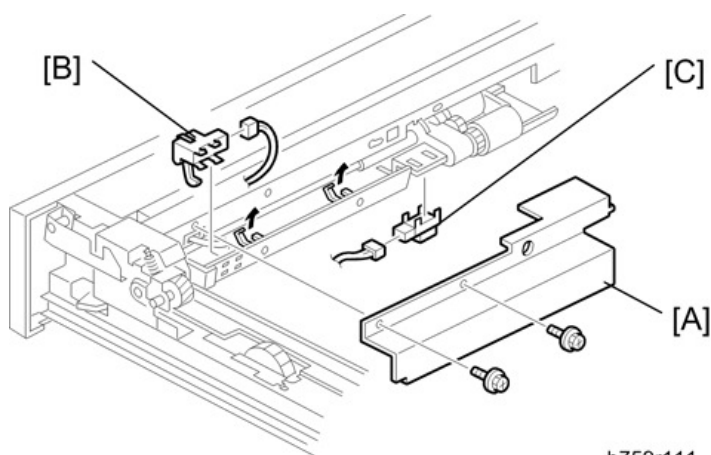

b759r111

## Vertical Feed Sensor, Tray Lift Sensor

- Remove the paper feed unit.
1. Release lever [A] (⌚ x1, ⌚ x1)
  2. Clutch cover [B] (⌚ x1, ⌚ x5)
  3. Paper feed clutch and support bracket [C] (⌚ x1, ⌚ x3)
  4. Gears [D]
  5. Gear mount [E] (⌚ x1)

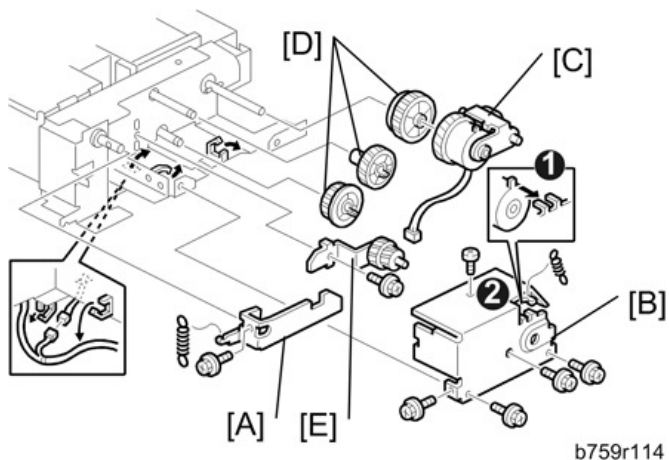

### Reinstallation

- The clutch tab must be vertical as shown to engage the notch of the cover ①.
- Reattach the flat-head screw on top of the cover ②.

1. Right bracket [A] (⚙️ x3, 📏 x1)
2. Cassette release lever [B] (🌀 x1, ⚙️ x1, 📏 x1)
3. Left bracket [C]
4. Bottom plate lift arm [D]
5. Vertical feed assembly [E]

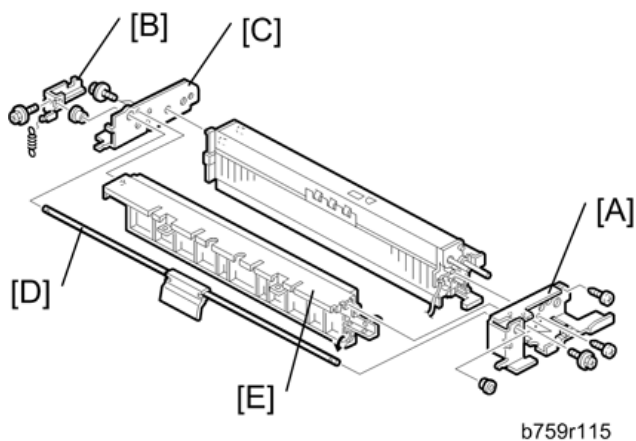

6. Bracket [A] (⚙️ x2, 🌀 x1)
7. Bracket [B] (⚙️ x1)
8. Feed roller [C] assembly
  - ① Right side (🌀 x1, 📏 x1, ⚙️ x2)



- ② Left side (⚙️ x2)
- ③ Top (⚙️ x1)
- ④ Below (⚙️ x1, ⚙️ x1)
- 9. Tray lift sensor [D] (⚙️ x1)
- 10. Paper feed sensor [E] (⚙️ x1)

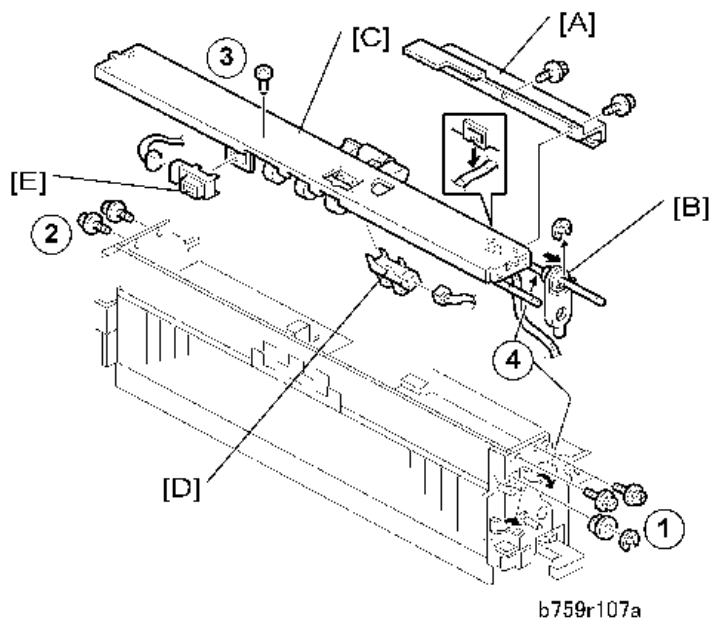



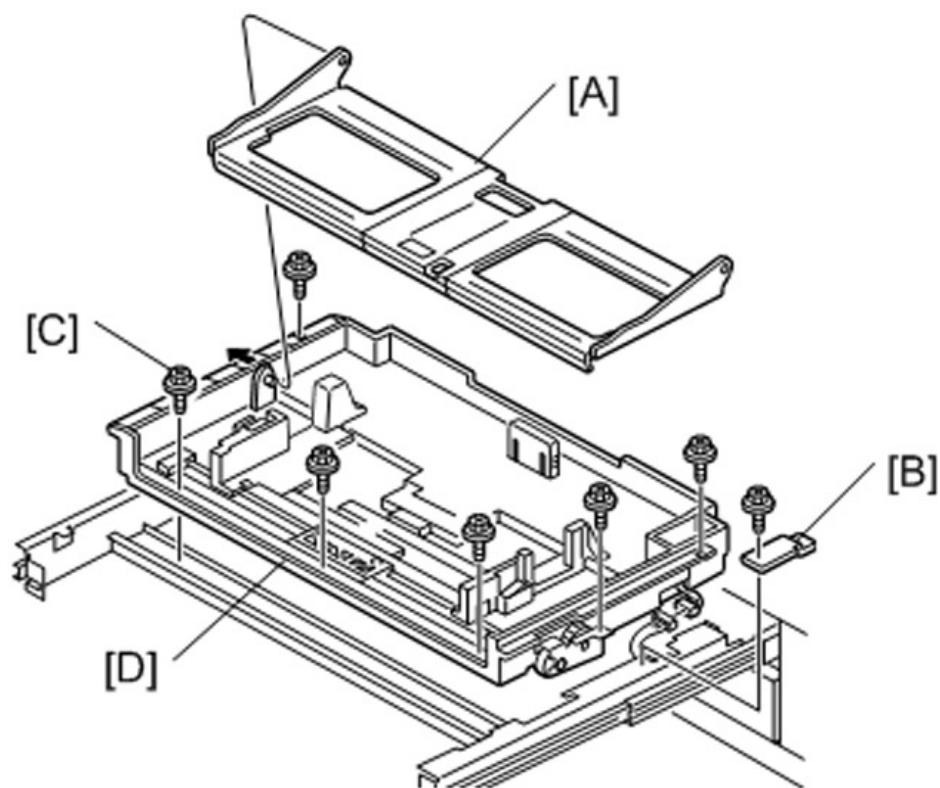

## Paper Size Sensors

1. Lift and remove bottom plate [A].
2. Connector plate [B] (⚙️ x1)
3. Cassette plate screws [C] (⚙️ x6)
4. Remove the cassette plate [D] (⚙️ x1)



b759r117

5. Switch cover [A] (▼ x2,  x1)
6. Paper size sensor 1 [B] (width) (▼ x2)
7. Turn over the cassette plate [C]
8. Sensor cover [D] ( x2)
9. Paper size sensor 2 [E] ( x1)
10. Paper size sensor 3 [F] ( x1)

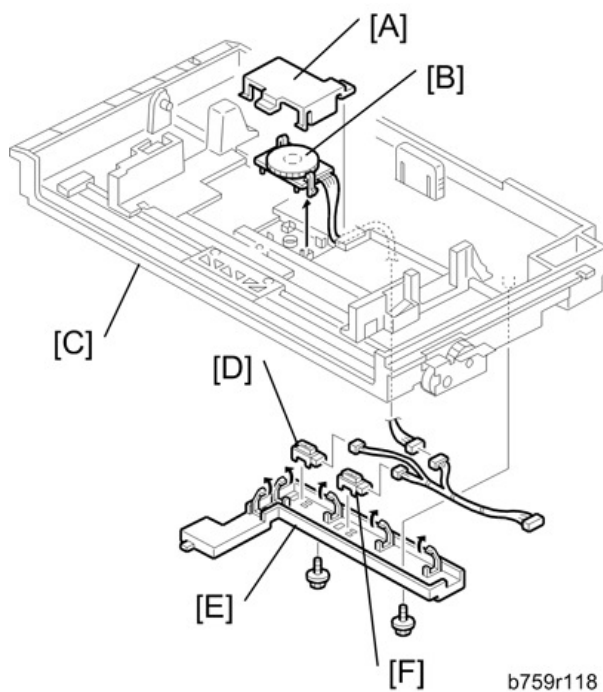

### Reinstallation

When you reattach paper size sensor 1 (width):

1. Set the side fences to A4 or LT.
2. Align the dot on the rotary wheel with the small dot on the rack for EU/ASIA (A4)

-or-

Align the dot on the rotary wheel with the large dot on the rack for NA: LT.

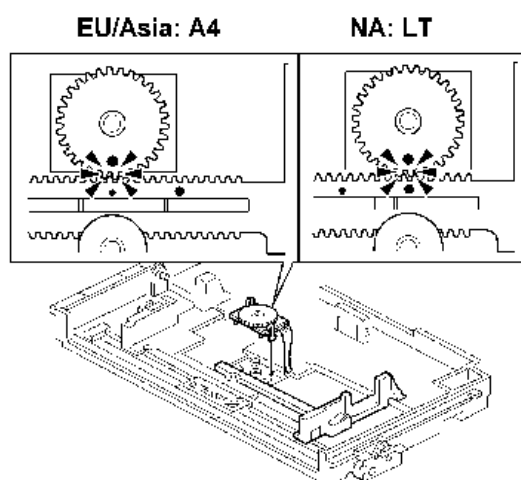

b795r109a

# Rollers

## Pickup, Feed, Reverse Rollers

1

- Pull out the cassette.
1. Upper paper guide [A] (⌀x1)
  2. Pickup roller [B]
  3. Lower paper guide [C] (⌀x1)
  4. Feed roller [D]
  5. Reverse roller [E], torque limiter (⌀x1)

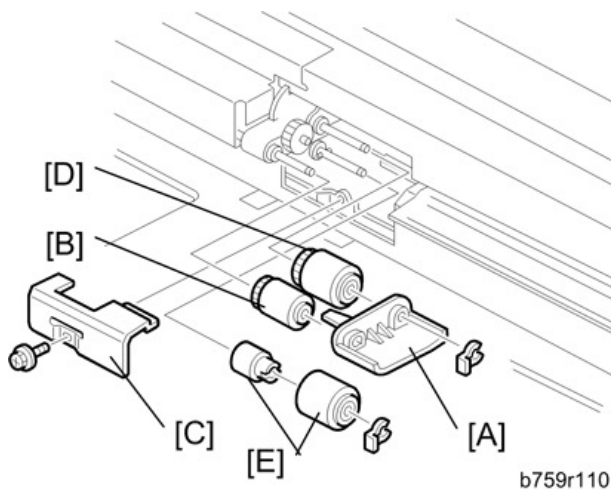

# Board

1

## Cassette Control Board

- Remove the covers, panels, and lock pins
- Pull the cassette unit partially out of the machine.

1. Cassette tray control board [A] (⚙️ x6, ⚙️ x4)

