

Model: V-C1 Mail Box CS391 (Ontario-B)	Date:15-May-09	No.: RB762001
--	----------------	---------------

Subject: Software Bug		Prepared by: T.Toriumi	
From: 2nd Tech. Support Sec. Service Support Dept.			
Classification:	<input type="checkbox"/> Troubleshooting <input type="checkbox"/> Mechanical <input type="checkbox"/> Paper path <input type="checkbox"/> Other ()	<input checked="" type="checkbox"/> Part information <input type="checkbox"/> Electrical <input type="checkbox"/> Transmit/receive	<input type="checkbox"/> Action required <input type="checkbox"/> Service manual revision <input type="checkbox"/> Retrofit information

3. Paper Exit 2 (B762)

Old part number	New part number	Description	Q'ty	Int	Page	Index	Note
B7625150	B7625152	PCB:MAIN CONTROL	1-1	X/O	7	17	-
B7625105	B7625109	EPROM:MAIN CONTROL	1-1	X/O	7	18	-

Change: The firmware for these parts was modified.

Reason:

- To support use with the D062/D063/D064/D065 copiers.
- To fix the following symptoms:
 - SC990 occurs if the cover of the Mail Box CS391 is opened while paper passes through the CS391.
 - A paper jam occurs while sheets of A5T paper are exited to the 9-Bin tray of the Mail Box CS391.

Model: V-C1 Mail Box CS391 (Ontario-B)

Date:14-Dec-10

No.: RB762002

Subject: Parts Registration(GUIDE PLATE:COUPLING:ASS'Y)

Prepared by: Takeshi Toriumi

From: 1st Overseas Tech Support Sec., 1st PQM Dept.

Classification:

☐ Troubleshooting

☒ Part information

☐ Action required

☐ Mechanical

☐ Electrical

☐ Service manual revision

☐ Paper path

☐ Transmit/receive

☐ Retrofit information

☐ Other ()

Change: The individual parts circled in red below were registered as a single service part (assembly).

Reason: To meet requests received from the field.

1. Exterior (B762)

Old part number	New part number	Description	Q'ty	Int	Page	Index	Note
-	B4716200	GUIDE PLATE:COUPLING:ASS'Y	0-1	-	3	22	New Index

1.Exterior (B762)

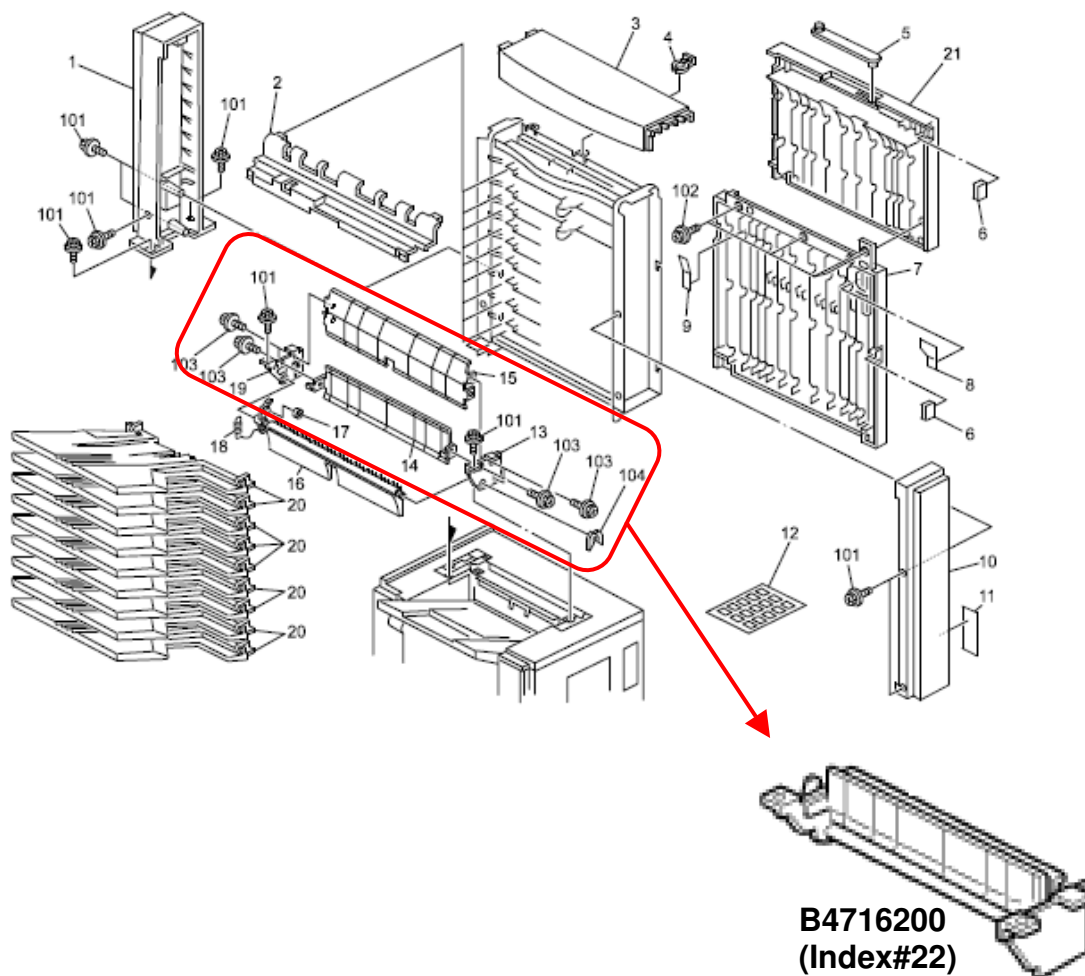

**B4716200
(Index#22)**