

FOUR-BIN MAILBOX

(Machine Code: G553)

1. REPLACEMENT AND ADJUSTMENT

⚠ CAUTION

Turn off the main power switch and unplug the machine before attempting any of the procedures in this section.

NOTE: This manual uses these symbols.

☞: See or Refer to

🔩: screw

🔌: connector

1.1 EXTERIOR COVERS

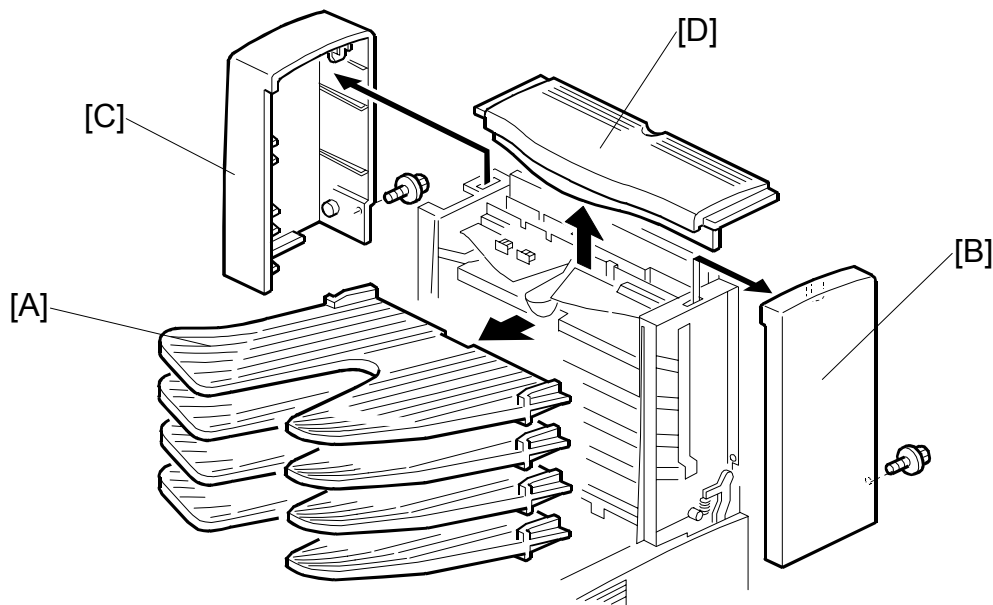

G553R101.WMF

[A]: Each tray (4 x 1 tray)

[B]: Right cover (🔩 x 1)

[C]: Left cover (🔩 x 1)

[D]: Upper cover

1.2 OVERFLOW AND VERTICAL TRANSPORT SENSORS

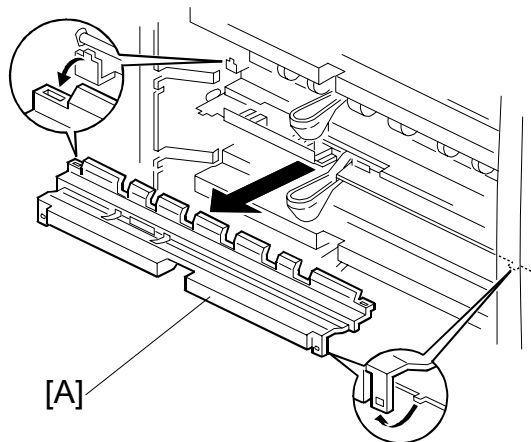

G553R102.WMF

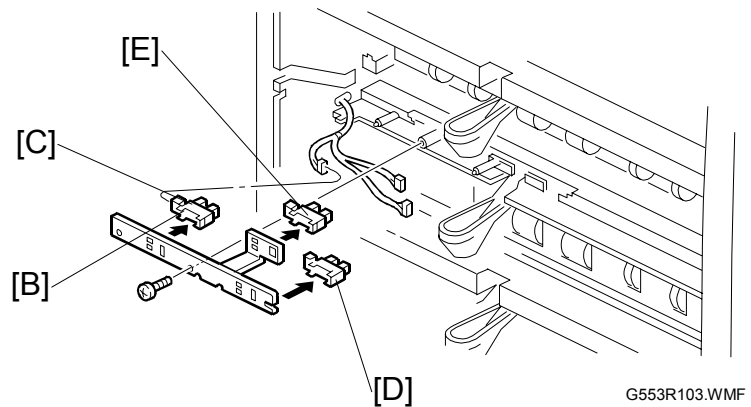

G553R103.WMF

Each tray (☛ Exterior Covers)

[A]: Each tray cover (x 4)

[B]: Sensor holder (☛ x 1)

[C]: Tray paper sensor (☛ x 1)

[D]: Overflow sensor (☛ x 1)

[E]: Vertical transport sensor (☛ x 1)

1.3 MAIN MOTOR

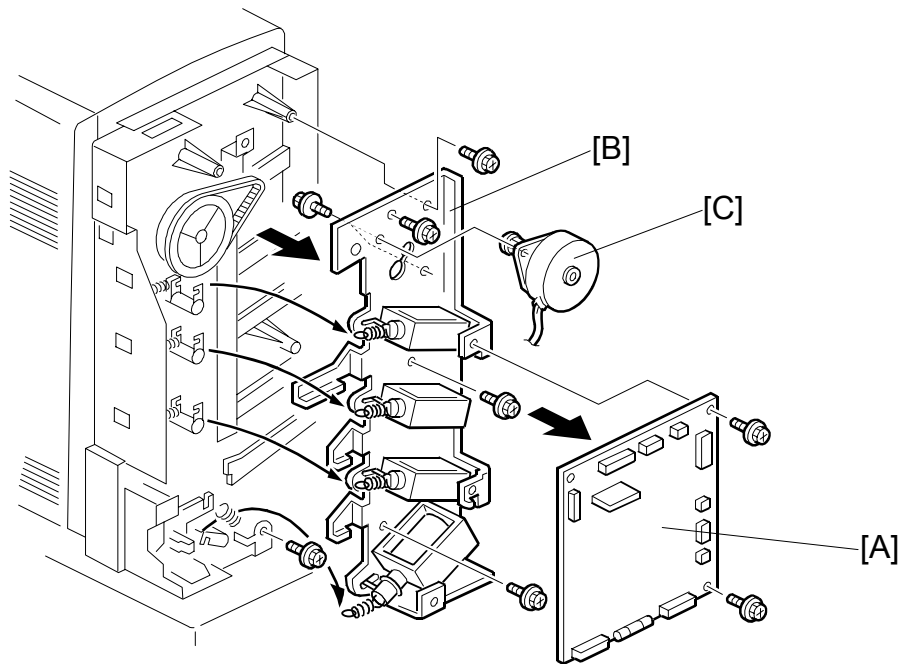

G553R104.WMF

Left cover (☛ Exterior Covers)

[A]: Mailbox board (⚙ x 2, 📧 x 11)

[B]: Drive bracket (⚙ x 5)

[C]: Main motor (⚙ x 2)

2. DETAILED DESCRIPTIONS

2.1 OVERALL MACHINE INFORMATION

2.1.1 MECHANICAL COMPONENT LAYOUT

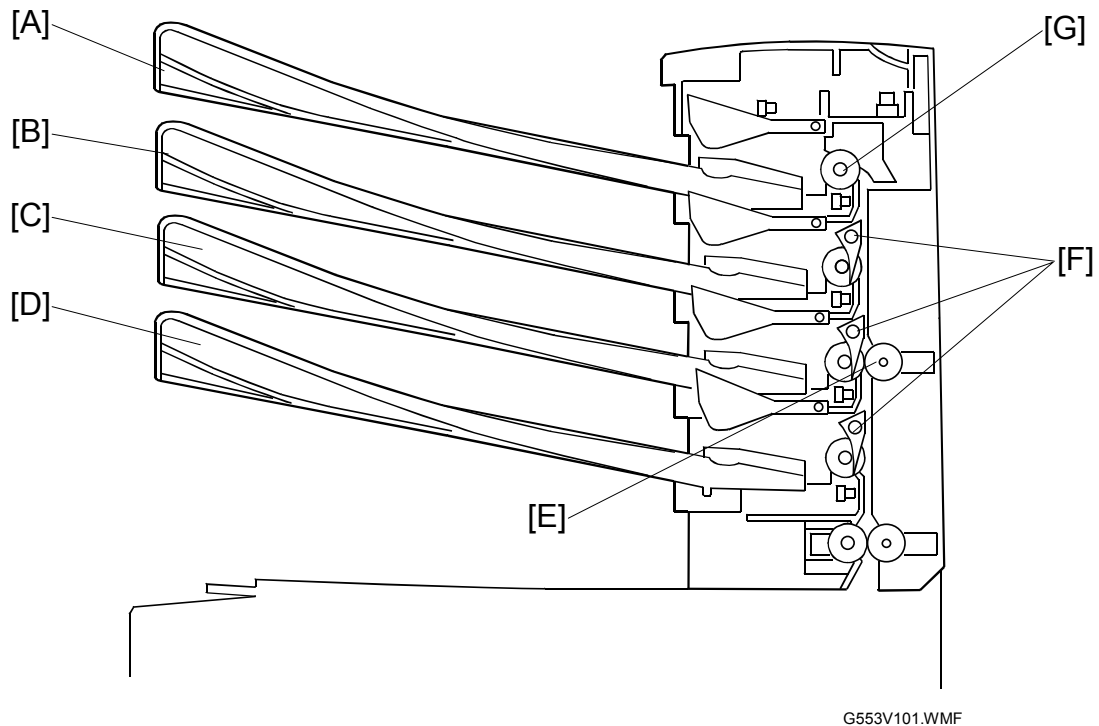

- [A]: 4th tray
- [B]: 3rd tray
- [C]: 2nd tray
- [D]: 1st tray
- [E]: Vertical transport roller
- [F]: Turn gate
- [G]: Exit roller

2.1.2 DRIVE LAYOUT

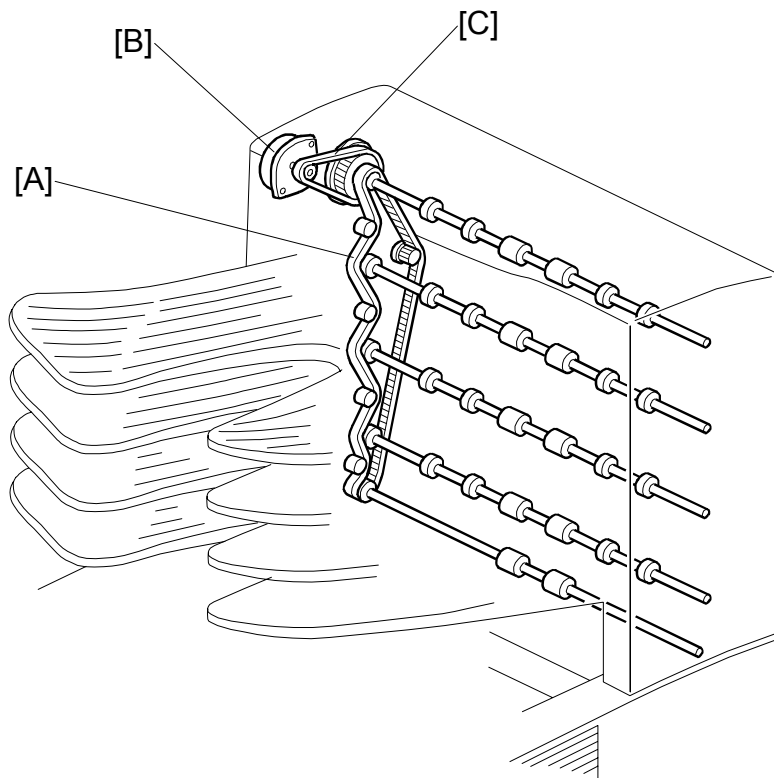

G553V102.WMF

- [A]: Timing belt
- [B]: Main motor
- [C]: Main motor timing belt

2.1.3 ELECTRICAL COMPONENT LAYOUT

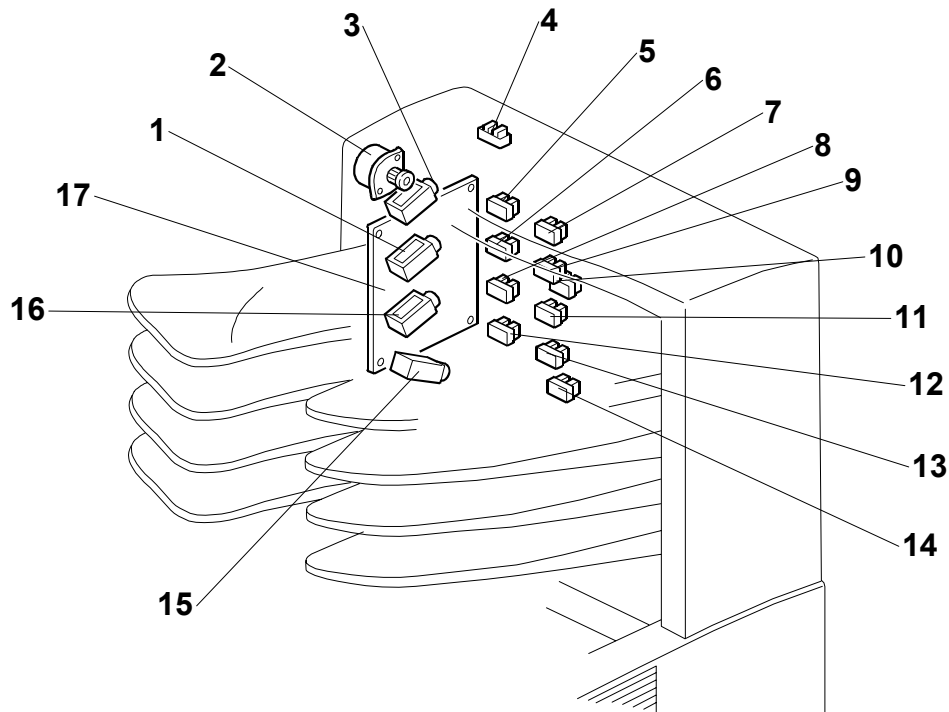

G553V103.WMF

- | | |
|-----------------------------|-------------------------------------|
| 1. 2nd turn gate solenoid | 10. Upper vertical transport sensor |
| 2. Main motor | 11. 2nd tray overflow sensor |
| 3. 3rd turn gate solenoid | 12. 1st tray paper sensor |
| 4. Cover sensor | 13. 1st tray overflow sensor |
| 5. 4th tray paper sensor | 14. Lower vertical transport sensor |
| 6. 3rd tray paper sensor | 15. Junction gate solenoid |
| 7. 4th tray overflow sensor | 16. 1st turn gate solenoid |
| 8. 2nd tray paper sensor | 17. Mailbox board |
| 9. 3rd tray overflow sensor | |

2.2 DETAILED SECTION DESCRIPTIONS

2.2.1 BASIC OPERATION

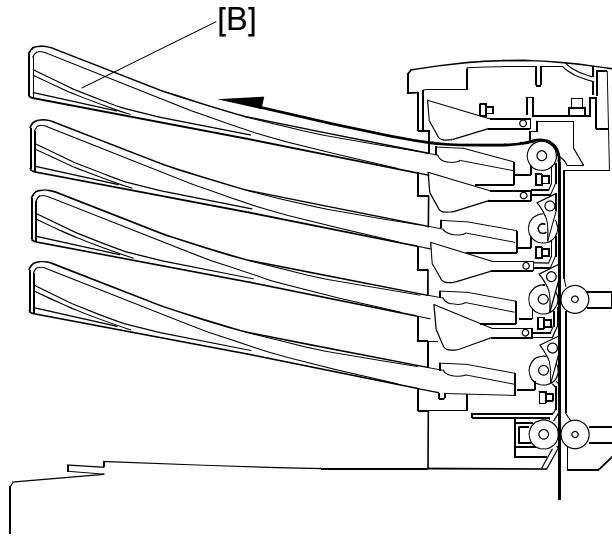

G553D101.WMF

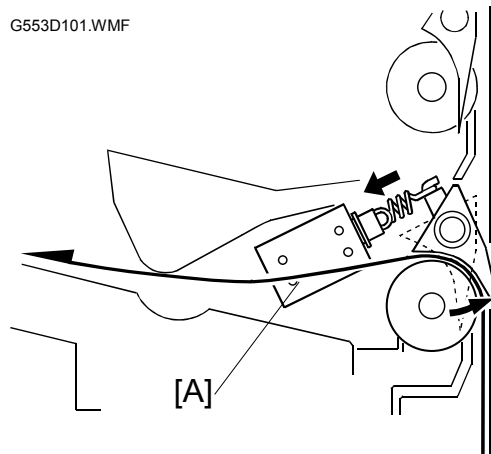

G553V105.WMF

- When the leading edge of the paper activates the exit sensor on the main unit, the mailbox main motor turns on.
- Each turn gate solenoid [A] opens and closes its turn gate, to direct the paper to the selected tray [B].
- When the top tray (4th tray) is selected, none of the solenoids are activated.

After the last sheet passes the upper or lower vertical transport sensor (depending on the selected tray), the main motor, junction gate solenoid, and the turn gate solenoid for the selected tray turn off.